

## Service Light

The service light is located beside the secondary antenna, and indicates the current status of the PS Receiver, as shown in the table below.

LED state	Meaning
Off	Normal operation.
Flashing every 0.5 sec.	Unconfigured PS Receiver. Run Auto Configure in the PS System Manager.
On	Hardware failure. Download firmware to the PS Receiver in the PS System Manager.

## Warranty

Stanley Healthcare Solution's products are warranted against defects in materials and workmanship and shall perform in accordance with published specifications for a period of one year. Stanley Healthcare Solution's warranty is limited solely to the repair or replacement of the defective part or product. Stanley Healthcare Solution reserves the right to change product specifications without notice.

## Limitation of Liability

This Product has been designed for use to assist personnel in summoning help when they are under personal duress, assist in the prevention of infant abduction and/or mother/infant mismatching, and/or locate assets.

The range, accuracy, function and performance of this Product may vary from the published specifications due to many factors, including, without limitation, site impairments from structural effects, metal objects in the vicinity, placement of the receiver and transmitter, interference from other electrical devices, atmospheric effects, installation, and maintenance. There may be other factors, which also affect performance of this Product.

Xmark Corporation does not guarantee that this Product will detect 100% of the calls for personal assistance, detect 100% of infant abductions and/or mother/infant mismatches, and/or locate all assets 100% of the time. Xmark does not guarantee that this Product will not return false reports of calls for personal assistance, infant abductions and/or mother/infant mismatches, and/or location of assets.

Monthly testing and maintenance of this Product, as described in the Product documentation, is essential to verify the system is operating correctly and to ensure that the probability of detecting an alarm and/or locating the transmitter are maximized.

The failure to undertake regular testing and maintenance will increase the risk of system failure and failure to report personal duress calls, failure to detect infant abductions and/or mother/infant mismatches, and/or failure to locate assets. The failure to undertake regular testing and maintenance will increase the risk of false reports of calls for personal assistance, infant abductions and/or mother/infant mismatches, and/or location of assets.

**Xmark hereby disclaims all warranties, express or implied, arising out of or in connection with any of its Products of the use**

or performance thereof, including but not limited to, where allowable by law, all other implied warranties or conditions of merchantable quality and fitness for a particular purpose and those arising by statute or otherwise in law or from a course of dealing or usage of trade.

Xmark's liability to you or anyone claiming through or on behalf of you with respect to any claim or loss arising out of the use or misuse of Xmark's Product, defective products or materials, improper installation or maintenance of Xmark's Product or products or the system in which they are incorporated, or alleged to have resulted from an act or omission of Xmark or any person, negligent or otherwise, shall be limited to:

- A) the repair or replacement of defective Product or materials supplied by Xmark during the warranty period as set out in the Product documentation; or, at the option of Xmark,
- B) a refund of the purchase price of the Product supplied by Xmark.

In no event shall Xmark be liable for general, specific, indirect, consequential, incidental, exemplary or punitive damages or any losses or expenses suffered by you or anyone else, whether or not Xmark, or its employees, officers, agents, resellers or installers has been informed of the risk of such loss or expense and whether or not such losses or expenses were foreseeable.

## Statements

### United States—Federal Communication Commission (FCC)

This device complies with Part 15 of the FCC Rules. Operation is subject to the following two conditions: (1) this device may not cause harmful interference, and (2) this device must accept any interference received, including interference that may cause undesired operation.

NOTE: This equipment has been tested and found to comply with the limits for a Class A digital device, pursuant to Part 15 of the FCC Rules. These limits are designed to provide reasonable protection against harmful interference when the equipment is operated in a commercial environment. This equipment generates, uses, and can radiate radio frequency energy and, if not installed and used in accordance with the instruction manual, may cause harmful interference to radio communications. Operation of this equipment in a residential area is likely to cause harmful interference in which case the user will be required to correct the interference at his own expense.

**Warning:** Changes or modifications not expressly approved by Xmark could void the user's authority to operate the equipment.

### Canada—Industry Canada

This device complies with RSS-210 of Industry and Science Canada. Operation is subject to the following two conditions: (1) this device may not cause interference, and (2) this device must accept any interference, including interference that may cause undesired operation of the device.

# Patient Security Receiver Installation Guide

Part Number: 816A0101

## Important!

### Have you:

- Pulled network and power cable?
- Resolved power supply requirements?
- Selected the location for the PS Receiver?

If you answered “No” to any of these questions, refer to the installation manual before installing.



Read these instructions thoroughly before installing the PS Receiver. Faulty installation can lead to system failure.



## Materials Required

- Patient Security Receiver (p/n 816A0101); includes antennas, Caddy clip and mounting hardware.
- Facility floor plan indicating PS Receiver position and network wiring path.
- 105  $\Omega$  network terminator (p/n 805A2401) required to terminate network. Two provided with each Patient Security Server.

## Specifications

Frequency	217 MHz
Supply Voltage	12-30 VDC
Current Draw	60 mA @ 12 / 24 VDC, 100 mA max.
Detection Radius	50 ft. (15 m) overlapping PS Receivers 35 ft. (11 m) stand-alone PS Receivers
Communications	LonWorks two wire
Temperature	Operating: 32°F to 120°F (0°C to 49°C) Storage: -22° to 158° F (-30° to 70°C)
Humidity	0-85% RH @ 70°F (21°C), non-condensing
Dimensions	Approximately 5.2 x 3.3 x 1.5 in. (133 x 84 x 38 mm)
Weight	Approximately 9.2 oz. (260 g)

## PS Receiver Orientation

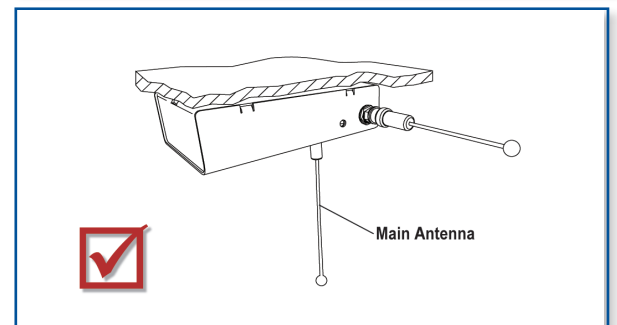
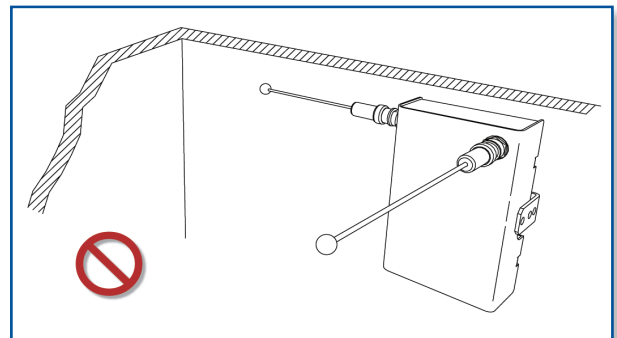

- Main antenna should be pointing downward into an area free of metal obstructions.
- Ensure that the PS Receiver is at least 2 ft. (60 cm) from metal objects, such as framing or air ducts.

**STANLEY**  
Healthcare Solutions

309 Legget Drive Ottawa, ON K2K 3A3 Canada  
Telephone: 1.866.559.6275 International: +1 (613) 592.6997 Facsimile: (613) 592.4296  
Web site: www.stanleyhealthcare.com  
© 2009 Xmark Corporation. All Rights Reserved.  
Printed in Canada. January 2009. 981-806004-000 Rev A.

## Installation Considerations

- **Position the PS Receiver beneath ceiling obstructions**—When mounting above drop ceilings, mount the PS Receiver below metal duct work, pipes and foil-backed ceiling tiles.
- **Route cables up and away from the PS Receiver**—When the cable is not in conduit, keep it at least 1 ft. (30 cm) from the PS Receiver.
- **Install the PS Receiver temporarily until testing is complete**—Fastenings should be secure enough that the PS Receiver can be permanently mounted without disturbing its orientation.
- **Point the secondary antenna into a clear area, away from metal objects**—The main antenna always points downwards, but the orientation of the secondary antenna is adjusted to suit site conditions. Point it away from metal objects, and make sure it is not running parallel to cabling in the ceiling.
- **Observe temperature and humidity restrictions**—Refer to the Specifications table.
- **Leave slack in the cable**—Leave at least 10 ft. (3 m) of slack in the communication and power cable to allow for adjustments in the location of the PS Receiver.
- **No user adjustments to internal circuitry**—Tampering may cause component or system failure, or both, and will void the warranty.

## Installing the PS Receiver



- **Ensure that the power supply and network are turned off to prevent electrical shock or damage to equipment.**
- **Touch your hand to ground to discharge any electrostatic charge before handling the PS Receiver.**

- 1** Record the LonWorks Neuron ID number.  
Locate and record the LonWorks Neuron ID number onto the facility floor plan indicating the PS Receiver's position and network wiring path. Affix one of the supplied Neuron ID labels on the floor plan and affix the other on the PS Receiver in a visible location.
- 2** Remove the Mounting Plate from the PS Receiver.  
If the PS Receiver is to be installed to a receptacle box, pass the network and power supply wires through the hole in the Mounting Plate. (For other installations, the wires are passed through the slot on the side of the PS Receiver case in Step 5.)
- 3** Wire the terminal block.  
Connect the LonWorks Network IN, Network OUT, and Power Supply to the terminals. If the PS Receiver is at the end of the network, then terminate the network segment with Item A (105  $\Omega$  terminator). Ensure there is at least 10 ft. (3 m) of slack in the cable to allow the possible repositioning of

the PS Receiver.

### 4 Install the Mounting Plate.

Referring to the facility floor plan, decide the position of the PS Receiver. Do not place near metal objects and structural frames. Ensure that the service light will be visible and that space is allowed for the antennas. Unless there is a conduit tray, run the cables at least 1 ft. (30 cm) up and away from the PS Receiver.

Install the mounting plate using one of the following methods.

#### A Fasten to a suspended ceiling guy wire, using:

- 1 multi-function Caddy clip
- 2 machine screws
- 2 hex nuts
- 2 lock washers, OR

#### B Install directly to a ceiling or a wall using:

- 2 wood screws
- 2 hollow wall anchors, OR

#### C Install to a receptacle box, using:

- 2 machine screws

### 5 Install the PS Receiver to the Mounting Plate.

Plug the wired terminal block into the PS Receiver and install the PS Receiver onto the Mounting Plate, using the screw removed in Step 2. **DO NOT** place excess network and power supply wires inside the PS Receiver case.

### 6 Attach the two antennas.

The antennas have a protective covering to prevent them from touching metal. For best coverage, ensure that they are at least 2 ft. (60 cm) from metal objects. Do not encase, wrap, or otherwise cover the antennas.

Installation is complete. Proceed to **Final Steps**.

## Final Steps



- **Do not supply power to the PS Receiver or any other network device until all connections are complete.**

Once all devices are installed, power up the PS Receiver and other devices. In the PS System Manager, run Auto Configure to install the new devices, and then configure them for operation.

The coverage area of the PS Receiver must also be checked.

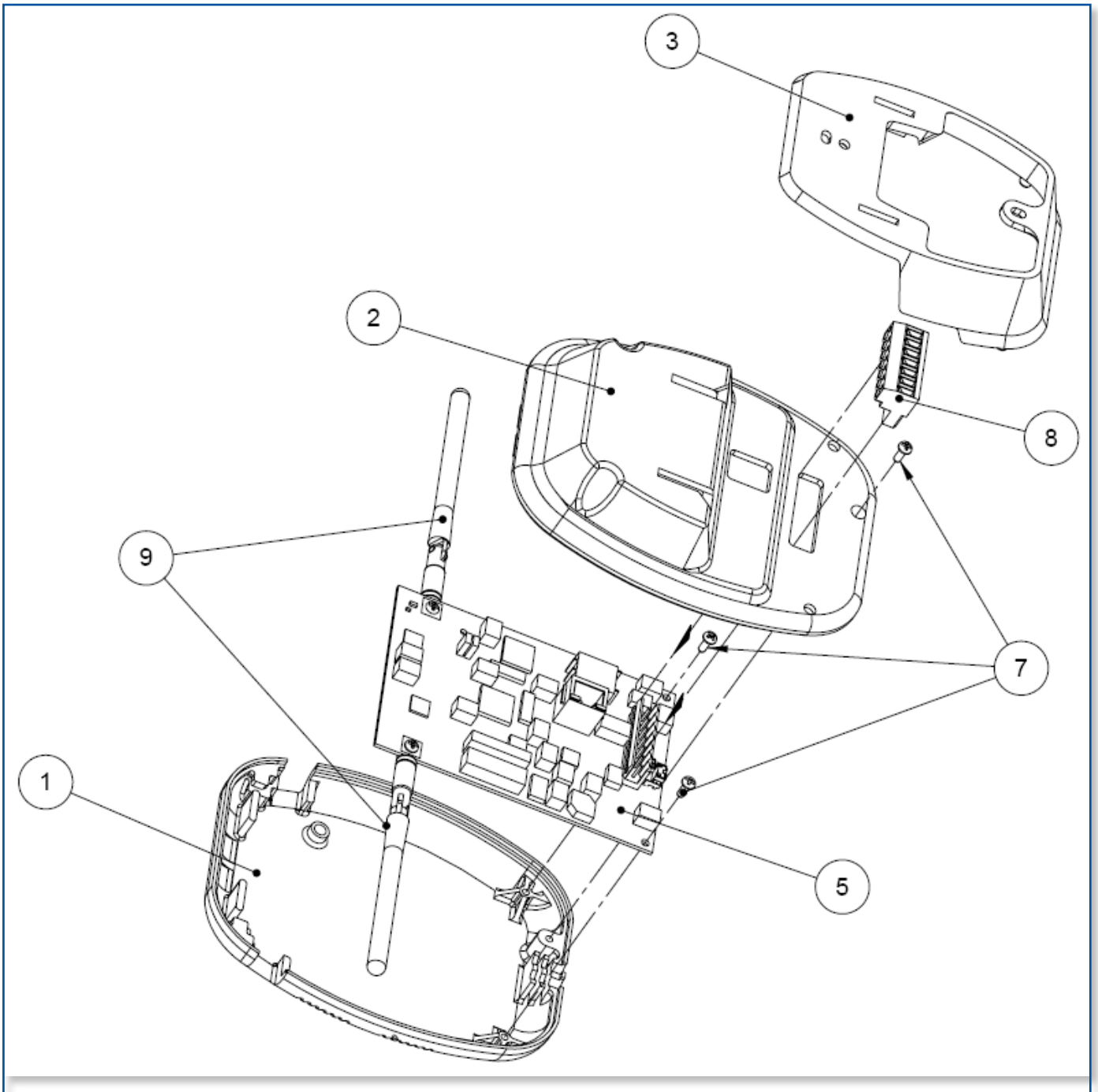

**Figure 1: Physical Connections for the PS Receiver**