

C1⁺

A Dashcam to Play



xplore[®]

/ HELLO

Thanks for choosing C1+.

This guide will show you how to install and use C1+.

/ Meet C1+

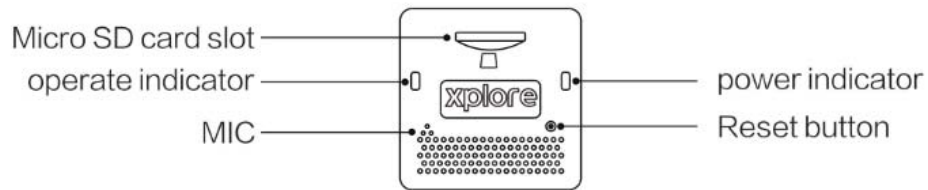

Working LED

Recording
Recording / Memory Card Error
Snapshot
WiFi Error
GPS Error
Snapshot Remote Error

GREEN
OFF
GREEN Flash
RED
YELLOW
BLUE

Power LED

Low Power 10%
Low Power 20%
Charging
Full
Upgrading Firmware

RED Flash
RED
BLUE Flash
GREEN
GREEN Flash

/ Quick Start

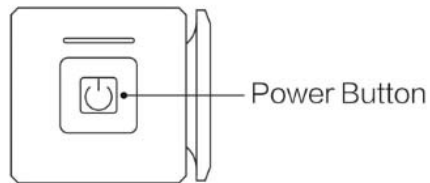

C1+ starts recording automatically on engine starts, and features a Auto-Power-Off 20s after engine stops.

ActionCam Mode (when C1+ is off)

TURN ON: Hold the Power Button for 2 seconds.

SHUT OFF: Hold the Power Button again for 3 seconds.

Snapshot Mode: When recording, press Power Button, C1+ generates a 12 seconds footage and saves a thumbnail file.

/ Accessories

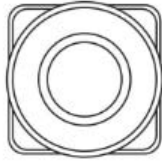

C1+



Bracket Docking

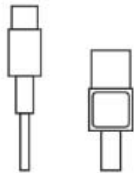

Cable



Manual

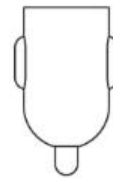

Dual Socket
Power Adaptor

/ Apply C1+ onto Your Car

- 1 Make sure the engine is off. Wipe clean your windshield before installation and take a suitable spot on it without blocking the view when driving. Connect the Bracket Docking with the Power Adaptor (either 2.1A or 1.0A) with the 3.5m USB cable (can be laid hidden if desire) in the package.
- 2 Insert a Memory Card (SDHC Class 10 or above recommended) into C1+.
- 3 Mount C1+ onto the Bracket Docking.

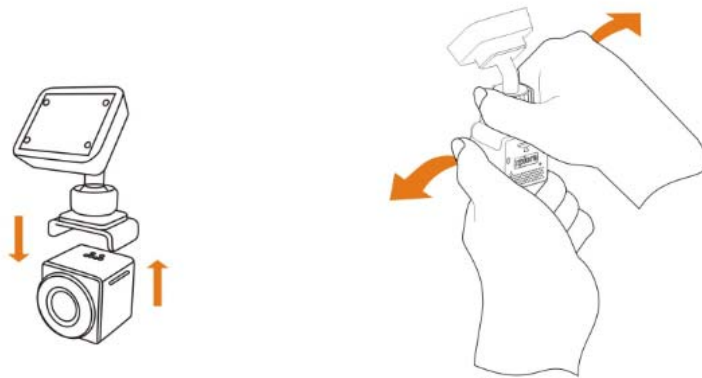

- 4 Plug in Power Adaptor to your cigarette lighter.

And……There you go!

/ install location & cabling

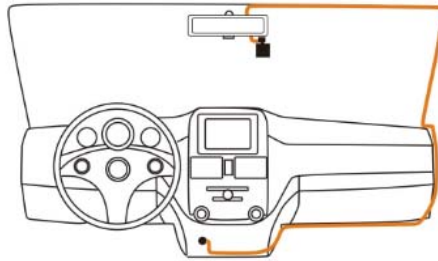

Tips:

- ★ Do not install where blocks driver's vision.
- ★ It is recommended to install behind the rear-view mirror.
- ★ Use Cable Clips to better organizing cable.

/ Xplore App

1 Downloading the App

Now the Xplore Apps are available on AppStore and Android Market! Search for “XploreCam” . Also you can download from our official website xploreCam.com.

2 Wi-Fi Connection



For iOS users:

Make sure your smartphone's Wi-Fi is switched on, search for SSID “Xplore_XXXXXX” , then connects it. Initial password is 12345678. Open the App and search for your C1+, it will appear automatically in the list.

For Android users:

Make sure your smartphone's Wi-Fi is switched on. Open the App, and find your C1 + in the list, then connects it.

/ FAQs

1 Q: Won't record?

A: Use SDHC compatible rapid storage card (Class 10 or above), make sure it comes from an authorized seller. Check if there's enough space on memory card, or format it if necessary.

2 Q: Device is heating.

A: Heating is normal C1+ has passed the heating test from the 3rd party authority. Its normal operating temperature is $-20^{\circ}\text{C} \sim 70^{\circ}\text{C}$.

3 Q: Device hanged.

A: Use a paperclip to press the "reset" button at the back of the device.

4 Q: What's the maximum capacity of memory card C1+ supports? Is Plug & Play?

A: Maximum capacity of memory card C1+ supports is 32 GB. Plug & play is not recommended. Insert or remove memory card best when the device is off, in case the device may cause malfunction.

5 Q: What's seamless loop recording?

A: When memory card is full, C1+ will overwrite from the earliest footage (File lock protecting footages and emergency footages will not be overwritten).

Warning:

This device complies with Part 15 of the FCC Rules. Operation is subject to the following two conditions: (1) this device may not cause harmful interference, and (2) this device must accept any interference received, including interference that may cause undesired operation.

changes or modifications not expressly approved by the party responsible for compliance could void the user's authority to operate the equipment.

NOTE: This equipment has been tested and found to comply with the limits for a Class B digital device, pursuant to Part 15 of the FCC Rules. These limits are designed to provide reasonable protection against harmful interference in a residential installation. This equipment generates, uses and can radiate radio frequency energy and, if not installed and used in accordance with the instructions, may cause harmful interference to radio communications. However, there is no guarantee that interference will not occur in a particular installation. If this equipment does cause harmful interference to radio or television reception, which can be determined by turning the equipment off and on, the user is encouraged to try to correct the interference by one or more of the following measures:

- Reorient or relocate the receiving antenna.
- Increase the separation between the equipment and receiver.
- Connect the equipment into an outlet on a circuit different from that to which the receiver is connected.
- Consult the dealer or an experienced radio/TV technician for help.

NOTE: This device and its antenna(s) must not be co-located or operation in conjunction with any other antenna or transmitter

RF Exposure Statement

To maintain compliance with FCC's RF Exposure guidelines, This equipment should be installed and operated with minimum distance of 20cm the radiator your body. This device and its antenna(s) must not be co-located or operation in conjunction with any other antenna or transmitter