

No.	Name	Description
1	Number of pouches	Displays the remaining number of pouches to be packaged in the current prescription data. The number goes down in response to the progress of packaging until it becomes 0 or the STOP button is pressed.
2	ECO	Activates the power saving mode.
3	Patient ID	Displays the patient ID.
4	Ticket No.	Displays the ticket number.
5	DTA queue	Displays the number of scripts in the DTA queue.
6	Ink level	Displays the ink ribbon level on a scale of zero to five.
7	Remaining paper	Displays the remaining paper level on a scale of zero to five.
8	Heater temperature	Displays the temperature of the heat roller. Dispensing is available in the temperature range from 90°C to 130°C .
9	Connection	Displays the connection status with the computer by O and X.
10	Machine status	Displays the packaging machine status.
11	Start button	Moves to the individual release mode screen.
12	DTA open/close button	Opens and closes the DTA tray.
13	DTA set button	Sets the DTA. The background color varies depending on the number of prescriptions in queue. Queue 0: White Queue 1: Light blue Queue 2: Gray
14	Canister button	Searches the canister.
15	Maintenance button	Moves to the maintenance mode.
16	Patient name	Displays the patient name.
17	Fraction	Displays the fraction registered in the prescription data. (This is the number of times to take medicine per day.)
18	Number of days	Displays the number of days or frequency registered in the prescription data.
19	Order	Displays the order of dispensing.
20	Category	Displays the category of tablets registered in the prescription data. (Canister, DTA, UC)
21	Entry No.	Displays the entry number of DTA instruction.
22	Medicines to be set	Displays medicines to set in the DTA.
23	Stop button	Suspends dispensing. (Only during dispensing)
24	Cancel button	Cancels the prescription data.

How to Turn On the Power

The packaging machine is connected to the system of the computer.

If the computer is turned on, the packaging machine is automatically turned on.

Note: The breaker needs to be controlled such as when installing the packaging machine or cleaning the print head.

1 Insert the power plug to the outlet.

Use a three-pronged grounded 120VAC or 230VAC outlet depending on the standard in the geographic area of use.

When using a two-pronged outlet, use a three-prong/two-prong adapter.

Do not connect the power plug to the power strip with an excessive number of plugs inserted.

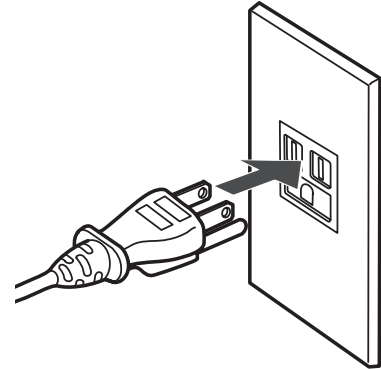

WARNING

Do not use the product when the power cord and plug are damaged or the plug is loose. Doing so may cause fire due to short circuit or electric shock.

2 Turn on the breaker.

Lightly push the upper right part of the left door. Open the left door.

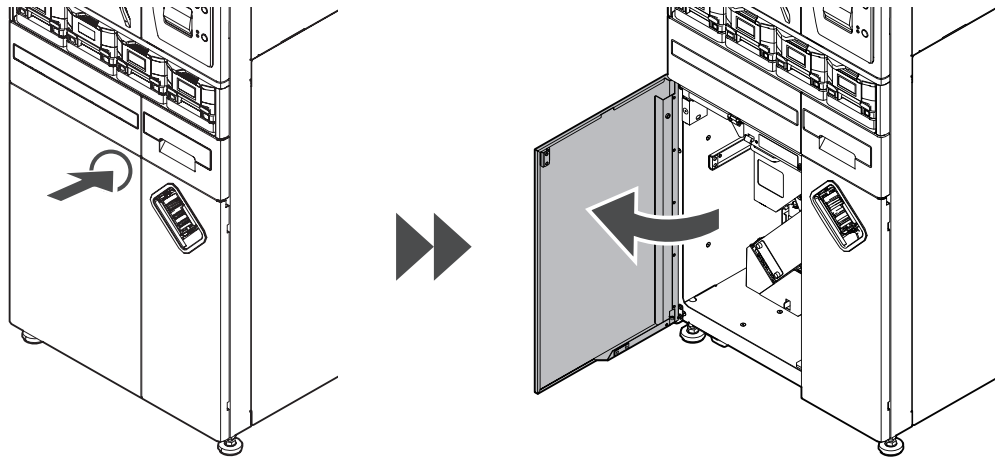

Flip up the breaker switch. After turning the breaker on, close the door.

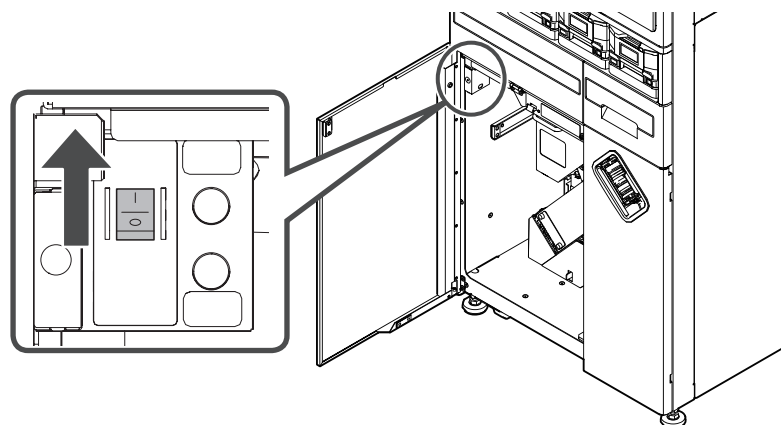

3 Turn on the computer.

Turn on the computer.

If the computer is turned on, the packaging machine and the tablet packaging system "JSD.NET" will be automatically turned on.

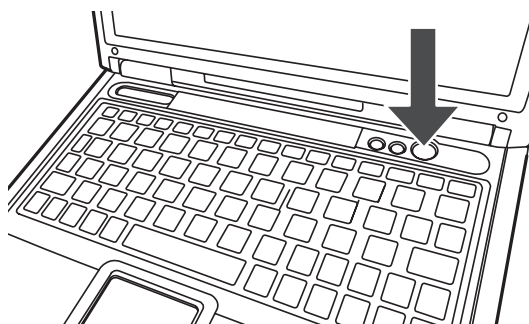

4 Start the operation.

The packaging machine and the computer are turned on.

Please wait for a while until the message "Waiting. Ready for dispensing." is displayed on the touch panel of the packaging machine.



Turn off the power after use. When turning off the power, turn off the computer first. When the system is turned off, the machine is automatically turned off.
Note: When moving the packaging machine or cleaning the print head, turn off the breaker as well.

1 End the tablet packaging system.

Click [JSD.NET] and then click [End]. When the confirmation message appears, click [OK].



2 Shut down the computer.

When pressing the Windows logo key, the start menu appears on the computer screen.

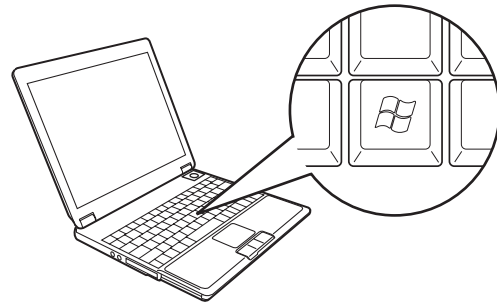

Click [Shutdown].
The computer is turned off.

CAUTION

When leaving the machine off for a long time after the end of business hours, turn off the breaker.

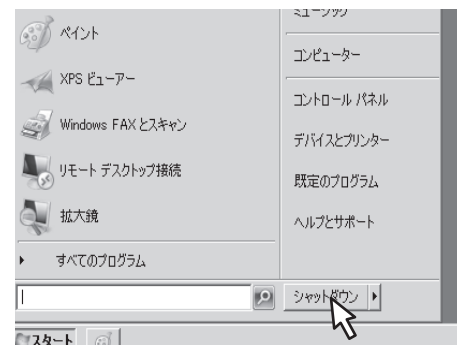

■ When the Printer is Inkjet (Option)

Click [End].
JSD.NET goes off. After the inkjet printer is turned off, the packaging machine is also turned off. (It takes about 5 minutes.)
Do not turn off the breaker of the packaging machine before the packaging machine is turned off.
Turning off the power before the completion of the termination process may result in faint printing.
When restarting JSD.NET, the packaging machine is restarted as well.

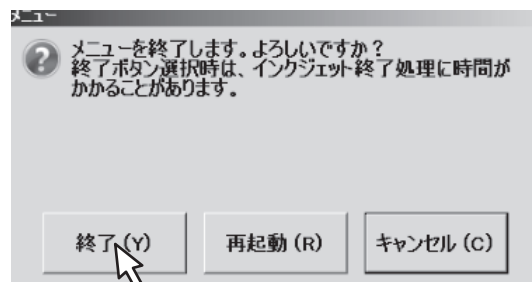

Dispensing

When Dispensing Medicines from Canisters

When dispensing only medicines stored in canisters, enter the prescription on the computer and then release it.

1 Release the prescription.

For the details of how to enter the prescription, refer to the "JSD.NET" instruction manual.

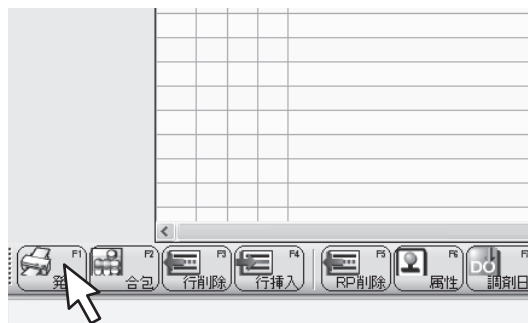

After the prescription is released, dispensing starts.

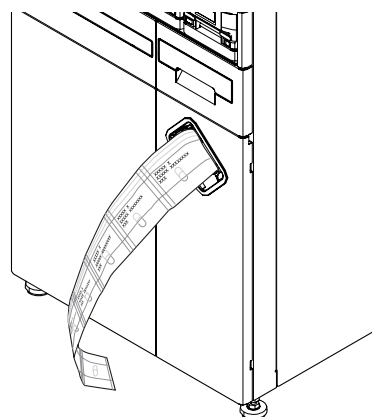
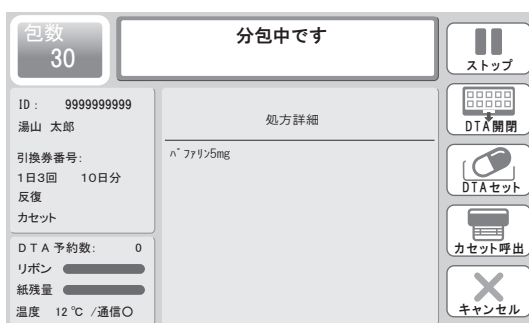

Dispensing Medicines from DTA

■ When Dispensing Medicines from DTA

When dispensing tablets which are not stored in canisters such as those are seldom used, set them in the DTA tray manually for each prescription. Enter the prescription on the computer and release it first. Then set tablets in the DTA tray manually.



When DTA LED Lights (Option) are Installed

The LED lights on the DTA tray turn on in blue, red, green, purple, light blue, and yellow depending on the method.

1 Release the prescription.

For the details of how to enter the prescription, refer to the “JSD.NET” instruction manual.

When dispensing tablets manually, the audio guidance “Set DTA.” is played and the DTA instruction is output from the journal printer. Then dispense tablets from the main body in the following procedures.

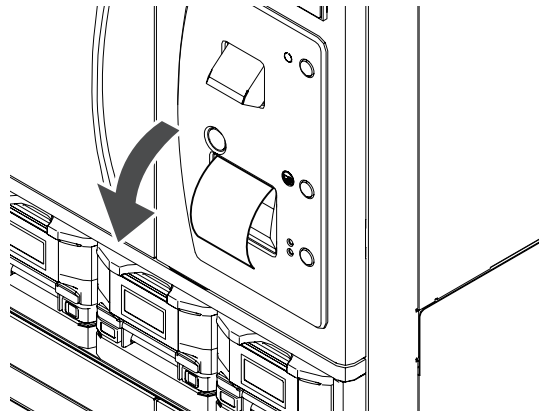

“S” printed on the DTA instruction (normal) indicates the start date, and “E” indicates the end date.

Setting of the DTA instruction print layout is available in the system environment settings. For the details, refer to the “Environment Settings (Dispensing Related)” described in the “JSD.NET” instruction manual.

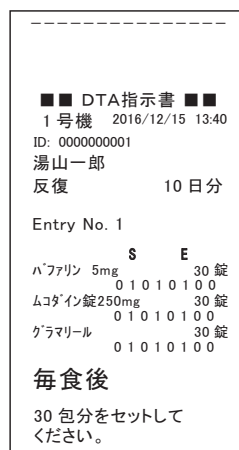

Image of DTA instruction
(normal)

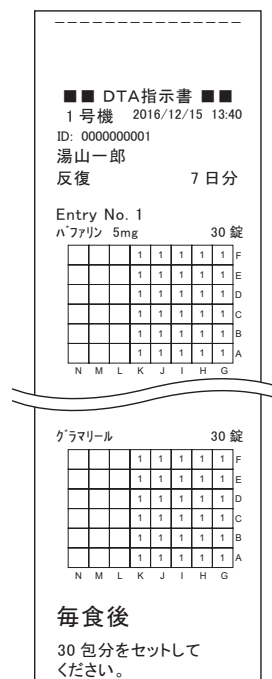

Image of DTA instruction
(detail)

2 Open the DTA tray.

The message “Set tablets in DTA” appears.
Tap [DTA Open/Close] to open the DTA tray.



3 Go back to the DTA job list screen.

Up to 13 medicines are displayed in one page on the DTA setting screen. If the number of medicines is 14 or more, tap [Next] to move to the next page.

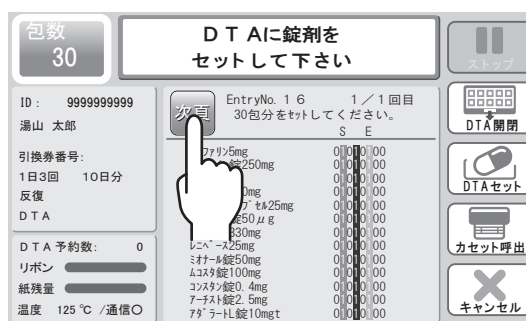

When the medicine name is tapped, it becomes selected.

Note: If the dose is half tablet, the half tablet icon is displayed next to the medicine name.



4 Tap [Detail].

Tap the medicine name to display and then tap [Detail] to display its detail setting screen.

Note: As for a half tablet, the number of tablets is displayed as "1/2".

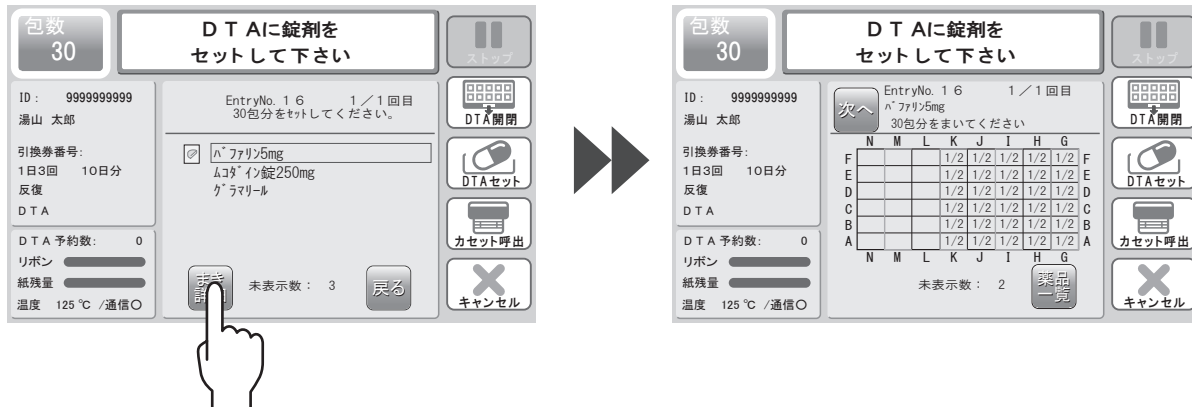

■ When DTA LED Lights (Option) are Installed

The setting position in the DTA tray and the number of tablets are displayed with different colors depending on medicine type and dosing time.

The colors are displayed as set in the method master and dosing period master of the system. (Blue, Red, Green, Purple, Light blue, Yellow)

Note: For the details of how to set the LED lights, refer to the "JSD.NET" instruction manual.



⚠ CAUTION

If the method is set to 7 times or more per day, every dosing time is displayed with the same color. If the LED colors are not set in the method master and dosing period master, or the same LED color is selected for some dosing times, every dosing time is displayed in blinking white.

5 Set tablets in the DTA tray.

Starting from the right front side, set tablets in the DTA tray in accordance with the numbers on the DTA partition tray.

Before setting tablets in DTA, prepare them in another container such as a tray.

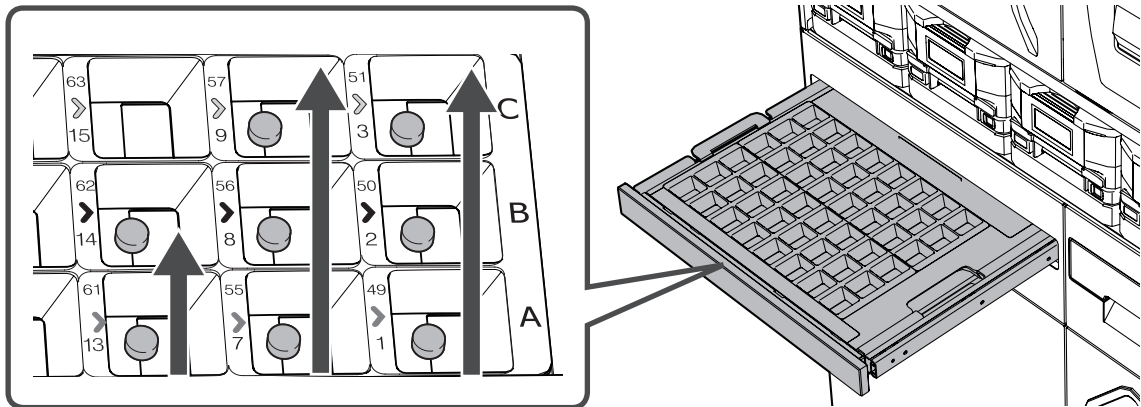

■ When DTA LED Lights (Option) are Installed

Set tablets in the DTA tray by checking the DTA instruction, detail setting screen, and each LED color on the DTA tray.



WARNING

The LED lights do not turn on when the prescription is released through the machine.

💡 When Removing the DTA Partition Tray

When returning the DTA partition tray to its original position, be sure to check if it is set in place.

⚠️ WARNING

- When the DTA partition tray is removed, the LED lights go off. Thus, be sure to set the correct DTA partition tray back in place after removing it or when using several DTA partition trays. The LED lights turn on again when the DTA partition tray is set in place.
- When setting the DTA partition tray in place, check if its left back side is in place properly when seen from the front side. If not, the LED lights may not turn on or medicines are not packaged correctly.

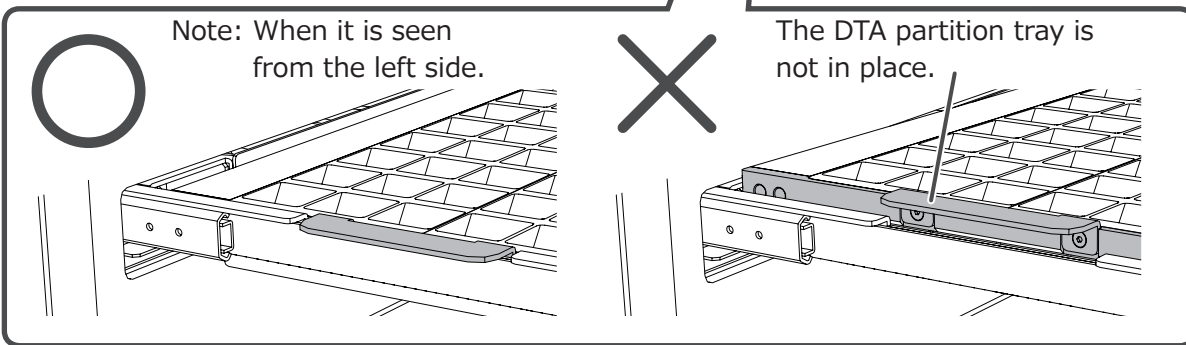
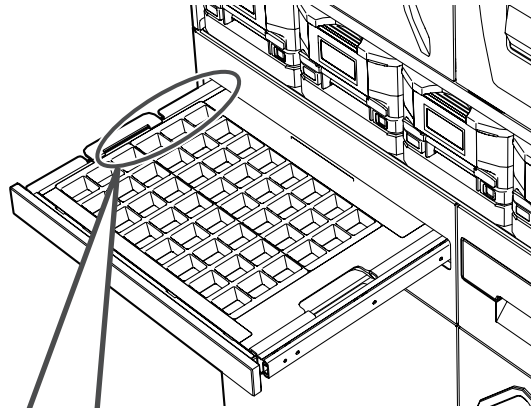

6 Set another type of tablets in the DTA tray.

When [Next] is tapped, the detail setting information of the next medicine appears. Then set the medicine in the DTA tray.



7 Tap [Job List].

Go back to the DTA job list screen. The background color of the medicine name is changed to gray, which indicates that its detail DTA setting is already checked.

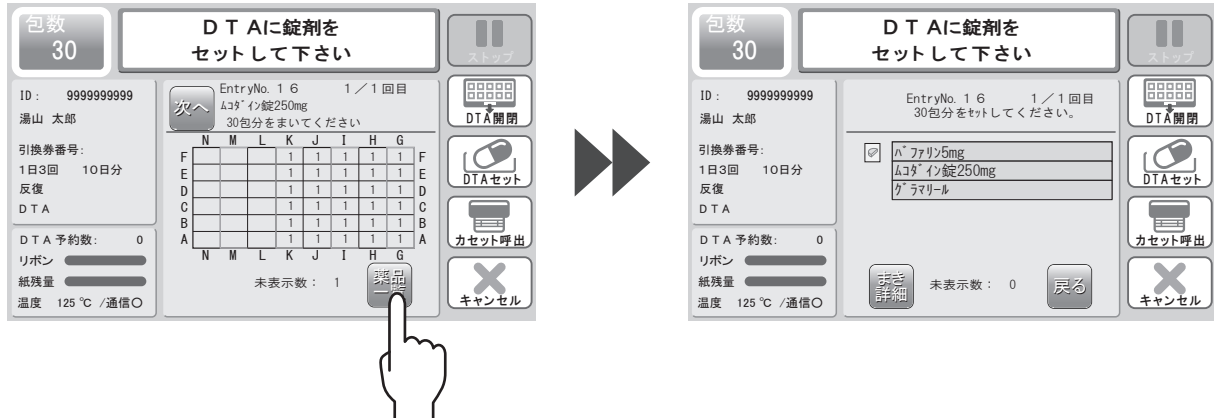

8 Close the DTA tray.

Tap [DTA Set] to close the DTA tray. The DTA job list screen is switched to the dispensing mode screen and then dispensing starts.

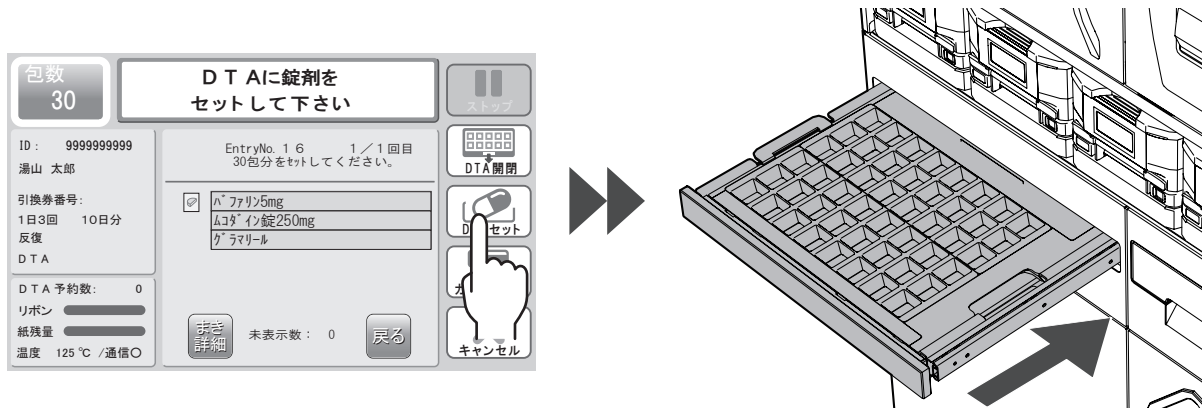

Individual Release Mode

Dispensing is available without the computer but only with the touch panel.

Press the [Spare Power] button to turn on the packaging machine.

Note: This function is for emergency, such as when a computer failure occurs.

1 Tap [Start].

The screen is switched to the one for dispensing medicines through the packaging machine.



2 Select the print classification.

Select the items to print on the packaging paper.

Tap the frame of [Print Classification], and it switches in the following order: [No], [Before Meals], [After Meals], [Between Meals], and [As Needed].



3 Select the number of days.

By tapping the frame of [Number of Days], the numeric keypad screen appears.

Enter the number of days and then tap [ENT].

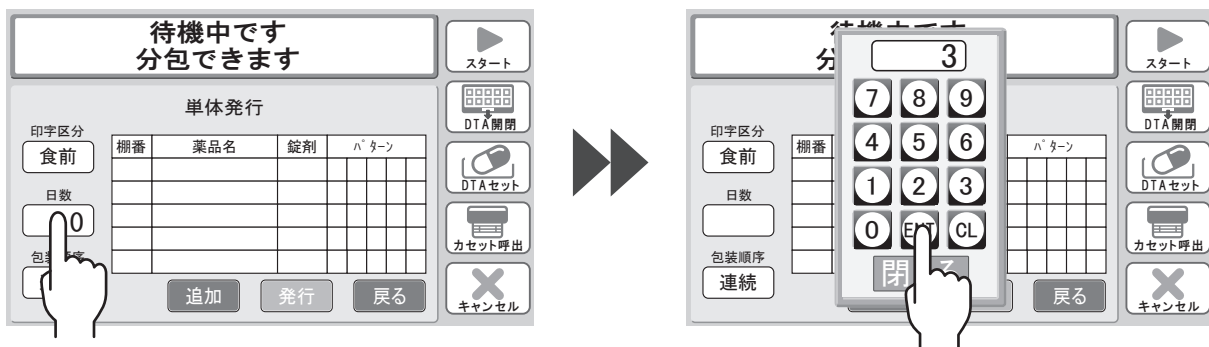

4 Select the dispensing order.

Tap the frame of [Dispensing Order], and it switches between [Repeat] and [Continuance].

Repeat: "Morning/Morning/Morning" ->
 "Afternoon/Afternoon/Afternoon" ->
 "Evening/Evening/Evening"

Continuance: "Morning/Afternoon/Evening" ->
 "Morning/Afternoon/Evening" ->
 "Morning/Afternoon/Evening"

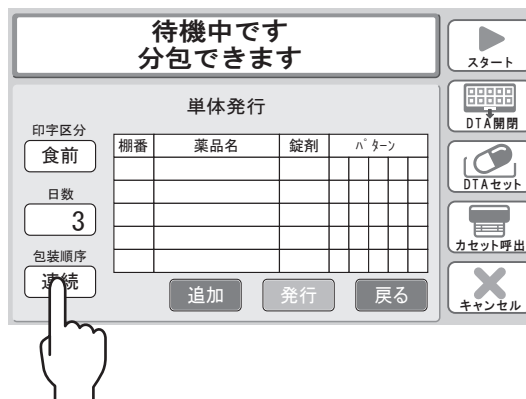

5 Tap [Add].

The screen is switched to the entry screen for medicines and dispensing patterns.

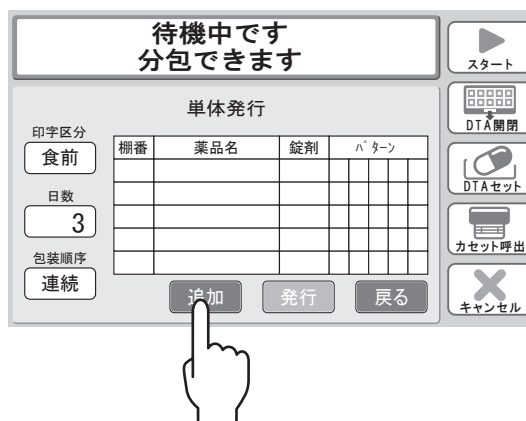

6 Select the medicine.

Tap the initial letter of the medicine to select. The medicine names starting with the selected initial letter are displayed in the list, thus tap and select the medicine.



As for the colors,
selected medicine is displayed in light blue,
unselected medicine stored in the canister for
half tablet is displayed in pink,
and medicine stored in several canisters is
displayed in green.

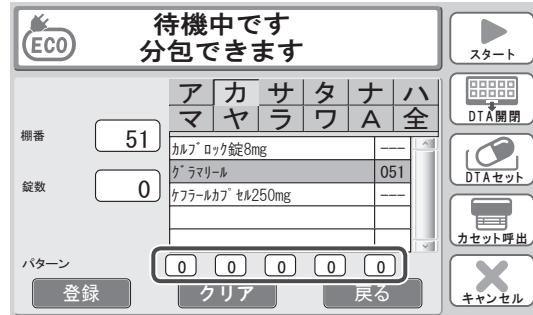

7 Select the pattern.

By tapping the frame of [Pattern],
the numeric keypad screen appears.
If the pattern is selected without selecting
medicines, it is determined as the DTA
prescription.

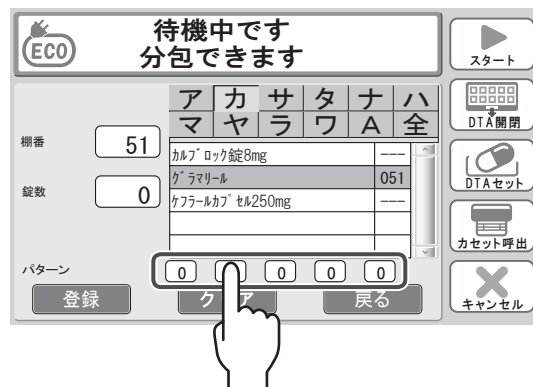

Enter the number of tablets to take for each
time and then tap [ENT].

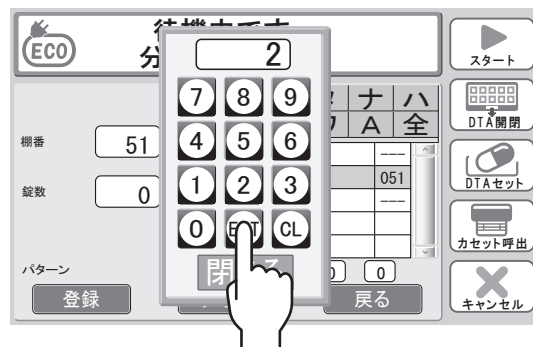

The pattern frame indicates the dosing time.
(Wake time, Breakfast, Lunch, Dinner, Bed-
time)

The number of tablets indicates the total
number of tablets for each day (pattern).

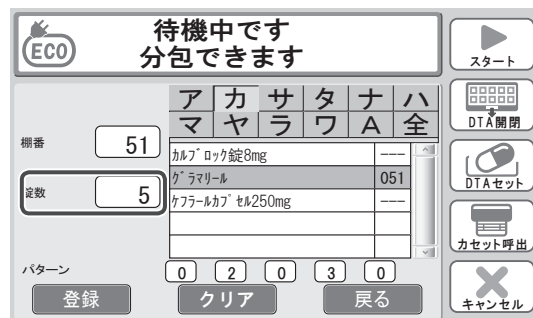

8 Tap [Save].

When adding medicines, continue to enter medicines and dispensing patterns.

待機中です
分包できます

ECO

スタート

DTA 開閉

DTA セット

カセット呼出

キャンセル

欄番 51

錠数 5

パターン 0 2 0 3 0

登録 クリア 戻る

ア	カ	サ	タ	ナ	ハ
マ	ヤ	ラ	ワ	A	全

Note: If the medicine is dispensed from DTA, the rack number shows "DTA" .

待機中です
分包できます

スタート

DTA 開閉

DTA セット

カセット呼出

キャンセル

単体発行

印字区分 食前

日数 3

包装順序 反復

追加 発行 戻る

欄番	薬品名	錠剤	パター				
051	ハファリン5mg	15	0	2	0	3	0
DTA	グラマリール	6	0	1	1	0	0

9 Tap [Release].

Dispensing starts.

待機中です
分包できます

スタート

DTA 開閉

DTA セット

カセット呼出

キャンセル

単体発行

印字区分 食前

日数 3

包装順序 反復

追加 発行 戻る

欄番	薬品名	錠剤	パター				
051	ハファリン5mg	15	0	2	0	3	0
278	グラマリール	6	0	1	1	0	0

Canister

If the canister becomes empty during dispensing, the machine stops operation and moves the empty canister to the front. Fill the canister, return it to its original position, and tap [Refill]. Then dispensing automatically restarts.

1 The warning appears.

The canister empty warning is displayed on the touch panel and the audio guidance is played.

Tap [Mute] to stop the audio guidance.

(The detail information of the medicine of the empty canister is displayed.)



2 Fill the canister.

Tap [Refill] to fill the canister. For the details of the filling procedure, refer to from P.44 to P.51.

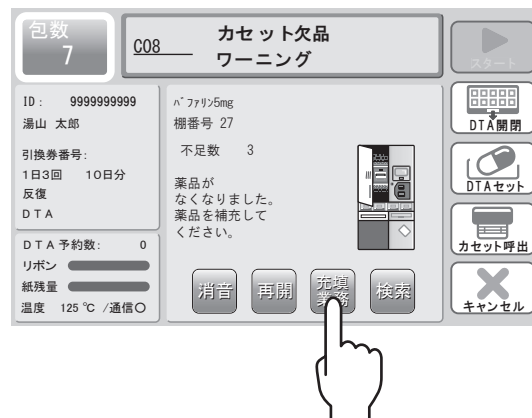

Group Canisters

If the canisters of one group become empty during dispensing, follow the procedure below.

1 The warning appears.

The canister empty warning is displayed on the touch panel and the audio guidance is played.

Tap [Mute] to stop the audio guidance.
(The detail information of the medicine of the empty canister is displayed.)

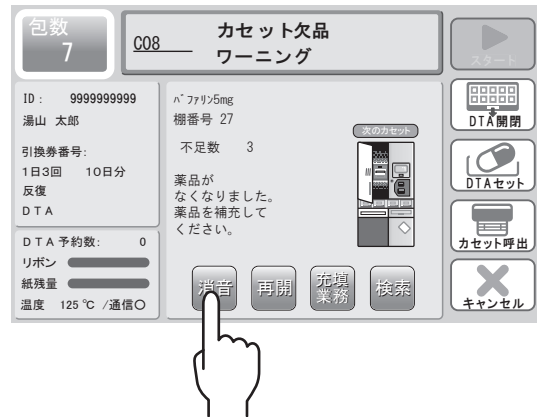

2 Display the next canister.

By tapping [Search], the cylinder starts rotating to move the next rack to the front side. Every time tapping [Next Canister] and [Search], the rack numbers with empty canisters attached are displayed in ascending order and the displayed rack is moved to the front side.

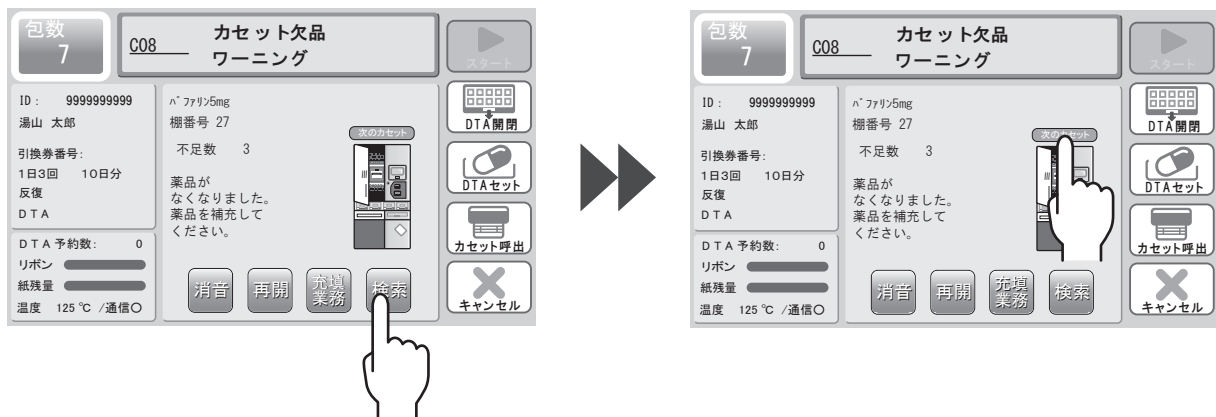

Note: By tapping [Next Canister] while the biggest rack number is displayed, the rack number is switched to the smallest one.

3 Fill the canister.

Tap [Refill] to fill the canister. For the details of the filling procedure, refer to from P.44 to P.51.

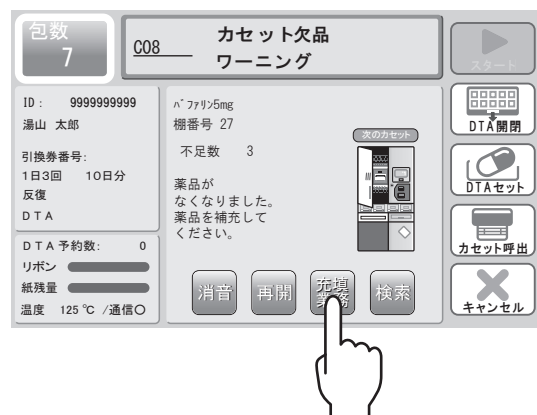

Canister for Half Tablets

If the canister for half tablets becomes empty during dispensing, follow the procedure below.

1 The warning appears.

The half tablet canister empty warning is displayed on the touch panel and the audio guidance is played.

Tap [Mute] to stop the audio guidance.

(The detail information of the medicine of the empty canister is displayed.)

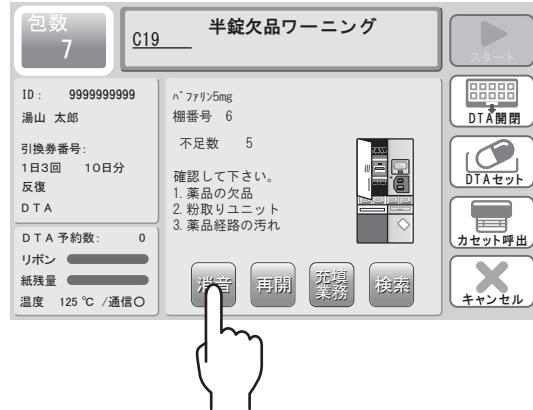

2 Fill the canister.

Tap [Refill] to fill the canister. For the details of the filling procedure, refer to from P.44 to P.51.

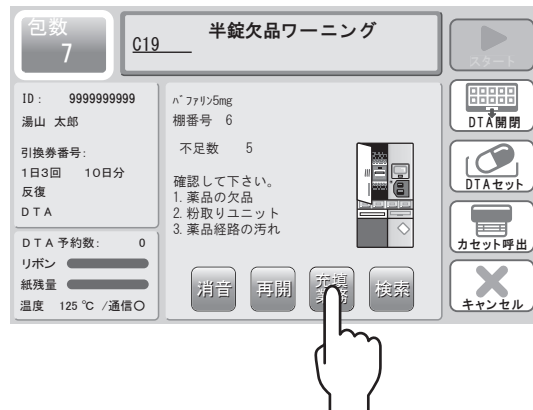

Clean the motor base of the canister for half tablets securely. Otherwise, a small amount of powder generated when dispensing half tablets may remain in the packaging machine.

⚠ CAUTION

Do not use the vacuum cleaner for cleaning the tablet drop hole of the motor base.

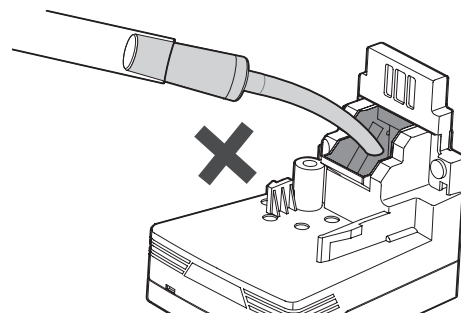

⚠ CAUTION

Note the following points when filling the canister.

- ・ Prevent contamination by foreign substances.
- ・ Prevent the canister from being overfilled.
- ・ Securely close the cover to prevent foreign substances from coming into the back side of the canister (place where tablets come out).

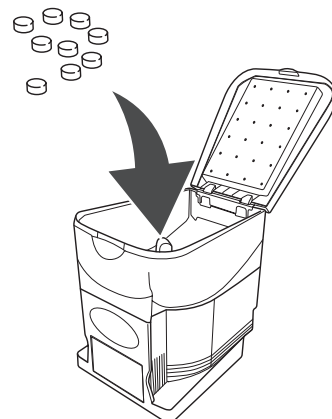

Filling of Canisters

Preliminary Filling

This function is for filling canisters in advance.

1 Read the barcode of the medicine box.

Read the barcode printed on the box of medicine to be filled.

The target canister is moved to the front side.

Note: This function is available only for medicines with JAN codes registered in the medicine master.

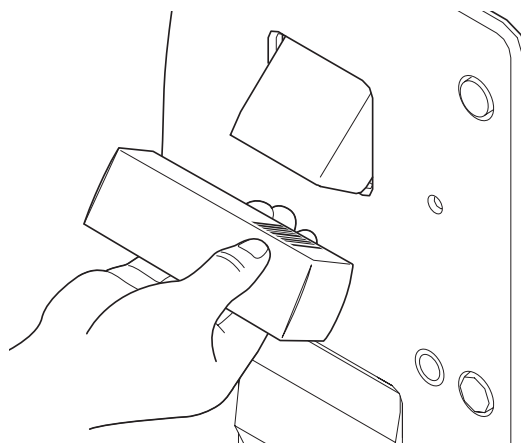

2 Tap [Canister Find].

The screen is switched to the canister find screen.



Tap [Refill].

The screen is switched to the medicine matching screen.

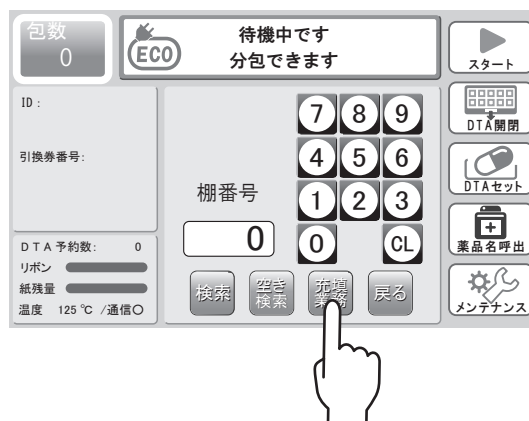

3 Select the operator.

By tapping [Operator], the list of the registered operators appears. Tap and select the operator.



4 Pull out the filling table.

Pull out the filling table.

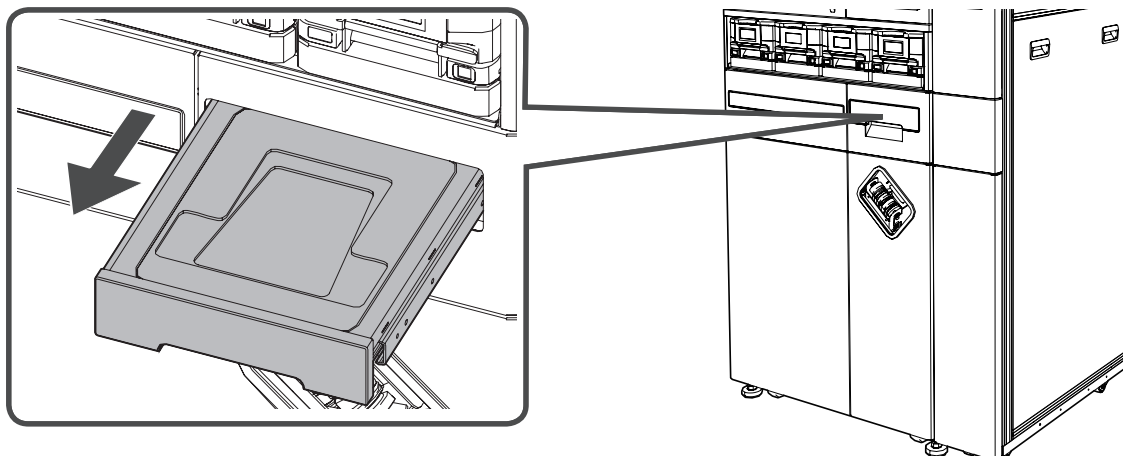

5 Remove the canister.

Open the upper door while holding its handle.

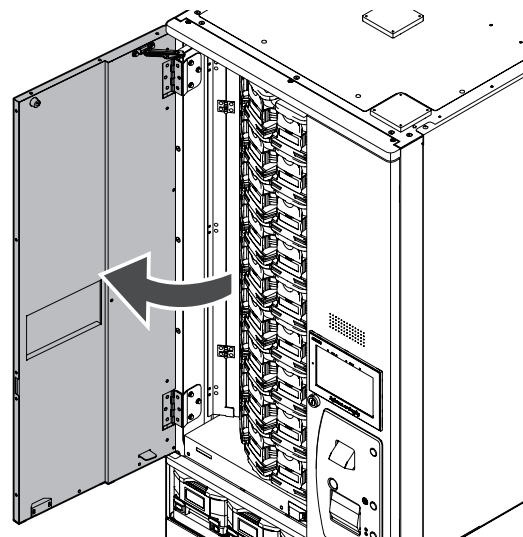

Press the lock of the canister until it clicks and then remove the canister while holding the lock.

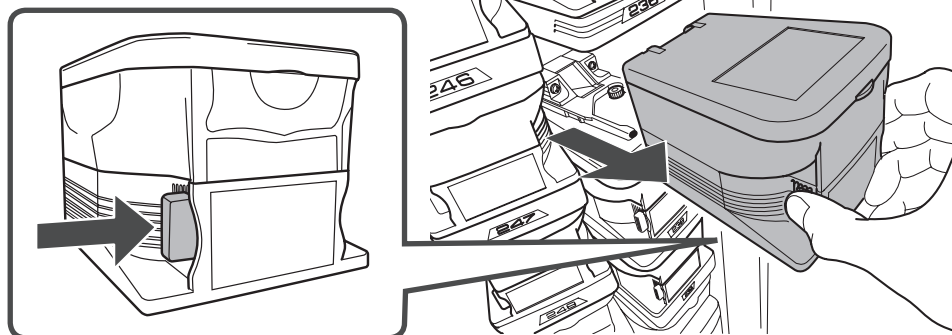

Place the canister so that it fits in the filling table. The beep sound indicates that the "RFID code" on the canister has been read.

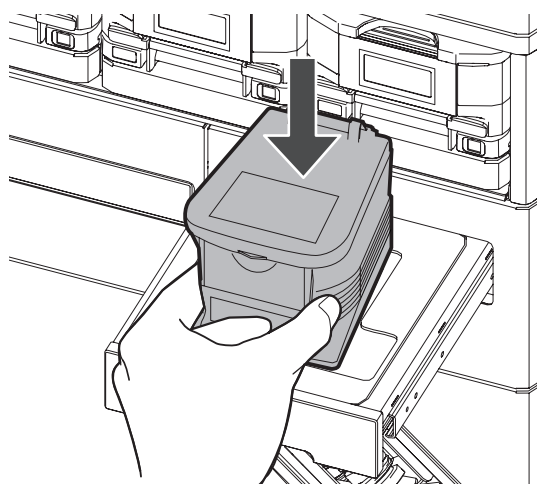

6 Read the barcode of the medicine box.

Read the barcode printed on the box of medicine to be filled.

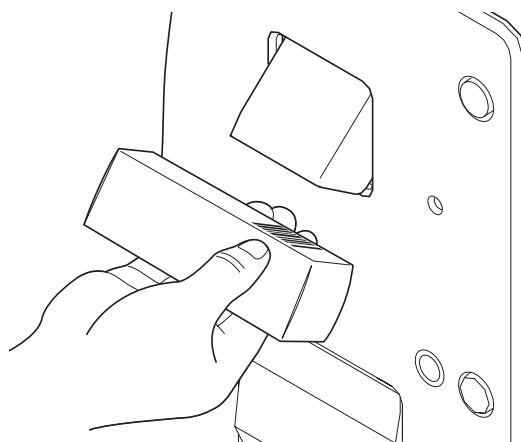

➔ Filling of Canisters (Continued)

If the medicine matches the one in the canister, [Verification OK] appears.
If not, check the medicine in the canister and the box of medicine to be filled.

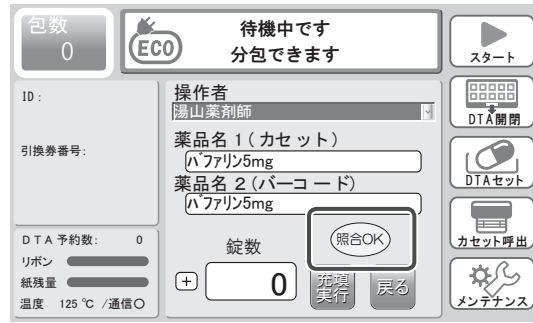

7 Enter the filling information. (Option)

From the medicine name retrieved from the barcode, you can enter its serial number and expiration date.
Retrieve the medicine name from the barcode and tap the displayed medicine name.

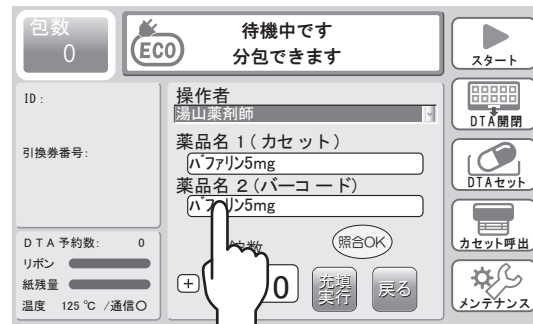

Tap the serial number field and enter numbers or letters by the numeric keypad.
(Up to 20 digits)

1	Repeats in the following order: 1-@-1.
2	Repeats in the following order: 2-A-B-C-2.
3	Repeats in the following order: 3-D-E-F-3.
4	Repeats in the following order: 4-G-H-I-4.
5	Repeats in the following order: 5-J-K-L-5.
6	Repeats in the following order: 6-M-N-O-6.
7	Repeats in the following order: 7-P-Q-R-S-7.
8	Repeats in the following order: 8-T-U-V-8.
9	Repeats in the following order: 9-W-X-Y-Z-9.
0	0
⇒	OK (Moves the cursor to the right.)
Clear	Back space



The serial number is displayed.
Then enter the expiration date (2 digits for year and 4 digits for month and day, or 2 digits for year and 2 digits for month).
Tap the expiration date field and enter numbers by the numeric keypad.
Enter both or either of the serial number and expiration date.



The expiration date is displayed. Then tap [OK].

The screen is switched back to the filling operation screen. "i" icon appears next to the medicine name (barcode).

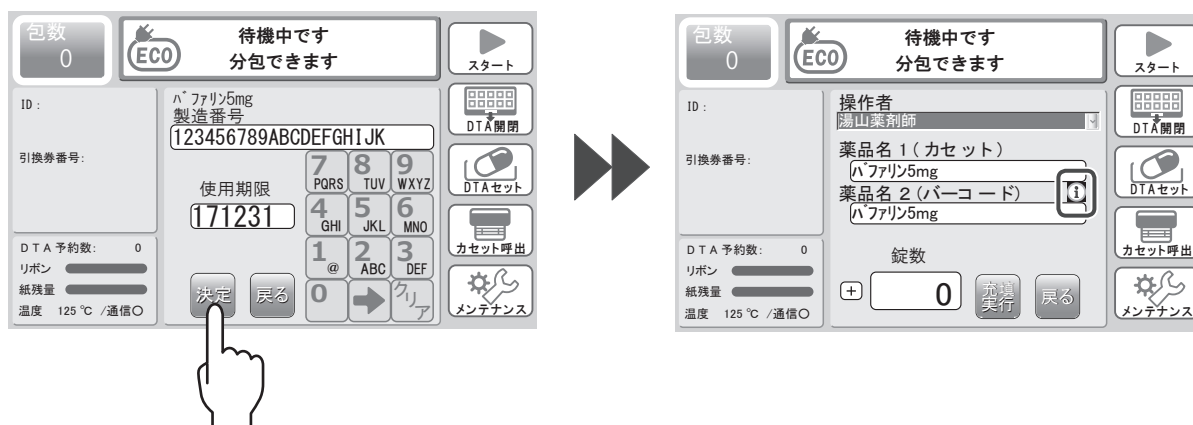

What is "i" Icon?

It appears when the serial number and expiration date are retrieved from the GS1 barcode or their information is entered in the filling information entry screen.

8 Clean the inside of the canister.

Insert the vacuum cleaner nozzle accessory into the air intake opening of a home vacuum cleaner.

Insert the nozzle all the way in so that it does not come off.

Note: If the medicine remains in the canister, be sure to take it out once before cleaning.

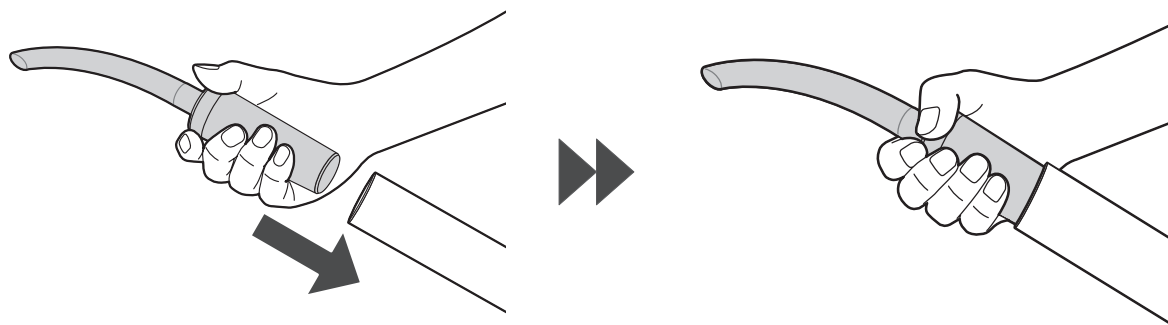

➔ Filling of Canisters (Continued)

Before filling the canister, remove the powder of medicine from the inside of the canister by vacuum cleaner. Clean not only the canister but also the dispensing route inside the machine.

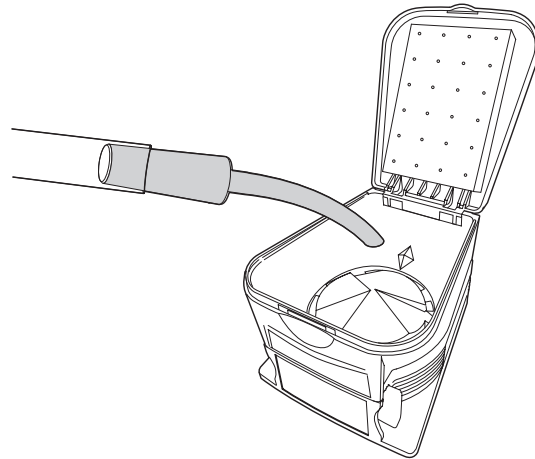

⚠ CAUTION

Do not insert the nozzle into the tablet drop hole of the canister motor base.

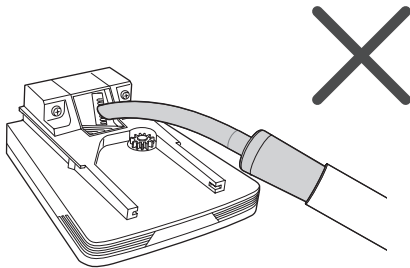

Regularly replace the desiccant inside of the canister. If the desiccant absorbs moisture, it changes from blue to pink. Thus replace it when it turns to pink. Overfilling of the canister causes the rotor inside the canister to be pushed and may result in a malfunction. Leave a space of 12mm or more inside the canister when filling it with medicine.

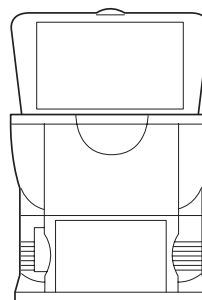
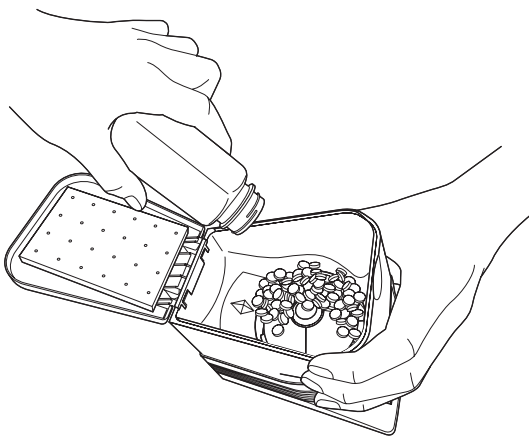

Be sure to leave a space of 12mm or more.
Do not fill this space with medicine.

⚠ CAUTION

Note the following points when filling the canister.

- Prevent contamination by foreign substances.
- Prevent the canister from being overfilled.
- Securely close the cover to prevent foreign substances from coming into the back side of the canister (place where tablets come out).

9 Attach the canister.

Attach the canister to the motor base.

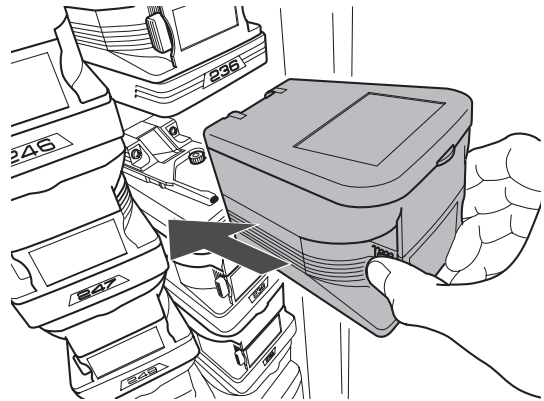

When attaching the canister, push it all the way in so that its edge is aligned to the motor base. When the canister is identified, the motor base LED light blinks in orange.

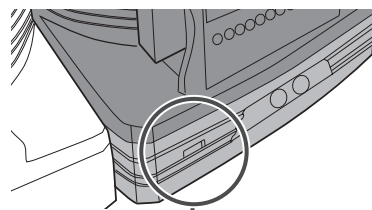
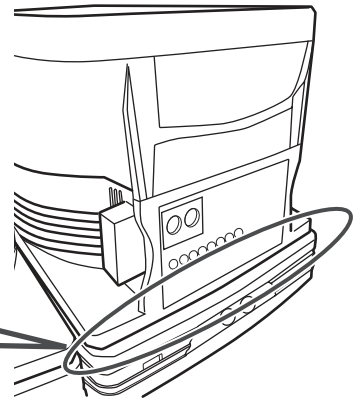
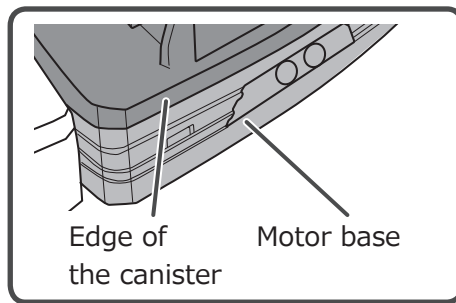

LED light

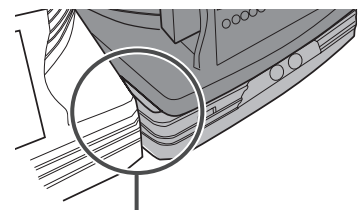

The edge of the canister is not aligned to the one of the motor base.

10 Perform the filling operation.

Tap the frame of the number of tablets and the numeric keypad screen appears.

Note: By tapping the icon next to the number of tablets, it switches alternatively between [+] and [-].

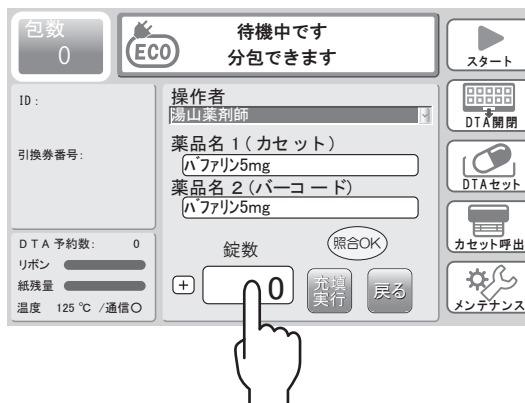

After entering the number of tablets, tap [ENT]. The entered number appears in the field of the number of tablets.

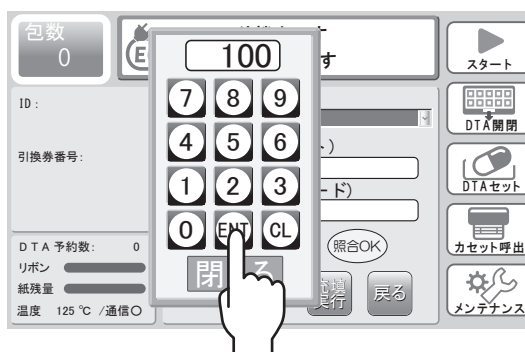

Tap [Fill].

Note: By changing the icon to [-], the amount of the inventory can be reduced.

