



# ***LC4*** **MUSIC LAB**

## **Wi-Fi Kit Installation Guide**

**Contents**

What's Included .....1

Setup Instructions .....2

Notes .....3

Troubleshooting Guide .....4

**What's Included**

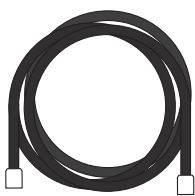

Ethernet cable



Stereo 1/8" to  
RCA Y-cable

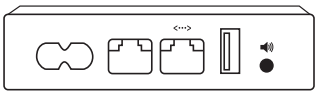

Pre-configured Apple  
Airport Express



Wireless stereo  
headphones

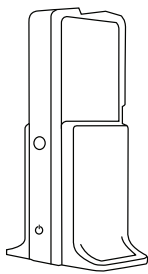

Wireless headset  
transmitter

## Setup Instructions

1. Download the LC4 Controller apps for iPad® from the App Store. If you're reading this PDF on your iPad just click this [link](#).
2. Connect the Airport Express to the LC4 hub's Ethernet port with the supplied Ethernet cable. It should go from the Ethernet LAN port of the Airport Express (<...>).
3. Using the 1/8" to RCA Y-cable, connect the analog audio output of the Airport Express (1/8" jack) to the LC4 hub using either the Aux 1 or Aux 2 RCA jacks.

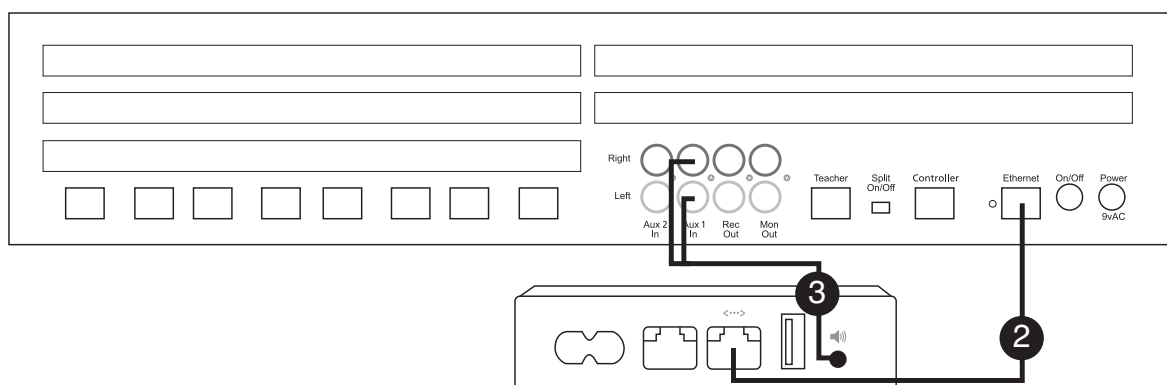

4. Connect the 1/8" to 1/8" cable, that comes packaged with the wireless headphones, from the teacher's instrument box Student 2 Phones to the Audio Input jack on the wireless headset transmitter. The LC4 headset/mic that comes with the lab for the teacher should stay connected to the Student 1 Phone and Mic jacks. For instructions on the operation of your wireless headphones, please refer to the owner's manual included in their packaging.

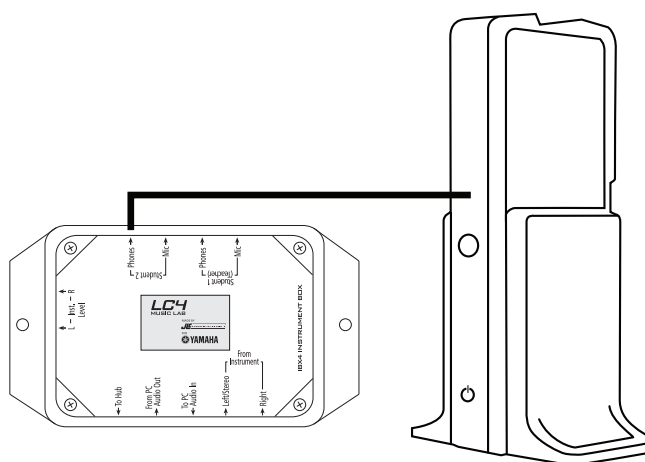

Your wireless headset transmitter may look different.

5. Connect the iPad Wi-Fi to the Airport Express network named “LC4LAB.” This network is private (not publically visible) so not just anyone will be able to find and join it. To do this, click on the Settings icon on your iPad. Next, select Wi-Fi from the Settings menu. Select “Other.” Enter the network name “LC4LAB” (case sensitive) and choose security type WPA2 Personal. When prompted, enter the case-sensitive password: YamahaLC4.

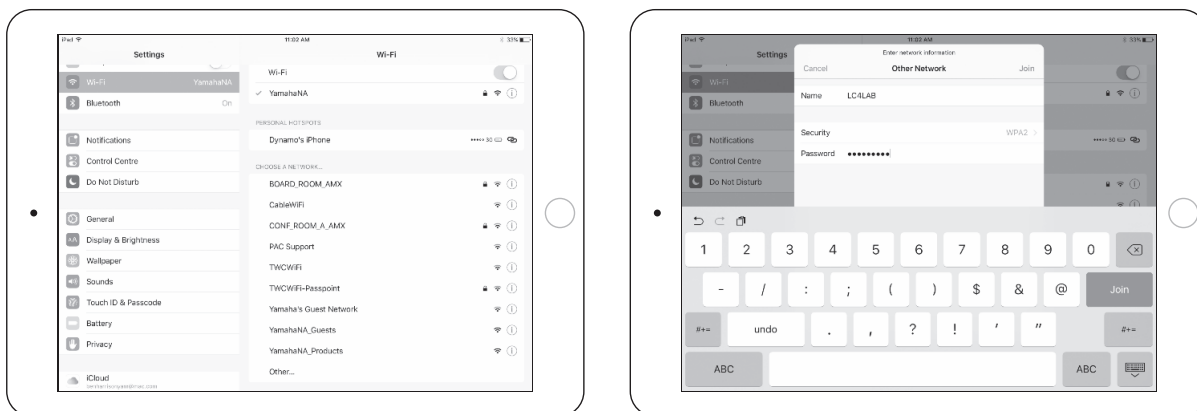

Once connected, open the LC4 Controller app and enjoy wireless operation of your music lab!

## Notes

- It is recommended that you close any other apps running on your iPad when using the LC4 Controller app.
- When connected to the “LC4LAB” network, you will not have an internet connection unless the Airport Express is connected to the Internet already (see Airport Express owner’s manual for more information).

## Troubleshooting Guide

Symptom	Solution
My LC4 is not detected by the app.	Ensure that Airport Express is connected properly to the LC4 Hub via the Ethernet port.
	Ensure that the iPad is connected to the wireless network called "LC4LAB."
LC4 Controller app connects without an error but isn't working properly.	Close the app, restart the LC4 lab system (power off and back on from the hub) and then restart the app.
"LC4LAB" network does not show in available networks on iPad Wi-Fi setting.	This is normal. The network is hidden and will not appear on this list. Choose "Other" from the networks list, enter "LC4LAB" for the network name, select WPA2 as the security type and enter "YamahaLC4" (case sensitive) for the password.
I can't connect to the "LC4LAB" network.	Verify that the correct security setting is selected (WPA2) and that the password is entered correctly ("YamahaLC4").
	Contact Yamaha customer support at 800-854-1569.
I can't hear anything in the wireless headphones.	Ensure that the input on the headphone transmitter/base station is connected to the Phone output 2 of the teacher's instrument box using the supplied 1/8" to 1/8" cable.
	Refer to the user manual for the wireless headphones to verify setup and operation procedures.