

AWCARD製品概要 / AWCARD Product Overview

2009/6/26
ヤマハ株式会社 九頭龍
YAMAHA Corp. Y. Kuzuryu

用途 / Purpose

AWCARDは2.4GHz帯を用いた無線通信用の基板モジュールであり、オーディオ機器に組み込むことで以下の用途に用いる
PCB AWCARD is a wireless module by using 2.4GHz (ISM Band)
This unit is assembled into some audio equipment and used for below function.

- 無線通信によってオーディオ信号を送受信する
Transmit and Receive Audio Data by wireless communication
- 無線通信によってオーディオ機器のコントロールを行う
Control audio equipments by wireless communication

特徴 / Unique Points

- 低遅延オーディオ転送 / Low Latency
- 非圧縮オーディオ転送 / Linear PCM
- 到達距離(妨害の無い時) 約20m / Transmit Range(no disturbance) about 20m

無線仕様 / RF Specification

・使用帯域 / Band Frequency
2400 ~ 2483.5MHz

・チャンネル数 / CH Number
8ch

ch1 :	2405.376 MHz
ch2 :	2415.616 MHz
ch3 :	2425.856 MHz
ch4 :	2436.096 MHz
ch5 :	2446.336 MHz
ch6 :	2456.576 MHz
ch7 :	2466.816 MHz
ch8 :	2473.984 MHz

・変調方式 / Moduration
GFSK

・データレート / Bit Rate
6.2Mbps

・符号化方式
リードソロモン / Reed Solomon

組み合わせ機器の例 / Example of use

((CASE 1))

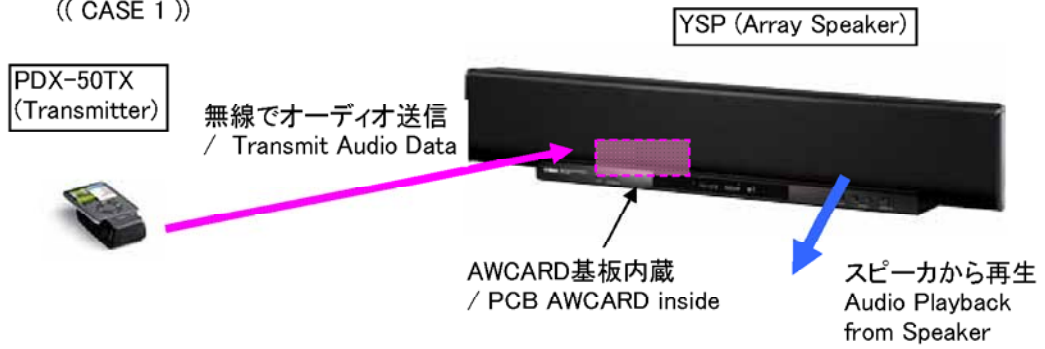

YSP-4000

<http://www.yamaha.co.jp/english/product/av/products/dsp/ysp4000.html>

PDX-50

<http://www.yamaha.co.jp/english/product/av/products/ht/pdx50.html>

((CASE 2))

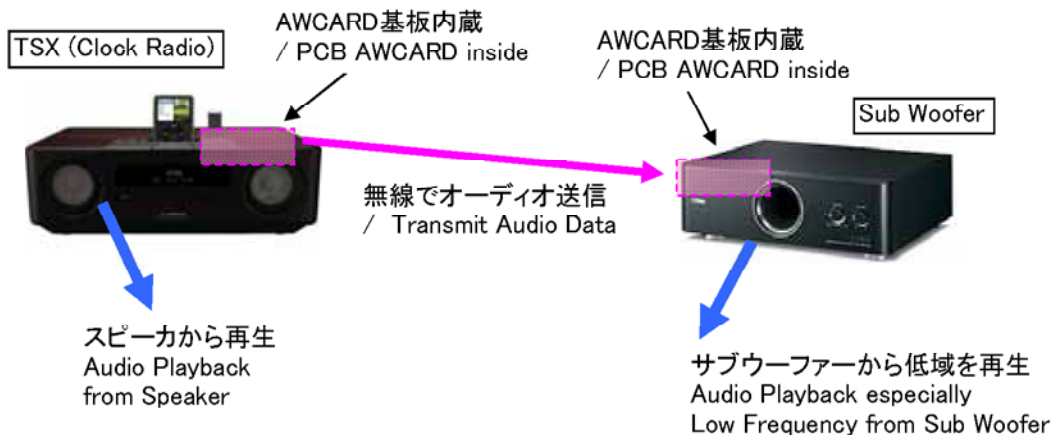

TSX-130

<http://www.yamaha.co.jp/english/product/av/products/ht/tsx130.html>

CASE1の場合の使用方法について / How to use about CASE1

YSPでiPodの音楽を聴く / Playback iPod Music source from YSP

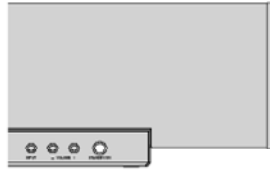

Step1.
YSPの電源を入れる
Turn on YSP unit

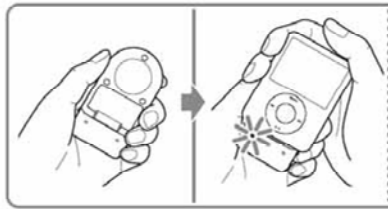

Step2.
iPodをPDX-50TXに接続する
Connect iPod and PDX-50TX



Step3.
iPodを再生するとYSPから音が聞こえる
Playback iPod then sound comes from YSP

iPodの操作でYSPのボリュームを変更する / Change YSP volume from iPod

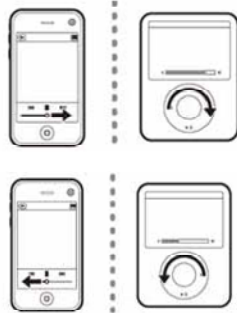

iPodのVolumeを変更する
Change iPod Volume



YSPのVolumeがそれに合わせて変わる
YSP volume is synchronized
with iPod volume

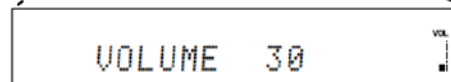

FCC INFORMATION (for US customers)

1 IMPORTANT NOTICE : DO NOT MODIFY THIS UNIT!

This product, when installed as indicated in the instructions contained in this manual, meets FCC requirements.

Modifications not expressly approved by Yamaha may void your authority, granted by the FCC, to use the product.

2 IMPORTANT : When connecting this product to accessories and/or another product use only high quality shielded cables. Cable/s supplied with this product **MUST** be used. Follow all installation instructions. Failure to follow instructions could void your FCC authorization to use this product in the USA.

3 NOTE : This product has been tested and found to comply with the requirements listed in FCC Regulations, Part 15 for Class "B" digital devices. Compliance with these requirements provides a reasonable level of assurance that your use of this product in a residential environment will not result in harmful interference with other electronic devices.

This equipment generates/uses radio frequencies and, if not installed and used according to the instructions found in the users manual, may cause interference harmful to the operation of other electronic devices.

Compliance with FCC regulations does not guarantee that interference will not occur in all installations. If this product is found to be the source of interference, which can be determined by turning the unit "OFF" and "ON", please try to eliminate the problem by using one of the following measures: Relocate either this product or the device that is being affected by the interference.

Utilize power outlets that are on different branch (circuit breaker or fuse) circuits or install AC line filter/s.

In the case of radio or TV interference, relocate/reorient the antenna. If the antenna lead-in is 300 ohm ribbon lead, change the lead-in to coaxial type cable.

If these corrective measures do not produce satisfactory results, please contact the local retailer authorized to distribute this type of product. If you can not locate the appropriate retailer, please contact Yamaha Electronics Corp., U.S.A. 6660 Orangethorpe Ave, Buena Park, CA 90620. The above statements apply **ONLY** to those products distributed by Yamaha Corporation of America or its subsidiaries.

FCC WARNING

Change or modifications not expressly approved by the party responsible for compliance could void the user's authority to operate the equipment.

This equipment complies with FCC/IC radiation exposure limits set forth for uncontrolled equipment and meets the FCC radio frequency (RF) Exposure Guidelines in Supplement C to OET65 and RSS-102 of the IC radio frequency (RF) Exposure rules. This equipment has very low levels of RF energy that it deemed to comply without maximum permissive exposure evaluation (MPE). But it is desirable that it should be installed and operated with at least 20 cm and more between the radiator and person's body (excluding extremities: hands, wrists, feet and ankles).

This device complies with Part 15 of the FCC Rules.

Operation is subject to the following two conditions:

- 1) this device may not cause harmful interference, and
- 2) this device must accept any interference received including interference that may cause undesired operation.

See user manual instructions if interference to radio reception is suspected.

NOTICE

This equipment has been tested and found to comply with the limits for a Class B digital device, pursuant to part 15 of the FCC Rules. These limits are designed to provide reasonable protection against harmful interference in a residential installation.

This equipment generates, uses and can radiate radio frequency energy and, if not installed and used in accordance with the instructions, may cause harmful interference to radio communications. However, there is no guarantee that interference will not occur in a particular installation. If this equipment does cause harmful interference to radio or television reception, which can be determined by turning the equipment off and on, the user is encouraged to try to correct the interference by one or more of the following measures:

- Reorient or relocate the receiving antenna
- Increase the separation between the equipment and receiver.
- Connect the equipment into an outlet on a circuit different from that to which the receiver is connected.
- Consult the dealer or an experienced radio/TV technician for help.

This transmitter must not be co-located or operated in conjunction with any other antenna or transmitter.

FOR CANADIAN CUSTOMERS

This Class B digital apparatus complies with Canadian ICES-003.

Cet appareil numérique de la classe B est conforme à la norme NMB-003 du Canada.