

# ELECTRIC GUITAR RGX 420S

## SERVICE MANUAL



This document is printed on chlorine free (ECF) paper with soy ink.

### ■ CONTENTS

OVERALL ASSEMBLY	.....	2
SPECIFICATIONS	.....	4
WIRING	.....	5
CIRCUIT DIAGRAM	.....	5



# OVERALL ASSEMBLY

## E25 Bridge Assembly: YF-01B (Black)

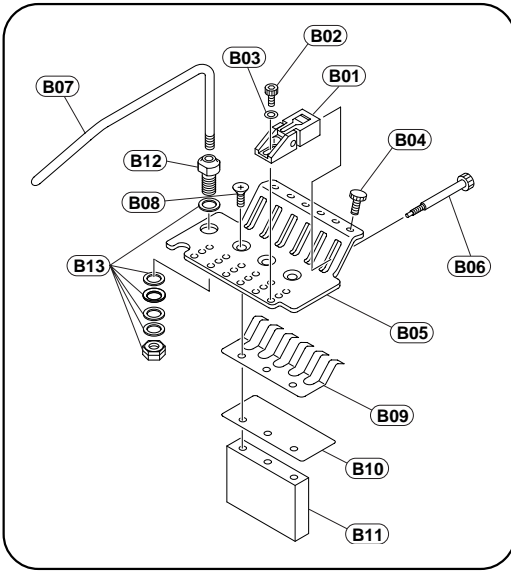

## • Jack Installation

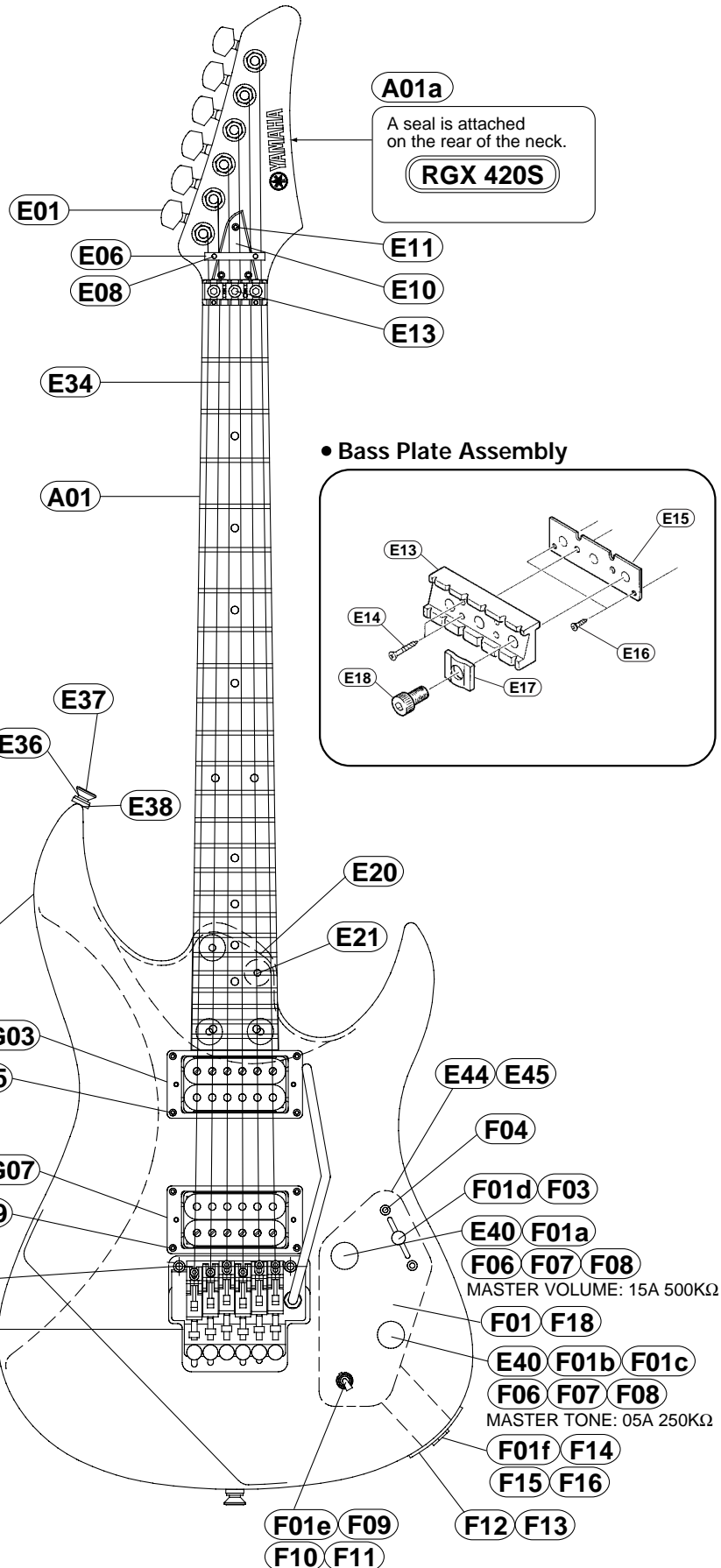
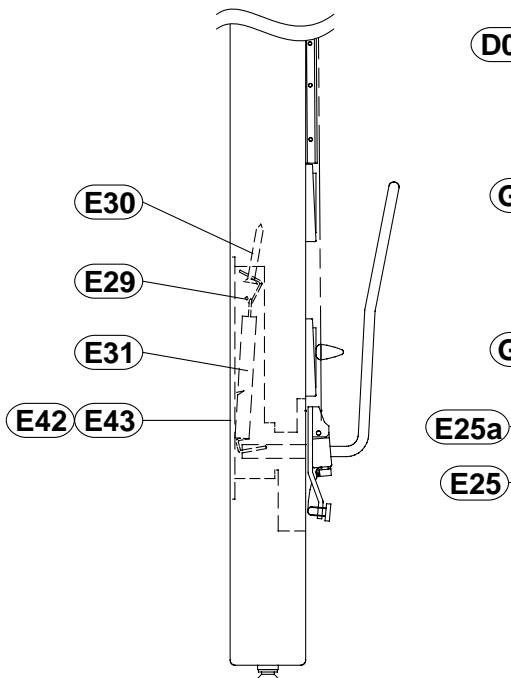
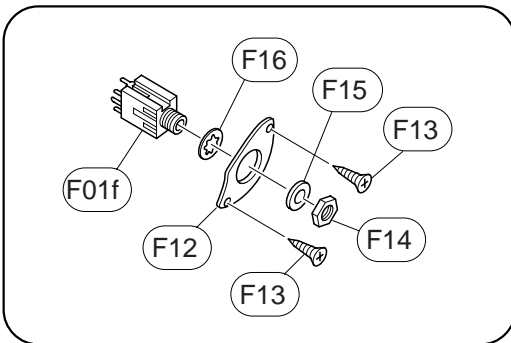

REF NO.	PART NO.	DESCRIPTION		REMARKS	QTY	RANK
* A01	AAX19320	OVERALL ASSEMBLY		RGX 420S		
* A01	AAX19330	Neck Assembly		SBL		
* A01	AAX19340	Neck Assembly		MGR		
A01a	--	Seal		GRS		
				(QC59360)		
D01	--	Body				
E01	QC296300	Tuning Machine Assembly	RM1273 DC (Black)	1set		12
E06	VB565400	String Guide	Black			04
E08	03704270	Round Head Wood Screw	2.7X13 (Black)		2	01
E10	VK739700	Rod Cover	Black			04
E11	03706220	Oval Head Wood Screw	2.1X10 (Black)		3	01
E13	QC054100	Bass Plate Assembly	43mm M4 (Black)			11
E14	VD763200	Oval Head Wood Screw	2.4X13 (Black)		4	03
E15	VD979000	Spacer	Black			04
E16	VE714900	Flat Head Tapping Screw	2.0X6 (Black)		2	05
E17	QC053500	Square Washer	M4 (Black)		3	04
E18	QC058300	Cap Screw	M4.0X8 (Black)		3	02
E20	QC205200	Neck Joint Bushing	Black		2	04
E21	VD762900	Oval Head Tapping Screw	4.0X40 (Black)		4	01
* E25	QC593700	Bridge Assembly	YF-01B (Black)			
* E25a	AAX19820	Bridge Column			2	
E29	AA815250	Arm Spring Plate	Nickel plate			04
E30	EN240060	Oval Head Tapping Screw	4.0X45 (Black)		2	01
E31	QC086700	Arm Spring			3	03
E34	--	Strings	XL-120	1set (QC16510)		
E36	VB563800	End Pin	BLACK		2	01
E37	EN230140	Oval Head Tapping Screw	3.0X25 (Black)		2	04
E38	VB793700	Spacer	BLACK		2	01
E40	VK739800	Knob Assembly	BLACK		2	05
E42	QC184300	Back Cover	Bridge (Black)			06
E43	EB620020	Oval Head Wood Screw	2.7X13 (Black)		6	03
* E44	QC593900	Back Cover	Control (Black)			
E45	EB620020	Oval Head Wood Screw	2.7X13 (Black)		5	03
F01	--	Electrical Unit		1set (QC59400)		
F01a	HS120070	Variable Resistor	15A 500K ohm	VOLUME		03
F01b	HS120100	Variable Resistor	05A 250K ohm	TONE		03
F01c	UA114220	Mylar Cap.	0.022uF			01
F01d	QA296100	Pickup Switch	4pole 5-P			12
* F01e	QC596000	Direct Switch	AS-500M-F (Black)			
F01f	LB201120	Jack				03
F03	CB821810	Knob	Black			02
F04	03755170	Oval Head Screw	3.0X8 (Black)		2	01
F06	--	Hexagonal Nut			2	
F07	--	Flat Washer			2	
F08	--	Toothed Lock Washer			2	
F09	--	Hexagonal Nut			2	
F10	--	Flat Washer				
F11	--	Toothed Lock Washer				
F12	VB518300	Jack Panel	Black			05
F13	EB620020	Oval Head Wood Screw	2.7X13 (Black)		2	03
F14	AA820860	Hexagonal Nut	Black			01
F15	AA820850	Flat Washer	Black			01
F16	ET800180	Toothed Lock Washer	9-S (A)		3	01
F18	EA620060	Round Head Wood Screw	2.7X13 (Chrome)		2	03
* G03	QC593800	Pickup Assembly	H/B	FRONT		
G05	20454100	Oval Head Tapping Screw	2.4X16 (Black)		4	01
* G07	QC594500	Pickup Assembly	H/B	REAR		
G09	20454100	Oval Head Tapping Screw	2.4X16 (Black)		4	01
H01	QC354200	Accessory Unit	G-3	1set		07
	QA262600	Cord	D	(AA82101)		05
	--	Hexagonal Wrench	#4			
	--	Hexagonal Wrench	#3			
	--	Hexagonal Wrench	#2.5			
	--	Hexagonal Wrench	#2			
	--	Hexagonal Wrench	#1.5			

\*: New Parts

RANK: Japan only

REF NO.	PART NO.	DESCRIPTION		REMARKS	QTY	RANK
*	QC593700	Bridge Assembly	YF-01B (Black)			
* B01	AAx19350	Bridge Piece Assembly	Black		6	
* B02	AAx19360	Cap Screw	Black		6	
* B03	AAx19370	Flat Washer	Black		6	
* B04	AAx19380	Fine Tuning Screw	Black		6	
* B05	AAx19390	Bridge Base	Black			
* B06	AAx19400	String Stopper	Black		6	
* B07	AAx19410	Arm	Black			
* B08	AAx19420	Flat Head Screw	Black		3	
* B09	AAx19430	Bridge Plate 1	Chrome			
* B10	AAx19440	Bridge Plate 2	Chrome			
* B11	AAx19450	Bridge Tail	Brass			
* B12	AAx19460	Adjusting Ring	Black			
* B13	AAx19470	Bushing Set				

\*: New Parts

RANK: Japan only

## SPECIFICATIONS

### STANDARD SPECIFICATIONS

Scale Length ..... 648mm  
 Body-Neck Construction ..... Bolt On  
 Length ..... 982mm  
 Width ..... 315.8mm  
 Net Weight ..... 3.3kg

### COLOR

Body  
 SBL ..... Satin Black  
 MGR ..... Mist Green  
 GRS ..... Gray Satin  
 Neck  
 SBL ..... Satin Black  
 MGR ..... Mist Green  
 GRS ..... Gray Satin

### BODY

Material ..... Alder  
 Body Depth ..... 44mm

### FINGERBOARD

Material ..... Rose  
 Fingerboard Width ..... 0-F 43 mm, 12-F 52.5 mm  
 No. of Frets ..... 24

### NECK

Material ..... Maple  
 Neck Thickness ..... 1-F 19.0 mm, 12-F 21.7 mm

### PARTS

Hardware ..... Black  
 Bridge ..... YF-01B  
 Strings ..... Super Light: XL-120

### CONTROLS

Volume ..... 15A 500KΩ x 1  
 Tone ..... 05A 250KΩ x 1  
 Pickup Switch ..... 4pole 5P Lever Switch  
 Direct Switch ..... 3pole 2P Mini Toggle Switch

### PICKUPS

Front/Rear ..... Open Humbucking  
 Magnet  
 Front/Rear ..... Ceramic

### WARNING : CHEMICAL CONTENT NOTICE!

The solder used in the production of this product contains LEAD. In addition, other electrical/electronic and/or plastic (Where applicable) components may also contain traces of chemicals found by the California Health and Welfare Agency (and possibly other entities) to cause cancer and/or birth defects or other reproductive harm.

DO NOT PLACE SOLDER, ELECTRICAL/ELECTRONIC OR PLASTIC COMPONENTS IN YOUR MOUTH FOR ANY REASON WHAT SO EVER!

Avoid prolonged, unprotected contact between solder and your skin! When soldering, do not inhale solder fumes or expose eyes to solder/flux vapor!

If you come in contact with solder or components located inside the enclosure of this product, wash your hands before handling food.

# CIRCUIT DIAGRAM

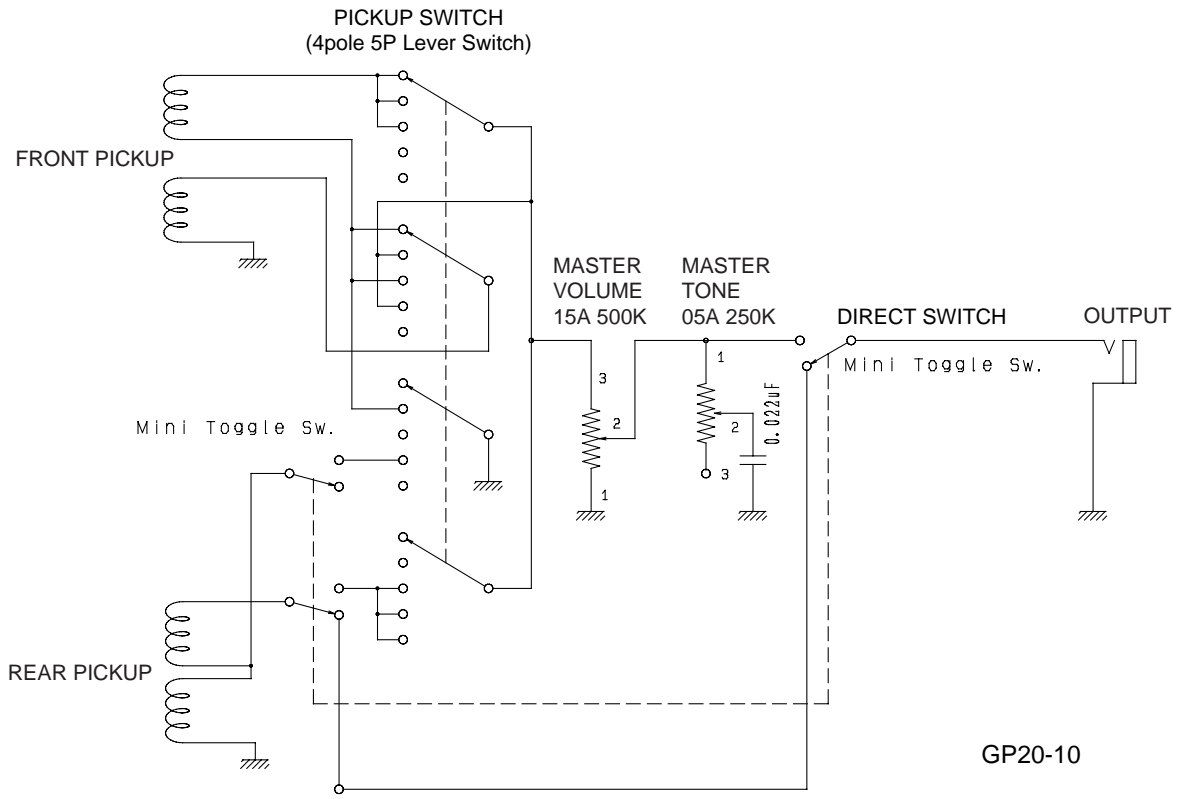

# WIRING

