

D201 Kami Doorbell Camera User Manual



kami
Doorbell Camera

Website: www.kamihome.com
E-mail: support@kamihome.com
<https://kamihome.com/legal/fcc>

D201 V2.2

Installation Guide

2020/08/07 新建
2020/08/11 1. 二级管安装图示修改 2. 认证编号更新 3. 安装定位线图示更新
4. 背板上墙图示更新 5. 尺寸更新 6. 安装顺序调整 7. 安全提示
8. 文字更新 9. 版本更新。
2020/08/12 1. 文字更新 2. 版本更新
2020/08/13 1. 11页加一段话 2. 版本更新
2020/08/14 1. 电话改回 2. 版本升级
2020/09/03 1. 语音播报更新 2. 版本升级
2020/09/16 1. 第9页文字翻译调整 2. 版本升级 (V1.8)
2021/01/22 1. 翻译大调整 2. 增加两个配件图示及说明 3. 第8页图示更新
4. 14-16页线条调整 5. 去掉FCC ID 6. 版本升级
2021/03/04 1. 封底去掉认证信息 2. FCC ID更新 3. 版本更新
2021/04/07 1. 更新FCC ID 2. 增加IC认证编号及声明 3. 版本更新

印刷颜色 ▶ PANTONE 541 U
PANTONE Cool Gray 11 C+K
成品尺寸 ▶ 165 × 165mm

物料材质 ▶ 68g晨鸣云镜双胶
特种工艺 ▶ 骑马钉装订 (两钉)

图号 ▶ D20
料号 ▶ 609

1. What's in the Box

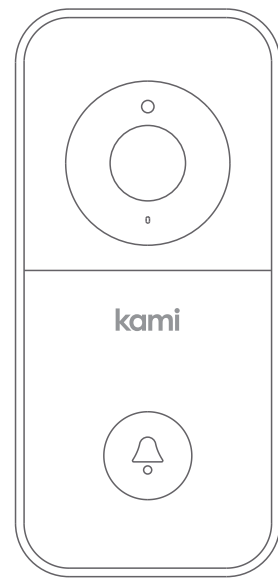

Kami Doorbell Camera x 1



Wire Nuts x 2

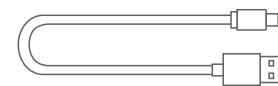

Charging Cable x 1



Battery x 1

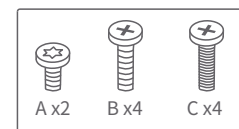

Screw Bag x 1

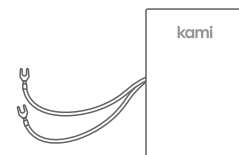

Chime Connector x 1

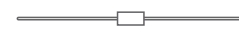

Diode x 1

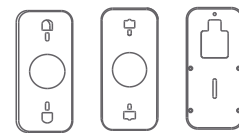

Backplate x 3

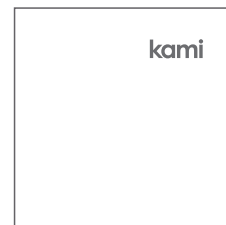

Manual x 1

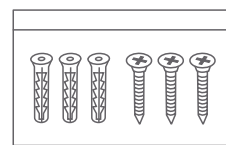

Installation Hardware x 1

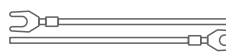

Extension Wires x 2

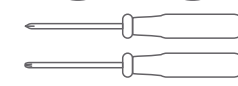

Screwdriver x 2

1

2. Getting to Know Your Doorbell Camera

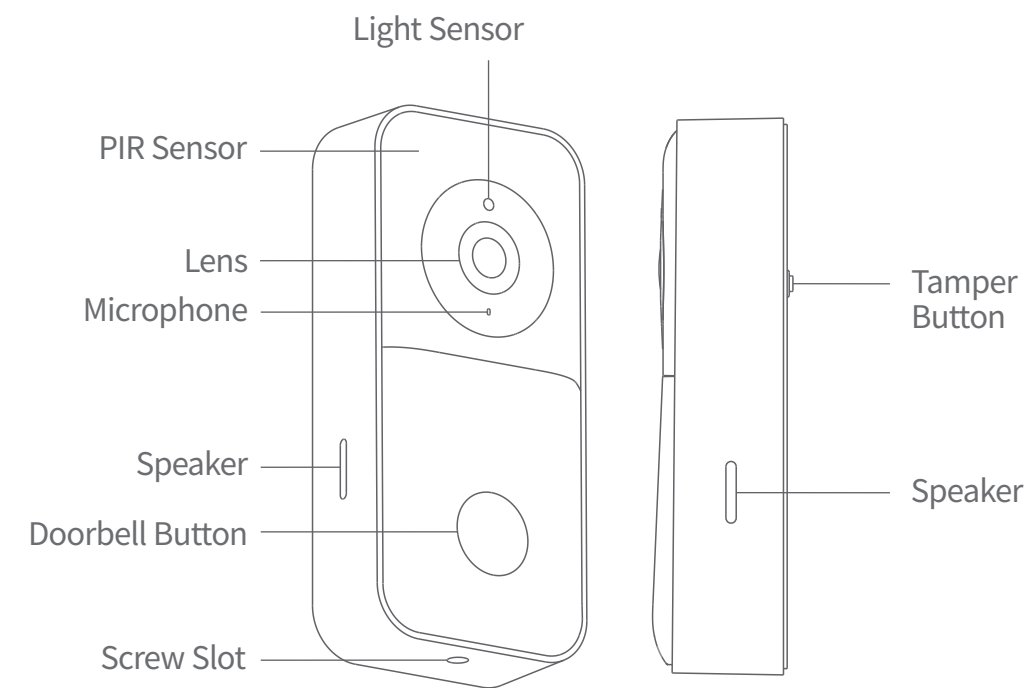

2

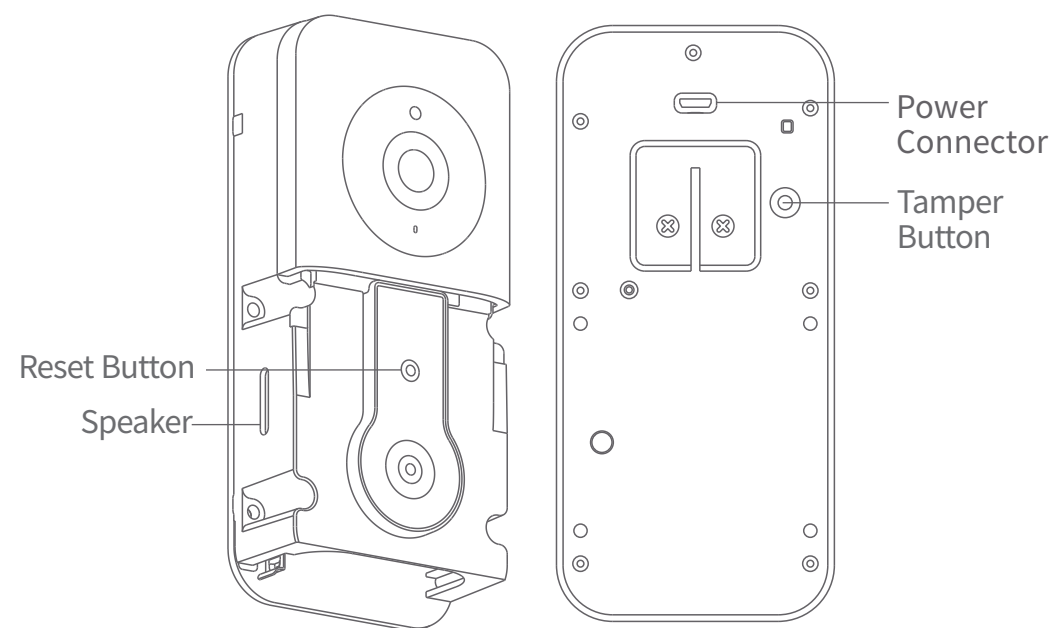

To reset the doorbell fast press the Reset Button (less than 1 second).

3

3. Charge + Insert battery

a. Charge the Battery

Please charge the battery, using a micro USB cable and a power adapter (not included). The indicator light will be red while charging and turn white when fully charged.

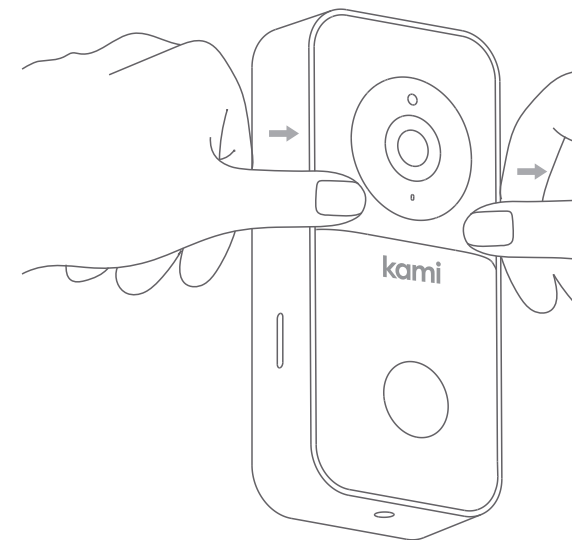
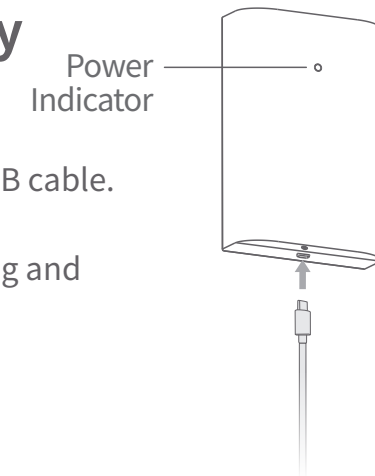

b. Remove the Protective Cover

Press down on the face of the doorbell with your thumbs and pull the outer protective cover up and away from the main body, as shown in the diagram on the left.

4

c. Installing the Battery

After removing the protective cover, push the battery into the battery compartment as shown. (Ensure that the battery is inserted in the correct direction with pins facing up)

Push the tab shown in the diagram below to free the battery. Pull the battery straight down to remove.

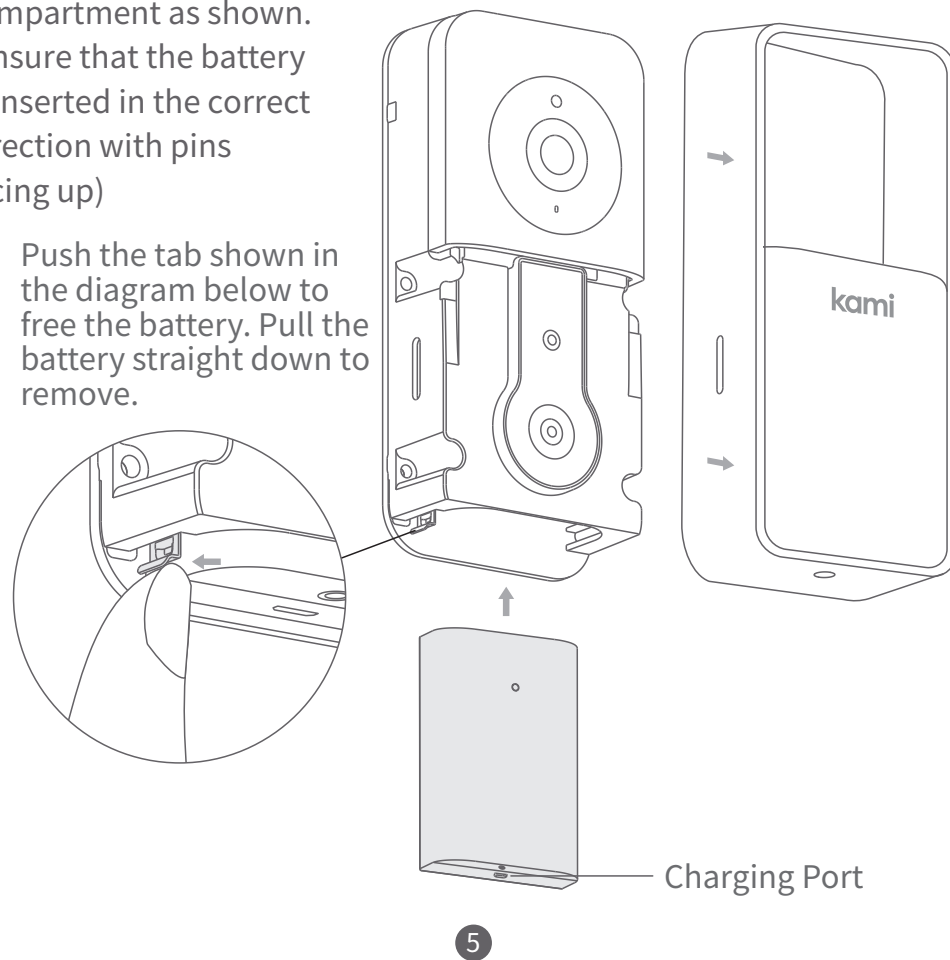

4. Pairing Your Doorbell Camera

Step 1

Download the Kami Home / YI Home App and sign up or sign in to your existing account.

Step 2

Ensure that your cell phone is connected to your local Wi-Fi network. Enable the "Location" function on your phone, and then authorize the "Location" function of the Kami Home / YI Home App.

Step 3

After logging in to your Kami Home / YI Home App, tap the "+" symbol in the top right corner and select "Kami Doorbell Camera". Wait for the voice prompt and then tap the "I heard 'Waiting to connect'" button.

Step 4

Enter your Wi-Fi network password and tap the "Please choose Wi-Fi" button.

A QR code will appear on your phone's screen.

Point the QR code towards the camera lens until you hear the following voice prompts "QR code scan is successful connecting to Wi-Fi" and "Wi-Fi is connected".

6

Step 5

Tap the "Next" button and wait until you hear the message "Pairing is successful" both from the camera and from the app. Assign your desired name to the Doorbell and tap "Save". You will hear "You may start using your camera now".

5. Installation Options

a. Remove the Original Doorbell (optional)

If you are replacing an existing doorbell, please switch the power off, remove the doorbell, and disconnect the wires.

b. Electronic Doorbell Setup: Installing a Diode (optional)

- If you want to connect your doorbell to an electronic bell (if your doorbell has a speaker, it uses a digital chime), you will need to install a diode.
- If you are using a mechanical indoor doorbell, DO NOT install a diode, as this will damage the existing doorbell.

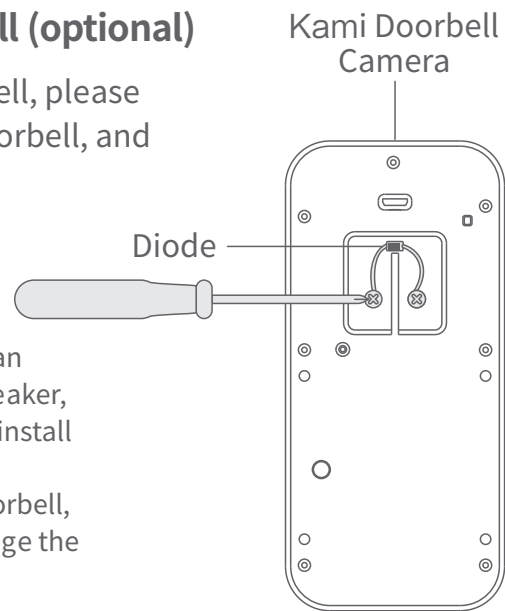

7

c. Mechanical Doorbell Setup: Installing the chime connector (optional)

If you are using a mechanical chime, please install the chime connector ① to ensure a stable power supply.

If you don't want chime to make a sound, please connect the wires as shown in the picture ②.

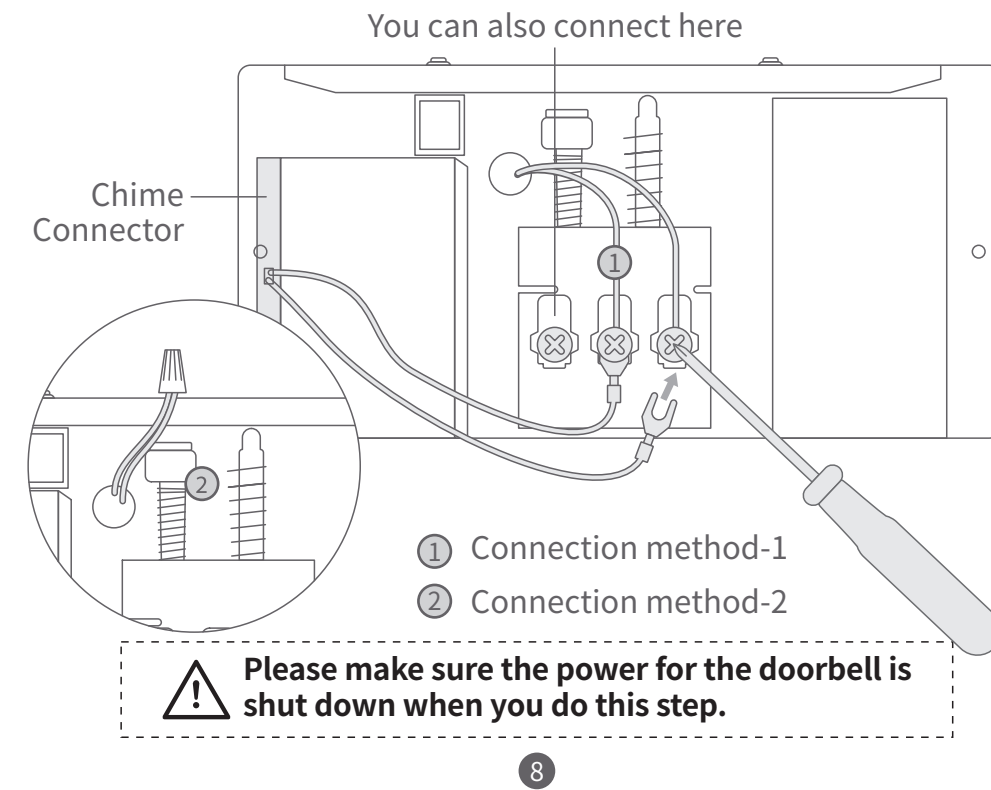

d. Height and Distance Recommendations

The optimal detection range for the Kami Doorbell Camera is 0-4m / 0-13ft. Additionally, we recommend you install the doorbell at a height of 1.2m / 4ft to ensure the ground in front of your door can be captured.

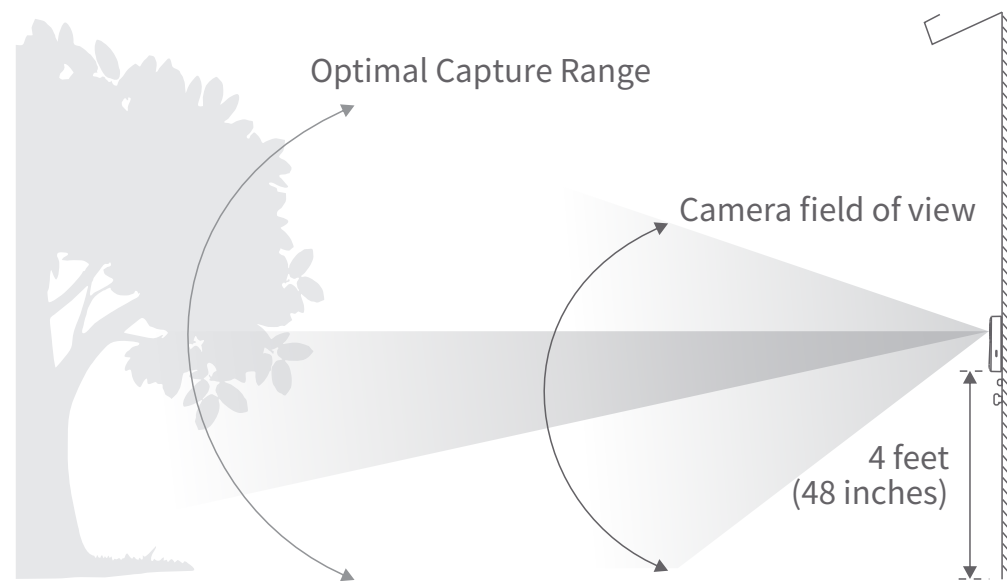

9

e. Suggested Installation Angle

Your Kami Doorbell Camera comes with three different backplates that can be used to help place your camera at Flat Backplate #1.

- If you don't want to change the camera's angle, use Flat Backplate #1.
- If you want to angle your Doorbell to the left or right, use Horizontal Backplate #2.
- If you want to angle your camera in a vertical direction, use Backplate #3.

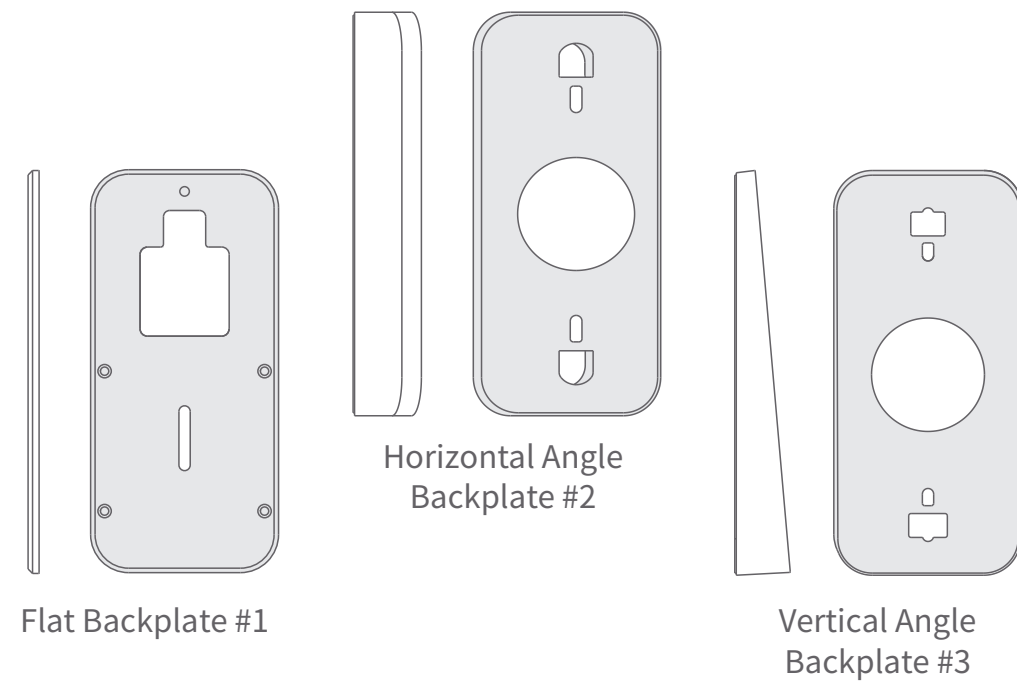

10

f. Fixing the Backplate to the Wall (optional)

Take out the backplane and lay it flat on the wall where Doorbell is to be installed. Take a pen and press it firmly into the center of the two holes in the back panel to mark the wall.

Note: Installing your camera on wood doesn't require screw anchors.

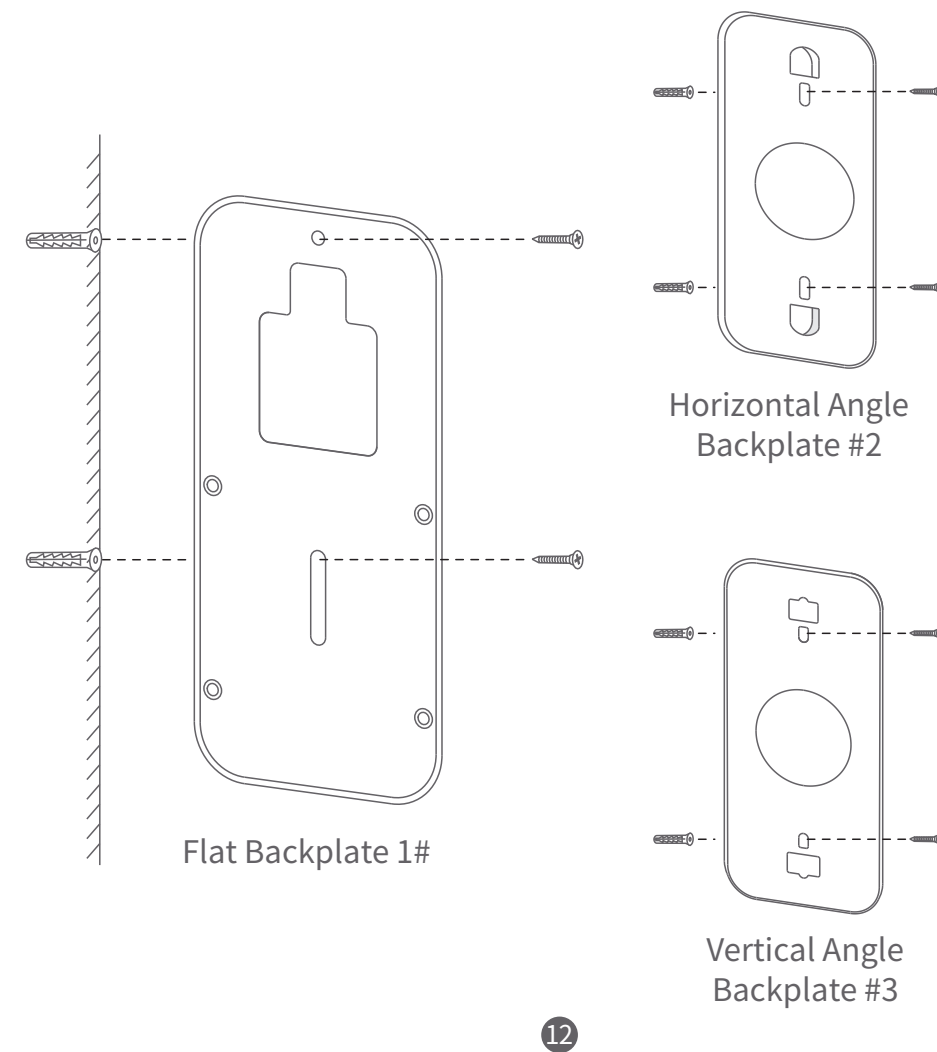
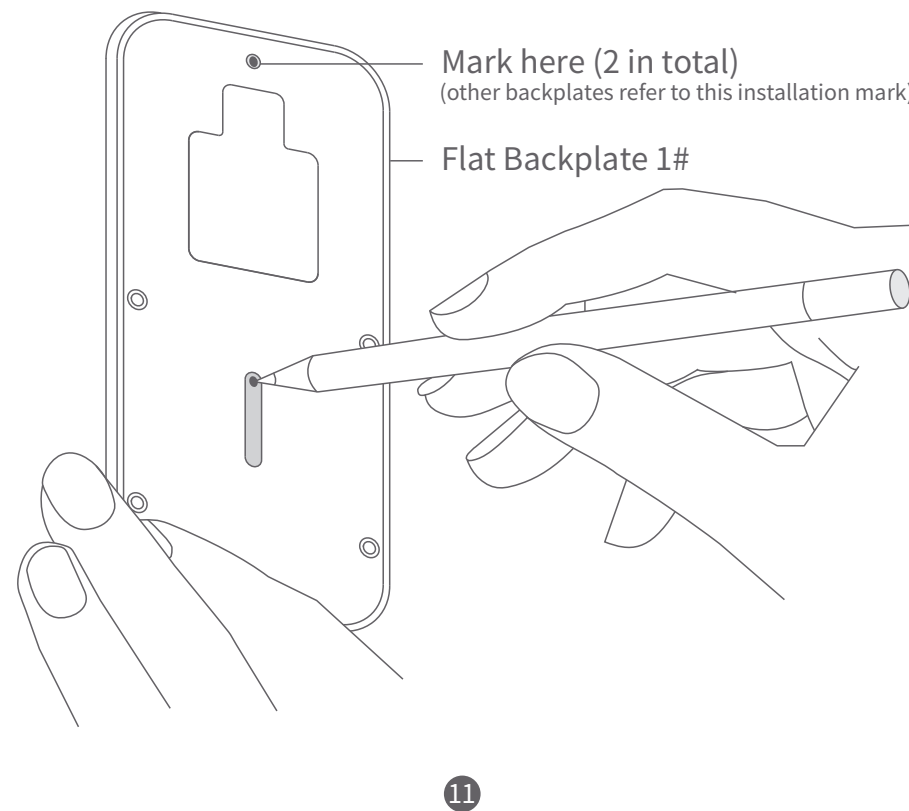

g. Connecting the Doorbell wires and (2) Extension Wires (optional)

You connect each of the wires to either of the screws in the back. The order does not matter.

If your wires are too short and you have trouble connecting the wires coming out of the wall to the back of the doorbell, please use the included Extension Wires and wire nuts. (See Picture).

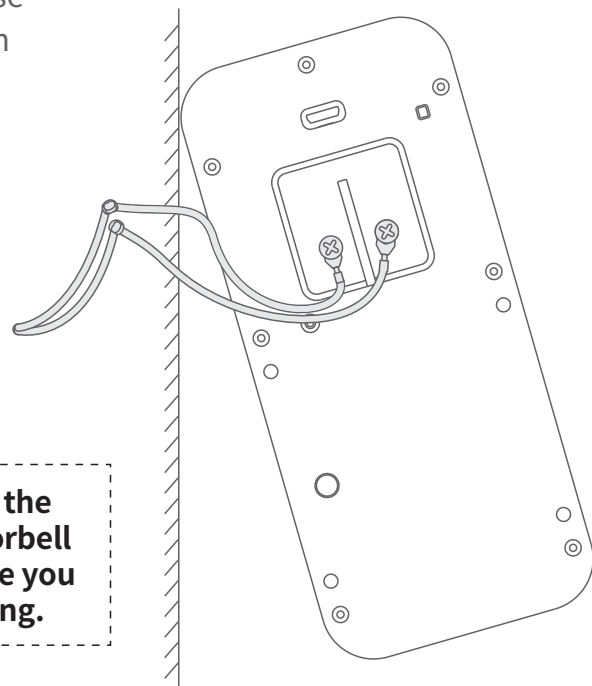

Please make sure the power for the doorbell is shut down while you complete the wiring.

13

h. Mount the Doorbell to the Flat Backplate

Feed all wires (and wire nuts, if you use them) into the wall and use four screws (screw C) to secure your doorbell to Flat Backplate #1.

Mount the Doorbell to the Flat Backplate:

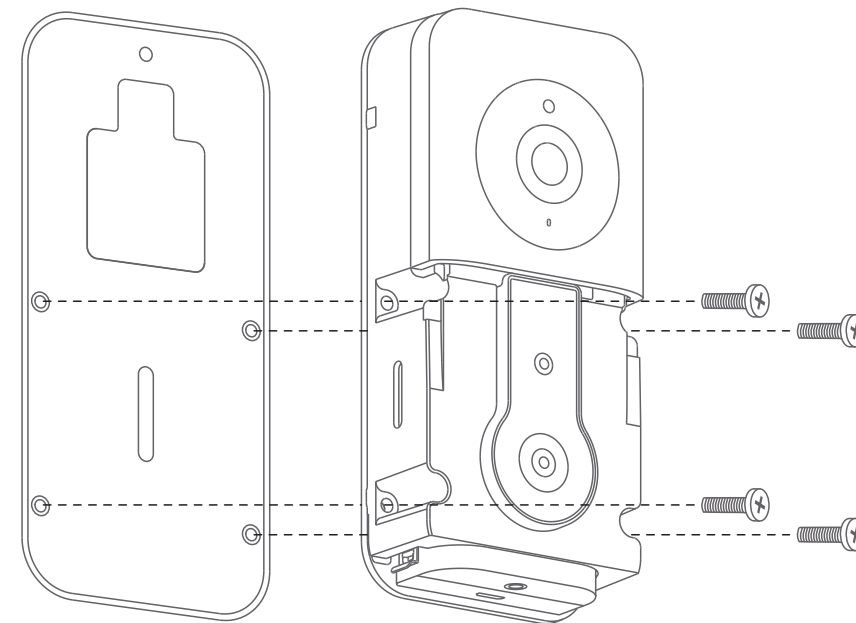

Flat Backplate #1

 Screw C
(Fine Threads)



14

Mount the Doorbell to an Angled Backplate:

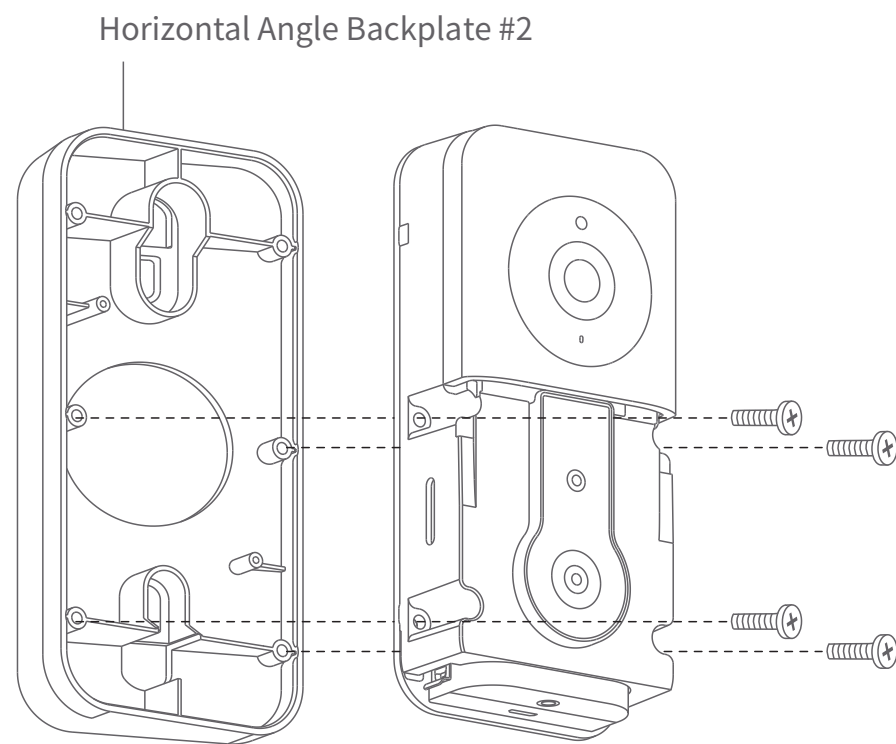

Angled Backplate #2 or
Backplate #3



15

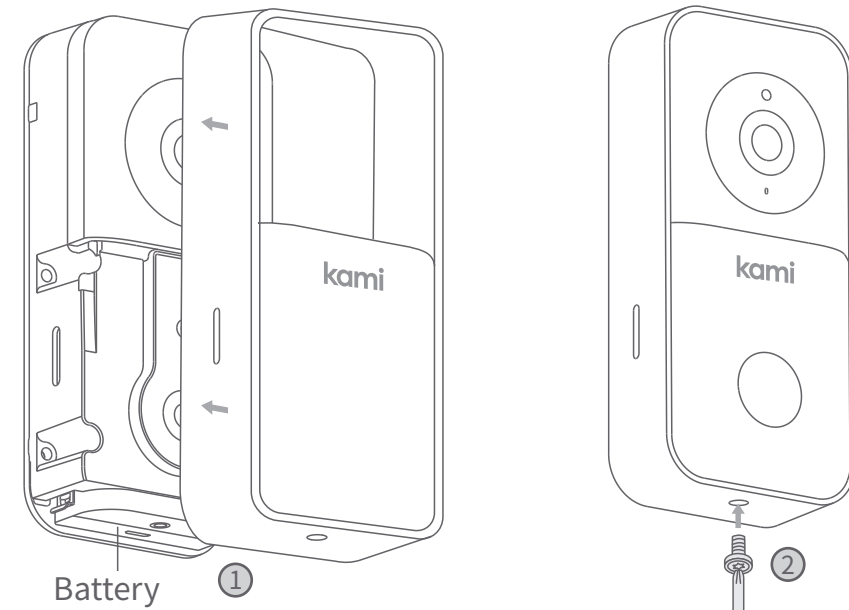

I. Install the Front Panel

- 1 Use Screw A to keep the Doorbell Front Panel in place.
- 2 Use Mounting Screw A to fix the camera



16

j. Turning the Power On

To complete the installation process, please switch the power back ON and test the operation of your Doorbell.

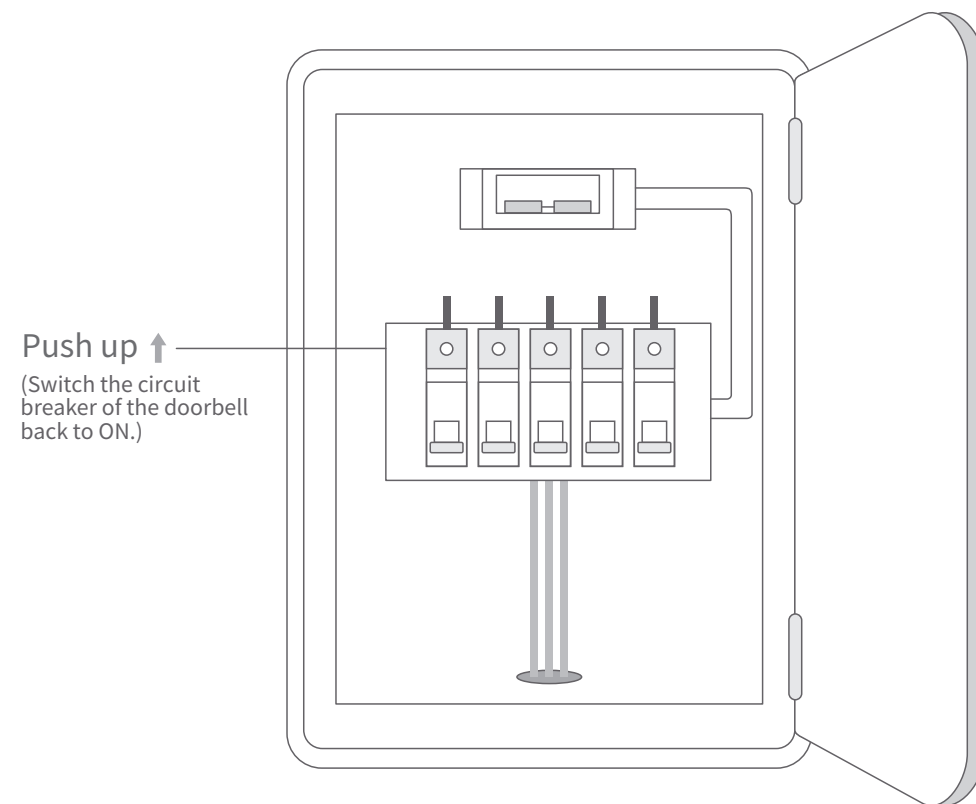

17

FCC COMPLIANCE STATEMENT:

This device complies with part 15 of the FCC Rules. Operation is subject to the following two conditions: (1) This device may not cause harmful interference, and (2) this device must accept any interference received, including interference that may cause undesired operation.

Changes or modifications not expressly approved by the party responsible for compliance could void the user's authority to operate the equipment.

The distance between user and products should be no less than 20cm

This equipment has been tested and found to comply with the limits for a Class B digital device, pursuant to part 15 of the FCC Rules. These limits are designed to provide reasonable protection against harmful interference in a residential installation. This equipment generates, uses and can radiate radio frequency energy and, if not installed and used in accordance with the instructions, may cause harmful interference to radio communications. However, there is no guarantee that interference will not occur in a particular installation. If this equipment does cause harmful interference to radio or television reception, which can be determined by turning the equipment off and on, the user is encouraged to try to correct the interference by one or more of the following measures:

- Reorient or relocate the receiving antenna.
- Increase the separation between the equipment and receiver.
- Connect the equipment into an outlet on a circuit different from that to which the receiver is connected.
- Consult the dealer or an experienced radio/TV technician for help.

IC WARNING

This device contains licence-exempt transmitter(s)/receiver(s) that comply with Innovation, Science and Economic Development Canada's licence-exempt RSS(s). Operation is subject to the following two conditions:

- (1) This device may not cause interference.
- (2) This device must accept any interference, including interference that may cause undesired operation of the device

The distance between user and products should be no less than 20cm

ADVERTENCIA IC

Cet appareil contient des émetteurs / récepteurs exemptés de licence conformes aux RSS (RSS) d'Innovation, Sciences et Développement économique Canada. Le fonctionnement est soumis aux deux conditions suivantes :

- (1) Cet appareil ne doit pas causer d'interférences.
- (2) Cet appareil doit accepter toutes les interférences, y compris celles susceptibles de provoquer un fonctionnement indésirable de l'appareil.

La distance entre l'utilisateur et de produits ne devrait pas être inférieure à 20cm

FCC ID: 2AFIB-YDS20121

IC: 20436-YDS20121