

BATTERY INFORMATION

The operation requires 4 "AA" 1.5V alkaline batteries for car and one 9V battery for remote control.

- Carefully remove items from package.
- Locate the battery compartment on the back of each item.
- Unscrew latch on bottom of car to release battery pack and replace batteries following the correct polarities.
- Replace the battery compartment door.
- Slide open the battery compartment door of the controller.
- Insert the 9V battery following the correct polarities.
- Replace the battery compartment door.

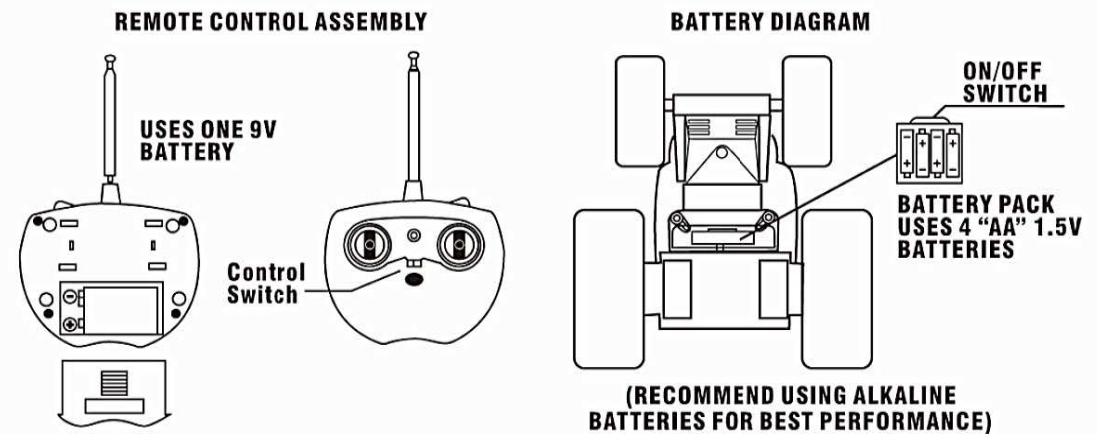

PERFORMING STUNTS

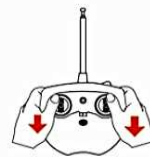

Reverse:
Press both control sticks backward.



Forward:
Press both control sticks forward.



Spinning Action:
Press and hold the control sticks in opposite directions to make the car spin.

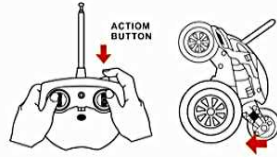

Action Button:
Press and hold the action button to have the car stand up on its back and move forward.

Spin on back wheel: Using Control Sticks

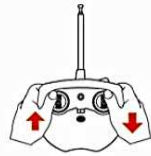

1) Have the car spinning by pressing and holding the control sticks in opposite directions.

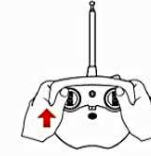
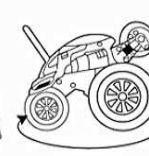

2) Quickly press the right hand control switch in forward and the car spinning on rear wheel.

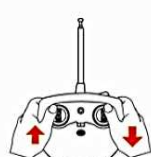
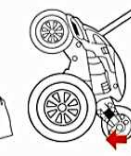

1) Have the car spinning by pressing and holding the control sticks in opposite directions.

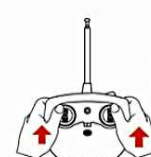
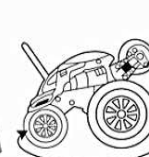

2) Quickly press and hold both control switches in forward direction.



SAFETY PRECAUTIONS

- Do not operate during thunderstorms or rain.
- Avoid water, sand and snow when operating your car.
- Do not submerge car or controller in water.
- Never operate your car on the street or highway.
- Adult supervision is recommended when operating this car.
- Remove all batteries when not in use to avoid accidental operation.
- Never operate your car in a confined or crowded area and do not use people or animals as obstacles.
- Do not run your car into furniture, objects or hard surfaces, as this will cause damage to both the objects and the car.
- Keep fingers, hair and loose clothing away from the tires, gears and motor while the car is switched to "ON".
- Do not leave car or transmitter near sources of heat or under direct sunlight for long periods of time.
- Do not leave car or transmitter outside overnight. Dampness is harmful to interior components.

BATTERY WARNING

- Do not mix old and new batteries.
 - Do not mix alkaline, standard (carbon-zinc) or rechargeable (nickel-cadmium) batteries.
 - Insert batteries using the correct polarity. Do not short-circuit the supply terminal.
 - Remove batteries when not in use. Recycle or dispose of exhausted batteries according to federal, state or local laws. Do not dispose of batteries in a fire—they may leak or explode.
 - Only use manufacturer specified battery(ies), charger(s) and/or adapter, if applicable, specifies by the manufacturer.
 - Always use, replace and recharge (if applicable) batteries under adult supervision.
 - Non-rechargeable batteries are not to be recharged.
- KEEP THIS PACKAGE FOR REFERENCE AS IT CONTAINS IMPORTANT INFORMATION.

Caution: The user is cautioned that changes or modifications not expressly approved by the party responsible for compliance could void the user's authority to operate the equipment.

This device complies with Part 15 of the FCC Rules. Operation is subject to the following two conditions: (1) this device may not cause harmful interference, and (2) this device must accept any interference received, including interference that may cause undesired operation.

Note: This equipment has been tested and found to comply with the limits for a Class B digital device, pursuant to part 15 of the FCC Rules. These limits are designed to provide reasonable protection against harmful interference in a residential installation. This equipment generates, uses and can radiate radio frequency energy and, if not installed and used in accordance with the instructions, may cause harmful interference to radio communications. However, there is no guarantee that interference will not occur in a particular installation. If this equipment does cause harmful interference to radio or television reception, which can be determined by turning the equipment off and on, the user is encouraged to try to correct the interference by one or more of the following measures:

- Reorient or relocate the receiving antenna.
- Increase the separation between the equipment and receiver.
- Connect the equipment into an outlet on a circuit different from that to which the receiver is connected.
- Consult the dealer or an experienced radio/TV technician for help.