



Dobot User Manual

V2.0

Let's Dobot

Dobot 2.0 is a new generation of desktop robotic arm. It has friendly unibody design, better performance and more features, while maintaining a price of a desktop level product. With continuous development and full optimization, it's a powerful helper for your home. Rich extension ports, help you make the most out of the robot. Brand new professional controlling software brings you the engaging experience never had before, and makes you feel the endless possibilities of future technology.

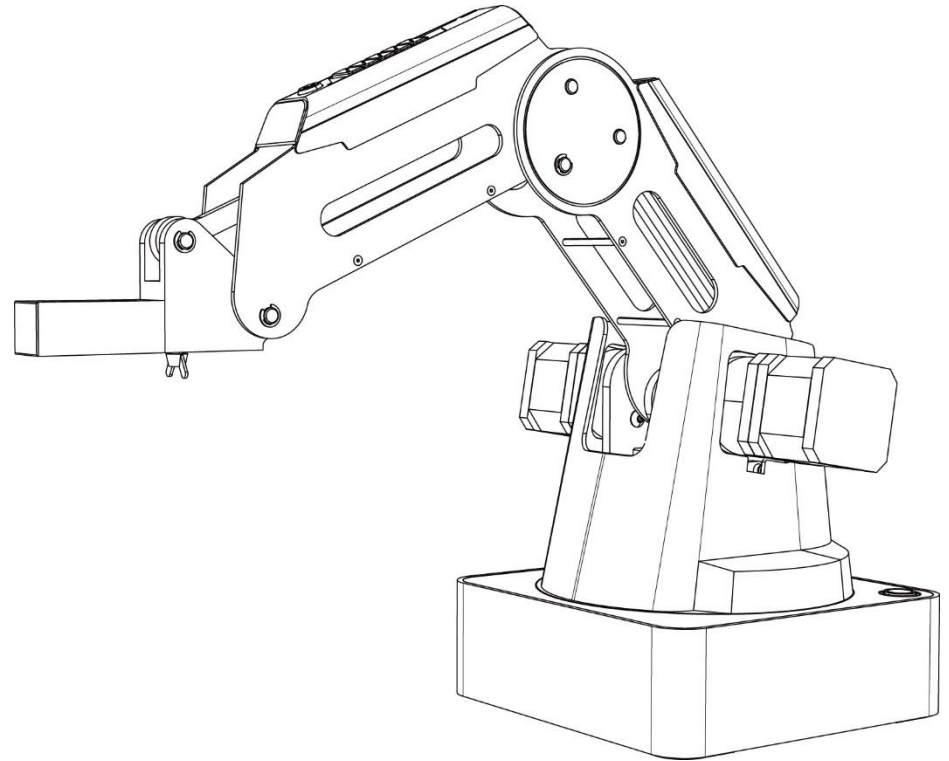

Robot Arm

Joint1
Joint2
Joint3
joint4

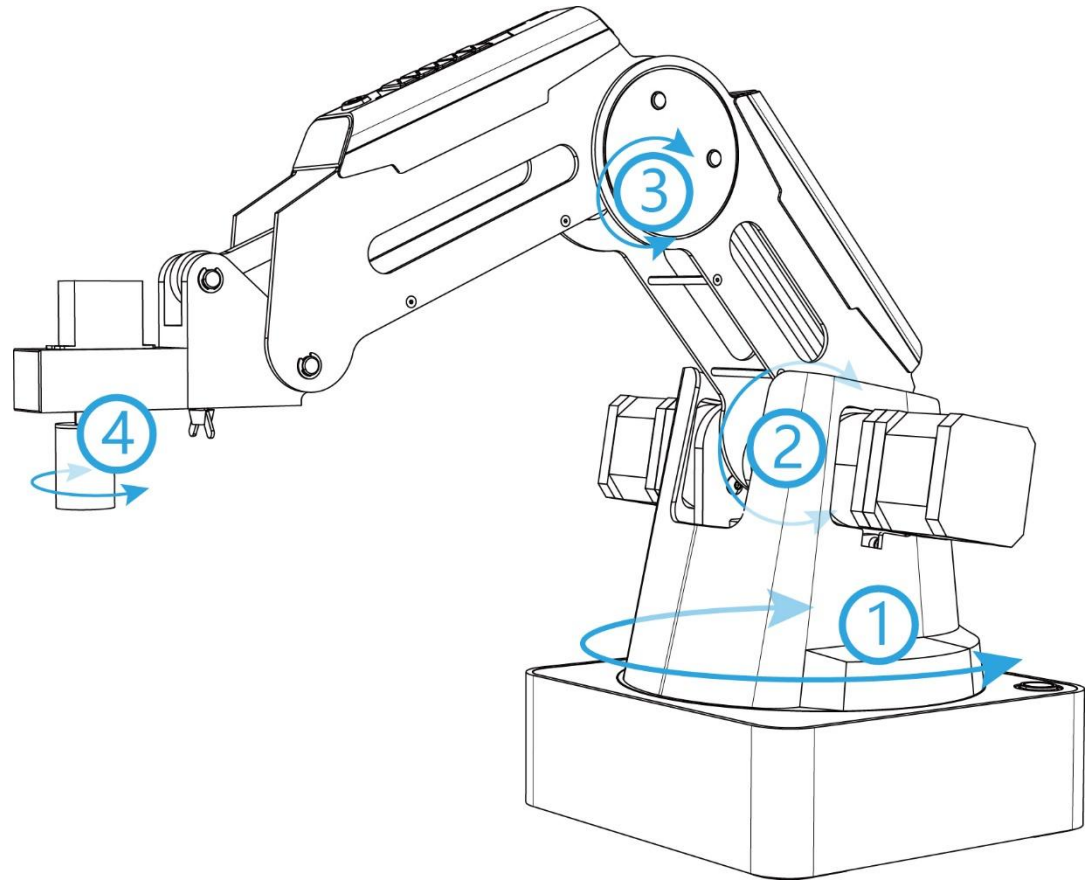

Dobot Integrated Controller

The Dobot controller is specifically designed for Dobot Application. The innovative FPGA solution significantly increases the stability of stepper driving and gives the flexibility to STM32 for complex tasks.

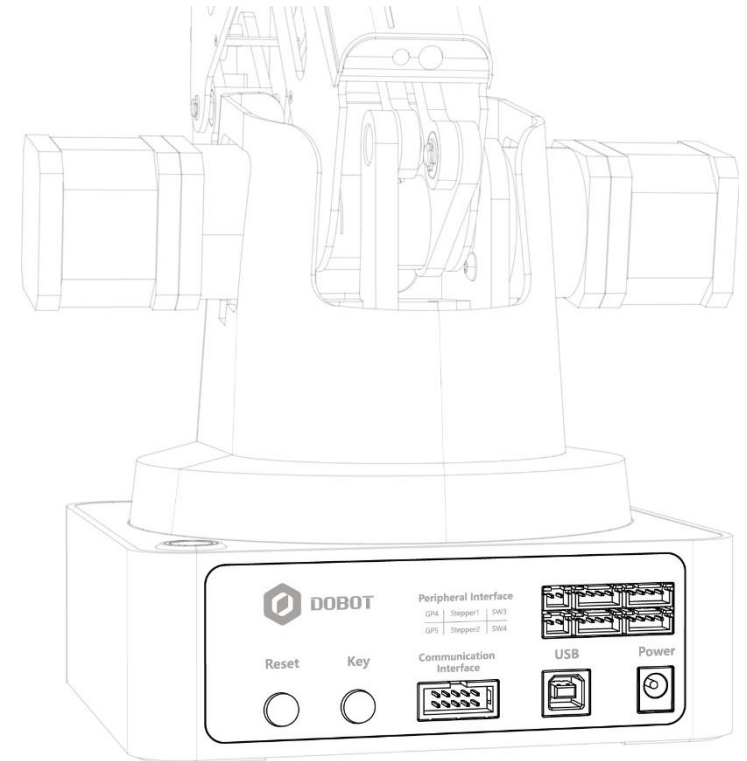
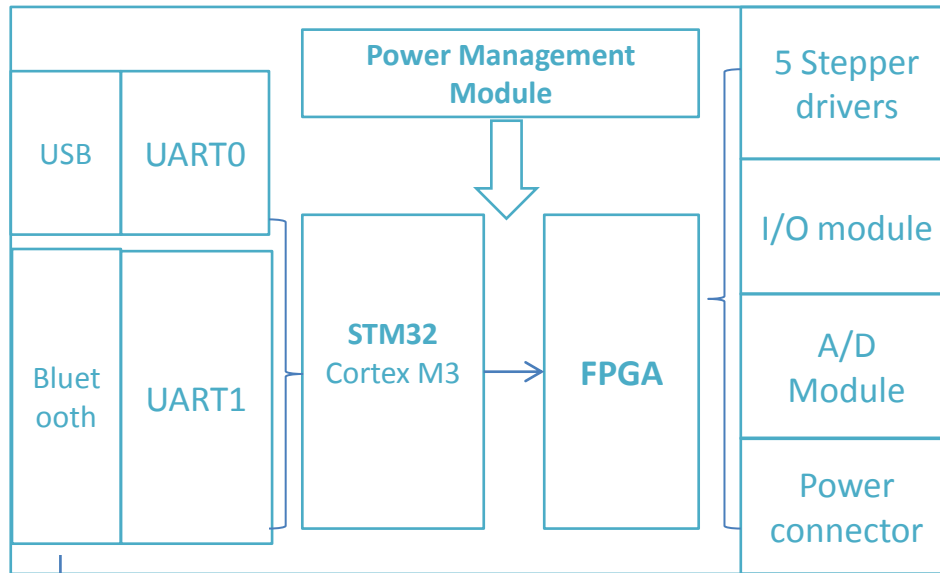

Connection interface
(for external box with Bluetooth module)

Reference Frame

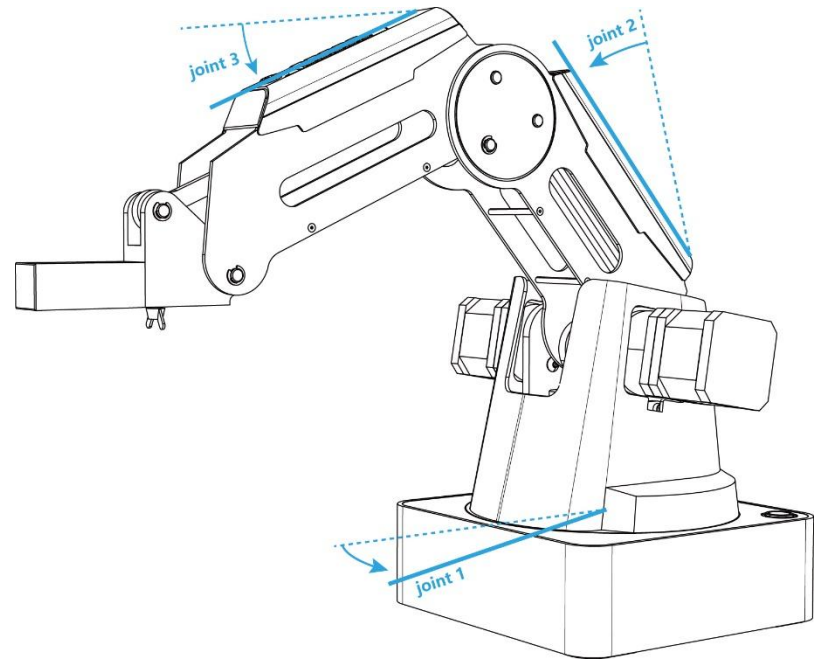
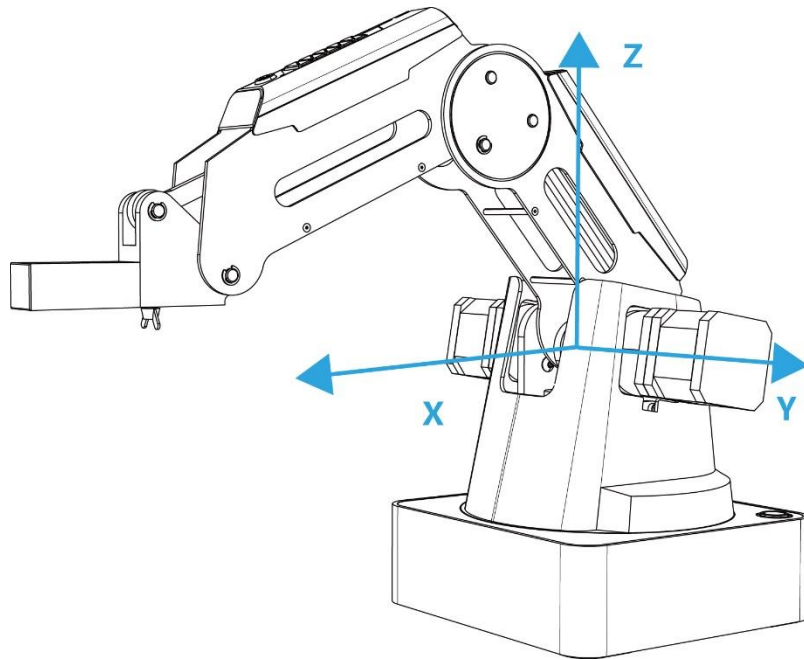

Quick Start Guide

1. To control through USB

- step1: Connect USB port with PC and start power;
- step2: Open PC software, click 'connect' to access to Dobot;
- step3: After a successful connection, Dobot can realize lots of functions through jog mode or liner mode , such as teach & playback, writing, drawing, laser engraving and so on.

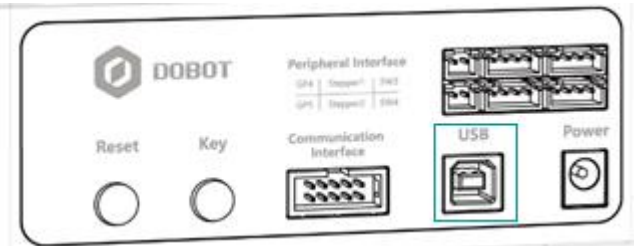

USB Port

2. To control through Bluetooth module(optional)

- step1: Insert Bluetooth module into corresponding interface of controller;
- step2: Start power and reset Dobot;
- step3: Open mobile APP, search Bluetooth port and connect, and here password is 0000 or 1234;
- step4: After a successful connection, Dobot can be controlled by APP, like the function of teach & playback.

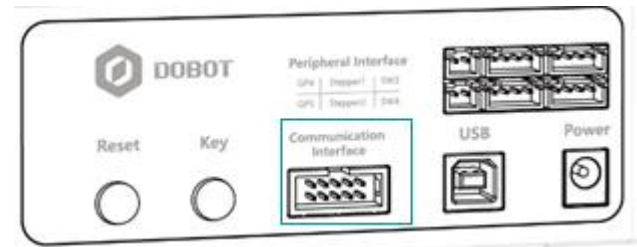

Bluetooth Interface

Note: The external box with Bluetooth module is an optional accessory. Through the Bluetooth connection interface, the external box can connect to the Dobot 2.0 via the cable.

State definition

State definition	Blue	Light Gradually eliminate gradually	Connected with USB
		On	Execute a command
		Flash	Ready to be connected
		Light 2 sec and eliminate 0.5 sec	Task suspended
	Green	Light Gradually eliminate gradually	Connected with communication port
		On	Offline
		Flash	
		Light 2 sec and eliminate 0.5 sec	Task suspended
	Orange	On	Reset software when got an unexpected interrupt or halt
		Light Gradually eliminate gradually	Be at a limited position
		Flash	
		Light 2sec and eliminate 0.5 sec	
	Red	On	Error: Fail to return to zero
		Light Gradually eliminate gradually	
		Flash	Error: Reading error of angle sensor
		Long light and short eliminate	Encoder error of base



Robot will return to zero automatically when start, so please put it in a safe place to prevent any accidents!

Support

1. More information available on our official website dobot.cc.
2. Software and detailed instructions can be found on dobot.cc/download.
3. Share your joy and creative ideas on forum.dobot.cc.
4. If you have further questions, please send email to support@dobot.cc.

Specification



Number of Axis	4
Weight	4kg
Dimension base	158mm * 158mm
Payload	500g
Position repeatability	0.2mm
Material	Aluminum Alloy 6061
Controller	Dobot Integrated Controller
Communication	UART/Bluetooth connection interface
Power Supply	12V/5A DC
Joint	Working Range
Joint 1 base	+135° to -135°
Joint 2 rear arm	+85° to -5°
Joint 3 forearm	+95° to -10°
Joint 4 rotation servo	+90° to -90°

Statement

Changes or modifications not expressly approved by the party responsible for compliance could void the user's authority to operate the equipment.

This device complies with Part 15 of the FCC Rules. Operation is subject to the following two conditions: (1) this device may not cause harmful interference, and (2) this device must accept any interference received, including interference that may cause undesired operation.

This equipment has been tested and found to comply with the limits for a Class B digital device, pursuant to Part 15 of the FCC Rules. These limits are designed to provide reasonable protection against harmful interference in a residential installation. This equipment generates, uses and can radiate radio frequency energy and, if not installed and used in accordance with the instructions, may cause harmful interference to radio communications. However, there is no guarantee that interference will not occur in a particular installation.

If this equipment does cause harmful interference to radio or television reception, which can be determined by turning the equipment off and on, the user is encouraged to try to correct the interference by one or more of the following measures:

- Reorient or relocate the receiving antenna.
- Increase the separation between the equipment and receiver.
-
- Connect the equipment into an outlet on a circuit different from that to which the receiver is connected.
- Consult the dealer or an experienced radio/TV technician for help.



Shenzhen Yuejiang Technology Co., Ltd

18F, BUILDING C2, NANSHAN I PARK, NO. 1001, XUEYUAN
AVENUE, SHENZHEN, GUANGDONG PROVINCE, CHINA. 518055
TEL: +86-0755-33077021 (Mon to Sat, 09:00 AM to 18:00 PM GMT+8)
E-MAIL: sales@dobot.cc info@dobot.cc WEB: dobot.cc