

YUNMAI App

Easy life, lighter! Using YUNMAI SE together with the App, you can not only record exercise consumption, food intake and other basic information, but also track your weight trends. YUNMAI helps to analyze on the Cloud and provide health reports and improvement recommendations.

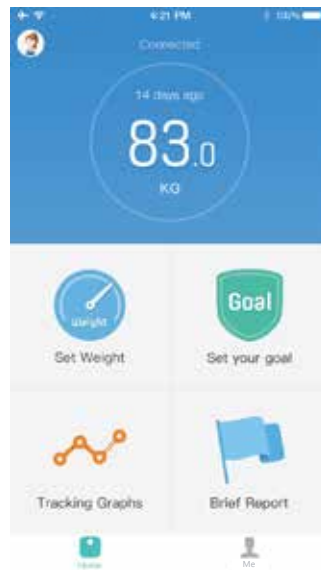

Notice: Due to the frequent updates of YUNMAI App, this picture is for reference only. Please adhere to the real products in case of any change!

Display Screen



Body Mass Index comparison table

BMI (for men and women)					
Age	Underweight	Normal	Overweight	Obese	Grossly Overweight
18-120	< 18.5	18.5-24.9	25-29.9	30-34.9	≥ 35

Body Mass Index (BMI) = weight (kg) ÷ height ^ 2 (m)
For example: BMI = 70kg ÷ (1.75m × 1.75m) = 22.86, belongs to the normal range.
Note: BMI Index is a standard that is widely used to judge a person's health condition.

Mobile Device Support

iOS8.0 and above
iPhone 4S /5/5S /6/6 Plus/SE/6S/6S Plus /7/7 Plus/iPod touch /iPad
Android 4.3 and above with Bluetooth 4.0

Maintenance

Use a wet cloth to clean the scale. Do not use any detergent and don't use water to wash it directly.

Warranty

YUNMAI SE guarantees a year of technical support and hardware warranty.

Warning

Do not disassemble, squeeze, puncture the product or put it into water, fire, or exposes it to temperature higher than 60 ° C (140 ° F).

FCC Statement

FCC ID: 2ADEB-M1680
This equipment has been tested and found to comply with the limits for a Class B digital device, pursuant to Part 15 of the FCC Rules. These limits are designed to provide reasonable protection against harmful interference in a residential installation. This equipment generates uses and can radiate radio frequency energy and, if not installed and used in accordance with the instructions, may cause harmful interference to radio communications. However, there is no guarantee that interference will not occur in a particular installation. If this equipment does cause harmful interference to radio or television reception, which can be determined by turning the equipment off and on, the user is encouraged to try to correct the interference by one or more of the following measures:
--- Reorient or relocate the receiving antenna.
--- Increase the separation between the equipment and receiver.
--- Connect the equipment into an outlet on a circuit different from that to which the receiver is connected.
--- Consult the dealer or an experienced radio/TV technician for help.
This device complies with part 15 of the FCC Rules. Operation is subject to the following two conditions:
(1) This device may not cause harmful interference.
(2) This device must accept any interference received, including interference that may cause undesired operation.
Changes or modifications not expressly approved by the party responsible for compliance could void the user's authority to operate the equipment.

Product Specifications

Product Name: YUNMAI SE Smart Weight Scale
Model : M1680
Measurement Unit: Kg/Lb
Connection : Bluetooth 4.0
Size: 260 × 260 × 26 mm
Executive Standard: Q / HC 1 - 2015
Net Weight: 1.2 Kg
Weighing Range: 3 - 180 Kg
Accuracy: ±50g
Working Temperature: -5 °C - 40 °C
Exterior Material: Eco-friendly ABS
Power: 1.5V AA Battery x3

For more information please visit www.iyunmai.com
Hotline: +86-755-8671-6230
Facebook : www.facebook.com/iyunmai
Twitter: twitter.com/YunmaiGlobal
Manufacturer: Shenzhen YUNMAI Technology Co., Ltd
Address: Room 10D, 10F, 4C Building, Software Industry Base, Nanshan District, Shenzhen, China

YUNMAI SE Smart Weight Scale Instructions



Product Introduction and Installation

Thank you for choosing YUNMAI SE

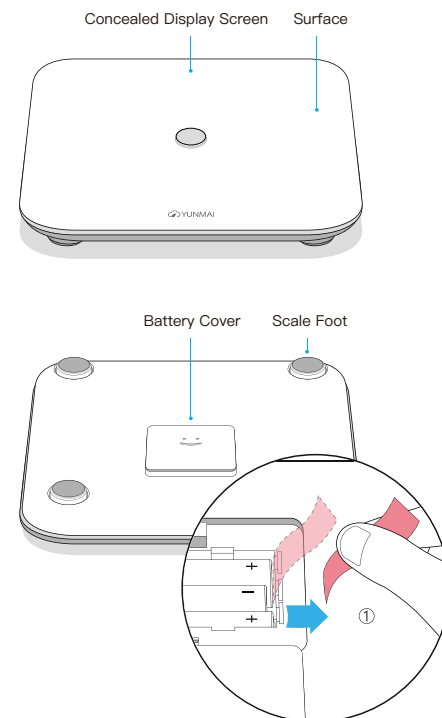

① Note: Remove the battery insulation to start

1 Install YUNMAI App on your phone

Search "YUNMAI" in the Android Application Market or the iOS App Store or scan the following QR Code to download, install it and it will get connected to the scale once turned on.



Scan QR code
Download <YUNMAI App>

2 Connect to the scale via Bluetooth

Open YUNMAI App and Bluetooth and it will get connected automatically, and your real-time data will sync to the App.

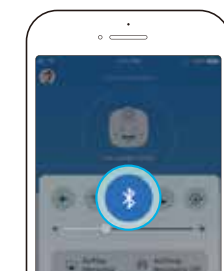

iOS: Slide from the bottom of the screen to open the Control Center and click on the [Bluetooth] Logo

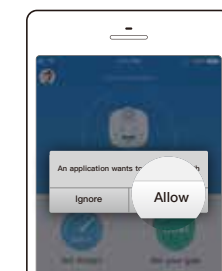

Android: Click on [Allow] to turn on Bluetooth when the system reminds you when open YUNMAI App

3 Start Using

Set each foot on each side of the central point naturally as shown below:

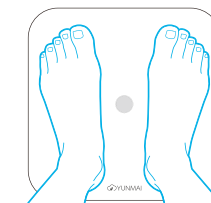

Correct
Each foot on each side of the central point naturally

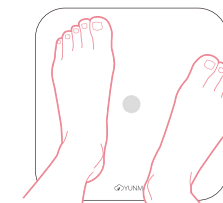

Wrong
Feet go out of the verge may affect the accuracy

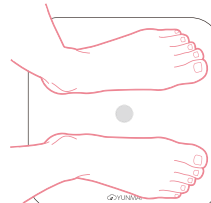

Wrong
Stand in wrong direction will shield the screen

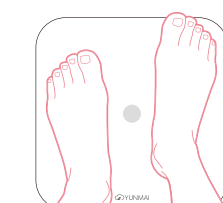

Wrong
Feet not in a line may affect the accuracy

Note: To ensure the accuracy please stand on the scale barefoot with the right posture.

Product Introduction

Thank you for choosing YUNMAI 2 Smart Scale

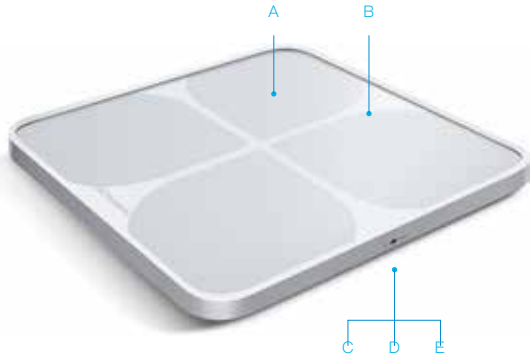

- A ITO conductive coating x 4
- B Concealed Display Screen
- C Reset Key
- D USB Type-C charge port
- E Speaker

1 Activation

Place YUNMAI 2 on a flat floor and press the surface until the screen shows "YUNMAI" to activate it.

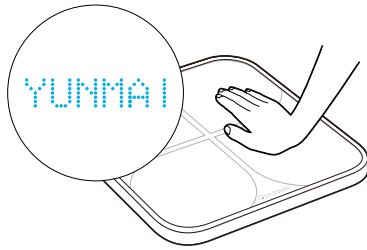

2 App Installation

Search "YUNMAI" in the iOS App Store or Android Application Market or scan the following QR Code to download, install it and it will get connected to the scale once turned on.



Scan QR Code
Download <YUNMAI App>

3 Get Connected

Please lay the scale at a place with strong WiFi signal or near the router when it first get connected. WiFi signal will influence connecting time and stability.

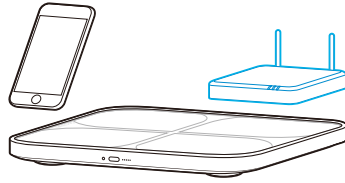

Place in the scope of WiFi in first connection

3-1 Connect to the scale via Bluetooth

Open YUNMAI App and Bluetooth and it will get connected automatically, and your real-time data will sync to the App.

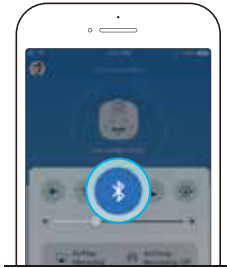

iOS: Slide from the bottom of the screen to open the Control Center and click on the [Bluetooth] Logo

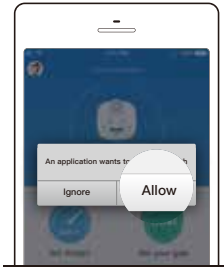

Android: Click on [Allow] to turn on Bluetooth when the system reminds you when open YUNMAI App

3-2 Connect via WiFi

Under WiFi mode, as long as the scale and the phone are placed in the scope of the WiFi, then the data will be synchronized automatically to the App even without opening it. Open WiFi option on the phone and YUNMAI App and get connected as the following instructions:

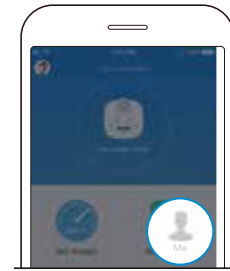

① Click on [Me]

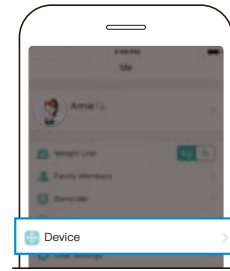

② Click on [Device]



③ Click on [Device Connection]



④ Finish the process as indicated

4 Start Using

Set each foot on each side of the central point naturally as shown below:

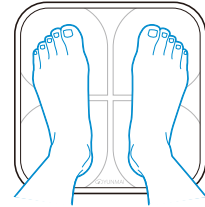

Correct
Each foot on each side of the central point naturally



Wrong
Feet go out of the verge may affect the accuracy

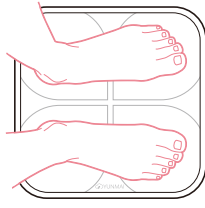

Wrong
Stand in wrong direction will shield the screen



Wrong
Feet not in a line may affect the accuracy

Note: To ensure the accuracy please stand on the scale barefoot with the right posture.

Display and Status



WiFi Connection



WiFi Signal Error



Bluetooth



Alarm Clock



Full Battery Power



Low Battery Power



Weight gained



Weight lost



Kg (Unit)



Body Fat



lb (Unit)



Upgrading



Sunny



Cloudy



Rainy



Snowy



Temperature

Body Statistics Table

	Age	Body Fat	Muscle Ratio	BMI
Male	18-39	0-9.9% Low	<51% Low ≥51% Normal	< 18.5 Underweight 18.5-24.9 Normal 25-29.9 Overweight 30-34.9 Obese ≥ 35 Grossly Overweight
		10-20.9% Normal		
		21-25.9% Slightly obese		
		26-60% Obese		
	40-59	0-10.9% Low		
		11-21.9% Normal		
Female	18-39	0-9.9% Low	<46% Low ≥46% Normal	< 18.5 Underweight 18.5-24.9 Normal 25-29.9 Overweight 30-34.9 Obese ≥ 35 Grossly Overweight
		10-33.9% Normal		
		34-38.9% Slightly obese		
		39-60% Obese		
	40-59	0-20.9% Low		
		21-34.9% Normal		
Male	18-39	0-9.9% Low	<51% Low ≥51% Normal	< 18.5 Underweight 18.5-24.9 Normal 25-29.9 Overweight 30-34.9 Obese ≥ 35 Grossly Overweight
		10-20.9% Normal		
		21-25.9% Slightly obese		
		26-60% Obese		
	40-59	0-10.9% Low		
		11-21.9% Normal		
Female	18-39	0-9.9% Low	<46% Low ≥46% Normal	< 18.5 Underweight 18.5-24.9 Normal 25-29.9 Overweight 30-34.9 Obese ≥ 35 Grossly Overweight
		10-33.9% Normal		
		34-38.9% Slightly obese		
		39-60% Obese		
	40-59	0-20.9% Low		
		21-34.9% Normal		
Male	18-39	0-9.9% Low	<51% Low ≥51% Normal	< 18.5 Underweight 18.5-24.9 Normal 25-29.9 Overweight 30-34.9 Obese ≥ 35 Grossly Overweight
		10-20.9% Normal		
		21-25.9% Slightly obese		
		26-60% Obese		
	40-59	0-10.9% Low		
		11-21.9% Normal		
Female	18-39	0-9.9% Low	<46% Low ≥46% Normal	< 18.5 Underweight 18.5-24.9 Normal 25-29.9 Overweight 30-34.9 Obese ≥ 35 Grossly Overweight
		10-33.9% Normal		
		34-38.9% Slightly obese		
		39-60% Obese		
	40-59	0-20.9% Low		
		21-34.9% Normal		

	Age	Body Fat	Muscle Ratio	BMI
Male	18-39	0-9.9% Low	<51% Low ≥51% Normal	< 18.5 Underweight 18.5-24.9 Normal 25-29.9 Overweight 30-34.9 Obese ≥ 35 Grossly Overweight
		10-20.9% Normal		
		21-25.9% Slightly obese		
		26-60% Obese		
	40-59	0-10.9% Low		
		11-21.9% Normal		
Female	18-39	0-9.9% Low	<46% Low ≥46% Normal	< 18.5 Underweight 18.5-24.9 Normal 25-29.9 Overweight 30-34.9 Obese ≥ 35 Grossly Overweight
		10-33.9% Normal		
		34-38.9% Slightly obese		
		39-60% Obese		
	40-59	0-20.9% Low		
		21-34.9% Normal		
Male	18-39	0-9.9% Low	<51% Low ≥51% Normal	< 18.5 Underweight 18.5-24.9 Normal 25-29.9 Overweight 30-34.9 Obese ≥ 35 Grossly Overweight
		10-20.9% Normal		
		21-25.9% Slightly obese		
		26-60% Obese		
	40-59	0-10.9% Low		
		11-21.9% Normal		
Female	18-39	0-9.9% Low	<46% Low ≥46% Normal	< 18.5 Underweight 18.5-24.9 Normal 25-29.9 Overweight 30-34.9 Obese ≥ 35 Grossly Overweight
		10-33.9% Normal		
		34-38.9% Slightly obese		
		39-60% Obese		
	40-59	0-20.9% Low		
		21-34.9% Normal		

Note: Juveniles have rapid physical developments and their body statistics, such as body fat, BMI and muscle rate may fluctuate largely, so it is difficult to get an accurate result except the weight.

Mobile Device Support

iOS 8.0 and above
iPhone 4S/5/5S/6/6 Plus/SE/6S/6S Plus/7/7 Plus
iPod touch /iPad
Android 4.3 and above with Bluetooth 4.0

Important Note

Measurement results of YUNMAI 2 is only for reference, but professional medical advice.
Measurement Range: 3-150 Kg.

Safe Power Charging

Do not use low-quality plugs and cables.
Refrain from long-time charging in case of short circuit.
Do not charge in damp environment in case of electric leakage.

Maintenance

Use a wet cloth to clean the scale.
Do not use any detergent and don't use water to wash it directly.

Warranty

YUNMAI 2 Smart Scale guarantees a year of technical support and hardware warranty.

Product Specification

Product Name: YUNMAI 2 Smart Scale
Model : M1601
Measurement Unit: Kg /Lb
Connection : Bluetooth 4.0, WiFi
Size: 300 x 300 x 23 mm
Executive Standard: Q / HC 1 - 2015
Net Weight: 1.9 Kg
Weighing Range: 3 - 180 Kg
Accuracy: ±50g
Working Temperature: -5 °C - 40 °C
Exterior Material: Eco-friendly ABS + PC
Battery Type : Li-Polymer Battery

FCC Statement

FCC ID: 2ADEB-M1601

This equipment has been tested and found to comply with the limits for a Class B digital device, pursuant to Part 15 of the FCC Rules. These limits are designed to provide reasonable protection against harmful interference in a residential installation. This equipment generates uses and can radiate radio frequency energy and, if not installed and used in accordance with the instructions, may cause harmful interference to radio communications. However, there is no guarantee that interference will not occur in a particular installation. If this equipment does cause harmful interference to radio or television reception, which can be determined by turning the equipment off and on, the user is encouraged to try to correct the interference by one or more of the following measures:

- Reorient or relocate the receiving antenna.
 - Increase the separation between the equipment and receiver.
 - Connect the equipment into an outlet on a circuit different from that to which the receiver is connected.
 - Consult the dealer or an experienced radio/TV technician for help.
- This device complies with part 15 of the FCC Rules. Operation is subject to the following two conditions:
(1) This device may not cause harmful interference.
(2) This device must accept any interference received, including interference that may cause undesired operation.
Changes or modifications not expressly approved by the party responsible for compliance could void the user's authority to operate the equipment.

For more information please visit www.iyunmai.com
Hotline: +86-755-8671-6230
Facebook : www.facebook.com/iyunmai
twitter: twitter.com/YunmaiGlobal
Manufacturer: Shenzhen YUNMAI Technology Co., Ltd
Address: Room 10D, 10F, 4C Building, Software Industry Base, Nanshan District, Shenzhen, China

YUNMAI2
Smart Scale Instructions



YUNMAI