



2 Scene Controller with Switches - Single Pole (One Location)

Cat. No. VRCS2, 120/240VAC, 50/60Hz
 Incandescent-1000W/Switch – Magnetic Low-Voltage-1000VA/Switch
 Electronic Low-Voltage-1000W/Switch – Fluorescent-1000VA/Switch – Supplemental-1/4 HP/Switch

INSTALLATION INSTRUCTIONS

WARNINGS AND CAUTIONS:

- To be installed and/or used in accordance with appropriate electrical codes and regulations.
- If you are unsure about any part of these instructions, consult an electrician.
- Vizia RF +™ electronic combo switches are not compatible with standard 3-way or 4-way switches. They must be used with compatible Vizia RF +™ controllers.

WARNINGS AND CAUTIONS:

- Disconnect power at circuit breaker or fuse when servicing, installing or removing fixture.
- Recommended minimum wall box depth is 2-1/2".
- Use this device only with copper or copper clad wire.

INTRODUCTION

Leviton's Vizia RF +™ Z-Wave® components are designed to communicate with each other via Radio Frequency (RF) to provide remote control of your lighting. Using RF technology allows Leviton to provide the greatest signal integrity possible. Each module in Leviton's Vizia RF +™ component line is a Z-Wave® enabled device. In a Z-Wave® network, each device is designed to act as a router. These routers will re-transmit the RF signal from one device to another until the intended device is reached. This ensures that the signal is received by its intended device by routing the signal around obstacles and radio dead spots. The Scene Capable Combo Switch is compatible with any Z-Wave® enabled network, regardless of the manufacturer and can also be used with other devices displaying the Z-Wave® logo.

FEATURES

- Switch ON/OFF
- Scene Capable
- This is a Z-Wave® Controller
- Can call 2 Scene Controller
- ON/OFF LED
- Two way communication
- RF reliability
- Ease of installation – No new wiring
- Compatible with other Z-Wave® enabled devices

Tools needed to install your Device

- Slotted/Phillips Screwdriver
- Electrical Tape
- Pliers
- Pencil
- Cutters
- Ruler

Changing the color of your Device

Your 2-Scene Controller with Switches includes three color options. The device ships with the White frame attached. To change color of frame, proceed as follows:

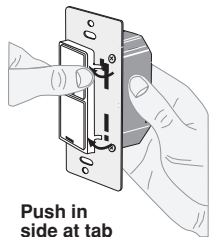

Push in side at tab to release

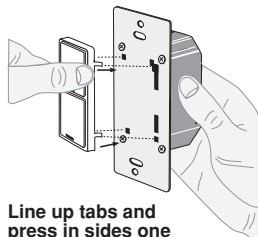

Line up tabs and press in sides one at a time to attach

INSTALLING YOUR DEVICE

NOTE: Use check boxes when Steps are completed.

Step 1 **WARNING: TO AVOID FIRE SHOCK OR DEATH; TURN OFF POWER** at circuit breaker or fuse and test that power is off before wiring!

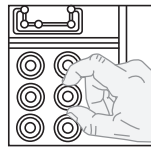
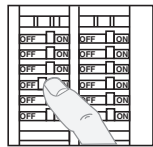

Step 2 **Identifying your wiring application (most common):**

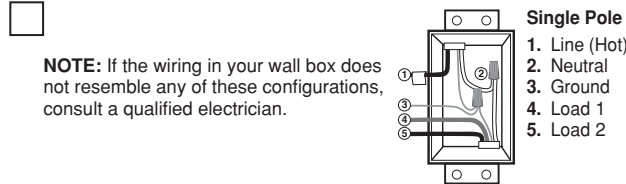

Step 3 **Preparing and connecting wires:**

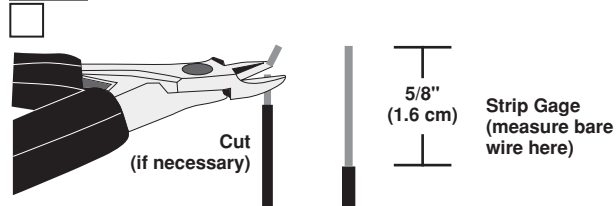

- Make sure that the ends of the wires from the wall box are straight (cut if necessary).
- Remove insulation from each wire in the wall box as shown.

For non-standard wiring applications, refer to Wire Nut and Connector Size Chart

WIRE CONNECTOR / # OF COND. COMBINATION CHART
1 - #12 w/ 1 to 3 #14, #16 or #18
2 - #12 w/ 1 or 2 #16 or #18
1 - #14 w/ 1 to 4 #16 or #18
2 - #14 w/ 1 to 3 #16 or #18

Step 4 **Single Pole Wiring Application:**

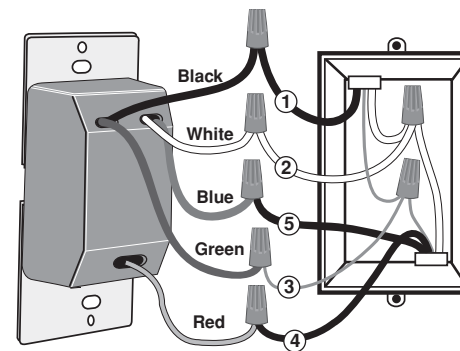

2 Scene Controller with Switches

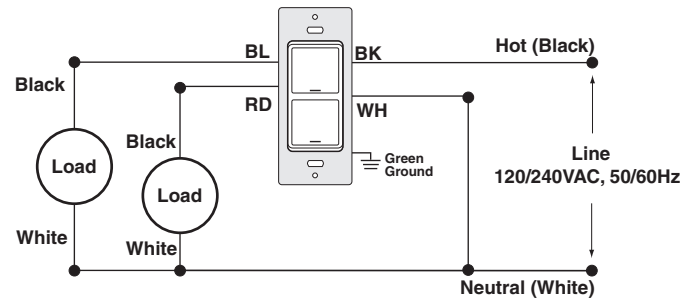

WIRING COMBO 2-SCENE CONTROLLER WITH SWITCHES:

Connect wires per WIRING DIAGRAM as follows:

- Green or bare copper wire in wall box to Green switch lead.
- Line Hot wall box wire to Black switch lead.
- Line Neutral wall box wire to White dimmer lead.
- Load 1 wall box wire to Red switch lead.
- Load 2 wall box wire to Blue switch lead.
- **Proceed to Step 5.**

Step 5 **Testing your Switch prior to mounting in wall box:**

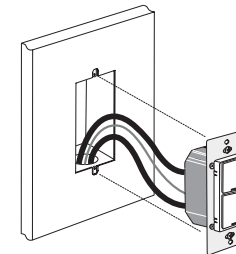

- Position all wires to provide room in outlet wall box for device.
 - Ensure that the word "TOP" is facing up on device strap.
 - Partially screw in mounting screws in wall box mounting holes.
- NOTE:** Dress wires with a bend as shown in diagram in order to relieve stress when mounting device.

- Restore power at circuit breaker or fuse.
 - Press pad until locator light is OFF. Lights should turn ON.
- If lights do not turn ON, refer to the TROUBLESHOOTING section.**

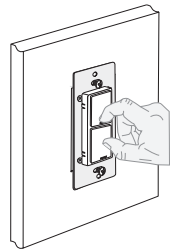

Step 6 **Switch Mounting: TURN OFF POWER AT CIRCUIT BREAKER OR FUSE.**

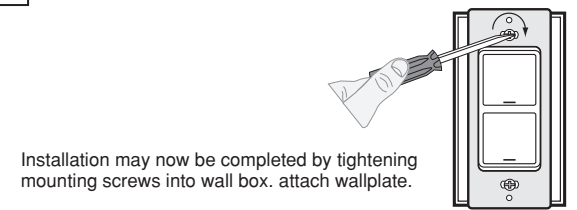

Installation may now be completed by tightening mounting screws into wall box. attach wallplate.

Step 7 **Restore Power:** Restore power at circuit breaker or fuse. **Installation is complete.**

Step 8 Including 2-Scene Controller with Switches into Z-Wave® Network:

NOTES:

- If using a non-Leviton Programmer/Controller, refer to the Programmer/Controller instruction sheet for Including a device.
 - Controllers included into a Z-Wave network must be updated after you have included all other devices
 - If using VRCPG install checklist go directly to step B.
- A)** Follow These steps for Leviton Vizia RF+ Programmer/Controller, Cat. No. VRCPG, press the Menu button and scroll down to System. Press the center button to select System Menu. Choose Advanced Settings. Press the center button to select Advanced Install. Press the center button to select <Include Node>
- B)** You will be prompted to place 2-Scene controller into programming mode.
- C)** To access Program mode press and hold buttons 1 and 2. Wait approximately 5 seconds until the LED turns Amber. Release the buttons and the LEDs will blink Amber. You are now in programming mode.
NOTE: If the LED on the 2-Scene Controller turns solid Red while including, there has been a communication error.
- D)** While standing close to the 2-Scene Controller with switch (approximately 1 foot), press the center button on the Programmer/Remote to <Include> device into network.
NOTE: Only one device may be included at any time
- E)** The Primary Programmer/Controller will assign a Home ID and Node ID number for this device.
NOTE: This information will be stored in the Programmer/ Remote to be used for future reference.
NOTE: You may name or edit your device at this time.
- F)** The 2-Scene Controller is now installed in the network. If using Leviton VRCPG you will be automatically prompted to include load 1 and load 2, otherwise please proceed to **Step G)**. If you would like to use just as a controller press the "Back" button to proceed with installation.
- G)** Including Local Switches:
*Remain in Advanced Settings
*Press Center Button to select Include switch 1
*The Primary Programmer/Remote will assign a Node ID switch 1.
*You may name or edit the device at this time
NOTE: To include Load 2, repeat Step G using Button 2.
- H)** After all devices are included into the network, the controller must be updated. To update controller proceed as follows:
• If using a non-Leviton Programmer/Remote, refer to the Programmer/Remote instruction sheet for updating controller.

Step 8 cont'd

- If using Leviton Z-Wave® Programmer/Remote, Cat. No. VRCPG, press the Menu button and scroll down to System. Press the center button to select System Menu. Choose Advanced Settings. Press the center button to select Advanced Install. Select Update controller. Select your controller from the list. Press center Button to begin update. Update will start automatically. Stand within (1ft) of controller while updating Network topology.
- Wait until the VRCPG Programmer/Remote confirms completion. Update is done.
NOTE: If the 2-Scene controller with switches has been successfully Included in the network and the user tries to Include it again without first excluding it from the network, the node ID will remain the same.

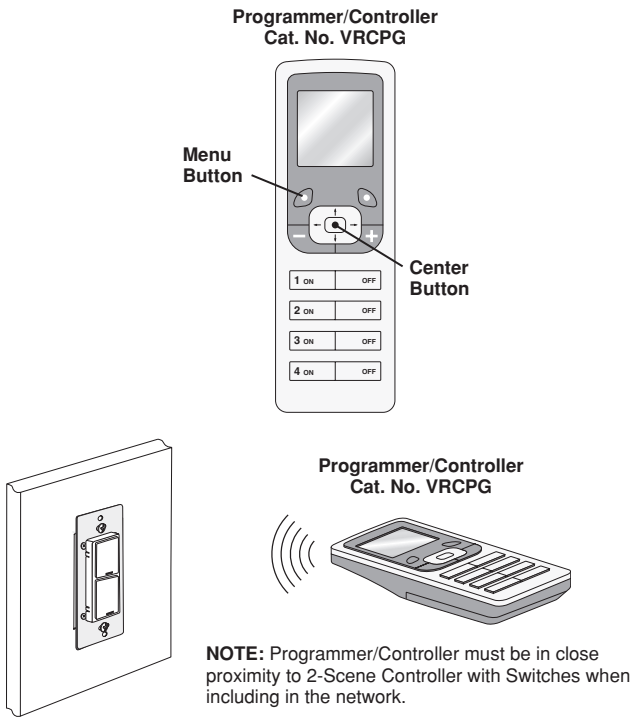

Step 9 Excluding 2-Scene Controller with Switches from Z-Wave® Network:

Excluding Load Control:

- A)** If using a Leviton Z-Wave® Programmer/Remote, Cat. No. VRCPG, press the Menu button and scroll down to System. Press the center button to select System Menu. Choose Advanced. Press the center button to select Advanced Install. Scroll down to <Exclude Node> and press the center button.

Step 9 cont'd

- B)** To Exclude, press button 1. Switch 1 will exclude from your network.
NOTE: If the LED on the Load control turns solid Red while excluding, there has been a communication error. Try excluding node again.
- C)** Repeat Steps above to exclude Load 2, pressing Button 2
- Excluding 2-Scene controller:**
- A)** If using a Leviton Z-Wave® Programmer/Remote, Cat. No. VRCPG, press the Menu button and scroll down to System. Press the center button to select System Menu. Choose Advanced. Press the center button to select Advanced Install. Scroll down to <Exclude Node> and press the center button.
- B)** If using VRCPG Programmer/Remote, you will be prompted to place 2-Scene controller into programming mode.
- C)** To access program mode, press and hold buttons 1 and 2 (refer to figure). Wait approximately 5 seconds until the LED turns Amber. Release the buttons and the LED will blink Amber. You are now ready to exclude.
NOTE: If the LED on the 2-Scene controller turns solid Red while excluding, there has been a communication error.
- D)** While standing close to the 2-Scene controller (approximately 1 ft.), press the center button on the Programmer/Remote to <Exclude> device from the network.

Factory Default:

If your 2-Scene controller with switch is not responding, or you are unable to control it after you have tried to Include/Exclude it multiple times, it may be necessary to reset the 2-Scene controller with switch to its original factory settings. To accomplish this, proceed as follows:

- On the 2-Scene controller with switch (refer to figure), press and hold buttons 1 and 2. Wait approximately 10 seconds until the LED turns Amber and then turns solid Red. Allow LED's to blink red twice, release the buttons. The 2-Scene controller with switches is now reset. Once the controller is reset, it will be necessary to Re-Include it to a network before it can be used.

CAUTION: SETTING A DEVICE TO A FACTORY DEFAULT DOES NOT EXCLUDE THAT DEVICE FROM A NETWORK. THE EXCLUSION PROCEDURE MUST STILL BE FOLLOWED TO REMOVE THE DEVICE FROM THE PRIMARY CONTROLLER'S INFORMATION TABLE. FAILURE TO DO SO MAY RESULT IN SYSTEM THAT IS SLOW TO RESPOND, OR MAY FAIL TO RESPOND TO SOME DEVICES.

Step 10 Device Association:

After inclusion process, you may associate Vizia RF + light switches, to buttons on the controllers. Refer to the Primary Programmer/Remote instruction sheet for complete details.
NOTE: This step requires a controller that can create association lists to specific groups.
NOTE: If using a non-Leviton Programmer/Remote, refer to the Programmer/Remote instruction sheet for associating a Vizia RF+ light switch.

OPERATION

NOTE: The locator light will illuminate when the load is in the OFF position to facilitate access in the dark.

Push Pad (Default settings)

Turn ON from OFF position:
Tap – Lights turn ON.

Turn OFF from ON position:
Tap – Lights turn OFF.

If there is a power outage, when the power is restored, the lights will return to the last setting before the power interruption.

Cleaning: Clean with a damp cloth. **DO NOT** use chemical cleaners.

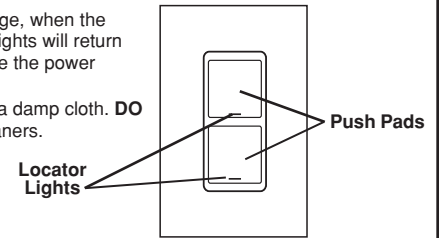

TROUBLESHOOTING

- Lights Flickering**
 - Lamp has a bad connection.
 - Wires not secured firmly with wire connectors of switch.
- Light does not turn ON and Locator LED does not turn ON**
 - Circuit breaker or fuse has tripped.
 - Lamp is burned out.
 - Lamp Neutral connection is not wired.

For additional information, contact Leviton's Techline at 1-800-824-3005 or visit Leviton's website at www.viziarfplus.com

Protected under U.S. Patent Number 6,388,399 and patents pending and licensed under U.S. Patents Numbers 5,905,442, and 5,982,103

FCC COMPLIANCE STATEMENT:

This device complies with Part 15 of the FCC Rules. Operation is subject to following two conditions: (1) this device may not cause harmful interference, and (2) this device must accept any interference received, including interference that may cause undesired operation of the device.

This equipment has been tested and found to comply with the limits for a Class B Digital Device, pursuant to Part 15 of the FCC Rules. These limits are designed to provide reasonable protection against harmful interference in a residential installation. This equipment generates, uses, and can radiate radio frequency energy and, if not installed and used in accordance with the instructions, may cause harmful interference to radio communications. However, there is no guarantee that interference will not occur in a particular installation. If this equipment does cause harmful interference to radio or television reception, which can be determined by turning the equipment OFF and ON, the user is encouraged to try to correct the interference by one or more of the following measures:

- Reorient or relocate the receiving Antenna.
- Increase the separation between the equipment and the receiver.
- Connect the equipment into an outlet on a circuit different from that to which the receiver is connected.
- Consult the dealer or an experienced radio/tv technician for help.

FCC CAUTION: Any changes or modifications not expressly approved by Leviton Manufacturing Co., Inc., could void the user's authority to operate the equipment.

LIMITED 5 YEAR WARRANTY AND EXCLUSIONS

Leviton warrants to the original consumer purchaser and not for the benefit of anyone else that this product at the time of its sale by Leviton is free of defects in materials and workmanship under normal and proper use for five years from the purchase date. Leviton's only obligation is to correct such defects by repair or replacement, at its option, if within such five year period the product is returned prepaid, with proof of purchase date, and a description of the problem to **Leviton Manufacturing Co., Inc., Att: Quality Assurance Department, 201 North Service Road, Melville, N.Y. 11747**. This warranty excludes and there is disclaimed liability for labor for removal of this product or reinstallation. This warranty is void if this product is installed improperly or in an improper environment, overloaded, misused, opened, abused, or altered in any manner, or is not used under normal operating conditions or not in accordance with any labels or instructions. **There are no other or implied warranties of any kind, including merchantability and fitness for a particular purpose**, but if any implied warranty is required by the applicable jurisdiction, the duration of any such implied warranty, including merchantability and fitness for a particular purpose, is limited to five years. **Leviton is not liable for incidental, indirect, special, or consequential damages, including without limitation, damage to, or loss of use of, any equipment, lost sales or profits or delay or failure to perform this warranty obligation.** The remedies provided herein are the exclusive remedies under this warranty, whether based on contract, tort or otherwise.