

ZAGG®

ORIGIN™

THE NEW MOBILITY OF SOUND

USER MANUAL

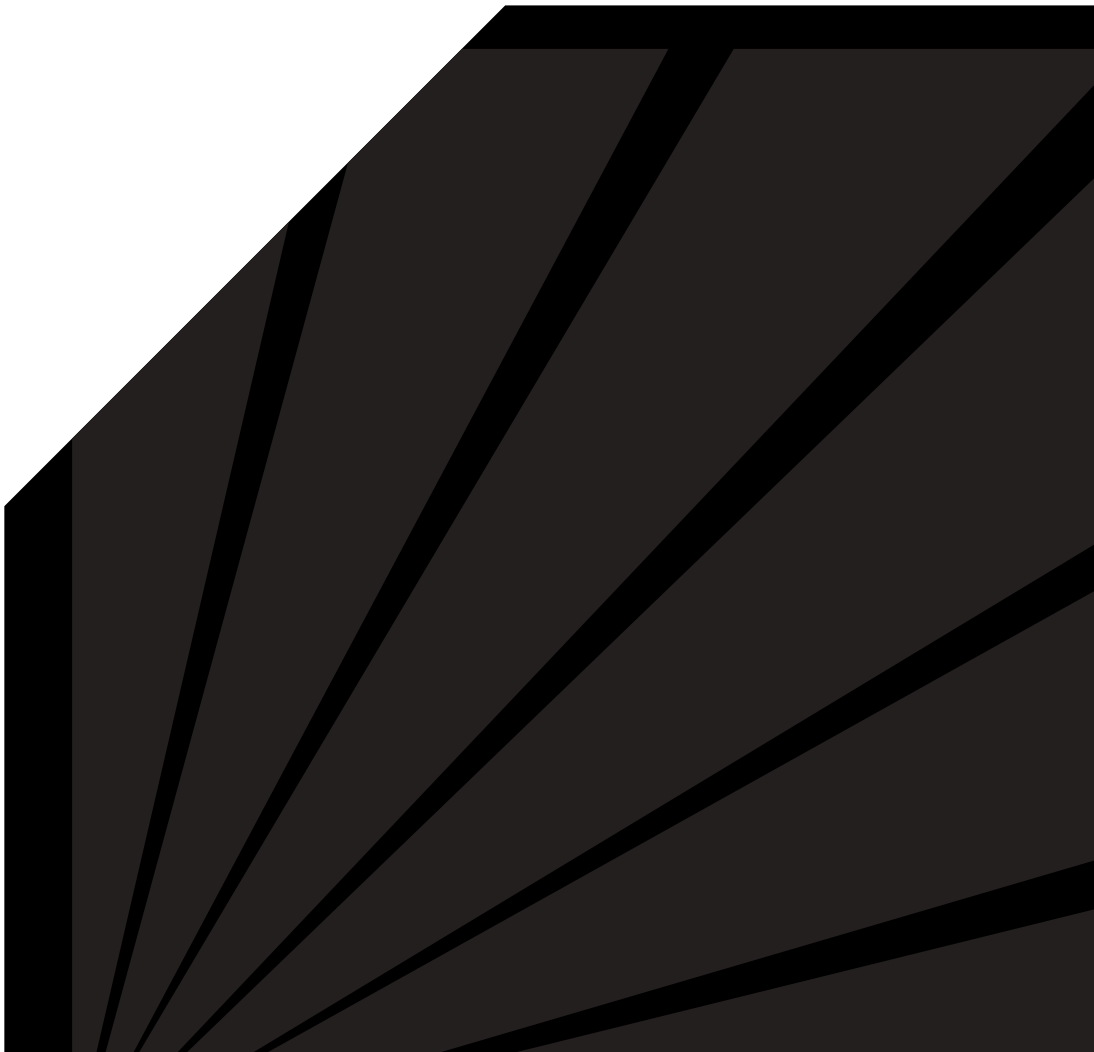

INTRODUCTION

Congratulations on being the proud new owner of the latest innovation in portable and home speaker technology. The ZAGG® Origin™ does what no other speaker system can – it gives you full-bodied sound, everywhere you go, with no cables and no wires. The wireless, Bluetooth®-enabled speaker gives you party-quality sound wherever you want it. The desktop speaker rocks any room lucky enough to have it. Dock the portable speaker into the desktop speaker and enjoy music Nirvana as the two speakers combine in a transcendent audio experience. So leave the tangled connections of the 2000s home and embrace the future. From now on, Origin is all you need to enjoy your music anytime, anywhere.

To get the most from the full range of benefits Origin delivers, follow the directions in this handbook. Then, when you're ready, fire it up and let Origin bring your music to life like never before.

REGISTER YOUR ORIGIN

Before you begin enjoying your Origin, please take a moment to register it. Simply direct your internet browser to **www.zagg.com/register** and complete the form there. By registering, you can easily stay up to date on all our special offers, discounts, and promotions as well as track your ZAGG purchases in one convenient location. Your Origin is automatically registered if you purchased it from **www.zagg.com**.

PAGE 1

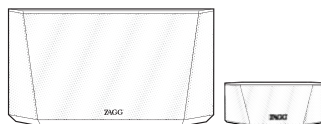

You are about to experience a sound revolution. But before that revolution can start, make sure you have all of the following pieces for it:

- Instruction manual
- Desktop speaker
- Portable speaker
- Remote
- 3.5mm AUX cable
- Micro USB cable
- Power adapter

As you verify each piece, take a moment to familiarize yourself with its features.

ORIGIN DESKTOP SPEAKER

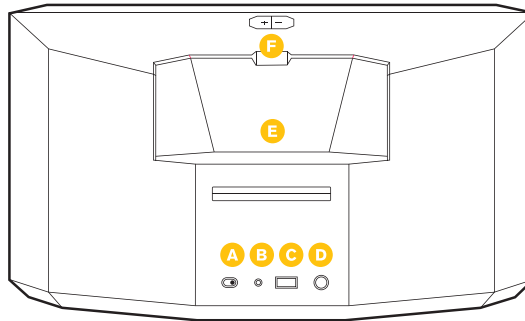

A ON/OFF: Use this switch to turn the Origin desktop speaker on or off.

NOTE: When playing music using the AUX connection, the Play/Pause and Prev/Next buttons on the Origin become inactive. Use the Play/Pause and Prev/Next features on the device you have plugged in.

NOTE: When the Origin portable speaker is connected using both the AUX and Bluetooth® options, music coming in through the AUX line will play by default. To use the Bluetooth® connection, simply unplug the AUX line. If the desktop speaker is playing music via the AUX in and the portable speaker is playing via Bluetooth®, when the portable speaker is docked the complete unit will, by default, play music via the Bluetooth® connection.

B AUX: Use this to connect any music player that uses a 3.5mm jack to the Origin. When connected, Origin will play your music in high fidelity stereophonic sound.

C USB OUT: Use this power out jack to connect your phone, tablet, or other device to Origin to charge the device. This lets you use your device without depleting its power supply. Even if you are not using your device to play music, you can charge it through Origin while enjoying your music.

D DC 16V: Use this jack to connect your power adapter.

E CONTACT PLATE: Use these powerful magnets to dock the portable speaker to the desktop speaker.

F VOLUME UP/DOWN: Use the + button to increase Origin's volume. Use the - button to decrease Origin's volume. When you have increased or decreased Origin's volume to its maximum or minimum level, the LED lights will flash twice indicating the volume cannot be adjusted further in that direction.

WARNING – Overexposure to loud sounds may cause permanent damage to your hearing. Use sound judgment when increasing the volume of your music.

ORIGIN PORTABLE SPEAKER

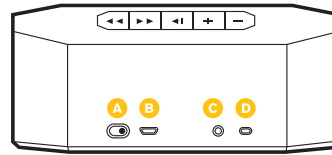

A ON/OFF: Use this switch to turn the Origin portable speaker on or off. Each time you turn it on, Origin will sound a welcome tone. Each time you turn it off, Origin will sound a goodbye tone.

NOTE: The Origin portable speaker can work independently of the desktop speaker, even if the desktop speaker is turned off. However, the desktop speaker will not charge the portable speaker unless the desktop speaker is turned on and the portable speaker is properly docked.

B MICRO USB IN: Use this port to charge your portable speaker when it is not docked to the desktop speaker.

C AUX IN: Use this jack to connect your phone, tablet or other music device to Origin's portable speaker via the included 3.5mm AUX cable.

D BLUETOOTH®: Press this to pair with your Bluetooth®-enabled music device. When the speaker pairs, you will hear a confirmation tone.

QUICK START

Origin is ready to start playing music right out of the box. This section will show you how to use Origin to begin enjoying your music quickly. For more in-depth directions please refer to the Enjoying Your Origin section.

- 1 Remove the Origin desktop and portable speakers from the box.
- 2 Dock the portable speaker to the desktop speaker using the magnetic prongs on the back of the desktop speaker.
- 3 Remove the power adapter and connect it to the desktop speaker using the DC 16V jack. Plug the power adapter into a wall outlet.
- 4 Turn the Origin on using the ON/OFF switch. You will hear a welcome tone to indicate the power is on.
- 5 Make sure your Bluetooth® connection is enabled on your music device.
- 6 Press the Bluetooth® button found on the back of the portable speaker. When Origin has connected to your device, you will hear a tone (this may take several seconds). You can check your device's Bluetooth® manager to verify the Origin is connected.

NOTE: Because the portable speaker has not yet charged, you will need to keep it docked for this process.

- 7 Press the Play button on the portable speaker and begin enjoying rich, room-filling sound. Adjust the volume using the + and - buttons found on the top of the desktop speaker.

WARNING – Overexposure to loud sounds may cause permanent damage to your hearing. Use sound judgment when increasing the volume of your music.



THE PERKS OF OWNING AN ORIGIN

By purchasing an Origin, you have proven that you have a discerning ear when it comes to enjoying music the way it is supposed to be enjoyed. The Origin is one of the most portable and powerful wireless speakers available, but did you know it is also ideal for managing hands-free conference calls? Read on to learn more about this and other ways you can benefit from Origin that you may not have known about.

THE ORIGIN

Good things come in twos: salt and pepper, hugs and kisses, cake and ice cream, and the Origin portable and desktop speakers. Used together, these two speakers bring you more than an amazing sound system; they bring you the future of wireless audio. You can enjoy the following benefits when the portable speaker is docked with the desktop speaker:

- ▶ **Ultimate Flexibility** – The Origin features a removable Bluetooth® speaker that provides clear sound wherever you go. The portable speaker docks with the desktop speaker to give you booming sound that brings life to any room. You can also use the Bluetooth® connection with your phone to enjoy hands-free conference calls.

NOTE: You can use your cell phone, the Play/Pause button on the portable speaker, or the remote's Play/Pause button to answer calls via Bluetooth. Use your phone or the Play/Pause button on either the portable speaker or the remote to disconnect the conference call.

- ▶ **Superior and Powerful Sound Quality** – The Origin features a bass-pumping, four-inch subwoofer that combines with two sleek, midrange speakers and two crisp tweeters to give you a full, dynamic sound at any volume. Preserve

the integrity of your music no matter how loud you play it.

■ **Universal Compatibility** – The Origin communicates with your music player via Bluetooth®. This means you can play your music from virtually any system including: iOS®, Android®, OSX®, Windows® and other Bluetooth®-enabled devices.

■ **Remote Control** – Origin comes with a remote control that allows you to adjust volume, bass, treble, and other aspects of your music. The remote works up to 30 feet (8 meters) away.

■ **USB Charging Port** – Use Origin's 2.1A output charging port to quickly charge most USB-charged devices.

■ **3.5mm AUX Jack** – Have a device that is not Bluetooth®-enabled? No problem! The Origin has a convenient 3.5mm jack you can use to plug and play.

ORIGIN'S PORTABLE SPEAKER

Enjoying a crisp, clear sound while on the go is just one of the benefits of Origin's portable speaker. Here are some other things you'll enjoy:

■ **Versatility** – The portable speaker operates via Bluetooth®, so there is no need for annoying cables. Just grab the speaker, pair your device, and enjoy big sound anywhere you want.

■ **3.5mm AUX Jack** – There if you need it, the 3.5mm jack lets you connect and enjoy any music device.

■ **Light and Compact** – You don't have to worry about the portable speaker getting in the way when you're on the move. It's so small and light, you'll barely notice it's there – until it starts the party.

■ **Long Lasting** – The portable speaker's internal lithium ion rechargeable battery provides you hours of music enjoyment. But if you need it, you can use the micro USB jack to plug it in for continuous power.

ORIGIN'S DESKTOP SPEAKER

The desktop speaker can work alone or with the portable speaker docked. Either way, you can enjoy full, room-filling music anytime you want. Here are some other benefits of the desktop speaker:

■ **Superior Sound** – A strong four-inch woofer, two clear midrange speakers, and two crisp tweeters provide a full sound that will bring the party to any room.

■ **3.5mm AUX Jack** – Connect any music device and enjoy clear, resonant music free of annoying speaker static.

NOTE: The desktop speaker is not Bluetooth®-enabled. To use it on its own you need to connect a music device via the 3.5mm jack.

■ **USB Charging Port** – Charge your music device, or any other device, while enjoying your music. Featuring a 2.1A output, the desktop speaker can quickly and efficiently charge any gadget you like, and you won't even have to interrupt your music.

■ **Remote Control** – Change songs, adjust the treble or bass, turn the volume up or down, and other actions without touching the Origin. When we say wireless, we mean wireless.

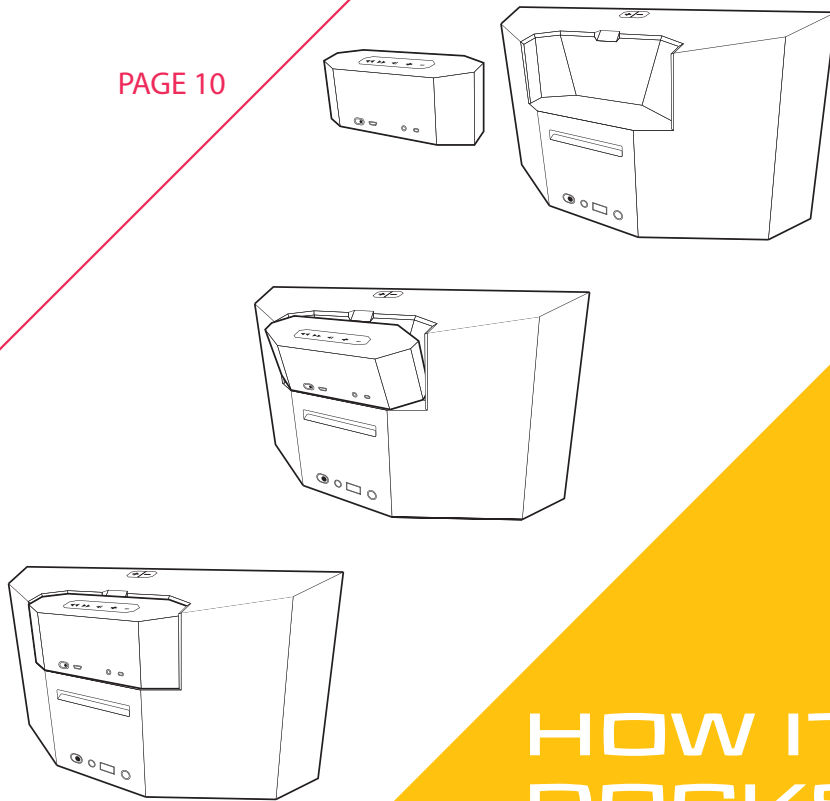

HOW IT DOCKS

ENJOYING YOUR ORIGIN

The Origin portable speaker system lets you enjoy excellent sound on the go, or at home. Its versatility is in the Bluetooth®-enabled portable speaker that gives you crisp music wherever you are and the powerful desktop speaker that provides full-bodied sound to any room. The speakers can be used together or individually depending on your needs. This section teaches you how to use Origin to enjoy your music no matter where you find yourself.

Here's how to transform your music experience using the desktop speaker:

- 1 Remove all contents of the box and verify that you have all the pieces you'll need to enjoy your music. For a list of contents, see the Meet Your Origin section of this manual.
- 2 Dock the portable speaker using the magnetic prongs on the back of the desktop speaker.
- 3 Connect your power adapter using the DC 16V jack. Plug the power adapter into a wall outlet. For more information on how to place your Origin, see the Maximize Your Origin section.
- 4 Turn both the desktop and portable speakers on using their respective power switches. Green indicates the power is on, red indicates the power is off. You will hear a welcome tone indicating the power is on.
 - ▶ Turning both speakers on allows the portable speaker's internal battery to charge, but it also allows you to begin listening to music using the desktop speaker or to charge your device using the USB Out jack.
 - ▶ You can enjoy your music from the desktop speaker while waiting for the portable speaker to charge. To do this, simply

plug your music device into the desktop speaker using the 3.5mm jack and begin playing music according to your device's instructions. Make sure to adjust the volume on your Origin to a comfortable level.

NOTE: You can adjust the volume using your music device; however, we recommend you use your music device at about 75% its maximum volume and control the volume via the volume button on the speaker.

- 5 While waiting for the portable speaker to charge, connect your music device using the 3.5mm jack.

NOTE: The desktop speaker is not Bluetooth®-enabled; therefore, you cannot use a Bluetooth® connection to play your music without the portable speaker or when the portable speaker is not charged.

▶ In order to use the Bluetooth® connection to play your music, the portable speaker needs to carry about a 10% capacity charge. This equals about ten minutes of charging when the portable speaker is docked to the desktop, both speakers' power switches are turned on, and the desktop speaker is plugged into a wall outlet.

▶ The portable speaker needs about eight hours to fully charge.

- 6 Adjust the volume as necessary and enjoy your music.

USING THE PORTABLE SPEAKER

- 1 Follow steps 1-4 above.

NOTE: The portable speaker requires about eight hours to fully charge.

- 2 Press the Bluetooth® button on the back of the portable speaker.

▶ When the speaker pairs with your device, you will hear a short confirmation tone.

- 3 Press the Play button on the portable speaker and begin enjoying a new revolution in portable sound.

To use the Bluetooth® capabilities of the portable speaker with the desktop speaker, simply dock the portable speaker after it has connected to your music device. After a brief pause your music will begin playing wirelessly through the desktop speaker.

NOTE: Because the desktop speaker is not Bluetooth®-enabled, you must use the docked portable speaker with it in order to enjoy your music wirelessly.

CHARGING YOUR ORIGIN

Enjoy your music anytime, anywhere with your Origin portable speaker. Follow these steps to charge it so your music can move with you.

- 1 Dock the portable speaker to the desktop speaker.
- 2 Connect the power adapter to the desktop speaker. Plug the power adapter into a wall outlet.
- 3 Turn both speakers on. You will hear a welcome tone when they power on.
- 4 Leave the portable speaker docked for approximately five hours. This will give it sufficient time to charge.

NOTE: You may also choose to charge your portable speaker via a micro USB cable.

- 5 Remove the portable speaker and begin enjoying the best in wireless music.

Note: You can check your speaker's battery level by pressing the Play/Pause button for three seconds. If lights flash four times the battery level is 76-100% full, 3 times 51-75%, 2 times 26-50%, 1 time 25% or less.

REMOTE CONTROL

PAGE 14

MUTE: Mute your Origin at any time by pressing this button. Simply press it again to resume listening.

VOLUME UP (+): Increase the volume to your desired level.

VOLUME DOWN (-): Decrease the volume to your desired level.

SKIP (⏮ ⏭): Use the forward button to skip forward in your playlist. Use the back button to restart the song currently playing. Press the back button twice to skip back a song on your playlist.

PLAY/PAUSE (⏪ ⏩): Press once to begin playing your music. While your music is playing, press this button again to pause it. To resume your paused music, press once more.

BASS: Adjust the bass to your preferred level. You can press the center of this button to restore the default bass setting.

TREB: Adjust the treble to your preferred level. You can press the center of this button to restore the default treble setting.

SOURCE: Switch between Bluetooth® and AUX input.

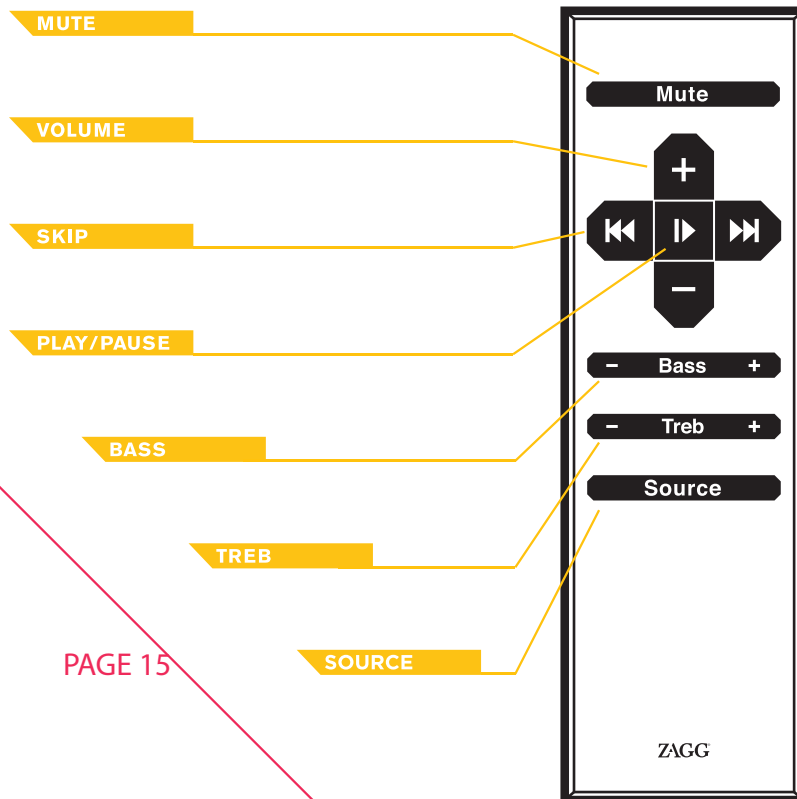

PAGE 15

MAXIMIZE YOUR ORIGIN

PAGE 16

The Origin produces amazing sound wherever it is; however, each space is different. Use the following tips to maximize your Origin's production.

- 1 Recognize that the layout of the room will affect how well the sound resonates in the room. Couches, drapes and flooring may dampen or enhance certain sounds. Play around with the placement of your Origin to find a place that makes the best sound for your ears.
- 2 Consider walls and corners. The distance between your origin and the nearest wall will impact the sound. Placing it closer to a wall will enhance the bass, while placing it in the middle of a room will dampen the bass. Similarly, corners will help amplify the bass and reduce the high and midrange sounds. Change the placement of your Origin to see what works best for your room.
- 3 Know your surface. Because the Origin provides such a deep bass it can cause the surface it sits on to vibrate. Avoid surfaces that rattle or ones that hold fragile items.
- 4 High or low? Ideally you will be able to place your Origin at about ear level. Placing it in very high or low points in the room will affect your sound quality. Especially avoid placing the Origin high on a shelf or bookcase as you will lose sound quality when you sit close to, or under it. Optimal sound production is achieved when the Origin is at ear level approximately five feet away.

WARNINGS

By owning an Origin, you are now a part of the ZAGG® family. We love our family and try to look out for them. Please help us take care of you by following these safety rules.

- 1 Don't expose your Origin, or any of its individual parts, to water. As nice as it would be to listen to some soothing music in the bath, don't do it. And while singing in the rain is a fun idea, please do it acapella, without your Origin in the rain.
- 2 Don't use your Origin close to heat sources. The Origin is a cool, powerful product, but not cool or powerful enough to withstand prolonged exposure to heat. So don't place it near fires, radiators, heat registers, and other heat sources.
- 3 Don't use your Origin as a shelf. Avoid placing anything on the Origin that could damage it. Drinks, candles, food, paint, putty, and other, similar items can easily be knocked over by the powerful bass, and if they fall onto your Origin, well, that just wouldn't be good.
- 4 Don't try to alter your Origin in any way. At ZAGG, we love our products almost as much as we love our customers. We put a lot of time and effort into making the most efficient and durable product possible. While we certainly understand your desire to see how your Origin produces such amazing sound, please don't open it, especially if it's plugged in. Many of the design features are strictly for fashion, but some are for your safety. Be safe, don't tinker.

PAGE 17

FCC NOTE

PAGE 18

- 1 This device may not cause harmful interference.

This device must accept any interference received, including interference that may cause undesired operation.

Specification

- 1 Model: ORIGIN
- 2 Power Output: 40W (Desktop speaker: 36W Portable speaker: 4W)
- 3 Driver unit:
Desktop speaker:
Treble: 1" 8Ω, 2PCS Full frequency: 2.5" 3.5Ω, 2PCS Bass: 4" 3.6Ω, 1PC
Portable speaker:
Full range: 1.5" 3Ω, 2PC
- 4 S/N Ratio: $\geq 65\text{dB}$
- 5 Sensitivity:
Desktop speaker : Treble:780MV \pm 50MV Bass:300MV \pm 50MV
Portable speaker:900MV \pm 50MV
- 6 Distortion: $\leq 0.3\%$ 1W 1KHz
- 7 R. Frequency: Desktop speaker: 20Hz~20KHz Portable speaker: 80Hz~15KHz
- 8 Power input: Desktop speaker: DC 16V Portable speaker: DC 5V
- 9 Dimensions:
Desktop speaker: W355.6×H198.5×D160.4 mm
Portable speaker: W156.7×H67.4×D46 mm

©2005 - 2012 ZAGG Inc All Rights Reserved
NASDAQ: ZAGG | Designed by ZAGG® in Utah
MADE IN CHINA | Patent Pending
Apple® and Mac® are trademarks of Apple, Inc.
Android™ is trademark of Google, Inc.
ZAGG® and Origin™ are trademarks of ZAGG IP Holding Co., Inc.
Bluetooth® is a trademark of Bluetooth SIG, Inc.

www.ZAGG.com

CE RoHS



PAGE 19

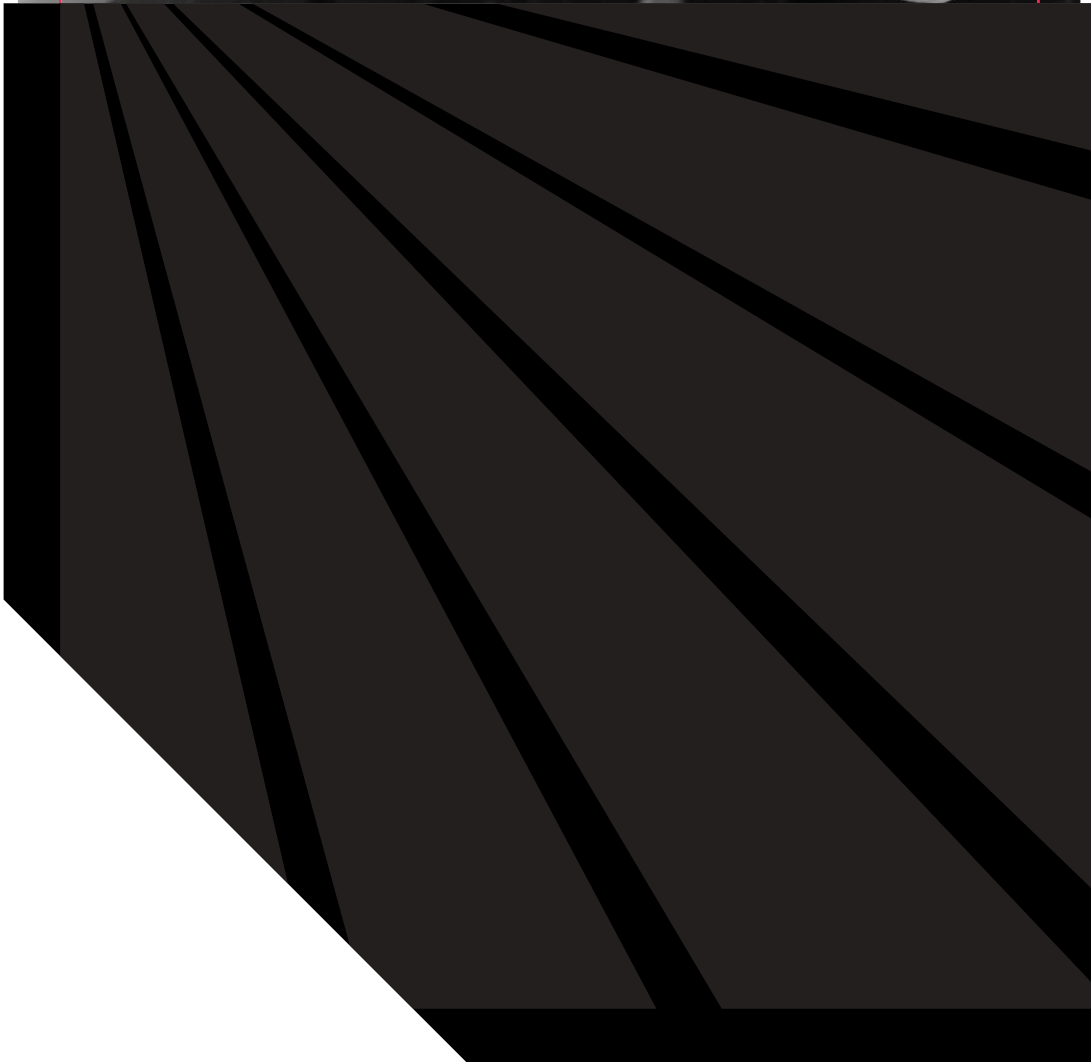

FCC Caution: Any changes or modifications not expressly approved by the party responsible for compliance could void the user's authority to operate this equipment.

This device complies with Part 15 of the FCC Rules. Operation is subject to the following two conditions: (1) This device may not cause harmful interference, and (2) this device must accept any interference received, including interference that may cause undesired operation.

FCC15.105: This equipment has been tested and found to comply with the limits for a Class B digital device, pursuant to Part 15 of the FCC Rules.

These limits are designed to provide reasonable protection against harmful interference in a residential installation. This equipment generates, uses and can radiate radiofrequency energy and, if not installed and used in accordance with the instructions, may cause harmful interference to radio communications. However, there is no guarantee that interference will not occur in a particular installation. If this equipment does cause harmful interference to radio or television reception, which can be determined by turning the equipment off and on, the user is encouraged to try to correct the interference by one or more of the following measures:

- Reorient or relocate the receiving antenna.
- Increase the separation between the equipment and receiver.
- Connect the equipment into an outlet on a circuit different from that to which the receiver is connected.
- Consult the dealer or an experienced radio/TV technician for help.