

TD169 Restaurant Pager Instructions

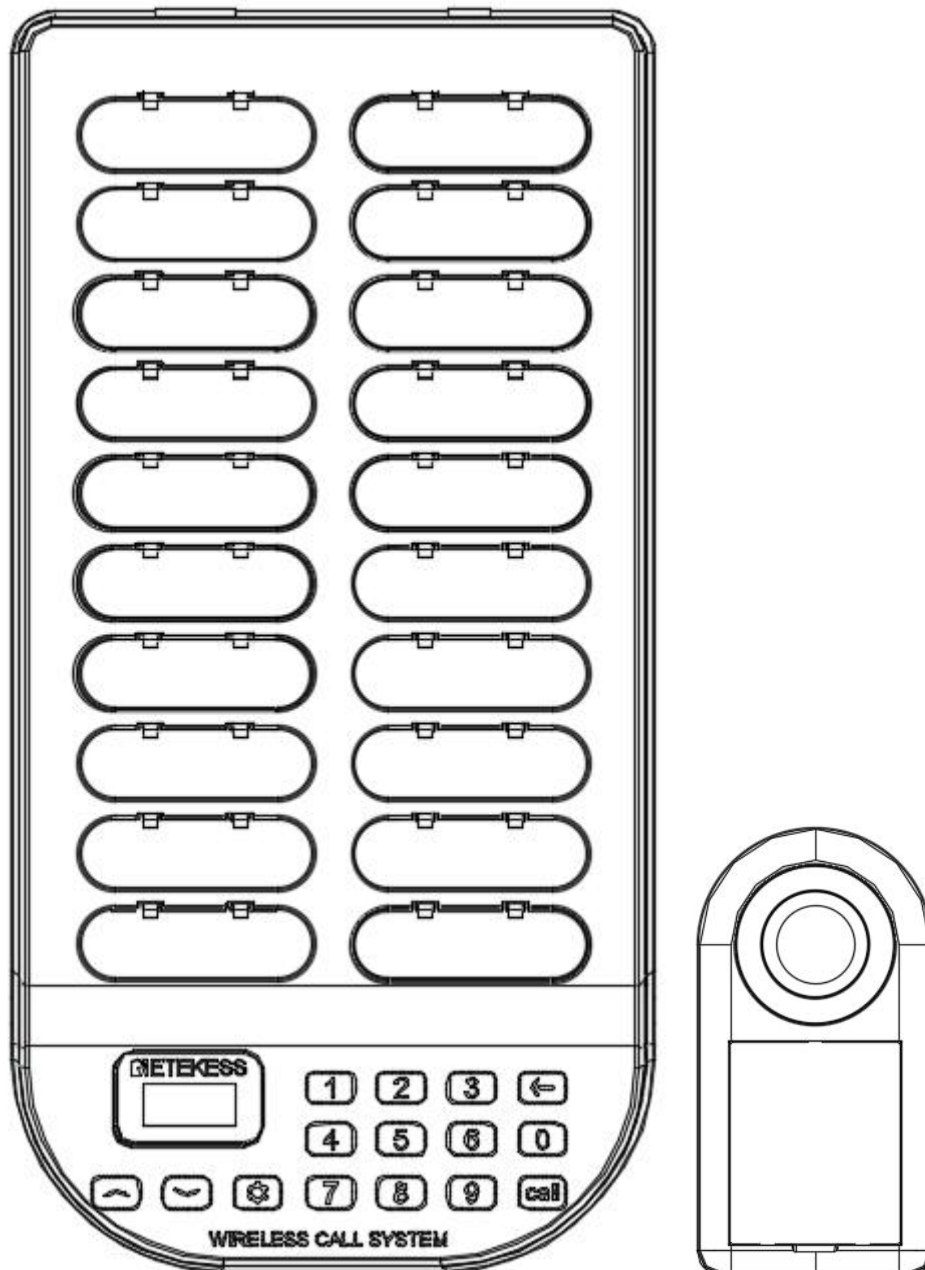

1. Product Introduction

1.1 Schematic diagram

1.1.2 Host diagram

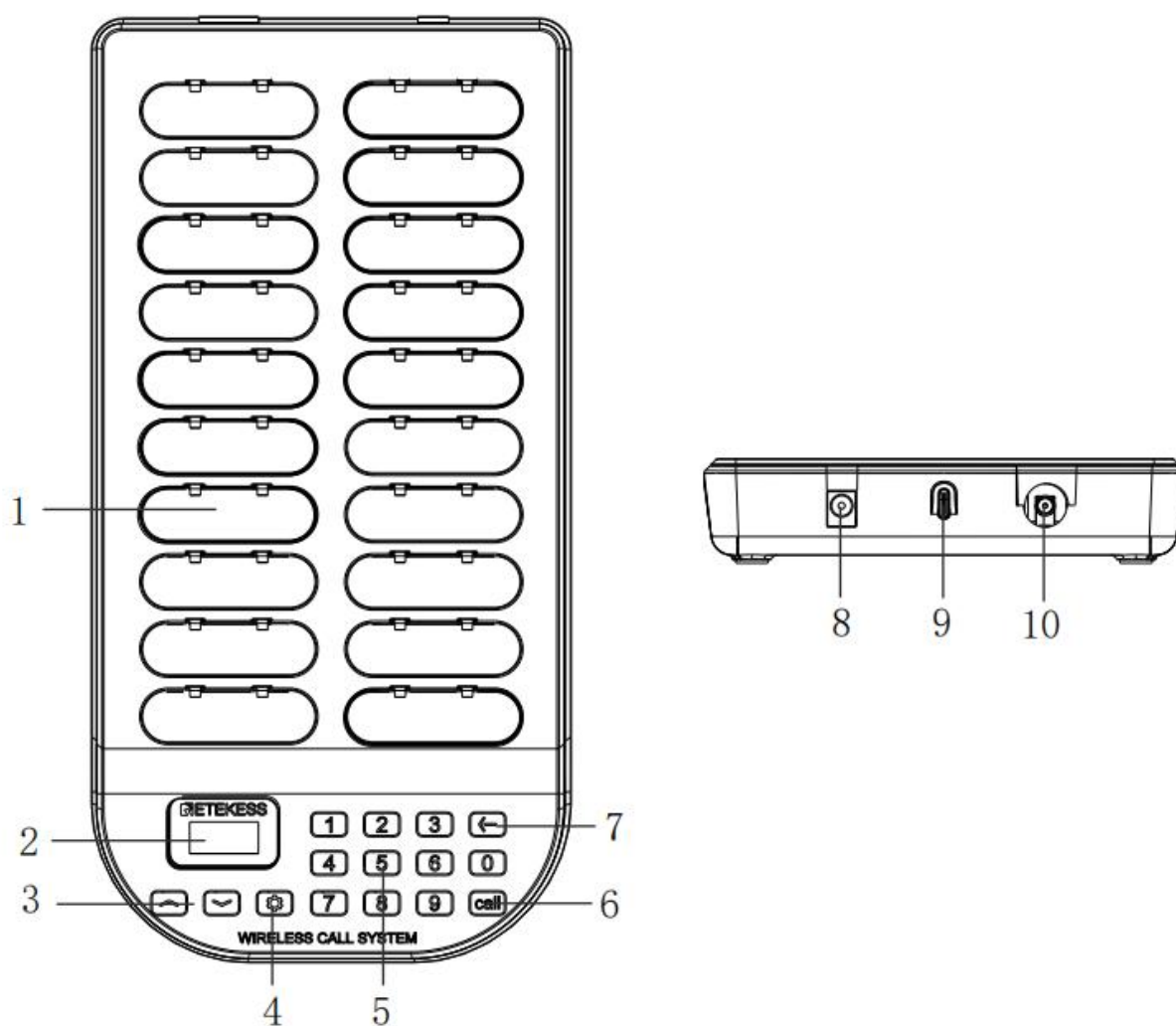

- 1: Pager charging slot
- 2: Digital tube display area
- 3: Up/down buttons
- 4: Setting button
- 5: Number key area 0 -9
- 6 : Call /Confirm button
- 7: Back/Delete button
- 8: DC power interface

9: Type C interface (connect to the host computer)

10: SMA antenna interface

1.1.3 Pager

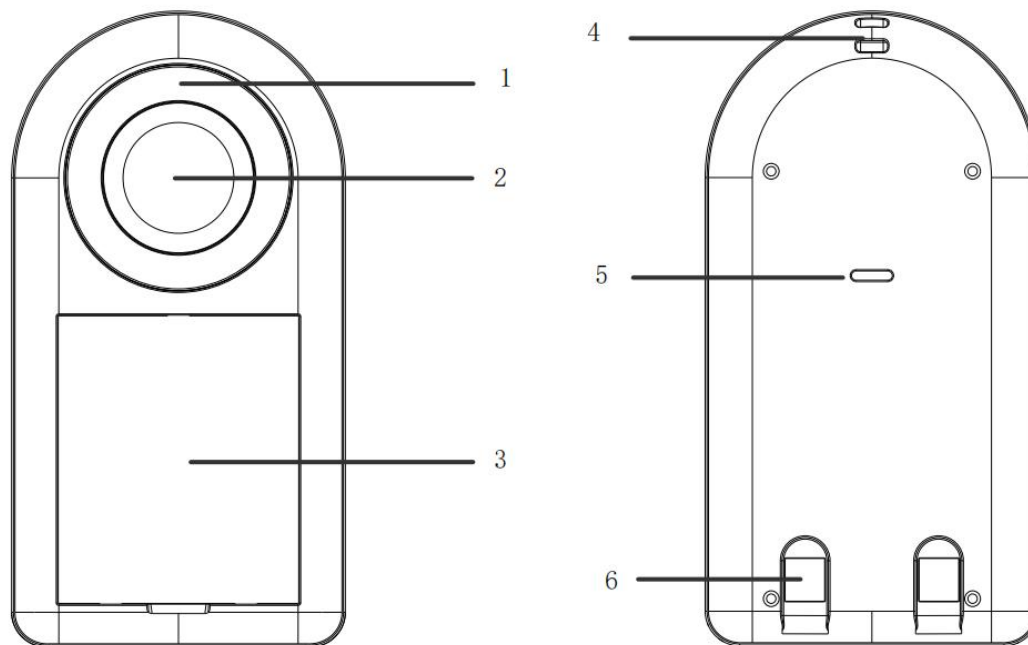

1: Ring indicator light (the indicator light status is described in the following table)

2: Mute button (can cancel call reminder)

3: Pager number sticker area

4: Lanyard port

5: Buzzer sound hole

6: Charging contacts

Light status display description table	
Charge	Flashing red light
full	Green light is always on
Standby	Green light flashing
call	Flashing red light

1.2 Specifications

1.2.1 Transmitter host

Material	ABS, Silicone
Surface treatment	Material sunburn
Host size	285x140x30mm
Host weight	406g
Modulation	OOK (AM)
Transmitting frequency	433.92Mhz
show	3-digit red digital tube
Input voltage	12v == 2A
stand-by current	<50mA
Transmit power	10mW Max.
interactive mode	Capacitive touch buttons
Button Definition	0--9 number keys, return key, call key, setting key, up and down keys
Charging slot	20
Communication distance	500M Max. (Open distance)
Configurable number of pagers	1-99 7

1.2.2 Pager

Pager size	100x53x15mm
Pager weight	52g
Modulation	OOK AM
Receiving frequency	433.92Mhz
Receiving sensitivity	-108dBm
Operating Voltage	3.7v
stand-by current	<12mA
Alarm current	12 0mA
Reminder method	Beep/Flash/Vibration

Battery	Built-in lithium battery 3.7V 300mA
Standby time	>24h
Communication distance	500M Max. (Open distance)
Volume	≥85db, adjustable in three levels: large, medium and small
Ringtone	7 types of single-step chord prompt tones Single-step chord prompt tones
Waterproof	IP67 waterproof

2. Preparation

Before use, the power cord of the transmitter host should be connected normally and the transmitting antenna should be installed correctly. If it is used for the first time, it is recommended to charge the pager for 15 minutes and then set the basic functions such as pager ID with the host before it can be used normally.

3. Function Introduction

3.1 Calling pager

The transmitter clicks the "number" key to enter the tray number to be called, and presses the "call" key to call.

Note: You can adjust the call number by pressing the "up and down" button

3.2 Group Call

Group call: Enter " 998 " using the numeric keys and press the "Call" button to call all pagers .

Pagers that are charged in the charging base and pagers without registered ID numbers cannot respond to group calls.

3.3Cancel call

When the pager is called, you can cancel the pager calling status by pressing the "Mute" button of the calling meal pager or putting it back into the charging base.

3.4 Shutdown

Place the pager in the charging base, input the number "999" into the host, click the " Call " button, and the pager in charging state will shut down.

Note: To use the "Power Off" function, the pager needs to be paired with the keyboard base first .

3.5 Startup

Place the pager in the charging base to turn on the device. If the pager is turned off and in the charging base, take it out and put it back in the base to turn it on.

4 Menu functions and settings

" Set " button on the transmitter host in the standby interface to enter the setting menu. The interface displays "F--". Click the "Up"/"Down" button or press the corresponding "number" key to select the corresponding setting option (for example, if you enter the number 1 and it displays F-1 , it is the F1 menu item; if you enter 1 1, it displays F11, which is the F11 menu item). Press the "Call" button to enter the corresponding menu function setting.

4.1 【 F1 】 Setting of pager ringtone

Select the "F1" menu to enter the pager ringtone setting, click the "up/down" key or use the "number" key to enter "1-7" to select a different ringtone, there are 7 ringtones to choose from. Click the "Call" key to save and return to the main menu, all pagers ringtones in the base will be set.

Note: To set the pager ring tone, make sure the pager has an ID set.

4.2 【 F2 】 Set the volume of the pager

Select the "F2" menu to enter the reminder volume setting , click the "Up/Down" key or use the "Number" key to enter "0 -3 " to select the sound volume (" 0: Off ; 1: Small ; 2: Medium ; 3: Large "). Then press the "Call" key to save and return to the main menu. The buzzer reminder volume of all the pagers in the base will be set .

Note: To set the volume of the pager , make sure the pager ID has been set.

4.3 【F3】 Pager vibration setting

Select the "F3" menu to enter the reminder vibration setting , click the "Up/Down" key or use the "Number" key to enter "0/1 " to select the vibration switch (" 0: Off ; 1 : On "), press the "Call" key to save and return to the main menu. The vibration switch of all pagers in the base will be set .

Note: To set the pager vibration, make sure the pager ID has been set.

4.4 【F4】 Setting of pager indicator light

Select the "F4" menu to enter the reminder light setting , click the "Up/Down" key or use the "Number" key to enter "0-3 " to select the reminder light mode (" 0: Off ; 1 : Slow flash ; 2 : Fast flash ; 3 : Breathing light mode "), press the "Call" key to save and return to the main menu. The reminder lights of all pagers in the base will be set.

Note: To set the reminder light, make sure the pager has an ID set.

4.5 【F5】 Pager countdown setting (0-999 minutes)

Select the "F5" menu to enter the countdown setting , press the "number" key to enter a number 0-999 (unit: minute, 0: off, 1-999 can set the time) to set the countdown for all pagers in the base , then press the "call" key to save and return to the main menu. The countdown for all pagers in the base will be set. After setting the pager countdown time, the countdown starts when the plate is taken out of the base. When the set time is reached , the pager will sound a reminder, and the alarm will stop when it is put back into the base .

Note: To set the countdown , make sure the pager has an ID set.

4.6 【F6】 Pager out of bounds alarm setting

Select the "F6" menu to enter the out-of-bounds alarm setting, click the "Up/Down" key or use the "Number" key to enter "0/1 " to set the out-of-bounds alarm function on or off (" 0 : Off; 1 : On"), press the "Call" key to save and return to the main menu. The out-of-bounds alarm switch for all pagers in the charging base will be set. After the out-of-bounds alarm function for the pager is turned on, the pager will issue a reminder after a certain period of time outside the communication range , and the alarm will stop when it is put back to the base.

Note: To set the out-of-bounds alarm, make sure the pager has an ID set. The activation time of the

out-of-bounds alarm is 4 minutes. If no signal is received from the host for 4 minutes (the host sends a signal every 50 seconds), the out-of-bounds alarm function will be triggered.

4.7 【F7】 Set the pager reminder duration (0-250 seconds)

Select the "F7" menu to enter the reminder duration setting, press the "number" key to enter " 0-250 (unit: seconds) or adjust the value by clicking the "up/down" key (setting to 0 means off), press the "call" key to save and return to the main menu. The reminder duration of all pagers in the base will be set.

Note: To set the reminder duration, make sure the pager has an ID set.

4.7 【F8】 Set pager ID number (1-99 7)

Select the "F8" menu to enter the ID number setting, press the "number" key to enter the pager number (1-9 9 7) , and after taking the pager out of the base, press the "call" key within 5 seconds (after the pager charging indicator goes out) , and the pager will make a " beep " sound to indicate that the setting is successful. Click the "delete" key to return to the main menu.

Note: 998 is used for group calling, 999 is used for powering off, these two numbers cannot be set as pager numbers.

4.9 【F9】 Host ID setting (1-99)

Select the "F9" menu to enter the host ID number setting, press the "number" key to enter "1-99" to set the host ID number, then press the "Call" key to save and return to the main menu, the host ID will be set successfully.

Note: If there is no special need, please do not modify the host ID, otherwise all pagers will need to reset the ID number before use.

4.10 【F10】 Host vibration setting

Select the "F10" menu to enter the host vibration function setting, click the "Up/Down" key or use the "Number" key to enter "0 / 1 " to set the vibration on or off (0: off , 1: on) and press the "Call" key to save and return to the main menu.

4.11 【F11】 Host buzzer setting

Select the "F11" menu to enter the host vibration function settings, click the "Up/Down" key or use the "Number" key to enter "0/1 " to select on or off (0: off, 1: on), press the "Call" key to save and return to the main menu

5. Notes

No response to pager call:

- 1, Make sure the pager ID has been set and paired with the keyboard base successfully , the pager reminder duration is not set to 0, the reminder sound is turned off, the vibration is turned off, and the reminder light is turned off.
- 2, The pager ID was not re-registered after the base ID was modified ; re-registering is required, and after completing the F function setting, please call again to confirm.

The pager function setting does not take effect

- 1, The pager was not in the charging base when the function was set up ; please put the pager in the charging base before setting up the function.
- 2, The pager ID was not registered before the function was set up . Please complete this setting and try again.

1 . CAUTION

RF ENERGY EXPOSURE AND PRODUCT SAFETY GUIDE

Before using this device, please read this guide which contains important operating instructions for safe usage, control information and operational instructions for compliance with RF Energy Exposure limits in applicable national and international standards.

User ' instructions should accompany the device when transferred to other users.

2. Unauthorized modification and adjustment

Changes or modifications not expressly approved by the party responsible for compliance may void the user's authority granted by the local government radio management departments to operate this radio and should not be made. To comply with the corresponding requirements, transmitter adjustments should be made only by or under the supervision of a person certified as technically qualified to perform transmitter maintenance and repairs in the private land mobile and fixed services as certified by an organization representative of the user of those services. Replacement of any transmitter component (crystal, semiconductor, etc.) not authorized by the local government radio management departments equipment authorization for this radio could violate the rules.

3.1 US FCC requirements

3.1.2 This device complies with part 15 of the FCC Rules. Operation is subject to the following two conditions:

- (1) This device may not cause harmful interference .
- (2) His device must accept any interference received, including interference that may cause undesired operation.

3.1.3 Note: This equipment has been tested and found to comply with the limits for a Class B digital device. These limits are designed to provide reasonable protection against harmful interference in a residential installation. This equipment generates, uses and can radiate radio frequency energy and, if not installed and used in accordance with the instructions, may cause harmful interference to radio communications. However, there is no guarantee that interference will not occur in a particular installation. If this equipment does cause harmful interference to radio or television reception, which can be determined by turning the equipment off and on, the user is encouraged to try to correct the interference by one or more of the following measures:

- Reorient or relocate the receiving antenna.
- Increase the separation between the equipment and receiver.
- Connect the equipment into an outlet on a circuit different from that to which the receiver is connected.
- Consult the dealer or an experienced radio/TV technician for help.

3.2 Canadian IC Requirements

3.2.1 Licence-exempt radio apparatus

EN: This device contains licence-exempt transmitter(s)/receiver(s) that comply with Innovation, Science and Economic Development Canada's licence-exempt RSS(s). Operation is subject to the following two conditions:

- (1) This device may not cause interference.
- (2) This device must accept any interference, including interference that may cause undesired operation of the device.

3.2.2 Detachable antenna

This radio transmitter has been approved by Innovation, Science and Economic Development Canada to operate with the antenna types listed below, with the maximum permissible gain indicated. Antenna types not included in this list that have a gain greater than the maximum gain indicated for any type listed are strictly prohibited for use with this device.

4 European CE requirements

4.1 Simple EU declaration of conformity

• HENAN ESHOW ELECTRONIC COMMERCE CO., LTD declares that the radio equipment type is in compliance with the essential requirements and other relevant provisions of RED Directive 2014/53/EU and the ROHS Directive 2011/65/EU and the WEEE Directive 2012/19/EU ; the full text of the EU declaration of

※※※※ The copyright of this material belongs to Shenzhen Ruitweisi Technology Co. , Ltd. Without authorization, copying or dissemination is prohibited ※※※※

conformity is available at the following internet address: www.retekess.com.

5.1 Disposal



The crossed-out wheeled-bin symbol on your product, literature, or packaging reminds you that all electrical and electronic products, batteries, or accumulators must be taken to designated collection locations at the end of their working life. Do not dispose of these products as unsorted municipal waste. Dispose of them according to the laws and rules in your area.

5.2 Germany's electronic products recycling program

6.1 RF Safety (Note: Applicable to TX products)

This two-way radio uses electromagnetic energy in the radio frequency (RF) spectrum to provide communications between two or more users over a distance. RF energy, which when used improperly, can cause biological damage. Please refer to the following websites for more information on what RF energy exposure is and how to control your exposure to assure compliance with established RF exposure limits: <http://www.who.int/en/>

Keeping the radio at a proper distance is important as RF exposure decreases with increasing distance from the proper antenna. A proper antenna is an antenna supplied with this radio by the manufacturer or specifically authorized by the local authority for use with this radio. This radio can only be operated by use of an antenna of a type and maximum (or lesser) gain approved for the transmitter under regulations and rules. This transmitter must operate with the antenna(s) documented and in Push-to-Talk and body-worn configurations as documented. Using authorized accessories is important because the use of Non-Retevis accessories may result in exposure levels, which exceed the IEEE/ICNIRP RF exposure limits.

Transmit no more than the rated duty factor 50% of the time. Transmitting necessary information or less, is important because the radio generates measurable RF energy exposure only when transmitting in terms of measuring for standards compliance. For users who wish to further reduce their exposure, Some effective measures to reduce RF exposure include:

- Reduce the amount of time spent using your wireless device.
- Use a speakerphone, earpiece, headset, or other hands-free accessory to reduce proximity to the head (and thus head exposure). While wired earpieces may conduct some energy to the head and wireless earpieces also emit a small amount of RF energy, both wired and wireless earpieces remove the greatest source of RF energy (handheld device) from proximity to the head and thus can greatly reduce total exposure to the head.
- Increase the distance between wireless devices and your body.

6.2 License-free transmitter only

This radio is designed for and classified as “General population/uncontrolled environments”. General population/uncontrolled environments are defined as locations where there is exposure of individuals who have no knowledge or control of RF exposure level.

7.1 Electromagnetic Interference/Compatibility

Nearly every electronic device is susceptible to electromagnetic interference (EMI) if inadequately shielded, designed, or otherwise configured for electromagnetic compatibility. During transmissions, your radio generates RF energy that can possibly cause interference with other devices or systems. To avoid such interference, turn off the radio in areas where signs are posted to do so, such as hospitals or healthcare facilities.

9.1 Protect your hearing



- Use the lowest volume necessary to do your job. Turn up the volume only if you are in noisy surroundings.
- Limit the amount of time you use headsets or earpieces at high volume.
- When using the radio without a headset or earpiece, do not place the radio's speaker directly against your ear.
- Use carefully with the earphone maybe possible excessive sound pressure from earphones and headphones can cause hearing loss .

CAUTION : Exposure to loud noises from any source for extended periods of time may temporarily or permanently affect your hearing. The louder the radio's volume, the less time is required before your hearing could be affected. Hearing damage from loud noise is sometimes undetectable at first and can have a cumulative effect.

10.1 Batteries Safety

~~•WARNING: KEEP NEW OR OLD USED BATTERIES OUT OF REACH OF CHILDREN.~~

- In the event of a battery leaking, do not allow the liquid to come into contact with the skin or eyes. If contact has been made, wash the affected area with copious amounts of water and seek medical advice immediately.
- If a radio or a battery has been submerged in water, please dry and clean it before use. Do not dry the radio or battery with an appliance or heat source, such as a hair dryer or microwave oven. If the radio has been submersed in a corrosive substance (eg saltwater), rinse the radio and battery in fresh water, then dry them.

~~10.2 Warnings for storage and disposal of batteries~~

~~•Since batteries are sensitive to high temperatures when storing them, keep them in a cool and dry place. The recommended temperature should be between +10℃ and +25℃ and never exceed +30℃. Batteries should therefore not be stored next to radiators or boilers nor in direct sunlight. Extremes of humidity (below 35% and above 95% relative humidity for sustained periods should be avoided since they are detrimental to both batteries and packing. Although the storage life of batteries at room temperature is good, storage is improved at lower temperatures provided special precautions are taken. Also, accelerated warming is harmful.~~

~~Leaving a battery in an extremely high temperature surrounding environment that can result in an explosion or the leakage of flammable liquid or gas;~~

~~A battery subjected to extremely low air pressure may result in an explosion or the leakage of flammable liquid or gas.~~

10.4 Recommended charging guide for secondary batteries (rechargeable batteries) equipped with charger

- Pull by the plug rather than the cord when disconnecting the charger.
- Unplug the charger from the AC outlet before attempting any maintenance or cleaning.

※※※※ The copyright of this material belongs to Shenzhen Ruitweisi Technology Co. , Ltd. Without authorization, copying or dissemination is prohibited ※※※※

- Do not use the charger outdoors or in moist environments, use only in dry locations/conditions.
- Do not disassemble the charger, which may result in a risk of electrical shock or fire. A charger should be dismantled only by trained people.
- Do not operate the charger if it has been broken or damaged in any way.
- An extension cord should not be used unless absolutely necessary. Use of an improper extension cord could result in a risk of a fire and/or electric shock. If an extension cord must be used, make sure that:

The pins on the plug of the extension cord are the same number, size and shape as those on the plug of the charger.

The extension cord is properly wired and in good condition.

Make sure the cord is located so it will not be stepped on, tripped over or subjected to damage or stress.

11.1 Children's Products

WARNING: CHOKING HAZARD-Small Parts. Not suitable for children under 3 years old.



12.1 Adapter Warnings

12.1.1 Included adapter

The plug of the adapter is considered a disconnect device. The socket-outlet shall be installed near the equipment and shall be easily accessible.

~~12.1.2 Equipped with type C charging port~~

The power delivered by the charger must be between min [xx] Watts and max [yy] Watts required by the radio equipment in order to achieve the maximum charging speed.

13.1 Authorized Accessories List

- Contact Reteless for assistance regarding repairs and service.
- For a list of Reteless-approved accessories for your radio model, visit the website <http://www.reteless.com>

3 French environmental recycling labels

1. **manual**



2. The red box changes to EMBALLAGES A SEPARER ET A DEPOSER DANS LE BAC DE PRI

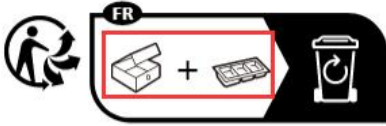

3. The red box is changed to "Cet appareil, ses accessoires" and batterie se recyclable



FCC Statement

This equipment has been tested and found to comply with the limits for a Class B digital device, pursuant to part 15 of the FCC Rules. These limits are designed to provide reasonable protection against harmful interference in a residential installation. This equipment generates, uses and can radiate radio frequency energy and, if not installed and used in accordance with the instructions, may cause harmful interference to radio communications. However, there is no guarantee that interference will not occur in a particular installation. If this equipment does cause harmful interference to radio or television reception, which can be determined by turning the equipment off and on, the user is encouraged to try to correct the interference by one or more of the following measures:

- Reorient or relocate the receiving antenna.
- Increase the separation between the equipment and receiver.
- Connect the equipment into an outlet on a circuit different from that to which the receiver is connected.
- Consult the dealer or an experienced radio/TV technician for help.

Caution: Any changes or modifications to this device not explicitly approved by manufacturer could void your authority to operate this equipment.

This device complies with part 15 of the FCC Rules. Operation is subject to the following two conditions: (1) This device may not cause harmful interference, and (2) this device must accept any interference received, including interference that may cause undesired operation.

RF Exposure Information

The device has been evaluated to meet general RF exposure requirement. The device can be used in portable exposure condition without restriction.