

USER MANUAL

AL10B digital lock with voice guide

Version: 1.0

Date: December, 2017

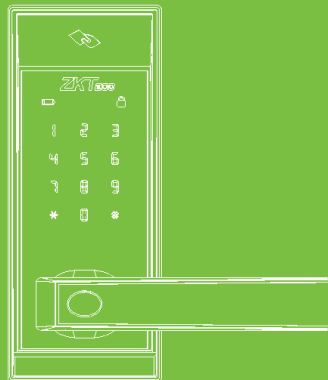

Table of Contents

Read Before Use	1
Safety Precautions	1
Structure	2
Basic Function	3
User Introduction	3
Initialization	4
Random Password.....	4
Voice Guide	5
Volume setting.....	5
Language setting	5
Lockout mode	5
Normal Open	6
Low Battery Warning	6
9V External Battery	7

How to change handle direction.....	8
Emergency Mechanical Key	9
How to Use	10
Register First Administrator	10
Register Other Administrator	12
Register Normal User	13
Delete Admin	14
Delete Normal User	15
Back up enroll	16
Volume setting	17
Language setting	18
Lockout mode	19
Normal open mode	20

Safety Precautions

1. The factory setting of all new locks will allow ANY verification to open them.
2. Please register at least one administrator for the newly installed lock. The lock cannot register any normal users without an administrator.
3. The lock is equipped with mechanical keys for manual unlocking. Please keep the mechanical keys at a safe place.
4. To power ON the lock, four alkaline AA batteries (not included) are required. Non-alkaline and rechargeable batteries **ARE NOT RECOMMENDED**.
5. Do not remove batteries when the lock is in working state.
6. Please replace the battery soon when the lock prompts of low battery.
7. If the lock does not have any activity for seven seconds it will go into sleep mode and prompts of time expired.

Structure

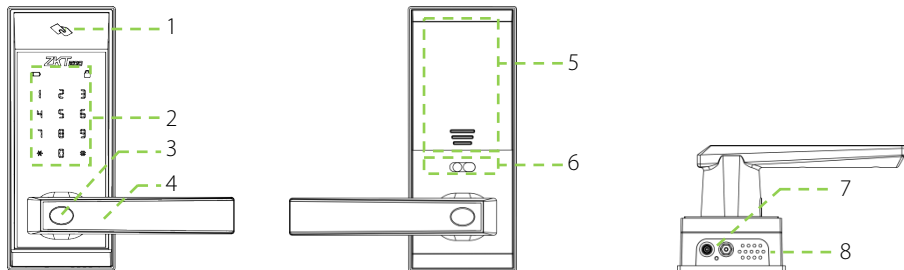

1. Card Area
2. Keypad & Card Detection Area
3. Mechanical Key Hole
4. Handle

5. Battery Area
6. Louckout Switch
7. 9V Battery Interface
8. Speaker

Basic Function

User Introduction

Group	Verification Mode	Function	Capacity
Administrator	Card	Register / Delete User, Open The Door, Access in menu	Max.100
	Password		Max.100
Normal User	Card	Open the door	Max.100
	Password		Max.100

Note:

1. The maximum card/password capacity is 100 for all groups.
2. The length of password is six digits.

Initialization

Initializing the lock means all data will be delete and restore to factory default setting.

Operation steps: Press the reset button on the back body of the lock, then touch the keypad to power on the lock holding the reset button for 5 seconds until the lock prompts the voice of “Restore to default settings, wait a moment”. After around 30 seconds, the lock prompts the voice of “completed”, and then the initialization is finished completely.

Random Password

Random password = Users may enter any number of random digits before or after the correct six digit password as long as the maximum number of digits entered is 32 or less.

For example: If the correct password is 123456, the random password can be 89123456807, 1234562363, 389123456, etc.

Voice Guide

After accessing the menu, the lock provides voice prompts before and after each operation for easy configuration.

Volume Setting

The lock volume can be set, which has three modes, high volume mode, low volume mode and silent mode.

Language Setting

Supports English / Spanish.or English / Portuguese.

Lockout Mode

When the lock set as lockout mode, only administrator can open the door, and also can use the **Lockout Switch** to enable or disable the mode.

Normal Open

Normal open mode is to keep door always unlocked, which is fit for meeting room and some places free to in or out.

Low Battery Warning

When the lock has a low battery a short beep and voice prompt of "Battery is low, please replace" will be prompted".

Note: Access to menu steps is not allowed in low battery status.

9V External Battery

9V external battery is used to open doors in emergency.

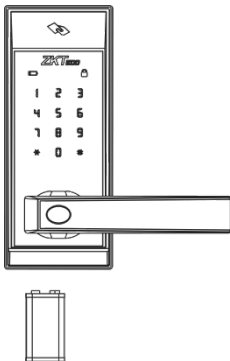

Note: The above battery must be 9V alkaline battery (6LR61).

How To Change Handle Direction

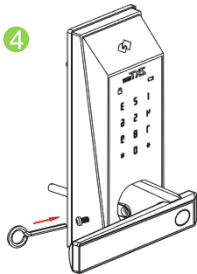
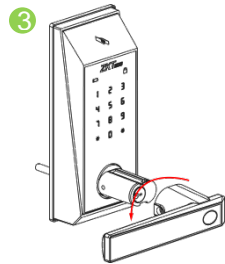
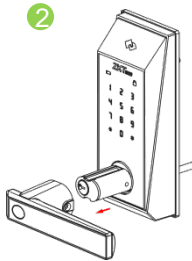
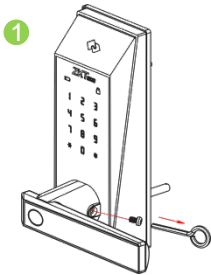

Step:

1. Remove the screws with a screwdriver.
2. Take out the lock handle.
3. Turn the handle in the opposite direction.
4. Replace the screws.

Emergency Mechanical Key

The mechanical key is used to open door when the lock has electronic malfunction.

Note: Keep the mechanical key at a safe place.

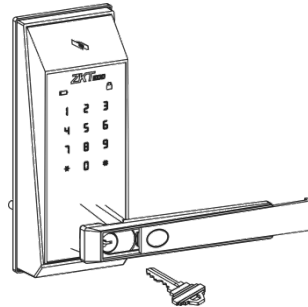

Register First Administrator

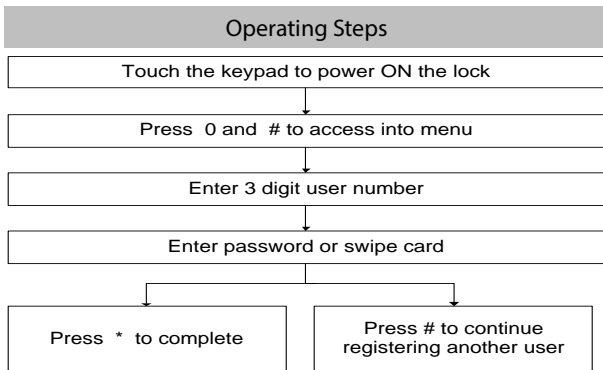

Note:

1. Put the card on the card area.
2. The length of password should be of six digits.
3. Default user number length is three digits, but one or two digit user numbers are accepted by pressing the # key.
4. Press * to cancel registration before the registration is complete.

Register Other Administrator

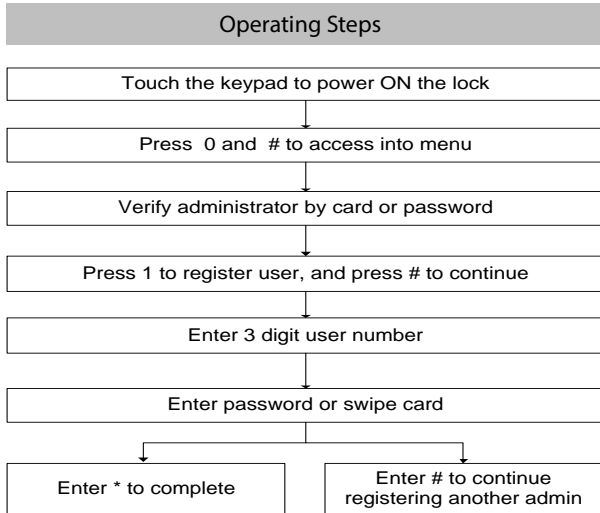

Note: If you verify administrator by password, please end with button #.

Register Normal User

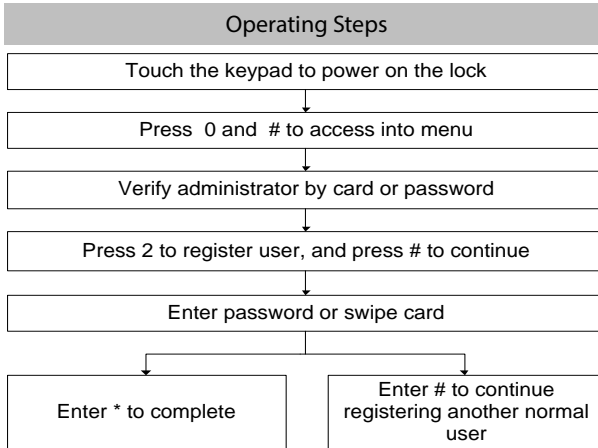

Delete Admin

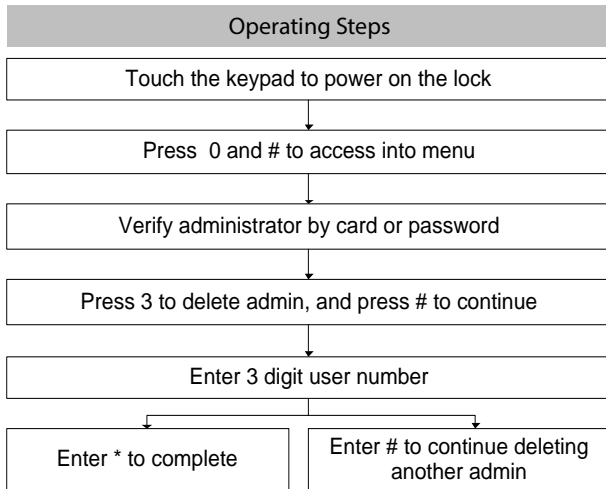

Delete Normal User

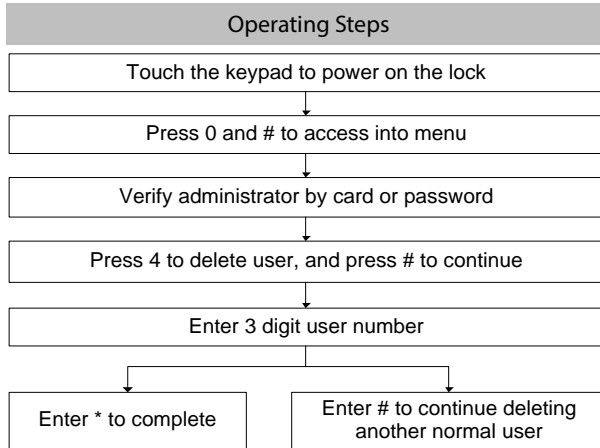

Back Up Enroll

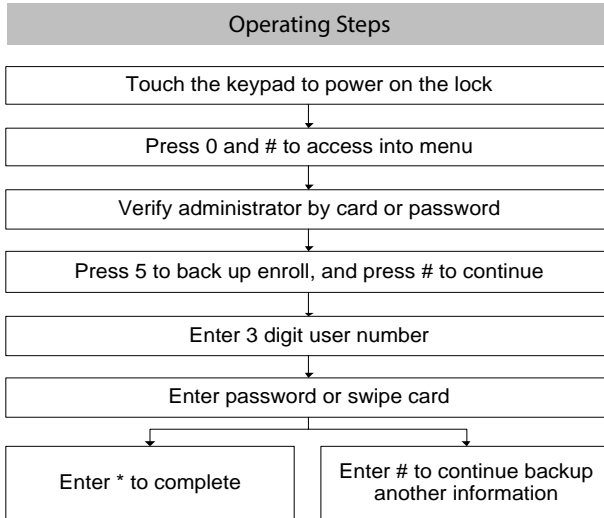

Volume Setting

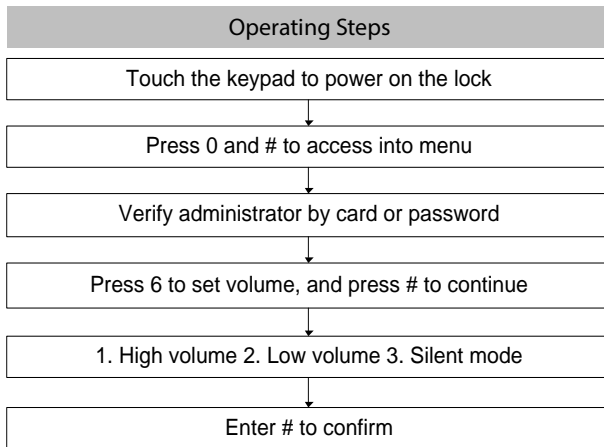

Language Setting

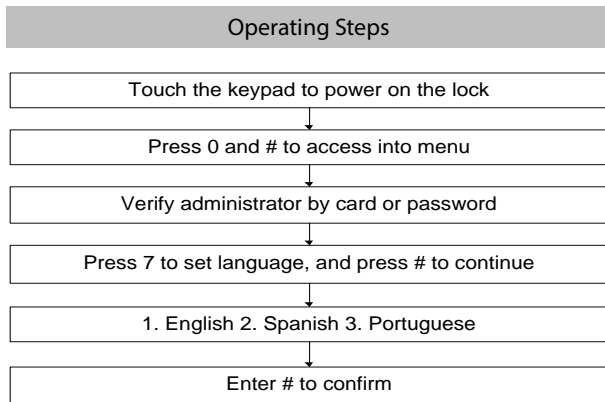

Note: There are only two language mode, English/Spanish, or English/Portuguese. For example, if the lock is equipped with English/Spanish, selecting "3" (Portuguese), will still show Spanish mode.

Lockout mode

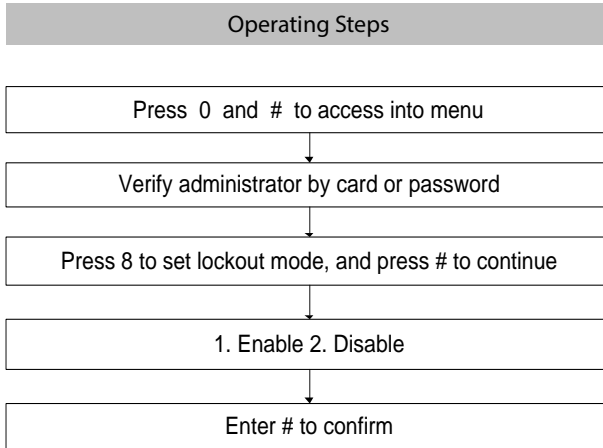

Normal open mode

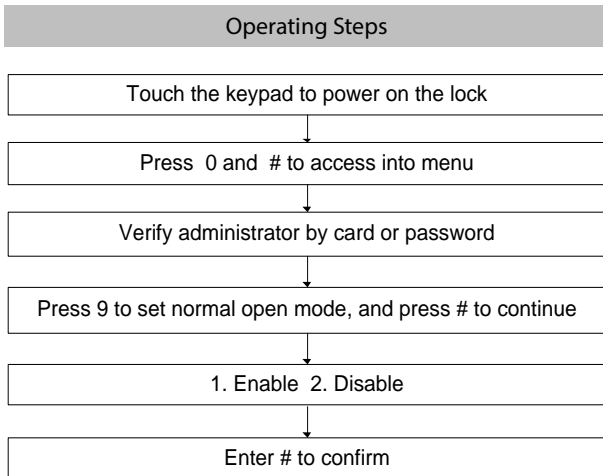

Warning: Changes or modifications to this unit not expressly approved by the party responsible for compliance could void the user's authority to operate the equipment

Note: This equipment has been tested and found to comply with the limits for a Class B digital device, pursuant to Part 15 of the FCC Rules. These limits are designed to provide reasonable protection against harmful interference in a residential installation. This equipment generates, uses and can radiate radio frequency energy and, if not installed and used in accordance with the instructions, may cause harmful interference to radio communications. However, there is no guarantee that interference will not occur in a particular installation. If this equipment does cause harmful interference to radio or television reception, which can be determined by turning the equipment off and on, the user is encouraged to try to correct the interference by one or more of the following measures:

Reorient or relocate the receiving antenna

Increase the separation between the equipment and receiver

Connect the equipment into an outlet on a circuit different from that to which the receiver is connected

Consult the dealer or an experienced radio/TV technician for help

"This equipment complies with FCC RF radiation exposure limits set forth for an uncontrolled environment. This equipment should be installed and operated with a minimum distance of 20 centimeters between the radiator and your body."

ZK Building, Wuhe Road, Gangtou, Bantian, Buji Town,
Longgang District, Shenzhen China 518129
Tel: +86 755-89602345
Fax: +86 755-89602394
www.zkteco.com

