

# User Guide

## Bluetooth Touch Gesture Control Z-BT1000



### Touch BT1000

Quick Start Guide

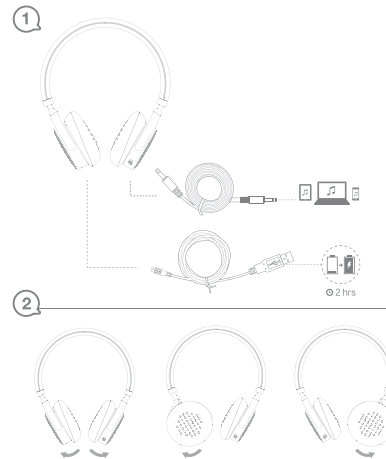

### Touch BT1000

Quick Start Guide

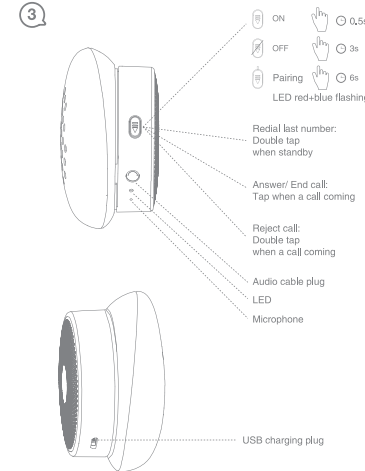

### Touch BT1000

Quick Start Guide

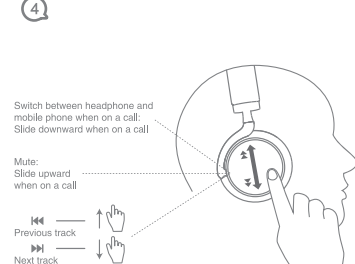

### Touch BT1000

Quick Start Guide

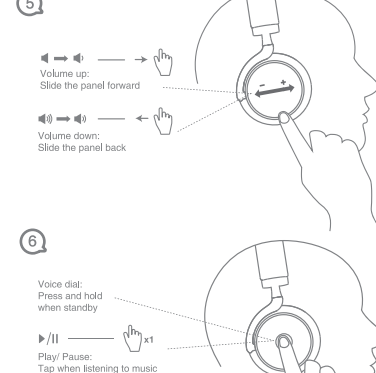

### Touch BT1000

Quick Start Guide

**Warning**  
Excessive sound pressure from earphones and headphones can cause hearing loss.

**Support**  
1.FAQ

**Q: Why do I hear crackling noises?**  
A: Bluetooth is a radio technology that is sensitive to objects between the headset and the connected device. Ensure the headset and the connected device are within range (Up to 10m/ 33ft).

**Q: What is the range of the headset?**  
A: The Z-BT1000 supports the following maximum ranges: 10m/ 33 ft.

**Q: Why do I not hear anything?**  
A: You might need to increase the speaker volume, or ensure that the headset is connected to the device.

**Q: I am having Bluetooth connection problems**  
A: Check your mobile device's Bluetooth menu and delete/ forget the headset. Re-connect the headset to your Bluetooth device following the Bluetooth connection instruction.

**2.How to care for your headset**

- Always store the headset with the power off and safely protected.
- Avoid storage at extreme temperatures ( Above 65° C/ 149° F or below -10° C/ 14° F). This can shorten battery life and may affect the headset.

### Touch BT1000

Quick Start Guide

#### TECHNICAL SPECIFICATIONS

Weight	142g
Dimensions	L 180xW 154xH 72 mm
Cable length	30cm
Microphone	4X1.5mm,Sensitivity:-38db+/-3dB
Microphone frequency	50HZ-15KHZ
Speaker	40mm dynamic speaker
Operation range	Up to 10m
Bluetooth version	4.1
Paired devices	Connected to two at the same time
Supported Bluetooth profiles	Hands free profile v1.6, headset profile v1.2, AVRCP v1.4, A2DP v1.2
Operate hours	About 18 hours (battery saturation)
Standby time	15 days
Pairing passkey or pin	0000