

TM772 Tablet Quick Start Guide

What's in the Box:

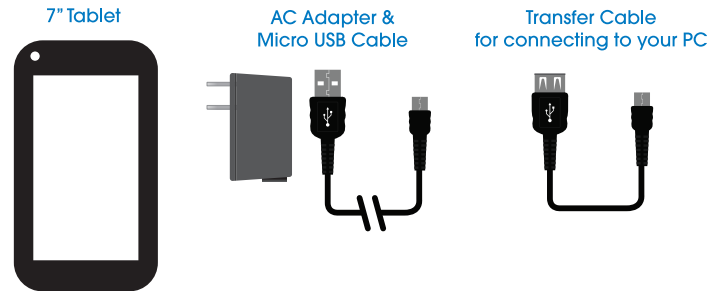

Features:

- 7" 1024 x 600 HD Display
- Intel® Atom™ Processor
- Android 4.4 KitKat
- 8GB Storage; 1GB RAM
- Front 0.3MP/Rear 2.0MP Cameras
- Wireless and WiFi Connectivity
- Micro USB
- TF Memory Card Slot
- 3000mAh Rechargeable Battery

Important Safety Instructions

We would like you to have an enjoyable experience with your new tablet. Please read the following instructions and notices prior to use.

- Avoid using the tablet in extremely hot, cold, dusty, damp or wet environments.
- The tablet is not moisture/water-resistant. Avoid using the tablet around sources of water.
- Avoid dropping or forcibly placing the tablet onto a hard surface. This may damage the screen or internal electronic components.
- Do not use alcohol, thinner or benzene to clean the surface of the tablet. Use only cleaning products designed for computer tablet devices.
- Do not use the tablet while walking or driving.
- Excessive use of earphones at high volume may lead to hearing impairment. Limit earphone usage, and adjust the volume to a moderate level when doing so.
- The images in this guide may vary slightly from the actual product.
- Charge the tablet battery under any of the following circumstances:
 1. The battery level icon indicates low power, by showing a drained, red battery icon.
 2. The tablet powers-off automatically, and continues to do so even after restarting.
 3. On-screen keys do not work.
- Warning: This product may contain a chemical known to the State of California to cause cancer, birth defects, or other reproductive harm.
- Do not suddenly disconnect the tablet when formatting, uploading or downloading data. This can lead to program errors (e.g., system or screen "freezing".)
- Static discharge in the cable, while it is connected to a computer, may corrupt files or damage the memory of the tablet.
- Dismantling the tablet will void the manufacturer's warranty. If you are experiencing problems, contact Customer Service at www.tmaxdigital.com
- The tablet functions, hardware, software, and warranty information may be improved or modified by the manufacturer or their respective owners, and is subject to change without notice.

Solo 7i Tablet At-a-Glance

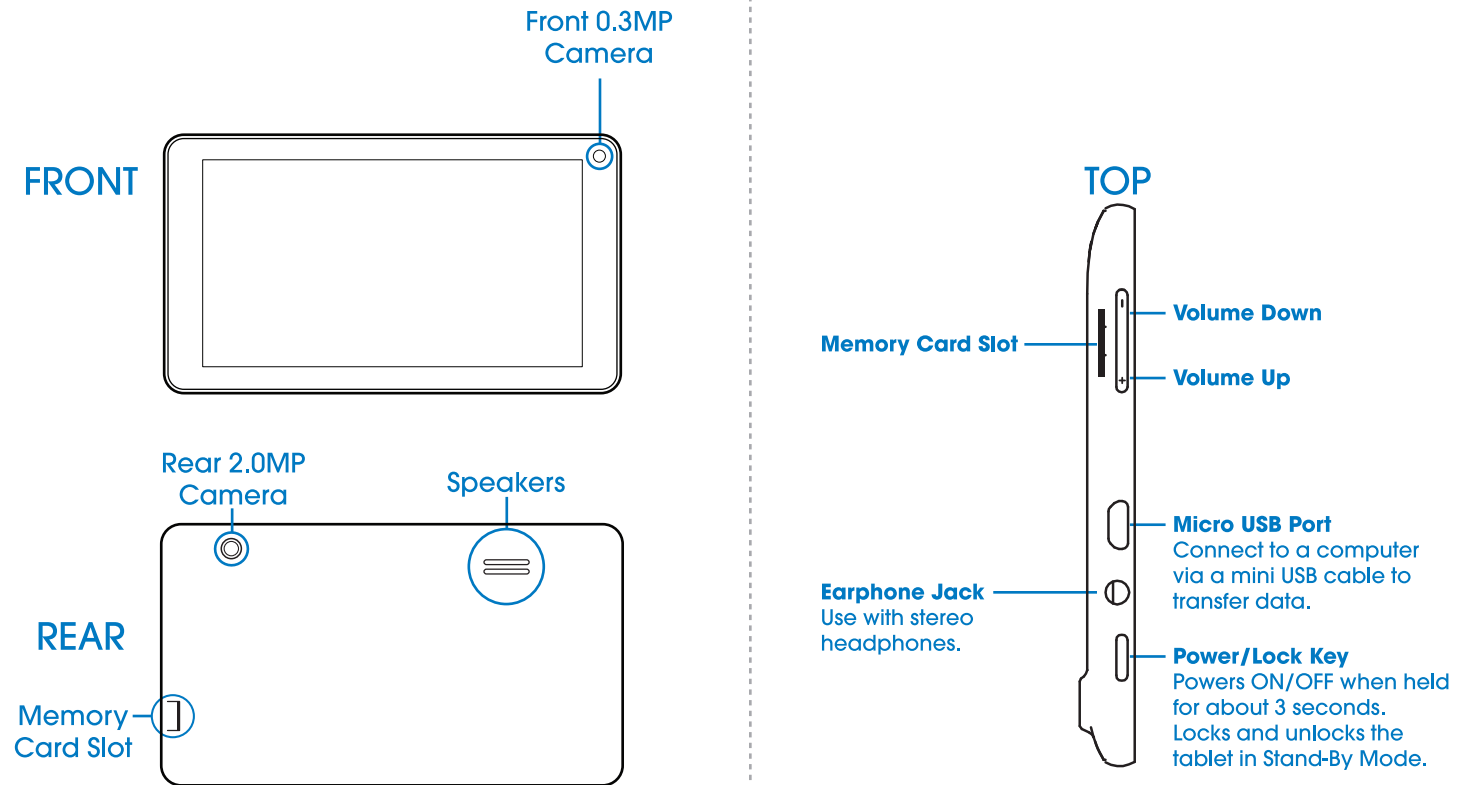

Home Screen At-a-Glance

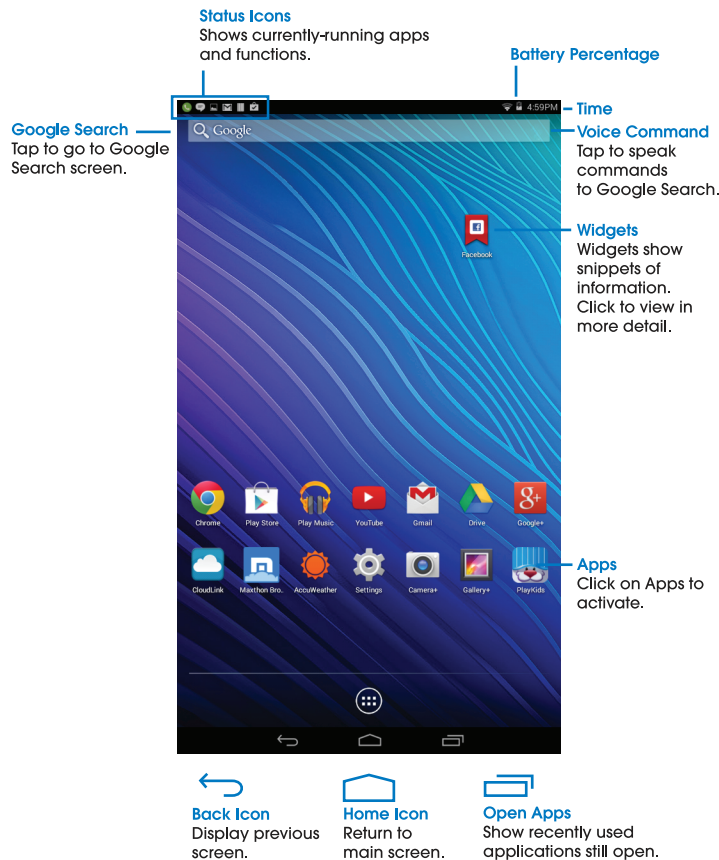

TIP - For best performance, open apps that are not in use should be closed.

Starting your Tablet

- 1) Press and hold the Power button for 3 seconds.
- 2) If your unit does not turn on, or instructs you to "connect your charger", connect the AC adapter and charge the unit.
- 3) At the Start-up screen, slide the lock icon to the right.
- 4) Once you've arrived at the main screen, you can begin using your tablet.

Charging your Tablet

Charge the battery completely before first usage. It is also recommended to charge the tablet before the battery icon indicates empty, or immediately after the pop-up message displays that the battery requires charging.

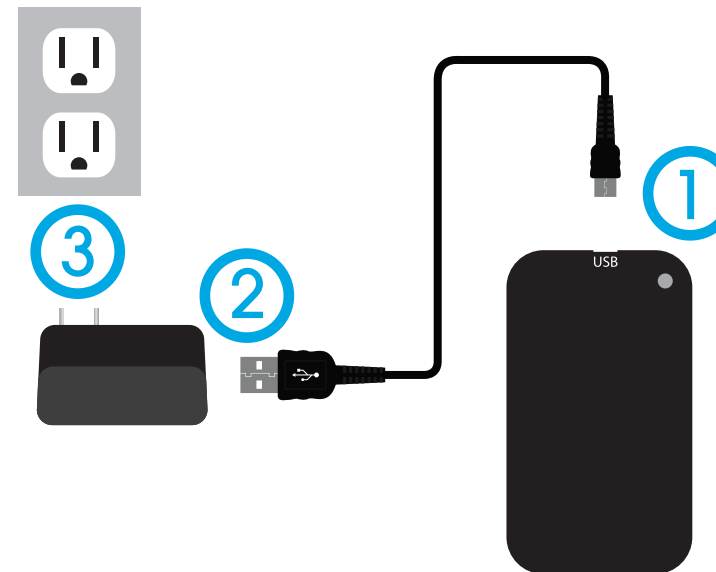

To charge the tablet, plug the micro USB end of the included USB cable into the top of the tablet, in the slot marked "USB" (1). Connect the other end of the cable to the AC adapter (2), and plug the AC adapter into a wall outlet (3). If the tablet is on, the battery icon will pulse, showing that it is being charged. It is fully charged when an icon of a full battery is displayed on the screen.

A complete battery charge will take approximately 5 hours. It is normal for the tablet to be warm to the touch as it is being charged.

Touching and Typing

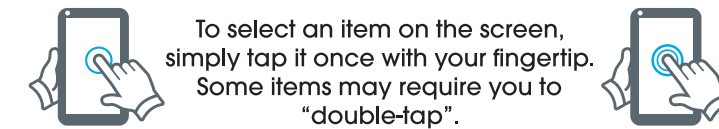

To type into a text field (i.e., when inputting your name, or a web address), tap the text field. The on-screen keyboard will appear, and allow you to type the information you wish to enter.

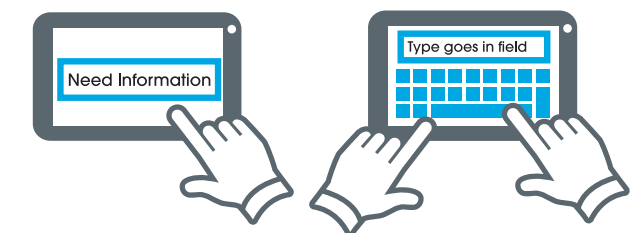

Touch and Hold: Keep your finger on an on-screen item until it glows or activates an alternate menu.

Drag: Move an App or object by touching and holding the image, then sliding it to the destination.

Slide: When there are extra "screens" to the side, slide one or more fingers from one side to another.