

ZTE Bluetooth headset

Light BTH

User Guide

Overview

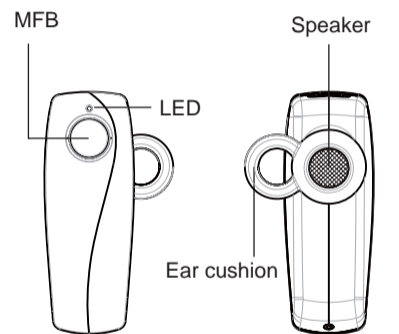

Front

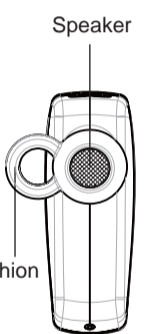

Back

Charging

First time use: Charge the headset for approximately 2 hours, or until the LED light is off.

Step 1. Connect the miniconnector of charging cable to the charging connector on the headset.

Step 2. Connect the USB connector of charging cable to the powered USB port on the desktop or laptop.

Step 3. LED will flash twice when connected and lights on during charging. After charging complete, LED will turn off.

Note: Headset is not functional while charging.

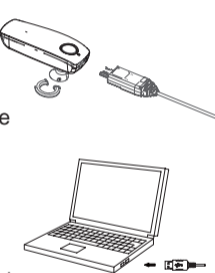

How to use

Power on / off:
Press and hold the MFB for longer than 5 seconds to switch.

Pairing:
Before you can use your headset, you must pair it with your phone.

Step 1. Press and hold the MFB for longer than 5 seconds to power on the headset and put Headset in pairing mode.

Step 2. Turn on the Bluetooth function on the mobile phone and set the phone to search for Bluetooth devices.

Step 3. Select the headset (Light BTH).
* decide by customer of device name.

Step 4. Enter the passcode 0000 to pair and connect the headset to your phone.

Answering / Ending a call:
Short press the MFB

Rejecting an incoming call:
Press and hold MFB for longer than 2 seconds.

Redialing last number:
Press and hold MFB for longer than 3 seconds.

Talk time ≥ 8 Hours
Standby time ≥ 120 Hours
Typical -1~4 dBm for Class 2
Out power: -0.5~4 dBm

If BT Headset doesn't connect A.G., it will auto-shut down after 300 sec.

Button Function

| Button | Headset Status | Action | Function |
|--------|----------------|--|--|
| MFB | Ringing | Short Press | Answer an incoming call Talking |
| | Talking | Short Press | Voice Recognition |
| | Power off | Press and hold for longer than 5 seconds | Power on headset and put Headset into pairing mode |
| | Power on | Press and hold for longer than 5 seconds | Power off the Headset |
| | Voice dial | Short Press | The phone will enter voice dial mode (handset must have this function) |

Without permission, any company, firm or user shall not alter the frequency, increase the power, or change the characteristics and functions of the original design of the certified lower power frequency electric machinery.

The application of low power frequency electric machinery shall not affect the navigation safety nor enter a legal communication, if an interference is found, the service will be suspended until improvement is made and the interference no longer exists.

LED Flashing

| Event | Flashing Pattern | COMMENT |
|-------------------------|--|---|
| Power on | Flash 3 times ON (250ms) OFF (250ms) | Only applied when user power on the system. |
| Power off | Flash 3 times ON (250ms) OFF (250ms) | Only applied when user shutdown the system. |
| Pairing | ON(300ms) OFF(300ms) | N/A |
| Standby – No Connected | ON(100ms) OFF(4900ms) | N/A |
| Standby - ACL connected | ON(100ms) OFF(2900ms) | N/A |
| SCO Connected | ON(100ms) OFF(1900ms) | N/A |
| Charging | ON | N/A |
| Charging Complete | OFF | N/A |

FCC Statement

This equipment has been tested and found to comply with the limits for a Class B digital device, pursuant to Part 15 of the FCC Rules. These limits are designed to provide reasonable protection against harmful interference in a residential installation. This equipment generates, uses and can radiate radio frequency energy and, if not installed and used in accordance with the instructions, may cause harmful interference to radio communications. However, there is no guarantee that interference will not occur in a particular installation. If this equipment does cause harmful interference to radio or television reception, which can be determined by turning the equipment off and on, the user is encouraged to try to correct the interference by one of the following measures:
- Reorient or relocate the receiving antenna.
- Increase the separation between the equipment and receiver.
- Connect the equipment into an outlet on a circuit different from that to which the receiver is connected.
- Consult the dealer or an experienced radio/TV technician for help.

FCC Caution

. Any changes or modifications not expressly approved by the party responsible for compliance could void the user's authority to operate this equipment.
. This device and its antenna(s) must not be co-located or operating in conjunction with any other antenna or transmitter.

FCC Notice

This device complies with Part 15 of the FCC Rules. Operation is subject to the following two conditions:
(1) This device may not cause harmful interference, and
(2) this device must accept any interference received, including interference that may cause undesired operation.

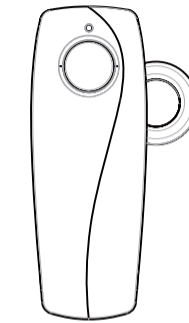

中兴蓝牙耳机

Light BTH

用户手册

概观

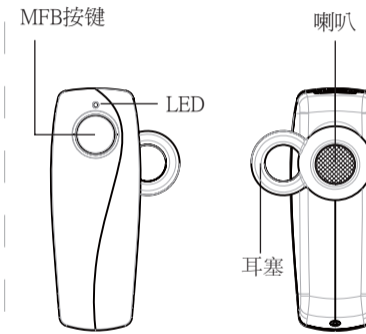

前视图

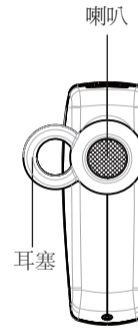

后视图

充电

第一次使用：请将耳机充电约2小时，或直到LED灯熄灭。

步骤1.将充电线连接至耳机的充电界面。

步骤2.将充电线的USB端子接到桌机或笔记型计算机的USB埠。

步骤3. 连结充电时、LED会闪烁两次。充电时LED会保持亮着。当充电完成后，LED将熄灭。

附注：耳机在充电时将无法运作。

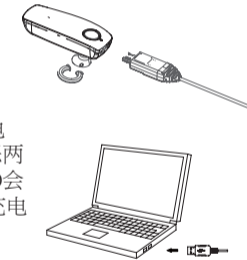

如何使用

电源开/关：

开:按住MFB按键的时间超过5秒钟

关:按住MFB按键的时间超过5秒钟

● 配对：

在使用耳机之前，您必须将耳机跟您的手机进行配对。

步骤1.按住MFB按键五秒，让耳机开启并进入配对模式。

步骤2.打开移动电话的蓝牙功能并设置手机搜索蓝牙设备。

步骤3.选择耳机（Light BTH）。

步骤4.输入密码0000配对并连接耳机到您的手机。

如何使用

接听/结束通话：

短按MFB

拒绝接听来电：

按住MFB的时间超过2秒

回放最后号码：

按住MFB的时间超过3秒

通话时控制麦克风开/关：

按住MFB的时间超过2秒

通话时间 ≥ 8 Hours

待机时间 ≥ 120 Hours

蓝牙范围 信息 Class 2

如果蓝牙耳机没有和A.G.连线，300秒后自动关机。

按键功能

| 按钮 | 耳机状态 | 动作 | 功能 |
|-----|------|----------|----------------------|
| MFB | 响铃 | 按一下 | 回答来电 |
| | 通话 | 按一下 | 挂断电话 |
| | 关机 | 按住超过 5 秒 | 开机并让耳机进入配对模式 |
| | 开机 | 按住超过 5 秒 | 关机 |
| | 语音播号 | 按一下 | 手机进入语音播号模式(手机必需有此功能) |

经型式认证合格之率射频电机,非经许可,公司、商号或使用者均不得擅自变更频率、加大功率或变原计之特性及功能。

低功率射频电机之使用不得影响飞航安全及干扰合法通信；经发现有干扰现象时，应立即停用，并改善至无干扰时方得继续使用。前项合法通信，指依电信法规定作业之无线电通信。低功率射频电机须忍受合法通信或工业、科学及医疗用电波辐射性电机设备之干扰。

LED 显示状态

| 事件 | 闪烁方式 | 备注 |
|------------|-----------------------------------|------------|
| 电源开启 | 闪烁3 次 亮着 (300ms) 不亮 (300ms) | 只有当系统开启时候. |
| 电源关闭 | 闪烁3 次 亮着 (300ms) 不亮 (300ms) | 只有当系统关闭时候. |
| 配对 | 亮着 (200ms) 不亮 (200ms) | N/A |
| 待机--未连结 | 亮着 (500ms) 不亮 (2500ms) | N/A |
| 待机--ACL 连结 | 亮着 (1500ms) 不亮 (6000ms) | N/A |
| SCO 连结 | 亮着 (2000ms) 不亮 (6500ms) | N/A |
| 充电中 | 亮着 | N/A |
| 充电完成 | 不亮 | N/A |