

# **F116 Series Mobile Phone**

## **User manual**

ZTE CORPORATION  
NO. 55, Hi-tech Road South, ShenZhen, P.R.China  
Postcode: 518057  
Tel: (86) 755 26779999  
URL: <http://www.zte.com.cn>  
E-mail: [mobile@zte.com.cn](mailto:mobile@zte.com.cn)

## **LEGAL INFORMATION**

Copyright © 2011 ZTE CORPORATION.

All rights reserved.

No part of this publication may be excerpted, reproduced, translated or utilized in any form or by any means, electronic or mechanical, including photocopying and microfilm, without the prior written permission of ZTE Corporation.

The manual is published by ZTE Corporation. We reserve the right to make modifications on print errors or update specifications without prior notice.

Version No. : R1.0

Edition Time : 20110122

Manual No. :

# Contents

For Your Safety .....	3
General Care.....	3
Aircraft Safety .....	4
Hospital Safety .....	4
General Guidelines.....	4
Road Safety .....	5
Vehicles Equipped with an Airbag .....	5
Third Party Equipment.....	5
Radio Frequency (RF) Energy .....	错误! 未定义书签。
Emergency Services .....	7
Information on Privacy .....	7
Copyright Notice.....	7
Getting Started .....	8
Your F116 Series.....	8
Technical Parameters .....	8
Starting Up .....	9
How to install the (U)SIM card and battery.....	9
How to insert the memory Card.....	9
How to charge the battery .....	10
Powering On/Off.....	10
How to lock the keypad.....	11
Indicators .....	11
Standby Mode .....	12
Special Features .....	12
Using Your Phone Features .....	13
Multitasking .....	13
Entering Text.....	13
How to add people to Contacts .....	13
How to make and receive calls.....	14
To make a voice call .....	14
To make a video call .....	14
To make a speed dial call.....	14
To answer a call .....	14
How to compose and send an SMS/MMS message.....	15
How to compose and send an E-mail.....	15
How to browse the Internet.....	15
Web Browser.....	15
How to watch streaming videos .....	16
How to capture a photo or record a video clip.....	16
How to play audios and videos .....	17
How to listen to FM radio .....	17
How to use Bluetooth.....	17
To set up Bluetooth .....	17
To pair with a Bluetooth device .....	17
How to set your phone .....	18
To add a new connection.....	18
To configure the browser network settings.....	19
To configure the MMS networking settings .....	19
To configure your mailbox.....	19

To configure the streaming settings .....	20
Declaration of RoHS Compliance.....	21
Disposal of Your Old Appliance.....	22

# Chapter 1

## For Your Safety

### *General Care*

Your handset contains delicate electronic circuitry, magnets and battery systems. You should treat it with care and give particular attention to the following points:

- Do not allow the handset, battery or accessories to come into contact with liquids or moisture at any time. Do not immerse the handset in any liquid.
- Do not place the handset alongside computer disks, credit cards, travel cards and other magnetic media. The information contained on disks or cards may be affected by the handset.
- Do not paint the handset.
- Do not leave the handset or the battery in places where the temperature could exceed 60°C, e.g. on a car dashboard or a windowsill, behind glass in direct sunlight, etc.
- Do not remove the handset's battery while the handset is switched on.
- Take care not to allow metal objects, such as coins or key rings to contact or short-circuit the battery terminals.
- Do not dispose of battery in a fire. The handset's Li-ION batteries may be safely disposed of at a Li-ION recycling point. Follow local requirements for recycling.
- Do not put the handset's battery in your mouth, as battery electrolytes may be poisonous if swallowed.
- Do not attempt to dismantle the handset or any of its accessories.
- Do not put a battery into a microwave oven, dryer, or high-pressure container.
- Do not contact battery directly to an electric outlet or cigarette lighter charger. Use only approved charger units.
- Do not pierce battery with a sharp object such as a needle.
- Do not disassemble or modify the battery.
- Do not use a damaged or deformed battery.
- Do not drop, throw, or subject the handset to rough treatment.
- Do not solder the battery directly.
- Stop using the battery if abnormal heat, odor, discoloration, deformation, or abnormal condition is detected during use, charge, or storage.
- Remove the battery whose life cycle has expired from equipment immediately.
- This equipment is fitted with an internal battery. Take it to a qualified service engineer when the replacement of the battery is required.
- The earpiece may become warm during normal use. Also, the handset itself may become warm while the battery is being charged.
- When a handset is in vibration mode, the vibration can sometimes cause the handset to move.
- Be careful not to place the handset near heat sources (such as a heater) or too close to the edge of the table.
- Power off your phone before you clean it. Use a damp or anti-static cloth to clean the handset. Do not use an ordinary dry cloth or electrostatic cloth. Do not use chemical or abrasive cleaners

as these could damage the casing.

- Remember to make backup copies of all important data on your handset.
- Remember to recycle: the cardboard packing supplied with this handset is ideal for recycling.



#### Warning:

In the unlikely event of a battery leak, take care to keep the battery discharge away from your eyes or skin. If the leakage does come into contact with the eyes or skin, please flush thoroughly in clean water and consult with a doctor.

### ***Aircraft Safety***

- Power off your phone before the airplane takes off. In order to protect airplane's communication system from interference, it is prohibited to use mobile phone in flight. If you want to use mobile phone before the airplane takes off, you should get aircrew's permission according to safety regulations.
- If the mobile phone has the function of automatic timing power-on, please check your alarm setting to ensure that your phone will not be automatically powered on during the flight.

### ***Hospital Safety***

- Power off your phone and remove the battery in areas where the use of handsets is prohibited.
- Follow the instructions given by the respective medical facility regarding the use of handsets on their premises.

### ***General Guidelines***

- In some countries, national law prohibits private copying of copyrighted material. Please check the national legislation of the applicable country concerning the use of such material.
- Many jurisdictions have laws and regulations about taking pictures in public or private areas and regarding the processing and further use of such pictures. The manufacturer encourages its customers to obey all laws and to respect the personal rights of others.
- Please check roaming agreement availability with your service provider.
- The use of mobile phones is not allowed in some radiation sensitive areas, such as hospitals, research centers and airplanes. The user is responsible to power-off the device. If there is any uncertainty, you should remove the battery from the handset.
- Observe any signs that indicate powering off handsets, such as those near gas stations, or explosives, and power off the handset/device immediately.
- If you have a heart condition, be careful with the settings of call vibration or tone volume.
- Do not allow children to play with the handset, charger or batteries.
- Do not use the handset where blasting is in progress.
- Do not try to make a call or conversation while the temperature of charging battery is above 50°C.
- Take care not to put your handset in the back pocket of your trousers or skirt and then sit on it. Also, do not put your phone at the bottom of bag where it may subject to excessive weight or pressure. Doing so may damage the LCD and camera lens and cause them malfunction.
- The operation of some medical electronic devices, such as hearing aids and pacemakers, may be affected if a handset is used next to them. Observe any caution signs and the manufacturer's recommendations.

- Do not leave the handset discharged or without a battery for a long time, otherwise some data may be erased.
- Your phone contains metal, which may cause you an itch, a rash or eczema depending on your physical condition.

## ***Road Safety***

- You must exercise proper control of your vehicle at all times. Give your full attention to driving.
- Observe all of the recommendations contained in your local traffic safety documentation.
- Pull off the road and park before making or answering a call, if driving conditions require so. Check if local laws and/or regulations restrict the use of handsets while driving.
- You **MUST NOT** stop on the hard shoulder of a motorway to answer or make a call, except in an emergency.
- Power off your handset at a refueling point, such as a gas station, even if you are not refueling your own car.
- Do not store or carry flammable or explosive materials in the same compartment as the handset.
- Electronic systems in vehicle, such as anti-lock brakes, speed control and fuel injection systems are not normally affected by radio transmissions. The manufacturer of such equipment can advise if it is adequately shielded from radio transmissions. If you suspect vehicle problems caused by radio transmissions, consult your dealer and do not power on the handset until it has been checked by a qualified technician.

## ***Vehicles Equipped with an Airbag***

An airbag inflates with great force. Do not place objects, including either installed or portable wireless equipment, in the area over the airbag or in the airbag deployment area. If in-vehicle wireless equipment is improperly installed and the airbag inflates, serious injury could result.

## ***Third Party Equipment***

The use of third party equipment, cables or accessories, not made or authorized by ZTE, may invalidate the warranty of your handset and also adversely affect the phone's safety/operation.

## **Health and safety information**

### Radio Frequency (RF) Energy

This model phone meets the government's requirements for exposure to radio waves.

This phone is designed and manufactured not to exceed the emission limits for exposure to radio frequency (RF) energy set by the Federal Communications Commission of the U.S. Government: The exposure standard for wireless mobile phones employs a unit of measurement known as the Specific Absorption Rate, or SAR. The SAR limit set by the FCC is 1.6W/kg. \*Tests for SAR are conducted using standard operating positions accepted by the FCC with the phone transmitting at its highest certified power level in all tested frequency bands. Although the SAR is determined at the highest certified power level, the actual SAR level of the phone while

operating can be well below the maximum value. This is because the phone is designed to operate at multiple power levels so as to use only the power required to reach the network. In general, the closer you are to a wireless base station antenna, the lower the power output. The highest SAR value for the model phone as reported to the FCC when tested for use at the ear is 1.22 W/kg and when worn on the body, as described in this user guide, is 0.761 W/kg (Body-worn measurements differ among phone models, depending upon available enhancements and FCC requirements.)

While there may be differences between the SAR levels of various phones and at various positions, they all meet the government requirement.

The FCC has granted an Equipment Authorization for this model phone with all reported SAR levels evaluated as in compliance with the FCC RF exposure guidelines. SAR information on this model phone is on file with the FCC and can be found under the Display Grant section of <http://www.fcc.gov/oet/fccid> after searching on

FCC ID: Q78-F116

For body worn operation, this phone has been tested and meets the FCC RF exposure guidelines for use with an accessory that contains no metal and the positions the handset a minimum of 1.5 cm from the body. Use of other enhancements may not ensure compliance with FCC RF exposure guidelines. If you do not use a body-worn accessory and are not holding the phone at the ear, position the handset a minimum of 1.5 cm from your body when the phone is switched on.

### **FCC Compliance**

This device complies with part 15 of the FCC Rules. Operation is subject to the following two conditions: (1) This device may not cause harmful interference, and (2) this device must accept any interference received, including interference that may cause undesired operation.

Caution: Changes or modifications not expressly approved by the manufacturer could void the user's authority to operate the equipment.

NOTE: This equipment has been tested and found to comply with the limits for a Class B digital device, pursuant to part 15 of the FCC Rules. These limits are designed to provide reasonable protection against harmful interference in a residential installation. This equipment generates, uses and can radiate radio frequency energy and, if not installed and used in accordance with the instructions, may cause harmful interference to radio communications. However, there is no guarantee that interference will not occur in a particular installation. If this equipment does cause harmful interference to radio or television reception, which can be determined by turning the equipment off and on, the user is encouraged to try to correct the interference by one or more of the following measures:

- Reorient or relocate the receiving antenna.
- Increase the separation between the equipment and receiver.
- Connect the equipment into an outlet on a circuit different from that to which the receiver is connected.
- Consult the dealer or an experienced radio/ TV technician for help.



## ***Emergency Services***

To make an emergency call in any country:

1. Ensure that your handset is on and in service.
2. Press **End Key** as many times as needed to clear the display and ready the device for calls.
3. Enter the official emergency number for your present location, for example, 112 (the international emergency number).
4. Press **Send Key** to dial the number. Follow instructions received and do not end the call until told to do so.

When the USIM card is not inserted, press **Right Soft Key [SOS]** and then enter the official emergency number for your present location. Press **Send Key** or **OK Key [Call]** to dial the number. If the keypad lock is on, enter the emergency number directly and press **Send Key**.



### **Notes:**

- Tell the operator which service you require: Police, Ambulance, Fire Brigade, Coastguard or Mountain Rescue Service. Tell them where you are and remain stationary to maintain contact if possible.
- Due to the nature of the cellular system, the connection of emergency calls cannot be guaranteed. You should never rely solely on any wireless device for essential communications like medical emergencies.

## ***Information on Privacy***

Camera usage and photo/audio/video recordings carried out with the handset can offend the confidentiality of the subjects. The user therefore is held to respect legislation in confidentiality matter and remains the only responsible subject in case of eventual violations of the enforced norm.

## ***Copyright Notice***

The video/audio recordings you make/download are protected by copyright laws. They are for personal use only and must not be otherwise used without the permission of the copyright owner.

# Chapter 2

## Getting Started

### Your F116 Series

The F116 described in this manual is approved for use on the UMTS/GSM/GPRS networks and achieves seamless handover between them.

When using this device, obey all laws, respect the privacy and legitimate rights of others, including copyrights.

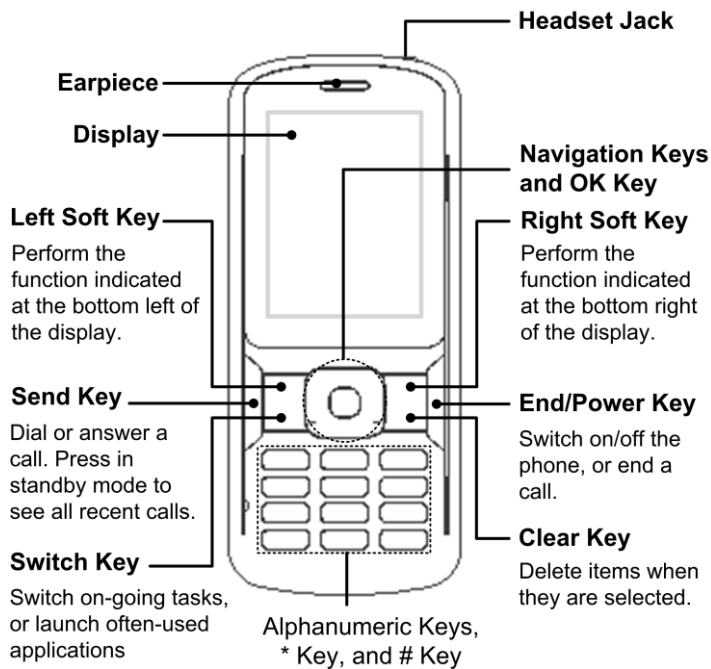

### Technical Parameters

Type	F116
Dimensions	110mm×47.5mm×11.8mm
Display	2.0 inches 176*220 TFT
Weight	70g (Including a standard battery)
Battery	820 mAh Li-ion battery
Continuous standby time	GSM: 200 hours; WCDMA: 330 hours
Continuous talk time	GSM: 400 minutes; WCDMA: 240 minutes
Continuous video talk time	135 minutes

\* The phone's talk and standby times are based on ideal working environments. The use of extended backlight, browser, and network conditions can reduce battery life and talk/standby time.

## Starting Up

### How to install the (U)SIM card and battery

1. Make sure that the phone is powered off and the charger is disconnected from the phone.
2. Turn the phone over, hook the edge of the back cover and lift it up to remove the back cover.

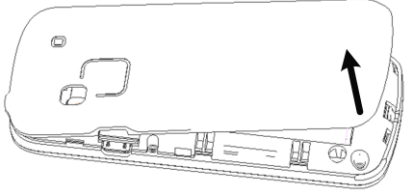

3. If the battery is already inside, remove it.

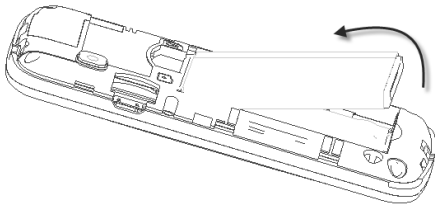

4. Hold your (U)SIM card with the cut corner oriented as shown above the (U)SIM card slot and then slide it into the slot.

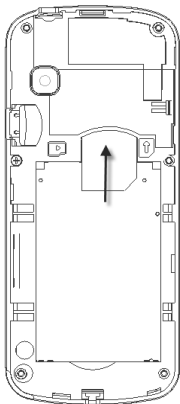

5. Insert the battery by aligning the gold contacts on the battery with the gold contacts in the battery compartment on the phone.

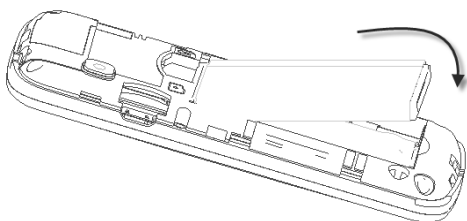

6. Replace the back cover.

### How to insert the memory Card

Your phone supports microSD cards with capacity up to 4 GB, giving you a very large memory capacity to save images, photos, audio and video files.

**Notes:**

The microSD logo  is a trademark of SD Card Association.

1. Remove the back cover.
2. Slip the memory card carefully into the microSD card slot with the metal contacts facing downwards.

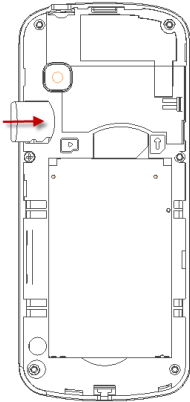

To remove the card, carefully slide it out of the slot.

## How to charge the battery

The lithium ion rechargeable battery of the mobile phone can be immediately used after unpacking. A new battery performs best after performing a full charge/discharge 3 times. When not using the battery for a long period, remove it from the phone and store it in a cool dry place.

**Caution:**

Do not charge the battery out of the temperature range of 0°C to 45°C.

1. Connect your adapter to the right side of your mobile phone as shown in the picture.

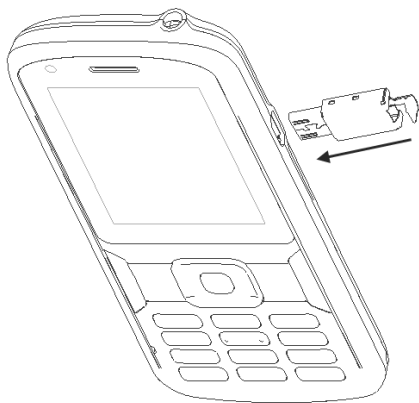

2. Connect the other end of the adapter to the mains socket.

## Powering On/Off

1. Make sure that your SIM card is inserted and the battery is charged.

2. Hold **End/Power Key** for about 2 seconds to power on/off the phone. The phone will automatically search for the network.

## How to lock the keypad







You can use the keypad lock to prevent the keys from being accidentally pressed.

In standby mode, hold \* **Key**.

To unlock the keypad, press **OK Key** and then press \* **Key**.

## Indicators

Indicator	What it means
	Signal strength
	3G network
	EDGE network
	GSM network
	New text messages
	New E-mails
	New multimedia messages
	New WAP PUSH messages
	Message space is full
	Data communication is available
	Data communication in progress
	Call forward is active
	Missed voice calls
	Missed video calls
	Alarm clock has been set
	Battery level
	Low battery
	Bluetooth active

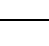
Indicator	What it means
	Earphone inserted
	Vibration on
	Ringtone off
	Meeting mode
	Flight mode
	FM radio on
	Roaming

## Standby Mode

When you turn on the phone, it enters the standby mode. You can find the following information:

- Indicator icons
- Date and time
- Network name or the operator logo
- Functions of **Left Soft Key**, **OK Key** and **Right Soft Key**

You can return to the standby mode from any interface by pressing **End Key**.

## Special Features

Your F116 offers several special functions that make it more convenient and more fun to use.

- Multitasking: Handle multiple applications at the same time and toggle freely.
- FM radio: More freedom for you while no wired headset is needed for FM radio any more.  
**Note:** Only available on certain phone models.
- Changing themes: Choose what you like from the two sets of themes in **Display** settings.

# Chapter 3

## Using Your Phone Features

### *Multitasking*

In any screen, press **Switch Key** to find a dock at the bottom of the screen, where you can launch frequently used applications, return to standby mode or the main menu, without closing the current application.

To reopen the application you switched from, press **Switch Key** and select the app on the dock.

### *Entering Text*

1. Change input mode: Press **# Key** to choose input mode from the drop-down menu.
2. Change input language: Press **# Key** and choose the last option from the drop-down menu. Then select the language you need and press **OK Key**.
3. Input Letters: In abc/Abc/ABC mode, press the corresponding letter key till the letter appears.
4. Input Words: In eZiEng mode, key-in any letter with a single key press. Press each key only once for every letter. The phone will present a list of words based on the keys you pressed and its built-in dictionary. The word changes after each key stroke. When you have finished typing, move the cursor with **Navigation Keys** to choose the right word and confirm it by pressing **0** or **OK Key**.
5. Input Digits: In 123 mode, press a digit key once to enter a digit. In eZiEng mode, press the digit key, and select the number by pressing a Navigation key. In abc/Abc/ABC mode, constantly press the digit key until the number appears.
6. Input Symbols: Press **\* Key** to choose a symbol and **OK Key** to insert it into the text. In abc/Abc/ABC mode, press 1 key continuously till the required symbol (common symbols) appears.
7. Input Space: Press **0 Key** to input space. It does not work in 123 mode.
8. Delete Characters: Press **Clear Key** to clear a character. Press and hold **Clear Key** to delete all text before the cursor.
9. Move Cursor: Press **Navigation Keys** to move the cursor left, right, up, or down.

### *How to add people to Contacts*

1. Press **Menu > Contacts** from Standby Mode.
2. Press **Options > Advanced > Default memory** to choose where you want to save the new contact.
2. Press **Options > Add new contact**.
3. Enter information for the new contact.
4. Press **OK Key** to save and exit.



#### Notes:

- **Contacts on the phone can be classified into different groups. When you are in the phone contact list, select **Groups** on top of the list to manage the groups, or send a message to all contacts in a group.**

## How to make and receive calls

### To make a voice call

1. Enter a phone number in the standby mode.
2. Press **Send Key**, **OK Key** or select **Options > Call > Voice call**.



#### Tips:

You can also select **Options > Save** to save the number, or **Options > Send Message** to send a message.

3. Press **Right Soft Key** to cancel the call.
4. Press **End Key** to end the call.

### To make a video call

The called party as well as the network has to be capable of handling video calls. Otherwise, the phone will prompt you to make a voice call.

1. Enter a phone number in the standby mode.
2. Select **Options > Call > Video call**.
3. Press **Right Soft Key** to cancel the call.
4. Press **End Key** to end the call.

### To make a speed dial call

In the standby mode, hold the numeric key (1~9) corresponding to the phone number in the speed dial list to make a call.



#### Notes:

The number key 1 is reserved for your voicemail number.

### Set speed dial

1. In the standby mode, select **Menu > Contacts** and highlight a contact.
2. Select **Options > Set speed dial**.
3. Select a number between 2 and 9.
4. Press **OK Key [Setup]**.

To cancel a speed dial setting, select the speed dial number and press **Clear**.

### To answer a call

When there is an incoming call, you can press **Send Key** to answer it or **Right Soft Key** to reject it. You can also select **Options** to mute the ringtone or reject the call and send a message to the caller, explaining why you cannot answer.



**Caution:**

Adjust the volume of the earpiece to a moderate level to avoid injury to your ear.

### ***How to compose and send an SMS/MMS message***

SMS/MMS is a way to send a message from one mobile to another. The difference between an SMS and MMS is that MMS can include not just text, but also sound, images and videos. Before sending an MMS, you need to configure the MMS network settings first (see *How to set your phone-To configure the MMS networking settings*).

1. In standby mode, select **Menu > Messages > Create message** to compose an SMS/MMS message.
2. Enter the recipients' numbers or press **OK Key** to choose from contacts or call history.
3. Press **Down Key** to move the cursor to the text field and enter the text.

For an SMS message, you can select **Options** to insert **My words**, text templates, or contacts, or to save the message to **Drafts**.

For an MMS message, you can select **Options > Insert** to insert multimedia files or attachments, or insert a subject to the message. You can also press **Options** to insert **My words/Templates**, add/delete a file, preview the MMS, or save it to **Drafts**.

5. Press **OK Key** to send the message.

### ***How to compose and send an E-mail***

Before sending or receiving an E-mail, you need to configure the mailbox first (see *How to set your phone-To configure your mailbox*).

1. In standby mode, select **Menu > Messages > Email tab > New Email**.
2. Enter the recipients' addresses or press **OK Key** to choose from contacts.
3. Press **Down Key** to move the cursor to the Cc field and enter the recipients' addresses, or press **OK Key** to choose from contacts.
4. Press **Down Key** to enter the subject.
5. Press **Down Key** to the text field and enter the contents of your Email. You can select **Options** to insert or check attachments, Email templates, My words, signature, or to save the message to **Drafts**.
6. Press **Send** to send the Email.

### ***How to browse the Internet***

Before browsing the Internet, you need to configure the browser networking settings (see *How to set your phone- To configure the browser network settings*).

#### **Web Browser**

In standby mode, select **Menu > Browser** to launch the preinstalled Internet browser.

## To set the browser

The browser must be correctly set before you can access the Internet.

Go to **Menu > Browser > Settings > Connection settings** to select connection profile (see *How to set your phone- To configure the browser network settings*).

Open **Advanced Settings** to set up **Display Picture, Display Animation, Font, Browser Mode, SmartFit Mode, Background Music, Cache Mode, Cookie Mode, Autofill Mode, Script** and **Refresh Limit**.

You can also clear cache, cookies, histories, or view certificates provided in the browser.

## To link to a web page

In the browser, you can open a web page in the following ways:

- Select **Home Page** to open home page set in the connection profile (see *How to set your phone – To add a new connection*).
- Select **Enter Address**. Enter the address directly and press **OK Key**.
- Open **Bookmarks**. Choose a bookmark and open the web site.
- Open **History**. Select a record to open the web page you have visited.

## Web Page Options

Open a web page and press **Options**. You can refresh the page, check downloading progress, forward to the next page, browse in full screen, open a new page, save the page to bookmark, or save the page as an off-line file.

You can also use images, the background music and the URL of the web page, choose the encoding, or view properties of the page. The URL can be sent as a message or an Email.

Select **Settings** to set up the browser, **Dial** to dial a number, or **Exit** to end the application.

## How to watch streaming videos

Before watching streaming videos, you should configure the streaming settings first (see *How to set your phone-To configure the streaming settings*).

1. Select **Menu > Multimedia > Video > Streaming URL**.
2. Select a URL bookmark and press **OK Key**. If there is no bookmark, press **OK Key** to add the first one.

## How to capture a photo or record a video clip

1. Select **Menu > Multimedia > Camera/Video camera**. The photos are stored in jpg format, and videos in 3gp or mp4 depending on the setting. You can switch between the camera and video camera by pressing **Options > Switch to camera/Switch to video camera**.
2. Press **Up/Down Key** to zoom in /out. You can also press **Options** to set the size, quality, brightness, contrast, etc.
3. Press **OK Key** to capture a photo or starting to record a video clip. You can pause the recording or stop it.
3. Select **Options > Discard** to delete the photo or video, **Options > Send** to send the file, or **Options > Set as wallpaper** to use the photo as wallpaper for standby screen.

## How to play audios and videos

1. Press **Menu > Multimedia > Music / Video**.
2. Press **All Music** or **All Videos** to choose a file from the phone or the microSD memory card.



### Notes:

Press **Recent play** or **Recent view** to view recently played/watched items.

## How to listen to FM radio

1. Press **Menu > Multimedia > FM radio**.

The phone will search for available channels automatically when you open it for the first time.

2. Press **Left/Right Key** to switch radio channels, **Up/Down Key** to adjust volume.

Press **Options** to see the channel list, tune channels manually or automatically, or enter a frequency directly.

## How to use Bluetooth

Bluetooth is a short-range wireless communications technology. When paired, devices with Bluetooth capabilities can exchange information within a distance of about 10 meters without any physical connection.

Your phone supports OPP, FTP, HSP, HFP, A2DP, AVRCP, DUNP, and PBAP Bluetooth profiles. You can connect your phone to a Bluetooth headset, transfer files with other Bluetooth devices, or browse the files on remote devices.

## To set up Bluetooth

Go to **Menu > Tools > Bluetooth** to set up Bluetooth. You can switch on or off the Bluetooth function, change phone visibility, set up device name or check Bluetooth services of your phone.

## To pair with a Bluetooth device

1. Press **Menu > Tools > Bluetooth > Search For New Device** to search for visible Bluetooth devices.

You can also press **Menu > Tools > Bluetooth > My Devices** and press **OK Key** to search.

2. Select a device and press **OK**.
3. Enter the pass key and press **Left Soft Key**. If necessary, change the connection options.

# Chapter 4

## How to set your phone

In standby mode, select **Menu > Settings** and you can adjust various settings of your phone.

- **Profiles:** Configure or activate the default profiles. While configuring a profile, you can set the ringtone, ring volume, ringing type, message tone, keytones, warning tone, power on/off sound, and earpiece volume.
- **Phone:** Select language, set the time & date, missed calls alert, shortcut keys, keylock, own phone number, and download locations. You can also reset your phone to default, or set the time for auto power on/off.
- **Display:** Set the wallpaper, backlight duration, brightness, keyboard light, owner name, and greeting of your phone. The phone offers two sets of themes. Select the one you like.
- **Connections:** Select the settings for mobile phone network, data connection, PC connection, and modem.
- **Calls:** Configure the call settings, such as videophone, call forwarding, call waiting, call barring services, and choose whether to send your number while making a call.
- **Security:** Activate or change security codes. You can also turn on or off the Fixed Dial Numbers (FDN) function, and edit the FDN list. You cannot dial numbers out of FDN list when FDN function is activated.

**Note:** The default handset code is 0000.

### To add a new connection

You can use default connection settings to connect to the internet via your mobile network. If the GPRS/3G/EDGE settings are not pre-configured on your phone, please contact your network operator.

Before you begin, get the following information from your network operator:

- Access Point Name (APN).
- Your user name and password if needed.
- Server IP and the port number if the network uses a proxy server.

1. Select **Menu > Settings > Connections > Access point settings**. Pre--configured settings are displayed here.

2. Press **Options > Add** to add a new APN. Enter the information obtained from your operator.

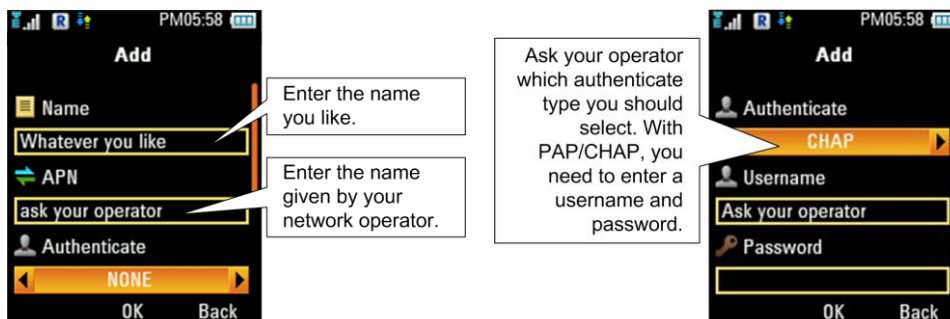

3. Press **OK Key** to save.

4. Select **Menu > Settings > Connections > Profile connect**. Pre-configured settings are displayed here.

5. Press **Add** to add a new connection setting. Enter the information obtained from your operator.

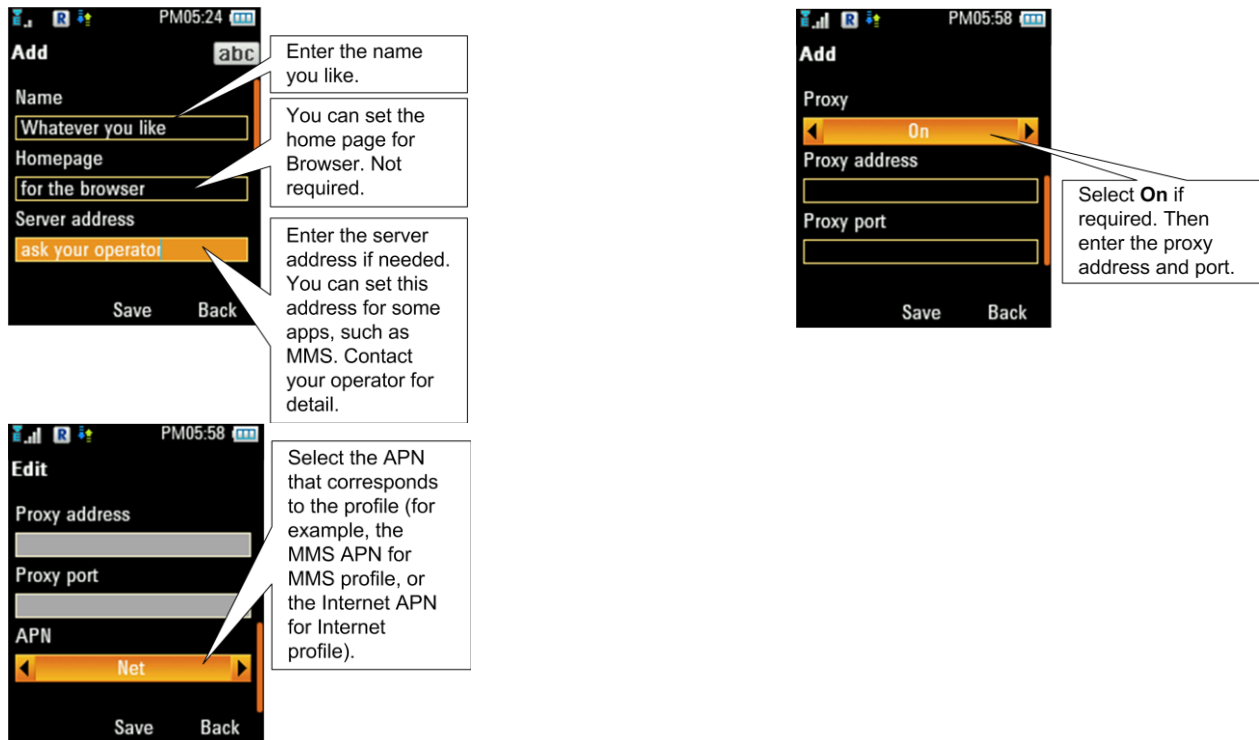

6. Press **OK Key** to save.

## To configure the browser network settings

Before using Browser to surf the internet, you should configure the browser networking settings first.

1. Select **Menu > Browser > Settings > Connection settings**.
2. Select the connection you'd like to use (see *How to set your phone-To add a new connection*).
3. Press **Activate**.

## To configure the MMS networking settings

Before sending an MMS, you should configure the MMS networking settings first.

1. Select **Menu > Messages > Settings > Mul. Msg. Settings**.
2. Use **Up/Down Key** to select **Connections** and use **Left/Right Key** to choose a connection you'd like to use (see *How to set your phone-To add a new connection*).
3. Press **OK**.

## To configure your mailbox

Before sending and receiving an E-mail, you should configure your mailbox first.

1. Select **Menu > Messages > Email tab > Settings > Mailbox Settings**.
2. Select **Options > New** to add a new mailbox, or select **Options > Edit** to edit the default mailbox.

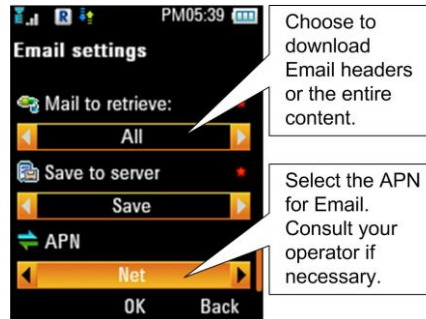
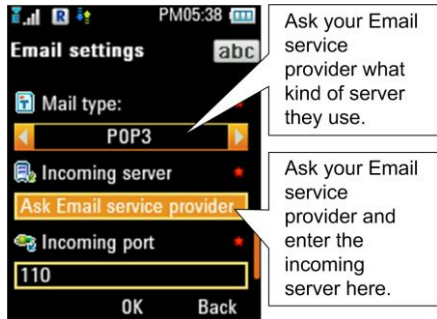
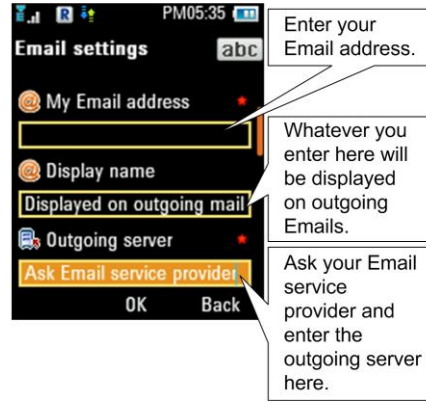
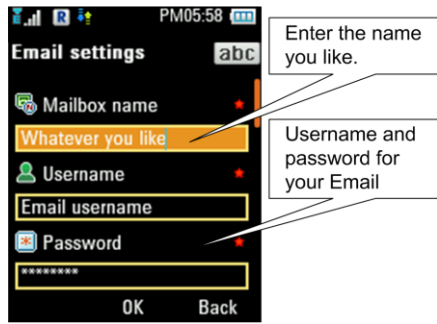

3. Press **OK** Key to save.

### To configure the streaming settings

1. Select **Menu > Multimedia > Video > Streaming URL.**
2. Select **Options > Network settings**, or **Setting** when there is no bookmark.

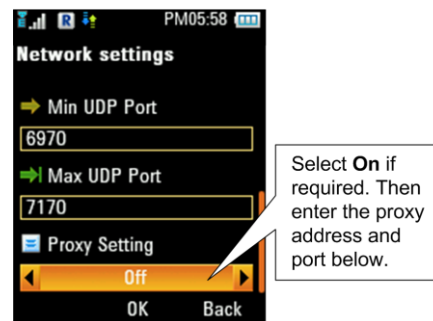
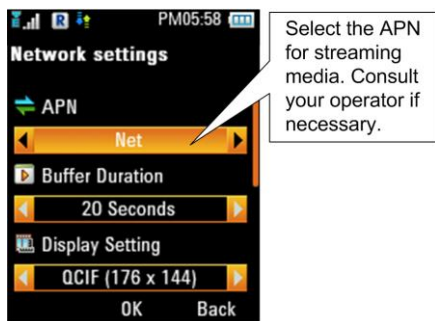

3. Press **OK** Key to save.

# Chapter 5

## **Declaration of RoHS Compliance**



To minimize the environmental impacts and take more responsibilities to the earth we live on, this document shall serve as a formal declaration that the F116 Series manufactured by ZTE CORPORATION is in compliance with the Directive 2002/95/EC of the European Parliament - RoHS (Restriction of Hazardous Substances) with respect to the following substances:

1. Lead (Pb)
2. Mercury (Hg)
3. Cadmium (Cd)
4. Hexavalent Chromium (Cr (VI))
5. Polybrominated biphenyls (PBBs)
6. Polybrominated diphenyl ethers (PBDEs)

The F116 Series manufactured by ZTE CORPORATION, meets the requirements of EU 2002/95/EC.

# Chapter 6

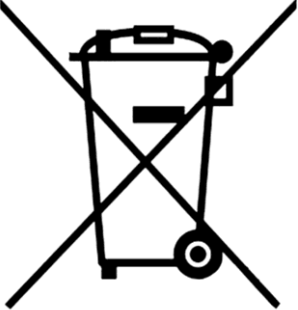
## Disposal of Your Old Appliance

 	<ol style="list-style-type: none"><li>1. When this crossed-out wheeled bin symbol is attached to a product, it means the product is covered by the European Directive 2002/96/EC.</li><li>2. All electrical and electronic products should be disposed of separately from the municipal waste stream via designated collection facilities appointed by the government or the local authorities.</li><li>3. The correct disposal of your old appliance will help prevent potential negative consequences for the environment and human health.</li></ol>
--	---

For this product's Recycling Manual based on WEEE directive, please send an e-mail to [weee@zte.com.cn](mailto:weee@zte.com.cn), or visit the website below to download the document:

<http://ensupport.zte.com.cn>