

**GSM Tri-Band GPRS Digital
Mobile Phone
User Manual**

The manual is applicable for ZTE-G A661 mobile phone.

FCC COMPLIANCE STATEMENT

This device complies with part 15 of the FCC Rules. Operation is subject to the following two conditions: (1) This device may not cause harmful interference, and (2) this device must accept any interference received, including interference that may cause undesired operation.

NOTE: This equipment has been tested and found to comply with the limits for a Class B digital device, pursuant to part 15 of the FCC Rules. These limits are designed to provide reasonable protection against harmful interference in a residential installation. This equipment generates, uses and can radiate radio frequency energy and, if not installed and used in accordance with the instructions, may cause harmful interference to radio communications. However, there is no guarantee that interference will not occur in a particular installation. If this equipment does cause harmful interference to radio or television reception, which can be determined by turning the equipment off and on, the user is encouraged to try to correct the interference by one or more of the following measures:

- Reorient or relocate the receiving antenna.
- Increase the separation between the equipment and receiver.

- Connect the equipment into an outlet on a circuit different from that to which the receiver is connected.
- Consult the dealer or an experienced radio/ TV technician for help.

Warning

Changes or modifications made to this equipment not expressly approved by ZTE for compliance could void the user's authority to operate the equipment.

Health and safety information

The phone with internal antenna has been tested for compliance with FCC RF Exposure (SAR) limits and is complied with FCC RF exposure compliance requirements.

Exposure to radio frequency energy

Radio wave exposure and Specific Absorption Rate (SAR) information The handset is designed to comply with safely, requirements for exposure to radio waves. This requirement is based on scientific guidelines that include safety margins designed to assure the safety of all persons, regardless of age and health.

The radio wave exposure guidelines employ a unit of measurement known as the Specific Absorption Rate, or SAR. Tests for SAR are conducted using a standardized method with the phone transmitting at its highest certified power level in all used frequency bands. While there may be differences between the SAR levels of various ZTE phone models, they are all designed to meet the relevant guidelines for exposure to radio waves.

The SAR limit recommended is 1.6W/kg averaged over one(1) gram of tissue. The highest SAR value for this device when tested at the ear was 1.39W/kg, and when tested at the body it was 1.47W/kg SAR compliance for bodyworn operations is restricted to belt-clips, holsters, or similar accessories that have no metallic component in the assembly and which provide at least 1.5 cm separation between the device, including its antenna, and the users body.

Legal Information

Copyright © 2009 by ZTE CORPORATION

All Rights Reserved

Your mobile phone is made by ZTE CORPORATION.

No part of this manual may be reproduced or transmitted in any form or by any means without prior written consent of ZTE CORPORATION.

Trademarks

ZTE and the ZTE logos are trademarks of ZTE CORPORATION.

Notice

The information in this manual is subject to change without notice. Every effort has been made in the preparation of this manual to ensure accuracy of the contents, but all statements, information, and recommendations in this manual do not constitute a warranty of any kind, expressed or implied. Please read the safety precautions carefully to ensure the correct and safe use of your mobile phone. For detailed information, refer to the section “Safety Precautions”.

ZTE CORPORATION Address:

ZTE Plaza, Keji Road South, Hi-tech Industrial Park, Nanshan District, Shenzhen,
P. R. China

Postal Code: 518057

Website: <http://www.zte.com.cn>

Release: V1.0.0

Manual number: 079584500373

Table of Contents

SECURITY	7	CREATING A CONTACT ON YOUR PHONE BOOK	23
SAFETY PRECAUTIONS.....	7	MAKING AND RECEIVING CALLS	23
LIMITATION OF LIABILITY	13	SENDING SMS	24
KEY FUNCTIONS.....	14	SENDING MMS	24
BATTERY	16	RECEIVING A MESSAGE..	25
INSERTING THE SIM CARD	17	SETTING YOUR PHONE ...	26
WHAT IS A SIM CARD?	19	SETTING YOUR ALARM ...	26
INSERTING THE SD CARD	19	USING YOUR BLUETOOTH	27
CHARGING THE BATTERY	20	USING JAVA.....	28
POWERING ON/ OFF YOUR PHONE	21	USING YOUR CAMERA.....	28
WRITING TEXT	21	WAP	29
		FM RADIO	29

Security

- To protect your mobile phone from illegal use, take the security measures as follows:
 - Set PIN codes of the SIM card.
 - Set handset lock code.
 - Set call restrictions.

Safety Precautions

This section includes some important information on safe and efficient operation. Please read this information before using the phone.

Operational Precautions

- Please use your phone properly. When making or receiving a call, please hold your phone as holding a wireline telephone. Make sure that the phone is at least one inch (about two point five centimeters) from your body when transmitting.
- Do not touch the antenna when the phone is in use. Touching the antenna area affects call quality and may cause the phone to operate at a higher power level than needed.
- Some people may be susceptible to epileptic seizures or blackouts when

exposed to flashing lights, such as when watching television or playing video games. If you have experienced seizures or blackouts, or if you have a family history of such occurrences, please consult your doctor before playing video games on your phone or enabling a flashing-light feature on your phone. (The flashing-light feature is not available on all products.)

- Keep the phone out of the reach of small children. The phone may cause injury if used as a toy.

Precautions While Driving

- Please pay attention to the traffic safety. Check the laws and regulations on the use of your phone in the area where you drive. Always obey them.
- Use hands-free function of the phone, if available.
- Pull off the road and park before making or answering a call if conditions require.

Precautions for Medical Devices and Facilities

- When using your phone near pacemakers, please always keep the phone more than eight inches (about twenty centimeters) from the pacemaker when the phone is switched on. Do not carry the phone in the breast pocket. Use the ear opposite the pacemaker to minimize the potential for interference. Switch off the phone immediately if necessary.
- Some phones may interfere with some hearing aids. In the event of such interference, you may consult your hearing aids manufacturer to discuss alternatives.

- If you use any other personal medical device, please consult the manufacturer of your device to determine if it is adequately shielded from RF energy.
- In those facilities with special demand, such as hospital or health care facilities, please pay attention to the restriction on the use of mobile phone. Switch off your phone if required.

Mobile Phone

- Please use original accessories or accessories approved by the phone manufacturer. Using any unauthorized accessories may affect your mobile phone's performance, damage your phone or even cause danger to your body and violate related local regulations about telecom terminals.
- Turn off your phone before you clean it. Use a damp or anti-static cloth to clean the phone. Do not use a dry cloth or electrostatically charged cloth. Do not use chemical or abrasive cleaners as these could damage the phone.
- As your mobile phone can produce electromagnetic field, do not place it near magnetic items such as computer disks.
- Using the phone near electrical appliances such as TV, telephone, radio and personal computer can cause interference.
- Do not expose your mobile phone to direct sunlight or store it in hot areas. High temperatures can shorten the life of electronic devices.
- Keep your phone dry. Any liquid may damage your phone.

- Do not drop, knock or harshly treat the phone. Rough handling can break internal circuit boards.
- Do not connect the phone with any incompatible enhancement.
- Do not attempt to disassemble the mobile phone or battery.
- Do not store the phone with flammable or explosive articles.
- Do not charge the mobile phone without battery.

Precautions for Potentially Explosive Atmospheres

- Switch off your phone prior to entering any area with potentially explosive atmospheres, such as fueling areas, fuel or chemical transfer or storage facilities.
- Do not remove, install, or charge batteries in such areas. Spark in a potentially explosive atmosphere can cause an explosion or fire resulting in bodily injury or even death.
- To avoid possible interference with blasting operations, switch off your phone when you are near electrical blasting caps, in a blasting area, or in areas posted "Turn off electronic devices." Obey all signs and instructions.

Precautions for Electronic Devices

- Some electronic devices are susceptible to electromagnetic interference sent by mobile phone if inadequately shielded, such as electronic system of vehicles. Please consult the manufacturer of the device before using the phone if necessary.

Safety and General Use in Vehicles

- Safety airbag, brake, speed control system and oil eject system shouldn't be affected by wireless transmission. If you do meet problems above, please contact your automobile provider. Do not place your phone in the area over an airbag or in the airbag deployment area. Airbags inflate with great force. If a phone is placed in the airbag deployment area and the airbag inflates, the phone may be propelled with great force and cause serious injury to occupants of the vehicle.
- Please turn off your mobile phone at a refueling point, and the same to the place where the use of two-way radio is prohibited.

Aircraft Safety

- Please turn off your mobile phone before the airplane takes off. In order to protect airplane's communication system from interference, it is forbidden to use mobile phone in flight. Safety regulations require you to have permission from a crew member to use your phone while the plane is on the ground.
- If the mobile phone has the function of automatic timing power-on, please check your alarm setting to make sure that your phone will not be automatically turned on during flight.

Battery Use

- Do not short-circuit the battery, as this can cause the unit to overheat or ignite.

- Do not store battery in hot areas or throw it into fire. Otherwise, it will cause explosion.
- Do not disassemble or refit the battery. Otherwise, it will cause liquid leakage, overheating, explosion and ignition of the battery.
- Please store the battery in a cool dry place if you don't use it for a long period.
- The battery can be recharged for hundreds of times, but it will eventually wear out. When the operating time (talk time and standby time) is noticeably shorter than normal, it is time to replace it with a new one.
- Please stop using the charger and battery when they are damaged or show evidence of aging.
- Return the worn-out battery to the provider or dispose of it in accordance with environment regulations. Do not dispose of it in household rubbish.
- Please use original batteries or batteries approved by the phone manufacturer. Using any unauthorized battery may affect your handset performance or may cause danger of explosion, etc.

Warning: If the battery is damaged, do not discharge it. If the leakage does come into contact with the eyes or skin, wash thoroughly in clean water and consult a doctor.

Limitation of Liability

ZTE shall not be liable for any loss of profits or indirect, special, incidental or consequential damages resulting from or arising out of or in connection with using this product, whether or not ZTE had been advised, knew or should have known the possibility of such damages. The user should refer to the enclosed warranty card for full warranty and service information.

Note: The pictures and icons shown in the manual are just schematic drawings for function demonstration. If they are inconsistent with your handset, please take your handset as the standard. If the inconsistency exists in the manual because of the handset function updating, please refer to the follow-up public information from ZTE CORPORATION.

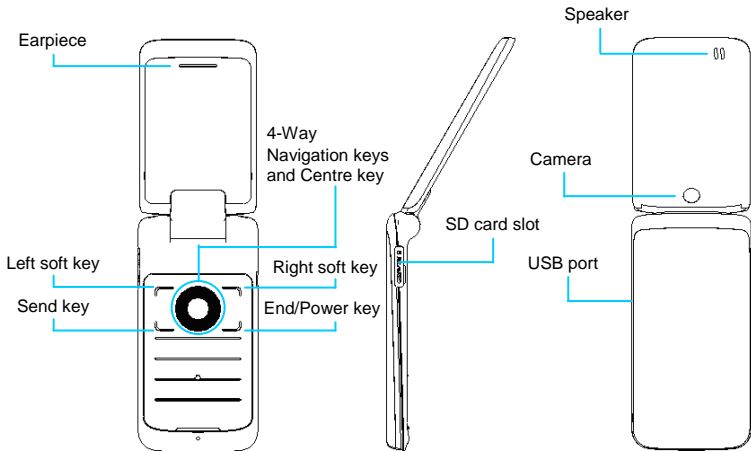

Key Functions



Function	Description
Earpiece	Listen to a phone call.
USB port	For charging the battery, connect to the earpiece and connect to the PC.
Left soft key	Perform the function indicated at the left bottom of the screen.
Right soft key	Perform the function indicated at the right bottom of the screen.
Centre key	Confirm actions and make selections.
4-Way Navigation keys	These keys (UP, DOWN, LEFT and RIGHT) allow for navigation through menu options and quick accessing to some function menus: UP-Audio Player, DOWN -Alarm, LEFT -User Profiles, RIGHT - Tone Setup.
Send key	Dial a phone number or answer a call, or view the call history.
End/Power key	Press to exit to the standby mode. Hold to switch off/on the phone.
Camera	Built-in camera.
Speaker	Listen to system sound, conversation, and music.
SD card slot	For inserting the SD card.

Note: In this User Manual, “press a key” means to press the key and release it, while “hold a key” means to press the key for at least two seconds and then release it.

Interface icons

	Signal strength		New message
	Call diverting		Silent
	Alarm clock set		GPRS online
	Vibration		Battery status
	Headset		Ring
	Keypad locked		Missed call
	Stopwatch		New MMS

Battery

The lithium ion battery of the mobile phone can be immediately used after unpacking.

Installing the battery

1. Insert the battery by aligning the gold-colored contacts with the contacts in the battery slot.
2. Push down the upper section of the battery until it clicks into place.
3. Replace the battery cover and close it gently until you hear a click.



Push down the battery



Replace the battery cover

Removing the battery

1. Make sure that your mobile phone is switched off.
2. Remove the battery cover.
3. Pull the battery up and remove it from the mobile phone.



Remove the battery cover



Pull up the battery from here

Inserting the SIM card

You want a mobile phone that is sophisticated yet easy to use and here it is in your hands! Naturally you are eager to start using it, but first you need to insert the SIM card.

Insert the SIM card as follows:

- Make sure that the phone is switched off and the charger is disconnected from the phone.
- Turn the phone over and remove the battery cover.
- Remove the battery if it is already installed.
- Hold your SIM card with the cut corner oriented as shown and then slide it into the card holder with the gold-colored contacts facing downward.
- Replace the battery first.
- Replace the battery cover.



Insert the SIM card

What is a SIM card?

Every mobile phone has a SIM card (Subscriber Identity Module). This is a micro-chip that holds your personal information such as names and phone numbers. Your phone won't work without it. If you already have contacts on your SIM card, they can be transferred in most cases.

Inserting the SD Card

You can use SD card to expand the storage of the phone. You can store or copy files such as videos, photos, music, and so on.

Do not take out the card or switch off the phone while transmitting or storing data, which may cause data loss or damage to the phone or the card.

Insert the SD card as follows:

- The SD card slot is on the left side of the phone. Open the cover. Insert the card with the metal contacts facing down until it clicks to the right position.

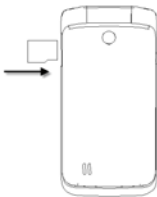

Insert the SD card

Charging the battery

Your phone is powered by a rechargeable battery. For maximum battery performance, it is recommended that you first use up the battery power and then charge it completely. A new battery's full performance is achieved only after three complete charge and discharge cycles.

- Connect your travel adapter to the side of your mobile phone as shown in the diagram.
Note: The side with arrow should be down while connecting.
- Connect the other end of the travel adapter to the mains socket.
- When you charge the battery, the battery indicator appears with the bars moving from right to left.

- When the battery is fully charged, disconnect the charger.

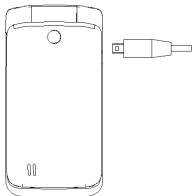

Insert

Powering on/ off your phone

Make sure that your SIM card is in your mobile phone and that the battery is charged.

Please hold the End/Power key to power on/off the phone. The phone will automatically search for the network.

Writing text

- Change input mode: Press the # key to change the input mode (input modes: eZien、eZiEN、ABC、abc、123).

- Input Letters: In abc/ABC mode, press the corresponding letter key till the letter appears.
- Input Words: In eZien、 eZiEN、 ABC and abc mode, input any letter with a single key press. Press each key only once for every letter. The word changes after each key stroke. Predictive text input is based on a built-in dictionary. When you have finished writing the word and it is correct, confirm it by pressing the 0 key or the Centre key. If the word is incorrect, press the Up/Down keys to view other matching words found in the dictionary. Pressing the Navigation keys moves the cursor.
- Input Digits: In 123 mode, press digit key once to input a digit. In abc/ABC mode, constantly press the digit key until the number appears.
- Input Symbol: Press the * key to enter a symbol. In abc/ABC mode, constantly press the 1 key till the required symbol (common symbols) appears.
- Input Space: Press the 0 key to input space. It does not work in 123 mode.
- Delete Character: Press the C key to clear a character. Hold the C key to delete all characters and clear the display.
- Move Cursor to Left or Right: Press the Left/Right navigation keys to move the cursor to left or right.

Creating a contact on your Phone Book

There are some numbers that you may want to call again and again, so it makes sense to add these numbers to your phone book. You can then access these numbers quickly and easily.

- Go to **Menu**→**Phone Book**→**Add New Entry**.
- Select to save the number to SIM or Phone, then enter the contact's phone number.
- Edit the information and confirm by pressing the Left soft key [OK] or the Centre key.
- You can also save a number right after you've made or received a phone call or a text message from someone who is not yet in your phone book list.
- To delete someone from your phone book list, first select the name, then press the Left soft key [Option] and choose Delete.

Making and receiving calls

The most basic way to make a call is to input the number in the standby mode and press the Send key. You can also make a call from the phone book list.

- To call someone: Go to **Menu**→**Phone Book**→**Quick Search**. Use the Up/Down keys to find the name of the person you want to call. You can also type in the first letter of the name of the person you want to call, and press the Send key.

- To receive a call, press the Send key.
- To end a call, press the End/Power key.

Make sure that you are in an area with sufficient coverage to make calls. The strength of the network signal is indicated on the Status Bar of the screen.

Sending SMS

You can use your mobile phone to send and receive text messages.

1. Go to **Menu**→**Messages**→**SMS**→**Write Message**.
2. Write your message. For more information on writing, see section 'Writing text'.
3. When you finish writing, press Left soft key [Option]to select **Done**, then press [ok].
4. Select **Send** to send the message to one person.
To send to more than one person, select **Send To Many**.
5. Enter the recipient's phone number or press Left soft key [Search] to select the names from the phone book list. Then select OK to send the message.

Sending MMS

You can use your mobile phone to send and receive multimedia messages.

1. Go to **Menu**→**Messages**→**MMS**→**Write Message**.

2. Enter the mobile phone number of one or more recipients in To by selecting **Edit**→**Add Number**.
3. When you finish writing, press Right soft key [Done] and choose to finish editing.
4. To send a copy of this message to others, move up to the Cc and Bcc fields below the To field.
5. Enter the MMS subject.
6. In the Edit Content mode, Insert text directly on the screen, use the Left soft key [Option] to Select add image/audio/video/attachment and so on.
7. When you finish writing, press Left soft key [Option] and choose **Done** to finish editing; choose **Preview** to preview the mms.
8. When you press **Done** in the MMS editing screen, then select **Send** only to send the message.

Receiving a message

Upon receiving a message, the mobile phone indicates with ringtone, prompt, or a new message icon.

1. Press the Left soft key to open the new message. You can also go to Inbox to read the message.
2. Use the Up/Down keys to read the message.
3. While the message is open, use the Left soft key [Option] to reply, delete, or forward the message. You can also call back to the sender or extract the

sender's number.

Setting your phone

You can adjust various settings of your phone.

- Phone settings: Select language, set the dedicated key and so on.
- Display settings: Select your favorite wallpaper and adjust the screen's contrast and brightness.
- Clock settings: Set date and time, and date format.
- Security settings: Security features protect you from illegal use of your phone and SIM card. You can select to turn on/off the automatic keypad locking function.

Note: You need to input the handset lock code to enter the security settings interface. The default lock code is 1234.

Setting your alarm

- Set alarm: Select Alarm submenu, you can set the corresponding features of the alarm according to instructions: alarm type (if required), date, time, and ringtone.
- List alarms: Select List alarms submenu, you can view, edit the alarm clocks settings. You can also enable or disable the alarms.

Using your Bluetooth

The Bluetooth devices must be paired before the communication is performed.

Turn on or off Bluetooth on your phone

Go to **Menu**→**Organizer**→**Bluetooth**→**Power**, you can turn on or off Bluetooth.

Make your phone visible

Go to **Menu**→**Organizer**→**Bluetooth**→**Setting**→**Visibility**, you can choose on or off to make your phone visible or invisible.

When your phone is visible, the Bluetooth is turned on, and all other Bluetooth-enabled devices within range can detect your phone.

Create a Bluetooth partnership

1. Go to **Menu**→**Organizer**→**Bluetooth**→**My Device**, select **Option**→**Inquiry New Device** to search other Bluetooth-enabled devices and list them.
2. Select the desired device name in the list and press Bond.
3. Enter a passcode (1 up to 16 characters) to establish a secure connection, then press Next.

Beam information using Bluetooth

After the Bluetooth partnership, you can beam information, such as contacts, calendar items, and tasks, as well as files from your phone to another Bluetooth-enabled device.

Connect a Bluetooth hands-free or stereo headset

For hands-free phone conversations or to listen to music, you can use a Bluetooth hands-free or stereo headset.

Go to **Menu**→**Organizer**→**Bluetooth**→**Inquiry Audio Device** to search the Bluetooth hands-free or stereo headset.

Using Java

MIDlets are Java™-based applications that can run on your phones. It supports Java 2 Edition, J2ME™. Java allows you to download Java-based applications, such as games and tools that are specifically designed for mobile phones. Java gives you the flexibility of installing and managing additional J2ME applications from the Internet.

Using your camera

Take a Photo

Go to **Menu**→**Multimedia**→**Camera** to take a photo.

Aim the camera at the subject and then press the Center key to take the shot.

Before capturing a photo, press the Up key to zoom in, press the Down key to zoom out; press the Left/Right key to change the brightness value.

Configure Your Camera

Go to **Menu**→**Multimedia**→**Camera** press **Option** to configure your camera, including white balance, ISO, Scene Mode and so on.

WAP

The WAP browser feature on your phone allows you to view internet content.

- You can view the homepage when it has been set or input the website address to view the web pages.
- The current website addresses can be saved as bookmarks on your phone.
- You can set the features of WAP browser.
- You can check the previously viewed web addresses and GPRS information.

FM Radio

With the radio, you can search for radio channels, listen to them, and save them on your device. Note that the quality of the radio broadcast depends on the coverage of the radio station in that particular area. The wired headset works as an antenna, so always connect the headset when using the radio. When you receive an incoming call while listening to the radio, the radio will be turned off temporarily. And when the call is ended, the radio will be turned on.

You can scan for channels automatically or tune them manually. The channels can also be set by inputting valid frequencies.

To adjust the volume, press the Up/Down keys.

The channels can be stored in a channels list. Open the list to view the information of the saved channels.