

MF730M
DC-HSPA+ USB MODEM
Your Quick Guide

ZTE CORPORATION
NO. 55, Hi-tech Road South, ShenZhen, P.R.China
Postcode: 518057
Tel: +86-755-26779999
URL: <http://www.zte.com.cn>
E-mail: mobile@zte.com.cn

LEGAL INFORMATION

Copyright © 2013 ZTE CORPORATION.

All rights reserved.

This guide is published by ZTE Corporation, which reserves the right to amend or update its content without prior notice. No part of this guide may be reproduced, translated or used in any form or by any means, electronic or mechanical, including photocopying and microfilm, without the prior written permission of ZTE Corporation.

Version No.: 1.0

Edition Time: 2013, 07

Welcome

The ZTE MF730M USB modem works on all the following networks: DC-HSDPA; HSPA+; HSUPA; WCDMA; EDGE; GPRS, and GSM.

Getting to know your device

1. microSD card slot
2. SIM/USIM card slot
3. USB Connector
4. Modem Cap
5. Front Cover

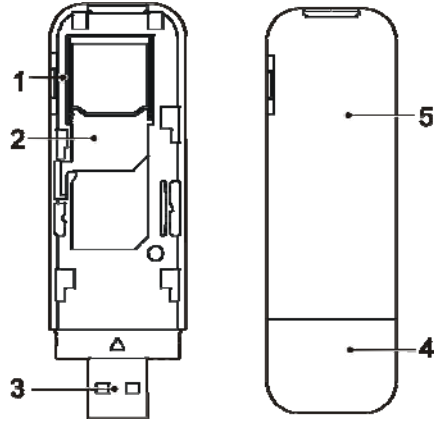

(Device appearance and detail may vary.)

Understanding the indicator light

Indicator status	Description
Red	On but not connected to network
Green Blinking	Connecting to 2G/3G and data transfer
Green Solid	Connected to 2G/3G

Five simple steps and you'll be online...

1. Open the front cover – gently sliding it back to avoid damage.

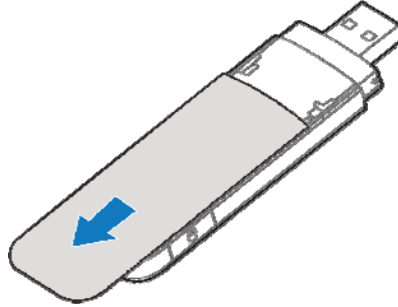

2. Insert a standard-size SIM card.

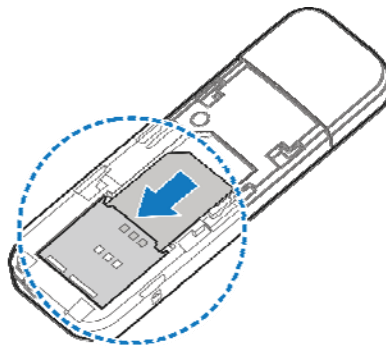

3. If you have one, Insert the microSD card.

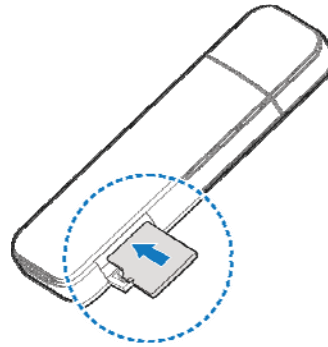

This modem only supports microSD card. (The microSD Logo () is a trademark of SD Card Association.)

4. Replace the front cover, clicking it into place.

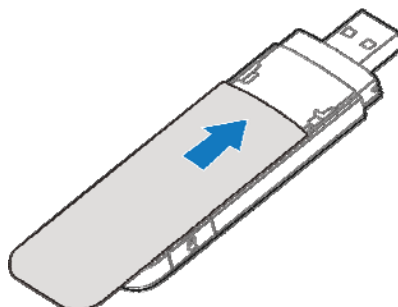

5. Firmly plug the USB connector into your computer's USB port.

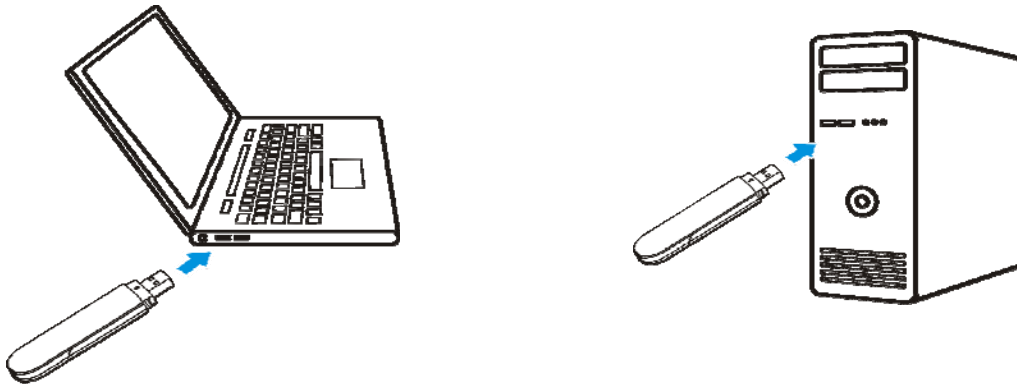

The computer operating system will automatically recognise the new hardware. Depending on the make and operating system of your PC, you will be taken to the operator's landing page or the device administration page (if the device doesn't connect). The LED indicator lights (see above) will show the connectivity status during the start up process.

6. Settings – Accessing the Web User Interface (UI).

From the Home page of the Web UI you can access the main settings for: Statistics, Messages, Updates, Settings and to check the device status. You can access the URL (<http://m.home> or <http://192.168.0.1>) via your web browser.

You should never need to change the settings; this is recommended for advanced users only.

Disconnect from the Network - To disconnect from the network, just remove the dongle from the PC directly.

Staying safe

- Some electronic devices – like vehicle systems – are susceptible to electromagnetic interference from modems. If you are concerned, please consult the device manufacturer before using your modem.
- Modems can interfere with medical devices, such as hearing aids and pacemakers. Please consult a doctor or the manufacturer of the device before using yours. And always keep it more than 20cm away from medical devices.
- Always turn off your modem in potentially explosive environments, such as chemical factories, unless you have been told by a qualified professional that it is safe to use.
- The use of electronic transmitting devices is forbidden in aircrafts, at petrol stations and in some hospitals. Please observe and obey all warning signs and switch off your modem when requested.
- Please keep your modem out of the reach of children. It's not a toy and could cause

injury.

- When the modem is on, please don't touch its metallic parts. They get hot and could burn you.

Taking care

- Try not to touch any internal parts, such as the antenna, as it could affect your modem's performance.
- Only use original or authorised accessories with your modem. Unauthorised accessories may affect your modem's performance, violate telecom regulations or invalidate the warranty.
- Don't be tempted to dismantle your modem. Remember that only qualified technicians can undertake repair work, otherwise your warranty will become void.
- Your modem might not work so well near or inside metallic structures or establishments which emit electromagnetic waves and interfere with the signal.
- Your modem is not waterproof. Please keep it dry and store in a cool place, out of direct sunlight.
- To avoid producing potentially damaging condensation inside and outside the modem, do not use it immediately after a sudden temperature change. Please wait until it dries before using it. (An operating temperature range of -10°C ~ +55°C and humidity range of 5% ~ 95% is what we recommend.)
- Your modem is a delicate device and needs careful handling to avoid damage. It won't like being dropped, bent or bashed.

Got a question or a problem? Please contact your network operator.

C € 0700

Troubleshooting

Problem	Solution
You've plugged it into the USB port but nothing is happening...	<ul style="list-style-type: none">● Install the software. Run the installation program: My Computer > ZTEMODEM● Reinstall the driver software. You'll need to uninstall the software first.
You can't get onto the Internet...	<ul style="list-style-type: none">● Make sure the SIM card is correctly inserted in its slot.● Check the signal – if it's poor, find a location where the signal is stronger.● Contact your network operator.
You can't visit the webGUI configuration page...	<ul style="list-style-type: none">● Enter the correct address. The default address is http://192.168.0.1 or http://m.home.● Make sure you only have one network adapter connected to your PC.● Don't use a proxy server.

Your Limited Warranty

- This warranty does not apply to defects or errors in the product caused by:
 - i. Reasonable abrasion.
 - ii. Failure to follow ZTE's installation, operation or maintenance instructions or procedures.
 - iii. Mishandling, misuse, negligence, or improper installation, disassembly, storage, servicing or operation of the product.
 - iv. Modifications or repairs not made by ZTE or a ZTE-certified individual.
 - v. Power failures, surges, fire, flood, accidents, actions of third parties or other events outside ZTE's reasonable control.
 - vi. Third party products or usage in conjunction with third party products, provided that such defects are due to the combined usage.
 - vii. Any other cause beyond the range of normal usage intended for the product.

There is no right to reject or return the product, or receive a refund from ZTE under the above-mentioned situations.

- This warranty is the end user's sole remedy and ZTE's sole liability for defective or nonconforming items, and is in lieu of all other warranties, expressed, implied or

statutory, including but not limited to the implied warranties of merchantability and fitness for a particular purpose, unless otherwise required under the mandatory provisions of the law.

Limitation of Liability

ZTE shall not be liable for any loss of profits or indirect, special, incidental or consequential damages resulting from or arising out of, or in connection with, using this product, whether or not ZTE had been advised, knew or should have known of the possibility of such damages, including, but not limited to lost profits, interruption of business, cost of capital, cost of substitute facilities or products, or any downtime cost.

FCC Regulations:

This device complies with part 15 of the FCC Rules. Operation is subject to the following two conditions: (1) This device may not cause harmful interference, and (2) this device must accept any interference received, including interference that may cause undesired operation.

This device has been tested and found to comply with the limits for a Class B digital device, pursuant to Part 15 of the FCC Rules. These limits are designed to provide reasonable protection against harmful interference in a residential installation. This equipment generates, uses and can radiated radio frequency energy and, if not installed and used in accordance with the instructions, may cause harmful interference to radio communications. However, there is no guarantee that interference will not occur in a particular installation. If this equipment does cause harmful interference to radio or television reception, which can be determined by turning the equipment off and on, the user is encouraged to try to correct the interference by one or more of the following measures:

- Reorient or relocate the receiving antenna.
- Increase the separation between the equipment and receiver.
- Connect the equipment into an outlet on a circuit different from that to which the receiver is connected.
- Consult the dealer or an experienced radio/TV technician for help.

Changes or modifications not expressly approved by the party responsible for compliance could void the user's authority to operate the equipment.

RF Exposure Information (SAR)

This device meets the government's requirements for exposure to radio waves. This device is designed and manufactured not to exceed the emission limits for exposure to radio frequency (RF) energy set by the Federal Communications Commission of the U.S. Government. The exposure standard for wireless device employs a unit of measurement known as the Specific Absorption Rate, or SAR. The SAR limit set by the FCC is 1.6W/kg. *Tests for SAR are conducted using standard operating positions accepted by the FCC with the device transmitting at its highest certified power level in all tested frequency bands. Although the SAR is determined at the highest certified power level, the actual SAR level of the device while operating can be well below the maximum value. This is because the device is designed to operate at multiple power levels so as to use only the power required to reach the network. In general, the closer you are to a wireless base station antenna, the lower the power output. SAR compliance has been established in the host product(s) (laptop computers), tested at 5mm separation distance to the human body, and tested with USB slot configurations including Horizontal-UP, Horizontal-Down, Vertical-Front, Vertical-Back. This device can be used in host product(s) with substantially similar physical dimensions, construction, and electrical and RF characteristics. The highest SAR value, tested per FCC RF exposure guidelines for USB dongle, as described in this user guide, is 1.18 W/kg. The FCC has granted an Equipment Authorization for this device with all reported SAR levels evaluated as in compliance with the FCC RF exposure guidelines. SAR information on this device is on file with the FCC and can be found under the Display Grant section of www.fcc.gov/oet/ea/fccid after searching on FCC ID: SRQMF730M.