

**MF97B\_T**  
**User Manual**

## **LEGAL INFORMATION**

**Copyright © 2014 ZTE CORPORATION.**

**All rights reserved.**

No part of this publication may be quoted, reproduced, translated or used in any form or by any means, electronic or mechanical, including photocopying and microfilm, without the prior written permission of ZTE Corporation.

### **Notice**

ZTE Corporation reserves the right to make modifications on print errors or update specifications in this guide without prior notice.

We offer self-service for our smart terminal device users. Please visit the ZTE official website (at [www.ztedevice.com](http://www.ztedevice.com)) for more information on self-service and supported product models. Information on the website takes precedence.

### **Disclaimer**

ZTE Corporation expressly disclaims any liability for faults and damages caused by unauthorized modifications of the software.

Images and screenshots used in this guide may differ from the actual product. Content in this guide may differ from the actual product or software.

### **Trademarks**

ZTE and the ZTE logos are trademarks of the ZTE Corporation.

Google and Android are trademarks of Google, Inc.

The *Bluetooth*<sup>®</sup> trademark and logos are owned by the Bluetooth SIG, Inc. and any use of such trademarks by ZTE Corporation is under license.



microSDHC Logo is a trademark of SD-3C, LLC.

Manufactured under license from Dolby Laboratories. Dolby, Dolby Audio, and the double-D symbol are trademarks of Dolby Laboratories.



Qualcomm<sup>®</sup> Snapdragon<sup>™</sup> processors are products of Qualcomm Technologies, Inc.

Qualcomm and Snapdragon are trademarks of Qualcomm Incorporated, registered in the United States and other countries. Used with permission.

Other trademarks and trade names are the property of their respective owners.

**Version No.:** R1.0

**Edition Time:** November 14, 2014

Manual No.:

## Getting to Know Your MF97B\_T

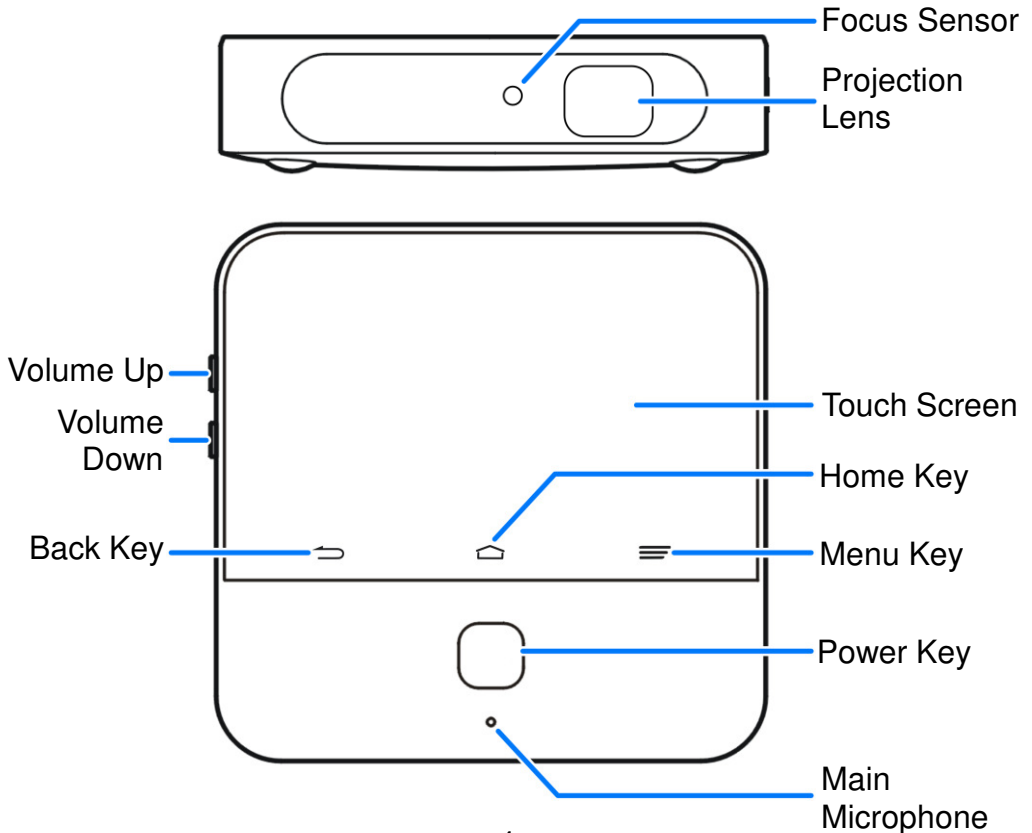

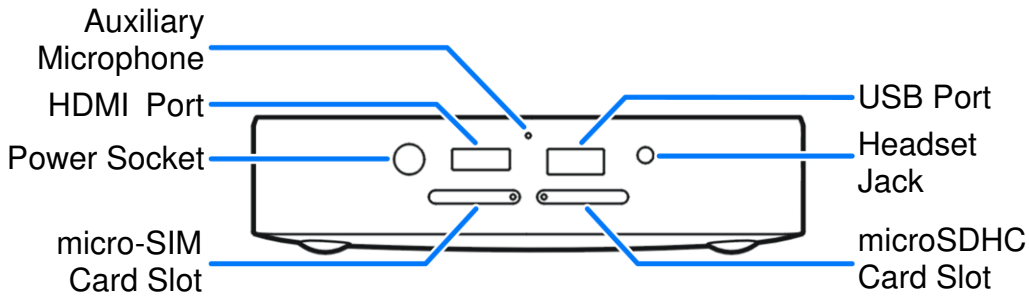

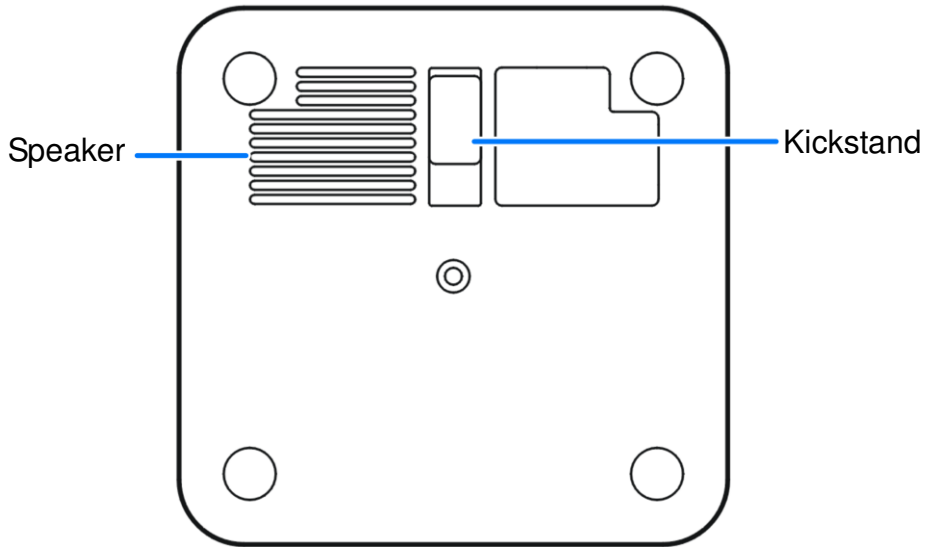

## Projection Lens

Project the display on a surface.

### **WARNING!**

Do not look directly into the projection lens or point the lens toward people or animals' eyes when the projector is on as this may cause injury to the

eyes.

## **Focus Sensor**

Analyze the clarity of the projected image in order for the projector to adjust its focus automatically.

## **Back Key**

Touch to go to the previous screen.

## **Home Key**

- Touch to return to the home screen from any application or screen.
- Touch and hold to open the Google app.

## **Menu Key**

- Touch to get the options for the current screen.
- Touch and hold to see recently used apps.

## **Power Button**

- Press and hold to enable or disable airplane mode, sound, or vibration, power off or restart your MF97B\_T.
- Press to turn off or on the screen display.

## **Volume Up/Down Button**

Press or hold to turn the volume up or down.

## **Main Microphone / Auxiliary Microphone**

Transmit your voice. The auxiliary microphone is useful for canceling ambient noise.

## **Ventilation Port**

Exhaust the hot air when the projector is on.



### **WARNING!**

Do not place anything near the ventilation holes as this may cause internal heat buildup. Do not place your hand near the ventilation holes as this may cause injury.

## **Installing the micro-SIM Card**

1. Insert the end of a small paper clip or other eject tool into the hole on the micro-SIM card tray and take the tray out of the slot.



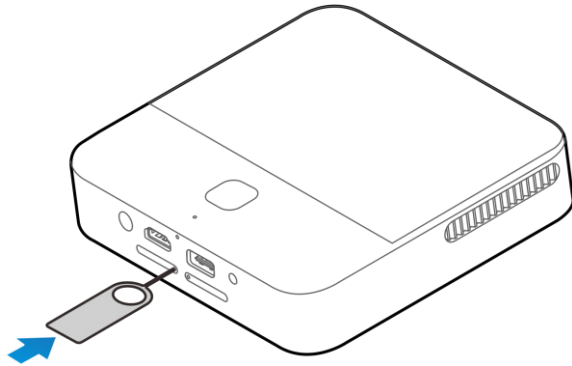

2. Place the micro-SIM card on the tray as shown and carefully install the tray back.

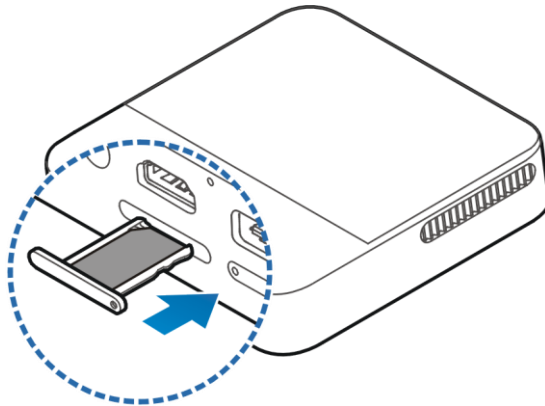

## Installing the microSDHC™ Card (Not Included)

A microSDHC card can be installed or removed while MF97B\_T is turned on. You need to unmount the microSDHC card before removing it.

1. Insert the end of a small paper clip or other eject tool into the hole on the microSDHC card tray and take the tray out of the slot.

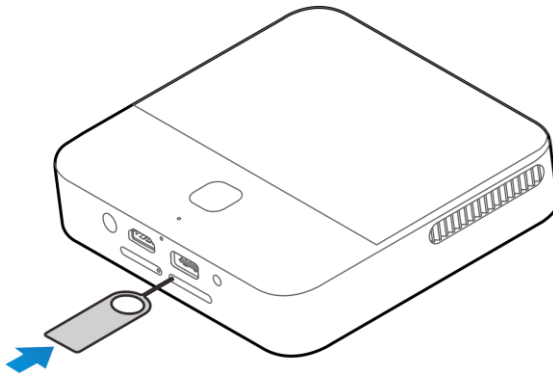

2. Place the microSDHC card on the tray as shown. Then carefully install the tray back.

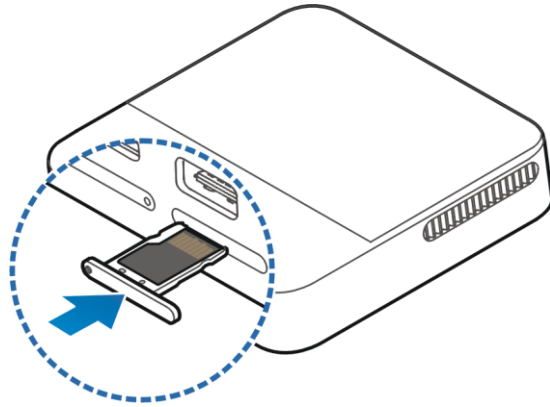

#### **NOTE:**

Some applications may require a microSDHC card to work normally or may store certain data on it. Therefore, it is recommended that you keep a microSDHC card installed and not remove or replace it randomly.

## **Charging the Battery**

Your MF97B\_T's battery should have enough power for it to turn on. You should fully charge the battery as soon as possible.



#### **WARNING!**

Use only ZTE-approved chargers and cables. The use of unapproved accessories could damage your device or cause the battery to explode.

**⚠ CAUTION:**

Do not remove or change the built-in rechargeable battery in your device by yourself. The battery can only be changed by ZTE or ZTE authorized service provider.

1. Plug the AC adapter into the power socket on your MF97B\_T and then plug the AC adapter into an electrical outlet.

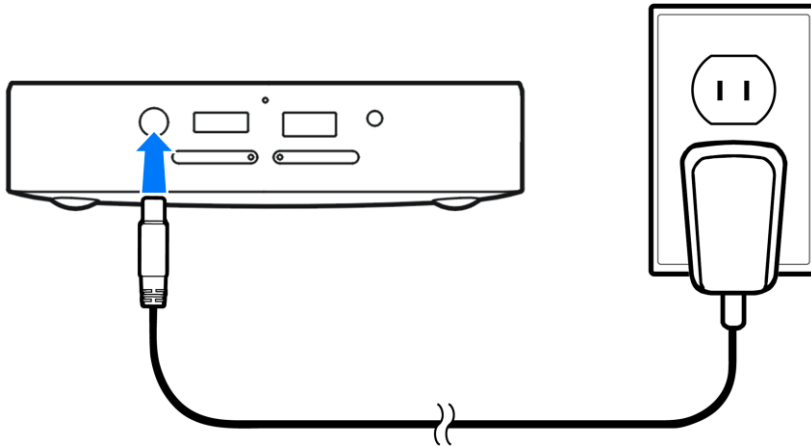

2. Disconnect the adapter when the battery is fully charged.

**📌 NOTE:**

If the battery is extremely low, you may be unable to power on the device even when it is being charged. In this case, try again after charging the device for at least 20 minutes. Contact the customer service if you still

cannot power on the device after prolonged charging.

## Powering On/Off

Ensure that the battery is charged.

- Press and hold the **Power Button** to turn on your MF97B\_T.
- To turn it off, press and hold the **Power Button** to open the options menu. Touch **Power off** and then touch **OK**.

## Restarting Your Device

If the screen freezes or takes too long to respond, try pressing and holding the **Power Key** for about 10 seconds to restart MF97B\_T.

## Waking Up Your Device

Your MF97B\_T automatically goes into sleep mode when it is not in use for some time. The display is turned off to save power and the keys are locked to prevent accidental operations.

You can wake up your MF97B\_T by turning on the display and unlocking the keys.

1. Press the **Power Key** to turn the screen on.
2. Touch and hold the screen.

## **NOTE:**

If you have set an unlock pattern, a PIN or a password for your device, you'll need to draw the pattern, or enter the PIN/password to unlock it.

## **Turning On/Off the Projector**

You can use the projector embedded in your MF97B\_T to project the display onto large surfaces.

1. Slide down the status bar at the top of the screen.
2. Touch **Project** to turn the projector on or off.

## **Using the Touch Screen**

Your MF97B\_T's touch screen enables you to control actions through a variety of touch gestures.

- Touch  
When you want to type using the onscreen keyboard, select items on the screen such as the application and settings icons, or press the onscreen buttons, simply touch them with your finger.



- Touch and Hold

To open the available options for an item (for example, a link in a web page), touch and hold the item.



- Swipe or Slide

To swipe or slide means to quickly drag your finger vertically or horizontally across the screen.



- Drag  
To drag, press and hold your finger with some pressure before you start to move your finger. While dragging, do not release your finger until you have reached the target position.



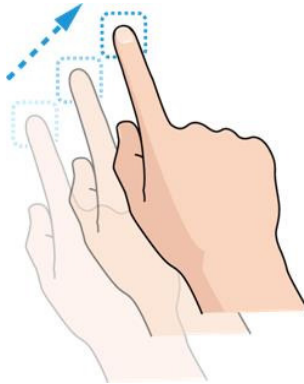

- Pinch

In some apps (such as Maps, browsers, and Gallery), you can zoom in and out by placing two fingers on the screen at once and pinching them together (to zoom out) or spreading them apart (to zoom in).

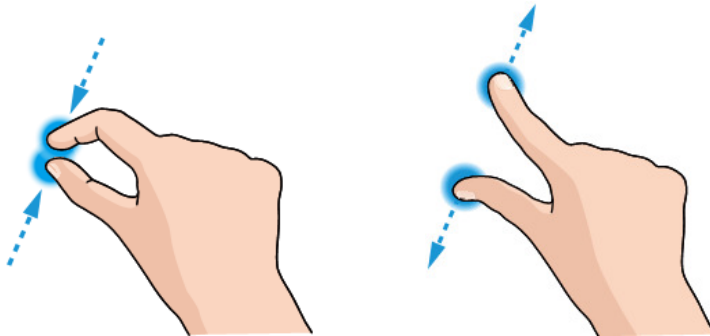

- Rotate the screen  
For most screens, you can automatically change the screen orientation from landscape to portrait by turning the MF97B\_T sideways.

## Projecting a File Saved in Your MF97B\_T

You can project a file stored in your MF97B\_T.

1. Open the file you want to project.
2. Turn on the projector.
3. Adjust the projection distance and place the MF97B\_T on a flat surface.



### **NOTE:**

For best results, project onto a flat screen at a 90° angle to the floor.

When you want to finish the projection, turn off the projector.

## Projecting an HDMI Source

You can project an HDMI source when connecting your MF97B\_T to a laptop or TV box.

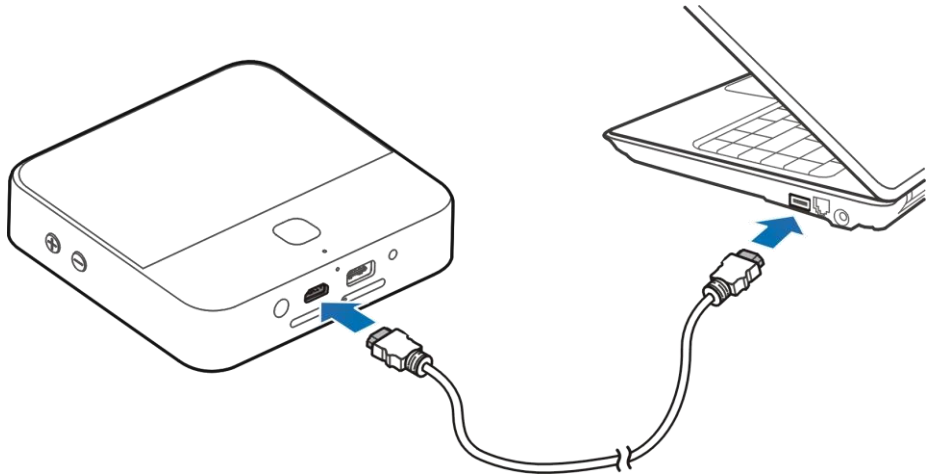

1. Connect your MF97B\_T with the laptop or TV box via the supplied HDMI cable.
2. Turn on the projector.
3. Slide down the status bar at the top of the screen and touch **HDMI**.
4. Operate your laptop or TV box to select the content you want to view.

## Projecting a File Saved in Your USB Flash Drive

You can project a file stored in the USB flash drive.

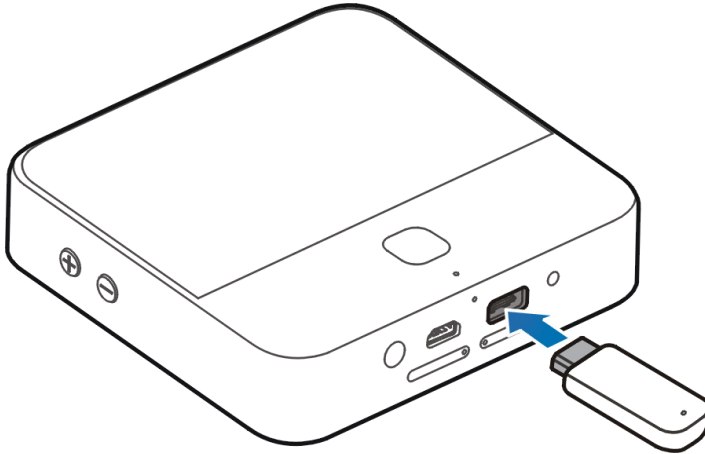

1. Connect your MF97B\_T with the USB flash drive via the USB port.
2. Touch the **Home Key > APPS tab > File Manager**.
3. Touch **USB Device** to open the file you want to project.
4. Turn on the projector.

 **NOTE:**

Before connecting your MF97B\_T with the USB flash drive, slide the status bar down to open the notification panel and ensure that the **Connect to PC** option is not highlighted.

## Projecting a Source on Your Phone (Wi-Fi Display)

You can display the content of your phone on your MF97B\_T with a wireless link.

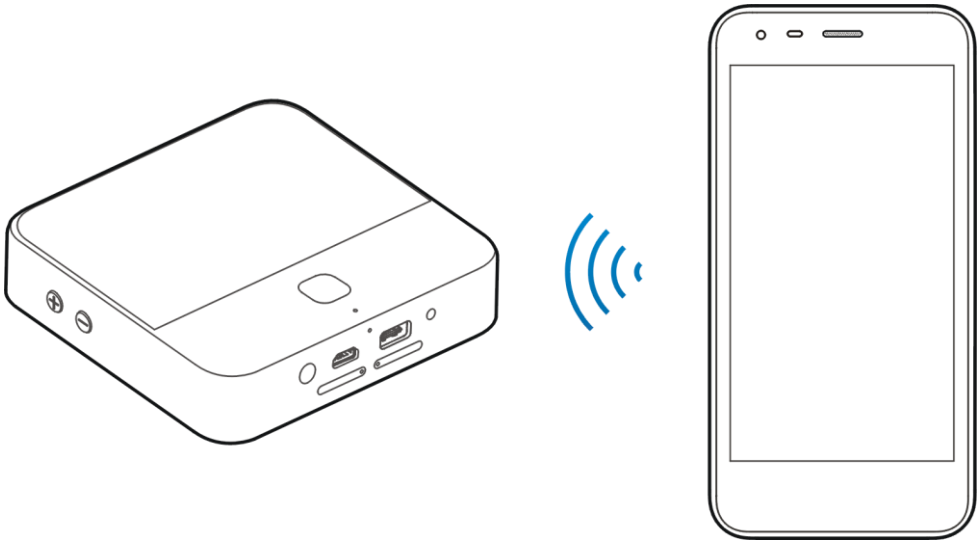















1. Turn on the projector.
2. Touch the **Home Key** > **APPS** tab > **Miracast**.
3. Open a Wi-Fi display application on the phone to scan for available devices within range.

4. When you see the name of your MF97B\_T displayed in the available devices section, touch the name. The phone then automatically tries to pair with your MF97B\_T.
5. Touch **Accept** on your MF97B\_T. After successful connection, the contents in the phone will be displayed on the projector.
6. Choose the content you want to display.

# For Your Safety

## General Safety

|  |   |   |   |
|--|---|---|---|
|  | Small parts may cause choking.                                  |  | Don't use at gas stations.  |
|  | Your device can produce a loud sound.                           |  | Your device may produce a bright or flashing light.                                       |
|  | Avoid contact with anything magnetic.                           |  | Don't dispose of your device in fire.   |
|  | Keep away from pacemakers and other electronic medical devices. |  | To prevent possible hearing damage, do not listen at high volume levels for long periods. |
|  | Turn off when asked to in hospitals and medical facilities.     |  | Avoid extreme temperatures.   |
|  | Turn off when told to in aircrafts and airports.                |  | Avoid contact with liquids. Keep your device dry.   |

|  |  |   |  |
|--|--|---|--|
|  | Turn off when near explosive materials or liquids. |  | Do not attempt to disassemble your device. |
|  | Only use approved accessories.                     |   |  |

## FCC Regulations:

This mobile phone complies with part 15 of the FCC Rules. Operation is subject to the following two conditions: (1) This device may not cause harmful interference, and (2) this device must accept any interference received, including interference that may cause undesired operation.

This mobile phone has been tested and found to comply with the limits for a Class B digital device, pursuant to Part 15 of the FCC Rules. These limits are designed to provide reasonable protection against harmful interference in a residential installation. This equipment generates, uses and can radiated radio frequency energy and, if not installed and used in accordance with the instructions, may cause harmful interference to radio communications. However, there is no guarantee that interference will not occur in a particular installation. If this equipment does cause harmful interference to radio or television reception, which can be determined by turning the equipment off and on, the user is encouraged to try to correct the interference by one or more of the following measures:



- Reorient or relocate the receiving antenna.
- Increase the separation between the equipment and receiver.
- Connect the equipment into an outlet on a circuit different from that to which the receiver is connected.
- Consult the dealer or an experienced radio/TV technician for help.

**FCC Note:**

Caution: Changes or modifications not expressly approved by the party responsible for compliance could void the user's authority to operate the equipment.

## **FCC RF Exposure Information (SAR)**

This device is designed and manufactured not to exceed the emission limits for exposure to radio frequency (RF) energy set by the Federal Communications Commission of the United States.

During SAR testing, this device is set to transmit at its highest certified power level in all tested frequency bands, and placed in positions that simulate RF exposure in usage near the body with the separation of 10 mm. Although the SAR is determined at the highest certified power level, the actual SAR level of the while operating can be well below the

maximum value. This is because the device is designed to operate at multiple power levels so as to use only the power required to reach the network. In general, the closer you are to a wireless base station antenna, the lower the power output.

The exposure standard for wireless employs a unit of measurement known as the Specific Absorption Rate, or SAR. The SAR limit set by the FCC is 1.6W/kg.

The FCC has granted an Equipment Authorization for this model device with all reported SAR levels evaluated as in compliance with the FCC RF exposure guidelines. SAR information on this model device is on file with the FCC and can be found under the Display Grant section of [www.fcc.gov/oet/ea/fccid](http://www.fcc.gov/oet/ea/fccid) after searching on FCC ID: SRQ-MF97B-T.

For this device, the highest reported SAR value for near the body is 1.42 W/kg. While there may be differences between the SAR levels of various devices and at various positions, they all meet the government requirement.

SAR compliance for body operation is based on a separation distance of 10 mm between the unit and the human body.

## **Distraction**

### **Driving**

Full attention must be given to driving at all times in order to reduce the risk of an accident. Using this device while driving can cause distraction and lead to an accident. You must comply with local laws and regulations restricting the use of wireless devices while driving.

### **Operating Machinery**

Full attention must be given to operating the machinery in order to reduce the risk of an accident.

## **Product Handling**

### **General Statement on Handling and Use**

You alone are responsible for how you use your device and any consequences of its use.

You must always switch off your device wherever the use of your device is prohibited. Use of your device is subject to safety measures designed to protect users and their environment.

- Always treat your device and its accessories with care and keep it in a clean and dust-free place.
- Keep the screen and projection lens clean. Unclean screen or projection lens may slow down the device's reaction to your operations

or lower projection image quality.

- Clean your device and its accessories with a soft material such as cleaning cloth for eyeglass lenses. Do not use alcohol or other corrosive substances for cleaning or allow them to get inside.
- Do not expose your device or its accessories to open flames or lit tobacco products.
- Do not expose your device or its accessories to liquid, moisture or high humidity.
- Do not drop, throw or try to bend your device or its accessories.
- Do not use harsh chemicals, cleaning solvents, or aerosols to clean the device or its accessories.
- Do not paint your device or its accessories.
- Do not attempt to disassemble your device or its accessories, only authorized personnel can do so.
- Do not expose your device or its accessories to extreme temperatures, minimum 23 °F and maximum 104 °F (minimum – 5 °C and maximum + 40 °C).
- Do not place your device inside or near heating equipments or high pressure containers, such as water heaters, microwave ovens, or hot cooking utensils. Otherwise, your device may be damaged.
- Please check local regulations for disposal of electronic products.

## **Small Children**

Do not leave your device and its accessories within the reach of small children or allow them to play with it.

They could hurt themselves or others, or could accidentally damage the device.

Your device contains small parts with sharp edges that may cause an injury or may become detached and create a choking hazard.

## **Demagnetization**

To avoid the risk of demagnetization, do not allow electronic devices or magnetic media close to your device for a long time.

## **Air Bags**

Do not place a device in the area over an air bag or in the air bag deployment area as an airbag inflates with great force and serious injury could result.

## **Seizures/Blackouts**

The device can produce a bright or flashing light. A small percentage of people may be susceptible to blackouts or seizures (even if they have never had one before) when exposed to flashing lights or light patterns such as when playing games or watching video. If you have experienced seizures or blackouts or have a family history of such occurrences, please

consult a physician. To reduce the risk of blackouts or seizures, you can use your device in a well lit room and take frequent breaks.

## **Repetitive Strain Injuries**

To minimize the risk of Repetitive Strain Injury (RSI) when texting or playing games with your device:

- Do not grip the device too tightly.
- Press the buttons lightly.
- Use the special features which are designed to minimize the times of pressing buttons, such as Predictive Text.
- Take lots of breaks to stretch and relax.

## **Loud Noise**

This device is capable of producing loud noises, which may damage your hearing. Turn down the volume before using headphones, Bluetooth stereo headsets or other audio devices.

## **Device Heating**

Your device may become warm during charging and during normal use.

## **Electrical Safety**

### **Accessories**

Use only approved accessories.

Do not connect with incompatible products or accessories.

## **Faulty and Damaged Products**

Do not attempt to disassemble the device or its accessory.

Only qualified personnel can service or repair the device or its accessory.

If your device or its accessory has been submerged in water, punctured, or subjected to a severe fall, do not use it until you have taken it to be checked at an authorized service center.

## **Radio Frequency Interference**

### **General Statement on Interference**

Care must be taken when using the device in close proximity to personal medical devices, such as pacemakers and hearing aids.

Please consult your doctor and the device manufacturer to determine if operation of your device may interfere with the operation of your medical device.

### **Pacemakers**

Pacemaker manufacturers recommend that a minimum separation of 15 cm be maintained between a wireless device and a pacemaker to avoid potential interference with the pacemaker. To achieve this, do not use this device near your pacemaker and do not carry it near the breast.

## **Hearing Aids**

People with hearing aids or other cochlear implants may experience interfering noises when using wireless devices or when one is nearby. The level of interference will depend on the type of hearing device and the distance from the interference source, increasing the separation between them may reduce the interference. You may also consult your hearing aid manufacturer to discuss alternatives.

## **Medical Equipment**

Switch off your wireless device when requested to do so in hospitals, clinics or health care facilities. These requests are designed to prevent possible interference with sensitive medical equipment.

## **Aircraft**

Switch off your wireless device whenever you are instructed to do so by airport or airline staff.

Consult the airline staff about the use of wireless devices on board the aircraft.

## **Interference in Vehicles**

Please note that because of possible interference to electronic equipment, some vehicle manufacturers forbid the use of your device in their vehicles.



# **Explosive Environments**

## **Gas Stations and Explosive Atmospheres**

In locations with potentially explosive atmospheres, obey all posted signs to turn off wireless devices such as your device or other radio equipment. Areas with potentially explosive atmospheres include fuelling areas, below decks on boats, fuel or chemical transfer or storage facilities, areas where the air contains chemicals or particles, such as grain, dust, or metal powders.

## **Blasting Caps and Areas**

Power off your device when in a blasting area or in areas posted power off “two-way radios” or “electronic devices” to avoid interfering with blasting operations.