

# **ZTE F160**

## **Dual Band 3G Mobile Phone**

### **Quick Start Guide**

ZTE CORPORATION  
NO. 55, Hi-tech Road South, ShenZhen, P.R.China  
Postcode: 518057  
Tel: (86) 755 26779999  
Website: <http://www.zte.com.cn>  
E-mail: [mobile@zte.com.cn](mailto:mobile@zte.com.cn)

## **LEGAL INFORMATION**

Copyright © 2011 ZTE CORPORATION.

All rights reserved.

No part of this publication may be excerpted, reproduced, translated or utilized in any form or by any means, electronic or mechanical, including photocopying and microfilm, without the prior written permission of ZTE Corporation.

The manual is published by ZTE Corporation. We reserve the right to make modifications on print errors or update specifications without prior notice.

Version No. : R1.0

Edition Time : 2011-7-12

Manual No. : 079584503128

# Contents

|   |    |
|---|----|
| Safety Information .....                    | 1  |
| General Care .....                          | 1  |
| General Guidelines.....                     | 2  |
| Road Safety .....                           | 2  |
| Hospital Safety .....                       | 3  |
| Emergency Service .....                     | 3  |
| Third Party Equipment.....                  | 3  |
| Vehicles Equipped with an Airbag .....      | 3  |
| Aircraft Safety.....                        | 3  |
| Declaration of Conformity .....             | 4  |
| Privacy Information .....                   | 4  |
| Copyright Notice.....                       | 4  |
| Radio Frequency (RF) Energy .....           | 4  |
| FCC Compliance.....                         | 4  |
| Disposing of Your Phone .....               | 5  |
| Limitation of Liability.....                | 6  |
| Phone Overview .....                        | 7  |
| Installing the (U)SIM Card and Battery..... | 8  |
| Charging Your Phone.....                    | 10 |
| Switching On/Off.....                       | 11 |
| Lock/Unlock Your Phone .....                | 12 |
| Standby Mode .....                          | 13 |
| Indicators and Icons .....                  | 14 |
| Main Menu.....                              | 15 |
| Shortcut for Menu .....                     | 16 |
| Voice Call .....                            | 17 |
| Videophone .....                            | 18 |
| Text Input.....                             | 19 |
| Searching the Contact .....                 | 20 |
| Sending SMS.....                            | 21 |
| Sending an Email .....                      | 22 |
| Setting Network Connection.....             | 23 |
| Sending MMS .....                           | 24 |
| Browsing the Website .....                  | 25 |
| Use Bluetooth to send one file .....        | 26 |
| Viewing the Pictures .....                  | 27 |
| Enjoying the Video .....                    | 28 |
| Streaming URL .....                         | 29 |
| PC Suite.....                               | 30 |
| Using the Phone as Modem .....              | 31 |
| Technical Parameters .....                  | 32 |



# Chapter 1

## Safety Information

### *General Care*

Your handset contains delicate electronic circuitry, magnets and battery systems. You should treat it with care and give particular attention to the following points:

- Do not allow the handset, battery or accessories to come into contact with liquids or moisture at any time. Do not immerse the handset in any liquid.
- Do not place the handset alongside computer disks, credit cards, travel cards and other magnetic media. The information contained on disks or cards may be affected by the handset.
- Do not paint the handset.
- Do not leave the handset or the battery in places where the temperature could exceed 60 °C, e.g. on a car dashboard or a windowsill, behind glass in direct sunlight, etc.
- Do not remove the handset's battery while the handset is switched on.
- Take care not to allow metal objects, such as coins or key rings to contact or short-circuit the battery terminals.
- Do not dispose of battery in a fire. The handset's Li-ION batteries may be safely disposed of at a Li-ION recycling point. Follow local requirements for recycling.
- Do not put the handset's battery in your mouth, as battery electrolytes may be poisonous if swallowed.
- Do not attempt to dismantle the handset or any of its accessories.
- Do not put a battery into a microwave oven, dryer, or high-pressure container.
- Do not contact battery directly to an electric outlet or cigarette lighter charger. Use only approved charger units.
- Do not pierce battery with a sharp object such as a needle.
- Do not disassemble or modify the battery.
- Do not use a damaged or deformed battery.
- Do not drop, throw, or subject the handset to rough treatment.
- Do not solder the battery directly.
- Stop using the battery if abnormal heat, odor, discoloration, deformation, or abnormal condition is detected during use, charge, or storage.
- Remove the battery whose life cycle has expired from equipment immediately.
- This equipment is fitted with an internal battery. Take it to a qualified service engineer when the replacement of the battery is required.
- The earpiece may become warm during normal use. Also, the handset itself may become warm while the battery is being charged.
- When a handset is in vibration mode, the vibration can sometimes cause the handset to move.
- Be careful not to place the handset near heat sources (such as a heater) or too close to the edge of the table.
- Power off your phone before you clean it. Use a damp or anti-static cloth to clean the handset. Do not use an ordinary dry cloth or electrostatic cloth. Do not use chemical or abrasive cleaners as these could damage the casing.

- Remember to make backup copies of all important data on your handset.
- Remember to recycle: the cardboard packing supplied with this handset is ideal for recycling.



**Warning:**

In the unlikely event of a battery leak, take care to keep the battery discharge away from your eyes or skin. If the leakage does come into contact with the eyes or skin, please flush thoroughly in clean water and consult with a doctor.

## **General Guidelines**

- In some countries, national law prohibits private copying of copyrighted material. Please check the national legislation of the applicable country concerning the use of such material.
- Many jurisdictions have laws and regulations about taking pictures in public or private areas and regarding the processing and further use of such pictures. The manufacturer encourages its customers to obey all laws and to respect the personal rights of others.
- Please check roaming agreement availability with your service provider.
- The use of mobile phones is not allowed in some radiation sensitive areas, such as hospitals, research centers and airplanes. The user is responsible to power-off the device. If there is any uncertainty, you should remove the battery from the handset.
- Observe any signs that indicate powering off handsets, such as those near gas stations, or explosives, and power off the handset/device immediately.
- If you have a heart condition, be careful with the settings of call vibration or tone volume.
- Do not allow children to play with the handset, charger or batteries.
- Do not use the handset where blasting is in progress.
- Do not try to make a call or conversation while the temperature of charging battery is above 50 °C.
- Take care not to put your handset in the back pocket of your trousers or skirt and then sit on it. Also, do not put your phone at the bottom of bag where it may subject to excessive weight or pressure. Doing so may damage the LCD and camera lens and cause them malfunction.
- The operation of some medical electronic devices, such as hearing aids and pacemakers, may be affected if a handset is used next to them. Observe any caution signs and the manufacturer's recommendations.
- Do not leave the handset discharged or without a battery for a long time, otherwise some data may be erased.
- Your phone contains metal, which may cause you an itch, a rash or eczema depending on your physical condition.

## **Road Safety**

- You must exercise proper control of your vehicle at all times. Give your full attention to driving.
- Observe all of the recommendations contained in your local traffic safety documentation.
- Pull off the road and park before making or answering a call, if driving conditions require so. Check if local laws and/or regulations restrict the use of handsets while driving
- You must not stop on the hard shoulder of a motorway to answer or make a call, except in an emergency.
- Power off your handset at a refueling point, such as a gas station, even if you are not refueling your own car.
- Do not store or carry flammable or explosive materials in the same compartment as the handset.
- Electronic systems in vehicle, such as anti-lock brakes, speed control and fuel injection systems are not

normally affected by radio transmissions. The manufacturer of such equipment can advise if it is adequately shielded from radio transmissions. If you suspect vehicle problems caused by radio transmissions, consult your dealer and do not power on the handset until it has been checked by a qualified technician.

## ***Hospital Safety***

- Power off your phone and remove the battery in areas where the use of handsets is prohibited.
- Follow the instructions given by the respective medical facility regarding the use of handsets on their premises.

## ***Emergency Service***

To make an emergency call in any country:

1. Ensure that your handset is on and in service.
2. Press the **End Key** as many times as needed to clear the display and ready the device for calls.
3. Enter the official emergency number for your present location, for example, 112 (the international emergency number).
4. Press the **Voice Call Key** to dial the number. Follow instructions received and do not end the call until told to do so.

When the (U)SIM card is not inserted or when the dial lock function is on, Press **SOS** and then enter the official emergency number for your present location. Press **Voice Call Key** to dial the number.



### **Notes:**

- Tell the operator which service you require: Police, Ambulance, Fire Brigade, Coastguard or Mountain Rescue Service. Tell them where you are and remain stationary to maintain contact if possible.
- Due to the nature of the cellular system, the connection of emergency calls cannot be guaranteed. You should never rely solely on any wireless device for essential communications like medical emergencies.

## ***Third Party Equipment***

The use of third party equipment, cables or accessories, not made or authorized by ZTE, may invalidate the warranty of your handset and also adversely affect the phone's safety/operation.

## ***Vehicles Equipped with an Airbag***

An airbag inflates with great force. Do not place objects, including either installed or portable wireless equipment, in the area over the airbag or in the airbag deployment area. If in-vehicle wireless equipment is improperly installed and the airbag inflates, serious injury could result.

## ***Aircraft Safety***

- Power off your phone before the airplane takes off. In order to protect airplane's communication system from interference, it is prohibited to use mobile phone in flight. If you want to use mobile phone before the airplane takes off, you should get aircrew's permission according to safety regulations.
- If the mobile phone has the function of automatic timing power-on, please check your alarm setting to ensure that your phone will not be automatically powered on during the flight.

## ***Declaration of Conformity***

We declare under our sole responsibility that the product(s) detailed in this manual, and in combination with our accessories, conform to the essential requirements of European Union Directive 1999/5/EC Radio and Telecommunications Terminal Equipment Directive requirements 3.1(a), 3.1(b), 3.2.

## ***Privacy Information***

Camera usage and photo/audio/video recordings carried out with the handset can offend the confidentiality of the subjects. The user therefore is held to respect legislation in confidentiality matter and remains the only responsible subject in case of eventual violations of the enforced norm.

## ***Copyright Notice***

The video/audio recordings you make/download are protected by copyright laws. They are for personal use only and must not be otherwise used without the permission of the copyright owner.

## ***Radio Frequency (RF) Energy***

Your handset is a low-power radio transmitter and receiver. When powered on, it intermittently receives and transmits radio frequency (RF) energy (radio waves). The transmit power level is optimized for the best performance, and automatically reduces in the areas with better reception.

### **Exposure to radio frequency energy**

Radio wave exposure and Specific Absorption Rate (SAR) information:

- The handset is designed to comply with safely, requirements for exposure to radio waves. This requirement is based on scientific guidelines that include safety margins designed to assure the safety of all persons, regardless of age and health.
- The radio wave exposure guidelines employ a unit of measurement known as the Specific Absorption Rate, or SAR. Tests for SAR are conducted using a standardized method with the phone transmitting at its highest certified power level in all used frequency bands.
- While there may be differences between the SAR levels of various ZTE phone models, they are all designed to meet the relevant guidelines for exposure to radio waves.
- The SAR limit recommended by the International Commission on Non-Ionizing Radiation Protection (ICNIRP), is 1.6W/kg averaged over ten (1) grams of tissue.
- The highest SAR value for this model phone tested for use at the ear is 1.170 W/kg (10g).

## ***FCC Compliance***

This device complies with part 15 of the FCC Rules. Operation is subject to the following two conditions:

1. This device may not cause harmful interference.
2. This device must accept any interference received, including interference that may cause undesired operation



**Caution:**

Changes or modifications not expressly approved by the manufacturer could void the user's authority to operate the equipment.

**Notes:**

This equipment has been tested and found to comply with the limits for a Class B digital device, pursuant to part 15 of the FCC Rules. These limits are designed to provide reasonable protection against harmful interference in a residential installation. This equipment generates, uses and can radiate radio frequency energy and, if not installed and used in accordance with the instructions, may cause harmful interference to radio communications. However, there is no guarantee that interference will not occur in a particular installation. If this equipment does cause harmful interference to radio or television reception, which can be determined by turning the equipment off and on, the user is encouraged to try to correct the interference by one or more of the following measures:

- Reorient or relocate the receiving antenna.
- Increase the separation between the equipment and receiver.
- Connect the equipment into an outlet on a circuit different from that to which the receiver is connected.
- Consult the dealer or an experienced radio/ TV technician for help.

## ***Disposing of Your Phone***



The symbol  brought back on the equipment indicates that the refusal must be object of “separate collection”.

Therefore, the customer will have to confer (or to make to confer) the refusal to the centers of differentiated collection predisposed from the local administrations, or to deliver it to the retailer in exchange of one new equipment purchased.

The differentiated collection of the refusal and the successive operations of treatment, recovery and waste help the production of equipment with recycle material and limit the hazardous effects on the atmosphere and the health eventually caused from one improper management of the refusal.

The illicit disposal of the product by the customer involves the application of the administrative endorsements of which to article 254 and following of the D.Lgs. 152, April 3rd 2006.

According to the article, the 13, D.Lgs. 25th July 2005, n. 151 “Performance of the Directives 2002/95/CE, 2002/96/CE and 2003/108/CE, relative to the reduction of the use of dangerous substances in the equipment electronic electrical workers and, let alone to the disposal of the refusals”.

# Chapter 2

## **Limitation of Liability**

ZTE shall not be liable for any loss of profits or indirect, special, incidental or consequential damages resulting from or arising out of or in connection with using this product, whether or not ZTE had been advised, knew or should have known the possibility of such damages. Refer to the enclosed warranty card for full warranty and service information.

# Chapter 3

## Phone Overview

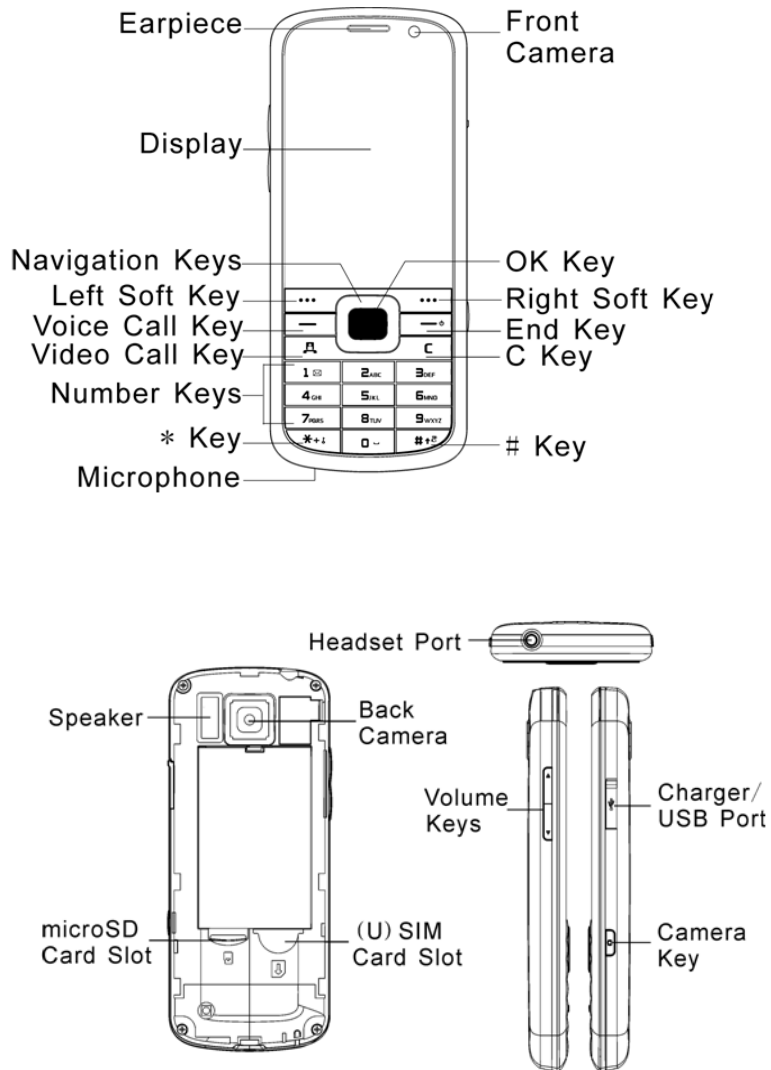

# Chapter 4

## Installing the (U)SIM Card and Battery

1. Use the thumb catch at the bottom of the handset to open the battery cover.

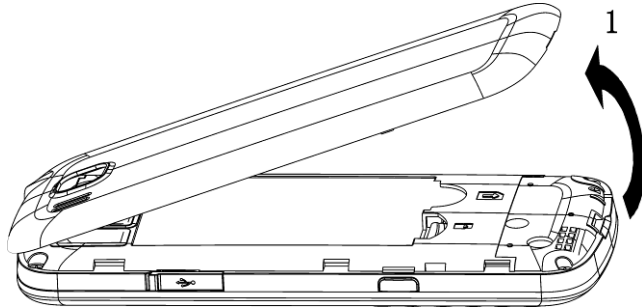

2. Insert the (U)SIM as shown.

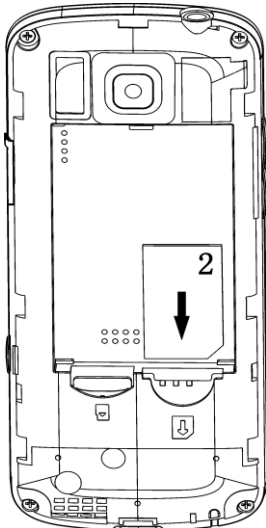

3. Insert the memory card as shown.

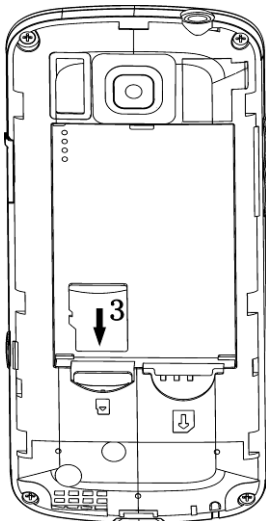

4. Insert the battery carefully with the contacts located against the metal spring.

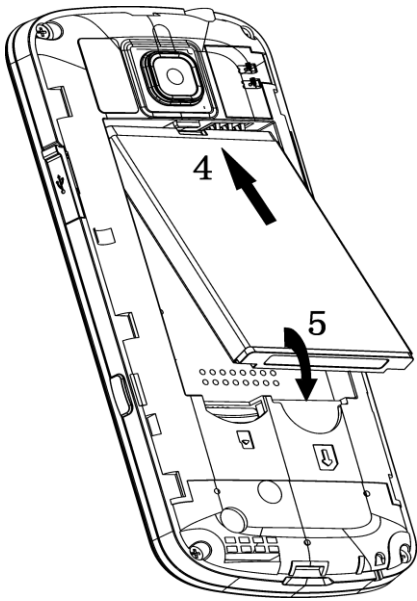

# Chapter 5

## Charging Your Phone

- Your phone uses a rechargeable battery. When you first unpack the phone, the battery is not fully charged, but there might be enough power to turn on the phone. You should flatten the battery by using all of the available power before charging the battery for the first time.
- To get the maximum performance out of your battery, it is recommended that you completely charge the battery before using the phone for the first time. A new battery's full performance is only reached after three complete charge and discharge cycles have been finished.

Open the USB port cover and insert the charger's USB adapter into the USB port.

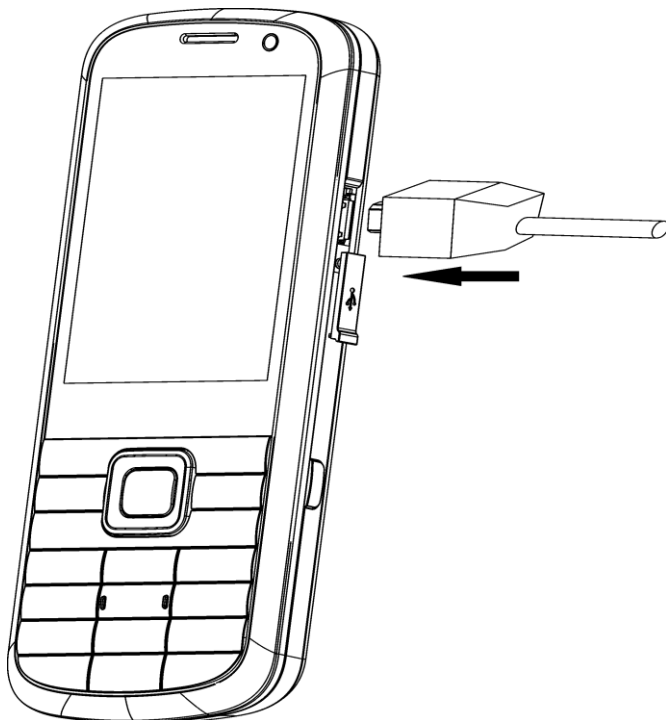

# Chapter 6

---

## Switching On/Off

1. Press and hold the **End Key** to power on the phone.



Notes:

When being asked, enter your PIN code or handset code, and press the **OK Key** to confirm.

2. To power off the phone, press and hold the **End Key** from the standby mode.

# Chapter 7

## Lock/Unlock Your Phone

- In the standby mode, press and hold the \* **Key** to lock the keypad manually.
- In the main menu, select **Settings > Phone > Auto keyguard** and set the keypad locking automatically as 10 seconds, 15 seconds, 30 seconds or 60 seconds.
- If you want to unlock the keypad, please press **Unlock**, and then press \* **Key**.



### Tips:

- If the call is coming when the keypad is locked, please press the **Voice Call Key** to answer. After ending or rejecting the call, the keypad will be locked automatically.
- When the keypad lock is on, calls may be possible to the official emergency number programmed into your phone.



# Chapter 8

## Standby Mode



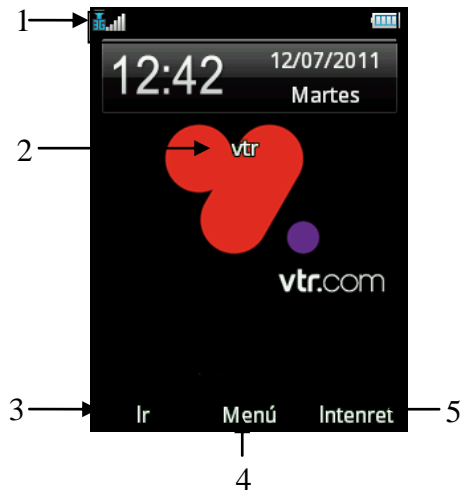













The start up screen below is referred to throughout the guide as the standby mode.



|   |  |
|---|--|
| 1 | Indicators                                 |
| 2 | The name of the service provider           |
| 3 | The function for the <b>Left Soft Key</b>  |
| 4 | The function for the <b>OK Key</b>         |
| 5 | The function for the <b>Right Soft Key</b> |

# Chapter 9

## Indicators and Icons

|   |                         |   |                    |
|---|-------------------------|---|--------------------|
|    | Network signal strength |    | Alarm              |
|    | GPRS attached           |    | GPRS in use        |
|    | Battery status          |    | Bluetooth on       |
|    | Missed voice call       |    | Missed video call  |
|    | New SMS                 |    | SMS memory is Full |
|    | New MMS                 |    | MMS memory is Full |
|    | Silence                 |    | Vibrate            |
|  | Handset mode            |  | Memory Card        |

# Chapter 10

## Main Menu

From the standby mode press **OK Key** to enter main menu.

|  |  |   |   |
|--|--|---|---|
| <b>Tools</b> <ul style="list-style-type: none"><li>• Game&amp;App</li><li>• Bluetooth</li><li>• Alarm</li><li>• Calendar</li><li>• Stopwatch</li><li>• World Time</li><li>• Calculator</li><li>• Converter</li></ul> | <b>Contacts</b>  | <b>Tienda VTR</b> <ul style="list-style-type: none"><li>• Tienda VTR</li><li>• Sucursal Virtual</li><li>• VTR.COM</li><li>• Game</li></ul>  | <b>Settings</b> <ul style="list-style-type: none"><li>• Profiles</li><li>• Phone</li><li>• Display</li><li>• Connections</li><li>• Calls</li><li>• Security</li></ul> |
| <b>Internet</b>  | <b>Messages</b> <ul style="list-style-type: none"><li>• Message</li><li>• Email</li></ul>                                      | <b>Multimedia</b> <ul style="list-style-type: none"><li>• Camera</li><li>• Video Camera</li><li>• FM radio</li><li>• Music</li><li>• Video</li><li>• Picture</li><li>• Audio record</li></ul> | <b>Profiles</b> <ul style="list-style-type: none"><li>• General</li><li>• Meeting</li><li>• Outdoor</li><li>• Silent</li><li>• Flight</li></ul>                       |
| <b>Game</b>  | <b>Call History</b> <ul style="list-style-type: none"><li>• All</li><li>• Missed</li><li>• Received</li><li>• Dialed</li></ul> | <b>File Mgr</b> <ul style="list-style-type: none"><li>• Phone</li><li>• Memo.Card</li></ul>   | <b>Camera</b>   |

# Chapter 11

## Shortcut for Menu

- In the main menu, press the corresponding number key as shown on the grid below to access the corresponding menu.



# Chapter 12

## **Voice Call**

1. In the standby mode, enter the phone number.
2. Press the **Voice Call Key** to make a voice call.

# Chapter 13

## Videophone

1. In the standby mode, enter a phone number
2. Press the **Video Call Key** to make a video call.

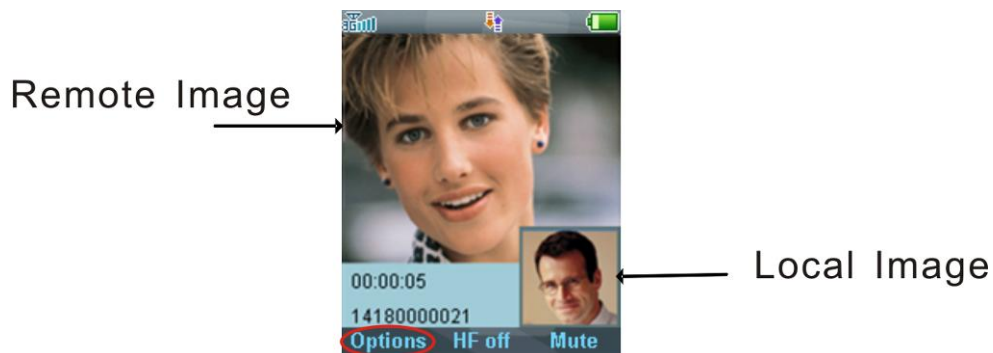

Press **Options** to show the following table items.

| Options                        | Description  |
|--------------------------------|--|
| <b>Hold /Cancel hold</b>       | Put the current call on hold or retrieve the call.                                     |
| <b>Start recording video</b>   | Record the current call, and you can press the <b>OK Key [Stop]</b> to stop recording. |
| <b>Block/Activate my image</b> | Block or send my picture during the call.  |
| <b>Use back/front camera</b>   | Switch between the front and back camera.  |
| <b>Zoom</b>                    | Adjust the image size.   |
| <b>PIP off/on</b>              | Close or open the local image.   |
| <b>Exchange PIP</b>            | Switch between the primary and secondary screen.                                       |
| <b>New text message</b>        | Switch to the new text message interface.  |
| <b>Contacts</b>                | Switch to the contacts interface.  |

# Chapter 14

## Text Input

Your phone provides the following input methods: Predictive Text Mode Input, Multitap Input (**abc/Abc/ABC**), Numbers Input and so on.

| Operation                                 | Method   |
|---|--|
| Input Words                               | <b>eZiEng</b> Input — Press each key once that corresponds to the letter you want to enter. The letters are shown on the display as they are entered. The list of candidate words changes as each key is pressed.                        |
| Input Letters                             | <b>Abc/abc/ABC</b> Input — Press a number key ( <b>2 to 9</b> ) repeatedly until the required character is shown on the screen. Press once to input the first letter on the keypad, press twice quickly to input the second letter, etc. |
| Input Numbers                             | <b>123</b> Input — Press the number keys to input numbers directly.  |
| Input Space                               | Press the <b>0 Key</b> , except for the numbers input mode.  |
| Move the cursor up, down, left , or right | Press the <b>Navigation Keys</b> .   |

# Chapter 15

---

## Searching the Contact

In the **Contacts** interface, enter the letters of the name you are searching for. To find 'John' press the 5 key once for 'J'. All names starting with 'J' are displayed.



### Tips:

Refine the search by entering more letters that can occur anywhere in the name.



# Chapter 16

---

## Sending SMS

### Setting SMS

1. In the main menu, select **Menu > Messages > Message > Settings > Text Msg. Settings**.
2. Set the related parameters. For more details, please contact your service provider.
3. Press the **OK** to complete.

### Sending SMS

1. In standby mode, select **Menu > Messages > Message > Create message**.
2. Enter the phone number(s) of the recipient(s).
3. Edit the message.
4. Press **Send**.

# Chapter 17

## Sending an Email

### Set Email

1. Choose the desired mailbox.

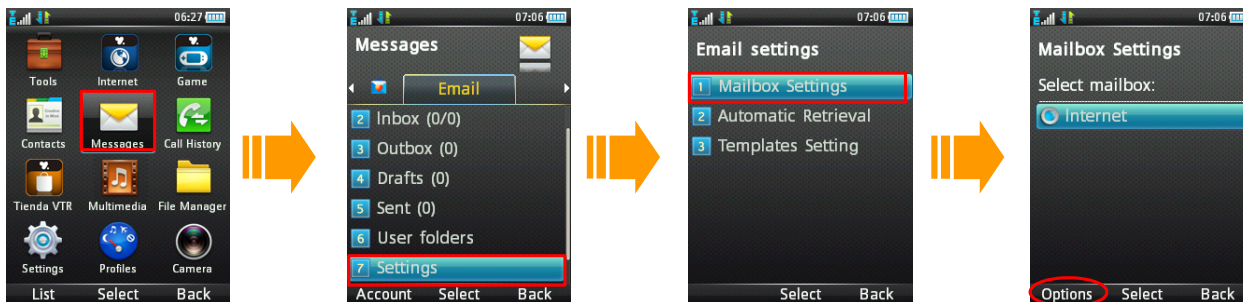

#### Notes:

If there is no desired mailbox, select **Options** > **New** to add a new mailbox.

2. Press the **OK** key to activate it.

### Send an Email

1. In the main interface, select **Messages** > **Email** > **New Email**.

2. Refer to the following picture to send the Email.

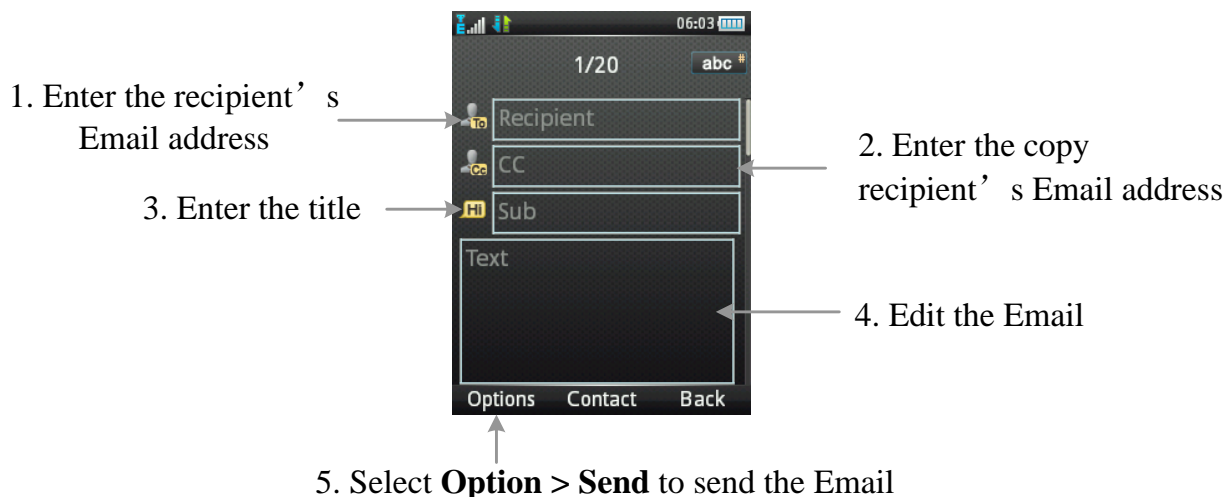

# Chapter 18

## Setting Network Connection

### Setting APN

Activate the proper APN.

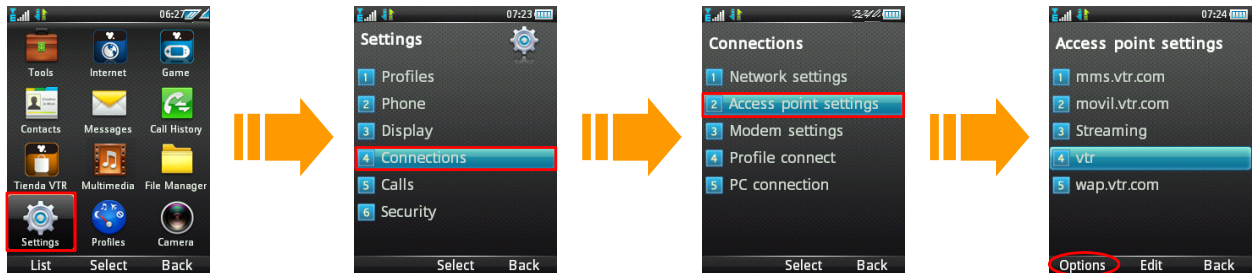

Notes:

If there is no desired APN, please select **Options** > **Add** to add one new APN.

### Setting connection

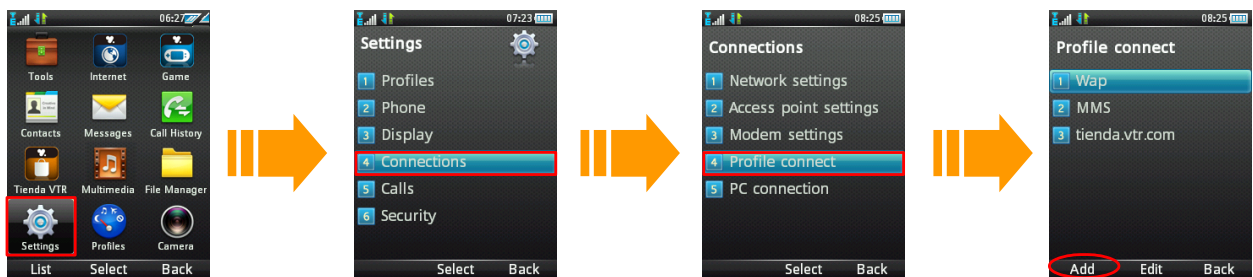

Notes:

If there is no desired connection, please press **Add** to add one new connection.

# Chapter 19

---

## Sending MMS

### Setting MMS

1. In the main menu, select **Messages > Settings > Mul. Msg. Settings**.
2. Set the related parameters. For more details, please contact your service provider.
3. Press **OK**.

### Sending MMS

1. In standby mode, select **Menu > Messages > Message > Create message**.
2. Enter the phone number(s) of the recipient(s).
3. Edit the message. Select **Options > Insert** to insert image/ audio/ video.
4. Select **Options > Send**.

# Chapter 20

## Browsing the Website

1. Activate the proper APN.

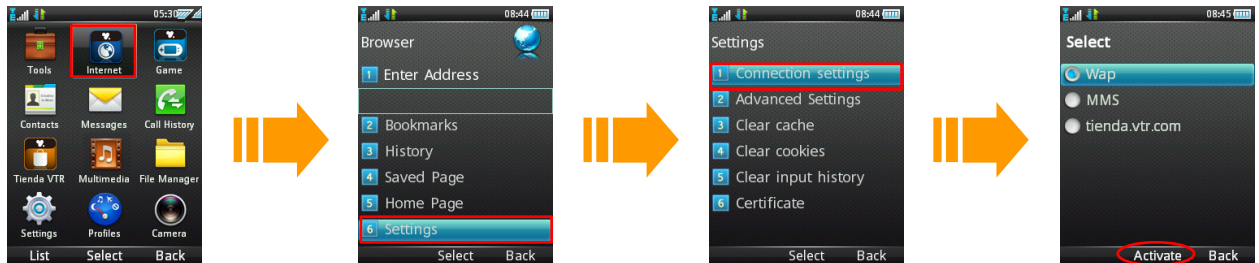

2. In the **Browser** interface, select **Home Page** to access the preset link.

Or press **Bookmarks** to access a previously saved link.

Or press **History** to access the visited webs.

Or press **Enter Address** to enter a web address manually using the keypad and access it.

# Chapter 21

## Use Bluetooth to send one file

1. Open the **Bluetooth** function.

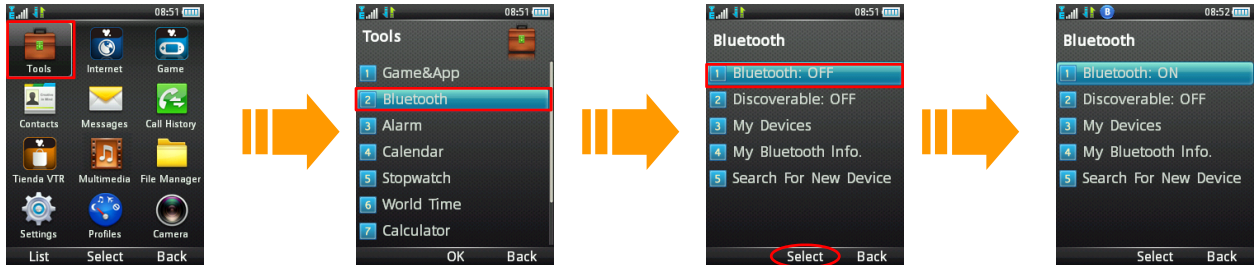

2. Find the file and paired device which you want to send.

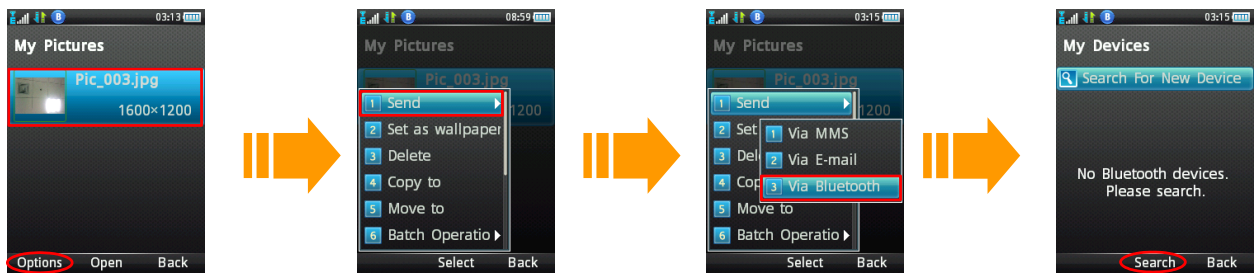

Notes:

Press **Search** to find new device(s).

3. Enter **Pass code** and use the same **Pass code** on the other device (e.g. 0000) if required.

# Chapter 22

---

## Viewing the Pictures

Additional features when you view one picture:

| Feature                | Function Key          |
|------------------------|-----------------------|
| Full Screen            | OK Key                |
| Zoom in and out        | Up and Down arrow Key |
| Rotate the image       | 1,3 keys              |
| Next or previous image | Right or Left Key     |

# Chapter 23

---

## Enjoying the Video

Additional features when you view one video:

| Feature                 | Function Key                      |
|-------------------------|-----------------------------------|
| Volume up and down      | Volume Keys or Left and Right Key |
| Brightness              | 2,8 keys                          |
| Fast forward and rewind | Up and Down arrow Key             |



# Chapter 24

## Streaming URL

TV channels are links to audio or video streaming content that are available through the browser (similar to bookmarks). The streaming content is only available while you are connected to the server, depending on your service provider or available content.

1. If there is no Streaming URL list, press **Multimedia > Video > Streaming URL > Add** to add a new streaming file, input the **Title** and **URL** and then press **Save** to complete setting.
2. In the Streaming URL list interface, press **Open** to open the URL, press **Options** for more options:

|   |
|---|
| <b>Edit:</b> Edit the URL.  |
| <b>New URL:</b> Create a new URL.                                       |
| <b>Send:</b> Send the URL via Message or Email.                         |
| <b>Delete:</b> Delete the URL.  |
| <b>Delete all:</b> Delete all the URLs.                                 |
| <b>Network Settings:</b> Set the parameter about network and streaming. |
| <b>Info.:</b> View the information about the URL.                       |

# Chapter 25

## PC Suite

### Installing PC Software

1. Connect the data cable to your phone and your computer correctly.
2. Your computer will recognize the handset and start the Join ME installation process automatically.



Notes:

If the system does not launch installation automatically, you can run the installation program in path of **My Computer > JoinME**.

3. Follow the prompts to complete the software installation. All required drivers are installed at this time.

### Uninstalling PC Software

1. Select **Start > Program > Join ME > Uninstall Join ME**.



Notes:

Before uninstall, please close the program.

2. Complete the uninstallation according to the prompt information.

### Running PC Software

1. Switch your phone on.
2. Double click the **JionMe** icon on the desktop.
3. You will be prompted to connect your device, select **F160**.
4. Click **Connect**.
5. Your phone will now automatically synchronize the content from the handset, and the Join ME is now ready to use with your connected device.



Notes:

For detailed use, please refer to the help file built in JoinMe software.

# Chapter 26

## Using the Phone as Modem

If you activate data service function, your phone will be used as one modem. And the following steps are only for reference.

1. Choose **USB** connection mode.

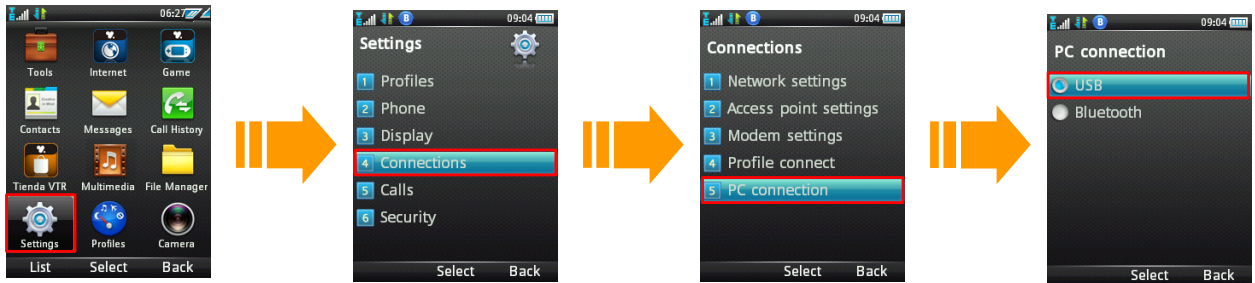

2. Set the modem related parameters.

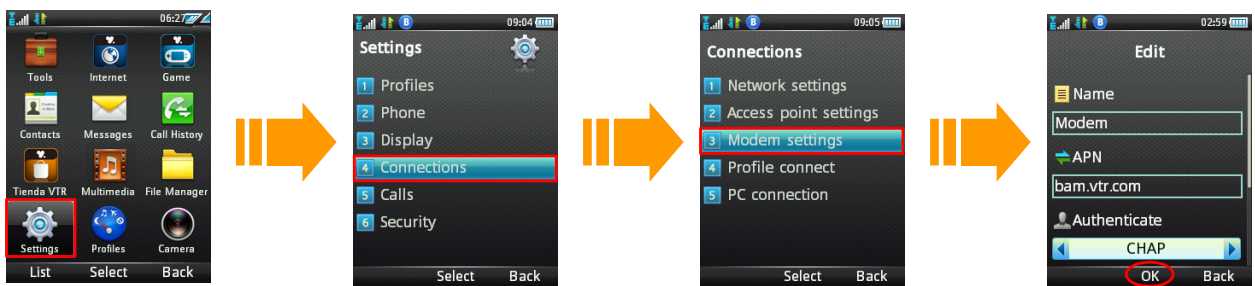

### Notes:

For the detail settings, please consult your service provider.

3. Press **OK** to save.
4. After launch **JoinMe** application software, please click the **Internet** tab.
5. Press **Connect** button to connect to the Internet.

# Chapter 27

## Technical Parameters

|                      |  |
|----------------------|--|
| Handset Standards    | WCDMA 850/AWS/2100MHz<br>GSM/GPRS/EDGE 850/1800/1900MHz  |
| Dimensions (H×W×D)   | 116mm × 49 mm × 11.3mm   |
| Weight               | Approx 84g (including battery)   |
| Display              | 2.4" 262 K TFT color screen  |
| Front camera         | 0.3 M pixel camera   |
| Back camera          | 2.0 M pixel camera   |
| Extended memory      | Up to 8GB memory card  |
| Battery              | 820mA hours, Lithium ion (Li-ion)  |
| Performance          | BMP/JPG/GIF image; 3GP/MP4 video; MP3/AMR/WAV/ACC/ACC+ audio;<br>Capture Image: up to 1200x1600, 24b; Capture Video: up to 176 x 144; USB 2.0;<br>JAVA MIDP 2.0; MMS Video and Picture, Email, Calendar, Speakerphone, Voice Recorder, Bluetooth |
| Continuous idle time | Up to 200 hours  |
| Continuous talk time | About 180 minutes  |
| Charge time          | Approximately 3 hours  |



### Notes:

The phone's talk time and idle time are based on ideal working environments. The use of extended backlighting, browser, and network conditions can reduce battery life and talk/idle time.