

ZTE MF50

Quick Guide

ZTE CORPORATION
NO. 55, Hi-tech Road South, ShenZhen, P.R.China
Postcode: 518057
Tel: +86-755-26779999
URL: <http://www.zte.com.cn>
E-mail: mobile@zte.com.cn

LEGAL INFORMATION

Copyright © 2011 ZTE CORPORATION.

All rights reserved.

No part of this publication may be excerpted, reproduced, translated or utilized in any form or by any means, electronic or mechanical, including photocopying and microfilm, without the prior written permission of ZTE Corporation.

The manual is published by ZTE Corporation. We reserve the right to make modifications on print errors or update specifications without prior notice.

Version No. : R1.0

Quick Guide

Introduction

ZTE MF50 is a 3G mobile hotspot device, working in GPRS/EDGE/WCDMA/HSPA network. It provides Internet connection via USB or Wi-Fi to clients, enabling you to communicate anytime and anywhere.

Specification

Data Service	HSPA: DL 14.4 Mbps UL 5.76Mbps
	WCDMA CS: UL 64kbps/DL 64kbps WCDMA PS: UL 384kbps/DL 384kbps
Interface	USB and Wi-Fi
Wi-Fi Standard	802.11b/g/11n
Wi-Fi Security	WEP/WPA/WPA2
USB Version	USB 2.0 HIGH SPEED
USB Interface Type	Micro USB
Weight	80g
Dimensions (W×H×D):	101.8mm*51.8mm*13.65mm
microSD card	Support up to 32GB microSD card
Battery	1500mAh Li-ion battery
*Standby time	100 hours
*Working time	4 hours
Charge time	3 hours
Operate system	Windows 7, Windows Vista, Windows XP (SP2 or later), Mac OS (10.4 or later)
Web Browser	IE (6.0 or later), Firefox (1.0 or later), Opera (6.0 or later), Safari (3.0 or later), Chrome (6.0 or later)
Working temperature	-10°C ~ +45°C
Storage temperature	-20°C ~ +70°C
Charging temperature	0°C ~ +40°C

Humidity	5%~ 95%
----------	---------



Notes:

microSD  is a trademark of SD Card Association.

The device's standby and working time are only for your reference, and based on ideal working environment.

Getting to Know Your Device

The following figure shows the appearance of the device. It is only for your reference. The actual device may be different.

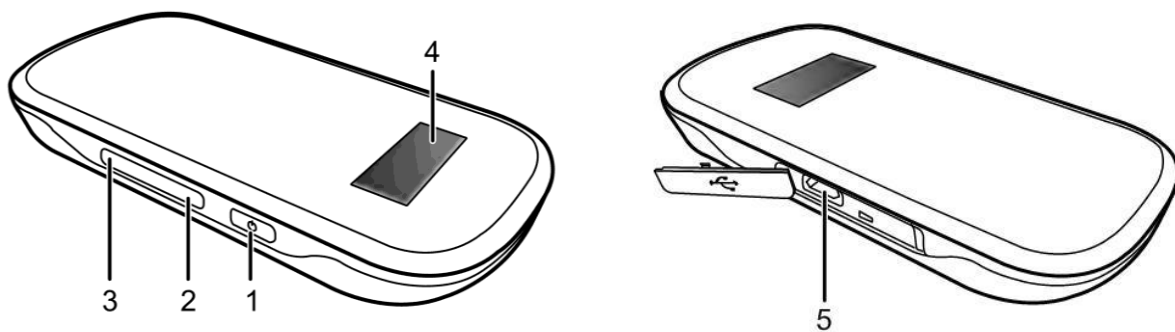

Interface and Buttons

1.Power	Hold the Power button to switch on/off the device.
2. Internet	<ul style="list-style-type: none"> ● Press to connect to or disconnect from the Internet. ● Hold for about five seconds to change between manual and automatic connection.
3.WPS	<p>This button is used to start Wi-Fi Protected Setup authentication process and enable/disable the Wi-Fi function.</p> <ul style="list-style-type: none"> ● Hold it for about five seconds to activate the WPS process. ● Hold it for about two seconds to enable/disable Wi-Fi function.
4. LED Screen	It is to indicate the signal type, signal strength, battery, Wi-Fi, etc.
5.Charger/USB port	<ul style="list-style-type: none"> ● Charge your device. ● Connect the client to your device via USB cable.







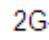

Notes:

- Press **WPS** and **Power** buttons simultaneously, and hold on about three seconds until all LEDs are off, then release the buttons, the device will restart automatically and restore to the factory default settings.
- Please use the original external antenna if necessary.

LED Indicator

When the device is powered on, the following icons will appear on the OLED screen, with the corresponding indications listed in the table below:

Icon	Indication
	Network signal strength.
	Network type. 2G or 3G icon will appear on the OLED screen according to the network being connected.
	Roaming network indication.
	Connect to the Internet automatically.
	Connect to the Internet manually.
	Wi-Fi status and number of the connected users.
	Battery power indication.

Hardware Installation

Inserting SIM Card, Memory Card and Battery

1. Use the thumb catch on the device to open the battery cover.

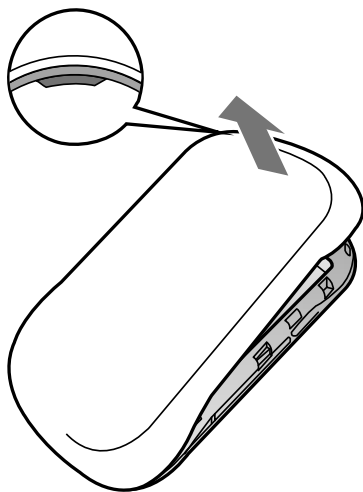

2. Insert SIM Card into the slot.

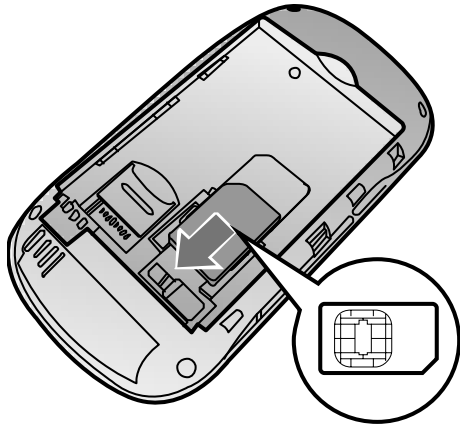

 **Warning:**

Please power off the device and remove the external power adapter before removing or inserting the SIM card, if not, the device or SIM card may be damaged.

3. Insert the memory card into the memory card holder.

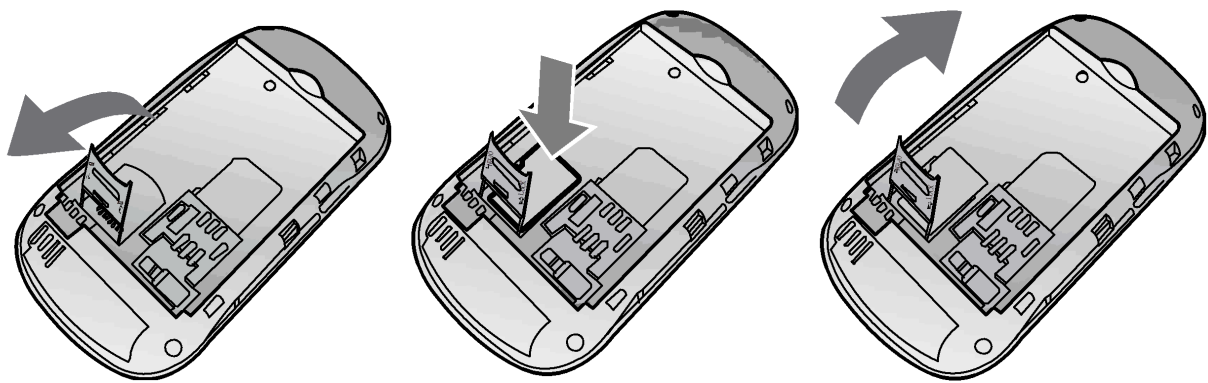

4. Insert the battery as shown with the contacts located against the gold springs.

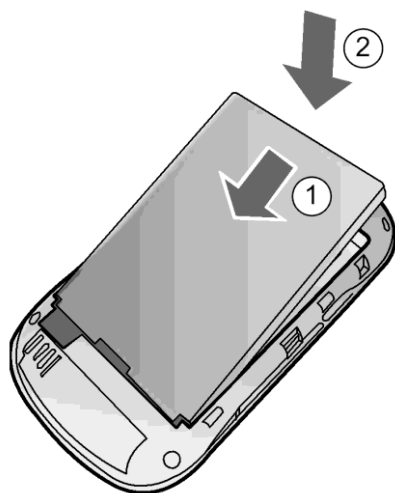

5. Line the battery cover up correctly and press gently to close the case.

Switching On/Off Your Device

Press and hold the **Power** button to switch on/off the device.



Notes:

Please install battery before power on.

Charging Your Device

1. Insert the charger lead carefully with the correct orientation to the charger port.

The plug only fits one way. Do not use excessive force to insert the plug.

2. Connect the charger to a mains socket.

3. Disconnect when the battery is fully charged.

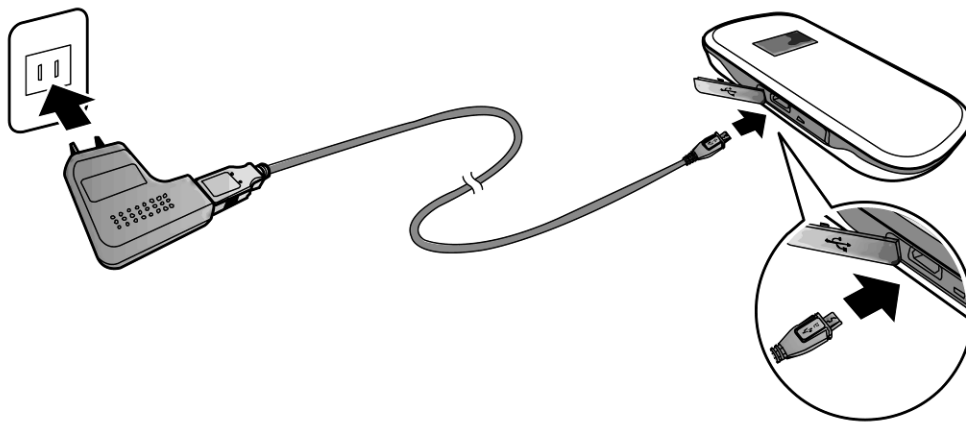

Working Mode

Your device supports three working modes. For the client, we only use PC or laptop as the example in this document.

USB Mode: Connect the device to your PC or laptop via the included USB cable, then power on your device. And the following picture is one application example:

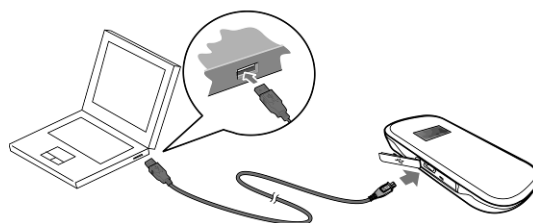

Wi-Fi Mode: Power on directly, and then connect the device to your PC or laptop via Wi-Fi. And the following picture is one application example:

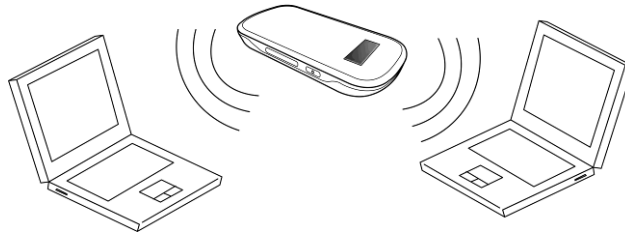

Mixed Mode: Connect to the device with the above two connection methods.

The following picture is the application example. All of the client devices can surf on the Internet at the same time.

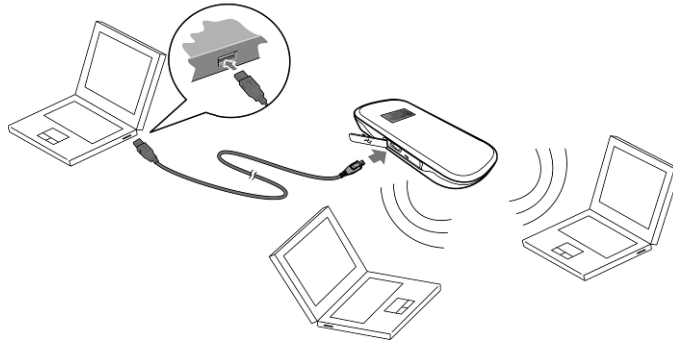

Establish a connection between your device and the client

Via USB Cable

1. Connect your device and the client with the USB cable.
2. Install software.

After the installation, the connection between your device and the client will be established successfully a moment later.

Via Wi-Fi

1. Power on your device directly. It will take 1~2 minutes to initialize, and then Wi-Fi status icon will appear on the screen of your device.
2. If the Wi-Fi status shown is , hold the WPS key for about 2 seconds to enable the Wi-Fi function.
3. Use your normal Wi-Fi application on the client to search the available wireless network.



Notes: You need to check your Wireless Network Connection. Set the client to obtain an IP address automatically in the Internet protocol (TCP/IP) properties, and the client will get an IP address like "192.168.0.101".

4. Select the SSID of your device, and then click **Connect**.

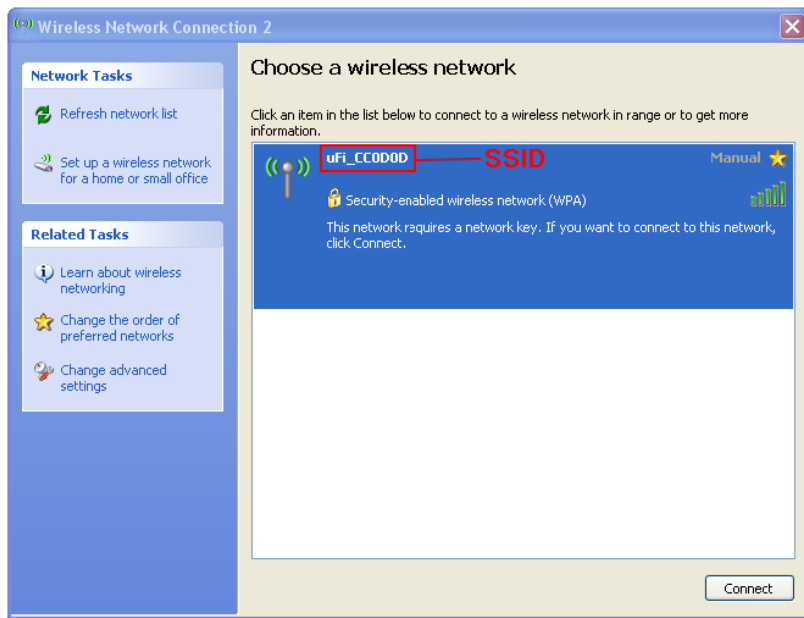

Notes:

There will be a pop-up window to require the password. Please check the label on the battery compartment of your device to gain the SSID and preset password information.

5. Wait a moment, the connection between your device and the client will be established successfully.

Access the Internet

1. Switch on the device.
2. Establish a connection between your device and the client.
3. After successfully establishing the connection, access the Internet in the **Always On** or **Manual** mode. The default mode is **Manual**.



Notes:

You can browse the WebGUI Configuration page and click WAN Connection to set the WAN connection mode.

Access the WebGUI Configuration Page

1. Make sure the connection between your device and the client is correct.

2. Click  to Launch the internet browser.



Notes:

It is recommended that you use IE (6.0 or later), Firefox (1.0 or later), Opera (6.0 or later), Safari (3.0 or later), Chrome (6.0 or later)

3. The login page appears as follows.

Language : English [Help](#)

Administrator :

ZTE中兴 3G Mobile Hotspot

📶 Limited Service
📶 0 Disconnected

WAN Information

- Network Provider ---
- Network Type Limited Service
- Connection Status Disconnected
- IP Address
- Primary DNS
- Secondary DNS

WLAN Information

- SSID uFI_CC0D0D
- Channel Auto
- Security Level WPA-PSK
- Gateway Address 192.168.0.1
- Subnet Mask 255.255.255.0
- DHCP Server Enable

Device Information

- Software Version WEB_MF50TVV1.0.0B05
- Firmware version BD_MF50TVV1.0.0B05
- PIN Status Disable

Copyright © 1998-2011 ZTE Corporation. All rights reserved

4. View the information of WAN, WLAN and Device. Input the case-sensitive default password “**admin**”, and then click **Login** to access the WebGUI Configuration page.



Notes:

- Do not put anything on the top of your device. Do not lay devices to overlap each other when using.
- The device takes 1~2 minutes to initialize, and attach to the network.

PIN Code Verification

If the PIN code of your SIM card is enabled, you will need to input the PIN code when you login at the first time.

PIN

Verify PIN

PIN	<input style="width: 80%;" type="text"/>
Remaining times: 3	



Notes:

The SIM card will be locked if you enter wrong PIN code consecutively for three times.

If you want to modify the PIN Status, please select **Settings > Advanced > PIN Manage** to do the actions.

Advanced > PIN Management

Status	Management	Restore	PIN Management	Router	Statistics
--------	------------	---------	----------------	--------	------------

PIN Management

PIN Status	Disable
Action	Enable <input type="button" value="v"/>
PIN	<input style="width: 80%;" type="text"/>
Remaining times: 3	

Quick Setup

After logging in, select **Quick Settings**, and then the Quick Settings wizard appears.

Quick Settings (1/6)

The wizard will show you how to set up your gateway in the safe way. Click "Next" to continue, click "Back" and "Next" to navigate, and click "Apply" to save the settings.

Notes:
Basic parameters can be set in this wizard. For advanced parameters, you need to set them in other menus.

Next

The Quick Settings wizard guides you how to set the basic parameters for your device in the safest way. After this procedure, you can use your Internet service.



Notes:

The parameter settings may have been preset by your service provider, and you will enjoy your Internet service directly. Please contact your service provider for details if you want to do some modification.

WAN Connection

After logging in, select **WAN Connection**, and you can choose the WAN Connection Mode according to your requirement.

WAN Connection

WAN Connection Mode	
<input checked="" type="radio"/>	Always On
<input type="radio"/>	Manual Connect Internet
WAN Connection Status	Disconnected

Apply

Settings

After logging in, select **Settings**, and you can do the following operations.

Select Settings > 3G Settings	View the 3G Wireless Information, select Band Selection Mode or change APN Setting.
Select Settings > Wi-Fi Settings	View the current station list, change the basic wireless network settings, choose security mode and WPA type, and perform the WPS configuration.
Select Settings > Firewall	Set the Mac/IP/Port Filtering, Port Forwarding or the System Security configuration.
Select Settings > Advanced	View the current status of your device, change the Administrator Settings, restore factory defaults, manage PIN or set the LAN interface configuration.



Notes:

Make sure that you can remember the new password if you change the login password by selecting **Settings** > **Advanced** > **Management**. Please restore the device to the factory default settings in case you forget the new password.

Disconnect from the Internet

1. Log in the WebGUI Configuration page, and select **WAN Connection**.
2. Select **Manual** > **Disconnect Internet**.
3. Click **Apply**.

WAN Connection

WAN Connection Mode

<input type="radio"/>	Always On
<input checked="" type="radio"/>	Manual Disconnect Internet
WAN Connection Status	Disconnected

Apply



Notes:

Turning off the device can also terminate the Internet connection.

SMS

This function allows you to view, send and receive short messages.

After logging in, select **SMS**, and you can do the following operations.

Select SMS > Device	Operate the SMS in your device.
Select SMS > SIM Card	Operate the SMS in your SIM card.
Select SMS > New Message	Send or save SMS.
Select SMS > SMS Settings	Set the SMS configuration.

PhoneBook

This function allows you to store contacts to your device or SIM card.

After logging in, select **PhoneBook**, and you can add a new contact by clicking the **Add New** tab, and perform operations to the contacts in the **Local** or **SIM Card** tab.

PhoneBook->Local (1 / 500)

<input type="checkbox"/> No.	Name	Phone number	Mobile number	Home number	Office number	Nick name	E-mail	Group
<input type="checkbox"/> 1	hanson	13800138000				splatt		Common

K 1 H

Edit Delete Delete All

Usage of WPS

If your client device supports WPS, you need not to input the password manually after WPS has been available. Please do the following:

1. Start up your device.
2. Launch the client device connected to your device.
3. Enable the WPS function of your device.
4. Enable the WPS function of the client.



Notes:

For the detailed operations about the client, please refer to the client's instruction.

Sleep Mode

• After powering your device on without USB connection, once no user connects to the device within 10 minutes and no action is performed to the device, or the WPS button is pressed manually, the device will enter the sleeping mode with the screen off. In the sleeping mode, the

Wi-Fi function will be disabled.

- With USB connection, once no user connects to the device within 10 minutes and no action is performed to the device, or the WPS button is pressed manually, the Wi-Fi function will be disabled, and then unplug the USB cable, the device will enter the sleeping mode.

In the sleeping mode, press any button or connect your device and PC with the USB cable to wake up the device, and the screen will be turned on.

Warning and Notice

To the Owner

- Some electronic devices are susceptible to electromagnetic interference sent by your device if inadequately shielded, such as the electronic system of vehicles. Please consult the manufacturer of your device before using if necessary.
- Operating of laptop and desktop PCs and your device may interfere with medical devices like hearing aids and pacemakers. Please always keep them more than 20 centimeters away from such medical devices when they are turned on. Turn your device off if necessary. Consult a physician or the manufacturer of the medical device before using your device.
- Be aware of the usage limitation when using your device at places such as oil warehouses or chemical factories, where there are explosive gases or explosive products being processed. Turn off your device if required.
- The use of electronic transmitting devices is forbidden in aircrafts, at petrol stations and in hospitals. Please observe and obey all warning signs and switch off your device in these conditions.
- Do not touch the inner antenna area if not necessary. Otherwise it will affect your device's performance.
- Store your device out of the reach of little children. Your device may cause injury if used as a toy.
- Do not touch the metallic parts of your device so as to avoid a burn, when your device is working.

Using Your Device

- Please use original accessories or accessories that are authorized. Using any unauthorized accessories may affect your device's performance, and violate related national regulations about telecom terminals.
- Avoid using your device near or inside metallic structures or establishments that can emit electromagnetic waves. Otherwise it may influence signal reception.
- Your device is not waterproof. Please keep it dry and store in a shady and cool place.
- Do not use your device immediately after a sudden temperature change. In such case, it will produce dew inside and outside your device, so don't use it until it becomes dry.
- Handle your device carefully. Do not drop, bend or strike it. Otherwise your device will be damaged.
- No dismantling by non-professionals and only qualified technicians can undertake repair work.
- Operating temperature range of 0°C ~ +35°C and humidity range of 5% ~ 95% are recommended.

Using Battery

- Do not short-circuit the battery, as this can cause excessive heat and fire.
- Do not store battery in hot areas or dispose of it in a fire to avoid explosion.
- Do not disassemble or modify the battery.
- When not using the battery for a long period, remove it from the device and store it in a cool dry place.

-
- Never use any charger or battery damaged or worn out.
 - Return the wear-out battery to the provider or put it in the appointed recycle place. Do not put it in familial rubbish.



Warning:

If the battery is broken, keep away from it. If it taints your skin, wash your skin with abundant fresh water and ask doctor help if necessary.

Limited Warranty

- This warranty does not apply to defects or errors in the Product caused by:
 - i. Reasonable abrasion.
 - ii. End User's failure to follow ZTE's installation, operation or maintenance instructions or procedures.
 - iii. End User's mishandling, misuse, negligence, or improper installation, disassembly, storage, servicing or operation of the Product.
 - iv. Modifications or repairs not made by ZTE or a ZTE-certified individual.
 - v. Power failures, surges, fire, flood, accidents, actions of third parties or other events outside ZTE's reasonable control.
 - vi. Usage of third-party products, or usage in conjunction with third-party products provided that such defects are due to the combined usage.
 - vii. Any other cause beyond the range of normal usage intended for the Product.

End User shall have no right to reject or return the Product, or receive a refund for the Product from ZTE under the above-mentioned situations.

- This warranty is End User's sole remedy and ZTE's sole liability for defective or nonconforming items, and is in lieu of all other warranties, expressed, implied or statutory, including but not limited to the implied warranties of merchantability and fitness for a particular purpose, unless otherwise required under the mandatory provisions of the law.

Limitation of Liability

ZTE shall not be liable for any loss of profits or indirect, special, incidental or consequential damages resulting from or arising out of or in connection with using of this product, whether or not ZTE had been advised, knew or should have known of the possibility of such damages, including, but not limited to lost profits, interruption of business, cost of capital, cost of substitute facilities or product, or any downtime cost.

FCC Compliance

This device complies with part 15 of the FCC Rules. Operation is subject to the following two conditions:

(1) This device may not cause harmful interference, and (2) this device must accept any interference received, including interference that may cause undesired operation.

Caution: Changes or modifications not expressly approved by the manufacturer could void the user's authority to operate the equipment.

NOTE: This equipment has been tested and found to comply with the limits for a Class B digital device, pursuant to part 15 of the FCC Rules. These limits are designed to provide reasonable protection against

harmful interference in a residential installation. This equipment generates, uses and can radiate radio frequency energy and, if not installed and used in accordance with the instructions, may cause harmful interference to radio communications. However, there is no guarantee that interference will not occur in a particular installation. If this equipment does cause harmful interference to radio or television reception, which can be determined by turning the equipment off and on, the user is encouraged to try to correct the interference by one or more of the following measures:

- Reorient or relocate the receiving antenna.
- Increase the separation between the equipment and receiver.
- Connect the equipment into an outlet on a circuit different from that to which the receiver is connected.
- Consult the dealer or an experienced radio/ TV technician for help.

Radio Frequency (RF) Energy

This model device meets the government's requirements for exposure to radio waves.

This device is designed and manufactured not to exceed the emission limits for exposure to radio frequency (RF) energy set by the Federal Communications Commission of the U.S. Government:

The exposure standard for wireless devices employs a unit of measurement known as the Specific Absorption Rate, or SAR. The SAR limit set by the FCC is 1.6W/kg. *Tests for SAR are conducted using standard operating positions accepted by the FCC with the device transmitting at its highest certified power level in all tested frequency bands. Although the SAR is determined at the highest certified power level, the actual SAR level of the device while operating can be well below the maximum value. This is because the device is designed to operate at multiple power levels so as to use only the power required to reach the network. In general, the closer you are to a wireless base station antenna, the lower the power output.

The highest SAR value for the model device as reported to the FCC when worn on the body, as described in this user guide, is **1.15 W/kg** (Body-worn measurements differ among device models, depending upon available enhancements and FCC requirements.)

While there may be differences between the SAR levels of various devices and at various positions, they all meet the government requirement.

The FCC has granted an Equipment Authorization for this model device with all reported SAR levels evaluated as in compliance with the FCC RF exposure guidelines. SAR information on this model device is on file with the FCC and can be found under the Display Grant section of <http://www.fcc.gov/oet/fccid> after searching on **FCC ID: Q78-ZTEMF50**.

Body Worn Operation

Important safety information regarding radio frequency radiation (RF) exposure:

To ensure compliance with RF exposure guidelines the phone must be used with a minimum of 10 mm

separation from the body.

Failure to observe these instructions could result in your RF exposure exceeding the relevant guideline limits.

National Restrictions

2400.0-2483.5 MHz

Country	Restriction	Reason/remark
Bulgaria		General authorization required for outdoor use and public service
France	Outdoor use limited to 10 mW e.i.r.p. within the band 2454-2483.5 MHz	Military Radiolocation use. Refarming of the 2.4 GHz band has been ongoing in recent years to allow current relaxed regulation. Full implementation planned 2012
Italy		If used outside of own premises, general authorization is required
Luxembourg	None	General authorization required for network and service supply(not for spectrum)
Norway	Implemented	This subsection does not apply for the geographical area within a radius of 20 km from the centre of Ny-Ålesund
Russian Federation		Only for indoor applications

Note: Please don't use the product outdoors in France.

How to Get Help

You can get Help by:

- Sending E-mail to **mobile@zte.com.cn**
- Visiting **http://www.zte.com.cn**
- Calling Service Hotline: **+86-755-26779999**