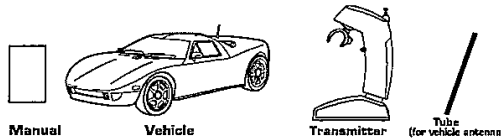

User manual
#9621
Instruction Manual

 Please read through this instruction manual carefully before starting to operate.
 Please ensure to remove all accessories and components from packaging.

How to Play

1. Insert antenna wire through the hollow tube. Avoid pulling wire too tight. Tie a knot on top to secure.
2. Pull the trigger of the controller to control forward and push the trigger to control backwards
3. Swing the controller left for spinning left and swing the controller right for spinning right
4. Turn switch to "ON" position for power. You are set to run!

What is required to play

Battery requirements

 Recommended to use alkaline batteries for best performance.
 Vehicle : 3 x 1.5V (AA) size batteries.
 Transmitter : 1 x 9V (008P , 6F22) size battery.

Battery installation
Transmitter

1. Remove battery cover located at the back.
2. Insert 1 X 9V battery following the + / - marking.
3. Replace battery cover.

Vehicle

- Turn the toggle underside of vehicle to release battery door.
- Insert 3 X 1.5V(AA) batteries following the + / - marking.
- Lock up to secure batteries in position.

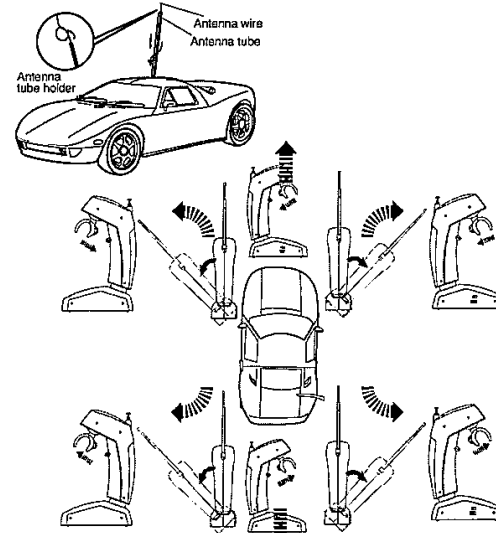
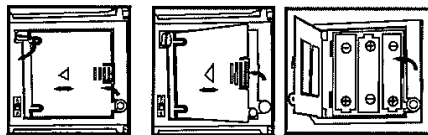
Trim Switch Control

Trim switch is located on the underside of the vehicle, between the two front wheels. and is used to align the wheels for consistent straight line driving.

MAINTENANCE AND CARE

- Never drive the vehicle on a wet floor, on sand, or in mud, rain or snow. Such surfaces may cause damage.
- Do not expose the vehicle to extreme temperatures.
- Be sure to remove the batteries from the vehicle and transmitter when storing the product away.
- To protect the vehicle's wheel mechanism from lint, thread, hair, and dust particles. You can use a small brush, tweezers or tie a small bit of cloth to the tip of a toothpick, etc., and wipe off.
- Always keep vehicle clean, use a dampened cloth to wipe off, and then wipe all the water off with a dry cloth. Never use chemicals to clean the product.
- Keep this instruction manual carefully for future use.
- Avoid holding the wheels when rotating, this will cause the electronic components short - circuit, overheating and cause malfunction.

HELPFUL HINTS

- If vehicle does not respond to the transmitter, move closer to the vehicle and try again.
- If vehicle starts to lose power. It may experience loss of performance ability. If this happens, simply replace with new batteries.
- If the vehicle moves slowly, try changing the batteries and check the wheel mechanisms for lint, thread, hair or dust.
- When the transmitter range decreases, replace the battery in the controller.
- If someone uses a CB nearby, it might interfere with control of the car. If this happens, move the car and transmitter away from the CB.
- Do not touch the motor after play, as it may become hot during long periods of playtime.

CAUTION

- Do not apply a big shock to vehicle and transmitter.
- Do not play in the thunderstorms.
- Do not touch the wheels when the switch is turned ON because it is extremely dangerous.
- Do not leave the vehicle or transmitter near sources of heat or under direct sunlight for long periods of time, which may damage sensitive electronic instruments.
- Do not operate the vehicle near small children, because it can be very dangerous.
- Do not mix old and new batteries together. Do not mix battery type or brands.
- Always select a safe place to play. Never drive your vehicle in the street.
- Non - rechargeable batteries are not to be recharged
- Rechargeable batteries are to be removed from the toy being charged.
- Rechargeable batteries are only to be charged under adult supervision.
- Only batteries of the same or equivalent type as recommended are to be used.
- Batteries are to be inserted with the correct polarity.
- Exhausted batteries are to be removed from the toy.
- The supply terminals are not to be short - circuited.
- Long periods of play time can generate high heat level which causes wear and tear. To extend product life, it is suggested to allow 10 minutes of cool down period before installing new batteries.

TROUBLE SHOOTING

Problem	Causes	Correction
Vehicle doesn't move	- Power switch is turned OFF. - Vehicle is too far away from the controller. - The metal tab in the battery cartridge is flattened and not touching the batteries installed.	- Turn the power switch ON. - Bring the vehicle closer to the controller. - Lift up the metal tab so that it touches the tip of the battery.
Vehicle drives slowly	- Weak batteries in the vehicle.	- Replace with batteries, following the + / - marking.
Floor range control	- Weak battery in the transmitter. - Strong interference at the surrounded area.	- Replace with new battery. - Move to a better location to drive your vehicle.

Warning:

Changes or modifications to this unit not expressly approved by the party responsible for compliance could void the user's authority to operate the equipment.

NOTE: This equipment has been tested and found to comply with the limits for a Class B digital device, pursuant to Part 15 of FCC Rules and R&TTE Directive 1999/5/EC. These limits are designed to provide reasonable protection against harmful interference in a residential installation. This equipment generates, uses and can radiate radio frequency energy and, if not installed and used in accordance with the instructions, may cause harmful interference to the radio communications. However, there is no guarantee that interference will not occur in a particular installation. If this equipment does cause harmful interference to radio or television reception, which can be determined by tuning the equipment off and on, the user is encouraged to try to correct the interference by one or more of the following measures:

- Reorient or relocate the receiving antenna.
- Increase the separation between the equipment and receiver.
- Connect the equipment into an outlet on a circuit different from that to which the receiver is needed.
- Consult the dealer or an experienced radio/TV technician for help.

THIS PRODUCT IS FOR THE USE IN U.K., SPAIN, GERMANY, FRANCE, BELGIUM, ITALY, SWITZERLAND, THE NETHERLANDS, DENMARK, U.S., CANADA AND PORTUGAL.

CE 0197

 English
 #9621
 ©ZAPTOYS 2008
 MADE IN CHINA
 Printed in China

Remarks: The applicant declared that 9621 is the series number while 9608 is the assorted model in this series.