



http://www.zebra.com/3600series

Replace Illustration



Digital Scanner with Keypad & Display Quick Start Guide

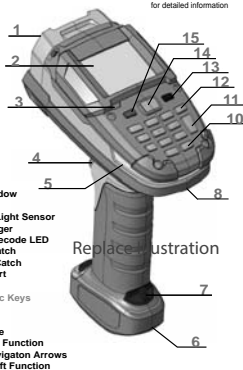

- 1 Scan Window
- 2 Display
- 3 Ambient Light Sensor
- 4 Scan Trigger
- 5 System/Decode LED
- 6 Battery Latch
- 7 Lanyard Catch
- 8 Sound Port
- 9 Keypad with Alpha/Numeric Keys
- 10 Home
- 11 Enter
- 12 Backspace
- 13 Blue Shift Function
- 14 4-way Navigator Arrows
- 15 Green Shift Function

See Product Reference Guide for detailed information

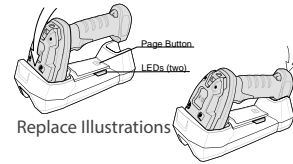

Replace Illustrations

BATTERY INSERTION/REMOVAL

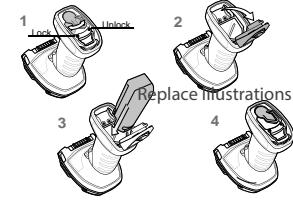

Replace Illustrations

POST IN WORK AREA

CRADLE CABLE CONNECTION

SET DEFAULTS / ENTER KEY BAR CODES

TAB KEY BAR CODE

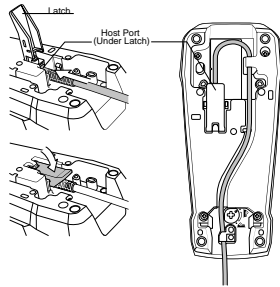

RETURN TO FACTORY DEFAULTS

ADD AN ENTER KEY (Carriage Return/Line Feed)

To add an Enter key after scanned data, scan the bar code below.



ADD AN ENTER KEY (CARRIAGE RETURN/LINE FEED)

ADD A TAB KEY

To add a Tab key after scanned data, scan the bar code below.



ADD A TAB KEY

USB CAPS LOCK OVERRIDE BAR CODE



USB - OVERRIDE CAPS LOCK KEY (ENABLE)



\*USB - DO NOT OVERRIDE CAPS LOCK KEY (DISABLE)

STEP 1 - CONNECT HOST INTERFACE

STEP 2 - SET UP INTERFACE (Scan Host Bar Codes)

USB

NOTE: Cables may vary depending on configuration

Replace Illustration

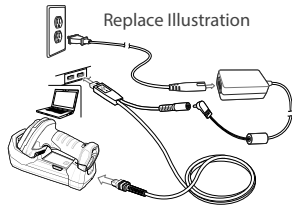

USB

Scan ONE of the bar codes below

The interface cable automatically detects the host interface type and uses the default setting. If the default (\*) does not meet your requirements, scan another host bar code below.



\*USB KEYBOARD (HID)



USB CDC Host



IBM TABLE TOP USB



SNAPI WITHOUT IMAGING



SNAPI WITH IMAGING



USB OPOS HAND-HELD



SIMPLE COM PORT EMULATION



SSI OVER USB CDC



IBM HAND-HELD USB

RS-232

Replace Illustration

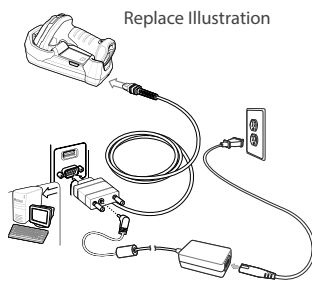

RS-232

Scan ONE of the bar codes below

The interface cable automatically detects the host interface type and uses the default setting. If the default (\*) does not meet your requirements, scan another host bar code below.



\*STANDARD RS-232



NIXDORF RS-232 MODE B



ICL RS-232



FUJITSU RS-232



NIXDORF RS-232 MODE A



OPOS/POS

Keyboard Wedge

Replace Illustration

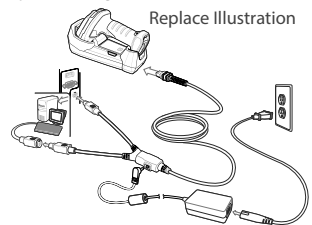

Keyboard Wedge

Scan a bar code below

The Auto-Host Detect Cable feature automatically detects the host interface type and uses the default setting. If the default (\*) does not meet your requirements, scan the IBM PC/AT and IBM PC COMPATIBLE bar code below.



\*IBM AT NOTEBOOK



IBM PC/AT and IBM PC COMPATIBLE

IBM 46XX

Replace Illustration

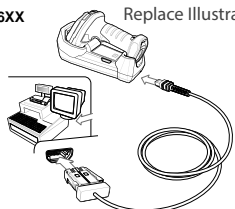

IBM 46XX

Scan ONE of the bar codes below

The Auto-Host Detect Cable feature automatically detects the host interface type, but there is no default setting. Scan one of the bar codes below to select the appropriate port.



NON-IBM SCANNER EMULATION (PORT 9B)



TABLE-TOP SCANNER EMULATION (PORT 17)



HAND-HELD SCANNER EMULATION (PORT 9E)

123Scan

123Scan is an easy-to-use, PC-based software tool that enables rapid and easy customized setup of a scanner via a bar code or USB cable. For more information, visit: www.zebra.com/123Scan.

# DS3678-HP DIGITAL SCANNER WITH KEYBOARD & DISPLAY

# RECOMMENDED USAGE GUIDE - OPTIMUM BODY POSTURE

POST IN WORK AREA

## DS3678 - HP Aiming



## Avoid Extreme Wrist Angles



## Avoid Bending



## Avoid Reaching



# Replace Illustrations

## SCANNER DISPLAY INDICATIONS

### Battery Icons

- Critical low battery / 4 high beeps
- Battery 25% full
- Battery 50% full
- Battery 75% full
- Battery full

### Connection Icons

- Bluetooth active
- Bluetooth inactive

### Keypad Functionality

- Blue Shift Function
- Green Shift Function
- Home
- Batch Mode

### Health and Safety Recommendation

- Ergonomic Recommendations**
- Caution: In order to avoid or minimize the potential risk of ergonomic injury follow the recommendations here. Consult with your local Health & Safety Manager to ensure that you are adhering to your company's safety programs to prevent employee injury.
  - Reduce or eliminate repetitive motion
  - Maintain a natural position
  - Reduce or eliminate excessive force
  - Reduce or eliminate vibration
  - Purform tasks at correct height
  - Keep objects that are used frequently within easy reach
  - Reduce or eliminate direct pressure
  - Provide adjustable workstations
  - Provide adequate clearance
  - Improve work procedures.

# Replace Icon Images

## BEEPER INDICATIONS

Indication	Beeper Sequence
Power up	Low/medium/high beep
Bar code decoded	Medium beep
Transmission error detected; data is ignored	4 long low beeps
Successful parameter setting	High/low/high/low beep
Correct programming sequence performed	High/low beep
Incorrect programming sequence, or Cancel bar code scanned	Low/high beep

Note: In addition to the System/Decode LEDs, the DS3678 cordless digital scanner has a Radio and Battery LED gauge. Refer to the DS3678 Product Reference Guide for detailed information.

## LED INDICATIONS

Hand-Held Scanning	
Indication	LED Indicator
Scanner is on and ready to scan, or no power to scanner	Off
Bar code is successfully decoded	Green
Transmission error	Red
Hands-Free (Presentation) Scanning	
No power to scanner	Off
Scanner is ready to scan	Green
Bar code is successfully decoded	Off Momentarily
Transmission error	Red

Local Contact:

# TROUBLESHOOTING

Scanner not working		Scanner not decoding bar code	
No power to scanner	Check system power.	Scanner not programmed for bar code type	Ensure scanner is programmed to read type of bar code being scanned.
Scanner is disabled	Ensure that correct host interface cable is used.	Bar code unreadable	Ensure bar code is not defaced; try scanning test bar code of same bar code type.
Scanner decoding bar code, but data not transmitting to host	Scan appropriate host parameter bar codes. Ensure all cable connections are secure.	Distance between scanner and bar code incorrect	Move scanner closer to, or further from bar code.
Host interface not configured properly	Program the correct ADF rules.	Scanned data incorrectly displayed on host	Scan appropriate host parameter bar codes.
Interface cable is loose	Scan cradle pairing bar codes.	Region improperly configured	Select appropriate country and language encoding scheme.
Invalid ADF Rule			
Scanner not paired to cradle			

# REGULATORY INFORMATION

**Warranty**  
For the complete Zebra hardware product warranty statement, go to: <http://www.zebra.com/warranty>.

**For Australia Only**  
This warranty is given by Zebra Technologies Asia Pacific Pte. Ltd., 71 Robinson Road, #05-02/03, Singapore 068891, Singapore. Our goods come with guarantees that cannot be excluded under the Australian Consumer Law. You are entitled to a replacement or refund for a major failure and compensation for any other reasonably foreseeable loss or damage. You are also entitled to the full range of remedies if the goods fail to be of acceptable quality and the failure does not amount to a major failure. Zebra Technologies Corporation Australia limited warranty above is in addition to any other remedies you may have under the Australian Consumer Law. If you have any queries, please call Zebra Technologies Corporation at 08 9288 0702. You may also visit our website: <http://www.zebra.com> for the most updated warranty terms.

**Service Information**  
If you have a problem using the equipment, contact your facility's Technical or Systems Support. If there is a problem with the equipment, they will contact the Zebra Global Customer Support Center at: [help@zebra.com](mailto:help@zebra.com). For the latest version of this guide go to: <http://www.zebra.com>.

**Waste Electrical and Electronic Equipment (WEEE)**  
Attention: For EU Customers: All equipment at the end of their life must be returned to Zebra for recycling. For information on how to return product, please go to: <http://www.zebra.com/waste>. Belgium: Dit materiaal is aan televeren bij de lokale autoriteiten voor recycling van afgedankte elektrische en elektronische apparatuur. In België moet het materiaal worden afgeleverd bij de lokale autoriteiten voor recycling van afgedankte elektrische en elektronische apparatuur. In België moet het materiaal worden afgeleverd bij de lokale autoriteiten voor recycling van afgedankte elektrische en elektronische apparatuur.

**Regulatory Information**  
This device is approved under Zebra Technologies Corporation. This guide applies to Model Number DS3678 with Keyboard and Display. All Zebra devices are designed to be compliant with rules and regulations in locations they are sold and will be labeled as required. Local language translations are available at the following website: <http://www.zebra.com/conformity>. Any changes or modifications to Zebra equipment, not expressly approved by Zebra, could void the user's warranty or affect the equipment.

**Caution:** Do not use Zebra approved and UL listed accessories, battery packs, and battery chargers. Only Zebra approved charging devices will work completely with batteries. All components must be dry before connecting to an external power source.

DS3678 Declared maximum operating temperature, 50°C / 122°F (ambient to charge device will complete at 130°F). All components must be dry before connecting to an external power source.

DS3678 Declared maximum operating temperature when used with FLEXIBLE SPC / ST3678 A4PC: 50°C / 122°F.

**Bluetooth® Wireless Technology**  
This is an approved Bluetooth® product. For more information or to view the End Product Listing, visit <https://www.bluetooth.org/go/life/links>.

**Wireless Device Country Approvals**  
This device is approved only for use in the following countries.

Regulatory markings, subject to certification, are applied to the device signifying the radio(s) have approved use in the following countries: United States, Canada, China, Japan, S. Korea, Australia, and Europe. Please refer to the Declaration of Conformity (DoC) for details of other country markings. This is available at <http://www.zebra.com>.

**Warnings for Use of Wireless Devices**

**Caution:** Operation of the device without regulatory approval is illegal.

**Warnings for Use of Wireless Devices**

**Caution:** Please observe all warning notices and refer to the usage of wireless devices.

**Safety in Hospitals**

Wireless devices transmit radio frequency energy and may affect medical electrical equipment. These devices may also be affected by other electromagnetic sources such as mobile phones or medical coils. These requirements are designed to prevent possible interference with sensitive medical equipment.

Package manufacturers recommended that a minimum of 15cm (6 inches) be maintained between a handheld scanner and any implanted medical device.

- Do not use the device in a hospital.
- Should ALWAYS keep the device more than 15cm (6 inches) from their pacemaker when turned ON.
- Do not use the device near any implanted medical device.
- Should use the device further from the pacemaker to minimize the potential for interference.
- If you have any reason to suspect that interference is taking place, turn OFF your device.

**Other Medical Devices**  
Please refer to the information of the manufacturer of the medical device, to determine if the operation of your wireless device may interfere with the medical device.

**RF Exposure Guidelines**

**Safety Information**

- **Read and Follow Instructions - Use Properly**
- **Use the device in accordance with the instructions provided.**

The device complies with intentionally radiated emissions covering human exposure to electromagnetic fields from radio devices. For information on "intentionally" human exposure to electromagnetic fields visit <http://www.fcc.gov>. For further information on the safety of RF energy from wireless devices, visit <http://www.fcc.gov>.

**Storage - Handheld Devices**  
To comply with EN 60950 requirements, this device must be operated in the hand with a minimum separation distance of 20 cm from a person's body. Other storage configurations should be avoided.

**UL and Canada**  
To comply with FCC or CE equipment requirements, the antenna should be maintained at the minimum distance of 20 cm from the body, at all times.

**Caution:** Use of certain accessories, or the performance of procedures other than those specified in the manual may result in hazardous radio frequency exposure.

**Radio Frequency Interference Requirements - FCC**

**FCC Class B Limited Power Device**

Note: This equipment has been tested and found to comply with the limits for a Class B digital device, pursuant to Part 15 of the FCC rules. These limits are designed to provide reasonable protection against harmful interference in a residential installation. This equipment generates, uses, and can radiate radio frequency energy and, if not installed and used in accordance with the instructions, may cause harmful interference to radio or television reception. However, there is no guarantee that interference will not occur in a particular installation. If this equipment does cause harmful interference to radio or television reception, which can be determined by turning the equipment off and on, the user is encouraged to try to correct the interference by one or more of the following measures:

- Reorient or relocate the receiving antenna.
- Increase the separation between the equipment and receiver.
- Connect the equipment into an outlet on a circuit different from that which the receiver is connected to.
- Consult the dealer or an experienced radio/television technician for help.

**FCC Transmitters (Part 15)**

This device complies with Part 15 of the FCC Rules. Operation is subject to the following two conditions:

- (1) This device must not cause harmful interference, and
- (2) this device must accept any interference received, including interference that may cause undesired operation.

**Radio Frequency Interference Requirements - Canada**

**Class B Radiated Emissions (ICES-003)**

This device complies with Industry Canada's license-exempt RSSB. Operation is subject to the following two conditions:

- (1) This device must not cause harmful interference, and
- (2) this device must accept any interference received, including interference that may cause undesired operation.

See approval list conforme exemple de licence la RSS de Industrie Canada. Son fonctionnement est soumis aux deux conditions suivantes:

- (1) le dispositif ne peut causer des interférences, et
- (2) le dispositif doit accepter toute interférence reçue, y compris des interférences qui peuvent causer un mauvais fonctionnement de l'appareil.

**CE Marking and European Economic Area (EEA)**

Bluetooth® Wireless Technology for use through the EEA has the following requirements:

- Maximum notified transmit power of 100mW ERP in the frequency range 2,402-2,483,5 GHz.

Zebra hereby declares that this radio equipment is in compliance with directive 2011/65/EU and 2012/19/EU. (RoHS and WEEE) as well as EMC Directive 2014/53/EU (EMC) and the EU Declaration of Conformity is available at the following internet page: <http://www.zebra.com>.

**Other Countries**

**Japan (VCCI) - Voluntary Control Council for Interference Class B ITE**

この製品は、電波庁指定無線電機等自主適合審査委員会 (VCCI) の基準に適合 (クラス B) の製品です。電波干渉を低減させるために、取扱説明書に記載されている電波干渉防止の注意事項を必ず守ってください。

**Korea Warning Statement for Class B ITE**

이 제품은 전파안전관리위원회 (KCC)의 기준에 적합 (클래스 B)인 무선 전자기기입니다. 전자파 간섭을 줄이기 위해,取扱説明書에 명시된 전자기파 방호 규정을 꼭 지켜주세요.

**Brazil (UNWANTED EMISSIONS - ALL PRODUCTS)**

Regulatory declarations for DS3678 - BRAZIL

For more information contact the website [www.anatel.gov.br](http://www.anatel.gov.br).

NOTA: A marca de certificação se aplica ao Equip. de Radiação Eletromagnética Modelo DS3678. Este equipamento opera em caráter isento, ou seja, é isento de qualquer processo de interferência prévia, podendo de qualquer modo causar interferência a sistemas operando em caráter licenciado. Por favor consulte o site [www.anatel.gov.br](http://www.anatel.gov.br).

**China**

国家无线电管理委员会公告 2012年第 18 号

工业和信息化部公告 2012年第 11 号

工业和信息化部公告 2012年第 11 号

工业和信息化部公告 2012年第 11 号

工业和信息化部公告 2012年第 11 号

**Chile**

Este equipo cumple con la Resolución N° 4308 del 2008, de la Superintendencia de Electrónica y Telecomunicaciones.

**China**

工业和信息化部公告 2012年第 11 号

工业和信息化部公告 2012年第 11 号

工业和信息化部公告 2012年第 11 号

工业和信息化部公告 2012年第 11 号

工业和信息化部公告 2012年第 11 号

**Ukraine**

Згідно технічної документації тестування відповідності до EN 55022 за обмеженого радіоелектромагнітного випромінювання в частотному діапазоні 27,12 - 138 МГц виконано за результатами випробувань.

**Taiwan**

本產品符合 CENELEC EN 55022 標準之電磁干擾 (EMI) 要求。

本產品符合 CENELEC EN 55022 標準之電磁干擾 (EMI) 要求。

本產品符合 CENELEC EN 55022 標準之電磁干擾 (EMI) 要求。

**European Customs Union**

Свободный продукт соответствует требованиям знака ЕАС.

**Battery Safety Guidelines**

The area in which the battery is charged should be clear of debris and combustible materials or chemicals. Particular care should be taken when the device is charged in a confined or unventilated environment.

- Follow battery usage, storage, and charging guidelines found in the user's package.
- Improper battery use may result in fire, explosion, or other hazard.
- To charge the mobile device battery, the battery and charger temperatures must be between 32°F and 104°F (0°C and 40°C).
- Do not use rechargeable batteries and chargers. Use of an incompatible battery or charger may present a risk of fire, explosion, leakage, or other hazard. If you have any questions about the compatibility of a battery or a charger, contact Zebra support.
- For devices that utilize a USB port as a charging source, the device shall only connect to products that meet the USB2.0 port and comply with the USB2.0 compliance program.
- Do not disassemble or open, crush, bend or deform, puncture, or inhale.
- Do not charge from charging any battery-operated device on a hard surface could cause the battery to overheat.
- Do not attach a battery to a battery or conductive object to connect the battery terminals.
- Do not charge or reassemble, recharge or use damaged or non-Zebra batteries.
- Do not attempt to solder or attach the battery to any other device.
- Do not charge the battery in a confined space.
- Do not use the battery in a confined space.
- Do not use the battery in a confined space.
- Do not use the battery in a confined space.
- Do not use the battery in a confined space.
- Do not use the battery in a confined space.
- Do not use the battery in a confined space.

**Scanner Labeling**

CLASS 2 LASER PRODUCT

CLASS 2 LASER PRODUCT

CLASS 2 LASER PRODUCT

CLASS 2 LASER PRODUCT

CLASS 2 LASER PRODUCT

**Batteries**

Replacement

Caution: Risk of explosion if battery is replaced by an incorrect type. Dispose of batteries according to instructions.

Use only Zebra recommended batteries. Accessories which have battery charging capability are approved for use with the following battery models. Part Number: DS3678-SP (U.S. MSRP: \$180.00).

Zebra approved rechargeable battery packs are designed and constructed to the highest standards within the industry.

However, there are limitations to how long a battery can operate or be stored before needing replacement. Many factors affect the actual life cycle of a battery pack, such as heat, cold, harsh environmental conditions and usage.

When batteries are stored over six months, some irreversible deterioration in overall battery quality may occur. Store batteries at half of full charge in a dry, cool place, removed from the equipment to prevent loss of capacity, razing of metallic parts and electrolyte leakage. When storing batteries for one year or longer, the charge level should be verified at least once a year and charged to half of full charge. Replace the battery when a significant loss of life time is observed.

Standard warranty period for all Zebra batteries is 30 days, regardless of the battery type purchased. Standard warranty period for all Zebra batteries is 30 days, regardless of the battery type purchased. Standard warranty period for all Zebra batteries is 30 days, regardless of the battery type purchased. Standard warranty period for all Zebra batteries is 30 days, regardless of the battery type purchased.

**Chongqing**

注意：更換電池時有爆炸的危險。請務必按照說明書的要求進行操作。

僅使用 Zebra 推薦的電池。具有電池充電功能的配件僅適用於以下型號的電池。零件編號：DS3678-SP (美國建議零售價：\$180.00)。

Zebra 推薦的可充電電池包是根據最高行業標準設計和製造的。

然而，電池的持續使用時間和存放時間會受到多種因素的影響。電池的實際使用壽命會受到多種因素的影響。電池的實際使用壽命會受到多種因素的影響。電池的實際使用壽命會受到多種因素的影響。

存放超過六個月的電池，可能會發生不可逆轉的電池質量下降。電池應存放在乾燥、陰涼的地方，遠離設備存放。存放一年或更長時間的電池，應至少每年檢查一次電量，並將其充電至半滿。

當電池顯示壽命顯著縮短時，即應更換電池。

標準保修期為所有 Zebra 電池 30 天，不論電池類型。

標準保修期為所有 Zebra 電池 30 天，不論電池類型。

標準保修期為所有 Zebra 電池 30 天，不論電池類型。

標準保修期為所有 Zebra 電池 30 天，不論電池類型。

MS-02916-01EN-Rev A October 2020