

MC919Z

Quick Start Guide



BATTERY INSERTION

<http://www.motorola.com/mc919Z> See User Guide for more information

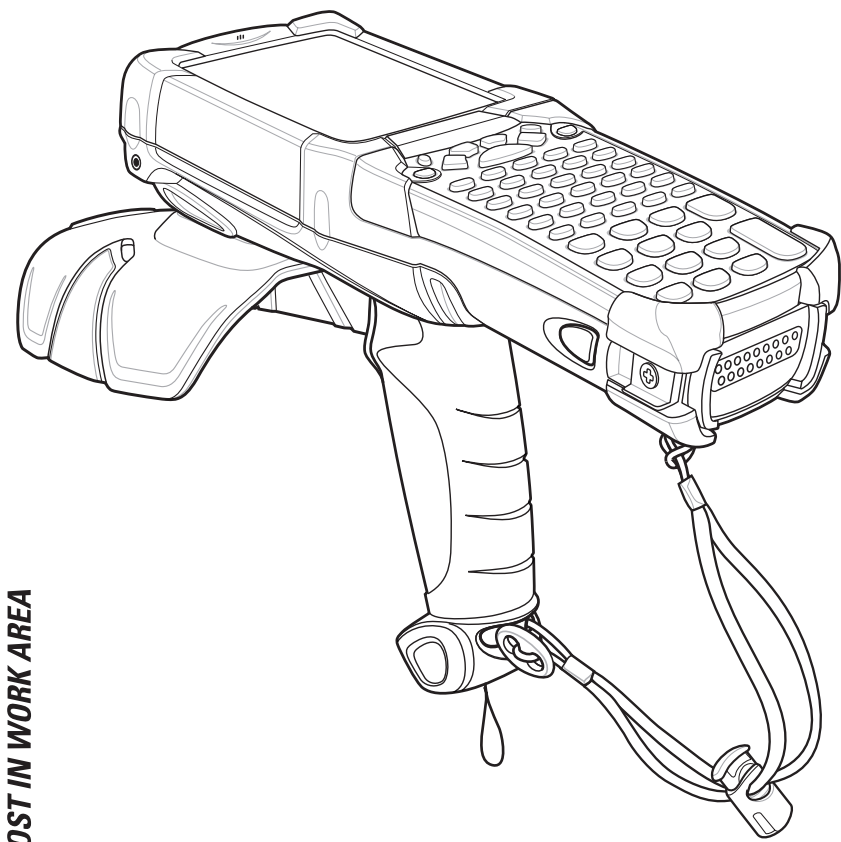

Front View

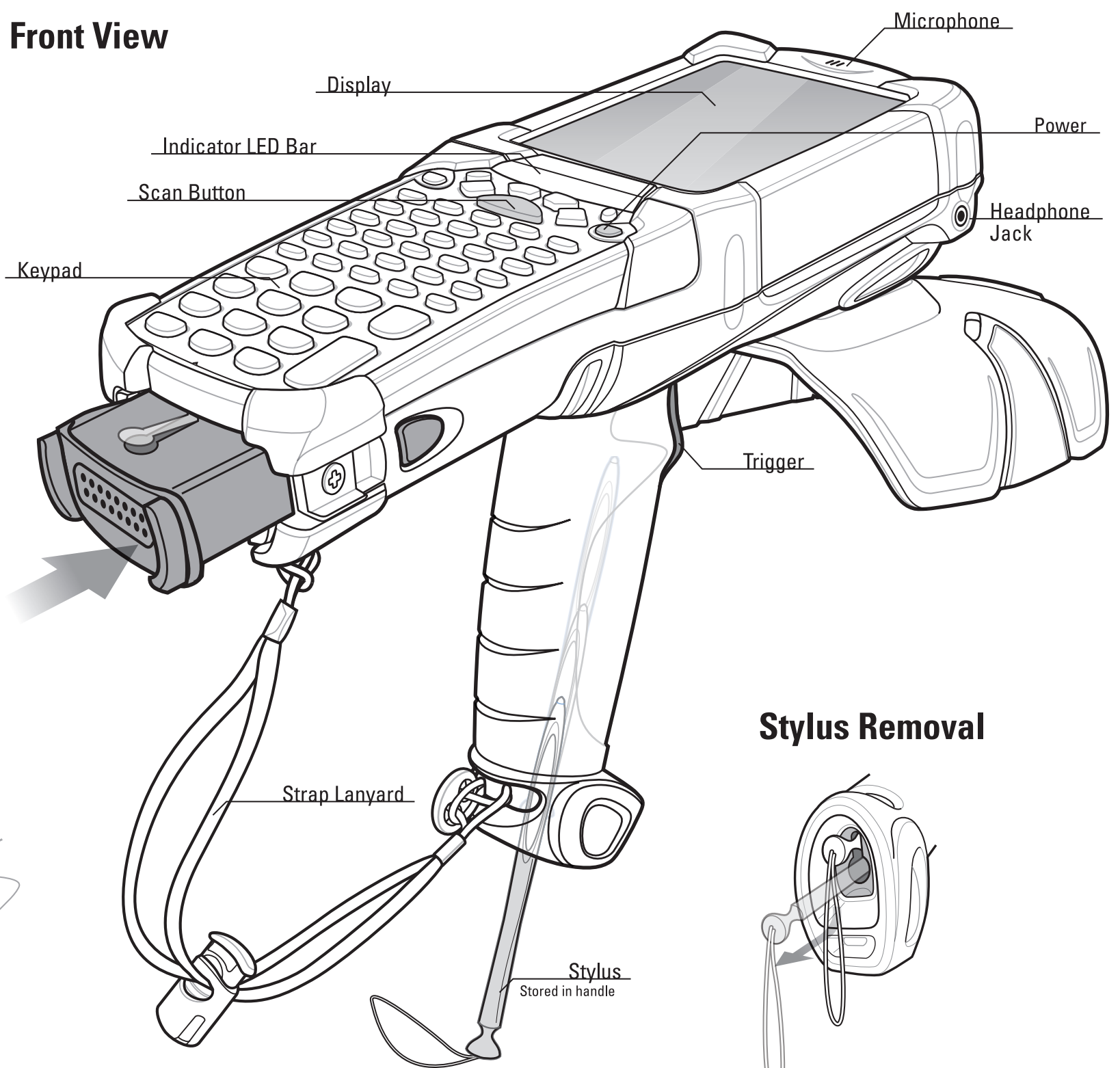

Battery Removal

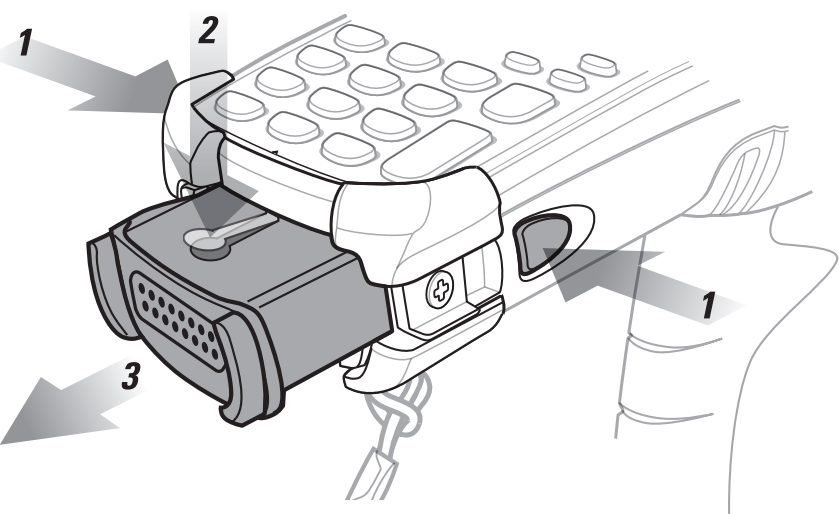

Stylus Removal

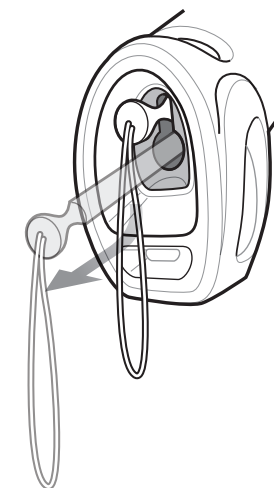

SNAP-ON ACCESSORY INSTALLATION

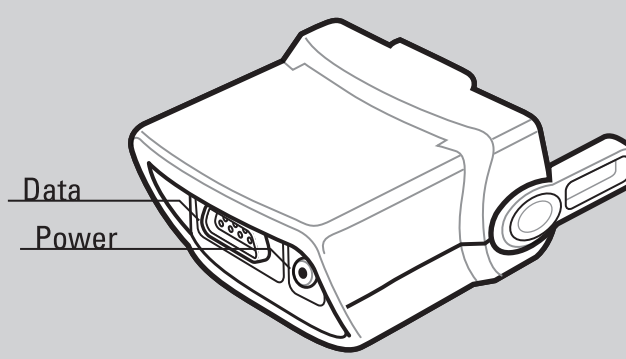
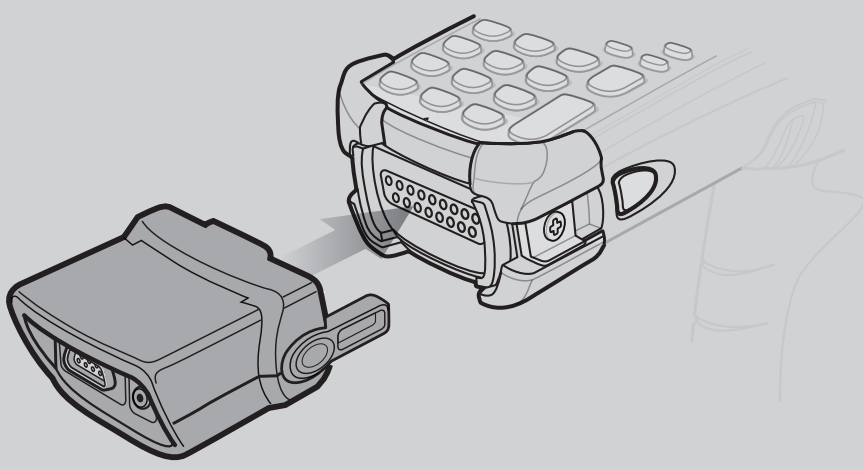

Cable Adapter Module

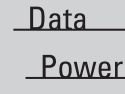
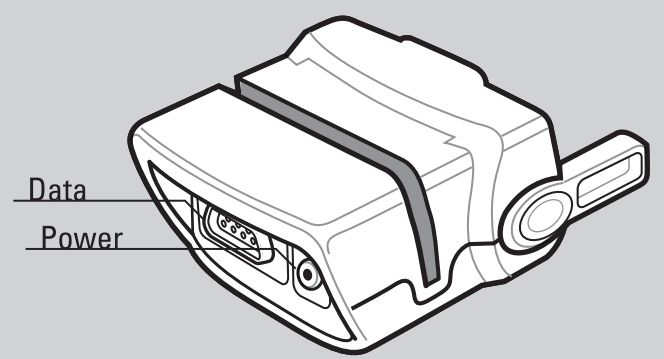

Magnetic Stripe Reader

CHARGING INSTRUCTIONS

⦿ = LED Indicator Location Slow Flash = Normal Charge Solid Amber = Full Charge Fast Flash = Charging Error

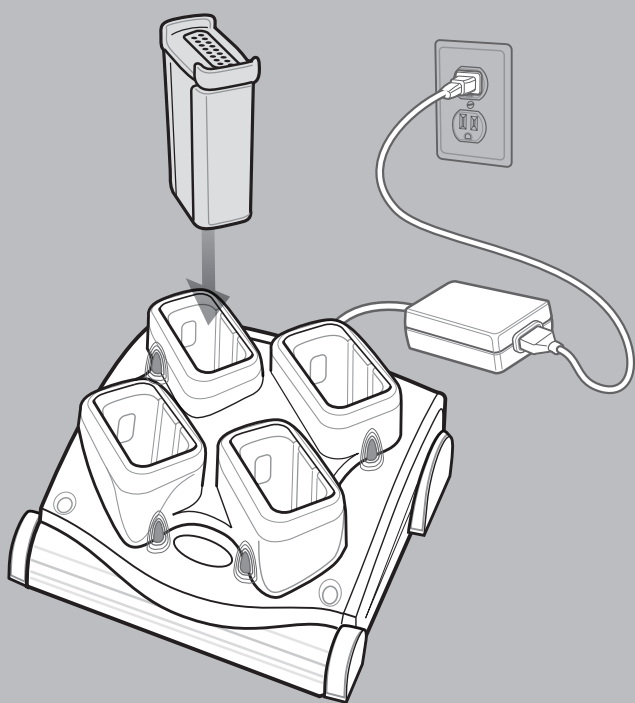

Four Slot Spare Battery Charger

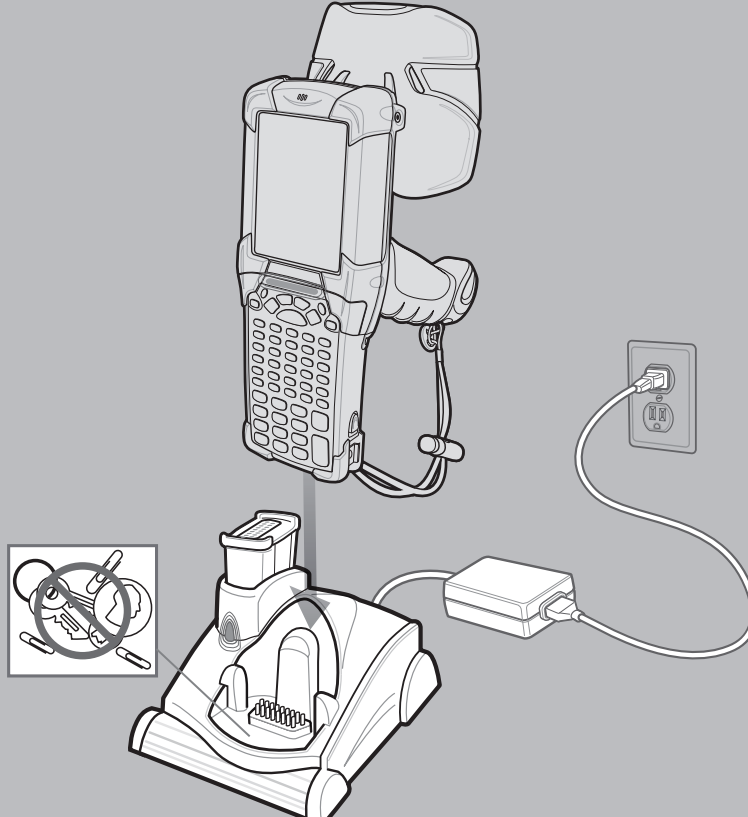

Single Slot Serial/USB Cradle

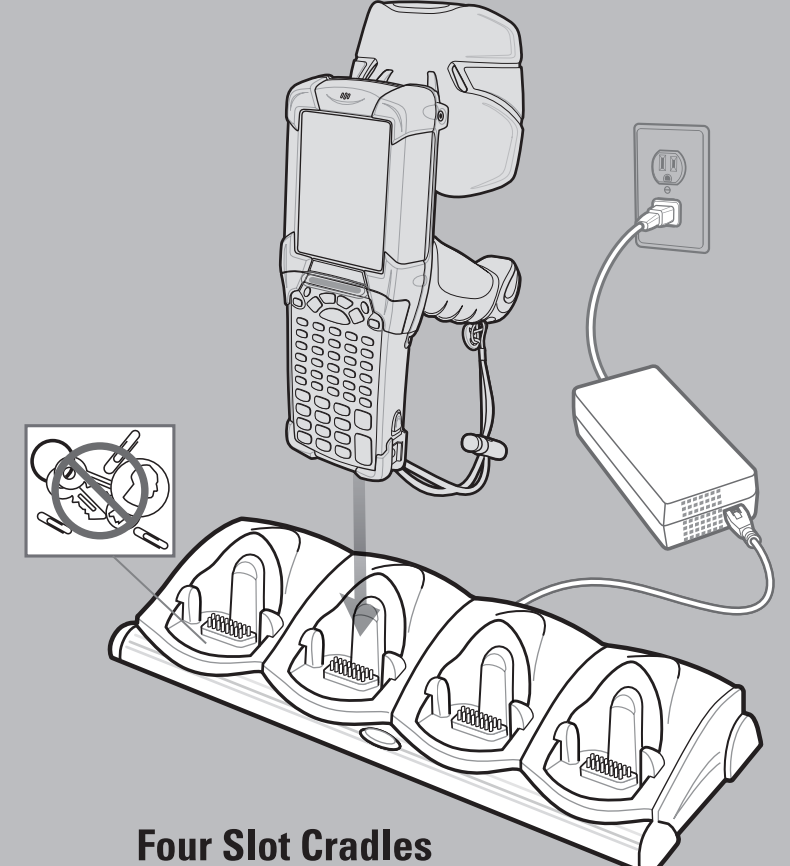

Four Slot Cradles
Charge-Only Cradle and Ethernet Cradle

OPTIMUM IMAGING AND SCANNING POSITIONS

Laser Scanning

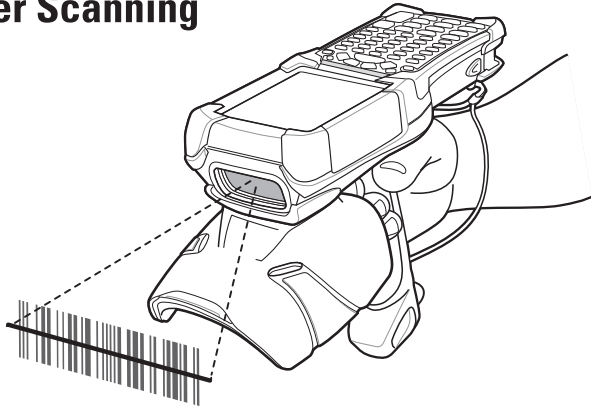

Standard Range Imaging

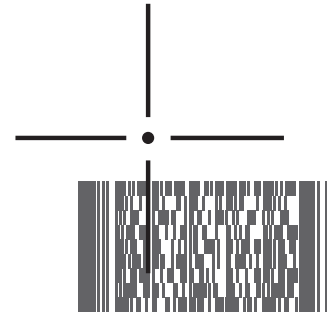
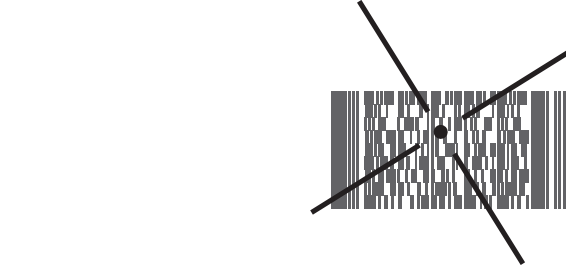
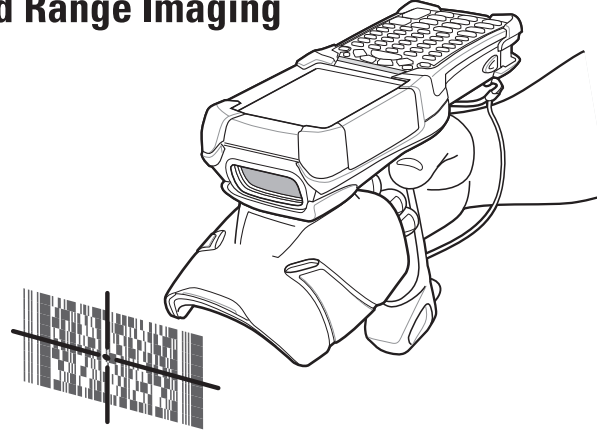

Long Range Imaging

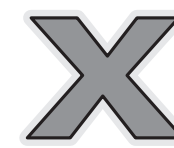
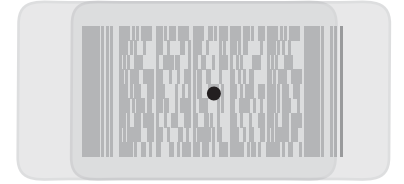
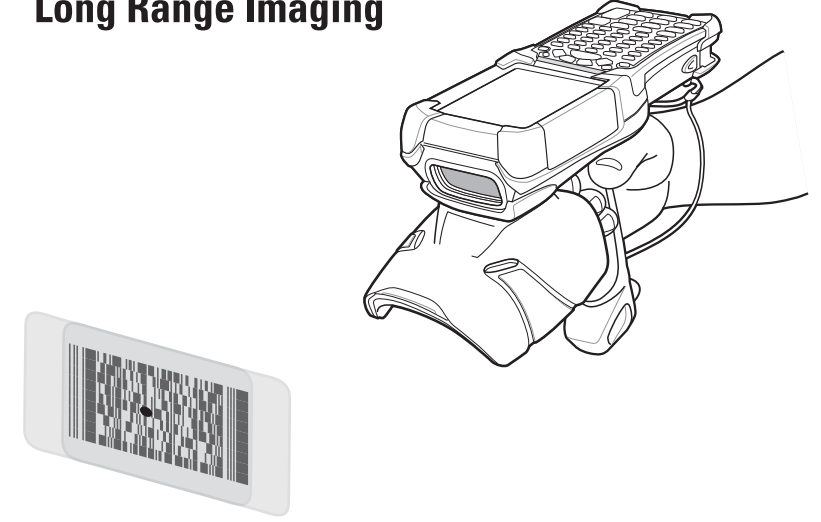

OPTIMUM UPRIGHT BODY POSTURE

AVOID EXTREME WRIST ANGLES

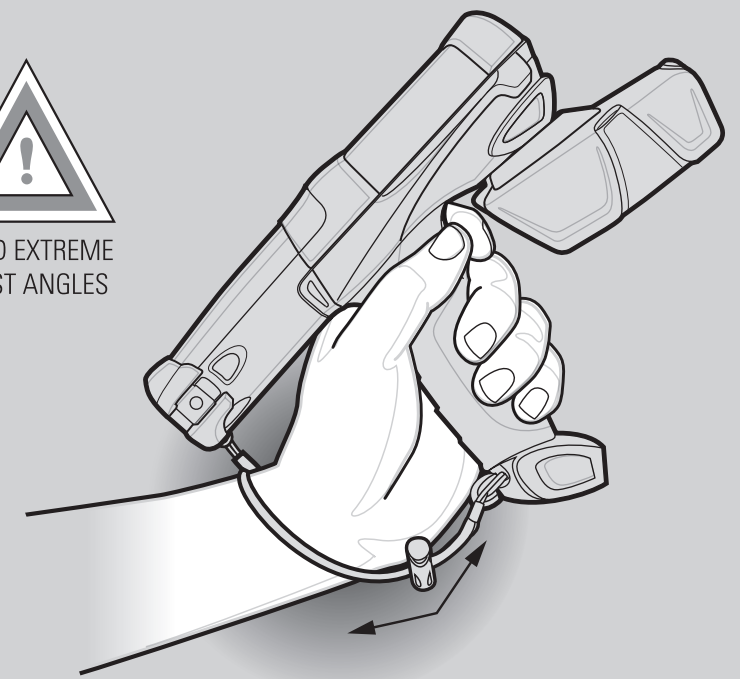
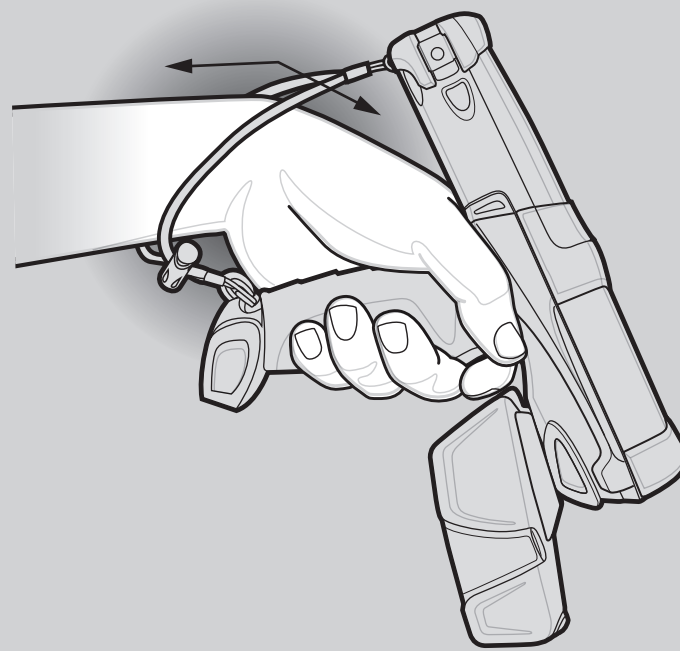

ALTERNATE LEFT AND RIGHT HANDS
TAKING BREAKS AND TASK ROTATION RECOMMENDED

OPTIMUM BODY POSTURE

Low Scanning

Alternate left and right knees

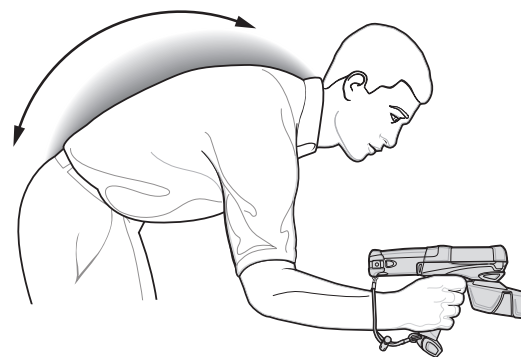

Alternate left and right hands



High Scanning

Use a ladder



Taking breaks and task rotation recommended

POST IN WORK AREA



MOTOROLA

One Motorola Plaza Holtsville, New York 11742-1300, USA
MOTOROLA, MOTO, MOTOROLA SOLUTIONS and the Stylized M Logo are trademarks or registered trademarks of Motorola Trademark Holding, LLC and are used under license. All other trademarks are the property of their respective owners. © 2011 Motorola, Inc. All rights reserved.



72-152191-01 Rev. A - February 2012



<http://www.motorola.com/mc919z>