

MC95XX Series

Quick Start Guide

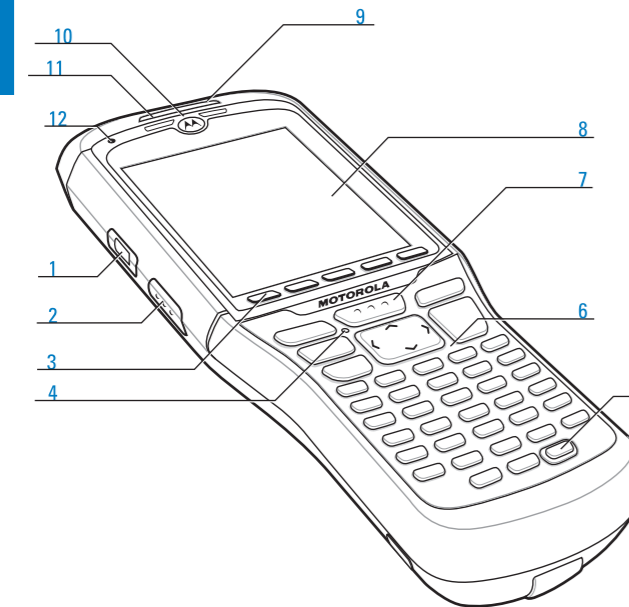

FEATURES



- 1 Up/Down Volume Button
- 2 Scan/Application Button
- 3 Function Keys
- 4 Microphone
- 5 Power Button
- 6 Keypad
- 7 Scan/Action Button
- 8 Touch Screen (with screen protector)
- 9 Scan/Decode LED
- 10 Receiver
- 11 Charging/Battery Status LED
- 12 Radio Status LED

Note 1: To warm boot the MC95XX, press and hold the Power button for five (5) seconds.
To cold boot the MC95XX, press and hold the 1, 9 and Power button.

- 13 Speaker
- 14 Camera and Flash
- 15 Interface Connector
- 16 Stylus
- 17 Scan Exit Window (see Data Capture Options)
- 18 IrDA Window
- 19 Action Button
- 20 Scan/Application Button
- 21 Headset Connector
- 22 Battery Release Button
- 23 Battery

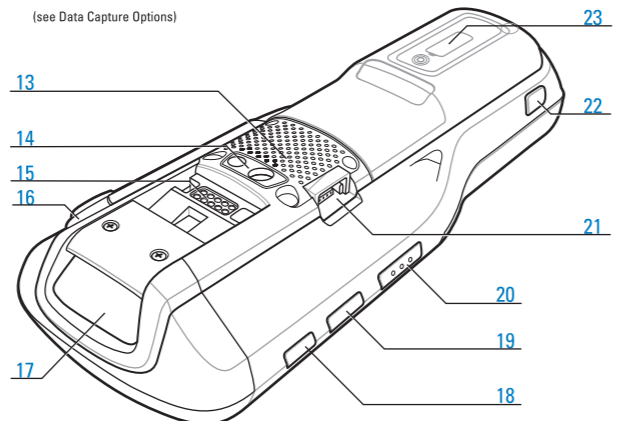

LED Notifications

Scan/Decode

Charging/Battery Status

Radio Status

Charging/Battery Status:

- Slow blinking amber: Battery charging
- Solid green: Fully charged
- Fast blinking amber: Charging error

Scan/Decode:

- Red: Scanning active
- Green: Good Decode

Radio Status:

- Flashing blue: RF activity

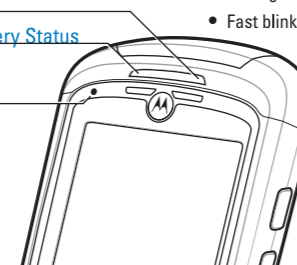

KEYPADS



Telephony Numeric



Biometric Telephony Numeric



Calculator Numeric



Alpha Numeric Wide



Alpha Primary

GETTING STARTED

1 Insert the Battery

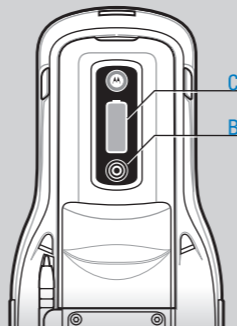
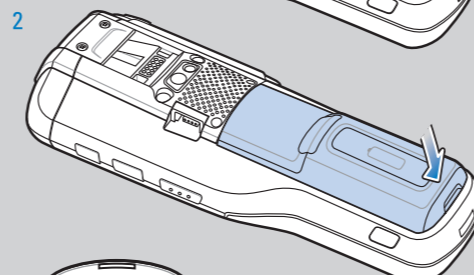
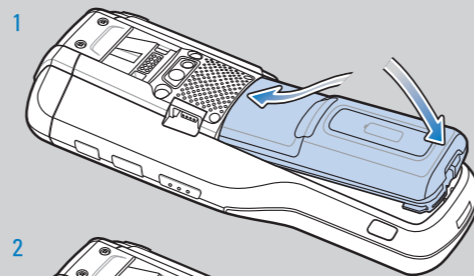

Charge Level Indicator

Battery Status Button

Battery Indications

Press the Battery Status button. Charge Level Indicator display approximate battery level.



2 Charge the MC95XX



1-Slot Cradle

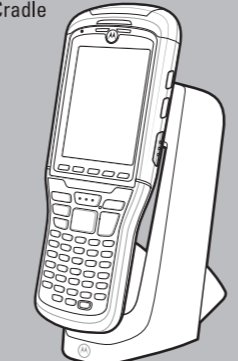

4-Slot Cradle

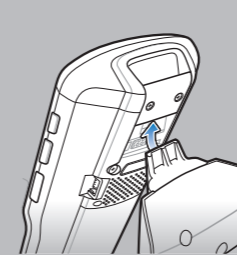
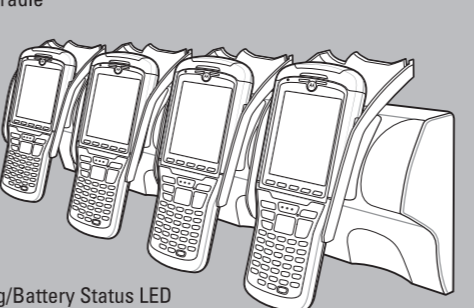

Charge the Battery

1-Slot Spare Battery Charger

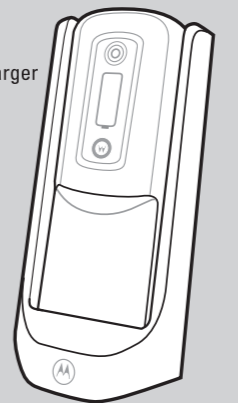

4-Slot Battery Charger

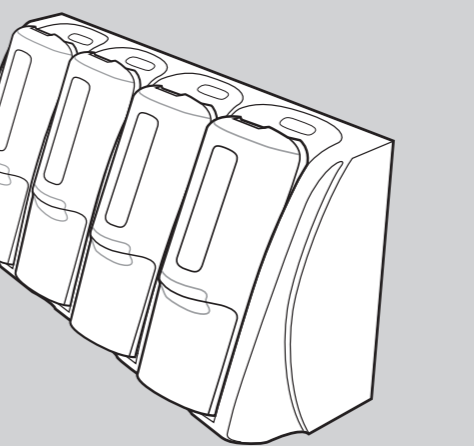

Charging/Battery Status LED

- Slow Blinking Amber = Charging
- Solid Green = Fully Charged
- Fast Blinking Amber = Charging error
- Solid Red = Un-healthy battery

* It is recommended that this product be charged for 24 hours before the first use to ensure that the internal battery is fully charged.

PHONE SETUP

SIM Card Installation (MC9596 Only)

1. Remove battery pack.
2. Remove SIM cover using flathead screwdriver.
3. Slide SIM card holder to the left.
4. Lift card holder.
5. Insert SIM card into SIM holder.

NOTE:

The proper position of the SIM card—the card connector (i.e., gold area) should be facing down with the beveled edge facing down.

6. Lower the SIM card holder down.
7. Slide SIM card holder to the right to lock into place.
8. Reinstall SIM cover and secure screw.
9. Reinstall battery pack.
10. Warm boot the MC9596.

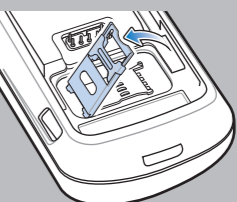
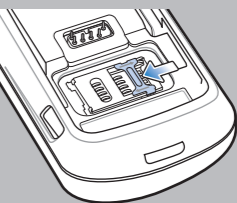

Enter Your PIN

After installing the SIM card activate your mobile service connection. In most cases, SIM cards are preset with a PIN (Personal Identity Number), provided by your service provider.

1. Press the Power button to turn on the MC9596.
2. Tap Start > Phone.
3. Enter the PIN from your service provider.
4. Tap Enter.

COMMUNICATION

3 Install ActiveSync®

Download ActiveSync® 4.5 or higher from <http://www.microsoft.com> and follow the instructions to install ActiveSync onto the host computer.

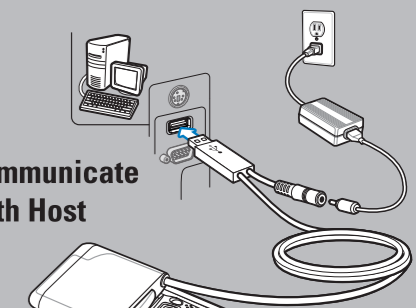

4 Communicate with Host

5 Create a Partnership

Follow the on-screen ActiveSync instructions to establish a connection between the MC95XX and the host computer.

SUPPORT INFORMATION

More Information on the MC95XX

Visit the Motorola Web site at <http://www.motorola.com/mc9500>

Setting up, using and troubleshooting the MC95XX

MC95XX User Guide
MC95XX Integrator Guide
Available at: <http://www.motorola.com/mc9500>

Additional Software

Check Motorola web site for approved applications.
<http://www.motorola.com/mc9500>

Connecting and synchronizing with the host computer

ActiveSync® Help on the host computer. To view help, start ActiveSync®, Click Help - Microsoft ActiveSync Help.

Information on using programs on the MC95XX

Tap Start – Help within the specific program.

Service and Warranty

MC95XX Regulatory Guide



MOTOROLA
Motorola, Inc.
One Motorola Plaza Holtsville, New York 11742-1300, USA
MOTOROLA and the Stylized M Logo and Symbol and the Symbol logo are registered in the U.S. Patent and Trademark Office. All other product or service names are the property of their respective owners.
© Motorola, Inc. 2009



72-118504-01 Rev. 1 — January 2009

ACCESSORIES

microSD Card Installation

1. Remove battery pack.
2. Remove SIM cover using flathead screwdriver.
3. Slide microSD card holder to the left.
4. Lift card holder.
5. Insert microSD card into holder.

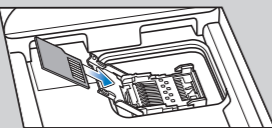
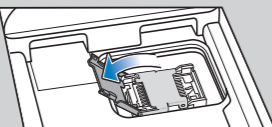

NOTE:

The proper position of the microSD card—the card connector (i.e., gold area) should be facing outward with the bevelled corner facing away.

6. Lower the microSD card holder down.
7. Slide card holder to the right to lock into place.
8. Reinstall SIM cover and secure screw.
9. Reinstall battery pack.
10. Warm boot the MC95XX.

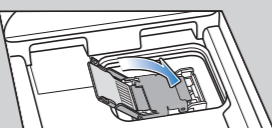

Screen Protector

Motorola recommends the use of a screen protector to minimize wear and tear. Screen protectors enhance the usability and durability of touch screen

- Protection from scratches and gouges
- Durable writing and touch surface with tactile feel
- Abrasion and chemical resistance
- Glare reduction

Not using a screen protector can affect your warranty coverage.

An initial screen protector is already applied to your MC95XX. Contact your local account manager or Motorola, Inc. for more information and purchasing details. Part number: KT-67525-01R Screen Protector 3/pk.

Vehicle Cradle

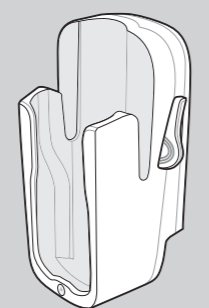

Auto-Charge Cable

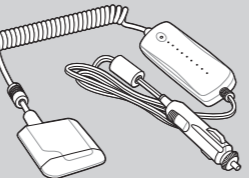

Vehicle Battery Charger



One Slot USB Cradle



One Slot Battery Charger



USB Charging Cable

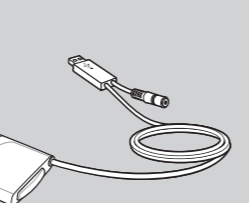

Four Slot Charge Only Cradle

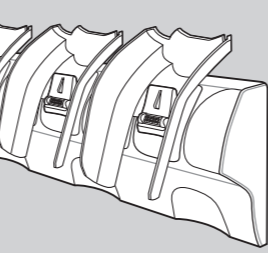

Four Slot Battery Charger

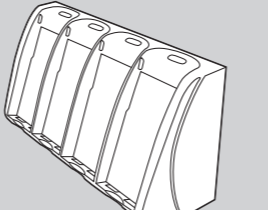

Magnetic Stripe Reader

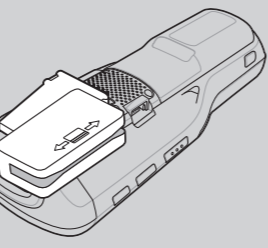

CABLE CONNECTION

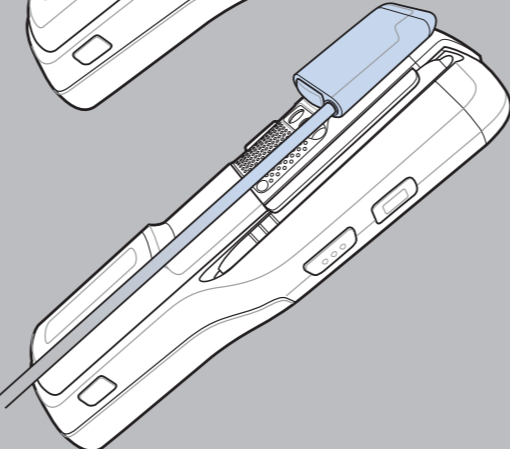
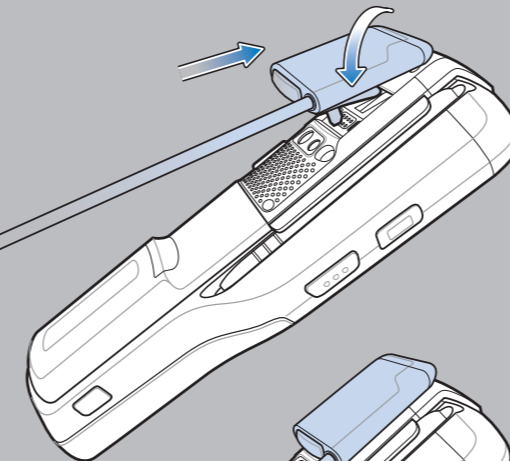

DATA CAPTURE OPTIONS

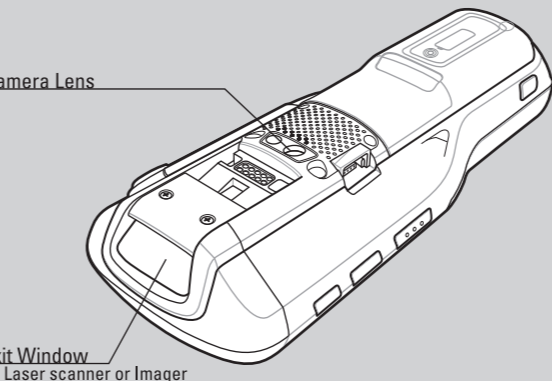

GPS Information

When using the GPS feature of the MC95XX:

- Acquiring satellite signals may take a few minutes. It is best to be outside and have a clear, unobstructed view of the sky.
- Without a clear view, acquisition takes much longer and could result in the MC95XX being unable to compute the initial position quickly.
- Obtain a satellite fix before moving.
- Shutdown GPS application when not in use.

OPTIMUM SCANNING AND IMAGING

Scanning/Imaging

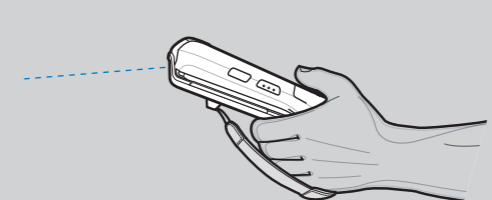

Laser Scanning



Imaging

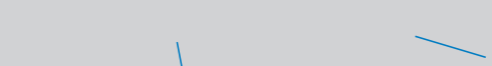

Camera Decode

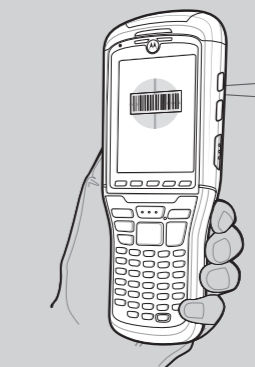

1. Launch a bar code reading application on the MC95XX.
2. Position the MC95XX toward the bar code.
3. Press the **Scan** button.
4. In the image window align the red target over the bar code. When the MC95XX decodes the bar code the target turns green.

Camera Photo

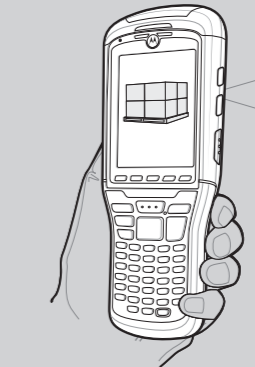

1. Tap **Start > Programs > Pictures & Videos > Camera**.
2. Point the MC95XX at an object.
3. Press the **Enter** button.
4. Hold MC95XX still until "Shutter Sound" is heard.

ERGONOMIC CONSIDERATIONS

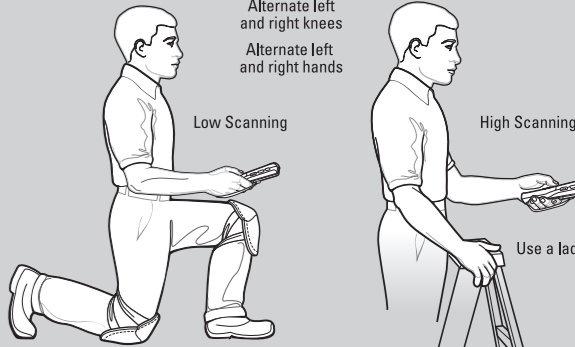
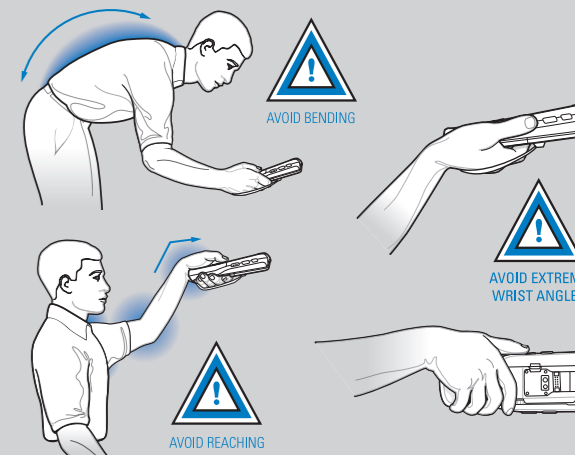

Taking breaks and task rotation recommended

<http://www.motorola.com/mc9500>