



ANT+ COMBO SENSOR

MODEL: BDS100

USER INSTRUCTION

1. Before using, please make sure 1 set includes combo sensor (1pc), magnet set for speed sensor(1pc),magnet for cadence sensor (1pc) , cable tie (4pcs), instruction paper
2. Assembling combo sensor on bicycle frame by using 2pcs of cable tie (see picture 1)
3. Assembling magnet (for speed sensor) on the rear wheel spoke by screws (see picture 1)
4. Assembling magnet (for cadence sensor) on the crank by using 2pcs cable tie (see picture 1)
Note: the distance between magnets and combo sensor need to be less 12cm (see picture 2)
5. Press LED button on combo sensor, the LED show red and green light for 2 seconds, when the magnet pass speed sensor for first 10 times and the LED show green light and it means the installation is success
6. Press LED button on combo sensor, the LED show red and green light for 2 seconds, when the magnet pass cadence sensor for first 10 times and the LED show red light and it means the installation is success
7. To replace the battery, please put the coin on the slot of battery hatch and turn left to open and take the battery from the combo sensor then put the new battery in
(Note: please make sure O-ring is placed in correct position after the battery hatch is open)
8. To put the battery hatch back, please put the coin on the slot of battery hatch and turn right to close and tight the battery hatch on combo sensor

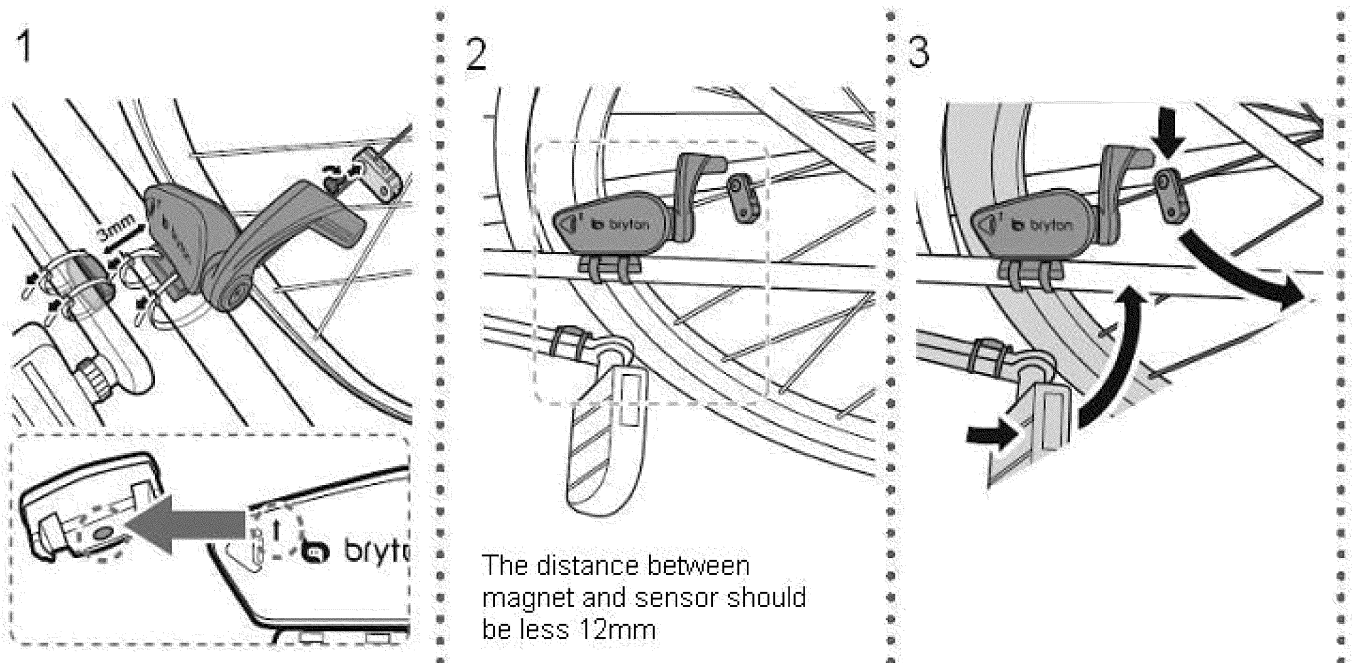

Federal Communication Commission Interference Statement

This equipment has been tested and found to comply with the limits for a Class B digital device, pursuant to Part 15 of the FCC Rules. These limits are designed to provide reasonable protection against harmful interference in a residential installation. This equipment generates, uses, and can radiate radio frequency energy and, if not installed and used in accordance with the instructions, may cause harmful interference to radio communications. However, there is no guarantee that interference will not occur in a particular installation. If this equipment does cause harmful interference to radio or television reception, which can be determined by turning the equipment off and on, the user is encouraged to try to correct the interference by one or more of the following measures:

- Reorient or relocate the receiving antenna.
- Increase the separation between the equipment and receiver.
- Connect the equipment into an outlet on a circuit different from that to which the receiver is connected.
- Consult the dealer or an experienced radio/TV technician for help.

FCC Caution:

This device complies with Part 15 of the FCC Rules. Operation is subject to the following two conditions: (1) This device may not cause harmful interference, and (2) this device must accept any interference received, including interference that may cause undesired operation.

.

changes / modifications not approved by the responsible party could void the user's authority to operate the equipment.