



Quick Start Guide

Version 1.0.0



1.2.51.32.T2.00108183

Packing List



Device*1



QSG*1



Power Adapter*1



Quick Installation Board*1



Installation Position Map*1



Screw Package*1



USB*1

Product Appearance

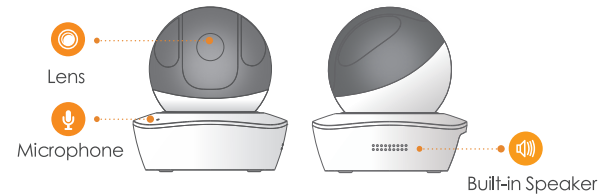
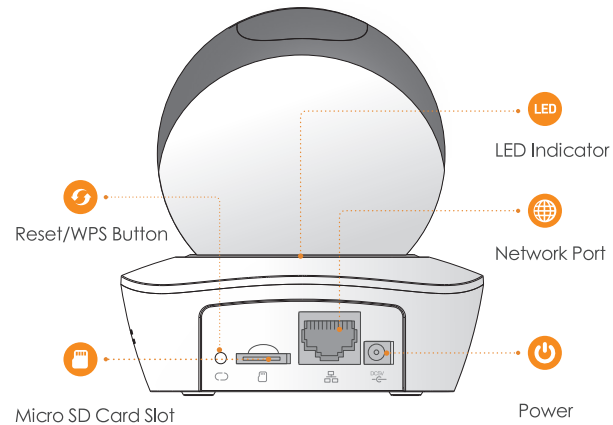

The following table shows more information about status of indicator light

Indicator Light Status	Device Status
Spinning red	<ul style="list-style-type: none">BootingDevice malfunctionFailed to boot up
Spinning green	<ul style="list-style-type: none">Booting completedWaiting for Wi-Fi configuration
Flashing yellow	<ul style="list-style-type: none">WiFi connection processDevice has been configured with WiFi, but it failed to work normally
Flashing green	WPS pairing
Blue light stably on	<ul style="list-style-type: none">Wi-Fi connection succeededOperate normally
Flashing blue	Device upgrade
Flashing red	SD card malfunction

Note:

To reset, long press for 10 seconds till the light is off; to enable WPS, just press the button.

Operation by Lechange App

Step 1

Power on your camera with power adapter.

Step 2

Connect your smartphone to your Wi-Fi network, scan "Lechange" QR on the packing box, download and install Lechange App.



Step 3

Run Lechange App, and register account for first use.

Step 4

Follow the steps below to add your camera .

Note:

- If you have more cameras, please follow step 4 to add them one by one.
- If you want to change the Wi-Fi signal, please reset the camera to factory default and repeat step 4 to add the camera.

Device Installation

Note:

Before installation, please make sure the installation environments can at least support 3x weight of the device.

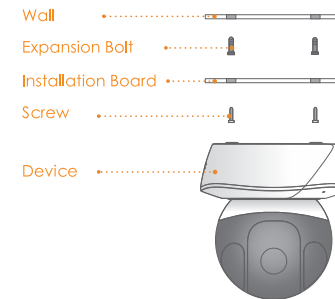

To install the device, do the following.

- Step1** Drill holes on the wall and install the expansion bolts into the drilled holes.
- Step2** Fix the installation board with screws onto the wall.
- Step3** Spin the device to get locked onto the installation board.

Disclaimer

- This quick start guide is for reference only. Minor difference might be found in user interface.
- All the design and software here are subject to change without prior written notice.
- All trademarks and registered trademarks mentioned are the properties of their respective owners.
- Please visit our website or contact your local service engineer for more information.
- If there is any uncertainty or controversy, please refer to our final explanation.

Regulatory Information

FCC Information

This device complies with Part 15 of the FCC Rules. Operation is subject to the following two conditions:

- (1) This device may not cause harmful interference, and
- (2) This device must accept any interference received, including interference that may cause undesired operation.

Attention that changes or modification not expressly approved by the party responsible for compliance could void the user's authority to operate the equipment.

Note: This product has been tested and found to comply with the limits for a Class B digital device, pursuant to Part 15 of the FCC Rules. These limits are designed to provide reasonable protection against harmful interference in a residential installation. This product generates, uses, and can radiate radio frequency energy and, if not installed and used in accordance with the instructions, may cause harmful interference to radio communications. However, there is no guarantee that interference will not occur in a particular installation. If this product does cause harmful interference to radio or television reception, which can be determined by turning the equipment off and on, the user is encouraged to try to correct the interference by one or more of the following measures:

- Reorient or relocate the receiving antenna.
- Increase the separation between the equipment and receiver.
- Connect the equipment into an outlet on a circuit different from that to which the receiver is connected.
- Consult the dealer or an experienced radio/TV technician for help.

This equipment should be installed and operated with a minimum distance 20cm between the radiator and your body