



Chelsea Home Imports™

MODEL: CIL-E-9

Docking Speaker with Bluetooth





 **Bluetooth®**

Instruction Manual

Contents

| | |
|------------------------------------------------|-----------|
| Important Safety Instructions | 2 |
| Safety..... | 2 |
| Warning | 2 |
| Identifying the Parts | 4 |
| Main Unit | 4 |
| Remote Control | 4 |
| Preparations..... | 5 |
| Prepare the Remote Control | 5 |
| Precautions Concerning Batteries | 5 |
| Install Batteries | 6 |
| Connect Power | 6 |
| General Operation..... | 6 |
| Powering ON/OFF / STANDBY | 6 |
| Selecting Modes..... | 6 |
| Set Time | 6 |
| Set the alarm timer..... | 7 |
| Adjust Display Brightness | 7 |
| Adjust Volume Level | 7 |
| Select a Preset Sound Effect | 7 |
| Set the sleep timer | 7 |
| Select repeat play options..... | 7 |
| Play from an External Audio Device..... | 7 |
| Play from iPod/iPhone/iPad..... | 7 |
| iPod/iPhone/iPad Operation..... | 7 |
| Play With Bluetooth Device | 8 |
| Pair Bluetooth-enabled Devices | 8 |
| Listen to Music from Bluetooth Device..... | 9 |
| Listening to the FM Radio | 9 |
| Auto Scan and Save Preset Station..... | 9 |
| Tune to a Preset Radio Station | 9 |
| Tuning in a Station | 9 |
| Presetting Stations Manually..... | 9 |
| Troubleshooting | 10 |
| Specifications..... | 10 |
| Standard Accessories | 10 |

Important Safety Instructions

| | | |
|-----------------------------------------------------------------------------------------------------------------------------------------------------------------|-----------------------------------------------------------------------|-----------------------------------------------------------------------------------|
|  | WARNING RISK OF ELECTRIC SHOCK DO NOT OPEN |  |
| CAUTION: TO REDUCE THE RISK OF ELECTRIC SHOCK, DO NOT REMOVE COVER (OR BACK). NO USER-SERVICEABLE PARTS INSIDE. REFER SERVICING TO QUALIFIED SERVICE PERSONNEL. | | |



The lightning flash with arrowhead symbol, within an equilateral triangle, is intended to alert the user to the presence of uninsulated "dangerous voltage" within the product's enclosure that may be of sufficient magnitude to constitute a risk of electric shock to persons.



The exclamation point within an equilateral triangle is intended to alert the user to the presence of important operating and maintenance (servicing) instructions in the literature accompanying the appliance.

Safety

- 1 Read these instructions – All the safety and operating instructions should be read before this product is operated.
- 2 Keep these instructions – The safety and operating instructions should be retained for future reference.
- 3 Heed all warnings – All warnings on the appliance and in the operating instructions should be adhered to.
- 4 Follow all instructions – All operating and use instructions should be followed.
- 5 Do not use this apparatus near water – The appliance should not be used near water or moisture – for example, in a wet basement or near a swimming pool, and the like.
- 6 Clean only with dry cloth.
- 7 Do not block any ventilation openings. Install in accordance with the manufacturer's instructions.
- 8 Do not install near any heat sources such as radiators, heat registers, stoves, or other apparatus (including amplifiers) that produce heat.
- 9 Do not defeat the safety purpose of the polarized or grounding plug. A polarized plug has two blades with one wider than the other. A grounding plug has two blades and a third grounding prong. The wide blade or the third prong is provided for your safety. If the provided plug does not fit into your outlet, consult an electrician for replacement of the obsolete outlet.
- 10 Protect the power cord from being walked on or pinched particularly at the plugs, convenience receptacles, and at the point where they exit from the apparatus.
- 11 Only use attachments/accessories specified by the manufacturer.
- 12 Use only with the cart, stand, tripod, bracket, or table specified by the manufacturer, or sold with the apparatus. When a cart or rack is used, use caution when moving the cart/apparatus combination to avoid injury from tip-over.
- 13 Unplug the apparatus during lightning storms or when unused for long periods of time.
- 14 Refer all servicing to qualified personnel. Servicing is required when the apparatus has been damaged in any way, such as power supply cord or plug is damaged, liquid has been spilled or objects have fallen into the apparatus has been exposed to rain or moisture, does not operate normally, or has been dropped.
- 15 This equipment is a Class II or double insulated electrical appliance. It has been designed in such a way that it does not require a safety connection to electrical earth.

Caution:

- Use of controls or adjustments or performance of procedures other than herein may result in hazardous radiation exposure or other unsafe operation.

Warning

- The battery (battery or batteries or battery pack) shall not be exposed to excessive heat such as sunshine, fire or the like.
- Before operating this system, check the voltage of this system to see if it is identical with the voltage of your local power supply.
- The ventilation should not be impeded by covering the ventilation openings with items such as newspaper, table-cloths, curtains etc.

Make sure there is at least 20 cm of space above and at least 5cm of space on each side of the unit.

- Do not place this unit close to strong magnetic field.
- Do not place the unit on the amplifier or receiver.
- Don't place this unit close to the damper, or the moisture will affect the life of the laser head.
- Should any solid object or liquid fall into the system, unplug the system and have it checked by qualified personnel before operating it any further.
- Do not attempt to clean the unit with chemical solvents as this might damage the finish. Use a clean, dry or slightly damp cloth.
- When removing the power plug from the wall outlet, always pull directly on the plug, never yank on the cord.
- Depending on the electromagnetic waves used by a television broadcast, if a TV is turned on near this unit while it is also on, lines might appear on the TV screen. Neither this unit nor the TV are malfunctioning. If you see such lines, keep this unit well away from the TV set.
- No naked flame sources, such as lighted candles, should be placed on the apparatus.
- Changes or modifications to this unit not expressly approved by the party responsible for compliance could void the user's authority to operate the equipment.

NOTE:

- This equipment has been tested and found to comply with the limits for a Class B digital device, pursuant to Part 15 of the FCC Rules. These limits are designed to provide reasonable protection against harmful interference in a residential installation. This equipment generates, uses and can radiate radio frequency energy and, if not installed and used in accordance with the instructions, may cause harmful interference to radio communications.
- However, there is no guarantee that interference will not occur in a particular installation. If this equipment does cause harmful interference to radio or television reception, which can be determined by turning the equipment off and on, the user is encouraged to try to

correct the interference by one or more of the following measures:

- Reorient or relocate the receiving antenna.
- Increase the separation between the equipment and receiver.
- Connect the equipment into an outlet on a circuit different from that to which the receiver is connected.
- Consult the dealer or an experienced radio/TV technician for help.
- This device complies with Part 15 of the FCC Rules. Operation is subject to the following two conditions:
 - 1) this device may not cause harmful interference, and
 - 2) this device must accept any interference received, including interference that may cause undesired operation.
- Shielded cables must be used with this unit to ensure compliance with the Class B FCC limits.



Correct Disposal of this product. This marking indicates that this product should not be disposed with other household wastes throughout the EU.

To prevent possible harm to the environment or human health from uncontrolled waste disposal, recycle it responsibly to promote the sustainable reuse of material resources. To return your used device, please use the return and collection systems or contact the retailer where the product was purchased. They can take this product for environmental safe recycling.

- The marking label is pasted on the bottom of the equipment.



iPod, iPhone and iPad are trademarks of Apple Inc., registered in the U.S. and other countries.

"Made for iPod", "Made for iPhone" and "Made for iPad" mean that an electronic accessory has been designed to connect specifically to iPod, iPhone or iPad respectively, and has been certified by the developer to meet Apple performance standards. Apple is not responsible for the operation of this device or its compliance with safety and regulatory standards. Please note that the use of this accessory with iPod, iPhone, or iPad may affect wireless performance.

All trademarks are the property of their respective owners and all rights are acknowledged.

Identifying the Parts

Main Unit

Top View

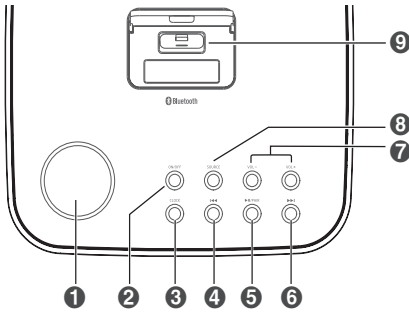

1 Display Panel

- Show the current status.

2 ON/OFF

- Turn on or turn off the unit.

3 CLOCK

- Press and hold this button in the standby mode to set the clock.

4 ⏮

- Skip to previous audio file.
- Search radio stations manually.
- Press and hold this button to search radio stations automatically.

5 ▶⏸/PAIR

- Start or pause play.

6 ⏭

- Skip to next audio file.
- Search radio stations manually.
- Press and hold this button to search radio stations automatically.

7 VOL+ / VOL-

- Decrease or increase the volume level.

8 SOURCE

- Select the play function.

9 DOCK for iPod/iPhone/iPad

- Load an iPod/iPhone/iPad.

Rear View

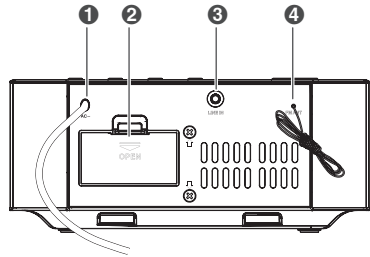

1 AC Connect to power.

2 Battery Compartment

3 LINE IN

- Connect to an external audio device.

4 FM ANT

Remote Control

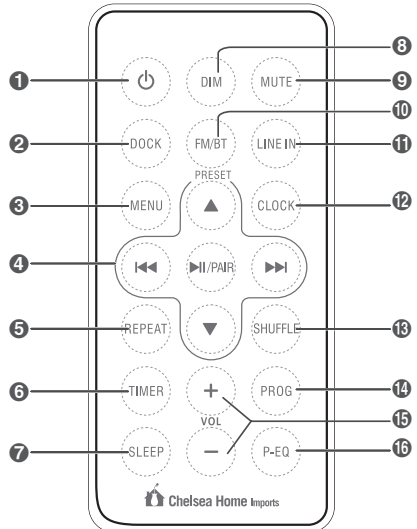

1 ⏻

- Turn on or turn off unit.

2 DOCK

- Select iPod/iPhone/iPad function.

3 MENU

- Switch between the folder list and the file list for iPod/iPhone.

4 ▲,▼

- Navigate through iPod/iPhone menu.
- Select a previous/next preset station.
- Adjust time.



- Skip to previous/next audio file.
- Search radio stations manually.
- Press and hold this button to search radio stations automatically.

▶ II/PAIR

- Start or pause play.
- Pair the Bluetooth-enabled device.

5 REPEAT

- Select repeat play modes.

6 TIMER

- Set the timer.

7 SLEEP

- Set the sleep timer.

8 DIM

- Adjust display brightness.

9 MUTE

- Mute or resume the sound.

10 FM/BT

- Select FM/Bluetooth function.

11 LINE IN

- Select LINE function.

12 CLOCK

- Press and hold this button in the standby mode to set the clock.

13 SHUFFLE

- Select shuffle play mode.

14 PROG

- Preset stations for tuner.

15 VOL+ /VOL-

- Increase/Decrease the volume level.

16 P-EQ

- Select a preset sound effect: CLASSIC, ROCK, JAZZ, POP, FLAT.

Preparations

Prepare the Remote Control

The provided Remote Control allows the unit to be operated from a distance.

- Even if the Remote Control is operated within the effective range (6m), remote control operation may be impossible if there are any obstacles between the unit and the remote control.
- If the Remote Control is operated near other products which generate infrared rays, or if other remote control devices using infrared rays are used near the unit, it may operate incorrectly. Conversely, the other products may operate incorrectly.

For First-time use:

The unit has a pre-installed lithium CR2025 battery. Remove the protective tab to activate the remote control battery.

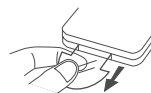

To Replace the Remote Control Battery:

1 Pull out the battery tray and remove the old battery.

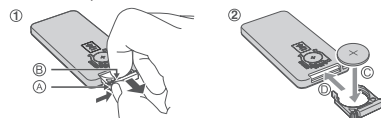

2 Place a new CR2025 battery into the battery tray with correct polarity (+/-) as indicated.

3 Insert the battery tray back into the slot.

Precautions Concerning Batteries

- When the Remote Control is not to be used for a long time (more than a month), remove the battery from the Remote Control to prevent it from leaking.
- If the batteries leak, wipe away the leakage inside the battery compartment and replace the batteries with new ones.
- Do not use any batteries other than those specified.
- Do not heat or disassemble batteries. Never throw them in fire or water.
- Do not carry or store batteries with other metallic objects. Doing so could cause batteries to short circuit, leak or explode.
- Never recharge a battery unless it is confirmed to be a rechargeable type.

Install Batteries



- You can only use AC power as power supply. Batteries (not supplied) are for backup purpose.
- If the system is unplugged or if a power failure occurs, all setups of the unit will be erased unless there are batteries in the unit and don't change them at this time. Once setups had be erased, please resetup all items (tuner stations; Source...) which you desire.

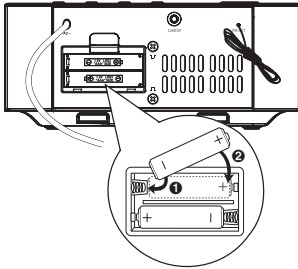

- 1 Open the batteries compartment.
- 2 Install two AAA batteries(not supplied) with correct polarity and the install steps as indicated.
- 3 Close the battery compartment.

Connect Power

Caution:

- Risk of product damage! Ensure that the power supply voltage corresponds to the voltage printed on the back or the underside of the unit.
- Before connecting the AC power cord, ensure you have completed all other connections.
- Connect the AC power cord to the wall socket.

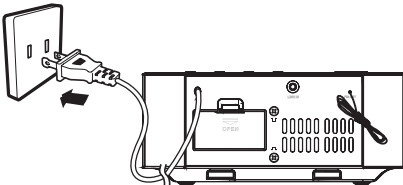

- Be sure to unplug the power cord from the outlet when the system is not in use for an extended period of time.

General Operation

Powering ON/OFF / STANDBY

When you first connect the unit to the mains socket, the unit will be in ECO power standby mode.

- Press **ON/OFF** on unit or press  button on remote control to switch the unit ON.
- Press again to switch the unit back to STANDBY mode.
- Disconnect the mains plug from the mains socket if you want to switch the unit OFF completely.



- When turning the system on, the system will continue in the mode it was in when it was turned off last time.

Selecting Modes



Press **SOURCE** button repeatedly on the unit to switch between DOCK / LINE IN / Bluetooth modes.



- If there is no signal under the DOCK, LINE IN and BT mode, the unit will automatically switch off within 15 minutes.

Set Time

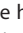
The built-in clock shows the correct time in the display.

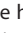
- 1 In the standby mode press and hold the **CLOCK** button on remote or on main unit for seconds, hour indicator will blink.
- 2 Set the hour with  /  on remote or  /  on main unit.
- 3 Press **CLOCK** button to confirm.
- 4 Repeat steps 2-3 to set the minutes, day, month and year.



- During Time Setup press the  button to select 12/24 hour format.

Note:

- Each activated state will be cleared if no buttons are pressed within 30 seconds.
- If a power failure occurs, once setups had be erased.

- Press the **CLOCK** button to show the current time on the display for few seconds.

Set the alarm timer

In standby mode, you can use the daily timer setting to turn the unit on automatically at a certain time everyday under standby mode.

- However the clock must be set correctly for the timer function to work.
- 1 In standby mode, press and hold the **TIMER** button for about 2s , then press ▲/▼ buttons to select an alarm sound source: FM tuner .
 - 2 Press the **TIMER** button, volume indicator will blink. Set the alarm volume with the ▲ button or ▼ button.
 - 3 Press the **TIMER** button, hour indicator will blink. Set the hour with the ▲ button or ▼ button.
 - 4 Press the **TIMER** button, minute indicator will blink. Set the minute with the ▲ button or ▼ button.
 - 5 Press the **TIMER** button, the selected time is set.
 - 6 Press the **TIMER** button to toggle the daily timer on or off.

Adjust Display Brightness

Press **DIM** repeatedly to select different levels of display brightness.

Adjust Volume Level

- During play, press the **VOL+/-** buttons to increase/decrease the volume level.
- During play, press the **MUTE** button to mute or restore sound. Press this button again to cancel the effect.

Select a Preset Sound Effect

During play, press the **P-EQ** button repeatedly to select: [FLAT], [POP], [CLASSIC], [ROCK], [JAZZ]

Set the sleep timer

This unit can switch to standby automatically after a set period of time.

- 1 Press **SLEEP** repeatedly to select a set period of time (in minutes).
- When the sleep timer is activated, the display show:z² , the volume will gradually decrease before the unit power off.

- 2 Press **SLEEP** repeatedly until [OFF] is displayed.
- When the sleep timer is deactivated, z² disappears on the display.

Select repeat play options

1. During play, press the **REPEAT** button once on the remote control, the unit will play the current track repeatedly.
2. Press the **REPEAT** button twice, the unit will play all tracks repeatedly.
3. Press the **REPEAT** button once more again, The repeat function will turn off.
- 4 Press the **SHUFFLE** button , the unit will shuffle play all tracks.

Play from an External Audio Device

You can listen to an external audio device through this unit.

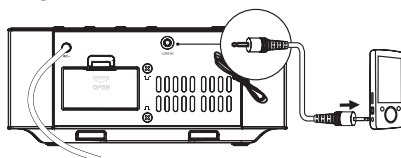

- 1 Connect the audio player.
 - Connect the 3.5mm cable to the **LINE IN** socket on the rear of unit and to the headphone socket on the audio player.
- 2 Press the **LINE IN** button to select the **LINE IN** source.
- 3 Start to play on the audio player.

Play from iPod/iPhone/iPad

iPod/iPhone/iPad Operation

Using the iPod/iPhone/iPad dock, you can use the unit to play music files stored on your iPod/iPhone/iPad.

Listen to the iPod/iPhone/iPad

You can enjoy audio from iPod/iPhone/iPad through this unit.

1. Press down docking cover of the unit to flip the docking cover up.

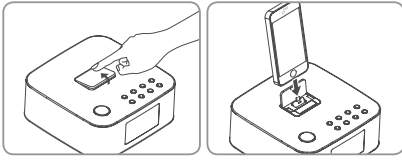

2. Insert your iPod/iPhone/iPad into the iPod/iPhone/iPad dock.
3. Press the **DOCK** button on remote control or **SOURCE** button on top panel to select the iPod/iPhone/iPad source.
4. Start to play the connected iPod/iPhone/iPad.
 - To pause/resume play, press the ►|| button.
 - To skip to a track, press the ◀◀/▶▶ buttons.
 - To search during play: press and hold ◀◀/▶▶ buttons, then release to resume normal play.
 - To navigate the menu(only for iPod/iPhone.): Press **MENU** button, then press ▲,▼ to select, and press ►|| to confirm.
 - To select repeat play options: press the **REPEAT** button repeatedly to select a repeat option play mode.



- This apparatus does not support to apple 30-pin models.

Charge the iPod/iPhone/iPad

The docked iPod/iPhone/iPad begins to charge as soon as the unit is connected to AC power.

Play With Bluetooth Device

You can listen to music from a bluetooth-enabled device via this player.

Pair Bluetooth-enabled Devices

The first time you connect your bluetooth device to this player, you need to pair your device to this player.

Note:

- The operational range between this player and a Bluetooth device is approximately 8 meters.

- Before you connect a Bluetooth device to this unit, familiarize yourself with the Bluetooth capabilities of the device.
 - Compatibility with all Bluetooth devices is not guaranteed.
 - Any obstacle between this unit and a Bluetooth device can reduce the operational range.
 - Keep this player away from any other electronic device that may cause interference.
1. Turn on the Bluetooth function on your device.
 2. Switch player's source to bluetooth, Display panel shows "**BT**", then shows "**NO BT**" (if no bluetooth device is connected).
 3. Press and hold "**PAIR**" button on remote control for a few seconds to activate bluetooth pairing mode, display panel shows "**PAIR**".
 4. Search for bluetooth device with your device. select "**CIL-E-9**" in the pairing list.
 5. Enter "0000" for the password if necessary. If the pairing succeeds, display panel shows "**BT**" again.
 6. To disconnect connection, turn off the bluetooth function on your device or switch the player to another source.

Tips:

- If a connection exist, hold and press "**PAIR**" button on remote control for a few seconds to re-activate the pairing mode, the connection will be interrupted.
- If no other bluetooth device pairs with this player within two minutes, the player will recover its previous connection.
- The player will also be disconnected when your device is moved beyond the operational range.
- If you want to reconnect your device to this player, place it within the operational range.
- If the device is moved beyond the operational range, when it is brought back, please check if the device is still connected to the player.
- If they are connected, display panel shows "**BT**".

- If the connection is lost, display panel shows "NO BT". Follow the instruction above to pair your device to the player again.

Listen to Music from Bluetooth Device

- If the connected Bluetooth device supports Advanced Audio Distribution Profile (A2DP), you can listen to the music stored on the device through the player.
- If the device also supports Audio Video Remote Control Profile (AVRCP), you can use the player's remote control to play music stored on the device.
 1. Pair your device with the player.
 2. Start to play music via your device (if it supports A2DP)
 3. Use supplied remote control to control play (if it supports AVRCP)
 - To pause/resume play, press the ►|| button.
 - To skip to a track, press the ◀◀/▶▶ buttons.

- Tune in radio stations manually
- Press the ◀◀/▶▶ buttons repeatedly until you find the station you want.



- If reception is still poor, try to adjust the position of the aerial or try to move the radio to another location.

Presetting Stations Manually

You can preset up to 20 FM stations.

- 1 Tune in the desired station, then press the **PROG** button.
- 2 Press the ▲/▼ buttons to select the preset number.
- 3 Press the **PROG** button to store the station.
- 4 Repeat above steps 1 to 3 for each station you want to store in memory with a preset number.

Listening to the FM Radio

Auto Scan and Save Preset Station

- 1 Tap the **SOURCE** button repeatedly on the unit or press the **FM/BT** button on the remote control to select FM mode.
 - 2 Press and hold the **PROG** button for a few seconds to activate automatic programming. All available stations are programmed in the order of waveband reception strength.
- The first programmed radio station is played automatically.

Tune to a Preset Radio Station

- Press the ▲ or ▼ buttons to select a preset number that you want.

Tuning in a Station

- Tune in radio stations automatically
- Press and hold the ◀◀/▶▶ buttons, the frequency changes down or up automatically until a station is found.



- The search may not stop at a station with a very weak signal.

Troubleshooting

To keep the warranty valid, never try to repair the system yourself. If you encounter problems when using this unit, check the following points before requesting service.

No power.

- Ensure that the AC cord of the apparatus is connected properly.
- Ensure that there is power at the AC outlet.
- Press ON/OFF button to turn the unit on.

Remote control does not work

- Before you press any function button, first select the correct source.
- Reduce the distance between the remote control and the unit.
- Insert the battery with its polarities (+/-) aligned as indicated.
- Replace the battery.
- Aim the remote control directly at the sensor on the front of the unit.

No Response From the Unit

- Disconnect and reconnect the AC power plug, then turn on the unit again.

Poor radio reception

- Increase the distance between the unit and your TV or VCR.
- Fully extend the FM antenna.

Timer does not work

- Set the clock correctly.
- Switch on the timer.

Clock/timer setting erased

- Power has been interrupted or the power cord has been disconnected.
- Reset the clock/timer.

Using iPhone to play music

- While the iPhone is playing the music through the docking, there may be a chance that the iPhone may not be under a good reception mode to get the incoming call signal.

Specifications

General

| | |
|------------------------------------|------------------|
| Power Requirements | AC120V~ 60Hz |
| Power Consumption | 25W |
| Output Power | 5W x 2 |
| Total Harmonic Distortion | 1%(1kHz, 1W) |
| Audio Input Sensitivity | 500mV |
| Frequency Response | 40Hz - 20kHz |
| Tuning Range..... | 87.5-108MHz |
| Unit Dimensions (W x H x D) .. | 198 x 89 x 198mm |
| Product operating temperature..... | 0°C -40°C |

Speaker

Front

| | |
|------------------|----|
| Impedance | 2Ω |
| Rate Power | 5W |

Remote

| | |
|----------------|-----|
| Distance | 6m |
| Angle..... | 30° |

Standard Accessories

| | |
|---------------------------|-----|
| Remote Control | x 1 |
| Owner's Manual | x 1 |
| 3.5mm to 3.5mm Cable..... | x 1 |

- Design and specifications are subject to change without notice.