

BTC015L
Bluetooth Car Kit
User's manual

■ Brief introduction	1
1. Bluetooth wireless communication technology.....	1
2. About BTC015L.....	1
■ Before use	2
1. Overview.....	2
2. Charging the battery of BTC015L.....	2
■ Getting started	3
1. Turning on/off BTC015L.....	3
2. Pairing BTC015L with a Bluetooth cell phone.....	4
3. Installation.....	4
4. Music playback.....	5
5. Making a call with BTC015L.....	6
6. Re-connecting with a Bluetooth device.....	8
7. Automatic turning off.....	8
8. LED Indicator	8
9. Indication tone.....	9
■ Care and maintenance	9
■ FAQs	10
■ Specifications	10
■ FCC notes	10

Welcome to use this Bluetooth Car Kit, BTC015L. Please read this user's manual carefully before use.

■ Brief introduction

1. Bluetooth wireless communication technology

Bluetooth is a standard of close range wireless technology that was drawn up by Ericsson, IBM, Intel, Nokia and Toshiba. With Bluetooth technology, we can achieve the highest transmission rate among mobile phones, computers, printers, PDAs and other devices. The max transmission range of class II is 10 meters while the max transmission range of class I can reach up to 100 meters.

2. About BTC015L

BTC015L is a Bluetooth Car Kit. It supports the following Bluetooth profiles: HFP, HSP, A2DP and AVRCP.

Connect BTC015L to AUX in jack of car audio system, now you can make a call or play music. The hands-free car kit has the following features:

- ◆ Answer a call, end a call and reject a call
- ◆ Redial last number
- ◆ Voice dial (This function needs to be supported by your cell phone)
- ◆ Call transfer between BTC015L and your cell phone
- ◆ Microphone mute
- ◆ Music pause/play

Remark: Even though the paired device and the hands-free car kit support the same Bluetooth profiles, functions may vary due to specification differences of the paired devices.

■ Before use

1. Overview

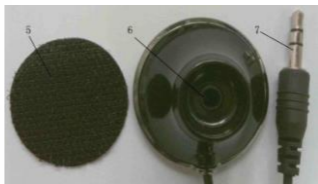
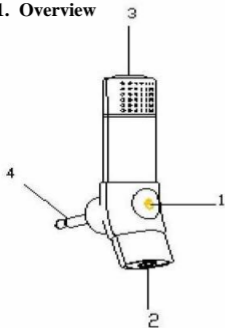

1	Multi-function Button (MFB): Power on/power off/pair/end a call/cancel calling/answer a call/microphone mute/call transfer/redial last number/music play/music pause
2	3.5mm Line-in jack/charging socket
3	Built-in microphone
4	3.5mm audio out plug
5	Velcro
6	3.5mm Line-in jack
7	3.5mm audio out plug

2. Charging the battery of BTC015L

BTC015L comes with a built-in rechargeable battery, prior to using it, it is recommended to charge the battery fully for the first time.

Connect the charger to an standard power outlet and the charger plug to the charging socket of BTC015L. The red LED is on while charging. It takes about 1.5 hours to charge the battery fully. When charging is completed, the red LED is off.

When BTC015L is on and the battery becomes low, red LED flashes once every 30 seconds and the BTC015L emits three “DU” tones every 30 seconds. Please recharge the battery fully as described above.

Remarks:

- 1) The battery will dry up if you don't use BTC015L for a long time. If this happens, you have to charge BTC015L for about 30 minutes, and then red LED will be on.
- 2) Please don't attempt to take out the battery from BTC015L, as this might damage it.

Warning:

- 1) The battery is recyclable.
- 2) Batteries (battery pack or batteries installed) shall not be exposed to excessive heat place, such as sunshine, fire or the like.

■ **Getting started**

1. Turning on/off BTC015L

Function	Operation	LED indicator
Power on	Press and hold MFB button for about 3~5 seconds until hearing indication tone	Blue LED flashes 5 times
Power off	Press and hold MFB button for about 3~5 seconds until hearing indication tone	Red LED flashes 5 times
Entering pairing mode	Make sure BTC015L is off, and then press and hold MFB button for 4~5 seconds until red and blue LEDs flash alternately	Red and blue LEDs flash alternately

Remark: Pairing mode will last 2 minutes. If no devices can be connected within 2 minutes, BTC015L will return back to standby mode. If you want to repair, please turn off BTC015L first and then enter pairing mode.

2. Pairing BTC015L with a Bluetooth cell phone

Please make sure your cell phone is Bluetooth-enabled. Specific pairing steps may vary with different models of cell phones. Please refer to your cell phone's user's manual for further information. The general pairing steps are as follows:

- 1) Keep BTC015L and Bluetooth cell phone within 1 meter when pairing;
- 2) Enter BTC015L's pairing mode (please refer to "Turning on/off BTC015L");
- 3) Activate your cell phone's Bluetooth function and set your cell phone to search for Bluetooth device within range, and select "BTC015L" from the list of devices shown;
- 4) According to the indication, enter password or PIN No.: "0000";
- 5) If prompted by your cell phone to connect, select "Yes" (This will vary among cell phone models);
- 6) After successful connecting, blue LED will flash twice every 4 seconds.

Remarks:

- ◆ If pairing is failed, please turn off BTC015L first and then try re-pairing according to the step 1-6 mentioned above.
- ◆ After successful pairing, BTC015L and the Bluetooth cell phone will remember each other, BTC015L will not need to re-pair with the Bluetooth cell phone next time unless the pairing information is deleted because of a new pairing.
- ◆ Every time BTC015L is turned on, it will connect to last connected devices automatically. If you want to pair it with other devices, please turn off the Bluetooth function of current Bluetooth device paired with BTC015L first and then pair BTC015L with a new device according to steps 1~6 mentioned above.

3. Installation

You can use BTC015L in your car, at home or in an office environment.

1) In-car usage

Please insert 3.5mm audio out plug into the AUX in jack of car audio system, and then fix 3.5mm audio dock well. make sure there are no barriers between user and BTC015L to get the best conversation quality. The installing steps are as follows:

- a) Insert 3.5mm audio out plug into the AUX in jack;



- b) Please find the best location in the car to place the velcro and clean the position;
c) Remove the protective strip and carefully fix the velcro to the position selected, please refer to the following pictures:

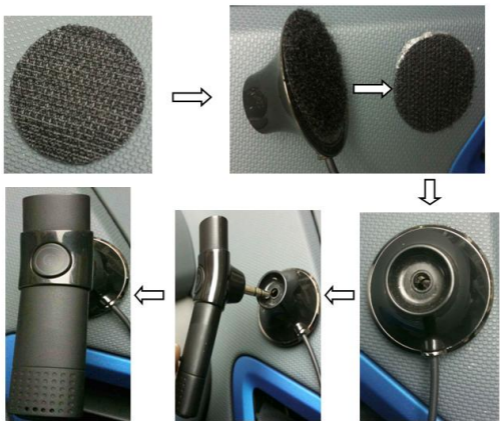

2) Office or home usage

When you use BTC015L at home or in your office, you can connect BTC015L to any home audio system with 3.5mm AUX in jack.

4. Music playback

BTC015L can not only connect to Bluetooth device to play music, but also connect to other music players through 3.5mm Line-in jack of BTC015L to play music.

1) Connecting to a Bluetooth device

- Adjust the audio input of car audio system to AUX.
- Connect BTC015L to a Bluetooth cell phone and play music on the phone, at this time, you can listen to music from the car audio system.
- Pause/play: Short press **MFB** button once, the music will pause, short press **MFB** button once again, the music will play.

2) Connecting to other music players through 3.5mm Line-in jack

- Adjust the audio input of car audio system to AUX.
- Connect music player to BTC015L by using a 3.5mm to 3.5mm audio cable and play music on the music player, at this time, you can listen to music from the car audio system.

Remarks:

- ◆ When BTC015L connected to a Bluetooth device and connected to another music player through 3.5mm Line-in jack of BTC015L at the same time, if Bluetooth device does not play music, 3.5mm audio input is available.
- ◆ When BTC015L connected to a Bluetooth device and connected to another music player through 3.5mm Line-in jack of BTC015L at the same time, if Bluetooth device play music, 3.5mm audio input is not available.

5. Making a call with BTC015L

Basic Operation		
Function	Status of BTC015L	Operation
Cancel calling	Calling	Short press MFB button once
Answer a call	Incoming ring	Short press MFB button once

Function	Status of BTC015L	Operation
Reject a call	Incoming ring	Press and hold MFB button for about 2 seconds
End a call	During a call	Short press MFB button once
Microphone mute	During a call	Double click MFB button
Cancel mute	During a call (Microphone mute)	Double click MFB button
Call transfer (BTC015L to cell phone)	During a call	Press and hold MFB button for about 2 seconds, and release it until hearing indication tone
Call transfer (cell phone to BTC015L)	During a call	Press and hold MFB button for about 2 seconds, and release it until hearing indication tone
Redial last number	Connected to a device	Double click MFB button
Voice dial	Connected to a device	Press and hold MFB button for about 2 seconds

Three-way call		
Function	Status of BTC015L	Operation
Incoming ring	During a call and there is another incoming call	“DU-DU” tones
End current call and answer a new incoming call	During a call and there is another incoming call	Short press MFB button twice
Keep current call and answer a new incoming call	During a call and there is another incoming call	Short press MFB button once
Call transfer between two calls	During a call (keep another call)	Short press MFB button once
End current call and switch to the call to be kept	During a call (keep another call)	Short press MFB button twice

Remarks:

- ◆ Not all cell phones support all functions listed above. Please refer to your cell phone's user's manual for further information.
- ◆ When pressing the answer button on some cell phones, the call will be transferred to the cell phone. You have to transfer the call to BTC015L manually then. Please refer to your cell phone's user's manual for further information.
- ◆ For some cell phones, there maybe some echo when making a call. Please adjust the volume or the angle of BTC015L.

6. Re-connecting with a Bluetooth device

1) Automatic connecting

Every time BTC015L is turned on, it will connect to the last connected device automatically.

2) Manual connecting

When BTC015L gets disconnect from the Bluetooth device, short press **MFB** button once, it will connect to the last connected device again.

Remarks:

- ◆ BTC015L only tries to connect to the last connected device.
- ◆ Please enable Bluetooth on your Bluetooth device before trying to connect.
- ◆ On some Bluetooth devices, take some Nokia cell phones for example, you need to set up "allow automatic connecting" on the phone.

7. Automatic turning off

BTC015L will turn off automatically in order to save power, if no devices can be connected within 5 minutes.

8. LED Indicator

When BTC015L is charging

LED indicator	Status of BTC015L
Red LED is on	Charging in progress
Red LED is off	Charging finished

When BTC015L connected to a Bluetooth device

LED indicator	Status of BTC015L
Red and blue LEDs flashes alternately	Pairing mode
Blue LED flashes once every 2 seconds	Standby mode(not connected to a device)
Blue LED flashes twice every 4 seconds	Connected to a device
Red LED flashes once every 30 seconds	Low power

9. Indication tone

Indication tone	Status of BTC015L
Emits two “DU” tones every 8 seconds	During a call (microphone mute)
Emits three “DU” tones every 30 seconds	Low power

■ Care and maintenance

Read the following recommendations before using BTC015L. Following these you will be able to enjoy our product for many years.

- ◆ Keep the product dry and don't put it in the damp place to avoid the product's internal circuit being affected.
- ◆ Keep the product away from direct sunlight or hot places. High temperature will shorten the life of electronic devices, destroy the battery or distort certain plastic parts.
- ◆ Don't expose the product to cold areas as it may damage the internal circuit board.
- ◆ Don't try to disassemble the product as it may get damaged if you are not professional.
- ◆ Don't let the product fall down onto the floor or other hard surfaces. The internal circuit might get damaged.
- ◆ Don't use intensive chemical products or detergent to clean the product.
- ◆ Don't scratch the surface with sharp things.

In case the product doesn't function properly, send it to the store you bought it. The staff will help you to solve the problem.

■ FAQs

1. What to do when there is no sound when making a call with BTC015L?

- Ensure BTC015L connects well with Bluetooth cell phone;
- Ensure the volume has already been properly adjusted;
- Make sure the audio input of car audio system is adjusted to AUX.

2. What to do when my cell phone can not search and find BTC015L?

If BTC015L is not in pairing mode, your cell phone can't find it. Please make sure BTC015L is in pairing mode and in the effective working range.

3. What to do when the voice is not clear?

- Ensure your cell phone is in strong-signal areas;
- Ensure BTC015L is in the effective working range.

4. How far is the effective range between BTC015L and Bluetooth cell phone?

According to the Bluetooth standard, the max. controllable range of Class II handsfree kit is 10 meters. But it varies with different environment and paired cell phone.

■ Specifications

Bluetooth specification	Bluetooth V4.0
Bluetooth profiles	HSP, HFP, A2DP and AVRCP
Bluetooth frequency range	2.402GHz~2.480GHz
Operating distance	10 meters Class II
Working time	Up to 5 hours
Standby time	200 hours
Charging input	DC 5V $\overline{=}$ 500mA
Charging time	About 1.5 hours
Dimensions	Main Unit: 66(L)×19.47(W) ×19.7(H)mm Audio Dock: 20.5(Diameter)×34(Height)mm
Weight	Main Unit: 11.7g Audio Dock: 17.4g

Notes:

1. This device complies with Part 15 of the FCC Rules. Operation is subject to the following two conditions: (1) this device may not cause harmful interference, and (2) this device must accept any interference received, including interference that may cause undesired operation.
2. Changes or modifications not expressly approved by the party responsible for compliance could void the user's authority to operate the equipment.

FCC Radiation Exposure Statement:

This equipment complies with FCC radiation exposure limits set forth for an uncontrolled environment.

This transmitter must not be co-located or operating in conjunction with any other antenna or transmitter.