

BTC021
Bluetooth hands-free car kit
User's manual

■ Brief introduction	1
1. Bluetooth wireless communication technology.....	1
2. About BTC021.....	1
■ Before use	2
1. Overview.....	2
2. Setting up hands-free kit.....	3
■ Getting started	4
1. Turning on/off BTC021.....	4
2. Pairing BTC021 with a Bluetooth cell phone.....	4
3. Music playback.....	5
4. Making a call with BTC021.....	5
5. Re-connecting with a Bluetooth device.....	6
6. Factory reset.....	7
7. USB charging.....	7
8. LED Indicator.....	8
■ Care and maintenance	8
■ FAQs	8
■ Specifications	9

Welcome to use this Bluetooth hands-free car kit, BTC021. Please read this user's manual carefully before use.

■ Brief introduction

1. Bluetooth wireless communication technology

Bluetooth is a standard of close range wireless technology that was drawn up by Ericsson, IBM, Intel, Nokia and Toshiba. With Bluetooth technology, we can achieve the highest transmission rate among mobile phones, computers, printers, PDAs and other devices. The max transmission range of class II is 10 meters while the max transmission ranges of class I can reach up to 100 meters.

2. About BTC021

BTC021 is a Bluetooth hands-free car kit. It supports the following Bluetooth profiles: HFP, HSP, A2DP and AVRCP.

Connect BTC021 to AUX in jack of car audio system, now you can make a call or play music. The hands-free car kit has the following features:

- ◆ Answer a call, end a call and reject a call
- ◆ Redial last number
- ◆ Voice dial (This function needs to be supported by your cell phone)
- ◆ Call transfer between BTC021 and your cell phone
- ◆ Microphone mute
- ◆ Music pause/play, previous/next song

Remark: Even though the paired device and the hands-free car kit support the same Bluetooth profiles, functions may vary due to specification differences of the paired devices.

■ Before use
1. Overview

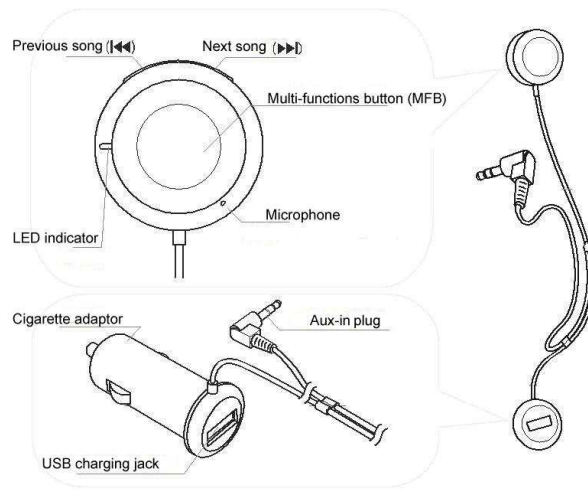

2. Setting up hands-free kit

Please refer to the following steps to set up BTC021 before use:

- ◆ Set up the Velcro on the best position in the car, and then stick the main body onto Velcro
- ◆ Plug the Aux-in plug into car Aux-in jack
- ◆ Plug the cigarette adaptor into the car

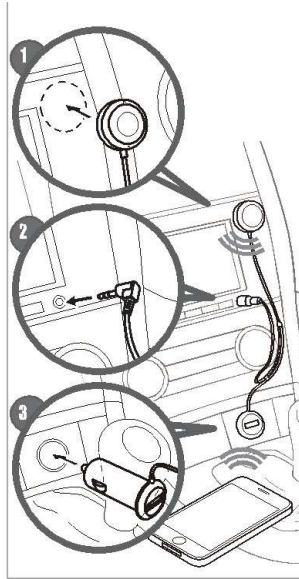

■ Getting started

1. Turning on/off BTC021

Function	Operation	LED indicator
Power on	Plug cigarette adaptor into car cigarette lighter	Blue LED on 1 second
Power off	Pull cigarette adaptor out of car cigarette lighter or turn off cigarette lighter	Indicator light off
Enter pairing mode	In standby mode, not connect with device, press and hold MFB button for 4~5 seconds	Red and blue LEDs flash alternately

Remark: Pairing mode will last 2 minutes. If no devices can be connected within 2 minutes, BTC021 will return back to standby mode. If you want to repair, please turn off BTC021 first and then enter pairing mode.

2. Pairing BTC021 with a Bluetooth cell phone

Please make sure your cell phone is Bluetooth-enabled. Specific pairing steps may vary with different models of cell phones. Please refer to your cell phone's user's manual for further information. The general pairing steps are as follows:

- 1) Keep BTC021 and Bluetooth cell phone within 1 meter when pairing;
- 2) Make BTC021 enter pairing mode (please refer to "Turning on/off BTC021");
- 3) Activate your cell phone's Bluetooth function and set your cell phone to search for Bluetooth device within range, and select "BTC021" from the list of devices shown;
- 4) According to the indication, enter password or PIN No.: "0000";
- 5) If prompted by your cell phone to connect, select "Yes" (This will vary among cell phone models);
- 6) After successful connecting, blue LED will flash twice every 8 seconds.

Remarks:

- ◆ If pairing is failed, please turn off BTC021 first and then try re-pairing according to the step 1-6 mentioned above.
- ◆ After successful pairing, BTC021 and the Bluetooth cell phone will remember each other, BTC021 will not need to re-pair with the Bluetooth cell phone next time unless the pairing information is deleted because of a new pairing.
- ◆ Every time BTC021 is turned on, it will connect to last connected devices automatically. If you want to pair it with other devices, please turn off the Bluetooth function of current Bluetooth device and then pair BTC021 with a new device according to steps 1~6 mentioned above.

3. Music playback

- 1) Adjust the car radio to AUX in
- 2) Make sure BTC021 has already connect with cell phone, then you can listen music from phone to car radio
- 3) Music remote control:
Pause/play: short press MFB once, music pause; short press MFB once, music play
Previous song: short press ◀ once
Next song: short press ▶ once

4. Making a call with BTC021

Function	Status of BTC021	Operation	Prompt tone
Cancel a call	Calling	Short press MFB button once	One short tone
Answer a call	Incoming ring	Short press MFB button once	Two raise tone
Reject a call	Incoming ring	Long press MFB button for about 2 seconds	Two fall tone
End a call	During a call	Short press MFB button once	One short tone
Microphone mute	During a call	Short press MFB button twice	Two fall tone

Cancel mute	During a call (Microphone mute)	Short press MFB button twice	Two raise tone
Call transfer (BTC021 to cell phone)	During a call	Long press MFB button for two seconds	One short tone
Call transfer (cell phone to BTC021)	During a call	Long press MFB button for about two seconds	One short tone
Redial last number	Standby mode, connected to a device	Short press MFB button twice	One short tone
Voice dial	Standby mode, connected to a device	Long press MFB button for about 2 seconds	One short tone

Remarks:

- ◆ Not all cell phones support all functions listed above. Please refer to your cell phone's user's manual for further information.
- ◆ For some phone, when pressing the answer button on some cell phones, the call will be transferred to the cell phone. You have to transfer the call to BTC021 manually then. Please refer to your cell phone's user's manual for further information.
- ◆ After microphone mute, BTC021 will emit two "dudu" tones every 5 seconds.

5. Re-connecting with a Bluetooth device

1) Automatic connecting

Every time BTC021 is turned on, it will connect to the last connected device automatically.

2) Manual connecting

When BTC021 gets disconnect from the Bluetooth device, short press **MFB** button once, it will connect to the last connected device again.

Remarks:

- ◆ BTC021 only tries to connect to the last connected device.
- ◆ Please activate Bluetooth on your Bluetooth device before trying to connect.
- ◆ On some Bluetooth devices, take some Nokia cell phones for example, you need to set up "allow automatic connecting" on the phone.

6. Factory reset

Under the status of turn on, press **⏪** and **⏩** button for 6 seconds simultaneously, and release it until hear two "dudu" tones and see red and blue LED on simultaneously.

Remarks:

- ◆ After factory reset, all the paired list will be deleted. When you turn on BTC021, it will enter pairing mode automatically, and you need to pair with Bluetooth device again.

7. USB charging

This product has USB charging jack (DC5V). You can charge for other devices, such as cell phone, MP3 and so on.

Remarks:

- ◆ Please make sure the charging voltage of device is DC5V.
- ◆ Please use the original charging cable of the device for charging.

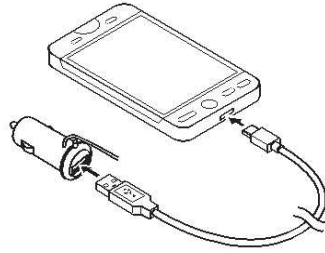

8. LED Indicator

LED indicator	Status of BTC021
Red and blue LED flashes alternately	Pairing mode
Blue LED flashes twice every 3 seconds	Standby mode(not connected to a device)
Blue LED flashes twice every 8 seconds	Connected to a device
Blue LED flashes quickly	Calling/incoming call
Blue LED flashes twice every 8 seconds	During a call
Blue LED flashes once every 5 seconds	Microphone mute

■ Care and maintenance

Read the following recommendations before using BTC021. Following these you will be able to enjoy our product for many years.

- ◆ Keep the product dry and don't put it in the damp place to avoid the product's internal circuit being affected.
- ◆ Keep the product away from direct sunlight or hot places. High temperature will shorten the life of electronic devices, destroy the battery or distort certain plastic parts.
- ◆ Don't expose the product to cold areas as it may damage the internal circuit board.
- ◆ Don't try to disassemble the product as it may get damaged if you are not professional.
- ◆ Don't let the product fall down onto the floor or other hard surfaces. The internal circuit might get damaged.
- ◆ Don't use intensive chemical products or detergent to clean the product.
- ◆ Don't scratch the surface with sharp things.

In case the product doesn't function properly, send it to the store you bought it. The staff will help you to solve the problem.

■ FAQs

1. How to do if there is no sound when making a call with BTC021?

- a) Ensure BTC021 connects well with Bluetooth cell phone;
- b) Ensure the volume has already been properly adjusted;
- c) Make sure the audio input of car audio system is adjusted to AUX.

2. How to do if my cell phone can not search and find BTC021?

If BTC021 is not in pairing mode, your cell phone can't find it. Please make sure BTC021 is in pairing mode and in the effective working range.

3. How to do if the voice is not clear?

- a) Ensure your cell phone is in strong-signal areas;
- b) Ensure BTC021 is in the effective working range.

4. How far is the effective range between BTC021 and Bluetooth cell phone?

According to the Bluetooth standard, the max controllable range of Class II hands free kit is 10 meters. But it varies with different environment and paired cell phone.

■ Specifications

Bluetooth specification	Bluetooth V2.1+EDR
Bluetooth profiles	HSP, HFP, A2DP and AVRCP
Operating distance	10 meters Class II
Charging input	DC 12V—24V
Charging output	DC5V --- 1A
Dimensions	Main Unit: 42x15x42 mm Cigarette adaptor: 24x54x24mm
Weight	About 35.5g

Notes:

- 1. This device complies with Part 15 of the FCC Rules. Operation is subject to the following two conditions: (1) this device may not cause harmful interference, and (2) this device must accept any interference received, including interference that may cause undesired operation.
- 2. Changes or modifications not expressly approved by the party responsible for compliance could void the user's authority to operate the equipment.