

# “2.4GHz Slim Keyboard with mouse function” RF612 Keyboard with mouse keyboard, your MCE System best solution.

## User's Manual



## System requirements

- IBM or compatible PC
- Windows and Macintosh Operating System
- Pentium-equivalent processor or above
- One available USB port

## OS support

- Windows XP
- Windows 2000/NT
- Windows ME
- Windows VISTA

## Introduction

Thank you for your patronage of purchasing our cordless keyboard. For your own safety, please read this manual thoroughly before using this product. After you have read this manual, please keep it in place for reference when necessary.

## Contents in the package

The following items are included in the package. Please make sure all items are accounted for as you open the package. If there was any item missing or damaged, please contact the reseller where the product was purchased or our support center.

- Wireless Keyboard x 1
- USB 2.4GHz dongle receiver x 1
- Manual/warranty x 1
- Alkaline AAA batteries x2

## **Warning**

Zippy Technology Corporation and its respective distributors and resellers are not responsible for any malfunction, damage or personal injury incurred by:

Any malfunction, damage or personal injury caused by the malfunctioning or damage of the user's personal computer or misuse of this product.

Any attempt to dismantle, change or modify this product in any manner.

### **Warning**

Please do not use this product in ashy, wet, or oily environments. Failure to do so may shorten the life of this product and may cause bodily harm.

Please keep this product as far away from Radio Frequency interruption areas as possible.

This is not an outdoor product. Exposing this product to the elements may cause damages to the product and bodily harm to its users.

Please do not use petroleum, benzene or thinner-based solution to clean this product.

This transmitter must not be co-located or operating in conjunction with any other antenna or transmitter.

## **Warranty Information**

This product is backed by a One-Year Manufacturer's Warranty, starting from the date of purchase. The warranty covers for free repair in accordance with the contents stated herein but does not cover wear and tear and any malfunction or damages as results of improper usage as stated in this manual.

## **Specifications**

- Keyboard
  - Dimensions: 306 x 139x 22 mm
  - Weight: 620+/- 20g (with Battery)
  - Key Number: 104 Keys(By language)
  - Battery: 2 x AAA batteries
  - Battery Life: 3 Month (Base on average usage)
  - Channel: 78 Channels automatically switch.
  - ID: unique ID for each keyboard
  - Radio Frequency: 2.4 GHz
  - Hot Keys : search, e-mail, www
- Dongle Receiver
  - Dimensions: L70xW22.7xH12.3 mm
  - Weight: 10.9g +/-25g
  - Interface: USB 1.1

## **Installation Procedure**

Before installing this product please make sure you have one available USB port reserved for the dongle receiver.

### A. Setting up the Dongle Receiver

1. Plug the dongle receiver (FIG. 3) into an available USB port
2. Wait for Windows to install drivers for the dongle receiver, keyboard.

### B. Setting up the Keyboard and Mouse

1. Open the keyboard's battery compartment cover and insert the two pieces of AAA Alkaline batteries. Make sure they are properly installed.
2. Replace the keyboard battery compartment cover.
3. Usually the keyboard have bind in the factory, if the system cannot recognize the keyboard, please follow step 4~6 to bind keyboard and mouse.
4. To press the link button of dongle at first.
5. To press the link button of keyboard bottom side, the system will automatically recognize the keyboard.
8. The LED indicator on the dongle receiver will flash green light for a few second when the connecting have been properly set and the keyboard is working.

## **Battery Low**

1. Low-Battery is indicated by the illumination of the keyboard Top case. Please replace the battery when the LED lights up.
2. We recommend using alkaline batteries for the keyboard.
3. You may need to reset the keyboard link status after replacing new batteries for the keyboard.

## **Keyboard**

(請插入鍵盤裝電池示意圖)

## **Receiver**

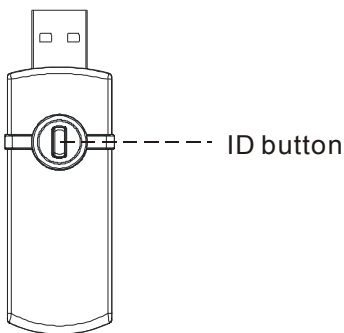

FIG.3

## **Hotkey Functions**

There are 3 built-in hotkeys and 6 VISTA Home entertainment for the RF-612 for quick access under the Windows operating system. Please refer to the following section on their functions.

### **For Hotkey Function**

Home page : Start the WWW browser.

E-mail : Start the e-mail application.

Search : [Search] button of the internet browser.

### **For Multi-key function**

MCE : Change your VISTA Home system to Media center

Backward : for vista backward function

My Music : for active the VISTA My Music function  
My TV : for active the VISTA My TV function  
My Picture : for active the VISTA My Picture function  
My Video : for active the VISTA My Video function

### **Troubleshooting**

Please visit our On-Line FAQ section for help.

### **FCC Statement on CLASS B**

This equipment has been tested and found to comply with the limits for a Class B digital device, pursuant to part 15 of the FCC Rules. These limits are designed to provide reasonable protection against harmful interference in a residential installation. This equipment generates, uses and can radiate radio frequency energy and, if not installed and used in accordance with the instructions, may cause harmful interference to radio communications. However, there is no guarantee that interference will not occur in a particular installation. If this equipment does cause harmful interference to radio or television reception, which can be determined by turning the equipment off and on, the user is encouraged to try to correct the interference by one or more of the following measures:

- Reorient or relocate the receiving antenna.
- Increase the separation between the equipment and receiver.
- Connect the equipment into an outlet on a circuit different from that to which the receiver is connected.
- Consult the dealer or an experienced radio / TV technician for help.

### **Mandatory repair charges are required for the following conditions, even within the guarantee period:**

- (1) Malfunction or damage is due to misuse or improper alteration or repair.
- (2) Malfunction or damage is caused by the movement or fall during installation after the purchase.
- (3) Malfunction or damage is caused by a fire, salt, gas, earthquake, lightning, wind, water or other natural calamities, or abnormal voltage.
- (4) The manual is not presented.
- (5) Date of purchase, customer's name, name of the shop are not filled in or are altered.
- (6) Malfunction or damage is caused by other devices connected to the RF-722.

To get the repair service, please disconnect RF-722 from other devices connected.

Date	Contents of service
Person in charge	
Person in charge	

This warranty is intended to provide free repair under the terms and period stated herein. Accordingly, this warranty shall not limit the legal rights entitled to the Customer. For more information concerning the repair after expiration of the guarantee period, please contact us or our retailer where you purchased this product.

Names of other products mentioned in this Manual are the trademarks or registered trademarks of their respective owners.

**Warning**

As shielded-type power cord is required in order to meet FCC omission limits and also to prevent interference to the nearby radio and television reception. It is essential that only the supplied power cord be used.

Use only shielded cables to connect I/O devices to this equipment.

You are cautioned that changes or modifications not expressly approved by the party responsible for compliance could void your authority to operate the equipment.

All brand names, trademarks and logos are the properties of their respective owners.

CAUTION

Danger of explosion if battery is incorrectly replaced.

Replace only with the same or equivalent type.