

# MOVETIME

## Track&Talk watch

### Quick Start Guide



# Know your watch

## Overview

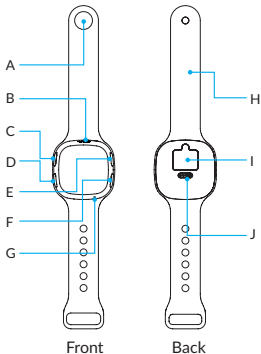

---

**A** Watch-button

---

**B** Speaker

---

**C** Volume +

**On the Home screen:** Press to open the phonebook, press again to choose contacts.

**In the List mode:** Press to increase the volume or page up.

---

**D** Volume -



**On the Home screen:** Press to enter the voice messages list.

**In the List mode:** Press to decrease the volume or page down.

When you have an incoming voice call, short press to answer.

Press for 3 seconds to start recording.

---

E SOS key 	<b>Emergency calls:</b> Long press the 'SOS' key for at least 3 seconds.
F Power key 	<ul style="list-style-type: none"> <li>• Power on/off.</li> <li>• Enter into the volume list.</li> <li>• When you have an incoming call, short press to reject the call.</li> <li>• On the Home screen, short press to enter the volume mode.</li> <li>• On all screens other than Home, short press once to go back.</li> <li>• Depress the button for at least 8 seconds to initiate a system reboot.</li> </ul>
G Microphone	
H Wristband	
I SIM slot	
J Charging port	

#### Notes:

- The screen will light up by pressing any key.
- Watch only supports GPRS network and Nano SIM card without encrypting PIN code.

#### Screen



When the watch is roaming, the right side of the signal bar will appear "R". At the same time, prompt information will display in the message bar in the application. **Note:** Consult the local operators to open the roaming service.

# Inserting Nano SIM card

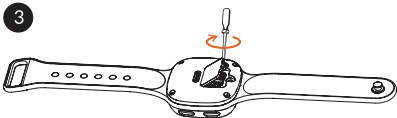
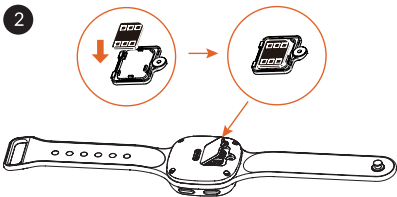
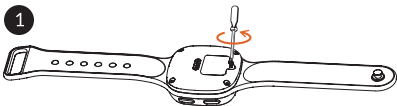

# Basic operations on your watch

## Power on/off

Press and hold the **Power key** for 3 seconds to power on/off your watch.

Press and hold the **Power key** for 8 seconds to reboot when your watch crashes.

## SOS

Press and hold the **SOS key** for 3 seconds on any screen (except the incoming/ongoing/dialing call screen) to call five key family members.

1. Once your watch has obtained a fix on your location, it will send details of your location to 10 chosen family members. (Application shows the SOS alarm screen with prompt).
2. It will attempt to dial 10 chosen numbers in turn. If there is no answer within 10 seconds, it will move onto the next number in the list until a call successfully connects.
3. If a SIM card is not inserted, or if the watch does not have a signal, the SOS feature will instead attempt to dial 112 (Emergency services). You can press the Power Key at any time to either cancel the call setup or hang up the call. Note: Currently emergent number is not set by default, you can customize it.

**Note:** Press the **Power key** to interrupt the call.

## Sending a voice message

1. Press **Volume -** for 3 seconds to start recording.
2. Release to stop recording, as well as to send the voice message.
3. When finishes sending, it will go back to the last screen.

**Note:** Notification icon will flash when your watch receives a voice message.

## Voice message management

- Press **Volume +** to scroll up the menu.
- Press **Volume -** to scroll down the menu.
- Short press the **Power key** to go back to the Home screen.

**Note:** The storage is limited to 30 voice messages. If there are more than 30 messages, the message will be overwritten automatically.

## Calling and answering

1. Short press **Volume +** to enter the family number list.
2. Short press **Volume +** to choose the next family number.

3. Press **Volume -** for 3 seconds to send a voice message to chosen family number.

**Note:** Press the **Power key** to go back to the Home screen.

### Volume adjustment

- Short press power on/off button first, then press **Volume +** to increase the volume.
- Short press power on/off button first, then press **Volume -** to decrease the volume.

**Note:** Decrease the volume to mute your watch. When you have an incoming call, your watch will vibrate.

### Power off & Airplane mode

Long press the **Power key** for 3 seconds to enter "Power off & Airplane mode" screen.



### Update

Watch will install the firmware automatically after finishing downloading.



# Using the application from your smartphone

Download the application from App Store or Google play.



## Pairing

### 1. Input the IMEI to pair your watch

Obtain the information of IMEI number through the package information or pressing **Volume +/-** and the **SOS key** in the same time until the information displayed on the screen. Then input the IMEI number to the application information bar and confirm.

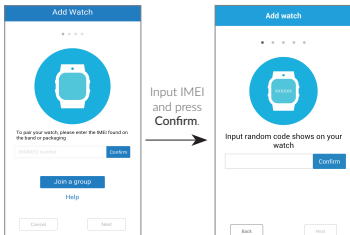

The server will send a random code to your watch and the information displayed on the screen should be noted at this time. Input the random code to the application information bar and confirm.

## 2. Scan the QR code to pair your watch

You can share the QR code to add some group members. Scanning the QR code will be automatically adjusted according to the interval time.

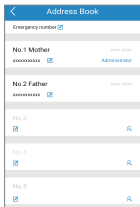

## Functions

### Application screen



Slide left  
to find  
the list

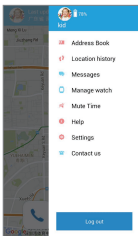

Hide or show the shortcut menu.



Click to refresh the watch location instantly.





Click to enter the details page of Electronic fence.



Click to jump to the navigation page.



Steps.



Power.



Click to enter the voice message screen.



Click to dial by the watch.

## Member management

Touch **Family numbers** to open the member list.

Set the local emergency call number here.

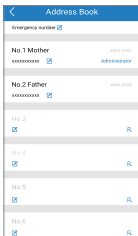

**Note:** Each device will have only one administrator, and the user will be regarded as an administrator for the first time.

Administrator can transfer the management rights in the members' management page.

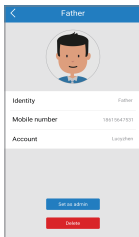

### Voice message

Touch  to enter the voice screen.

When you create a voice message, the length of each recording is 15s. You can dialogue with some group members, or dialogue with your children alone.



## Safe zone

Touch **##** to enter the **Safe zone** screen.

In this function, you can set an area on the map as a safe area for your child. When your child leaves the security area, you will be notified. Pay attention that the timeliness of the notification will depend on the frequency of the location. The longer interval time for positioning that you set, the time to receive the notification will be relatively longer.

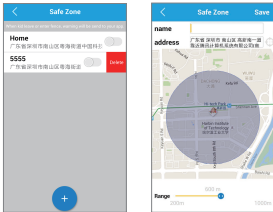

## Save power

Touch **🔋** to enter the power screen.

You can choose the location frequency according to the daily usage habit. Different positioning mode will affect the positioning accuracy and standby time. Choose the appropriate use mode according to the actual scene.

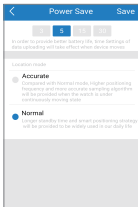

## Mute time

Touch **Mute time** to set the reminder function of your watch. You can set to mute or cancel the vibration according to the actual environment in use by your children. Pay attention that in the silent mode, children can recover the setting by adjusting the volume of the watch. But in the vibration mode, it need to be recovered through application setting.



## Upgrade

Touch **Update** to upgrade your watch and App. The status bar at the bottom will display the related downloading progress when upgrading. Be aware that the watch relies on the network when upgrading. It will use a certain amount of data.

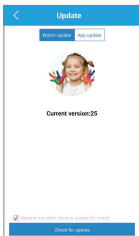

# FAQ

## 1. Unable to obtain the position of your watch

Go to check if your watch has a SIM card or if you're in a place where can't receive the signal. If SIM was inserted with device already powered on, it will not register as this device does not support "hot swap". In this case user will need to restart (power off/on device) to restore service.

## 2. Unable to obtain the verification code

You need to open the relevant SMS receiving service. For more information, consult your local operators.

## 3. Waterproof notice

This product has an IP65 rating which means it is protected against water jets. Do not submerge your watch in water, for example when swimming.

## 4. Positioning accuracy

Your watch will provide three kinds of positioning modes: GPS, WLAN, LBS. Position accuracy will be different according to different positioning methods. All position information is only for reference in a certain range.

## 5. Data service

The position information of watch and remote setting caused by voice message and application will be working based on the communication between GPRS network and cloud server. It will consume the data which need to be paid by yourself.

## 6. SOS

The guardian should be familiar with the specific operation of SOS and the operation instruction for children.

## 7. Whether the material of this product is harmful to children

The material in use has passed related safety testing for children, which can ensure the safety of daily use.

## 8. Charging

When the charging port is corroded or dirty, it will seriously affect the charging process which requires a clean surface. After playing sports, wipe any sweat from your watch before charging.

## 9. Storage and use of location data for user

For all the data related to you, we will only use the queries you submit to us. We will not use for any commercial application or development without authorisation.



[www.sar-tick.com](http://www.sar-tick.com)

This product meets applicable national SAR limits of 2.0W/kg. The specific maximum SAR values can be found in the section of this user guide.

When carrying the product or using it while worn on your body, either use an approved accessory such as a holster or otherwise maintain a distance of 5 mm from the body to ensure compliance with RF exposure requirements. Note that the product may be transmitting even if you are not making a phone call.

## Certification

### WEEE Approval

This device is in compliance with the essential requirements and other relevant provisions of the Waste Electrical and Electronic Equipment Directive 2012/19/EU (WEEE Directive).



This symbol on device means that these products must be taken to collection points at the end of their life:

- Municipal waste disposal centres with specific bins for these items of equipment.
- Collection bins at points of sale.

They will then be recycled, preventing substances being disposed of in the environment, so that their components can be reused.

#### **In European Union countries:**

These collection points are accessible free of charge.

All products with this sign must be brought to these collection points.

#### **In non European Union jurisdictions:**

Items of equipment with this symbol are not to be thrown into ordinary bins if your jurisdiction or your region has suitable recycling

and collection facilities; instead they are to be taken to collection points for them to be recycled.

CAUTION RISK OF EXPLOSION IF BATTERY IS REPLACED BY AN INCORRECT TYPE. DISPOSE OF USED BATTERIES ACCORDING TO THE INSTRUCTIONS

Following air regulation, the battery of your product is not charged. Please charge it first.

## RoHs Approval

This device is in compliance with the restriction of the use of certain hazardous substances in electrical and electronic equipment Directive 2011/65/EU (RoHs Directive).

## Radio Waves

Proof of compliance with international standards (ICNIRP) or with European Directive 1999/5/EC (R&TTE) is required of all modem models before they can be put on the market. The protection of the health and safety for the user and any other person is an essential requirement of these standards or this directive.

THIS DEVICE MEETS INTERNATIONAL GUIDELINES FOR EXPOSURE TO RADIO WAVES.

This device is a radio transmitter and receiver. It is designed not to exceed the limits for exposure to radio waves (radio frequency electromagnetic fields) recommended by international guidelines. The guidelines were developed by an independent scientific organization (ICNIRP) and include a substantial safety margin designed to assure the safety of all persons, regardless of age and health.

The radio wave exposure guidelines use a unit of measurement known as the Specific Absorption Rate, or SAR. The SAR limit for mobile devices is 2 W/kg.

Tests for SAR are conducted using standard operating positions with the device transmitting at its highest certified power level in all tested frequency bands. The highest SAR values under the ICNIRP guidelines for this device model are:

Maximum SAR for this model and conditions under which it was recorded.		
Body-worn SAR	GSM 1800	0.872 W/kg

During use, the actual SAR values for this device are usually well below the values stated above. This is because, for purposes of

system efficiency and to minimize interference on the network, the operating power of your mobile device is automatically decreased when full power is not needed for the call. The lower the power output of the device, the lower its SAR value.

Body-worn SAR testing has been carried out at a separation distance of 0mm. To meet RF exposure guidelines during body-worn operation, the device should be positioned at least this distance away from the body. If you are not using an approved accessory ensure that whatever product is used is free of any metal and that it positions the phone the indicated distance away from the body.

The World Health Organization has stated that present scientific information does not indicate the need for any special precautions for the use of mobile devices. They recommend that if you are interested in further reducing your exposure then you can easily do so by limiting your usage or keep the device away from the head and body.

For more information you can go to [www.alcatel-mobile.com](http://www.alcatel-mobile.com); Additional information about electromagnetic fields and public health are available on the following site: <http://www.who.int/peh-emf>

This device is equipped with a built-in antenna. For optimal operation, you should avoid touching it or degrading it.

## Licenses

**C E 0560**

This equipment is in compliance with the essential requirements and other relevant provisions of Directive 1999/5/EC. The entire copy of the Declaration of Conformity for your device can be obtained through our Website: [www.alcatel-mobile.com](http://www.alcatel-mobile.com)

## Warranty

The device is warranted against any deviation from technical specifications for a period of twelve (12)<sup>(1)</sup> months from the date specified on your original invoice.

Under the terms of this warranty, you must immediately inform your vendor in case of a conformity defect on this device, and present a proof of purchase.

---

<sup>(1)</sup> The warranty period may vary depending on your country.



The vendor or repair center will decide whether to replace or repair this device, as appropriate.

Repaired or replaced this device is warranted ONE (1) month unless there are statutory provisions to the contrary.

This warranty shall not apply to damage or defects to this device due to:

- 1) Not following the instructions for use or installation,
- 2) Not being compliant with technical and safety standards applicable in the geographical area where this device is used,
- 3) Improper maintenance of sources of energy, and of the overall electric installation,
- 4) Accidents or consequences of theft of the vehicle in which this device is transported, acts of vandalism, lightning, fire, humidity, infiltration of liquids, inclement weather,
- 5) Connecting to or integrating into this device any equipment not supplied or not recommended by the manufacturer,
- 6) Any servicing, modification or repair performed by individuals not authorised by the manufacturer, the vendor or the approved maintenance centre,
- 7) Use of this device for a purpose other than that for which it was designed,
- 8) Malfunctions caused by external causes (e.g., radio interference from other equipment, power voltage fluctuations),
- 9) Faulty connections resulting from unsatisfactory radio transmission or caused by the absence of radio relay coverage.

Warranty is also excluded for this device on which markings or serial numbers have been removed or altered.

This device is also warranted against hidden defects (defects inherent in the design, manufacture, etc.).

There are no other express warranties than this printed limited warranty, expressed or implied, of any nature whatsoever.

In no event shall the manufacturer be liable for incidental or consequential damages of any nature whatsoever, including but not limited to trading loss, commercial loss, to the full extent those damages can be disclaimed by law. Some countries/states do not allow the exclusion or limitation of incidental or consequential damages, or limitation of the duration of implied warranties, so the preceding limitations or exclusions may not apply to you.