

# Doro Secure<sup>®</sup> 580IUP

## User guide

English

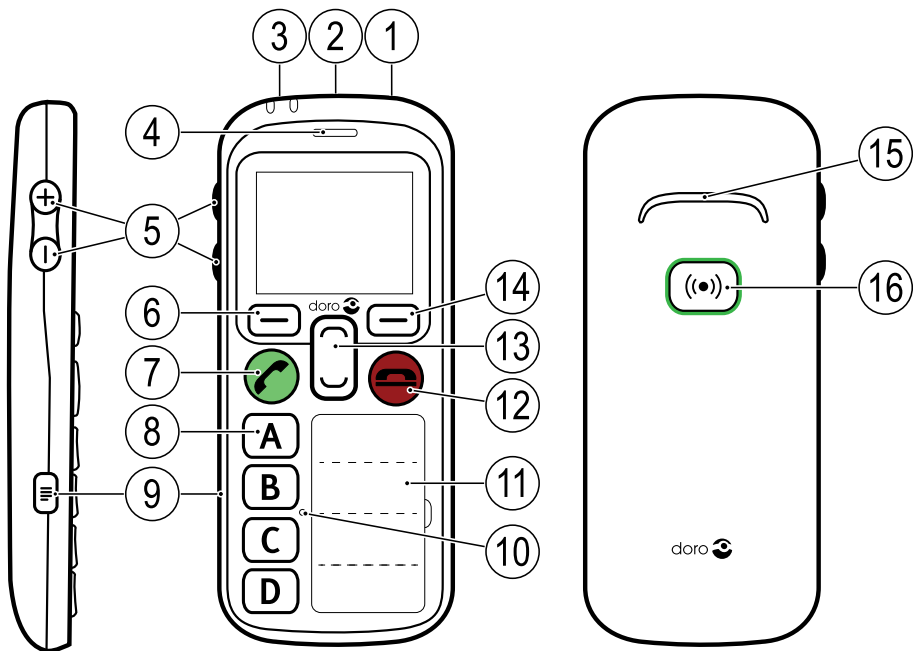





**Note!** All illustrations are for illustrative purposes only and may not accurately depict the actual device.

## English

- |   |                            |
|---|----------------------------|
| 1. Power on/off                                   | 9. Settings menu           |
| 2. Headset socket                                 | 10. Microphone             |
| 3. Charging socket                                | 11. Name list              |
| 4. Earpiece                                       | 12. End call key/Back      |
| 5. Volume keys (+/-)                              | 13. Navigation buttons     |
| 6. Left selection button                          | 14. Right selection button |
| 7. Call key                                       | 15. Loudspeaker            |
| 8. Speed dial keys<br>(A-D or Telecare functions) | 16. Assistance button      |

The items supplied with your phone might vary depending on the software and accessories available in your region or offered by your service provider. You can obtain additional accessories from your local Doro dealer. The supplied accessories provide the best performance with your phone.

# Contents

Congratulations on your purchase .....	1
Use the phone .....	1
Get started .....	1
Charge the phone .....	1
Turn the phone on .....	3
Turn the phone off .....	3
Navigate the phone  .....	3
Status bar .....	4
Calls .....	5
Make a call .....	5
Answer a call .....	5
Volume control .....	6
Handsfree mode .....	7
Headset .....	7
Emergency calls .....	8
Call waiting .....	8
Assistance button .....	8
Additional functions .....	9
Lock keys .....	9
My number .....	9
ICE  .....	9
Safety timer .....	9
Messages .....	10
Call log .....	10
IUP .....	11

## Congratulations on your purchase

An easy mobile phone for improved safety. Durable and splash proof (IP54) mobile with four speed dial keys for calling people you rely on with one simple press. Feel even safer thanks to an assistance button and a safety timer that can automatically dial up and send an SMS alarm to preset numbers. GPS localization lets people know where you are. Contacts can be managed by a trusted relative over the Internet using My Doro Manager. For more information about accessories or other Doro products please visit [www.doro.com](http://www.doro.com).

## Use the phone

### Get started

#### Charge the phone

#### CAUTION

Only use batteries, chargers and accessories that have been approved for use with this particular model. Connecting other accessories may be dangerous and may invalidate the phone's type approval and warranty.

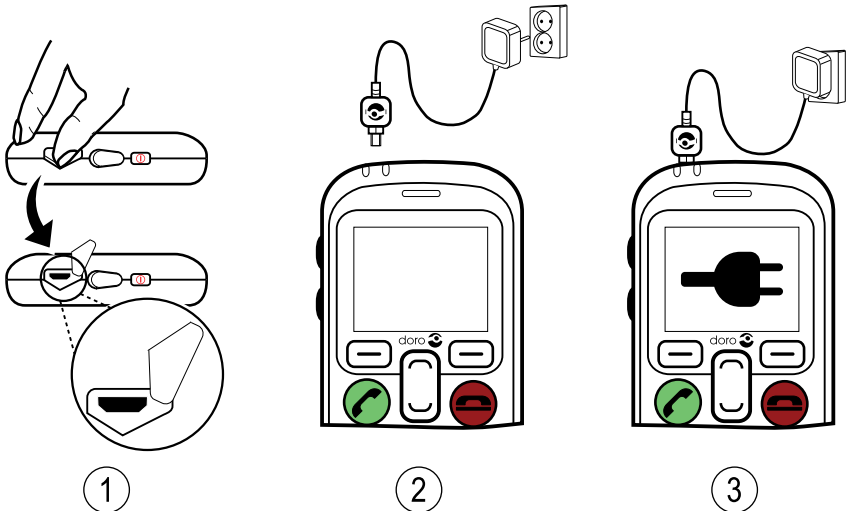

**IMPORTANT!**

The Assistance alarm feature is disabled when connected to a PC with a USB cable.

**Note!** When you have fully charged the battery and disconnected the charger from the device, unplug the charger from the wall outlet to save energy.

**Tip:** Use the cradle to charge your device.

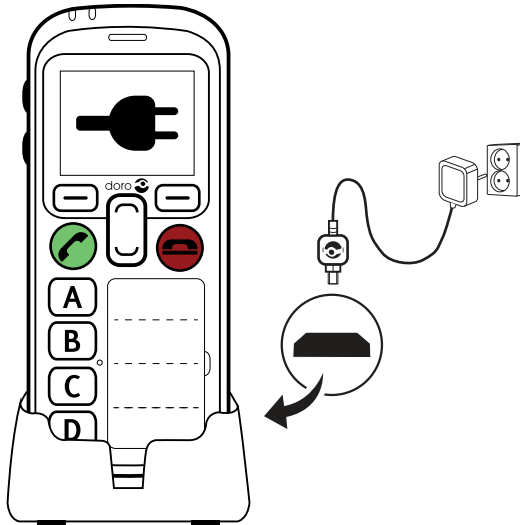

## Turn the phone on

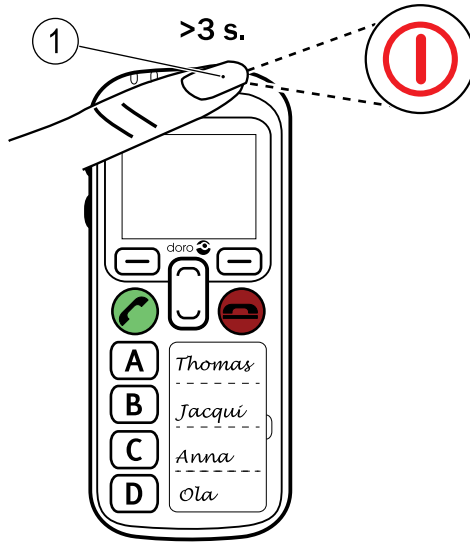

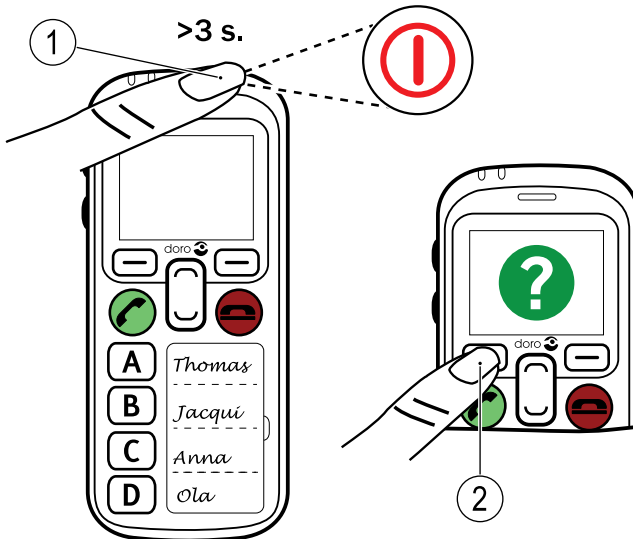

## Turn the phone off





## Navigate the phone

### Standby (idle mode)



















When the phone is ready to use, and you have not keyed in any characters, the phone is in standby.

- Press  to return to standby mode.
- Press left selection button  to access the **Menu**.

## Scroll

- Use the arrow buttons / to scroll in menus.

## Status bar

	Signal strength (the more bars, the better signal strength)		No network coverage
	Battery level (the more bars, the more charge in the battery)		Ringtone only for incoming calls
	Ringtone and vibration for incoming calls		Vibration only for incoming calls
	Silent. No ringtone or vibration for incoming calls.		Missed call
	Unread text message/SMS		Headset connected
	Bluetooth enabled		GPS active
	On-going safety timer		Roaming (in other network)
	Data transmission		Keypad locked
	Service centre connected		Service centre unavailable
	Active IUP function		

# Calls

## Make a call

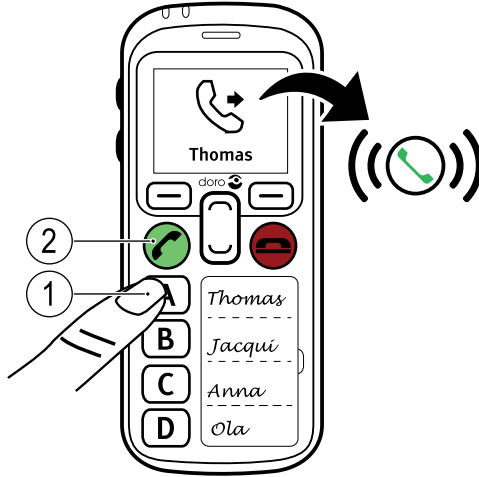

## Answer a call

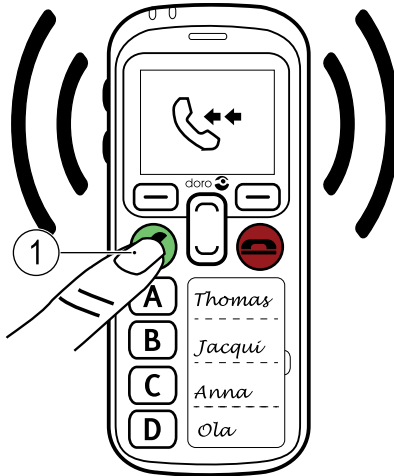



## Volume control

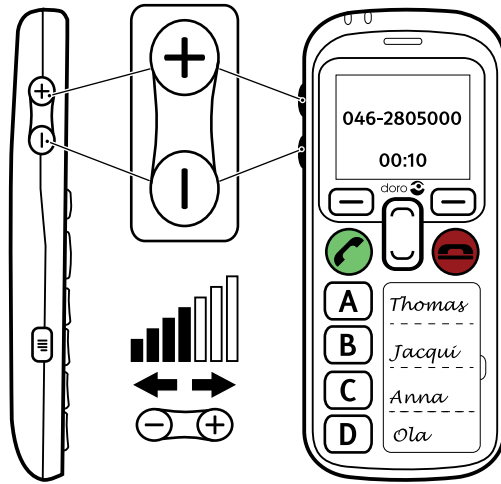

## Handsfree mode

The loudspeaker allows you to speak without holding the phone closely to the ear. Speak clearly into the phone microphone (A) at a maximum distance of 1 m.

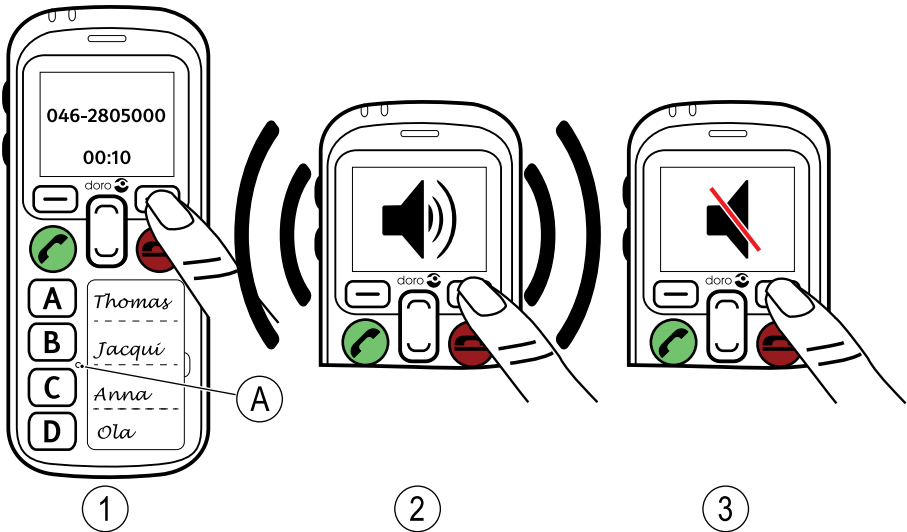

## Headset

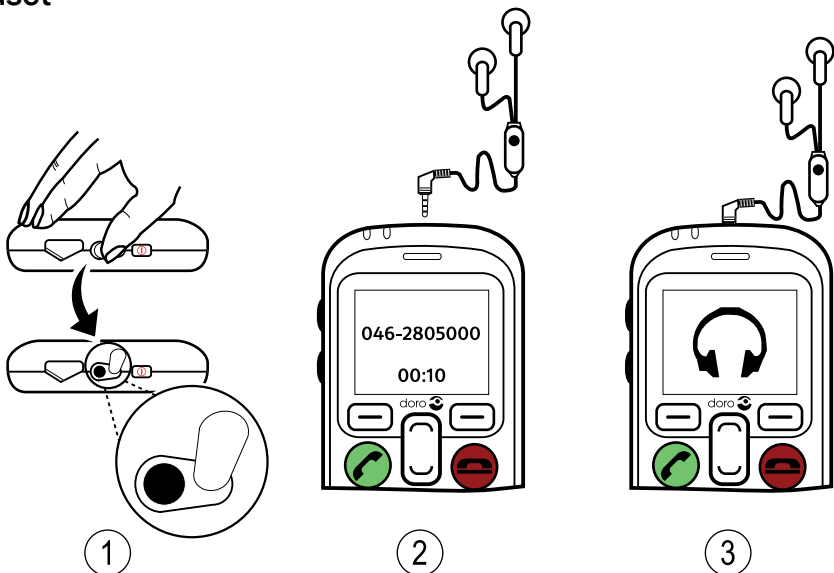

## Emergency calls

As long as the phone is switched on, it is possible to place an emergency call.

1. Press **Menu** and select  **Emergency call**.
2. Select **Call** or press .

**Note!** Some networks accept calls to emergency numbers without a valid SIM card. Contact your service provider for more information.

## Call waiting

You can handle more than one call at a time, put the current call on hold and answer the incoming call. When activated, an alert tone is heard if there is an incoming call whilst already on a call.

- During a call, press  to swap between calls.



## Assistance button

### CAUTION

When an assistance call is activated the phone is pre-set to handsfree/speakerphone mode. Do not hold the device near your ear when the handsfree mode is in use, because the volume may be extremely loud.

The assistance button allows easy access to contact your predefined help numbers should you need help.

### Make an assistance call

1. When help is needed, press and hold the Assistance button  for 3 seconds, or press it twice within 1 second. The assistance call begins after a delay. In this time you can prevent a possible false alarm by pressing .
2. An assistance text message (SMS) is sent to all recipients.
3. A positioning text message (SMS) is sent to all recipients.
4. The first recipient in the list is dialled. If the call is not answered within 25 seconds, the next number is dialled. Dialling is repeated 3 times or until the call is answered, or until  is pressed.

---

## Additional functions

The functions described in this section are optional and may vary depending on phone setup.

### Lock keys

You can lock the keypad to prevent the keys being accidentally pressed, for example, when your phone is in your handbag.

Incoming calls can be answered by pressing  even if the keypad is locked. During the call, the keypad is unlocked. When the call is ended or rejected, the keypad is locked again.

### Lock keys

1. Press **Menu** and select  **Lock keys**.
2. Press **Lock**.

### Unlock

- Press **Unlock** → **Yes**.

**Note!** Depending on phone settings, automatic key lock can be enabled after a set time.

### My number

The phone number assigned to your SIM card is saved as **My number**.

1. Press **Menu** and select  **My number**.
2. Press **OK** to view.

### ICE

First responders can access additional information such as medical information from the persons phone in case of emergency. In the event of a trauma, it is critical to have this information as early as possible to increase the chances of survival.

1. Press **Menu** and select  **ICE**.
2. Press **OK** to view.

### Safety timer

The safety timer is used to the alert service centre if the timer isn't deactivated within a set of time. For example, before taking a shower activate

---

the safety timer and if not deactivated within a set time, your predefined help numbers are notified.

### Enable safety timer

1. Press **Menu** and select  **Safety Timer**.
2. Select **Function on/off** → **On** to activate.

### Disable safety timer

- Press **Cancel**.

### Set time

1. Press **Menu** and select  **Safety Timer**.
2. Select **Time** and use the side buttons **+/-** to enter time, maximum 120 minutes.
3. Press **OK** to confirm.

### Turn on/off sound

1. Press **Menu** and select  **Safety Timer**.
2. Select **Sound**.
3. Select **On** to enable, or **Off** to disable.
4. Press **OK** to confirm.

### Messages

You can receive 200 text messages on your Doro Secure® 580IUP.

**Note!** When you have received the maximum limit, the oldest text message is replaced in order to receive the new one.

1. Press **Menu** and select  **Messages**.
2. Select **Read**.
3. Press **Back** to exit.

**Tip:** When you receive a new message, you can select **Yes** to read it. Check the status bar for unread messages,  is shown.

### Call log

Received, missed and dialled calls are saved in a combined call log.

1. Press **Menu** and select  **Call log**.

---

2. Use / to select:



Received call



Dialled call



Missed call

3. Select **View**.

## IUP

Mandown (IUP) is a lone person protection function that can send an alarm manually or automatically to predefined telephone numbers in the Emergency numbers list.

### Alarm features

**Note!** You can always deactivate the alarm by pressing .

The Mandown function is temporarily inactive when the phone is being charged, during an ongoing call and when handling the menus of the phone.

## Horizontal

- **Non alarm state:** the device is in horizontal position, example belt holder (A).
- **Automatic sequence:** Yes.

## Emergency call sequence

1. The phone is tilted approximately  $45^\circ$  from horizontal position for more than 15 seconds (B).
2. The emergency sequence is started after 30 seconds (C).
3. To cancel, place the phone into horizontal position within 25 seconds (A) OR press **Yes** to cancel. If no action:
  - An assistance text message (SMS) is sent to all recipients.
  - A positioning text message (SMS) is sent to all recipients.
  - The first recipient in the list is dialled. If the call is not answered within 25 seconds, the next number is dialled. Dialling is repeated 3 times or until the call is answered, or until  is pressed.

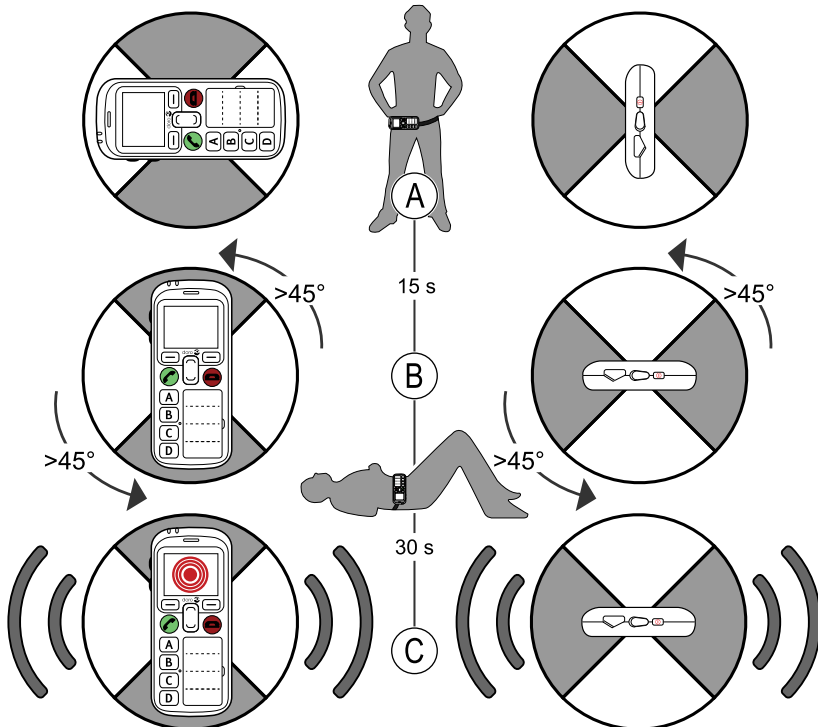

## Vertical

- **Non alarm state:** the device is in vertical position, example pocket or lanyard (A).
- **Automatic sequence:** Yes.

## Emergency call sequence

1. The phone is tilted approximately  $45^\circ$  from vertical position for more than 15 seconds (B).
2. The emergency sequence is started after 30 seconds (C).
3. To cancel, place the phone into vertical position within 25 seconds (A) OR press **Yes** to cancel. If no action:
  - An assistance text message (SMS) is sent to all recipients.
  - A positioning text message (SMS) is sent to all recipients.
  - The first recipient in the list is dialled. If the call is not answered within 25 seconds, the next number is dialled. Dialling is repeated 3 times or until the call is answered, or until  is pressed.

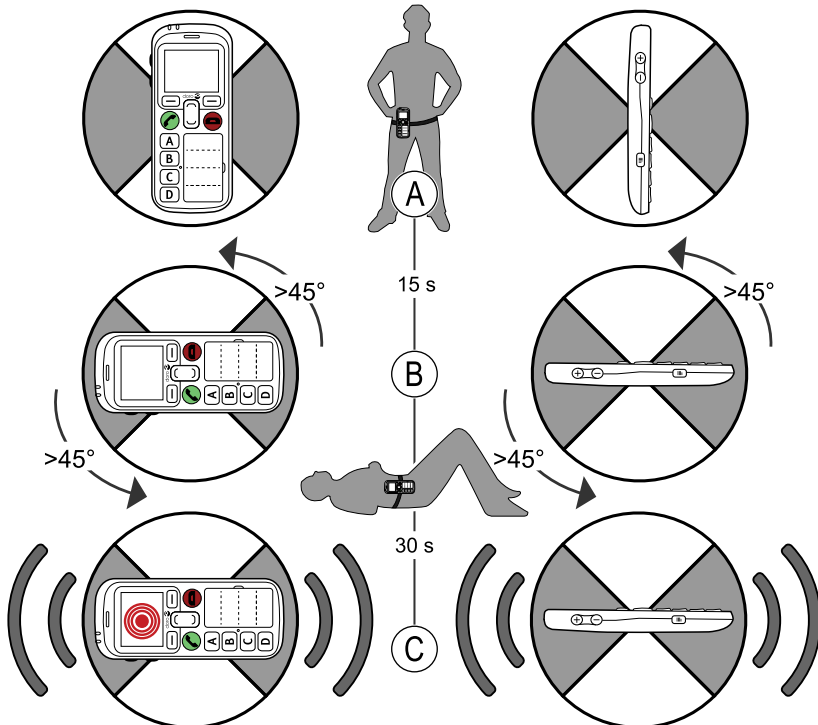



---

## Motionless

- **Non alarm state:** the device is in motion.
- **Automatic sequence:** Yes.

## Emergency call sequence

1. The phone is motionless (which could indicate unconsciousness of the carrier) for more than 15 seconds.
2. The emergency sequence is started after 30 seconds.
3. To cancel, put the phone in motion within 5 seconds OR press **Yes** to cancel. If no action:
  1. An assistance text message (SMS) is sent to all recipients.
  2. A positioning text message (SMS) is sent to all recipients.
  3. The first recipient in the list is dialled. If the call is not answered within 25 seconds, the next number is dialled. Dialling is repeated 3 times or until the call is answered, or until  is pressed.

## Horizontal & motionless

Combination of horizontal and motionless.

## Vertical & motionless

Combination of vertical and motionless.

## Activate Mandown

1. Press **Menu** and select  **IUP**:
  - **Off** to disable.
  - **Horizontal**
  - **Vertical**
  - **Motionless**
  - **Hor. or motionless** (combination of horizontal and motionless).
  - **Ver. or motionless** (combination of vertical and motionless).
2. Press **OK** to confirm.

Secure 580IUP (1031,1041,1051)

English

Version 4.0

© 2015 Doro AB. All rights reserved.  
[www.doro.com](http://www.doro.com)



REV 17353 – STR 20141212