

## USER MANUAL E504

### Safety Warning

- Before using the unit please read the manual.
- Keep this product away from any water, liquid or wet areas.
- Keep this product away from open flames such as candles.
- This item is ONLY to be plugged into an AC 100V~240V Power outlet.
- The unit should be powered off before unplugging the product.
- Do not place the product in direct sunlight or heat. Keep away from temperatures over 35°C.
- Never try to repair this product yourself, take it to an authorized technician. Trying to remove panels or repairing the unit yourself could result in an electric shock.
- Do not insert foreign objects into the product.
- Adult Supervision is recommended if children are using this product

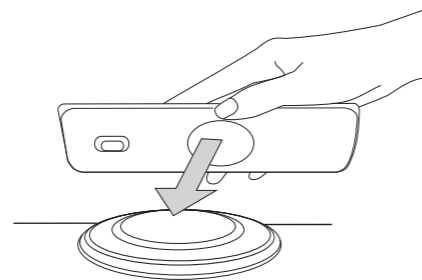

### Operating instructions :

Align the receiver to our transmitter.  
The blue light will be turned on if your device is in the charging status.

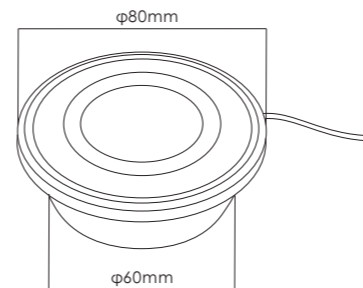

### Specifications :

Input: 5V2A  
Output: 5V1A  
Power: 5W

### Trouble Shooting :

Appearance	Passable Reason	How to Solve
Can not charge the phone	Power plug does not connect	Re connect the power plug
	USB plug does not connect	Re connect the USB plug
The charging light does not work	Does not align to the charging area	Try move around
	Receiver or transmitter not work	Try another receiver or contact your dealer
The charging light is twinkling	Does not align to the charging area	Try move around
The phone is too hot when charging	Does not align to the charging area	Try move around

### Compatible list :

Samsung	HTC	LG	Nokia	Sony	Microsoft
GALAXY S7	One M8 Eye	Nexus 4	Lumia 720	Xperia Z4v	Surface Phone
GALAXY S7 Edge	Butterfly 3	Nexus 5	Lumia 720T		Lumia 950 XL
GALAXY S6	One E9		Lumia 925		Lumia 950
GALAXY S6 Edge	One Max 2		Lumia 930		
GALAXY S6 Edge+			Lumia 929		
W2016			Lumia 820		
GALAXY Note 5			Lumia 1020		
GALAXY S4			Lumia 1050		
			Lumia 928		
			Lumia 925T		
			Lumia 1520		

### FCC STATEMENT

1. This device complies with Part 15 of the FCC Rules. Operation is subject to the following two conditions:  
(1) This device may not cause harmful interference.  
(2) This device must accept any interference received, including interference that may cause undesired operation.
2. Changes or modifications not expressly approved by the party responsible for compliance could void the user's authority to operate the equipment.

NOTE: This equipment has been tested and found to comply with the limits for a Class B digital device, pursuant to Part 15 of the FCC Rules. These limits are designed to provide reasonable protection against harmful interference in a residential installation.

This equipment generates uses and can radiate radio frequency energy and, if not installed and used in accordance with the instructions, may cause harmful interference to radio communications. However, there is no guarantee that interference will not occur in a particular installation. If this equipment does cause harmful interference to radio or television reception, which can be determined by turning the equipment off and on, the user is encouraged to try to correct the interference by one or more of the following measures:  
Reorient or relocate the receiving antenna.

Increase the separation between the equipment and receiver.  
Connect the equipment into an outlet on a circuit different from that to which the receiver is connected.  
Consult the dealer or an experienced radio/TV technician for help.

### RF warning statement:

The device has been evaluated to meet general RF exposure requirement. The device can be used in portable exposure condition without restriction.