

UX-2

WIRELESS CONTROLLER FOR PLAYSTATION®3 | PC

Thank you for purchasing the VX-2 Wireless Controller for PS3 and Playstation®3 from Gioteck.

We hope that this product will go beyond your expectations for a quality made accessory.

Please read this booklet thoroughly before using the product and review the Playstation®3 and PC manual for additional details regarding system operation.

Thank you & enjoy!

PRECAUTIONS

This product has been designed with the highest concern for safety. However, any electrical device, if used improperly, has the potential to cause harm. To help ensure risk-free operation please pay attention to the following guidelines.

- Use only as intended. This is a precision product, handle with care.
- Contains small parts. Not suitable for children under 3 years of age.
- Store in a dry & dust free area.
- Do not store in areas of extreme heat or cold, and avoid direct sunlight or heat sources eg. heaters.
- Do not allow the product to get wet or dirty; doing so may cause damage.
- Do not clean with benzene, paint thinner, acetone, alcohol, or other such solvents.
- Do not take the product apart; doing so will void your warranty and may cause electrical shock.

WARNINGS

 This symbol indicates important installation, operational or maintenance instructions. Always follow these instructions closely.

ENVIRONMENT

 Please help to conserve the environment by recycling the cardboard packaging of this product.

 This product should NOT be disposed of in normal household waste. It should be disposed of separately. Please take it to an electrical waste collection point.

TROUBLESHOOTING TIPS & TO VIEW THIS MANUAL ONLINE:
www.gioteck.com

LEGALS

This product complies with the following legal regulations. For further information go to www.gioteck.com

This device complies with Industry Canada RSS 210 standard(s). Operation is subject to the following two conditions: (1) this device may not cause interference, and (2) this device must accept any interference, including interference that may cause undesired operation of the device.

Caution: The user is cautioned that changes or modifications not expressly approved by the party responsible for compliance could void the user's authority to operate the equipment. This device complies with Part 15 of the FCC Rules. Operation is subject to the following two conditions: (1) this device may not cause harmful interference, and (2) this device must accept any interference received, including interference that may cause undesired operation. Note: This equipment has been tested and found to comply with the limits for a Class B digital device, pursuant to part 15 of the FCC Rules. These limits are designed to provide reasonable protection against harmful interference in a residential installation. This equipment generates, uses and can radiate radio frequency energy and, if not

installed and used in accordance with the instructions, may cause harmful interference to radio communications. However, there is no guarantee that interference will not occur in a particular installation. If this equipment does cause harmful interference to radio or television reception, which can be determined by turning the equipment off and on, the user is encouraged to try to correct the interference by one or more of the following measures:

- Reorient or relocate the receiving antenna.
- Increase the separation between the equipment and receiver.
- Connect the equipment into an outlet on a circuit different from that to which the receiver is connected.
- Consult the dealer or an experienced radio/TV technician for help.

This equipment complies with FCC radiation exposure limits set forth for an uncontrolled environment. End user must follow the specific operating instructions for satisfying RF exposure compliance. This transmitter must not be co-located or operating in conjunction with any other antenna or transmitter.

CE

Gioteck hereby declares that this product is in compliance with the essential requirements and other provisions of Directive 2004/108/EC and R&TTe 1999/5/EC. To view the full version of the Declaration of Conformity please go online to doc.gioteck.com

 **immersion**
TouchSense Technology

TouchSense Technology Licensed from Immersion Corporation. TouchSense Technology for Spinning Mass Tactile Feedback Devices protected by one or more of the following United States Patents: 5831408, 5844392, 5857986, 5907487, 5959613, 6020875, 6088017, 6104158, 6246390, 6252583, 6271833, 6275213, 6278439, 6343349, 6400352, 6411276, 6424333, 6715045, 6801008, 7131073, 7199790, 7209117, 7299321, 7327348, 7345672, 7502011 and other patents pending.

Complies with
IDA Standards
DB100398

UX-2

WIRELESS CONTROLLER

PLAYSTATION®3 | PC

FEATURES & DETAILS

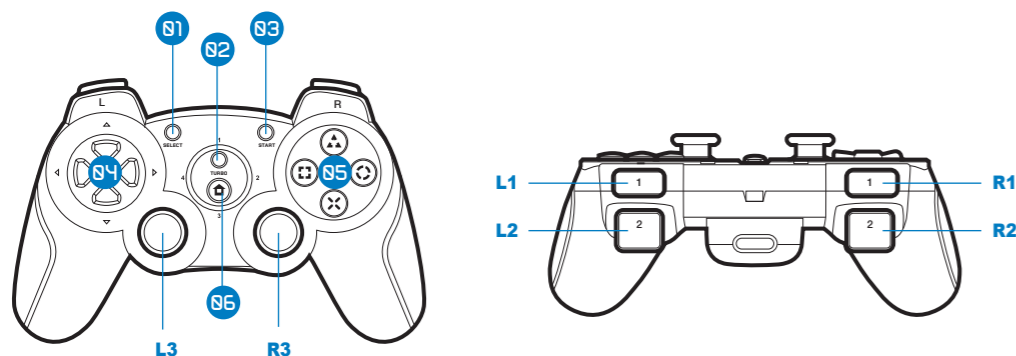

GB

- 01 | Select Button
- 02 | Turbo Button
- 03 | Start Button
- 04 | Directional Pad
- 05 | Function Buttons
- 06 | Home Button
- 07 | USB Receiver

FR

- 01 | Touche SELECT
- 02 | Bouton Turbo
- 03 | Touche START
- 04 | Touches directionnelles
- 05 | Touches de fonction
- 06 | Touche Home
- 07 | Dongle USB

DE

- 01 | Select-Taste
- 02 | Turbo-Taste
- 03 | Start-Taste
- 04 | Steuertaste
- 05 | Funktionstasten
- 06 | Home-Taste
- 07 | USB-Dongle

ES

- 01 | Botón SELECT
- 02 | Botón Turbo
- 03 | Botón START
- 04 | Botones de dirección
- 05 | Botones de función
- 06 | Botón Home
- 07 | Llave USB

IT

- 01 | Tasto SELECT
- 02 | Tasto TURBO
- 03 | Tasto START
- 04 | Tasto direzionale
- 05 | Tasti funzione
- 06 | Tasto HOME
- 07 | Dongle USB

PT

- 01 | Botão SELECT
- 02 | Botão Turbo
- 03 | Botão START
- 04 | Botões Direccionais
- 05 | Botões de Função
- 06 | Botão Home
- 07 | Adaptador USB

CZ

- 01 | Tlačítko Vybrat
- 02 | Turbo tlačítko
- 03 | Tlačítko Start
- 04 | Směrová podložka
- 05 | Funkční tlačítka
- 06 | Tlačítko Domů
- 07 | Adaptér USB



PS3 SET UP & PAIRING



1. Ensure 2 x AA batteries are loaded in your controller and that your PS3 console is turned on.

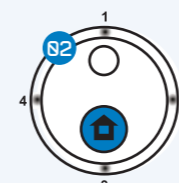

2. Press the Home button on the controller. (The 4 port LED's will flash rapidly while in search mode.)

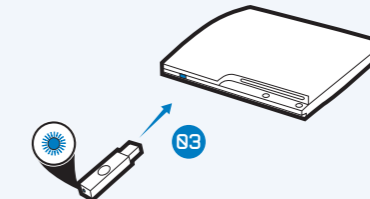

3. Plug the USB receiver into one of USB ports on your console. The LED on the USB receiver will flash rapidly during the pairing process and will turn to a solid colour when pairing is complete.

LED	CHANNEL
1	1
2	2
3	3
4	4
1+4	5
2+4	6
3+4	7

4. Press the Home button to confirm the allocated channel port. To add multiple controllers (up to 7) or to assign your controller to a different port go to: **Accessory settings > Reassign controller.** Once connected 1 or 2 LEDs around the Home button will light.

PC SET UP & PAIRING

1. Connect the USB receiver to your computer and then press the Home button. The controller will now connect wirelessly to your computer.
2. Configure the controller for use on your computer.

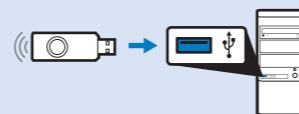

 The VX-2 can only be paired wirelessly with one device at a time. If you plan to alternate between your PS3 and computer, the set-up procedure will need to be repeated every time you want to use the VX-2 with your computer.

 To check/change the default key mapping and functions: Control Panel > Game Controllers > Properties > Test

FUNCTION KEYS

To Power On: Press the Home button once until the LED illuminates.

To Power Off: Press & hold the Home button for 10 secs.

START : To start/pause a game.

HOME : To enter the PS3 menu.

SELECT : To select weapons or tools.

D-PAD: For moving direction UP/DOWN/LEFT/RIGHT.

Low Battery: The chosen channel port LED will flash continuously and motor vibration will stop functioning.

Sleep Mode : The controller will automatically enter sleep mode after 5 minutes of inactivity (all LED indication will be Off). To wake the controller from sleep mode, press the Home button.

Operation Time: 35 hours game play.

Turbo Function: Pressing an action button assigned with turbo will

simulate the button being pressed rapidly e.g. "boost firepower". The buttons supported by Turbo are □, △, ○, ×, L1, L2, R1, R2

To enable turbo : Press & hold Turbo then press the action button you wish to turbo. The LED will flash when an action is assigned.

To disable turbo : Repeat the steps above and the LED will turn off.

 More than one button can be assigned to turbo at one time.

 Once powered off, all buttons will return to default without Turbo.

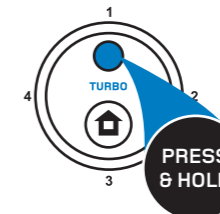

KEY MAPPING

Motor vibration is not supported in PC mode.

#	Function	PC Function	PS3 Function
1	LED 1	OFF	Channel 1 LED
2	LED 2	OFF	Channel 2 LED
3	LED 3	OFF	Channel 3 LED
4	LED 4	OFF	Channel 4 LED
5	HOME	13	PS Button
6	Fire Button 1	1	△
	Fire Button 2	2	○
	Fire Button 3	3	×
	Fire Button 4	4	□
7	Dpad - UP	POV_UP	UP
	Dpad - Right	POV_RIGHT	RIGHT
	Dpad - Down	POV_DOWN	DOWN
	Dpad - Left	POV_LEFT	LEFT
8	Left Stick-X Axis	Left Stick-X Axis	Left Stick-X Axis
	Left Stick-Y Axis	Left Stick-Y Axis	Left Stick-Y Axis
	L3	11	L3
9	Right Stick-X Axis	Z Axis	Right Stick-X Axis
	Right Stick-Y Axis	Z Rotation	Right Stick-Y Axis
	R3	12	R3
10	START	10	START
11	SELECT	9	SELECT
12	R1	6	R1
13	R2	8	R2
14	L1	5	L1
15	L2	7	L2

