

1.7 User Manual

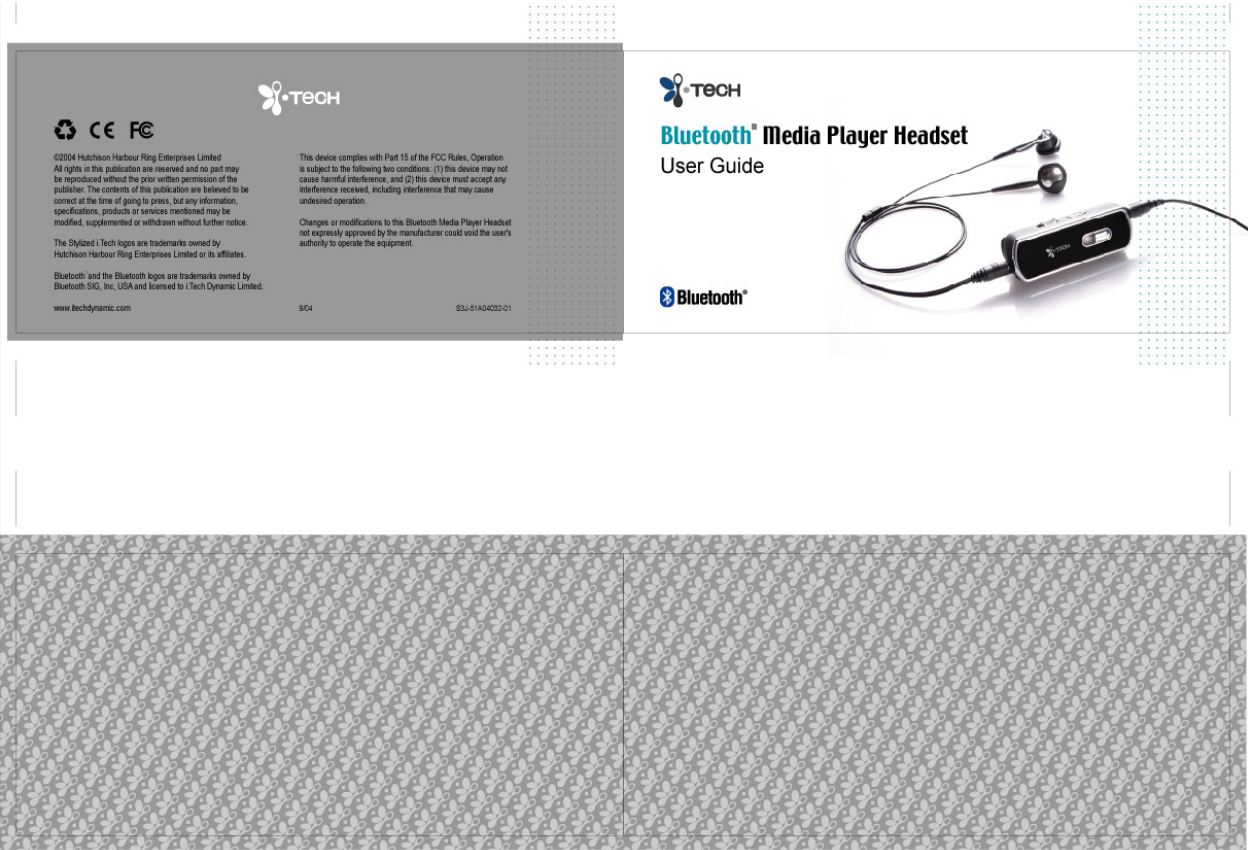

Product Specifications

Bluetooth Specification:	Version 1.1
Bluetooth Profile Supported:	Headset and Handsfree Profiles
Talk time*:	Up to 10 hours (AAA)
	Up to 6 hours (1.2V 800mA Ni-MH)
Standby time*:	Up to 500 hours(AAA)
	Up to 300 hours (1.2V 800mA Ni-MH)
Range:	Up to 10 meters
Dimensions:	65mm (L) x 23mm (W) x 17mm (H)
Weight (excluding battery):	37 grams

*may vary due to the battery and the users operation mode and mobile phone setting.

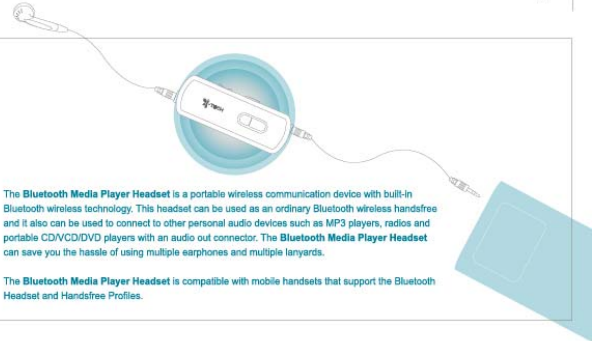

Contents

Bluetooth Media Player Headset Overview.....	2
Getting Started.....	3-4
Insert a Battery into Your Bluetooth Media Player Headset.....	5
Insert a Battery.....	5
Talk and Standby Time.....	5
Low Battery.....	5
Turning Your Bluetooth Media Player Headset On and Off.....	6
Turning On the Headset.....	6
Turning Off the Headset.....	6
Pairing Your Bluetooth Media Player Headset.....	7-8
Using Your Bluetooth Media Player Headset.....	9-10
Listen to Audio.....	9
Manage Your Call.....	9
• Answering a Call.....	9
• Ending a Call.....	9
• Dialing from Your Mobile Handset.....	9
• Voice Dialing from Your Headset.....	9
• Last Number Redialing from Your Headset.....	10
Adjusting the Volume & Resetting your Bluetooth Media Player Headset.....	11
Troubleshooting.....	12
Safety Information.....	13
Care and Maintenance.....	14
Product Specifications.....	15

Care and Maintenance

- Please turn off your Bluetooth Media Player Headset before placing it in your pocket or bag. If the MFB is accidentally depressed, your mobile handset may place an unintended call.
- Do not expose the Bluetooth Media Player Headset to liquid, moisture or humidity as it is not waterproof.
- Do not use abrasive cleaning solvents to clean the Bluetooth Media Player Headset.
- Do not expose the Bluetooth Media Player Headset to extremely high or low temperatures.
- Do not dispose of the Bluetooth Media Player Headset in a fire as it will result in an explosion.
- Do not expose your Bluetooth Media Player Headset to contact with sharp objects as this will cause scratches and damage.
- Do not stick anything inside the Bluetooth Media Player Headset as this may damage internal components.
- Do not attempt to disassemble the Bluetooth Media Player Headset as it does not contain serviceable components.
- If you do not use the Bluetooth Media Player Headset for long periods, be sure to store it in a dry place, free from extreme temperatures and dust.

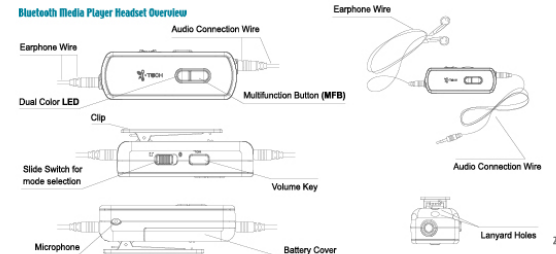
<p>Safety Information</p> <ul style="list-style-type: none"> • Check local laws regarding use of a mobile handset and Bluetooth Media Player Headset while driving. If you use the headset while driving, ensure your attention and focus remains on your responsibility of driving safely. • Never allow children to play with the Bluetooth Media Player Headset – small parts may be a choking hazard. • Observe all signs that require an electrical device or RF radio product to be switched off in designated areas. These could include hospitals, blasting areas, and potentially explosive atmospheres. • Turn off your Bluetooth Media Player Headset prior to boarding an aircraft. Do not use your Bluetooth Media Player Headset in an aircraft. • Never mount or store your Bluetooth Media Player Headset over any air bag deployment area as serious injury may result when an air bag deploys. 	<p>Bluetooth Media Player Headset Overview</p> 
--	--

<p>Getting Started</p> <p>1. To use your Bluetooth Media Player Headset ("headset") as an audio player headset, please follow these simple steps:</p> <ul style="list-style-type: none"> • Use the provided Audio Connection Wire to connect to the Bluetooth Media Player Headset with your personal audio device (such as MP3 player, radio or portable CD/VCD/DVD player). • Use the provided Earphone Wire* (or your own earphone wire) to connect to the Bluetooth Media Player Headset. *Dependent on package, either mono earphone wire or stereo earphone wire is provided. • Push the Slide Switch to Audio mode [A]. • Turn on your personal audio device (please refer to your personal audio device user guide). Now you can listen to audio signal from your personal audio device. <p>NOTE The Bluetooth Media Player Headset does not require power if you use it as an audio player headset. You can listen to stereo audio from your audio player device even if the headset is turned off.</p>	<p>Troubleshooting</p> <p>If you are unable to connect your Bluetooth Media Player Headset to the mobile handset, please try the following:</p> <ul style="list-style-type: none"> • Ensure the Bluetooth Media Player Headset is turned on and the battery is full. • Ensure the Bluetooth Media Player Headset is paired with your mobile handset no more than 1 meter apart and ensure there is nothing in between. • Ensure the mobile handset's Bluetooth feature is activated. Please refer to your mobile handset user guide for specific instruction. • Ensure the Bluetooth Media Player Headset is within a maximum of 10 meters of your mobile handset and there are no obstructions, such as walls or other electronic devices in between. <p>If the above steps do not resolve your problem, please reset your headset, remove both the headset and the mobile handset batteries for a while.</p> <p>The Bluetooth Media Player Headset is compliant with and adopts the Bluetooth Specification 1.1. However, interoperability between the device and other Bluetooth-enabled products is not guaranteed because it depends on compatibility. For more information on the compatibility between the device with other Bluetooth-enabled products, please check with the manufacturer.</p>
--	--

Adjusting the Volume & Resetting Your Bluetooth Media Player Headset

Adjusting the Volume

Push the **Slide Switch** to **1** and press the **Volume Key** repeatedly until you reach the desired volume level.

NOTE Volume can be adjusted only when the headset is in Bluetooth mode **1**.

Resetting the Headset

You may want to reset the **Bluetooth Media Player Headset** to its original setting. This also clears all current pairings.

1. Ensure the headset is OFF and is in Bluetooth mode **1**.
 2. Press and hold the **Volume Key** until the LED alternately flashes green and red rapidly.
 3. Release the **Volume Key**.
 4. Press and hold the **Volume Key** again until you hear 2 beeps.
- The headset is now turned off and returns to the original setting. All current pairings are cleared.

2. To use your Bluetooth Media Player Headset as a Bluetooth headset with your mobile handset, please follow these simple steps:

- Insert a battery into your Bluetooth Media Player Headset. Please refer to "Insert a Battery into Your Bluetooth Media Player Headset" on the next page.
- Push the **Slide Switch** to Bluetooth mode **1**.
- Turn on your headset and pair your headset with your Bluetooth-enabled mobile handset. Please refer to "Turning Your Bluetooth Media Player Headset On and Off" on page 6 and "Pairing Your Bluetooth Media Player Headset" on pages 7-8.

Insert a Battery into Your Bluetooth Media Player Headset

Insert a Battery

Insert one AAA alkaline battery or one 1.2V 800mA-Ni-MH rechargeable battery into your Bluetooth Media Player Headset.



Talk & Standby Time*

For AAA alkaline battery, the normal talk time is up to 4 hours and standby time is up to 120 hours.

For 1.2V 800mA-Ni-MH rechargeable battery, the normal talk time is up to 4 hours and standby time is up to 100 hours.

*Time and standby time may vary due to the battery and users' operation mode and phone setting.

Low Battery

When the headset is on and the battery becomes low, the LED flashes red and the headset emits a short beep in every 1 minute. Please change the battery as described above.

Using Your Bluetooth Media Player Headset

Voice Dialing from Your Headset

If your mobile handset is equipped with a voice dialing function, push the **Slide Switch** to **1**; press the **MFB** on your handset and when you hear a beep, say the voice tag name.

NOTE Please make sure to record voice tag into the mobile handset first before using voice dialing function.

Last Number Redialing from Your Headset

Push the **Slide Switch** to **1** and press the **MFB** on your headset twice.

NOTE The above functions are only applicable to mobile handsets with Bluetooth Handsfree Profile. Functionality varies depending on the mobile handset model you have. Please refer to your mobile handset user guide for additional information.

NOTE If you are listening to audio from your personal audio device and your headset has been paired with your mobile handset, when there is an incoming call, please push the **Slide Switch** from Audio mode **2** to Bluetooth mode **1** to accept the call. To end the call, push the **Slide Switch** back to **2** to continue listening to your audio.

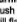
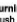

9

6

<p>Using Your Bluetooth Media Player Headset</p> <p>Listen to Audio Connect your headset to your personal audio device through the Audio Connection Wire and turn your personal audio device on. Please refer to "Getting Started" on pages 3-4.</p> <p>NOTE The Bluetooth Media Player Headset as an audio player headset does not require power and the headset can be turned off.</p> <p>Manage Your Call The Bluetooth Media Player Headset can be used as a Bluetooth headset after it has been paired with your Bluetooth-enabled handset.</p> <p>NOTE To manage your call, the headset must be in Bluetooth mode .</p> <ul style="list-style-type: none"> • Answering a Call To answer a call, wait for the headset to ring, then press the MFB once to accept the call or answer the call via your mobile handset in the normal way. • Ending a call Press the MFB once to end your call or end the call via your mobile handset in the normal way. <p>• Dialing from Your Mobile Handset Simply make calls on your mobile handset in the normal way.</p>	<p>Turning Your Bluetooth Media Player Headset On and Off</p> <p>Turning On the Headset Push the Slide Switch to , press and hold the MFB for approximately 2 seconds until you hear a short beep. The LED will flash green.</p> <p>NOTE Press the MFB again each time you turn on the headset to reactivate pairing so that the connection between the headset and the mobile handset is resumed. For pairing, please refer to "Pairing Your Bluetooth Media Player Headset" on pages 7-8.</p> <p>Turning Off the Headset Push the Slide Switch to , press and hold the MFB for approximately 3 seconds until you hear a long beep. The LED flashing stops.</p>
---	---

7

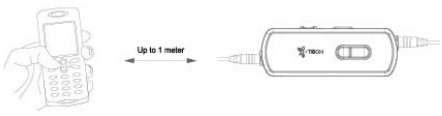
8

<p>Pairing Your Bluetooth Media Player Headset</p>  <p>Prior to using your Bluetooth Media Player Headset as a Bluetooth headset for the first time, you must pair it with a Bluetooth-enabled mobile handset.</p> <p>The information on the next page describes pairing instruction for a typical Bluetooth-enabled mobile handset. Handset pairing procedure is subject to different models of mobile handsets.</p>	<p>Pairing Your Bluetooth Media Player Headset</p> <ol style="list-style-type: none"> 1. Place the headset and the mobile handset no more than 1 meter apart and ensure there is nothing in between. 2. Ensure the headset is OFF. 3. Push the Slide Switch to , press and hold the MFB until the headset LED alternately flashes green and red. 4. Activate your mobile handset's Bluetooth function by referring to your mobile handset user guide for details. 5. Set the mobile handset to search for Bluetooth devices within about 1 meter as instructed in the mobile handset user guide and select "L.Tech" from the list. 6. Enter the preprogrammed passkey "0000" and press "OK" to pair your headset and mobile handset. When the pairing is complete, the headset LED will flash green rapidly for 5 times followed by a long beep. 7. Go back to your mobile handset's main menu. For certain mobile handset models, a headset icon will be shown on the screen. You should now be able to make and receive calls using your headset. <p>NOTE If the pairing cannot be completed within minutes while the pairing mode is activated, the headset LED flashes yellow with 3 beeps and the headset is turned off. Please repeat the above pairing procedures.</p>
--	---