

iBaby monitor



M2C User Manual

iOS
Android

Content

1	PRODUCT OVERVIEW.....	3
1.1	PACKING LIST	3
1.2	INTERFACE INTRODUCTION.....	3
1.3	PRODUCT SPECIFICATIONS	4
2	INSTALLATION INSTRUCTIONS.....	5
2.1	APP DOWNLOAD.....	5
2.2	DEVICE STARTUP.....	5
2.3	ACCOUNT REGISTRATION AND LOGIN	6
2.4	DEVICE ACTIVATION	6
3	APP OPERATION AND FUNCTION INTRODUCTION.....	9
3.1	VIDEO CONTROL MAIN INTERFACE	9
3.2	APP FUNCTION MENU	10
3.3	INTRODUCTION TO COMMON FUNCTIONS	11
4	FAQS.....	15
4.1	DEVICE LED STATUS LIGHT MEANING.....	15
4.2	INSTALLATION ISSUES	15
4.3	KEEP LOADING	19
4.4	USAGE ISSUES.....	21
5	CONTACT INFORMATION.....	22
6	FCC CAUTION.....	22

1 Product Overview

1.1 Packing list

- ✓ iBaby monitor*1
- ✓ Wall bracket *1
- ✓ User manual *1
- ✓ Power adapter *1

1.2 Interface Introduction



- 1) **LED status light:** Indicates the current working status of the machine, see Table 1 of Section 4.1
- 2) **Power interface**
- 3) **Reset button:** Long press to restore the device to factory settings.
- 4) **Temperature and humidity sensor interface:** Used to connect the bottom and transmit temperature and humidity data.
- 5) **Photosensitive sensor:** Used for automatic switching of night vision.
- 6) **Microphone**
- 7) **Lens**

1.3 Product Specifications

Model:M2C		
Video	compression method	H.264
	Frame rate	1~12 frames
	Resolution	Ultra (1920*1080), HD (1280*720), VGA (640*480)
	Lens	standard: 4.0mm F=2.0 Fixed aperture (2 million lens) Angle of view 85°
	Online users	support 4 users to watch online
Audio	compression method	G711
	Sampling frequency	8Kpbs
	Input	one audio input / built-in microphone
	Output	one audio output / built-in speaker
	Intercom mode	full duplex: two-way voice simultaneous intercom
Night vision	Night vision control	Photosensitive Resistor Automatic Control IR Light On (Minimum Illumination 0LUX)
	Night vision	effect 8 12ML LED lights Night vision 8 meters
Network protocol	Network protocol	TCP/IP, HTTP, UDP, DHCP, UPNP, NTP, P2P, etc.
	Support IP address	Dynamic IP address
Wireless	Wireless Protocol	Support WI-FI 802.11 a/b/g/n
	WI-FI module	supports 2.4GHz Wi-Fi
	Encryption mode	Support WPA/WPA2 encryption
	Built-in antenna port	1
Other interfaces	USB interface	1
	Temperature and humidity module	built-in: 1
	Reset button	1
	Power connector	DC5V 1A
	Other exterior	plastic

	material	
Others	Use environment	indoor use
	Product power consumption	within 2.5W when no one is watching during the day, within 3W after the infrared light is turned on at night
	Working environment	temperature: $-10^{\circ}\text{C} \sim 40^{\circ}\text{C}$, humidity: $40^{\circ}\text{C} \leq 75\%$
	Storage environment	temperature: $-40^{\circ}\text{C} \sim 55^{\circ}\text{C}$, humidity: $55^{\circ}\text{C} \leq 90\%$
	Size	body size: 585*55*55mm (length * width * height) packing size: 222*222*77mm (length * width * height)
	Weight	gross weight: 380g
System requirements	Mobile operating system	iOS8.0 or above, Android4.0 or higher
Certification	Certificate	FCC CE ROHS RCM KC

2 Installation instructions

2.1 APPDownload

Apple users: App Store search for "iBaby Care App"

Android users: Search the "iBaby Care App" on the Google Play Store

The application icon is shown below:



2.2 Device startup

Plug the device into the power supply. After about 30 seconds, the power-on prompt sounds and the rear LED status light turns red and flashes slowly, indicating that the device startup is complete and enters the standby state.

Note:

If the device has been activated on the server, no power-on tone will sound when powering up. For the meaning of LED status lights, see Table 1 in Section 4.1.

2.3 Account registration and login

1. New users

Press the App prompt to register an account. The account number must be an actual and valid mailbox, and the password must be a combination of letters (case sensitive) and numbers, and the length is 6 characters or more. Login will be completed automatically after registration is completed.

Note: The real mailbox is convenient for recovering the password and obtaining technical support reply when you forget the password.

2. Users with existing accounts

Log in directly using your registered email account and password. If you have forgotten your login password, please click the "Forgot Password" link on the login page and follow the steps to reset the password.

2.4 Device Activation

After the device is booted, confirm that the phone used to activate the device is connected to Wi-Fi and can access the iBaby Care App with the registered account when it is connected to the Internet.

1. Click "Add Device" in the menu bar to enter the product selection page below, select the corresponding device model to activate, and then select "Installation Preparation" page.

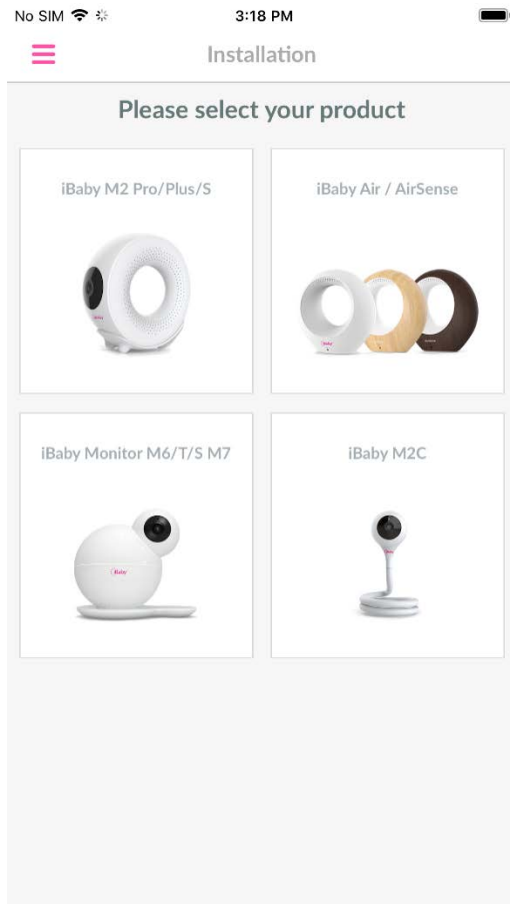

3. After confirming that the prepared content is complete, click the "Next" button.
4. Go to the following page, enter the correct Wi-Fi password, and click the "Next" button to enter the device activation process.

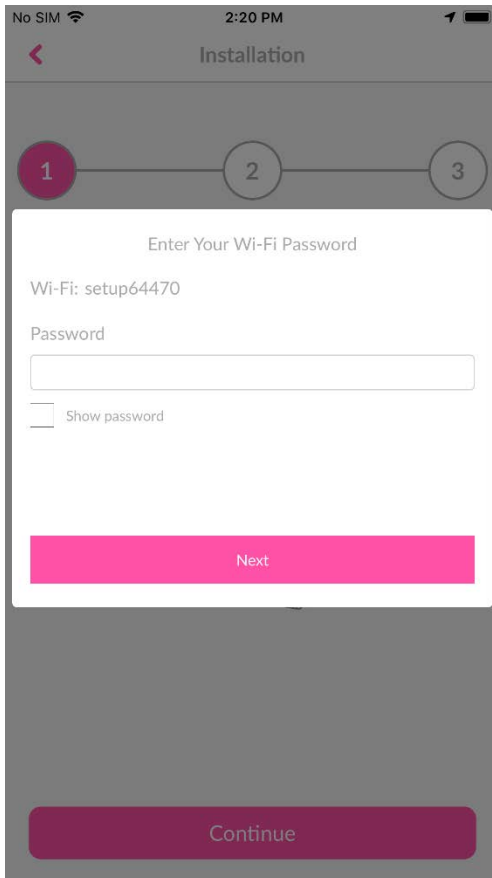

5. Activate the progress display, please wait for the activation progress to complete automatically and jump to the video control main interface (this process lasts about 1 minute), you can start normal use.

Note:

If you have not activated successfully, please refer to the "Installation Questions" section in section 4.2 of this document.

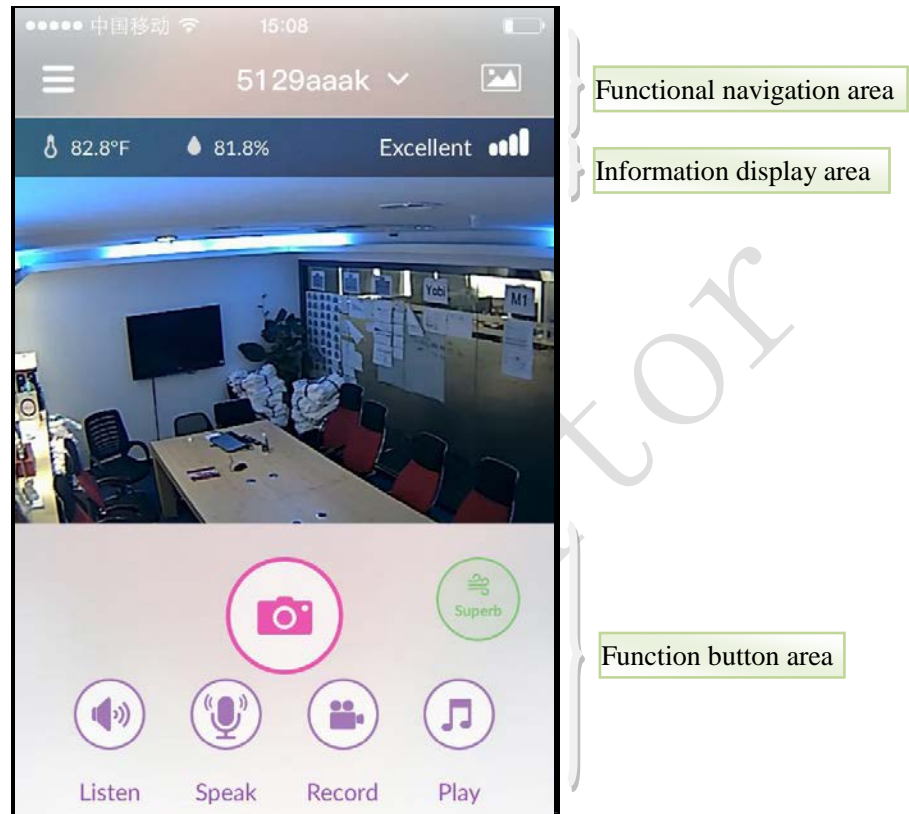

3 APP operation and function introduction

3.1 Video control main interface

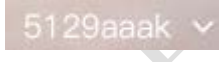

1. Functional navigation area:

: Function menu navigation button. Click on the left side to slide out the function menu page.

: Device list. When multiple devices are installed, click  to switch to watch other devices.

: Media library. Display alarms, manual recording/photographing media files.

2. Information display area:

: Current ambient temperature

: Current environmental humidity

: Device side Wi-Fi signal strength indication

3. Function button area:



: Listen button. Receive sound from the device side.



: Speech button. Transfer the sound to the device side.



: Record button. Record the current video, The video file is saved in the media library.



: Music button. Enter the music play page.



: Capture button. Capture the current video, the image is saved in the media library



Air quality icon. Display the current air quality level, click to view historical data.

3.2 APP function menu

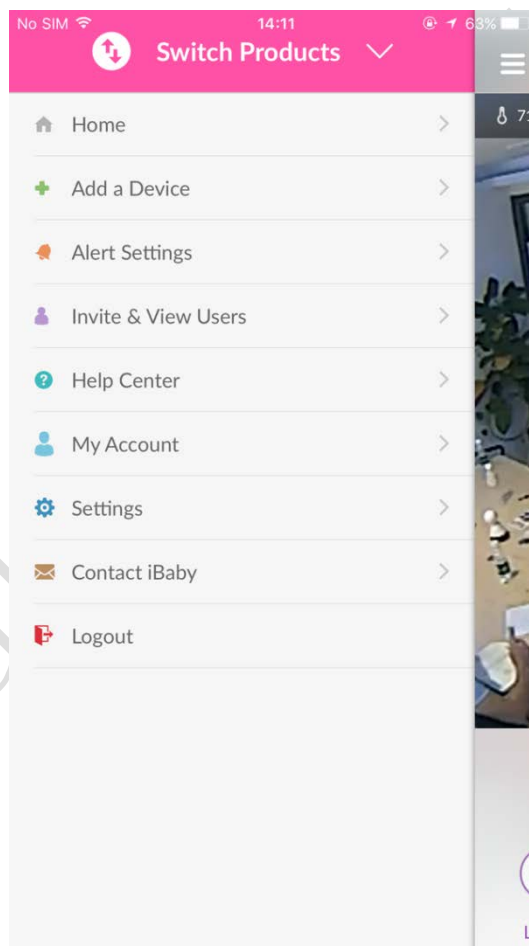

Switch products: Click to select other types of iBaby products

Home: Return to the viewing screen.

Add device: Add new device

Alarm setting: set alarm level or information such as movement, sound, etc.

Invite & View Users: Invite other users to view or configure viewer user permissions.

Help Center: Frequently Asked Questions

My account: personal information display and settings

Settings: device parameters, information settings

Contact us: Contact iBaby

Logout / Logout: Exit the current account

3.3 Introduction to common functions

3.3.1 Alarm setting function

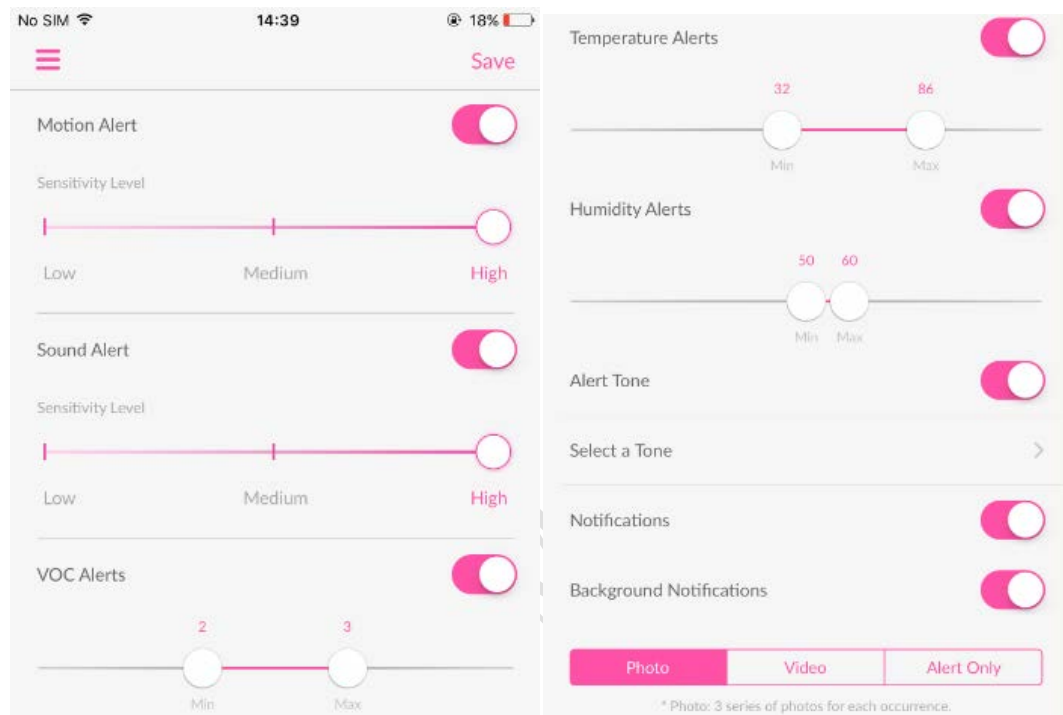

Motion alarm: An alarm that is triggered when an object moves in the screen. The higher the sensitivity level, the more sensitive it is.

Audible alarm: The alarm that is triggered when the ambient sound reaches the alarm level. The higher the sensitivity level, the more sensitive it is.

Temperature alarm: An alarm that is triggered when the ambient temperature is below a minimum value (such as 32°F) or above a maximum value (such as 86°F).

Humidity alarm: An alarm that is triggered when the ambient humidity is below a minimum value (such as 50%) or above a maximum value (such as 60%).

Alarm ringtone: Whether there is an audible prompt when setting the alarm, and the alarm ringtone can be selected when it is turned on.

Push notification: This button is enabled to receive an alert push message when the app is closed or running in the background.

Alarm action type selection:

Picture: When moving or audible alarm, capture 3 pictures and upload them to the media library for encryption.

Video: When moving or audible alarm, record a short 15 second video and upload it to the media library for encryption.

Alarm only: Only alarm message notifications are made and media files are not stored.

3.3.2 Invite & View Users

This feature invites family members or friends to work with the device. The invited user will act as a viewer within the permissions granted by the inviter. For detailed steps, see question 2 in section 4.4.

3.3.3 Settings → Display Settings

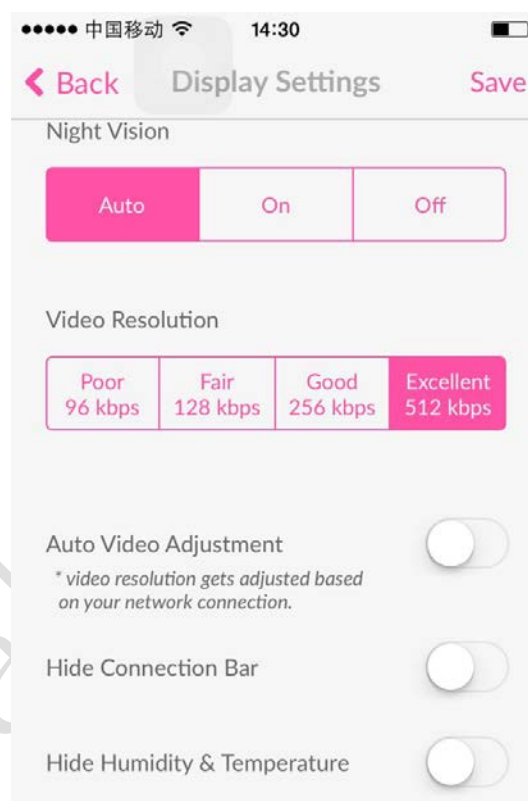

Night vision settings:

Auto: Automatically switch the screen to color/black and white as the ambient light is bright/dark. The default is automatic.

On: The picture is black and white regardless of whether the ambient light is bright or dark.

Off: The picture is displayed in color regardless of whether the ambient light is bright or dark.

Video resolution setting:

Poor 96kbps: The picture quality is poor, but the occupied bandwidth is small. The

amount generated per second is not more than 96kpbs

Medium 128kbps: medium quality, taking up less bandwidth. The amount generated per second is not less than 128kpbs

Good 256kbps: good picture quality (720P effect), occupying moderate bandwidth. The amount generated per second is not more than 256kpbs

Excellent 512kbps: The best picture quality (1080P effect), occupying a large bandwidth. The number generated per second is not less than 512kpbs

Automatic video adjustment: After turning on, the device will automatically adjust the display resolution according to the network conditions. After turning on, the video resolution setting will be invalid.

Hide the connection bar: Open the information display area in the main page of the hidden video control.

Hide Temperature and Humidity: Turn on the temperature and humidity display in the information display area in the main page of the hidden video control.

3.3.4 Settings → Sleep Mode

As shown below, when this setting is turned on, all invited viewers cannot view and operate the device. It is generally used when viewers who do not wish to invite are invited to operate the device during certain time periods or in some cases.



3.3.5 Music playback

As shown below, this function integrates the current popular children's songs, stories and poems and lullaby and other Internet resources, from the application to the songs on the device side to play.

Note: Since songs are Internet resources, there may be problems with delayed loading or playback depending on the status of the network during playback. Check the network configuration at the time.

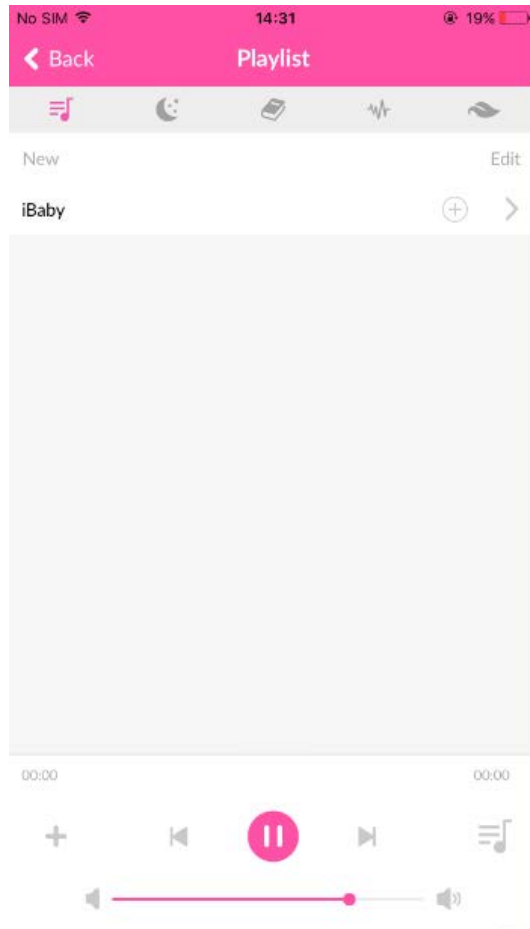

3.3.6 Version Information

As shown in the following figure, you can view the version of the APP, the version of the device firmware, and the serial number of the device. If a new version of the firmware is released, it can be updated to the latest firmware via the "Firmware Upgrade" button.



4 FAQs

4.1 Device LED Status Light Meaning

LED status	Meaning
Red slow flashing	The device is not connected to WI-FI, to be activated.
Green slow flashing	The device is connected to WI-FI but has not been activated yet.
Steady red	The device is activated without being connected to WI-FI.
Steady green	The device is working normally.
Red light and green light alternately flashes	Device startup.
No light	The device is not powered or faulty.

Table 4.1

4.2 Installation issues

Question 1 Apple users:

Prompt during installation, if you can't see any progress, please click Cancel (LED status light behind iBaby, red flashing)

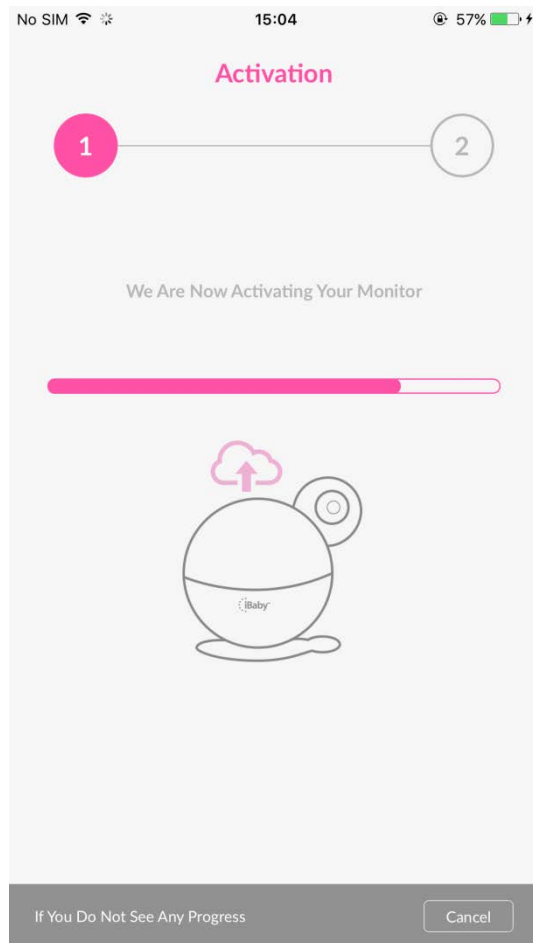

Answer: Red indicates that iBaby is not connected to your WI-FI. The solution is as follows:

- 1) Please use the USB cable that comes with the original phone to ensure good transmission.
- 2) Please install iBaby in a place with good WI-FI signal. The WI-FI name and password are preferably 8-32 characters in upper and lower case letters, numbers, - or underscores. They cannot contain special characters (such as Chinese characters, Japanese), Korean, etc.).
- 3) The SSID broadcast on the router should be turned on.
- 4) WPA2-PSK is selected for the WI-FI authentication type on the router, and AES is selected for the encryption algorithm.

Question 2 Android users:

Prompt installation failed, the LED status light behind iBaby flashes red, what is the reason?

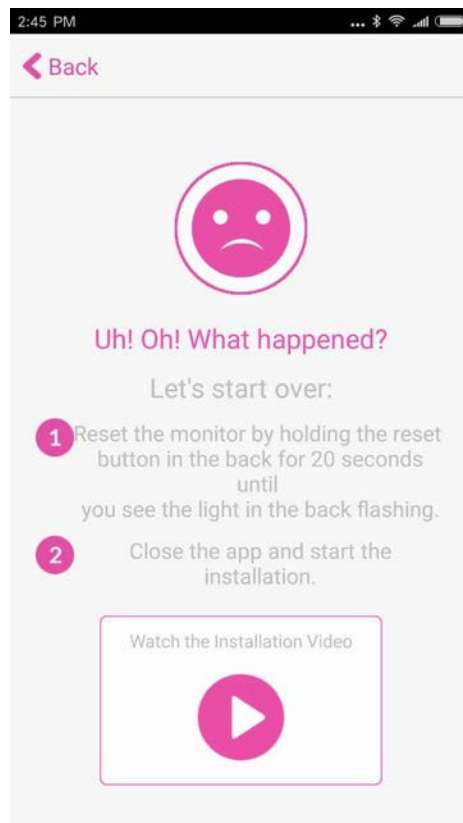

Answer: Red indicates that iBaby is not connected to your WI-FI. The solution is as follows:

- 1) Please confirm the WI-FI password, and then restart the device and re-install it.
- 2) Please install iBaby in a place with good WI-FI signal. The WI-FI name and password are preferably 8-32 characters in upper and lower case letters, numbers, - or underscores. They cannot contain special characters (such as Chinese characters, Japanese), Korean, etc.).
- 3) The SSID broadcast on the router should be turned on.
- 5) WPA2-PSK is selected for the WI-FI authentication type on the router, and AES is selected for the encryption algorithm.

Note:

After entering the password, immediately enter the installation, the installation progress bar, at around 5%, iBaby will make two beeps, after the installation is complete, the green light is always on.

If you don't hear the "beep" sound, you need to take the device to the side of the router to install, and power off and restart the router, it is best to change the time period before installing.

Question 3 Prompt during installation, if you can't see any progress, please click Cancel (LED status light behind iBaby, green flashing)

Answer: The green flashes slowly, indicating that the device is connected to your WI-FI but has not been activated on the server. Please exit the app from the background of the mobile phone, then run the APP, and turn off the router and device. If it still doesn't work, please re-install it in a different period of time and the device does not need to be reset.

Question 4 When adding equipment, stuck in the next step, what is the reason?

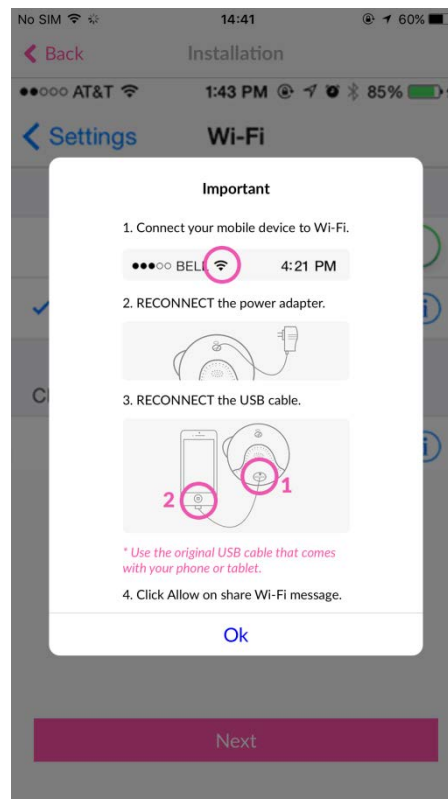

Answer: The reasons and solutions are as follows

- 1) Please use the original iPhone data cable
- 2) Please make sure the phone is connected to Wi-Fi
- 3) The device is plugged in and the startup is completed (the LED status light behind iBaby, the red flashes slowly)
- 4) The device is powered up and restarted.

Question 5 The home has replaced the new WI-FI, how to install the device?

Answer: If you have an Apple device (iPhone or iPad), you need to use a USB cable to reconnect your Apple device and iBaby. Click Allow WI-FI to share. If you don't have an Apple device, you need to RESET iBaby and reinstall it. RESET method, see question 4.4 in section 4.4.

Question 6 I forgot my login password, how do I do this?

Answer: If you have forgotten your login password, enter the email address you originally registered, and click Send. A link to reset your password will be sent to your email address. Please log in to the mailbox within one hour and click the password link to set a new login password.

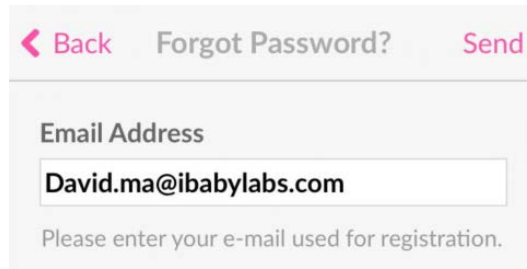

4.3 Keep Loading

Question 1 When viewing at home, the screen compares cards, which is slower (LED status lights behind iBaby, sometimes green, sometimes red)

Answer: Sometimes red, sometimes green, indicating that the WI-FI signal is not stable enough at the time, or the nearby WI-FI interference is serious, and it needs to be optimized from the following aspects:

- 1) If the router is a normal 2.4G, it is recommended to log in to the router to optimize the WI-FI settings. Take the TP-Link router as an example: select the band bandwidth 20M (NETGEAR router: enable 20/40MHz coexistence).
- 2) iBaby is too far away from WI-FI, or there are too many middle partition walls. It is recommended to try it near the WI-FI signal.
- 3) The router is heavily loaded at the time, and the router is powered off and restarted.
- 4) The router should be cool and not too old.

Question 2 When watching at home, the picture is always loaded, no picture is coming

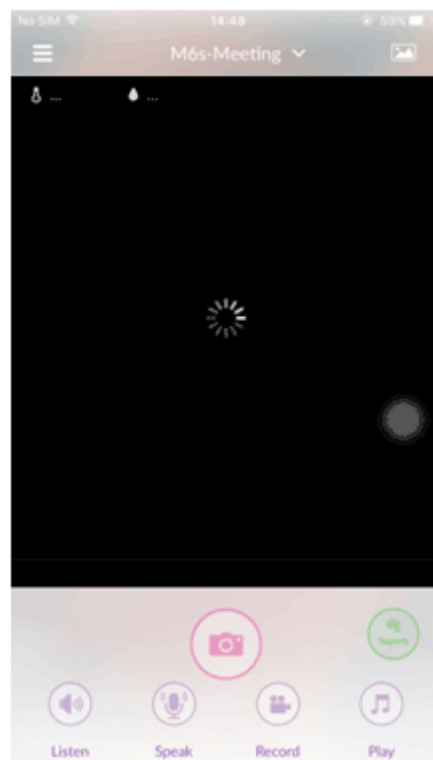

out (the LED status light behind iBaby is red)

Answer: Red indicates that iBaby is not connected to your WI-FI. Please try the following steps:

- 1) The device is powered up and restarted to see if the LED light turns green.
- 2) The router is heavily loaded at the time, and the router is powered on and restarted.
- 3) iBaby is too far away from WI-FI, or there are too many middle partition walls. It is recommended to try it near the WI-FI signal.
- 4) The router should be cool and not too old.
- 5) If it is always red, the router's WI-FI password may have been changed and the device needs to be reinstalled.

Question 3 When watching at home, the screen is black, but when you hear the sound, you can control the rotation of the device (the LED status light behind iBaby is green)

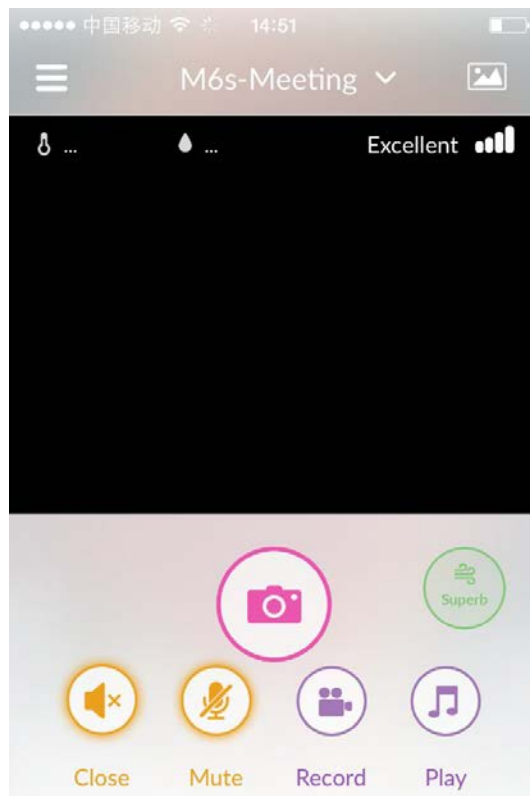

Answer: Green indicates that iBaby is connected to your WI-FI, but the network bandwidth is not enough. The reasons and solutions are as follows:

- 1) The router is heavily loaded at the time, and the router is powered on and restarted.
- 2) The device is powered on and restarted.
- 3) The APP is closed from the background of the mobile phone.
- 4) WI-FI is too far away from iBaby, or the nearby WI-FI is seriously interfered. If the router is 2.4G, log in to the router to optimize WI-FI. Take TP-Link router as an example: Band bandwidth is 20M (NETGEAR) Router: Enable 20/40MHz coexistence).
- 5) The router should be cool and not too old.

Question 4 Watching normal at home, watching 4G outside, comparing cards, slower.

Answer: Looking at the device screen, the requirements for network bandwidth are the same as watching video movies. The network where the device is located and the network speed of the

mobile phone must be fast.

- 1) Try to lower the resolution of the device.
- 2) The mobile app is closed in the background and reopened.
- 3) The device is powered up and restarted.

4.4 Usage issues

Question 1 When listening to the intercom at the same time, the noise is very loud.

Answer: The phone is too close to the device, it is recommended to be 10 meters away to reduce the crosstalk. The device is placed at home and there is no such problem when going out.

Question 2 I am the owner of the device, how can I invite other users to watch it?

Answer: You can invite other users (referred to as viewers) to watch by the owner. The steps are as follows:

- 1) Viewer's mobile phone, download the app, and register for an email account.
- 2) Owner, in the settings menu - "Invite & View Users, add viewers' email accounts, and send invitations.

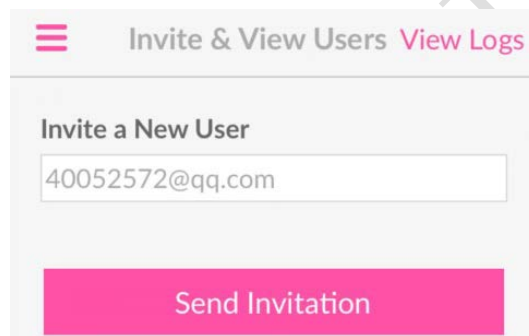

- 3) Viewer's mobile phone, exit the app from the background, and re-run the app.

Note:

Such a device is bound to both the owner account and the viewer account.

Question 3 The picture of the device is fuzzy. How to adjust the resolution?

Answer: You can adjust the resolution of the device in the APP Settings - Display Settings page. The image quality corresponding to "Excellent" is the highest, 1080P effect, but the occupied network bandwidth is also relatively large. If it is an Apple mobile phone, when the vertical screen is displayed, the screen is enlarged. It is recommended that the mobile phone be viewed horizontally, the picture is clearer, and the viewing angle is wider.

Question 4 Why can't I find my previous alarm pictures and videos?

Answer: Alarm pictures and videos are saved on the iBaby server. The default is 100 records, if it exceeds, the oldest record will be overwritten. Selecting a video will occupy a certain amount of network bandwidth. When the network is not good, it is recommended to select a picture.

Question 5 Why is the product not displayed in temperature and humidity?

Answer: Please check from the following:

1) Is the base placed?

The temperature and humidity module is built into the magnetic base. The iBaby and the three metal domes on the base should be aligned and placed flat. It is best to pick up the iBaby and pick up the magnetic base.

2) Is the iBaby firmware version up to date?

APP Settings Menu - "Settings -" Device & Application Information page, confirm the firmware version is 1.8.1 and above.

Question 6 How to reset the device (reset device to factory settings)?

Answer: Press and hold the RST button on the bottom of the device, don't let go, until the LED status light in Figure 1 starts to flash red and flash alternately (more than one second), then you can let go. When the music is ringing, and the LED light turns red slowly (one second), the reset is complete.

5 Contact information

Customer service hotline: 1-888-538-1004 (Monday – Friday: 9 am – 5 pm PT)

Email: support@ibabylabs.com

Website: <https://ibabylabs.com>

6 FCC Caution

This device complies with part 15 of the FCC Rules. Operation is subject to the following two conditions: (1) This device may not cause harmful interference, and (2) this device must accept any interference received, including interference that may cause undesired operation.

FCC warning:

Any Changes or modifications not expressly approved by the party responsible for compliance could void the user's authority to operate the equipment.

Note: This equipment has been tested and found to comply with the limits for a Class B digital device, pursuant to part 15 of the FCC Rules. These limits are designed to provide reasonable protection against harmful interference in a residential installation. This equipment generates uses and can radiate radio frequency energy and, if not installed and used in accordance with the instructions, may cause harmful interference to radio communications. However, there is no guarantee that interference will not occur in a particular installation. If this equipment does cause harmful interference to radio or television reception, which can be determined by turning the equipment off and on, the user is encouraged to try to correct the interference by one or more of the following measures:

- Reorient or relocate the receiving antenna.
- Increase the separation between the equipment and receiver.
- Connect the equipment into an outlet on a circuit different from that to which the receiver is connected.
- Consult the dealer or an experienced radio/TV technician for help.

This equipment complies with FCC radiation exposure limits set forth for an uncontrolled environment. This equipment should be installed and operated with minimum distance 20cm between the radiator & your body.