

WiFi and Bluetooth® Portable Stereo Speaker

Haut-parleur portable Wifi et Bluetooth®

iLuv®

Inspired in New York. Styled by iLuv®.

Aud™ Air

Quick Start Guide

Guide de démarrage rapide
快速入门指南

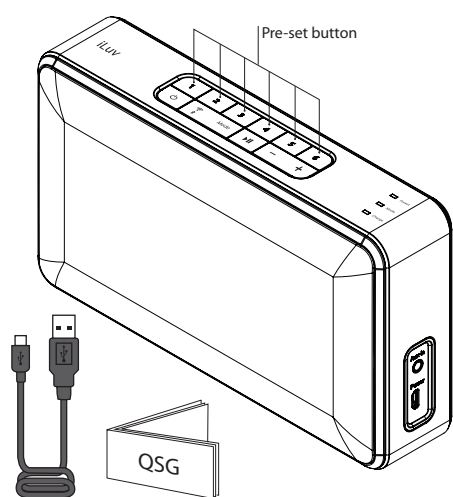

1. Click 'Mode' button to select Bluetooth

- Click 'Mode' button to select Bluetooth
- Click 'Mode' button to select Bluetooth
- Click 'Mode' button to select Bluetooth
 - Mode light will flash in blue quickly
 - Mode light will flash in blue quickly
 - Mode light will flash in blue quickly
- Hold button down for 3 seconds for manual pairing
- Hold button down for 3 seconds for manual pairing
- Hold button down for 3 seconds for manual pairing
- Set up from mobile device
- Set up from mobile device
- Set up from mobile device
- Set up from mobile device
 - Go to settings
 - Turn on Bluetooth
 - Go to settings
 - Turn on Bluetooth
 - Go to settings
 - Turn on Bluetooth
- Scan for and select 'iLuv Aud Air'
 - Scan for and select 'iLuv Aud Air'
 - Scan for and select 'iLuv Aud Air'
 - Scan for and select 'iLuv Aud Air'
- When Aud Air is paired, Mode light will be blue.
- When Aud Air is paired, Mode light will be blue.
- When Aud Air is paired, Mode light will be blue.

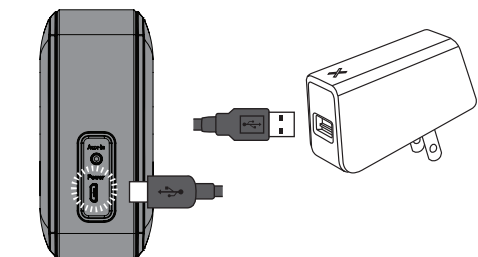

- Bluetooth effective range : 33 ft (10 m)
- Bluetooth effective range : 33 ft (10 m)
- Bluetooth effective range : 33 ft (10 m)
- Bluetooth effective range : 33 ft (10 m)

1. Click 'Mode' button to select Aux in

- Click 'Mode' button to select Aux in
- Click 'Mode' button to select Aux in
- Click 'Mode' button to select Aux in
 - Mode indicator will blink yellow
 - Mode indicator will blink yellow
 - Mode indicator will blink yellow
- When Aux Cable is plugged in, Mode light will be solid yellow
- When Aux Cable is plugged in, Mode light will be solid yellow
- When Aux Cable is plugged in, Mode light will be solid yellow



1. Power on / Power on / Power on / Power on

- Press Power button for 2 seconds
 - Press Power button for 2 seconds
 - Press Power button for 2 seconds
 - Press Power button for 2 seconds
 - Power LED (red) will be on
 - Power LED (red) will be on
 - Power LED (red) will be on
 - Power LED (red) will be on
- There will be a voice prompt "Ready"
 - There will be a voice prompt "Ready"
 - There will be a voice prompt "Ready"
 - There will be a voice prompt "Ready"
 - Default mode is Wi-Fi
 - Voice prompt: Wi-Fi Mode
 - Voice prompt: Wi-Fi Mode
 - Voice prompt: Wi-Fi Mode



1. Click 'Mode' button to select Wi-Fi

- Click 'Mode' button to select Wi-Fi
- Click 'Mode' button to select Wi-Fi
- Click 'Mode' button to select Wi-Fi
 - Follow initial set up guideline
 - Follow initial set up guideline
 - Follow initial set up guideline
 - Follow initial set up guideline
- Once Wi-Fi is set up, and power is turned on, it automatically connects to Wi-Fi.
- Once Wi-Fi is set up, and power is turned on, it automatically connects to Wi-Fi.
- Once Wi-Fi is set up, and power is turned on, it automatically connects to Wi-Fi.
 - Mode LED (green)
 - Mode LED (green)
 - Mode LED (green)
 - Mode LED (green)
 - Flashes during search
 - Flashes during search
 - Flashes during search
 - Flashes during search
 - Lit steady green after connected to Wi-Fi
 - Lit steady green after connected to Wi-Fi
 - Lit steady green after connected to Wi-Fi
 - Lit steady green after connected to Wi-Fi
- Voice prompt: Wi-Fi connected
 - Voice prompt: Wi-Fi connected
 - Voice prompt: Wi-Fi connected
 - Voice prompt: Wi-Fi connected



1. Connect your mobile device to Wi-Fi network

- Connect your mobile device to Wi-Fi network
- Connect your mobile device to Wi-Fi network
- Connect your mobile device to Wi-Fi network
- Download the free Aud Air app from the app store
 - Download the free Aud Air app from the app store
 - Download the free Aud Air app from the app store
 - Download the free Aud Air app from the app store
- Open the app
 - Open the app
 - Open the app
 - Open the app
- Select 'Add Device' button
 - Select 'Add Device' button
 - Select 'Add Device' button
 - Select 'Add Device' button
- Please make sure your Aud Air device is powered and on the same network as your phone or tablet. If not, please tap the "Add Device" button to configure your device to your Wi-Fi network.
 - Please make sure your Aud Air device is powered and on the same network as your phone or tablet. If not, please tap the "Add Device" button to configure your device to your Wi-Fi network.
 - Please make sure your Aud Air device is powered and on the same network as your phone or tablet. If not, please tap the "Add Device" button to configure your device to your Wi-Fi network.
 - Please make sure your Aud Air device is powered and on the same network as your phone or tablet. If not, please tap the "Add Device" button to configure your device to your Wi-Fi network.
- Press the WPS (Wi-Fi Protected Setup) button on Aud Air to configure network.
 - Press the WPS (Wi-Fi Protected Setup) button on Aud Air to configure network.
 - Press the WPS (Wi-Fi Protected Setup) button on Aud Air to configure network.
 - Press the WPS (Wi-Fi Protected Setup) button on Aud Air to configure network.



1. Click (Play/Pause) button to play or pause

- Click (Play/Pause) button to play or pause
- Click (Play/Pause) button to play or pause
- Click (Play/Pause) button to play or pause
- Click multifunction button again to pause
- Click multifunction button again to pause
- Click multifunction button again to pause
- Click VOLUME '+' button to increase volume
- Click VOLUME '+' button to increase volume
- Click VOLUME '+' button to increase volume
- Click VOLUME '-' button to decrease volume
- Click VOLUME '-' button to decrease volume
- Click VOLUME '-' button to decrease volume
- Hold VOLUME '+' button to select next track
- Hold VOLUME '+' button to select next track
- Hold VOLUME '+' button to select next track
- Hold VOLUME '-' button to move to previous track
- Hold VOLUME '-' button to move to previous track
- Hold VOLUME '-' button to move to previous track



6. Click 'Next' button on the app

- Click 'Next' button on the app
- Click 'Next' button on the app
- Click 'Next' button on the app
- Enter password for Wi-Fi network and press the 'Connect' button.
 - Enter password for Wi-Fi network and press the 'Connect' button.
 - Enter password for Wi-Fi network and press the 'Connect' button.
 - Enter password for Wi-Fi network and press the 'Connect' button.
- To set up the Wi-Fi network of your speaker system, please connect your phone with router running at 2.4GHz band (for dual band router, please connect with the router with SSID corresponding to 2.4GHz)
 - To set up the Wi-Fi network of your speaker system, please connect your phone with router running at 2.4GHz band (for dual band router, please connect with the router with SSID corresponding to 2.4GHz)
 - To set up the Wi-Fi network of your speaker system, please connect your phone with router running at 2.4GHz band (for dual band router, please connect with the router with SSID corresponding to 2.4GHz)
 - To set up the Wi-Fi network of your speaker system, please connect your phone with router running at 2.4GHz band (for dual band router, please connect with the router with SSID corresponding to 2.4GHz)
- When it is failed, there is message 'FAILED TO CONNECT WI-FI'
 - When it is failed, there is message 'FAILED TO CONNECT WI-FI'
 - When it is failed, there is message 'FAILED TO CONNECT WI-FI'
 - When it is failed, there is message 'FAILED TO CONNECT WI-FI'
- Select 'Alternative Way to Set up' button
 - Select 'Alternative Way to Set up' button
 - Select 'Alternative Way to Set up' button
 - Select 'Alternative Way to Set up' button
- Go to your phone's Wi-Fi setting and select your new Aud Air. Look for the device name you see on the product.
 - Go to your phone's Wi-Fi setting and select your new Aud Air. Look for the device name you see on the product.
 - Go to your phone's Wi-Fi setting and select your new Aud Air. Look for the device name you see on the product.
 - Go to your phone's Wi-Fi setting and select your new Aud Air. Look for the device name you see on the product.
- Come back to this app
 - Come back to this app
 - Come back to this app
 - Come back to this app
- Select 'Next' menu
 - Select 'Next' menu
 - Select 'Next' menu
 - Select 'Next' menu
- Please select network to connect and enter password of the Wi-Fi network
 - Please select network to connect and enter password of the Wi-Fi network
 - Please select network to connect and enter password of the Wi-Fi network
 - Please select network to connect and enter password of the Wi-Fi network
- Voice prompt: Wi-Fi connected
 - Voice prompt: Wi-Fi connected
 - Voice prompt: Wi-Fi connected
 - Voice prompt: Wi-Fi connected
- Select 'Done' menu
 - Select 'Done' menu
 - Select 'Done' menu
 - Select 'Done' menu



1. Each number keys from 1 to 6 are pre-set to playlists

- Each number keys from 1 to 6 are pre-set to playlists
- Each number keys from 1 to 6 are pre-set to playlists
- Each number keys from 1 to 6 are pre-set to playlists
- Connect Aud Air to internet
 - Connect Aud Air to internet
 - Connect Aud Air to internet
 - Connect Aud Air to internet
- Set up pre-set through the App
 - Set up pre-set through the App
 - Set up pre-set through the App
 - Set up pre-set through the App
- Search internet radio station you want to pre-set
 - Search internet radio station you want to pre-set
 - Search internet radio station you want to pre-set
 - Search internet radio station you want to pre-set
- Click Pre-set button on the right side of station list
 - Click Pre-set button on the right side of station list
 - Click Pre-set button on the right side of station list
 - Click Pre-set button on the right side of station list
- Select number out of 1-6 for pre-set
 - Select number out of 1-6 for pre-set
 - Select number out of 1-6 for pre-set
 - Select number out of 1-6 for pre-set
- Press number key to play the pre-set playlist
 - Press number key to play the pre-set playlist
 - Press number key to play the pre-set playlist
 - Press number key to play the pre-set playlist



1. Press 'Mode' button to toggle the mode among Bluetooth, Aux in, and WiFi.

- Press 'Mode' button to toggle the mode among Bluetooth, Aux in, and WiFi.
 - Press 'Mode' button to toggle the mode among Bluetooth, Aux in, and WiFi.
 - Press 'Mode' button to toggle the mode among Bluetooth, Aux in, and WiFi.
 - Bluetooth / Bluetooth / Bluetooth / Bluetooth
 - Mode light will flash in blue while it searches the mobile device.
 - Mode light will flash in blue while it searches the mobile device.
 - Mode light will flash in blue while it searches the mobile device.
 - When it is connected, the mode light will be solid blue.
 - When it is connected, the mode light will be solid blue.
 - When it is connected, the mode light will be solid blue.
 - When it is connected, the mode light will be solid blue.
 - When switching to BT mode, voice prompt: Bluetooth Mode, Bluetooth Discovering, Pairing successful
 - When switching to BT mode, voice prompt: Bluetooth Mode, Bluetooth Discovering, Pairing successful
 - When switching to BT mode, voice prompt: Bluetooth Mode, Bluetooth Discovering, Pairing successful
 - When switching to BT mode, voice prompt: Bluetooth Mode, Bluetooth Discovering, Pairing successful
 - Aux in / Aux in / Aux in / Aux in
 - Mode light will be solid yellow
 - Mode light will be solid yellow
 - Mode light will be solid yellow
 - When switch to Aux-in mode, voice prompt: Aux-in Mode
 - When switch to Aux-in mode, voice prompt: Aux-in Mode
 - When switch to Aux-in mode, voice prompt: Aux-in Mode
 - When switch to Aux-in mode, voice prompt: Aux-in Mode
- Wi-Fi / Wi-Fi / Wi-Fi / Wi-Fi
 - Mode light will blink in green while it searches for the Wi-Fi network.
 - Mode light will blink in green while it searches for the Wi-Fi network.
 - Mode light will blink in green while it searches for the Wi-Fi network.
 - Mode light will blink in green while it searches for the Wi-Fi network.
 - Mode light will be solid green when it is connected.
 - Mode light will be solid green when it is connected.
 - Mode light will be solid green when it is connected.
 - Mode light will be solid green when it is connected.



1. Open Device List from app

- Open Device List from app
- Open Device List from app
- Open Device List from app
- Click set up button
 - Click set up button
 - Click set up button
 - Click set up button
- Select 'Rename' from the menu
 - Select 'Rename' from the menu
 - Select 'Rename' from the menu
 - Select 'Rename' from the menu
- Select preferred name or select 'Custom' for your own name
 - Select preferred name or select 'Custom' for your own name
 - Select preferred name or select 'Custom' for your own name
 - Select preferred name or select 'Custom' for your own name

WARNING: Changes or modifications to this unit not expressly approved by the party responsible for compliance could void the user's authority to operate the equipment.

COMPLIES WITH FCC PART 15 RULES / COMPLIES WITH 21 CFR 104.101 / COMPLIES WITH RSS-210 OF INDUSTRY CANADA

This Class B digital apparatus complies with CAN ICES-3 (B)/NMB-3(B) / Cet appareil numérique de la classe B est conforme à la norme CAN ICES-3 (B)/NMB-3(B).

The device complies with Part 15 of the FCC Rules. Operation is subject to the following two conditions: (1) this device may not cause harmful interference, and (2) this device must accept any interference received, including interference that may cause undesired operation.

NOTE: This equipment has been tested and found to comply with the limits for a Class B digital device, pursuant to Part 15 of the FCC Rules. Operation is subject to the following two conditions: (1) this device may not cause harmful interference, and (2) this device must accept any interference received, including interference that may cause undesired operation. However, there is no guarantee that interference will not occur in a particular installation. If this equipment does cause harmful interference to radio or television reception, which can be determined by turning the equipment off and on, the user is encouraged to try to correct the interference by one or more of the following measures:

- Reorient or relocate the receiving antenna.
- Increase the separation between the equipment and receiver.
- Connect the equipment into an outlet on a circuit different from that to which the receiver is connected.
- Consult the dealer or an experienced radio/TV technician for help.