

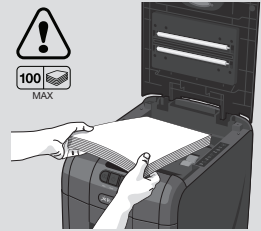

AUTO+100X&100M™ SHREDDERS

start here
démarrez ici
starten sie hier
iniziare qui
begin hier
empieza aquí
comece aqui
buradan başlayın
ξεκινήστε εδώ
start her
aloita tästä
start her
börja här
rozpocznij tutaj
začňte zde
kezdés itt
начинать здесь

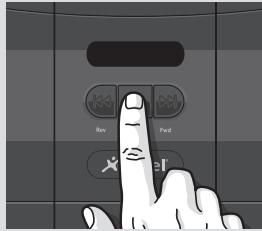

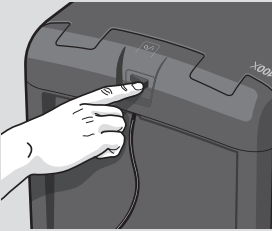
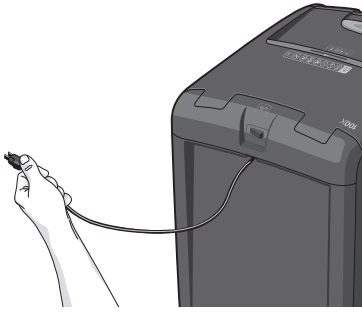

2min

Z
Z Z

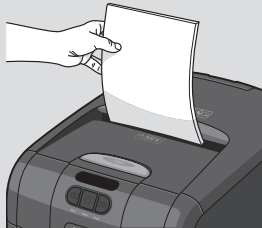

1

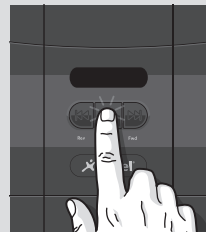
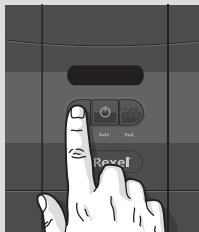

2

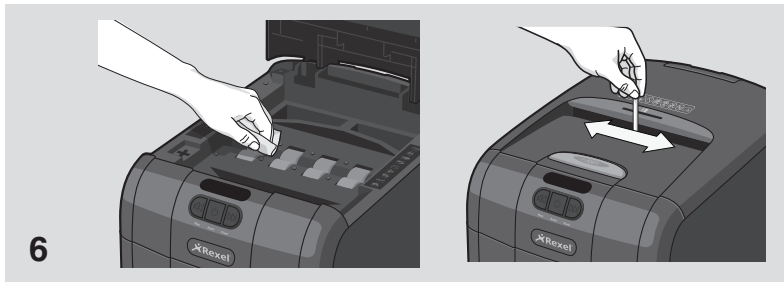
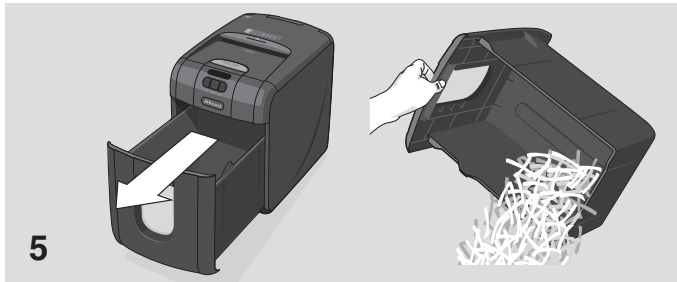
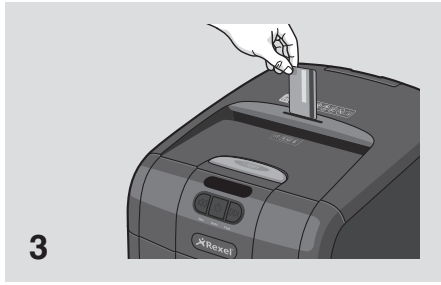

AUTO+ SHREDDERS

FEATURE COMPARISON	LIGHT USE			EVERYDAY USE				HEAVY USE			
Model	60X	80X	100X	100M	200X	300X	300M	500X	500M	750X	750M
Security level	P3		P3	P5	P3	P3	P5	P4	P5	P4	P5
Bin Capacity (sheets)	100	150	150	280	325	450	670	850	1100	1250	1400
Users	1		1-2		1-5	5-10		10-20		20+	
HANDS FREE SHREDDING											
Sheet Capacity	60	80	100	100	200	250	250	500	500	750	750
Staples and Paper Clips	✓	✓	✓	✓	✓	✓	✓	✓	✓	✓	✓
Intelligent Jam Clearance		✓	✓	✓	✓	✓	✓	✓	✓	✓	✓
Lockable Chamber					Optional	✓	✓	✓	✓	✓	✓
MANUAL FEED SHREDDING											
Manual feed sheet capacity	5	6	6	6	7	8	8	10	9	12	10
Jam Free Technology						✓	✓	✓	✓	✓	✓
Bin Capacity (Litres)	15L	20L	26L	26L	32L	40L	40L	80L	80L	115L	115L
Shreds Credit Cards	✓	✓	✓	✓	✓	✓	✓	✓	✓	✓	✓
Intelligent™ Power Save 		✓	✓	✓	✓	✓	✓	✓	✓	✓	✓
Bin Full Indicator		✓	✓	✓	✓	✓	✓	✓	✓	✓	✓
Illuminated Status Symbols			✓	✓	✓	✓	✓	✓	✓	✓	✓
Shreds CDs					✓	✓	✓	✓	✓	✓	✓
Castors for Mobility					✓	✓	✓	✓	✓	✓	✓
Intelligent™ SelfOil™								✓	✓	✓	✓
Continuous operation								✓	✓	✓	✓



AUTO+100X&100M™ SHREDDERS

GB instruction manual	6
F manuel d'utilisation	12
D bedienungsanleitung	18
I manuale d'istruzioni	24
NL gebruiksaanwijzing	30
E manual de instrucciones	36
P manual de instruções	42
TR kullanım kılavuzu	48
GR οδηγίες	54
DK brugsvejledning	60
FI käyttöopas	66
NO bruksanvisning	72
S bruksanvisning	78
PL instrukcja obsługi	84
CZ návod k obsluze	90
H használati útmutató	96
RUS руководство по эксплуатации	102



autofeed technology

The Auto+ 100X/100M has been designed to automatically shred up to 100 sheets from the auto-feed chamber and up to 6 sheets through the manual feed slot. The auto-feed mechanism has been designed to handle paper fastened with staples and paper clips and to only pull a few sheets of paper into the cutting mechanism to minimise the risk of paper jams.















To guard against injury, the following basic safety precautions must be observed in the set-up of this product.

- Ensure the machine is plugged into an easily accessible power outlet, and ensure the cable is not likely to trip up a passer by.
- Any attempt to repair this unit by unqualified personnel will invalidate the warranty. Please return to supplier.
- Unplug your shredder before moving it or when it is not in use for an extended period of time.
- Do not operate with a damaged power supply cord or plug, after it malfunctions, or after it has been damaged in any manner.
- Do not overload electrical outlets beyond capacity as this can result in fire or electrical shock.
- The socket-outlet should be installed near the equipment and shall be easily accessible.
- Do not alter the attachment plug. The plug is configured for the appropriate electrical supply.
- Do not use near water.
- Do not use aerosol dusters or cleaners.
- Do NOT spray anything into the shredder.
- Do NOT load the autofeed chamber with junk mail, magazines, bound documents etc.

Although this shredder has been designed to comply with UL 60950-1 EN 60950-1 safety standards including the “probe accessibility tests”, do not operate the shredder near children or pets.

There is a ‘cross shaped’ integral safety device, located on the left of the internal loading bay, which is designed to prevent the shredder from operating when the loading door is open. You must NOT under any circumstances tamper with with this switch, add any object into the cross-shaped interlock switch other than the interlock actuator, as to do so would activate the cutting blades.

warning symbols

-  Safety First 
-  This means you should be careful because long hair can become entangled in the cutting head.
-  This means be careful of ties and other loose clothing which could become entangled in the cutting head.
-  This means be careful of loose jewellery which could become entangled in the cutting head.
-  This means don't reach into the feed opening of the cutting head.
-  This means keep children away from shredder.
-  This means no aerosols.
-  6  Sheet capacity of manual feed entry slot.
-  This means the shredder can accept small staples.
-  This means the shredder can accept small paperclips.
-  This means no oil lubrication, use Rexel oil sheets only.

control panel and indicators

-  Reverse  Auto  Continuous Jam Boost

 **Paper Loading Door/Bin Door Open or Bin Full indicator –**

This means either:

- Loading door is open
- Bin is open
- Bin is full



Cool Down indicator – This means the machine is cooling down.



Paper jam indicator – This means there is a paper jam in the auto feed chamber.

If this symbol is flashing the shredder is attempting to clear a paper jam automatically.

If this symbol is permanently illuminated red please follow the instructions under 'Rare Occasion of Jamming'.

Auto+ 100X/100M shredding capability

Auto+ 100X/100M CAN shred the following:



- 100 sheets
- Stapled paper, 25mm within the corner
- 26/6 and 24/6 or smaller staples
- Small sized paper loaded centrally



- 100 sheets
- Paper clip paper, 25mm within the corner (100M through manual feed slot ONLY)
- Capable of shredding small/medium paper clips (max. wire thickness = 0.9 mm)
- >80/100gsm paper (through manual feed slot ONLY)



- A3 folded in half max. 2 sheets
- 100 sheets
- 80 gsm paper
 - A4 - 210mm x 297mm
 - A5 - 148mm x 210mm
 - A3 single sheet folded in half to make A4

Auto+ 100X/100M CAN shred (through the manual feed slot):



Thick paper or card.



Multiple folded sheets (e.g. A3 sheets folded in half).



Unopened mail (e.g. junk mail).



Glossy paper or a sheet covered with print on both sides.

Auto+ 100X/100M CANNOT shred the following:



Heavy duty staples. Check the staple leg length is not greater than 6mm.



Large clips. Check the length of the paperclip is not longer than 32mm.



Plastic sheets, laminated documents, plastic folders.



Bulldog clips



Bound documents



Adhesive labels.



Magazines or other documents bound by multiple staples or clips.

1. operation

- 1 After unpacking the product, pull out the shredder bin. Remove and fit the recyclable paper bag (as per instructions printed on the bag).
- 2 Connect the shredder to mains supply.
- 3 Ensure the on/off button on the back of the machine is in the on position.
- 4 To commence shredding, press the central Auto button (⏻). This will illuminate the blue standby symbol on the auto button and sets the shredder into auto mode. You are now ready to shred.
- 5 Press the loading door button to open the loading door. Load up to 100 sheets at a time into the feed chamber. Do not fill above the 100 MAX level, this could damage the shredder.
- 6 Close the loading door without pressing the loading door button. The shredder will now start automatically.
- 7 If there is still paper in the Autofeed tray after first attempt, open and re-close paper loading door a second time.
- 8 If you only have up to 6 sheets to shred, you can use the manual feed entry slot, provided the auto feed chamber is empty.
- 9 If the shredder is left in auto mode for more than 2 minutes without being used, it will automatically turn to sleep mode to save power.
- 10 The shredder will automatically operate from standby mode when paper is inserted into the manual feed entry slot. Opening either the loading door, emptying the bin or pressing any button will return the product to auto mode.

2. reverse function

- 1 Should you wish to reverse paper out whilst shredding, a reverse button (⏮) has been fitted for your convenience. The jam indicator will illuminate.
- 2 To resume shredding, turn the shredder on using the ON/OFF switch at the rear of the shredder. Return the switch to the auto position (⏻).

3. credit card shredding

Auto+ 100X can shred credit cards, not CDs or DVDs. Switch the shredder to auto mode and insert the credit card into the opening on top of the manual feed entry slot. Rexel encourages customers to recycle shredded paper. Please note that shredded paper can not be recycled if mixed with credit card shards. If recycling, please separate shredded paper and credit cards.

Rexel encourages customers to recycle shredded paper.

Please note that shredded paper cannot be recycled if mixed with credit card shards. If recycling, please separate shredded paper and credit cards.

bin or loading door open safety function

As a safety precaution, if the bin or loading door is opened during shredding, the shredder will stop and the bin full indicator will illuminate (🔴).

over heating

If the Auto+ 100X/100M is used continuously for over 10 minutes the shredder may overheat and the cool down indicator will flash red (🔥). Please allow the shredder to cool down. When the shredder is ready to be used the thermometer symbol will no longer illuminate. If the shredder needs to cool down while shredding, no action is needed. The shredder will automatically restart shredding paper once it has cooled down after periods of continuous use. All you need to do is ensure paper is loaded into the chamber and the bin is empty when the machine is cooling down.

4. self-cleaning cutters

After emptying and replacing a full bin, the shredder will run in forward for 4 seconds, stop for 2 seconds and then reverse for 4 seconds to clear away any remaining paper from the cutter mechanism. This unique 'self-cleaning' mechanism is additional jam prevention technology from Rexel.

rare occasions of jamming

If after this auto jam clearance cycle the shredder still has a paper jam, it will stop and the jam indicator illuminate (⚠️). Try clearing the jam using the reverse (⏪) and continuous jam boost (⏩) buttons. If this is unsuccessful, open the loading door, remove the remaining stack of paper, then pull the jammed paper free of the cutting mechanism.

automatic jam clearance

In the unlikely event of the shredder jamming, the Auto+ 100X and 100M will automatically reverse and forward the engine three times to clear a jam. During this operation the Paper Jam indicator will flash (⚠️).

5. bin full

The shredder will not function when the bin is full and the bin full symbol (🗑️) is illuminated. You should empty the bin.

- Pull open the bin slowly to empty.
- Push the empty bin back into place and press the auto button to resume shredding.

lubrication of the shredder

Only use Rexel Oil Sheets (2101948 & 2101949) to lubricate. ACCO Brands accepts no liability for product performance or safety when other types or brands of lubricants are used on any part(s) of this machine.

service

We recommend these machines are serviced every 6 to 12 months by a Rexel service engineer – see back of this booklet for the contact details of your local service centre and for enquiries about maintenance contracts.

6. maintenance

The rollers on the auto-feed mechanism may become dirty over time, please wipe clean with a dry cloth to maintain maximum product performance.

The auto-start infra-red sensor, located in the paper feed entry-slot, can occasionally become covered in paper-dust causing the shredder to run despite no paper being fed into the machine. Switch the shredder off at the rear of the machine and carefully clean the sensor using a cotton-swab.

technical specifications shredder accessories

Rexel Auto+ 100X and 100M

Sheet capacity: Manual feed slot	6 sheets (80gsm)
Sheet capacity: Autofeed chamber	100 sheets (80gsm)
Auto shutdown	After 2 minutes
Duty Cycle	5 min ON / 30 min OFF
Run time from cold	10 minutes
Volts / Hz	230V / 50Hz
Amperage	1.2 Amps
Motor Watts	100X: 200 Watts 100M: 350 Watts

We recommend that a paper waste sack for recycling shredded paper is used on all models.

Accessory	Part Number	Box Quantity
Recycling Waste Sack	1765031EU	20 sacks
Oil Sheets	2101949	20

guarantee

ACCO Brands Europe (ACCO) warrants its products and their parts against defects in materials and workmanship under normal use for a period of 24 months from the original date of purchase.

During this period we will repair or replace a defective product or part subject to the following warranty conditions:

The warranty applies only to defects in materials and workmanship under normal use and does not extend to damage to the Product or parts which result from:-

- alteration, repair, modification or service carried out by anyone other than an authorised ACCO service centre.
- accident, neglect, abuse or misuse owing to failure to comply with the normal operating procedures for a product of this type.

Depending on the diagnostics and the model type, we will either arrange a service call by an engineer or arrange with you return of the product to ACCO. ACCO will, at its discretion, in accordance with law, either

- repair the shredder using either new or refurbished parts, or
- replace the shredder with a new or refurbished shredder that is equivalent to the shredder being replaced.

Nothing in this Warranty shall have the effect of excluding the liability of ACCO in respect of death and personal injury caused by the negligence of ACCO. This Warranty is offered (subject to these terms and conditions) in addition to, and does not affect, your statutory rights.

If you experience a technical fault, please contact the ACCO customer helpdesk (see back cover)

Additional Guarantee

ACCO Brands guarantees the cutting blades of the shredder to be free from defects in material and workmanship for 10 years from the date of purchase by the original consumer.

*Please note that the cutter blades will be progressively worn down by shredding fastened sheets (staples and paperclips) - this is not covered in the warranty. The Auto+ 100X has been design to shred up to 50 credit cards in the standard 2 year warrant period. Any excessive credit card shredding will invalidate the extended cutter warranty. Auto+ 100X has NOT been designed to shred CDs or DVDs, any attempt to do so will invalidate this warranty.

These conditions shall in all respects be governed and construed in accordance with English Law and subject to the exclusive jurisdiction of the English Courts.

Australian Customers

This guarantee does not apply to Australian customers.
See warranty on page 110.

service addresses

- A ACCO Deutschland GmbH & Co. KG,**
Arnoldstrasse 5, 73614 Schorndorf, Germany
Tel: +49 7181 887 120 Fax: +49 7181 887 198 info.de@acco.com
- AUS Pelikan Artline Pty Ltd,**
2 Coronation Avenue, Kings Park, NSW, Australia 2148
Tel: +61 2 9674 9000 Fax: +61 2 9674 0910 custsupport@pelikanartline.com.au
- B ACCO Brands Benelux B.V.,**
Peppelkade 64, 3992AK Houten, Nederland/Les Pays-Bas
Tel: 0800-73362 Fax: 02-4140784 info@accobenelux.be www.accobenelux.be
- BD ACCO Brands Asia Pte Ltd,**
47 Ayer Rajah Crescent, #05-08/17, Singapore 139947
Tel: +65 6776 0195 Fax: +65 6779 1041 webmaster@accobrandsasia.com
- CH ACCO Brands Schweiz GmbH,**
Gewerbstrasse 8, CH-8212 Neuhausen a. Rheinfall
Tel: +41 (0)52 674 01 74 Fax: +41 (0)52 674 01 75 info.ch@acco.com
- CZ XERTEC a.s.,**
Kloknerova 2278/24 (vchod z ulice Košířova, budova CeWe Color - Fotolab), 148 00 Praha 4 - Chodov
Tel: 225 004 411 Fax: 225 004 162 servis@xertec.cz http://www.xertec.cz
- D ACCO Deutschland GmbH & Co. KG,**
Arnoldstrasse 5, 73614 Schorndorf, Germany
Tel: +49 7181 887 120 Fax: +49 7181 887 198 info.de@acco.com
- DK ACCO Brands Nordic AB,**
Makadamgatan 5, 254 64 Helsingborg, Sweden
Tel: +46 42 38 36 00 Fax: +46 42 38 36 10 service.nordic@acco.com
- E ACCO Brands Iberia SL,**
P Isaac Peral 19, 28820 Coslada (Madrid)
Tel: 902 500 182 ext. 2 Fax: 91 309 6412 servicio.tecnico@acco.com
- EST ACCO Brands Nordic AB,**
Makadamgatan 5, 254 64 Helsingborg, Sweden
Tel: +46 42 38 36 00 Fax: +46 42 38 36 10 service.nordic@acco.com
- F Acco Brands France SAS,**
Service après-vente, ZAC Excellence 2000, 6 rue Robert Schuman, 21800 Chevigny Saint Sauveur
Tel: +33 3 80 68 60 30 Fax: +33 3 80 68 60 49 contact@vms.fr
- GB ACCO Service Division,**
Hereward Rise, Halesowen, West Midlands, B62 8AN
Tel: 0845 658 6600 Fax: 0870 421 5576 www.acco.co.uk/service
- H OPI Customer Service**
Tel.: +359 2 80 99 166 Exportee@accoeu.local
- I ACCO Brands Italia Srl,**
Servizio post-vendita, Via Oberdan, 33, 28070 Tornaco (NO)
Tel: 800-87-86-16 Fax: 0321-88-01-27 servizio.clienti@acco.com
- IND ACCO Brands Asia Pte Ltd,**
47 Ayer Rajah Crescent, #05-08/17, Singapore 139947
Tel: +65 6776 0195 Fax: +65 6779 1041 webmaster@accobrandsasia.com
- IRL ACCO-Rexel Ltd,**
Clonshaugh Business & Technology Park, Clonshaugh, Dublin 17, Ireland
Tel: 01 816 4346 Fax: 01 816 4302 admin@accoservice.eu www.accorexel.ie

- IS ACCO Brands Nordic AB,**
Makadamgatan 5, 254 64 Helsingborg, Sweden
Tel: +46 42 38 36 00 Fax: +46 42 38 36 10 service.nordic@acco.com
- JPN GBC-Japan K.K.,**
14F Harmony Tower, 1-32-2 Honcho, Nakano-ku, Tokyo 164-8721
Tel: (81)-03-5351-1801 Fax: (81)-03-5351-1831 serv@gbc-japan.co.jp www.gbc-japan.co.jp
- LT ACCO Brands Nordic AB,**
Makadamgatan 5, 254 64 Helsingborg, Sweden
Tel: +46 42 38 36 00 Fax: +46 42 38 36 10 service.nordic@acco.com
- LUX ACCO Brands Benelux B.V.,**
Peppelkade 64, 3992AK Houten, Nederland/Les Pays-Bas
Tel: 0800-21132 Fax: 02-4140784 info@accobenelux.be www.accobenelux.be
- LV ACCO Brands Nordic AB,**
Makadamgatan 5, 254 64 Helsingborg, Sweden
Tel: +46 42 38 36 00 Fax: +46 42 38 36 10 service.nordic@acco.com
- N ACCO Brands Nordic AB,**
Makadamgatan 5, 254 64 Helsingborg, Sweden
Tel: +46 42 38 36 00 Fax: +46 42 38 36 10 service.nordic@acco.com
- NL ACCO Brands Benelux B.V.,**
Peppelkade 64, 3992AK Houten, Nederland/Les Pays-Bas
Tel: 030-6346060 Fax: 030-6346070 info@accobenelux.nl www.accobenelux.nl
- P ACCO Brands Iberia SL,**
P Isaac Peral 19, 28820 Coslada (Madrid)
Tel: 902 500 182 ext. 2 Fax: 91 309 6412 servicio.tecnico@acco.com
- PAK ACCO Brands Asia Pte Ltd,**
47 Ayer Rajah Crescent, #05-08/17, Singapore 139947
Tel: +65 6776 0195 Fax: +65 6779 1041 webmaster@accobrandsasia.com
- PL ACCO Polska Sp. z o.o.,**
Al. Jerozolimskie 184, 02-486 Warszawa
Tel. +48 22 570-18-29 fax +48 22 570-18-33 www.acco.pl
- RUS Представительство компании «АНКО Дойчланд ГМБХ и КО. КГ»,**
Россия 105005, Москва, Денисовский пер., д.26
Тел: (495) 933-51-63 Факс: (495) 933-51-64
- S ACCO Brands Nordic AB,**
Makadamgatan 5, 254 64 Helsingborg, Sweden
Tel: +46 42 38 36 00 Fax: +46 42 38 36 10 service.nordic@acco.com
- SK XERTEC a.s.,**
Kloknerova 2278/24 (vchod z ulice Koštířova, budova CeWe Color - Fotolab), 148 00 Praha 4 -
Chodov
Tel: 225 004 411 Fax: 225 004 162 servis@xertec.cz http://www.xertec.cz
- UA DataLux Distribution Company,**
03151, Киев, Очаковская, 5/6, оф. 110.3
Tel: + 380 (44) 498 4956 ext. 2324 Fax: + 380 (44) 275 9999
- ZA Rexel Office Products (PTY) Ltd,**
Crusher Road, Crown Ext.3, PO Box 102, Crown Mines, Johannesburg 2025, South Africa
Tel: +27 (0)11 226 3300 service@rexelsa.co.za

warranty (in Australia)

ACCO Australia warrants its products and their parts against defects in materials and workmanship under normal use for a period of 24 months from the original date of purchase (please retain proof of purchase). During this period we will repair or replace a defective product or part subject to the following warranty conditions:

The warranty applies only to defects in materials and workmanship under normal use and does not extend to damage to the Product or parts which result from:-

- Alteration, repair, modification or service carried out by anyone other than an authorised ACCO service centre.
- Accident, neglect, abuse or misuse owing to failure to comply with the normal operating procedures for a product of this type.

Nothing in this warranty shall have the effect of excluding the liability of ACCO in respect of death and personal injury caused by the negligence of ACCO. This Warranty is offered (subject to these terms and conditions) in addition to, and does not affect your rights and remedies under the Australian Consumer Law and other laws.

Our goods come with guarantees that cannot be excluded under the Australian Consumer Law. You are entitled to a replacement or refund for a major failure and for compensation for any other reasonably foreseeable loss or damage. You are also entitled to have the goods repaired or replaced if the goods fail to be of acceptable quality and the failure does not amount to a major failure.

For any questions relating to your warranty, please contact your local service agent.

Additional Guarantee

ACCO Australia guarantees the cutting blades of the shredder to be free from defects in material and workmanship for an extended warranty period from the date of purchase by the original consumer. Please refer to the table below for the cutter warranty period applicable to your shredder model.

Shredder Models	Extended Cutter Warranty Period
Style, Style+, V35WS, V30WS, Alpha	3
Auto+50, Auto+60	5
Promax V65WS, Promax V60WS, Prostyle, Prostyle+, RES1223, REX1023, REM723, SC170, CC175, Auto+80	7
V120, V125, P180CD, P185, RSS2030, RSX1630, RSS2232, RSX1632, RSM1130, Auto+100, Auto+175, Auto+200	10
RDS2250, RDX1850, RDSM750, RDM1150, RDS2270, RDX2070, RDSM770, RDM1170, Auto+250, Auto+300, Auto+500, Auto+750, RLS32, RLX20, RLM11, RLSM9, RLWX19, RLWX30, RLWSFM9, RLWM26, RLWX39, RLWS47, RLWX25, RLWS35	20

*Please note that the cutter blades will be progressively worn down by shredding fastened sheets (staples and paperclips)- this is not covered by this warranty. Excessive credit card and CD shredding will also invalidate the extended cutter warranty. Some shredder models are NOT designed to shred CDs. Any attempt to do so will invalidate the warranty.

How to Make a Claim

To make a claim under this warranty, contact the ACCO Australia Customer Service Team with your proof of original purchase handy:

ACCO Australia

Level 2, 8 Lord St
Botany NSW 2019

Ph: 1300 366 376

E: sales.au@acco.com

F: 1300 360 944

The customer service team member will advise whether your product should be repaired, replaced or returned and advise the next step for you to take. If the product is validated as still under warranty and deemed faulty, ACCO will bear costs involved with the warranty process. To claim expenses incurred in making a claim under this warranty, contact our Customer Service Team on the details above.

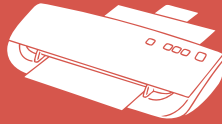

GBC Laminating / Plastifieuses / Laminiergeräte



Rexel Shredding / Destructeurs / Aktenvernichter



GBC Binding / Perforelieuses / Bindeggeräte

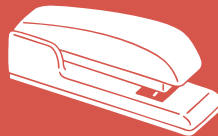

Rexel Stapling / Agrafage / Heftgeräte

www.accobrand.com