

# FEC MODEL FEC-PA1 CEILING POLE ADAPTER FOR PANASONIC

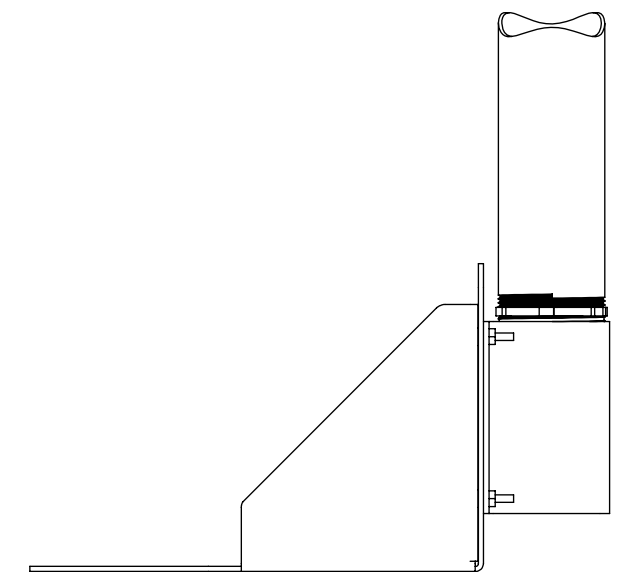

- PARTS INCLUDED IN KIT:**
- (1) ADAPTER BRACKET
  - (1) 1 1/2" NPT LOCK RING
  - (2) 6MM SET SCREWS
  - (1) 6MM HEX WRENCH
  - (4) 8-32 TRUSS HEAD SCREWS
  - (4) 8-32 NUTS WITH LOCKWASHER

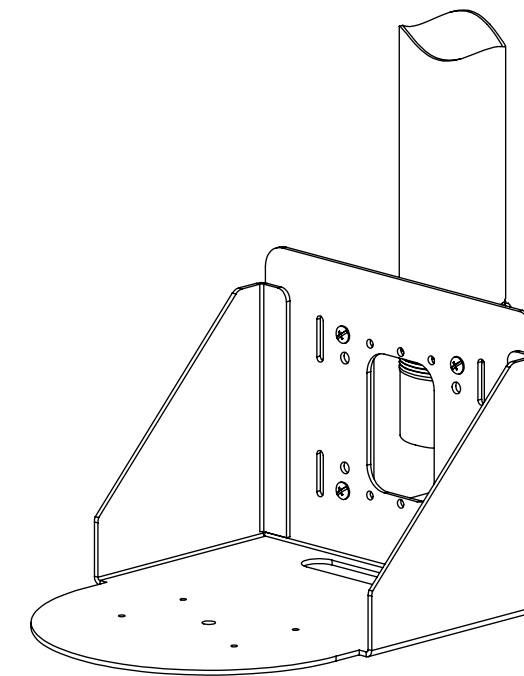
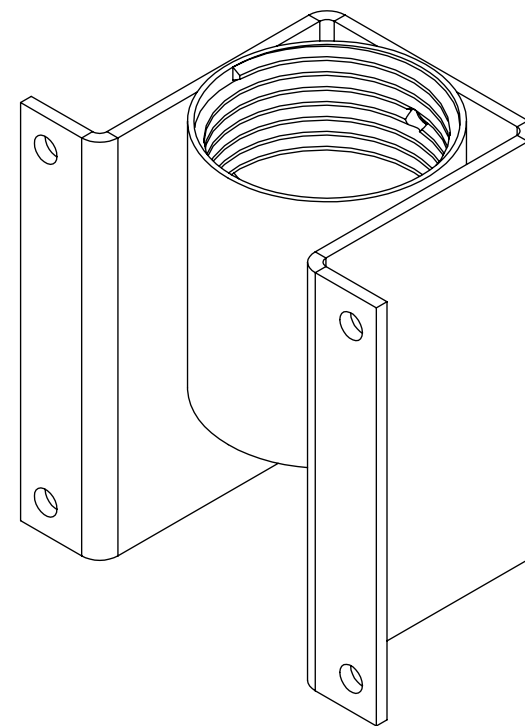

REFERENCE VIEWS SHOW GENERAL MOUNT IN UPRIGHT & INVERTED POSITIONS

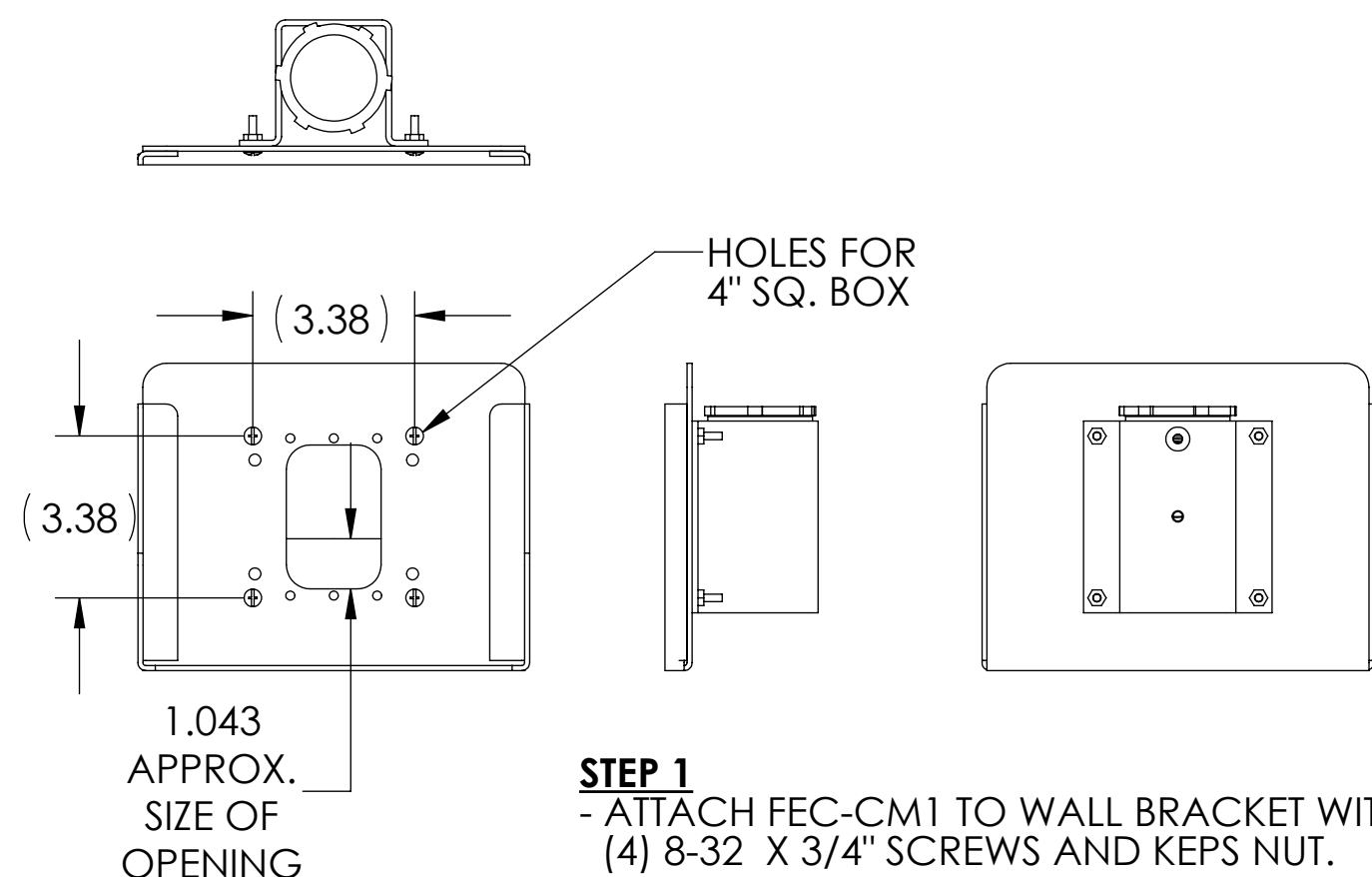

- STEP 1**
- ATTACH FEC-CM1 TO WALL BRACKET WITH (4) 8-32 X 3/4" SCREWS AND KEPS NUT.

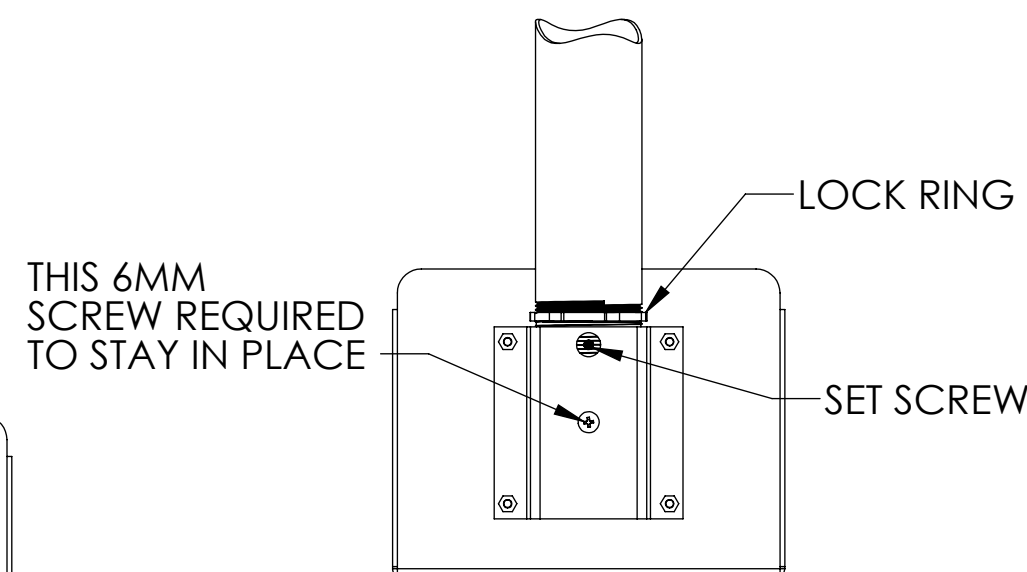

- STEP 2**
- THREAD PIPE ALL THE WAY INTO THE ADAPTER
  - RUN LOCK RING DOWN TO SECURE
  - TIGHTEN SET SCREW FIRMLY BUT DO NOT OVER TIGHTEN OVER TIGHTENING CAN CAUSE DAMAGE TO THE ITEM. THIS WILL GREATLY REDUCE SAFETY.

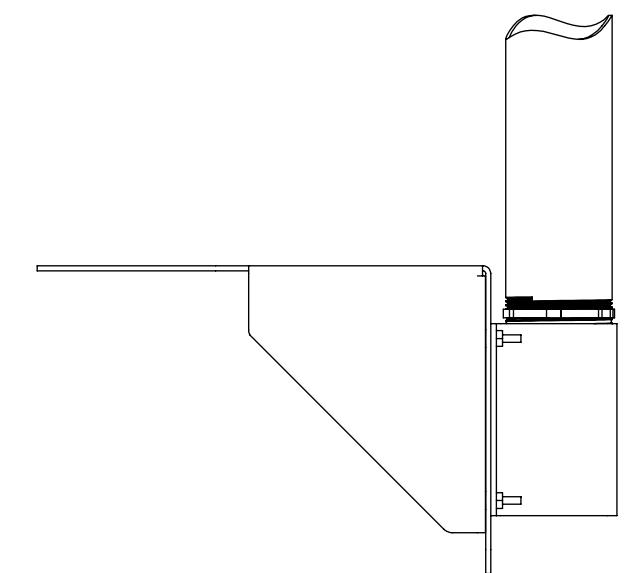
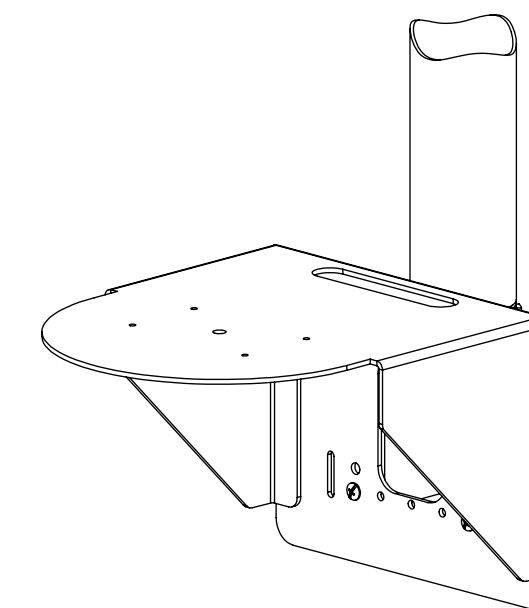

## SAFETY NOTE:

- **INSTALLER SUPPLIED SAFETY LANYARD MUST BE INSTALLED.**
- Before beginning the installation, it is very important to examine the unit for damage, defects and correct hardware.
- The Installation instructions must be read and entirely understood prior to install.
- It must be determined that the mounting surface is capable of supporting the mount and equipment.
- The Professional Installer must determine the proper way to attach the CEILING ADAPTER
- The installation of the mount and equipment is dependent on proper/secure attachment and is the responsibility of the installer.
- Please use only the hardware supplied with the unit or bolts of the correct size, making sure the hardware used is tightened properly for a secure installation.
- **Installer must supply and install a safety cable that attaches firmly to the PTZ CAMERA/MOUNT ASSEMBLY and make sure it is secured properly to a structural cross member!**
- **Installer supplied Safety lanyard must be used even where local codes do not require it.**
- If at anytime, a question arises regarding this installation (or regarding the safety or integrity of the projected use) cease the installation and either obtain the advice of another qualified installer or contact FEC.

## STEP 3

- INSTALLER SUPPLIED SAFETY LANYARD MUST BE USED EVEN WHERE LOCAL CODES DO NOT REQUIRE IT.
- FINISH INSTALLATION BY ATTACHING ANY REQUIRED CABLES, LINES OR ANY SECONDARY DEVICES AS REQUIRED PER MANUFACTURERS OR PROFESSIONAL INSTALLER'S INSTRUCTIONS.

## HARDWARE:

- (4) 8-32 X 3/4" LONG PHILLIPS TRUSS HEAD SCREW
- (4) 8-32 KEPS NUT
- (2) 6MM SET SCREW & HEX WRENCH
- (1) 1 1/2 NPT LOCK RING

**FEC** 5 BREWSTER ST.  
GLEN COVE, NY 11542

PHONE: (516) 967-9565  
fecrack@ix.netcom.com

P/N 22627

6-26-18