



HAPPY PLUGS AIR 1 GO USER MANUAL



CONNECT AND USE

- 1 Charge Air 1 Go for a least 15 minutes before use.
- 2 Remove the earbuds from the charge case. Keep them within 10 cm / 4 inches apart from each other until the LED on the left earbud stops blinking.
- 3 Select "Air 1 Go" on your phone/device to pair.



When inserting the earbuds into your ears - make sure not to touch the touch control surface. A five second touch turns the earbud off.



RESET TO FACTORY SETTINGS

- 1 Delete "Air 1 Go" from your Bluetooth devices list.
- 2 Make sure the charge case is charged. Put the earbuds in the charge case.
- 3 Touch and hold the touch sensors on both earbuds for 10 seconds until the earphone LEDs blink 3 times.

The earbuds are now reset and ready to pair to your device. Just follow the quickstart steps.

CALLS

When using the Air 1 Go for phone calls, both earbuds are active, but only the right (R) earbud has a microphone for speaking.



On Apple devices, while your Air 1 Go is paired; go into *Settings > Accessibility > Touch*, scroll down to *Call Audio Routing* and select *Bluetooth Headset*.

SIRI OR GOOGLE ASSISTANT



Control calls and music with Siri or Google Assistant. On iPhone, go into *Settings > Touch ID & Passcode*, scroll down to *Allow Access when locked* and enable Siri.

TOUCH CONTROLS



2 s	Power On
5 s	Power Off
10 s	Reset (In the case)



x 1	Volume Up
x 2	Volume Down



x 1	Play / Pause
x 2	Next Track
x 3	Previous Track
x 1	Call Answer / Call End
x 2	Reject Call
2 s	Switch Call
2 s	Siri / Google Assistant

Full instructions & FAQ available at: help.happyplugs.com

1

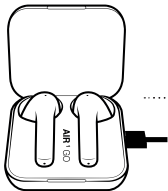

15 min

2

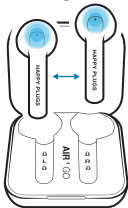

10 cm / 4"

3

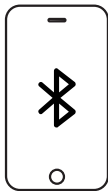

1

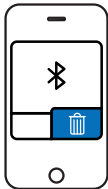

2

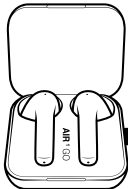

15 min

3

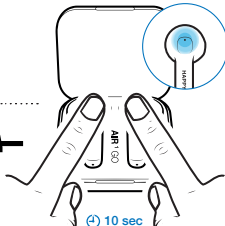

10 sec