

FCC COMPLIANCE

NOTE: This equipment has been tested and found to comply with the limits for a Class B digital device, pursuant to Part 15 of the FCC Rules. These limits are designed to provide reasonable protection against harmful interference in a residential installation. This equipment generates, uses and can radiate radio frequency energy and, if not installed and used in accordance with the instructions, may cause harmful interference to radio communications. However, there is no guarantee that interference will not occur in a particular installation. If this equipment does cause harmful interference to radio or television reception, which can be determined by turning the equipment off and on, the user is encouraged to try to correct the interference by one or more of the following measures:

- Reorient or relocate the receiving antenna.
 - Increase the separation between the equipment and receiver.
 - Connect the equipment into an outlet on a circuit different from that to which the receiver is connected.
 - Consult the dealer or an experienced radio/TV technician for help.
- This device complies with Part 15 of the FCC Rules. Operation is subject to the following two conditions: (1) This device may not cause harmful interference, and (2) this device must accept any interference received, including interference that may cause undesired operation.

Caution: Modifications not authorized by the manufacturer may void users authority to operate this device. CAN ICES-3 (B)/NMB-3(B).

SAFE BATTERY USAGE

- Use alkaline batteries for best performance and longer life.
- Use only the battery type recommended for the unit.
- Batteries should be replaced only by an adult.
- Insert batteries with the correct polarity (+ and -).
- Do not mix old and new batteries.
- Do not mix alkaline, standard (carbon-zinc), or rechargeable batteries.
- Do not short-circuit batteries.
- When not used for an extended time, remove batteries to prevent possible leakage and damage to the unit.
- Do not mix rechargeable and non-rechargeable batteries.
- Rechargeable batteries are to be removed from the toy before charging.
- Rechargeable batteries are to be recharged only under adult supervision.
- Do not recharge non-rechargeable batteries.
- Exhausted batteries are to be removed from the toy.
- Do not dispose of batteries in fire as they may leak or explode.

! WARNING:

This product contains a Button or Coin Cell Battery. A swallowed Button or Coin Cell Battery can cause internal chemical burns in as little as two hours and lead to death. Dispose of used batteries immediately. Keep new and used batteries away from children. If you think batteries might have been swallowed or placed inside any part of the body, seek immediate medical attention.

IMPORTANT NOTES ABOUT BUTTON BATTERIES

- WARNING - KEEP BATTERIES OUT OF REACH OF CHILDREN

- Swallowing may lead to serious injury in as little as 2 hours or death, due to chemical burns and potential perforation of the esophagus.
- If you suspect your child has swallowed or inserted a button battery immediately call the 24-hour Poisons Information Centre on 13 1126 (Australia)/ your local emergency services for fast, expert advice.
- Examine devices and make sure the battery compartment is correctly secured, e.g. that the screw or other mechanical fastener is tightened. Do not use if compartment is not secure.
- Dispose of used button batteries immediately and safely. Flat batteries can still be dangerous.
- Adults shall tell potential users about the risk of button batteries and keep their children away from button cell. Adult supervision is required.



'Let's care for the environment!'

The wheellie bin symbol indicates that the product must not be disposed of with other household waste. Please use designated collection points or recycling facilities when disposing of the item. Do not treat old batteries as household waste. Take them to a designated recycling facility.

Please keep this manual as it contains important information.



0620-1-E/INT
Printed in China

MGA Entertainment, Inc.
9220 Winnetka Ave. Chatsworth, CA 91311 U.S.A.
(800) 222-4685

MGA Entertainment UK Ltd.
50 Presley Way, Crownhill, Milton Keynes,
MK8 0ES, Bucks, UK
+ 0800 521 558

www.LOLsurprise.com
©2020 MGA Entertainment, Inc.
L.O.L. SURPRISE™ and L.O.L. SURPRISE! O.M.G. OUTRAGEOUS
MILLENNIAL GIRLS™ are trademarks of MGA in the U.S. and other
countries. All logos, names, characters, likenesses, images, slogans,
and packaging appearance are the property of MGA.

The preferred method of contact for
Customer Service is through our e-mail
contact form at www.mgae.com

MGA Entertainment (Netherlands) B.V.
Baronie 68-70, 2404 XG Alphen a/d Rijn, The Netherlands
Tel: +31 (0) 172 758038
E-mail: klantenservice@mgae.com

Imported by MGA Entertainment Australia Pty Ltd
Suite 2.02, 32 Delhi Road
Macquarie Park NSW 2113
1300 059 676



! WARNING:
CHOKING HAZARD-Small parts.
Not for children under 3 years.

AGES 3+
SKU: 571278
ADULT SUPERVISION REQUIRED

CONTENTS

- A. 1 Interactive Fashion Journal
B. 1 Invisible Ink Pen
C. 1 Black Light
D. 1 Watch
E. 1 Notebook
F. 1 Vinyl Sticker Sheet



(Invisible ink pen and black light are hidden inside the journal binding.)

Illustrations are for reference only. Styles may vary from actual contents.

BEFORE YOU BEGIN

An adult must install fresh alkaline batteries (not included) in your journal prior to playing. Here's how:

1. Using a Phillips screwdriver (not included), remove the screw and battery compartment cover located on the back of the journal.
2. Install three (3) AA alkaline batteries (not included) into the journal. Make sure the (+) and (-) ends face the proper direction as indicated inside the battery compartment.
3. Replace the compartment cover and tighten the screw.

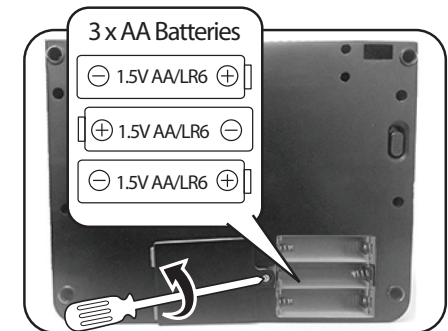

SETTING THE DATE AND TIME

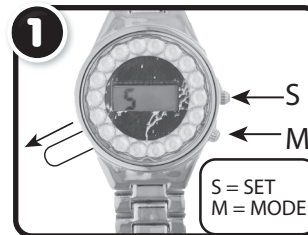

Remove the pull tab on the watch.
SET THE DATE:

1. Press "M" twice to show the month.
2. Continue pressing "S" until it is on the correct month.
3. Press "M" once to switch over to the day.
4. Continue pressing "S" until it is on the correct day.

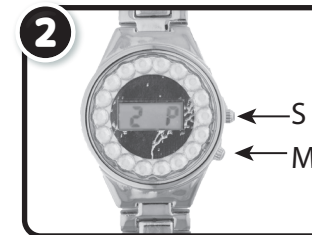

SET THE TIME:

1. Press "M" once to show the hour.
2. Continue pressing "S" until it is on the correct hour.
3. Press "M" once to switch over to the minute.
4. Continue pressing "S" until it is on the correct minute.
5. Press "M" to finish.



TO SWITCH FROM TIME TO DATE OR SECONDS:

1. Press "S" once and it will display the date. After a few seconds, it will return to the time.
2. To display the seconds, press "S" twice. NOTE: Pressing "M" while on the seconds will reset the seconds to zero.

ADJUSTING THE WATCH

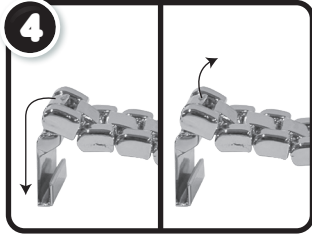

Remove the clasps from the ends of the watch by turning it at an angle and pulling it up.

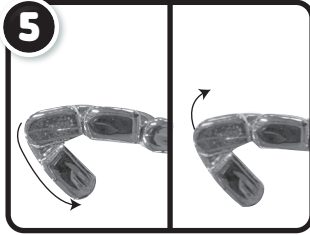

Remove a link from each side until it fits your wrist comfortably. Make sure the watch doesn't feel tight on your wrist.

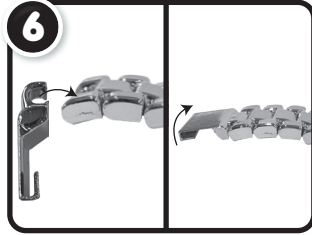

Replace the clasps by attaching the hook on the clasp to the bar on the link and turn it to straighten it out.

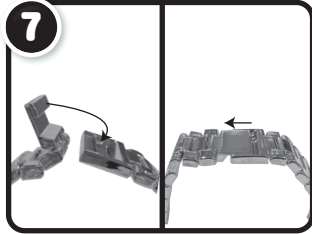

Place the watch around your wrist and hook the clasps. Insert the hook and slide it to lock in place.

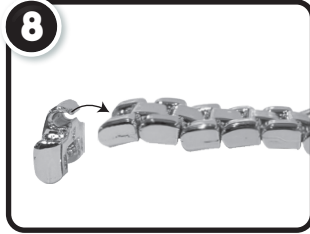

When replacing the links, remove the clasps and attach the hook of the link to a bar on another link. Then, turn it to straighten it out and replace the clasps.

YOUR JOURNAL

NOTE: Before beginning, cover the play area to avoid possible ink damage.

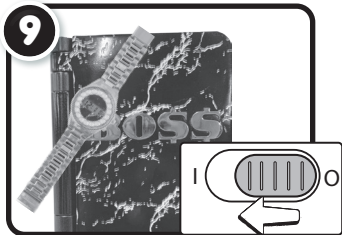

Move the switch on the back of the journal to the "ON" (I) position. Wave the back of the watch over the logo on the front of the journal to open. If wearing the watch, remove it first and then wave the back over the journal.

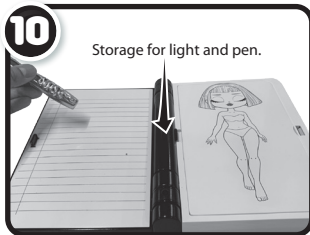

Remove the invisible ink pen and black light from the journal binding. Then, remove the pull tab on the black light. Use the pen to write on the inside cover of the journal or in the included notebook. Press and hold the button on the light to store the message. When done playing, steal the light and pen in the binding.

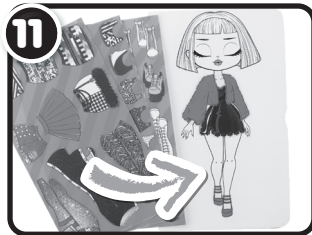

Use the stickers to create fashion looks or do the activities in the notebook. When adding the stickers, firmly press down and rub your finger over the stickers so they stick to the journal. Carefully peel off the stickers and replace to create different fashions.



Store the notebook in the compartment behind the doll drawing.



Should you misplace the watch, an access button is located on the side panel of the journal. Use a dull object, like a paper clip, to press the button, and the journal will open.

IMPORTANT INFORMATION

- Do not use a pen other than the one included with this product on the journal, as other pens may be permanent and may not be removable.
- Invisible ink pen cannot be removed from the notebook after writing in it. Use a pencil and erase when doing the notebook's activities.
- Use a damp cloth to remove the invisible ink writing from the journal cover. Air dry only before writing a new message. DO NOT use cleaners, abrasives, or other harsh chemicals.
- Recap the pen after using.
- Wash hands thoroughly after using the invisible ink pen. DO NOT write on skin, furniture, etc.
- Keep the pen away from eyes.
- DO NOT leave the pen in the sun or in very hot areas.
- Do not use stickers on humans, pets, furniture or any item which may be damaged by sticker or sticker removal.
- Keep dirt and debris away from the sticky part of the stickers. Store the stickers on the vinyl sheet when not in use.
- The journal won't open if the watch is on the wrist. Make sure to remove it first before waving the back over the journal.
- Always turn the journal "OFF" (O) after playing to conserve battery life.
- The watch has a battery life of 12 months. Batteries are not replaceable.

CHANGING THE BATTERIES

An adult must install fresh alkaline batteries in your black light should the batteries need replacing. Here's how:

1. Using a Phillips screwdriver (not included), remove the screw and battery compartment cover located on the bottom half of the black light.
2. Install three (3) AG3 (LR41) alkaline batteries into the black light. Make sure the (+) and (-) ends face the proper direction as indicated inside the battery compartment.
3. Replace the compartment cover and tighten the screw.

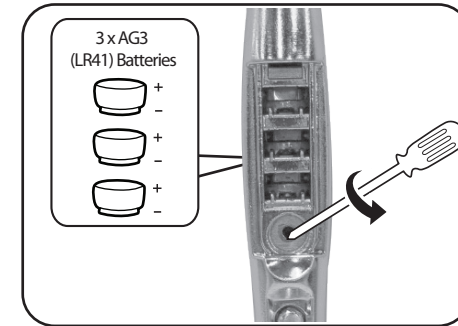

REMOVE THE BATTERIES BEFORE DISCARDING

An adult must remove the battery of the watch and dispose of it at a designated collection point or recycling facility at the end of the battery life. Here's how:

1. Using pliers or a similar tool (not included), open the bottom compartment of the watch.
2. Remove the battery and properly dispose.

