

Box Includes:

A. Upper Spray Mop Handle



B. Lower Pole with Bottle Enclosure



C. Mop Head



D. Bona Hard-Surface Floor Cleaner Bottle



E. Bona Microfiber Cleaning Pad



Assembly Instructions:

1. The silver Bottle Release Button on the Lower Mop Pole (B) and the flexible corners on the mop head (C) should both be facing the front. Ensure that the swivel knuckle on the mop pole is facing down before attachment. Attach mop pole to mop head by aligning the end of the Lower Pole with the knuckle on the Mop Head (C) and pressing together until a click is heard.

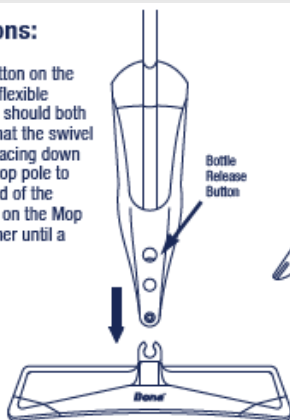

2. Attach Upper Spray Mop Handle (A) to Lower Pole with Bottle Enclosure (B) by aligning the similar profiles of the poles and pushing together until a click is heard.

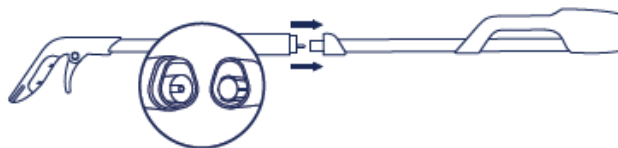

3. Attach Bona Microfiber Cleaning Pad (E) to Mop Head by placing pad on the floor with the printed side facing up. Place the Mop Head over the center of the pad and press down firmly to attach. The Bona® logo on the Mop Head should face forward while mopping. Your mop is now ready to use!

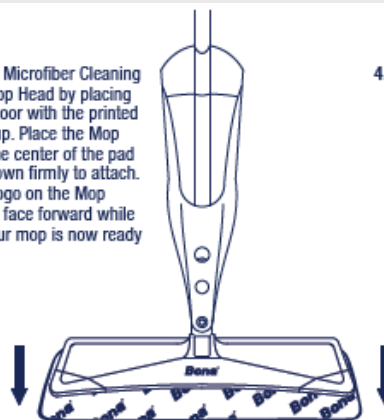

4. Remove cap from cleaning bottle, and engage into the bottle enclosure by pushing in until a click is heard. Your mop is now ready to use! When the bottle is empty, press the silver bottle release button to disengage the bottle before refilling.

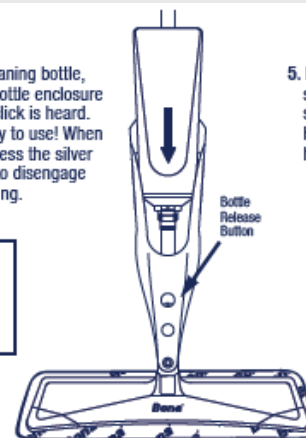

5. For easy and convenient storage, rotate Mop Head to side until it locks into place. Hang mop from wall using hanger in Spray Mop Handle.

