

PHILIPS

Portable DVD Player

3000 Series

TAP3705

User manual



Register your product and get support at
www.philips.com/support



Contents

1	Safety and important notice	3
----------	------------------------------------	----------

2	Your portable DVD player	6
	Introduction	6
	What's in the box	6
	Overview of the main unit	7
	Overview of the remote control	9

3	Get started	10
	Charge the battery	10
	Install remote control battery	11
	Connect additional equipment	11
	Use your player	12
	Control photo play	13
	Repeat play	13
	Skip play	13
	Divx videos	13

4	Adjust settings	14
	System setup	15
	Language setup	15
	Audio setup	15
	Video setup	15
	Digital setup	15
	Auto standby	15

5	Software update	16
----------	------------------------	-----------

6	Specifications	16
----------	-----------------------	-----------

7	Troubleshooting	17
----------	------------------------	-----------

1 Safety and important notice

Read and understand all instructions before you use this DVD player. If damage is caused by failure to follow the instructions, the warranty does not apply.

Hearing safety

Listen at a moderate volume.

- Using headphones at a high volume can impair your hearing. This product can produce sounds in decibel ranges that may cause hearing loss for a normal person, even for exposure less than a minute. The higher decibel ranges are offered for those that may have already experienced some hearing loss.
- Sound can be deceiving. Over time your hearing “comfort level” adapts to higher volumes of sound. So after prolonged listening, what sounds “normal” can actually be loud and harmful to your hearing. To guard against this, set your volume to a safe level before your hearing adapts and leave it there.

To establish a safe volume level:

- Set your volume control at a low setting.
- Slowly increase the sound until you can hear it comfortably and clearly, without distortion.

Listen for reasonable periods of time:

- Prolonged exposure to sound, even at normally “safe” levels, can also cause hearing loss.
- Be sure to use your equipment reasonably and take appropriate breaks.

Be sure to observe the following guidelines when using your headphones.

- Listen at reasonable volumes for reasonable periods of time.
- Be careful not to adjust the volume as your hearing adapts.
- Do not turn up the volume so high that you can't hear what's around you.
- You should use caution or temporarily discontinue use in potentially hazardous situations. Do not use headphones while operating a motorized vehicle, cycling, skateboarding, etc.; it may create a traffic hazard and is illegal in many areas.

Safety

Risk of electric shock!

- Never remove the casing of the player.
- Never expose the product and accessories to rain or water. Never place liquid containers, such as vases, near the product. If liquids are split on or into the product, disconnect it from the power outlet immediately. Contact Philips Consumer Care to have the product checked before use.
- Never place the product and accessories near naked flames or other heat sources, including direct sunlight.
- Never insert objects into the ventilation slots or other openings on the product.
- Where the mains plug or an appliance coupler is used as the disconnect device, it shall remain readily operable.
- Batteries (battery pack or batteries installed) shall not be exposed to excessive heat such as sunshine, fire or the like.
- Disconnect the product from the power outlet before lightning storms.
- When you disconnect the power cord, always pull the plug, never the cable.

Risk of short circuit or fire!

- Before you connect the product to the power outlet, make sure that the power voltage matches the value printed on the back or bottom of the product.
- Avoid applying pressure on the power plugs. Loose power plugs can cause arcing or fire.

Risk of injury or damage to the product!

- To avoid exposure to laser radiation, do not disassemble.
- Do not touch the optical lens inside the disc compartment.
- Never place the product or any objects on power cords or on other electrical equipment.
- If the product is transported in temperatures below 5°C, unpack the product and wait until its temperature matches room temperature before connecting it to the power outlet.

Risk of overheating!

- Never install his product in a confined space. Always leave a space of at least 10 cm around the product for ventilation. Ensure newspapers, table-cloths, curtains or other objects never cover the ventilation slots on the product.
- Never use the product in tropical climates.

Risk of contamination!

- Do not mix batteries. (old and new or carbon and alkaline, etc.)
- Danger of explosion if batteries are incorrectly replaced. Replace only with the same or equivalent type.
- Remove batteries if they are exhausted or if the remote control is not to be used for a long time.
- Batteries contain chemical substances, they should be disposed of properly to protect the environment.

Risk of swallowing batteries!

- The product/remote control may contain a coin type battery, which can be swallowed. Keep the battery out of reach of children at all times!

Note

- For identification and supply ratings, see the type plate at the back or bottom of the product.
- Before you make or change any connections, make sure that all devices are disconnected from the power outlet.

This is CLASS II apparatus with double insulation, and no protective earth provided.



CLASS 1 LASER PRODUCT



Class 2 Laser radiation when open.
Do not stare into the beam. (Inside of the product)

Care for your product

- Do not insert any objects other than discs into the disc compartment.
- Do not insert warped or cracked discs into the disc compartment.
- Remove discs from the disc compartment if you are not using the product for an extended period of time.
- Only use microfiber cloth to clean the product.

Care of the environment





Your product is designed and manufactured with high quality materials and components, which can be recycled and reused.

Never dispose of your product with other household waste. Please inform yourself about the local rules on the separate collection of electrical and electronic products and batteries. The correct disposal of these products helps prevent potentially negative consequences on the environment and human health.

Your product contains batteries, which cannot be disposed of with normal household waste. Please inform yourself about the local rules on separate collection of batteries. The correct disposal of batteries helps prevent potentially negative consequences on the environment and human health.

Please visit www.recycle.philips.com for additional information on a recycling center in your area.

 This symbol on a product means that the product is covered by European Directive 2012/19/EU.

 This symbol means that the product contains batteries covered by European Directive 2013/56/EU which cannot be disposed of with normal household waste.

Inform yourself about the local separate collection system for electrical and electronic products and batteries. Follow local rules and never dispose of the product and batteries with normal household waste. Correct disposal of old products and batteries helps prevent negative consequences for the environment and human health.

Compliance



Hereby, TP Vision Europe BV declares that this product is in compliance with the essential requirements and other relevant provisions of Directives 2014/35/EU 2014/30/EU You can find the Declaration of Conformity on www.p4c.philips.com.

Copyright

 **Be responsible
Respect copyrights**

This item incorporates copy protection technology that is protected by U.S. patents and other intellectual property rights of Rovi Corporation. Reverse engineering and disassembly are prohibited.

Trademarks



Manufactured under license from Dolby Laboratories.

Dolby and the double-D symbol are trademarks of Dolby Laboratories.



'DVD Video' is a trademark of DVD Format/Logo Licensing Corporation.

2 Your portable DVD player

Congratulations on your purchase, and welcome to Philips! To fully benefit from the support that Philips offers, register your product at www.philips.com/support.

Introduction

Your portable DVD player plays digital video discs that conform to the universal DVD Video standard. With it, you can play movies with true cinema picture quality and stereo or multi-channel sound (depending on disc and playback set-up). You can also select sound track, subtitle languages, and different angle of view (again depending on DVD disc). Besides, you can restrict the play of discs that are not suitable for children. You can play the following discs on the DVD player :
444A, TCD732, VCD/SVCD, DIVX, MP4, DVD-R/-RW, DVD+R/+RW, DVD-RW, CD-R/RW, MP3, JPG, USB, Area code disc.

What's in the box

Check and identify the contents of your package:

- Portable DVD player x1
- Remote control x1
- AAA batteries x2
- AC power adaptor x1
- Car charger x1
- AV cable x1
- Quick Start Guide x1
- Warranty Card x1
- Safety Sheet x1

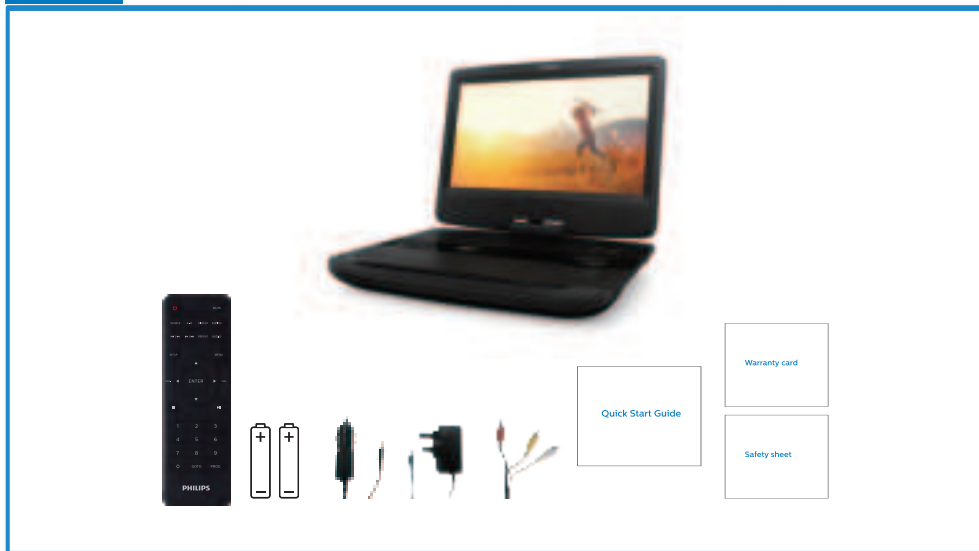

Overview of the main unit

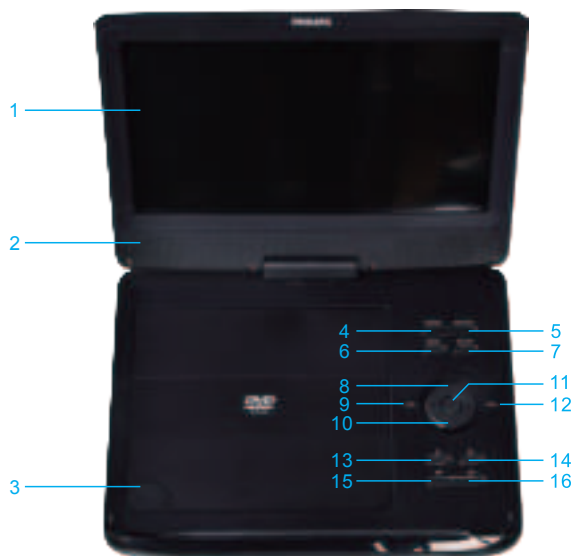

- 1.LED Display
- 2.Speakers
- 3.**OPEN** : Open the disc compartment.
- 4.**SOURCE** : Press to switch DVD/USB/SD card/AV in mode.
- 5.**REPEAT** : Press to repeat a title, chapter, track or the whole disc.
- 6.**MENU** : Press to return to the main menu of the disc.
- 7.**SETUP** : Enter or exit the system setup menu.
8. **^** : Scroll up.
9. **< / VOL-** : Short press to scroll left; long press to reduce volume.
10. **v** : Scroll down.
- 11.**OK** : Confirm an entry or selection.
12. **> / VOL+** : Short press to scroll right; long press to increase volume.
13. **▶▶** : To Start, pause or resume play.
14. **■** : Press to stop disc play.
15. **◀◀** : Skip to the previous next chapter, track or title.
16. **▶▶** : Skip to the next next chapter, track or title.



- 17.**USB** : USB port.
- 18.**SD/MMC** : SD/MMC slot.
19. **🎧** : Headphone jack.
- 20.**AV OUT** : Audio/video output jack.
- 21.**AV IN** : Audio/video input jack.
- 22.**OFF** **🔘** **ON** : Turn on/off the player.
- 23.**DC IN** : Power supply socket.

Overview of the remote control

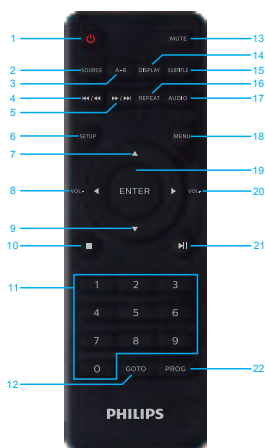

- | | |
|--------------------|--|
| 1. ⏻ | Press to turn on the player, or switch the player to standby. |
| 2.SOURCE | Switch between DVD/USB/SD card/AV IN mode. |
| 3.A-B | Marks the section for repeat play. |
| 4.◀◀/◀◀ | Short press to skip to the previous title, chapter, or track; long press for fast rewind play. |
| 5.▶▶/▶▶ | Short press to skip to the next title, chapter, or track; long press for fast forward play. |
| 6.SETUP | Enter or exit the system setup menu. |
| 7.▲ | Scroll up. |
| 8.◀ | Short press to scroll left; long press to reduce volume. |
| 9.▼ | Scroll down. |
| 10.■ | Stop play. |
| 11.0-9 | Number keys. |
| 12.GOTO | Skip to a title, a chapter or a track. |
| 13.MUTE | Press once to turn off the sound; press again to turn on the sound. |
| 14.DISPLAY | Display screen information. |
| 15.SUBTITLE | Select a subtitle language. |
| 16.REPEAT | Repeat a title, chapter, track or the whole disc. |
| 17.AUDIO | Adjust the audio output format. |
| 18.MENU | Return to the main menu of the disc. |
| 19.ENTER | Confirm an entry or selection. |
| 20.▶ | Short press to scroll right; long press to increase volume. |
| 21.▶ | Start, pause or resume play. |
| 22.PROG | If a disc contains 2 or more tracks, chapter or titles, set up the playing to your preferred programming. Press this button to enter the programming menu. |

3 Get started

! Caution

- Use the controls only as stated in this user manual.

Always follow the instructions in this chapter in sequence.

If you contact Philips, you will be asked for the model and serial number of your player. The model number and serial number are on the bottom of your player. Write the numbers here:

Model No. _____

Serial No. _____

Charge the battery

! Caution

- Risk of product damage! Ensure that the power supply voltage corresponds to the voltage printed on the bottom of the player.
- Use only the supplied AC adaptor to charge the battery.

- 1 Slide the **OFF**  **ON** switch to **OFF** position.
- 2 Connect the supplied AC adaptor to the player and to the AC outlet or connect to a car charger to charge battery.

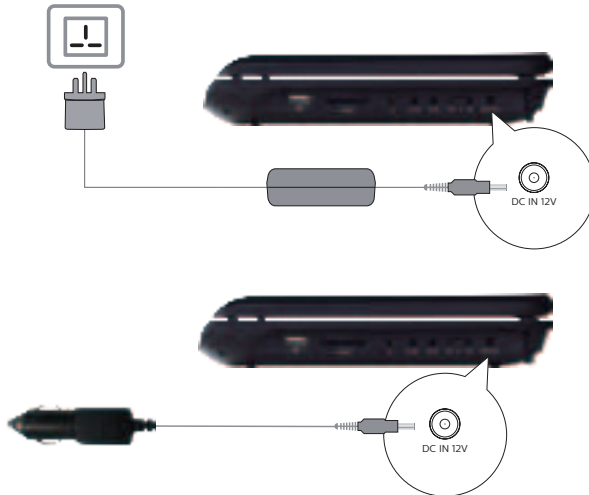

- ↳ The charge indicator lights up and turns red. It takes about 3.5 hours to fully charge the battery.
- ↳ When the battery is fully charged, the charge indicator turns yellow.

Install remote control battery



Caution

- Risk of explosion! Keep batteries away from heat, sunshine or fire. Never discard batteries in fire.
- Risk of decreased battery life! Never mix different brands or types of batteries.
- Risk of product damage! When the remote control is not used for long periods, remove the batteries.
- Perchlorate Material - special handling may apply. See www.dtsc.ca.gov/hazardouswaste/perchlorate.

For first-time use:

- 1 Remove the protective tab to activate the remote control battery.

To replace the remote control battery:

- 1 Open the battery compartment.
- 2 Insert two RO3 AAA CARBON ZINC batteries 1.5V.
- 3 Close the battery compartment.

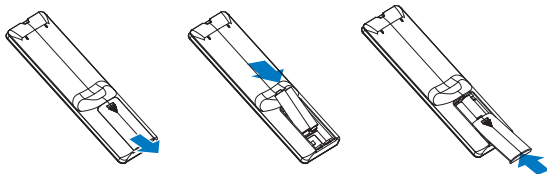

Connect additional equipment



Caution

- Turn off your player before connecting to any additional equipment.

You can connect the player to a TV or an amplifier to enjoy DVDs or Karaoke.

Match the color of the AV cables with the jacks: the yellow cable is for the yellow video jack, the red/white cable is for the red/white audio jacks.

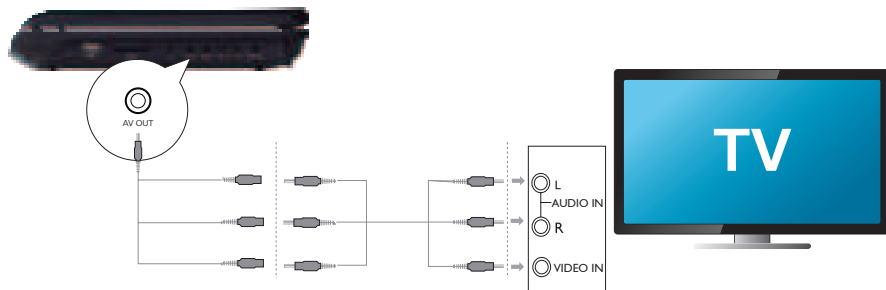

Tip

- To conserve energy, press **SOURCE** and select **AV IN** mode to turn off the front panel display.

Use your player



USB



SD

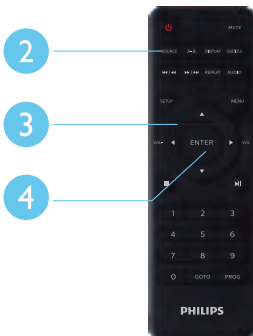
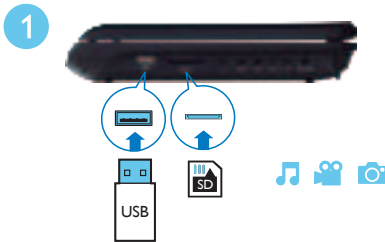

Control photo play

During a photo slideshow, use the remote control to control the play.

Button	Action
OK	Access to select [Photo preview]
▲ ▼	Flip the photo up and down.
◀ ▶	Rotate a photo anti-clockwise/clockwise.
▶	Photos are played from beginning to end one by one.
■	Press once to stop photo play and go back to browse; press twice to go back to menu setting.

Skip play

You can skip play to a specific title, chapter or track or time.

- 1 During play, press **GOTO**.
An input field bar is displayed, and "0" blinks. Then press **OK** to proceed.
- 2 Press **0-9** number key to select a digit as a title, chapter, or track number.
- 3 After a digit is selected, press **◀ / ▶** to change a digit position.
- 4 If necessary, repeat step 2 and 3 to complete the input of a title, chapter, or track number.
- 5 Press **OK**.
The play skips to the selected title, chapter or track or time.

Repeat play

During play, press **REPEAT** to select a repeat play option.

- Repeat the current title, chapter, track or the whole disc.
- Repeat all the contents on a disc or a USB storage device.
- To cancel repeat play, press and hold **REPEAT** until [Off] is displayed.

DivX videos

You can play DivX videos from a disc or a USB storage device.

DivX subtitles

- If subtitles are not displayed correctly, change the character set that supports DivX subtitles. Select a character set: press **SUBTITLE** and switch between subtitles until the desired character set are selected.

Character set	Languages
[English]	English

Note

- To use the subtitles, make sure that the subtitle file has the same name as the DivX video file name. For example, if the DivX video file is named "movie.avi", save the subtitle file as "movie.srt", or "movie.sub".
- This player can play subtitle files in the following formats: .srt, .sub, .ass, .smi and .ssa.

4 Adjust settings

This section helps you adjust the settings of this player.

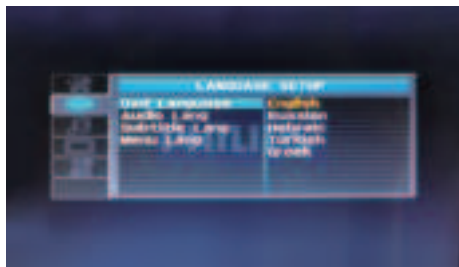
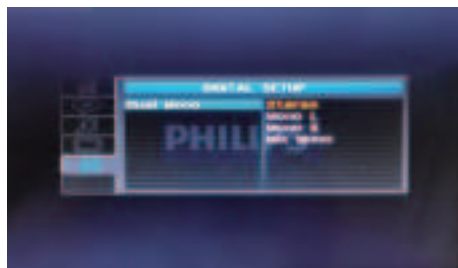
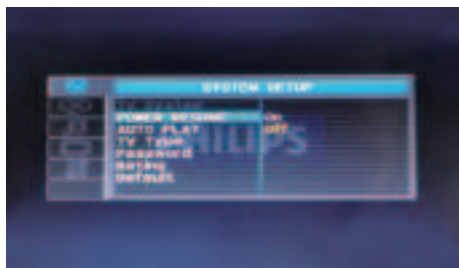
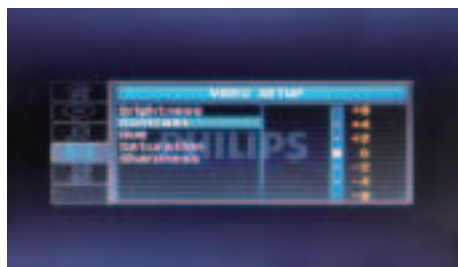
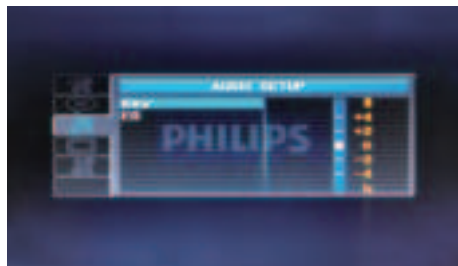

≡ Note

- You cannot change a menu option that is grayed out.
- Press ◀ to go back to previous menu level. Press **SETUP** to exit the menu.

System setup

- 1 Press **SETUP**.
- 2 Select **[Setup]** > **[System setup]** to access the general setup options.
 - **[TV System]** : Select a TV system that matches your TV. By default, this setting matches the common TVs in your country (when connected to a TV).
 - **[POWER RESUME]** : If enabled, the player will resume the play at the position it last stopped, after restarting from a power-off.
 - **[AUTO PLAY]** : If enabled, after reading the disc, the player will play the contents of the disc directly. If disabled, after reading the disc, you need to choose the contents that you want to play.
 - **[TV type]** : Adjust screen scale.
 - **[Password]** : Set or change a password to play a restricted disc. Input "0000" if you do not have a password or if you have forgotten your password.
 - **[Rating]** : If the disc has level information, you can use this option to control whether it can be played.
 - **[Default]** : Reset all settings to the factory default, except for the settings for **[Disc Lock]**, **[Parental Control]** and **[Password]**.

Language setup

- 1 Press **SETUP**.
- 2 Select **[Setup]** > **[Language setup]** to access the preference setup options.
 - **[Osd language]** : Select the operation page language for video.
 - **[Audio lang]** : Select an audio language for video.
 - **[Subtitle lang]** : Select a subtitle language for video.

- **[Menu lang]** : Select a menu language for a video disc.

Audio setup

- 1 Press **SETUP**.
- 2 Select **[Setup]** > **[Audio setup]** to access the audio setup options.
 - **[KEY]** : Adjustment of lifting and falling.
 - **[EQ]** : Equalizer of different music styles: STANDARD, CLASSIC, ROCK, JAZZ, POP.

Video setup

- 1 Press **SETUP**.
- 2 Select **[Setup]** > **[Video setup]** to access the video setup options.
 - Use **▲/▼/◀/▶/OK** to adjust the brightness, contrast, hue, saturation and sharpness of the picture to improve the quality.

Digital setup

- 1 Press **SETUP**.
- 2 Select **[Setup]** > **[Digital setup]** to access the Dolby digital setup options.
 - **[Dual mono]** : Select Stereo, Mono L, Mono R, Mix Mono

Auto Standby

- Enable or disable auto standby. If enabled, this player switches automatically to standby after 15 minutes of inactivity (for example, in pause or stop mode).

5 Software update

Note

- Power supply must not be interrupted during software update.
- If the power supply is cut off, the machine can no longer be used.

To check for updates, compare the current software version of this player with the latest software version (if available) at the Philips website.

1. Download the software from website.
2. Name the software as 8202KD.BIN, and then copy it to USB.
3. Remove the disc from the player; and turn it on. Insert the USB with copied software into the player's USB port, and the player will upgrade automatically.

6 Specifications

Note

- Specifications are subject to change without notice.

Region code

This player can play discs with the following region code.

DVD region code	Countries
	EU

Playable media

- DVD, DVD-Video, VCD, SVCD, Audio CD
- DVD+R/+RW, DVD-R/-RW, DVD+R/-R DL (Dual Layer), CD-R/-RW (maximum 64 folders and 999 files)
- USB storage device

Supported File Formats

- Video: avi, .divx(nonsupport DIVX3.11), .xvid
- Audio: .mp3, .wma
- Picture: .jpg, .jpeg

USB

- Compatibility: Hi-Speed USB (2.0)
- Class support: USB Mass Storage Class
- File system: FAT16, FAT32
- Maximum number of albums/folders: 64
- Maximum number of tracks/titles: 999
- USB port: 5V $\overline{=}$, 400mA
- Support USB HDD (Hard Disc Drive): an external power source may be needed

Video

- Signal system: PAL, NTSC, AUTO
- Composite video output: 1Vp-p (75 ohm)

Audio

- 2-channel analog output
 - Audio Front L&R : 2Vrms (47k Ohm)

Main unit

- Dimensions (W x H x D): 253 x 205 x 43 mm
- Net Weight: 0.92 kg

Power

- Power supply rating Input: 100-240V~, 50/60Hz
- Power supply rating Output: DC 12V, 1.5A
- Power consumption: \leq 13 W
- Power consumption in standby mode: < 0.5W

Laser specification

- Type: Semiconductor laser InGaAlP (DVD), AlGaAs (CD)
- Wave length: 650 nm (DVD), 790 nm (CD)
- Output Power: 7.0 mW (DVD), 10.0 mW (VCD/CD)
- Beam divergence: 60 degrees

7 Troubleshooting

To keep the warranty valid, never try to repair the player yourself.

If you have problems using this player, check the following points before you request service. If you still have a problem, register your player and get support at www.philips.com/support.

If you contact Philips, you will be asked for the model and serial number of this player. The model number and serial number are on the back of this player. Write the numbers here:

Model No. _____

Serial No. _____

No picture.

- The TV video input channel is not correctly selected (see the TV's user manual).
- If you have changed a TV system setting, switch back to the default setting.

No sound output from the TV.

- Make sure that the audio cables are correctly connected between this player and the TV.

No sound during DivX video playback.

- The audio codes are not supported.

No audio output from the loudspeakers of the connected external audio device (for example, stereo system, amplifier receiver).

- Make sure that the audio cables or coaxial cable are correctly connected.
- Switch the external audio device to correct audio input source.

Disc cannot be read.

- Make sure that this player supports the disc (see "Specifications" > "Playable media").
- For a recorded disc, make sure that the disc is finalized.

A USB storage device cannot be read.

- Make sure that the format of the USB storage device is compatible with this player (see "Specifications" > "USB").
- Make sure that the file system on the USB storage device is supported by this player (see "Specifications" > "USB").

Files cannot be displayed or read.

- Make sure that this player supports these files (see "Specifications" > "Supported File Formats").
- Make sure that the number of files or folders does not exceed the supported limit of this player (maximum 64 folders or 999 files).
- If a maximum number of folders exceeds 64, files in any folder which is outside the 64 folders cannot be read regardless of the total files stored on the media which are within the maximum number of files.

DivX video files cannot be played.

- Make sure that the DivX video file is complete.
- Make sure that the file extension is correct.

DivX subtitles do not display correctly.

- Make sure that the subtitle file has the same name as the DivX video file.
- Make sure that the subtitle file has an extension name supported by this player (.srt, .sub, .ass, .ssa or .smi).
- Select the character set that supports the subtitle (see "Use your player" > "DivX videos").



Specifications are subject to change without notice.

2020 © Philips and the Philips Shield Emblem are registered trademarks of Koninklijke Philips N.V. and are used under license. This product has been manufactured by and is sold under the responsibility of MMD Hong Kong Holding Limited or one of its affiliates, and MMD Hong Kong Holding Limited is the warrantor in relation to this product.

TAP3705_05_UM_V1.0

