

CLIMB AND SLIDE PLAY SET

(NBPLYSTCNSA)

Safety & warning	3
Components	5
Assembly notes	8
Assembly	11
Cleaning & care	27
Specifications	28
Notes	29

SAFETY & WARNINGS

Warning: Only for domestic outdoor use.

This playset satisfies all the requirements of the Australian standard AS/NZS ISO 8124 and has been certified by an independent laboratory. To guarantee safety, please give special attention to the assembly, safety, and care instructions detailed in this document.



Important notice for timber care & maintenance

This product contains timber components that are naturally subject to deterioration in the outdoor elements after years of exposure.

To combat the effects of outdoor exposure and greatly increase the lifespan of your play set or cubby, we strongly recommend that you apply a protective coat of exterior grade lacquer or oil to all timber parts upon first assembly. In order to best maintain the timber, we recommend reapplying protective coats every 3-6 months.

Failure to care for your timber parts by applying protective lacquer or oil will greatly reduce the lifespan of your product. For information on the most suitable exterior lacquer or oil, please consult your hardware specialist.

Splits and Cracks

1. Splits and cracks will occur in timber as it expands and contracts with humidity and temperature changes. They will occur particularly in the round pole timbers, but also in square cut timber, and in both new and old sets. If the wood has a similar moisture content to the natural surroundings, cracking is greatly reduced.
2. Whilst these can appear quite large and alarming, these cracks DO NOT affect the strength, integrity, and durability of the play equipment. Splits or cracks over 10mm should be considered dangerous as children could trap fingers within the openings – tend to these large gaps immediately.

Prevention: Applying a timber preservative (such as oil, gel, or other suitable preservatives – not included) can greatly help on preventing cracks and splits. Once it is applied, it can be used to treat all exposed areas. However, this means that the outside of the wood may have a higher moisture content. If it can be allowed to dry out slowly in more controlled conditions, often taking up to three months, the end result will be a greatly reduced incidence of cracking.

General statements

Please familiarise yourself with the installation manual, parts/components and general construction process of your new swing set before getting started. Approximate assembly time: 6 to 8 hours. 2 metre unobstructed safety perimeter around swing set recommended.

This play set is designed for children 3-14 years old and for the use of:

- 3 occupants who have a combined weight not exceeding 150 kgs on the elevated floor;
- 1 occupant who has a total weight not exceeding 50 kgs on the climbing net; and
- for a total unit capacity of 5 occupants who have a combined weight of 250kg.

We recommend that the weight limits for all components must not be exceeded. Failure to adhere to these and other safety guidelines could result in damage to the play set and injury to the users.

Safety Advice

- As per legal requirements, a swing seat with flexible means of suspension must have a 40cm minimal distance between the ground and the swing. This distance is important for safety. The distance between the swing seat and the ground, the trapeze and the ground can be adjusted using the plastic height adjustment hooks.
- **Warning:** This product is only to be used by children between the ages of 3 and 14.
- **Warning:** Not to be used by anyone weighing over 50kgs.
- **Warning:** Choking hazard – small parts can be dangerous for children.
- **Warning:** It must be used under adult supervision.
- This product is for private use at home only. Under no circumstances is it be used in parks, schools, camp sites, hotels, public leisure areas etc.
- The play set should be set up on a flat surface and two metres away from any structures or obstacles (walls, trees, washing lines, cables etc).
- To avoid eye damage, we advise that the swing and slide should not be setup directly facing the sun.
- The play set should be installed over impact absorbing surfaces such as sand, wood-bark chips, rubber and foam and must NOT be set up on a hard surface (concrete, tarmac etc). detail surfacing materials please refer attached consumer information sheet.
- We recommend securing your swing set firmly into the ground using concrete.
- The anchorage must be checked regularly.
- Dispose of packaging thoughtfully.
- Do not allow children to play with packaging.

CAUTION! This Product includes timber and/or fabric, Please Keep away from fire.

IMPORTANT! For safety reasons, your play set must be embedded into the ground.

- Place your play set in the desired position and mark a square area 350mm x350mm around each of the feet. Dig holes 350mm deep. The feet must be in the centre of the square.
- Fill the holes with concrete. Do not exceed the ground level. Fit the embedding piece into the centre of the concrete so that fixtures for screwing the posts into place rise out of the concrete.
- When the concrete is dry, screw the posts to the embedding pieces.
- Anchors shall be placed level with or underground to reduce tripping hazards.

IMPORTANT! Wait until the concrete is set before using and check anchorages regularly.

COMPONENTS

Timber Parts

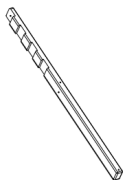

280001 (x1)

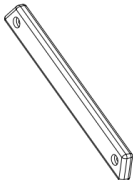

280002 (x2)

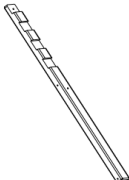

280003 (x1)



280004 (x1)



280005 (x2)

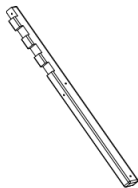

280006 (x1)



280007 (x2)



280008 (x2)

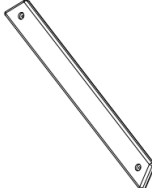

280009 (x2)

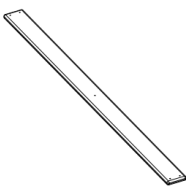

280010 (x11)

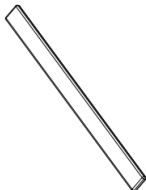

280011 (x1)

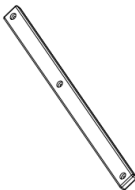

280012 (x2)

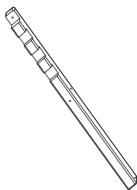

280013 (x1)

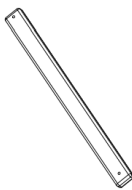

280014 (x1)

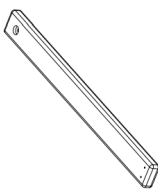

280015 (x3)

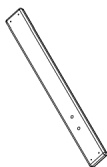

280016 (x5)

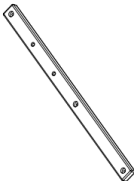

280017 (x2)



280018 (x5)



280019 (x1)



280020 (x2)

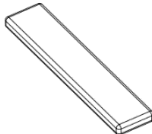

280021 (x1)

Fasteners

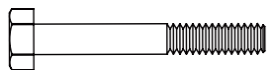

B131 Hex Head Bolt 5/16"
x 2 1/4" (x4)

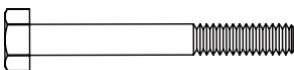

B132 Hex Head Bolt 5/16" x
3 3/4" (x12)

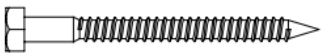

S06 Lag Bolt 1/4" x 2" (x12)



S65 Phillips Pan Head
Machine Screw 1/4" x 1
1/4" (x10)

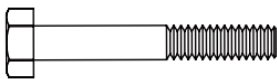

B91 Hex Head Bolt 5/16"
x 2 1/2" (x4)

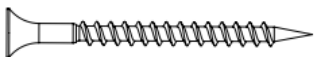

S95 Phillips Wood Screw #8
x 1" (x7)

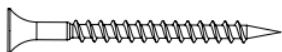

S96 Phillips Wood Screw
#8 x 2" (x98)

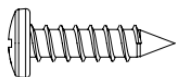

S80 Phillips Wood Screw
#14 x 1 1/4" (x4)

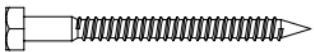

S05 Lag Bolt 1/4 x 2 1/2"
(x11)

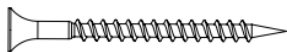

S97 Phillips Wood Screw
#8 x 1 1/2" (x16)

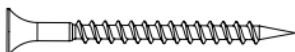

S91 Phillips Wood Screw
#8 x 1 1/4" (x27)

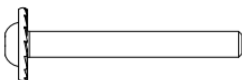

B115 Torx Pan Head Bolt
with teeth formed in under
head 5/16 x 1 1/2" (x6)

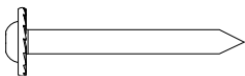

S119 Torx Pan Head Bolt
with teeth formed in
under head 5/16 x 2" (x2)

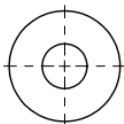

W07 USS Flat
Washer 1/4" (x33)

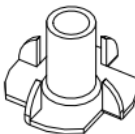

N01 T-Nut with
Barrel 1/4" (x10)

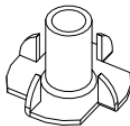

N02 T-Nut with
Barrel 5/16"
(x26)



W08 US Flat
Washer 5/16"
(x20)

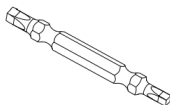

MSC01 (x1)

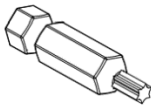

MSC02 (x1)



W14 Lock
Washer 1/4"
(x33)



W14 Lock
Washer 1/4"
(x20)

Accessories

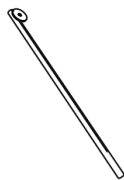

HD23 (x4)

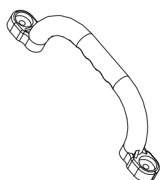

AC17 (x4)

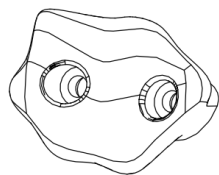

AC15 (x5)



AC43 (x1)

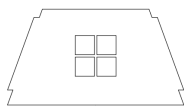

AC42 (x1)



AC39 (x1)

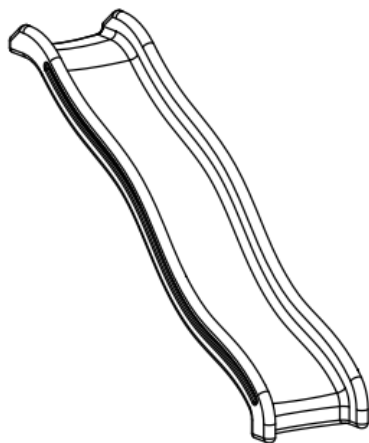

SL06 (x1)

ASSEMBLY NOTES

Additional Tools Required for Assembly

Tape Measure	610mm Level	Angle Square
Phillips Screwdriver	Cordless Drill or Electric Drill	10mm Drive Ratchet or Electric Impact Gun
Claw Hammer or Rubber Mallet	Pliers or Vise Grips	11mm Deep Well Socket
14mm Deep Well Socket	19mm Deep Well Socket	3mm, 6mm, 14mm and Drill Bits
Phillips Head Screw Bits		An adult with two adult helpers

Pre-Assembly Advice

Depending on your experience, assembly of our play sets can take as little as 6 hours up to 24 hours, including checking inventory of part; therefore, we recommend you set aside a full two days for assembly.

Identify all the parts for your play set. Empty each box and lay out boards so you can see each part. Your instruction book will have detailed drawings that will make it easy for you to recognise individual parts. Keep all hardware and metal parts separate from wooden pieces.

After everything is laid out, check carefully to ensure all parts are present. Make sure there are no broken boards.

Find an area to sort your hardware. It is best to open the hardware on a solid surface so that you do not lose any pieces in the grass. This will save time and familiarise you with all the different pieces in the hardware bag.

As fresh timber acclimates to its new environment, the natural tendencies of the tree can show itself in the form of checks or "cracks" in the lumber. In almost all cases this is normal and it will not affect the structural integrity of your play set.

Cosmetic defects that do not affect the structural integrity of the product or natural defects of wood such as warping, checking or any other physical properties of wood that do not present a safety hazard, are not covered by this warranty.

Defects that develop because the products are exposed to extreme climate conditions are not covered by this warranty. Defects that develop as a result of faulty or improper installation of the product are also not covered by this warranty.

Most cracks are not warrantable, however if you believe that the integrity of your play set is compromised by this natural occurrence, please contact the Dealer that you purchased

your swing set from. We appreciate your purchase and know that you will enjoy your play system for many years to come.

Important note: Wood has some natural defects such as knots, surface cracks, etc. We reject parts that are structurally defective. We use a high-quality timber in our structures; however, you should inspect each part for splinters or rough spots and sand them smooth to prevent injury.

After familiarising yourself with all the components, read all instructions thoroughly. Reading instructions after you have studied the parts will help you understand more clearly the installation process and help to eliminate unnecessary mistakes.

Pay close attention to the diameter and length of each bolt and screw.

Never tighten hardware completely at first. It helps to have some adjustment for bolt alignment while you are attaching parts together. After everything is square, tighten each joint.

After the main unit is assembled it is critical that the floor is level and square. If the main frame is not level, the walls and floor will be out of square.

After your complete installation, make sure every bolt, screw and nut are tight and every board is secure. Wood will expand and contract with the seasons.

Place the set on level ground, not less than 2 metre from any structure or obstruction such as a fence, garage, house, overhanging branches, laundry lines or electrical wires.

All 6mm and 10mm lag bolts must have pre-drilled holes 38mm to 50mm deep. Use a 3.175mm drill bit for the 6mm and 100mm lag bolt. Use pre-drilled holes in facias as a reference for placing lag bolt pilot holes.

If a board lifts or rises causing a gap between boards when running in lag bolt or screws, back out the screw or lag bolt and press or apply pressure (but not enough to crack or break board) while re-running in the lag bolt or screw in the same hole.

Do not over tighten bolts, lag bolts or screws. You can damage boards, break hardware and/or strip out the hardware. When using a hammer do not beat on the hardware, but gently tap it in. Never beat on the wood as it will leave marks.

Levelling Your Swing Set During Assembly

Complete the steps which will be the basic frame of the fort [i.e. four corner posts with base (sand box boards) and deck supports].

Position in the most level area chosen for the play set, keeping in mind the location and size of the swing beam, ladder, slides, etc. That extend off the fort.

Once the frame is in the final position, check for vertical and horizontal levelness to determine which side(s) will need to be dug into the ground to level the play set.

With a shovel, score the ground around the outside edges of the sandbox boards on the 'high' side of the fort. This is the area that will be dug in. Make sure to score deep enough; the scored lines will be your digging template.

Push the frame off and away from the scored area, far enough to dig and remove dirt to reach the appropriate depth.

Dig a channel along the scored line(s) for the base of the fort (corner post and sandbox boards) to rest into. Dig the channels to the same level depth. The bottom of the channel(s) should be level to each other, so your frame doesn't teeter or rock because the channel(s) are uneven.

Once you have removed enough grass and dirt, slide/push the frame into the channel(s). Place a level on the vertical and horizontal boards of the frame to determine if enough soil or too much, was removed.

Repeat this process until the basic frame is plumb and level and in its final position before completing the rest of the assembly. Measure to make sure fort is square.

Important: if you require a channel depth of more than 150mm, then we recommend you have your play set area professionally graded before completing assembly. **

Assembly Advice

- Follow the instructions exactly.
- This product must be assembled by adults.
- Once assembly has been completed, keep the instructions in a safe place for future reference. This can be particularly handy for identification of parts if any after sales service is required.
- Before commencing assembly, check that none of the parts are missing. If you find that that you are missing a part, please contact our after-sales service department.
- Retain extra parts to use as spares in the future if necessary.
- Pre-Drill timber before fixing with screws to avoid cracks in the timber.
- The dimensions given in the instructions are indicative only, they may vary according to the assembly method

ASSEMBLY

Step 1:

Timber Parts

280001	x1	280013	x1
280002	x2	280003	x1
280005	x2		
280006	x1		

Fastener & Accessories

B91	x4	B132	x4
W08	x8	W07	x4
N02	x8	W14	x4
S05	x4	W15	x8

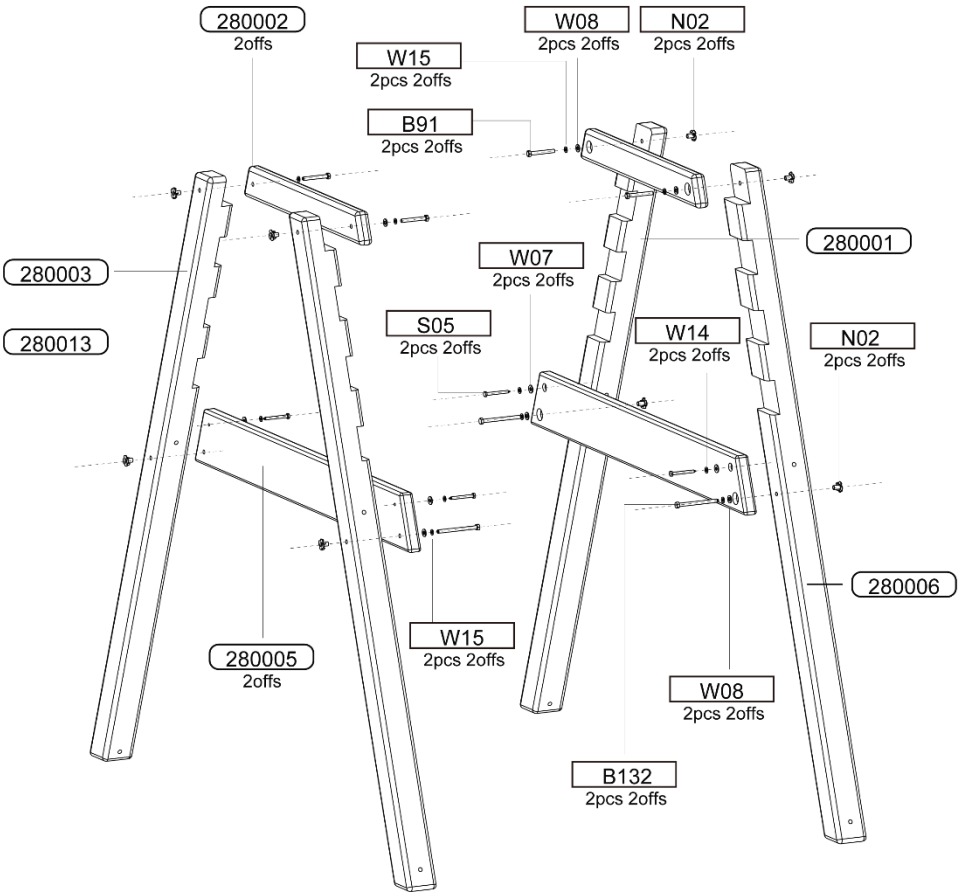

Step 2:

Timber Parts

280007	x2
280008	x2
280009	x2

Fastener & Accessories

S06	x12
W07	x12
W14	x12

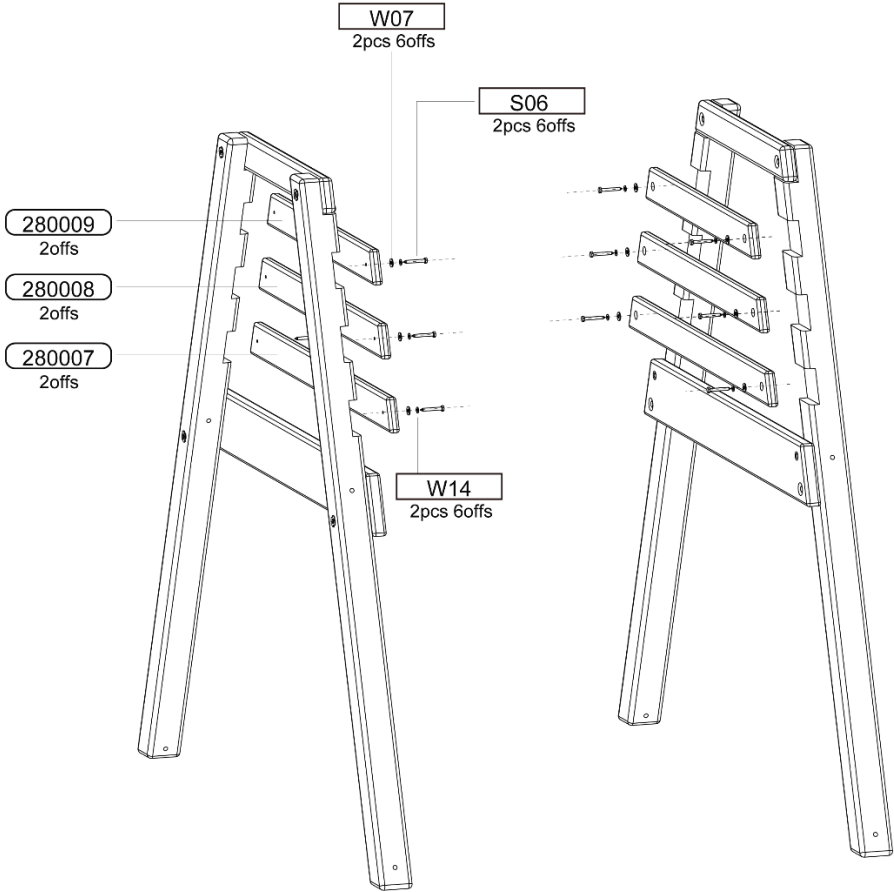

Step 3:

Timber Parts

280012	x2
280017	x2

Fastener & Accessories

B132	x8
W08	x8
N02	x8
W15	x8

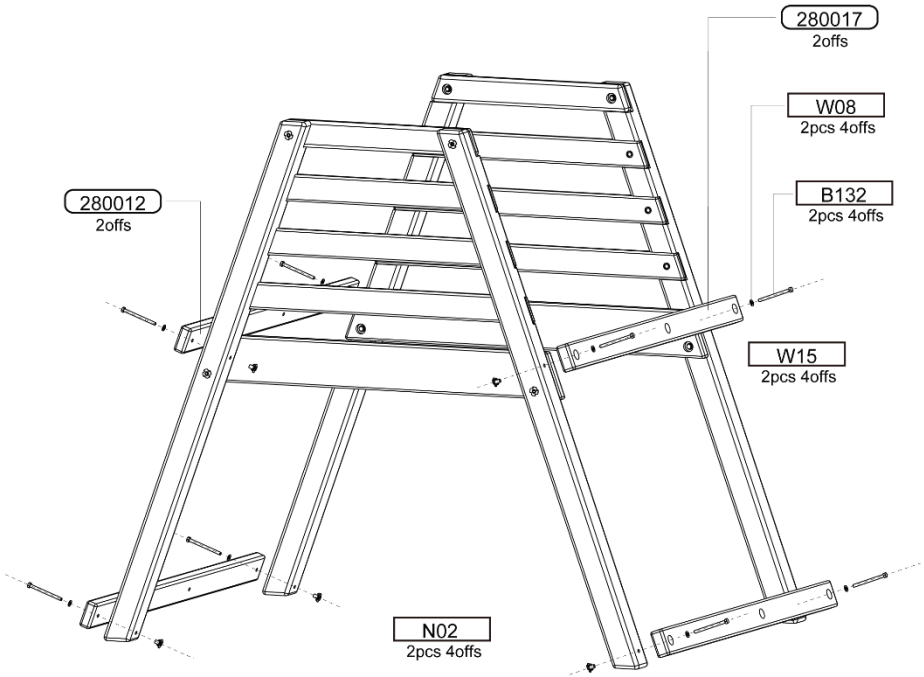

Step 4:

Timber Parts

- 280014 x1
- 280019 x1

Fastener & Accessories

- B131 x4
- W08 x4
- N02 x4
- W15 x4

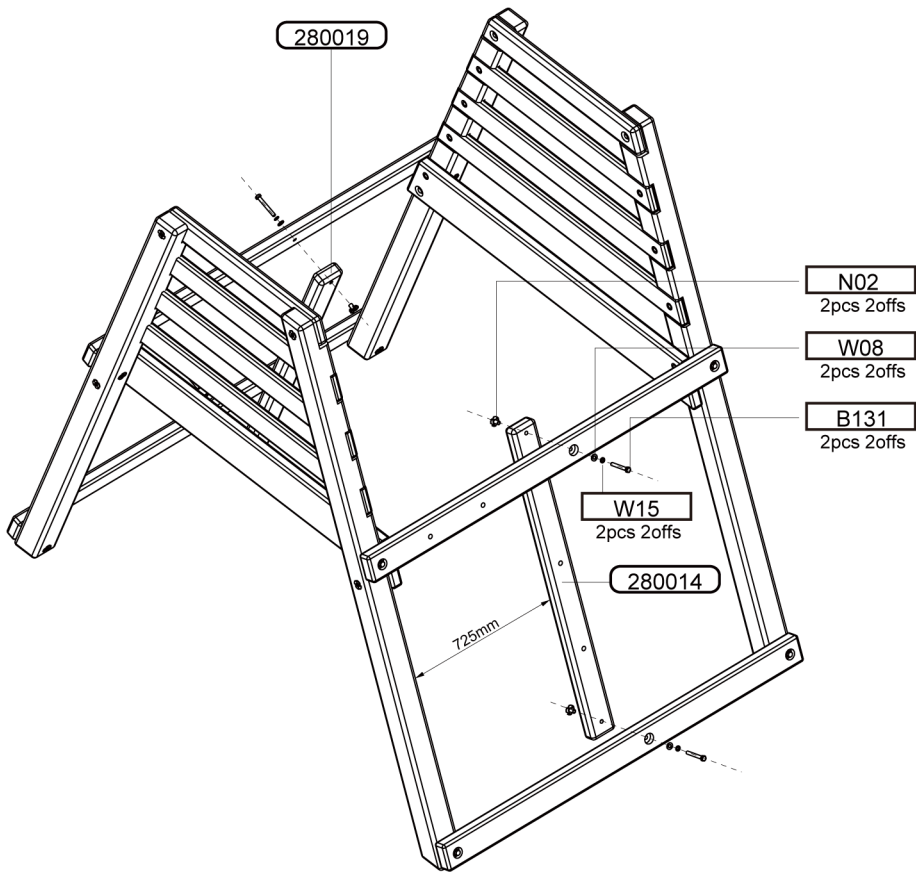

Step 5:

Timber Parts

280010 x11
280020 x2

Fastener & Accessories

S96 x52

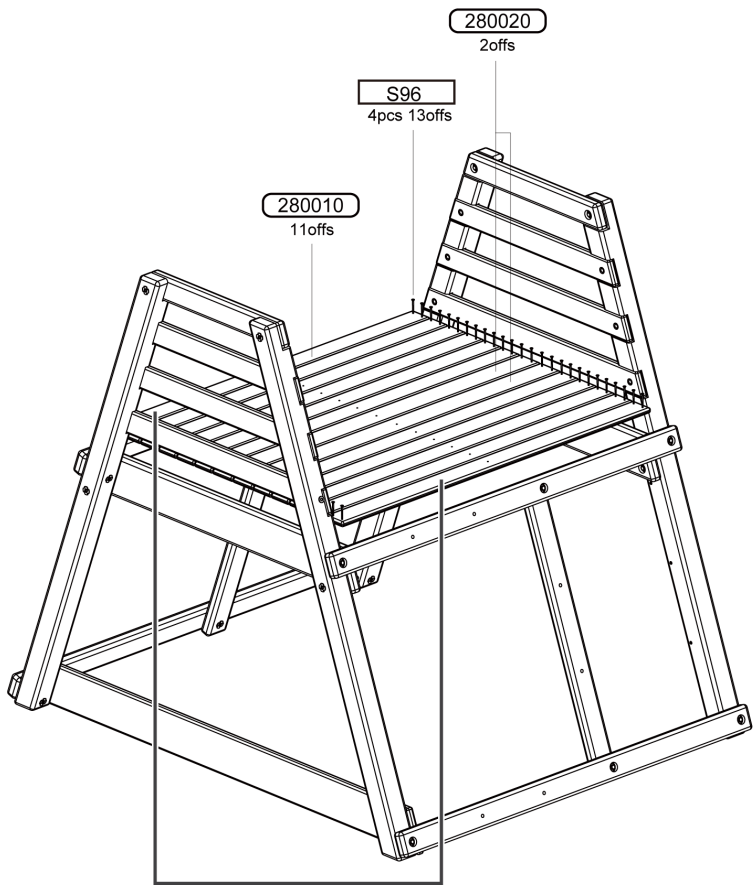

After installing the two side deck boards 280010, there should be no gap between side 280010 and 280012/280017, all other deck boards (280010/280020) should be evenly distributed.

Step 6:

Timber Parts

280011 x1

Fastener & Accessories

S91 x13

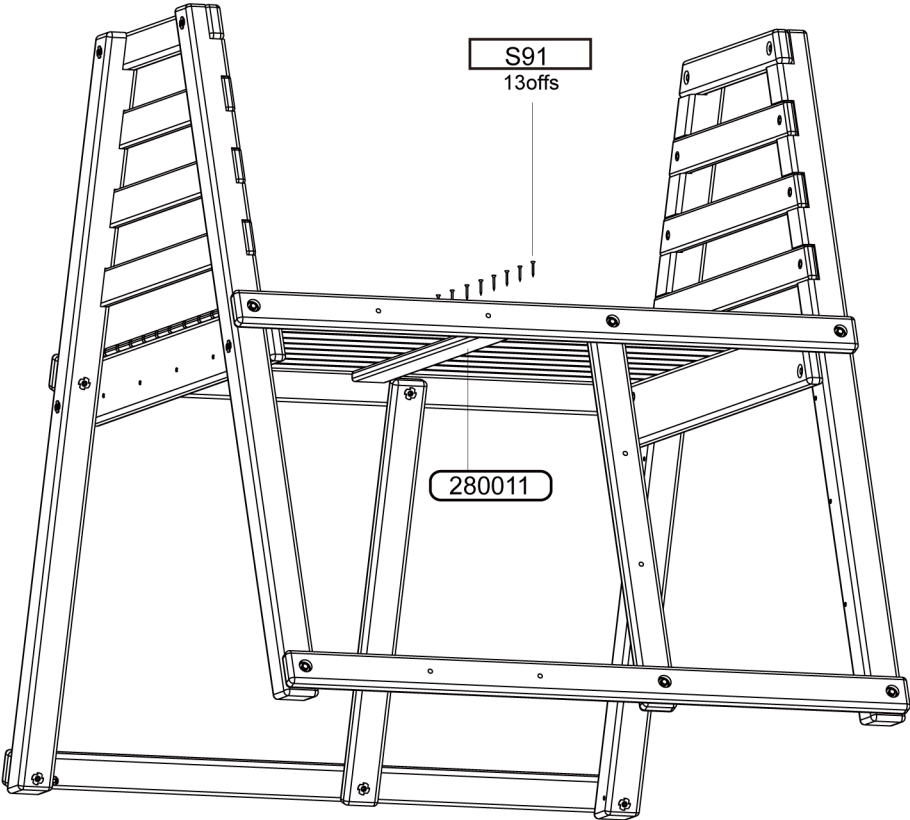

Step 7:

Timber Parts

280015 x3

Fastener & Accessories

S05 x3

W07 x3

S96 x6

W14 x3

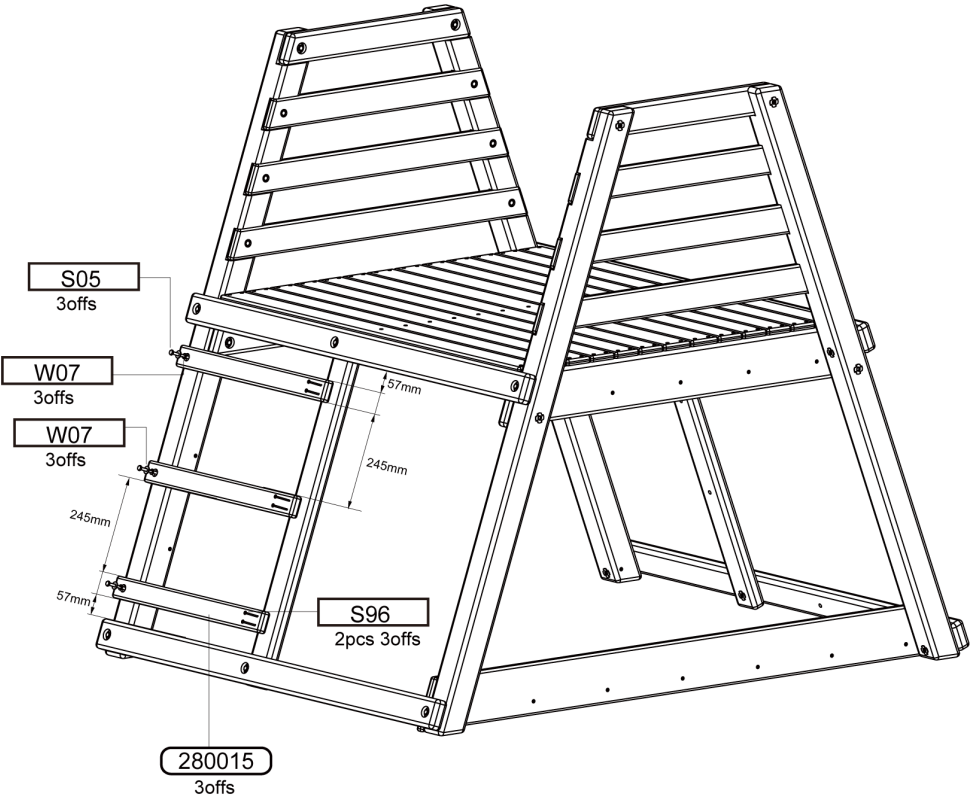

Step 8:

Timber Parts		Fastener & Accessories	
280016	x5	S65	x10
		W07	x10
		N01	x10
		W14	x10
		AC15	x5

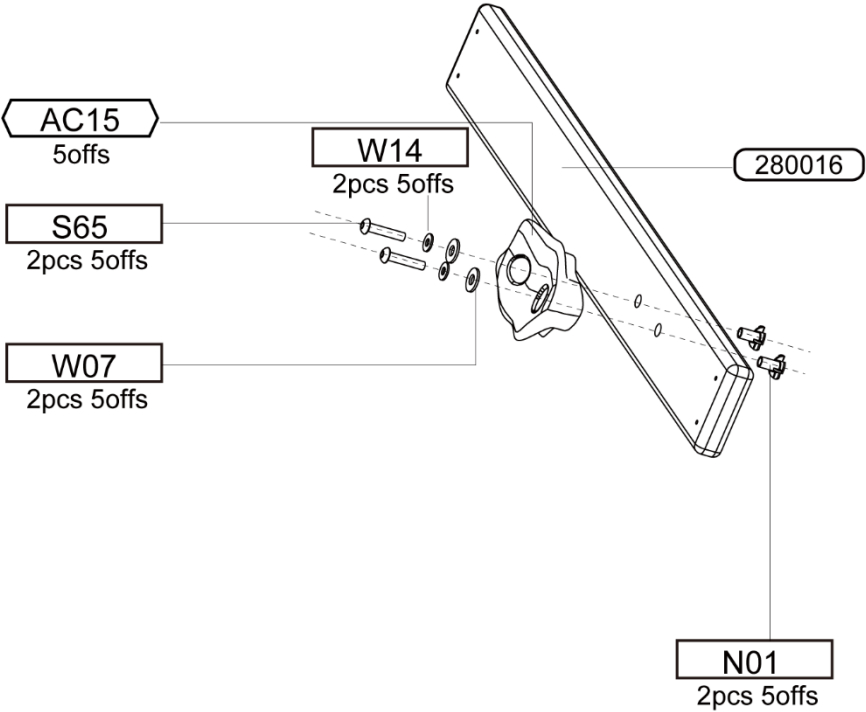

Step 9:

Timber Parts

- 280016 x5
- 280018 x5

Fastener & Accessories

- S96 x40

S96
4pcs 10offs

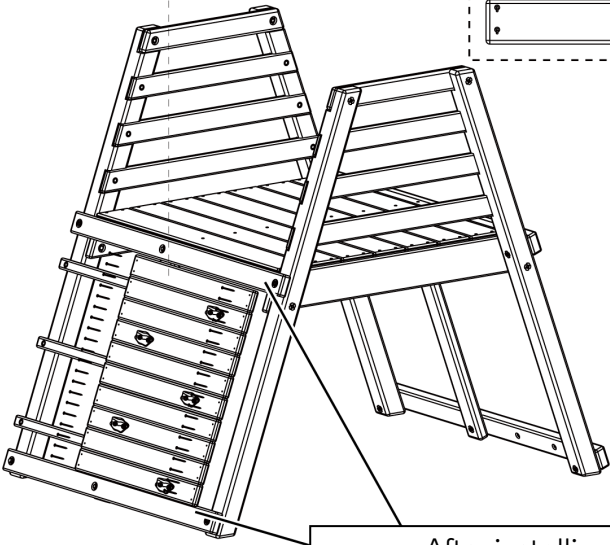
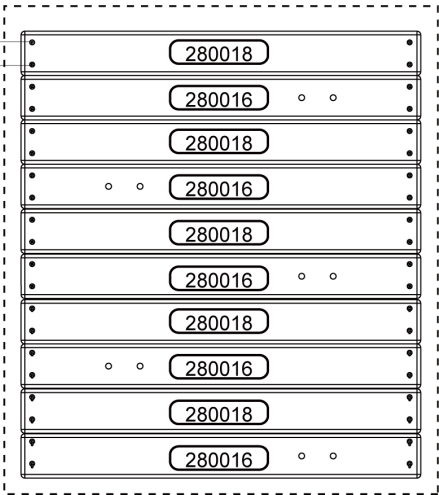

After installing the two side boards 280016/280018, there should be no gap between 280016/280018 and 280012 , all other boards (280016/280018) should be evenly distributed.

Step 10:

Timber Parts

280004 x1

Fastener & Accessories

S91	x5	W14	x4
S92	x8		
W07	x4		
S05	x4		
S95	x7	AC42	x1

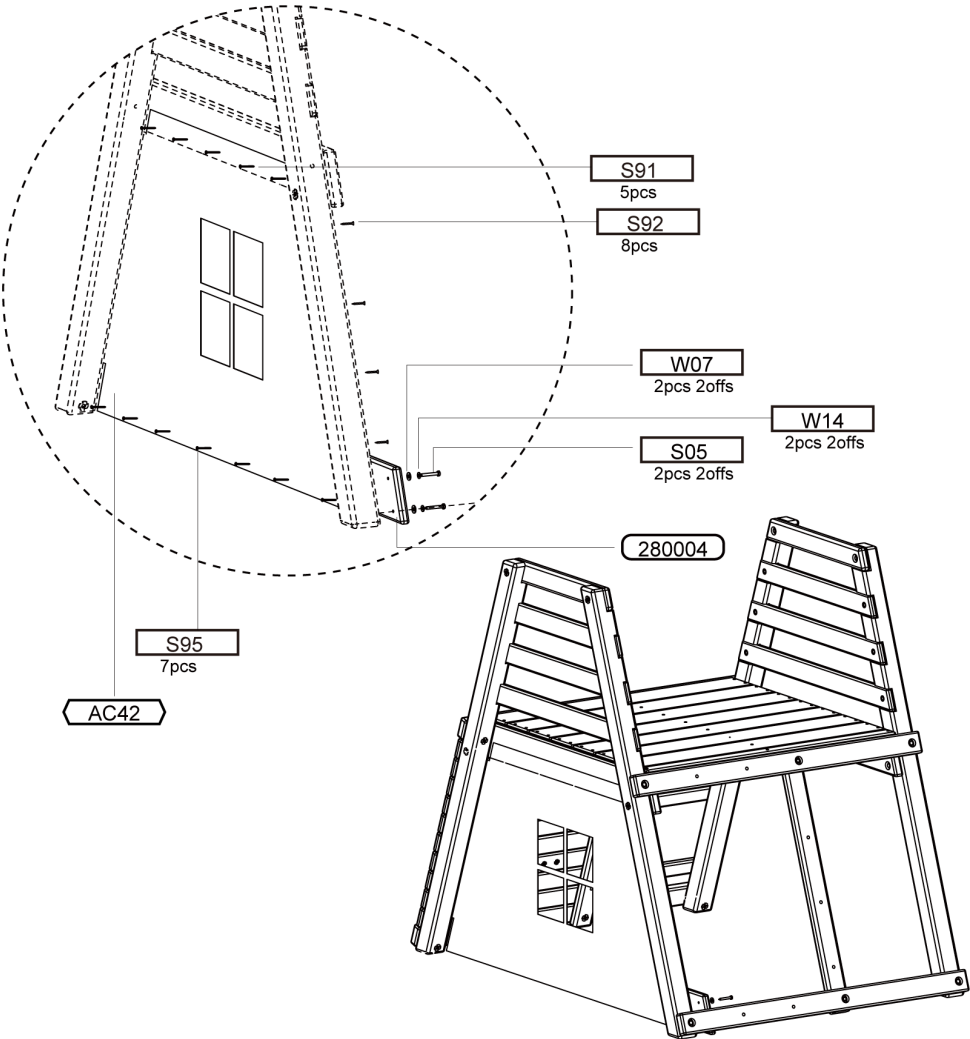

Step 11:

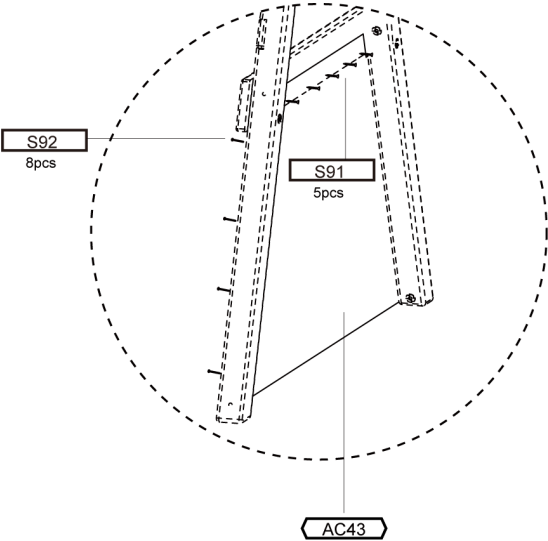

Fastener & Accessories			
S92	x8	AC43	x1
S91	x5		

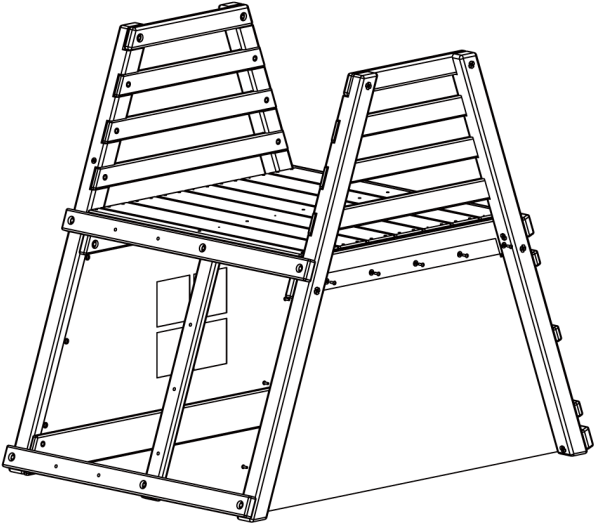

Step 12:

Fastener & Accessories

B115	x6	AC39	x1
S119	x2		
N02	x6		

S119
2offs

B115
6offs

N02
6offs

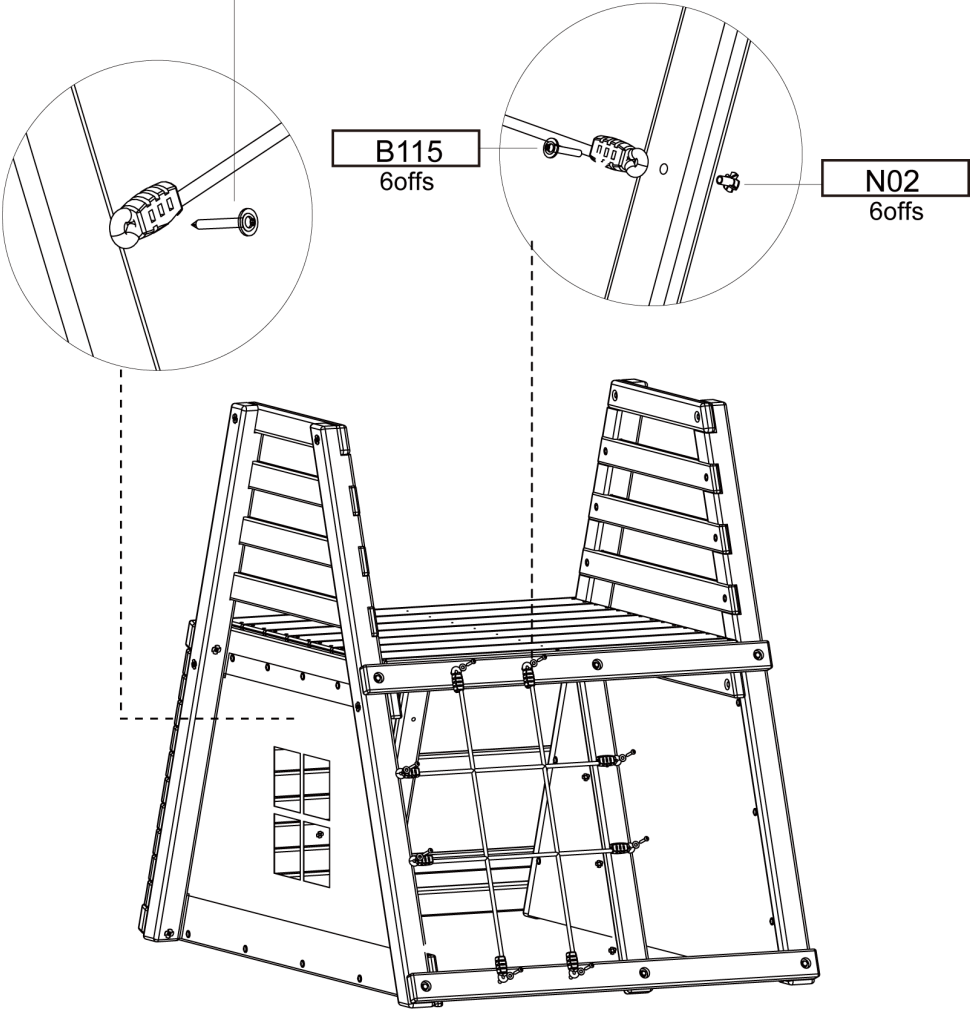

Step 13:

Fastener & Accessories

AC17 x4

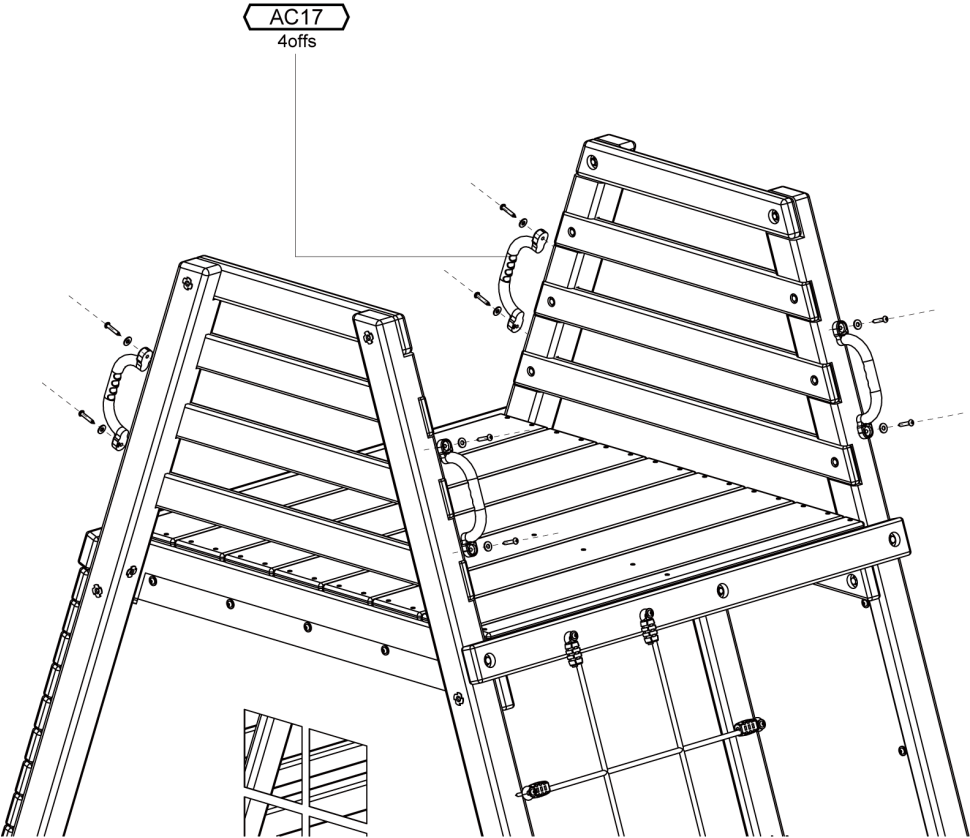

Step 14:

Timber Parts

280021 x1

Fastener & Accessories

S91 x4

S91

4offs

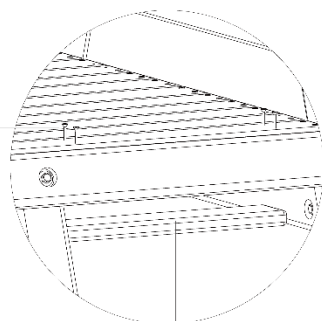

280021

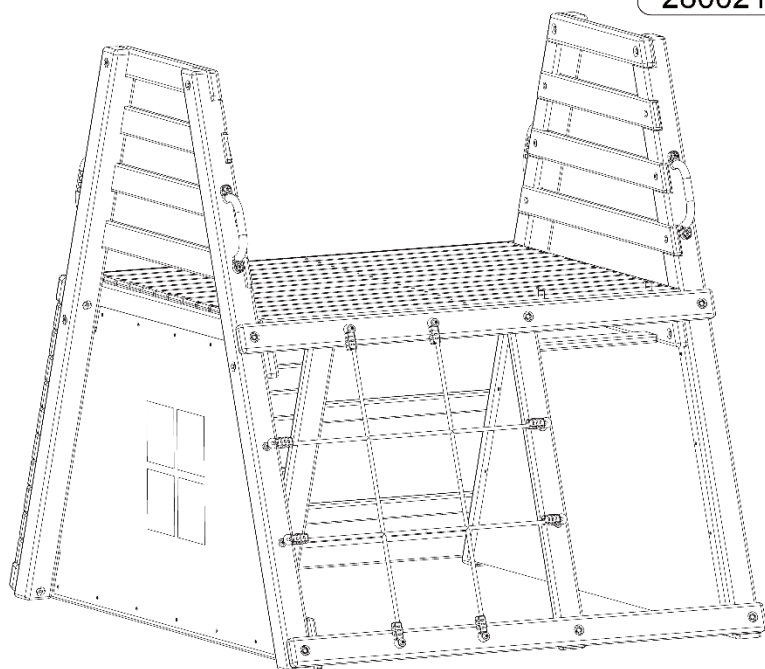

Step 15:

S80

x4

SL06

x1

S80

4pcs

After slide installation, there should be no gap between the slide and 280017.

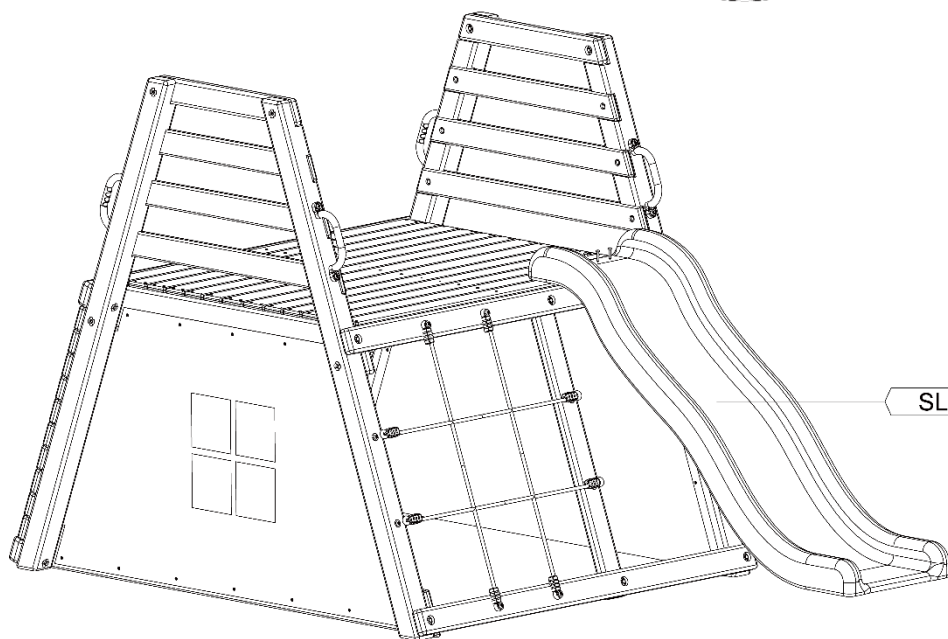
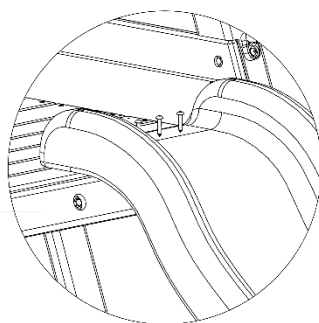

SL06

Step 16:

HD23 x4

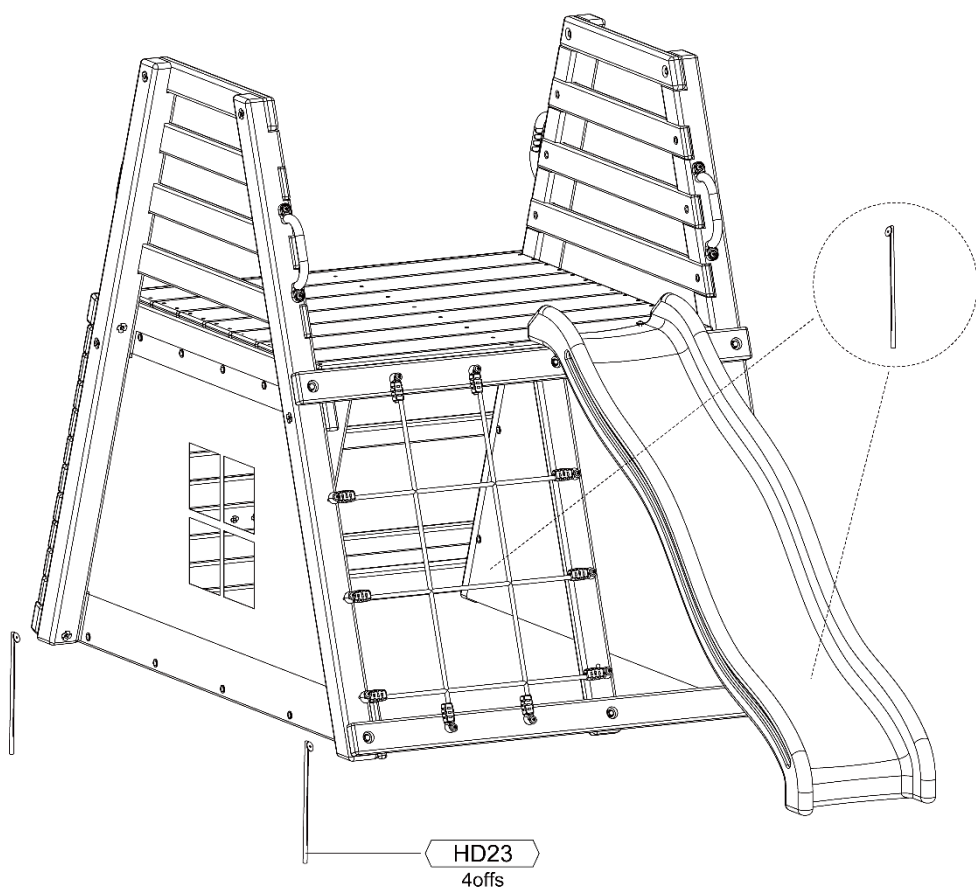

CLEANING & CARE

- All parts should be checked at least once a month.
- Check all nuts and bolts for tightness and tighten when required.
- Check for signs of wear to bolt coverings. If sharp edges are found, replace as required.
- In certain regions (seaside areas), certain coatings could be prone to damage. In this case, it is advised to use a rust prevention treatment.
- Check swing seats, chains, ropes and other means of attachment for evidence of deterioration; replace when required in accordance with the manufacturer's instruction.
- All parts that are under constant friction should be oiled regularly using a suitable lubricant.
- The ground on which the play centre is set up should be cleared regularly. All objects such as stones or anything else that could cause injury in the case of a fall should be removed.
- It is recommended that during the winter period when the equipment is not in use, all apparatus is removed to prevent deterioration due to bad weather.
- Sand rested areas and tubular members and repaint using a non-lead-based paint when required.
- Modifications to the original activity toy should only be carried out under instructions from the manufacturer.
- Defective parts should only be replaced in accordance with the manufacturer's instructions.
- For aesthetic reasons, you may want to apply a timber treatment to the timber parts.

All outdoor wooden products require routine inspection and regular maintenance. After installation, a follow-up inspection should take place after one week and twice a month thereafter for the remaining life of your play products. Maintenance should be performed at any time it is deemed necessary. Generally, major maintenance (wood refinishing) should be performed at twelve-month intervals from the date of installation. Inspect and perform maintenance based on the following checklist. Major wooden parts: Inspect for splintering and structure defects at regular intervals. For very minor splinters or chipping, lightly sanding and refinish with an exterior water repellent stain can assist. If timber has cracked or split significantly, replacement parts may be required, please contact national customer service centre for any replacement requirement. At regular intervals, the application of a penetrating oil-based sealer stain to all wooden components is essential. Please consult your local hardware or home improvement store for recommendation of an appropriate product, Ensure the product does not contain hazardous chemicals once dry that can pose a potential health risk to children. We hope you have a safe enjoyable time using the Multi play set.

SPECIFICATIONS

Fort platform	360 kg total weight
Swing belts	80kg
Trapeze	55kg
Full bucket swing	22kg
Toddler bucket swing	22kg
Slide	55kg
Rope ladder	34kg
Rock wall	68kg

NOTES

[illegible]

[illegible]

NOTES

[illegible]

Need more information?

We hope that this user guide has given you the assistance needed for a simple set-up.

For the most up-to-date guide for your product, as well as any additional assistance you may require, head online to **help.kogan.com**

kogan.com