

## YN360 II

Pro LED Video Light  
(General user manual 5500K  
color temperature and  
3200K-5500K color temperature)

Before using this product, please read this user manual carefully and keep it properly for reference.

### Overview

Thank you for using the YN360 II LED video light, which is a brand new video light design for photography. Equipped with built-in high capacity battery. It is no need to connect the external battery, which will increase the service time and more convenient and efficient. It adopts transparent cylinder design, which makes the lighting range wider and comfortable hand feeling. Adopts full color RGB SMD lamps and LED lamp beads, render rich full color fill light effect. The RGB SMD lamps color can be controlled by the mobile phone APP color mode, which makes the color types more rich. With the advantages of simple operation, practical use and color diversity.

## II. Function Introduction

1. The video light with LED lamp beads and full color RGB SMD lamps perfect integrated, which allows your creation colorful.
2. Equipped with built-in 5200mAh battery, combined with the quick charged chip, short charge time and long use time. It is no need to install the external battery, which convenient for outdoors use.
3. The main light adopts 320 pieces of extra-large luminous chips, the high display index LED lamp beads makes the color restore truly and naturally.
4. YN360 adopts encoder digital dimming system, including coarse tuning mode and fine tuning mode.
5. On the LED digital display screen of YN360, the parameter of the power output is intentional.
6. Shooting for long time is possible because YN360 supports external DC power input (power adapter is optional).
7. Supports external DC power input, it will charge the built-in battery when in use, which will convenient for your long time photographic use.
8. Supports YONGNUO LED wireless control system, the products can mutual communicate and synchronous control.

## III. Method of Application

### 1. External power supply

Use the YONGNUO power adapter to obtain long time use of the video light. When using the external power supply, it will charge the built-in battery until full charged; when not use the power adapter, it will automatically switch to charge the built-in battery. It takes 80 minutes to charge 80% of the battery. It can be continuous used 120 minutes under full electricity. The power supply interface is anode inside and cathode outside, the input voltage is 12V and the current is 2A.

3. Start up & Shut down and Brightness adjustment  
Press the power switch, the LED camera light enabled, rightwards rotate to increase the brightness, or leftwards rotate to reduce the brightness.

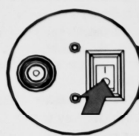

Brightness is adjusted by left and right rotation

### 4. RGB color switch button

Press the button when the red light on, the luminance of red light can be adjusted; when the green light on, the luminance of green light can be adjusted; and when the blue light on, the luminance of blue light can be adjusted. It can acquire different color by changing the luminance ratio of the three colors. Note: The RGB color mode and the 3200K/5500K color temperature mode can not be used at the same time.



Red mode

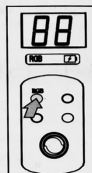

Green mode



Blue mode

### 5. Fine/Coarse button

Equipped with coarse and fine adjusting mode, which will be more convenient for use. Press the Coarse/Fine button to conduct to Fine/Coarse adjustment, when the indicator light of Coarse bright, it will enter into coarse adjusting mode, the luminance will be adjusted with 10% as an adjusting grade. Then press the button to switch to fine adjusting, the luminance will be adjusted with 1% as an adjusting grade.



Coarse tuning mode

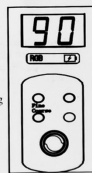

Fine tuning mode

### 6. Battery capacity testing button (Batt button)

Press the electric quantity testing button for electric test, the LED display shown is the battery capacity. The readings can be divided into P0-P9 which indicates 0%-90% of the electric quantity. The readings as the picture shown indicates the electric quantity is 30%. (Note: the rest electric quantity of test when the brightness is low is different from that of the test when the brightness is high, the service life is tested under the current brightness).

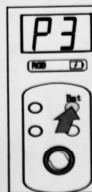

The digital tube display is the battery electricity quantity

7. 3200K/5500K color temperature switch button  
It can get the color temperature between 3200K to 5500K by changing the luminance ratio of the two color temperature. Note: the RGB color mode and the 3200K/5500K color temperature mode can not be used at the same time. the 5500K color temperature model does not need to switch the color temperature.

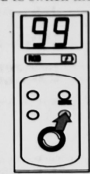

Press the button will adjust the luminance of the 3200K temperature.



Press the button will adjust the luminance of the 5500K temperature.

### 8. Channel Switching Button

Hold the battery capacity testing button for around two seconds to enter the channel switching. Short press to switch the channel you need, then hold around two seconds to quit channel switching. If you have more than one unit of the same model, the luminance and power switch can be controlled by grouping, at most divided into eight groups.

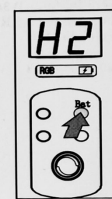

Adjust the channel of the video light to the channel needed

## IV. Product Specification

### \*3200K/5500K color temperature

Light Source	320 LED lamp beads and 40 RGB SMD lamps		
Color Temperature	3200K、5500K and RGB full color		
Output power	19W and 8W	Control distance	<15M
Lumen	2480LM and 494LM	Mobile control	Bluetooth 4.0
Weight	1134G	Average Service Life	50000H
		Luminance Angle	55°and 110°
Compatible batteries	One NP-F750 series lithium batteries		
External power source	12V 2A DC power supply		
Size	595*115*50MM		
Contents: Video light (1), User Manual (1), Storage bag (1), power adapter (1) Note: Please contact your dealer if anything missing.			

### \*5500K color temperature

Light Source	320 LED lamp beads and 40 RGB SMD lamps		
Color Temperature	5500K and RGB full color		
Output power	19W and 8W	Control distance	<15M
Lumen	2560lm and 494lm	Mobile control	Bluetooth 4.0
Weight	1134g	Average Service Life	50000H
		Luminance Angle	55° and 110°
Compatible batteries	One NP-F750 series lithium batteries		
External power source	12V 2A DC power supply		
Size	595*115*50MM		
Contents: Video light (1), User Manual (1), Storage bag (1), power adapter (1) Note: Please contact your dealer if anything missing.			

## V. Mobile APP Remote Control

The product supports mobile remote control, the APP can be downloaded from the YONGNUO official website or download through scanning the two-dimension code on the gift box. Mobile phone APP will be updated continuously. Please pay attention to YONGNUO official website for latest version of APP to get better remote control experience.

## VI. Failure Analysis and Troubleshooting

When using this product, you may encounter the following problems

Description	Cause	Troubleshooting
No reaction after power on	Low Battery	recharged or connect external power supply
	Damaged circuit board	Depot repair
Inadequate or low luminance at the greatest luminous intensity	Low battery	recharged or connect external power supply
Inaccurate battery capacity test; low battery in high luminance and full battery in low luminance.	The battery capacity indicates the length of time available for the use in the current luminance. Higher luminance required more power and the length of time available for use will be shortened, so the battery capacity shown gets lower	Normal phenomenon and no measure needed
The mobile phone could not remote control the video light	Too far away	Ensure the remote control distance is no more than 15 meters

SHENZHEN YONGNUO PHOTOGRAPHY EQUIPMENT Co.Ltd.  
Add: Building A, Shenfubao modern optics factory, Kengzi Street, Pingshan District, Shenzhen  
TEL: 0755-8376 2448  
Wed: www.hkynuo.com  
Manufacture address: 3/F 4/F Building B 3/F Building A 301 No. 104 Huangqianzhong Rd. Songyuan Community Guanhu Str. Longhua Shenzhen  
After-sales Service TEL: 400-0013-888

## I. Product Structure

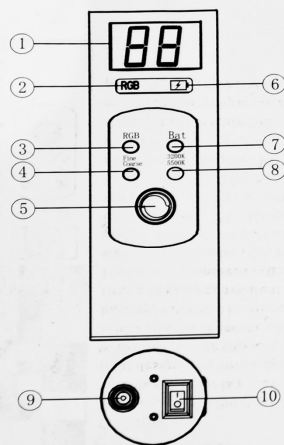

1. LED digital display screen
2. RGB color light
3. RGB color switch button
4. Fine/Coarse button
5. Brightness adjustment encoder
6. Charging indicator light (light on: in charging; light off: full charged)
7. Battery capacity testing button (Batt button)
8. 3200K/5500K color temperature button
9. Power switch/ Luminance adjusting knob
10. power switch

2. Fasten Video Light As Follow As Needed:  
a. Fasten the video light to the tripod directly

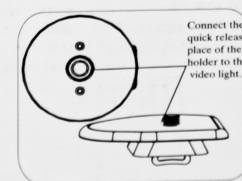
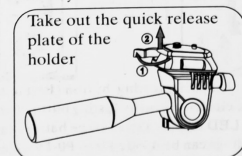

Fasten the video light to the tripod