

vtech®

Parent's Guide

Kidi★Star DANCE™



91-003674-004^{US}

INTRODUCTION

Thank you for purchasing the **Kidi Star Dance™** system!

Learn 20 cool dance moves step by step by following the animated dance trainer. Then, challenge a friend to a dance-off using the bands.

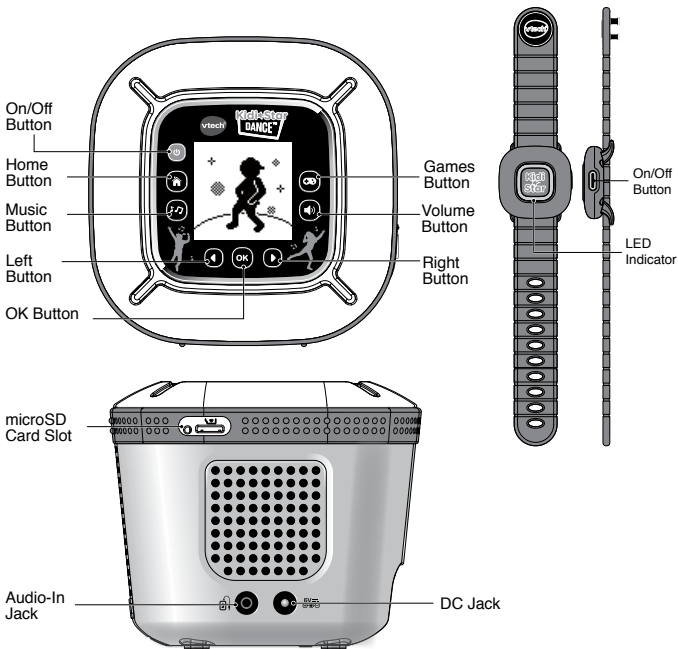

INCLUDED IN THIS PACKAGE

- One **Kidi Star Dance™** unit
- Two bands (with CR2025 battery pre-installed)
- One audio cable
- One parent's guide

WARNING:

All packing materials such as tape, plastic sheets, packaging locks, removable tags, cable ties and packaging screws are not part of this toy, and should be discarded for your child's safety.

NOTE: Please keep this parent's guide as it contains important information.

ATTENTION :

Pour la sécurité de votre enfant, débarrassez-vous de tous les produits d'emballage tels que rubans adhésifs, feuilles de plastique, attaches, étiquettes et vis d'emballage. Ils ne font pas partie du jouet.

NOTE : Il est conseillé de conserver ce guide des parents car il comporte des informations importantes.

Unlock the packaging locks:

- ① Turn the packaging lock counterclockwise several times.
- ② Pull out and discard the packaging lock.

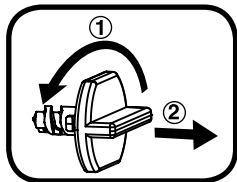

GETTING STARTED

BATTERY INSTALLATION

The **Kidi Star Dance**™ system uses 4 AA batteries or a VTech® 6V adapter (sold separately).

- Make sure the main unit is turned **OFF**.
- Locate the battery cover on the bottom of the main unit.
- Use a screwdriver to open the battery cover.
- Install 4 new AA batteries as illustrated. (The use of new alkaline batteries is recommended for maximum performance).
- Replace the battery cover.

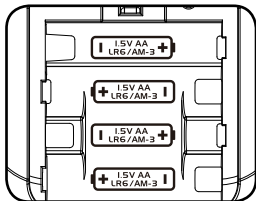
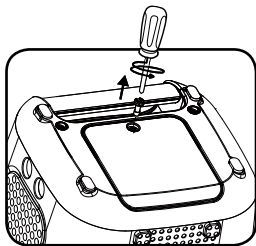

BATTERY NOTICE

- Use new alkaline batteries for maximum performance.
- Use only batteries of the same or equivalent type as recommended.
- Do not mix different types of batteries: alkaline, standard (carbon-zinc) or rechargeable, or new and used batteries.
- Do not use damaged batteries.
- Insert batteries with the correct polarity.
- Do not short-circuit the battery terminals.
- Remove exhausted batteries from the toy.
- Remove batteries during long periods of non-use.
- Do not dispose of batteries in fire.
- Do not charge non-rechargeable batteries.
- Remove rechargeable batteries from the toy before charging (if removable).
- Rechargeable batteries are only to be charged under adult supervision.

POWER ADAPTER CONNECTION

You may purchase a **VTech**® 3.5mm DC 6V power adapter by visiting our website at vtechkids.com. Hover over the “Support” option on the top menu bar and choose “Order Replacement Parts” from the menu that appears below. Or call our Consumer Services Department at 1-800-521-2010 in the US or 1-877-352-8697 in Canada.

To connect the adapter to the unit, follow the instructions below:

- Make sure the unit is **OFF** and ensure no batteries remain inside the unit.
- Locate the 3.5mm **DC Jack** on the side of the unit.
- Connect a power adapter (not included) into the **DC Jack**.
- Insert the other end of the power adapter into a wall outlet.
- Turn the unit **ON**.

TRANSFORMER SAFETY NOTICE

- Using a 3.5mm/1.3mm (positive center) 6V/800mA DC output AC adaptor is recommended.
- This toy shall only be used with a transformer for toys.
- The transformer is not a toy.

- This toy is not intended for use by children under 3 years old.
- Do not connect the toy to more than the recommended number of power supplies.
- Never clean a plugged-in toy with liquid.
- Please regularly examine the transformer, checking for damage to the cord, plug, transformer and other parts. Do not use the transformer if it is damaged.

MEMORY CARD INSTALLATION

The **Kidi Star Dance™** system is compatible with microSD/microSDHC memory cards up to 32GB.

- Make sure the main unit is in **OFF**.
- Pull away the rubber covering on the **microSD Card Slot**, located on the side of the unit.
- Insert the memory card (not included) as illustrated.
- To remove the memory card from the slot, push the card and it will eject.

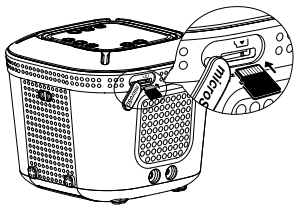

Note: To prevent accidental data loss, make sure you have backed up all important data from your memory card before using it.

⚠ **WARNING:**

The bands with this product contain a button or coin cell battery. A swallowed button or coin cell battery can cause internal chemical burns in as little as two hours and lead to death. Dispose of used batteries immediately. Keep new and used batteries away from children. If you think batteries might have been swallowed or placed inside any part of the body, seek immediate medical attention.

⚠ **ATTENTION !**

Ce jouet contient une pile bouton ! L'ingestion d'une pile bouton peut causer des brûlures internes pouvant provoquer la mort dans un délai de 2 heures. Jeter les piles usées immédiatement après les avoir retirées du jouet. Garder les piles neuves hors d'atteinte des enfants. Si vous remarquez qu'une pile bouton a été avalée, consultez immédiatement un médecin.

BAND USAGE

Power On

Press the **On/Off Button** on the side of the face to turn on the **Band**.

If you've just taken the **Bands** out of the packaging for the first time, you need to remove the battery strip before use.

Power Off

Press and hold the **On/Off Button** for two seconds.

Auto Power Off

The **Bands** will automatically power off if unused for a short period of time.

LED Indicator

The **Band** LED will flash periodically to show it is working normally. If the LED flashes twice in succession, the battery is low and you should replace it soon.



BAND BATTERY INSTALLATION

1. Remove the wristband from the **Band's** face by pulling it through the fitting guides.
2. Locate the battery cover on the back of the **Band's** face and open it with a screwdriver.
3. Remove the battery cover and insert a CR2025 battery as illustrated.
4. Replace the battery cover and fasten the screw.
5. Repeat steps 1-4 on the second **Band**.

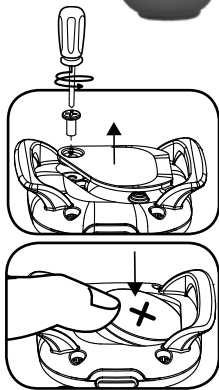

BAND BATTERY NOTICE

- Use one CR2025 Lithium coin battery only for each **Band**. Do not use rechargeable Lithium ion battery LIR2450. This toy is not compatible with LIR2450.
- The coin battery used with this product should be kept away from small children who might still put things in their mouths. If the coin battery is swallowed, consult a doctor immediately.
- Insert the coin battery with the correct polarity.

- Do not use a damaged coin battery.
- Do not short-circuit the coin battery terminals.
- Remove exhausted coin battery from the product.
- Remove coin battery during long periods of non-use.
- Do not dispose of coin battery in fire.
- Do not charge a non-rechargeable coin battery.
- Rechargeable batteries are to be removed from the toy before being charged. (if removable)
- Rechargeable batteries are only to be charged under adult supervision.

TO BEGIN USING KIDISTAR DANCE

Power On

Press the **On/Off Button**  to turn on the main unit. If you've just taken the **Kidi Star Dance™** system out of its packaging for the first time, you need to disable Try-Me mode before playing. Press the **OK Button** during the Try-Me movie to exit Try-Me mode.

Band Pairing

After exiting the Try-Me mode, you will be asked to pair the **Bands** before playing for the first time. Turn on your **Bands** and press the **OK Button**  to start the pairing procedure. Shake the **Band** that you want it to be paired as Band A first, and then shake the other **Band** to be Band B.

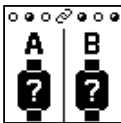



If the main unit cannot recognize the **Bands** during pairing, power off the **Bands**, turn them on and shake again.

NOTE: If for any reason you want to pair only one **Band**, after Band A is paired, you can press the **OK Button**  to skip Band B pairing.

Auto Power Off

To preserve battery life, the **Kidi Star Dance™** system will automatically shut down if there is no operation for a short period of time.

Volume Control

Press the **Volume Button**  and press the **Left**  or **Right**  **Buttons** to adjust the volume.

NOTE: Audio-in volume is not controlled by the **Kidi Star Dance™** system, please use the connected music device to control the audio-in volume.

BATTERY STATUS

When the batteries for the main unit are low, the screen will display the Low Battery icon and the unit will automatically shut off. New batteries should be installed before further use.

When the battery is low on one of the bands, the screen will display a Band Low Battery icon.



ACTIVITIES

Home Menu

1. Dancing Academy

Select a dance move from the menu and follow along with the dancer to learn it. The icon in the lower-left shows the move's difficulty.



2. Dancing Challenge

Use the moves you learn in Dancing Academy to dance along to eight original songs. Challenge a friend and see who knows the moves best!



3. Free Dance

Select a music style and dance along with the music as the lights follow your moves.



4. Freeze Dance

Select a song to play and follow the funny dance prompts, just don't move when the music stops!



5. System Setup

Band Pairing

- Pair the **Bands** with the main unit

Band A/B SFX

- Set the default sound effect response for Band A/B

Music Playtime

- Set the maximum playtime for music playback. The main unit will turn off automatically after the time is reached.

Factory Reset

- Reset your **Kidi Star Dance™** system to factory settings

After a factory reset, the bands will no longer be paired with the system. Please turn the bands off and on again before pairing them again.

Music Menu

1. MP3 Player

Play MP3 files from your memory card (not included) or songs from Dancing Challenge when no memory card is present.

Press the **Left** or **Right Buttons** to select a function icon and press the **OK Button** to confirm.



 Play or pause the music

 Play previous or next song

 Option Menu

- Play All: Play all songs in order
- Repeat All: Loop all songs continuously
- Repeat One: Play the current song on loop
- Shuffle All: Shuffle all songs
- Play Folder: Play all the songs stored in a single folder (not including sub-folders). Press the **Left** and **Right Buttons** to navigate through folders and press the **OK Button** to select a file or folder. Press the **Music Button** to return to the play screen.

NOTE:

The maximum playtime is 2 hours by default and can be adjusted in the System Setup Menu.

After the music is playing for 20 seconds, animations will start playing with light effects. Press the **Left** or **Right Buttons** to choose between 10 different light effects or turn off the effects. Press the **OK Button** to return to the music player.



2. Audio-In Connection

Plug in your own music player to the **Audio-In Jack** on the side and watch the lights dance along.

NOTE: Sound from a device using the **Audio-In Jack** will play through the **Kidi Star Dance™** speakers in any activity. The audio-in volume is controlled by the volume setting on your external device.

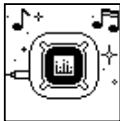

Game Menu

1. Beat Jam

Shake your **Band** when the falling icon crosses the line to play along with the music. Band A controls the left instrument, and Band B controls the right. Wear them both or give one to a friend to play together!

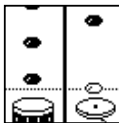

2. Music Bubble

Shake your **Bands** to keep the music afloat. Band A guides the music bubble to one way, and Band B pushes it the other way. Try to avoid obstacles as the levels get harder.



3. Funny Conductor

Take a turn conducting the orchestra by waving your **Band** to the beat. Try to wave your hand when the baton symbol enters the target. Go too slow and the music will stop, too fast and it will just sound silly.

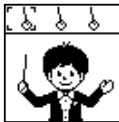

4. Magic Moves

Select an object and shake your **Bands** to make some funny sounds!



5. Motion Challenge

Select a challenge and play with your friend or the computer. Follow the instructions and perform the action as quickly as possible within the time limit, and see who is the winner!



DANCING CHALLENGE SONG LYRICS

The Funky Bear

Verse 1:

Let's do the funky bear
Join me, do you dare?
Let's do the funky bear right now,
C'mon I'll show you how!

Chorus:

Roar, roar like a bear,
Shout it out with some flair!
Stomp, stomp like a bear,
Try n' give me a scare!
Swim, swim like a bear,
Let's catch some fish to share!
Roar, roar like a bear,
Let's do the funky bear!

Verse 2:

Do you feel it in the air?
It's the beat of the funky bear
Come on let's give it a shot,
And show me what you got!
(Chorus)

Our Favorite Song

Verse 1:

I hear the music playing
The beat is loud, I feel amazing
All I wanna do is get up
With my friends now, let's stand up!

Chorus:

Put your hands up and wave them along,
To our favorite song
Nod your head to the beat,
Let's dance to our favorite song
Sway side to side, and clap your hands,
To our favorite song
Jump up and down to the beat,
Let's dance to our favorite song

Verse 2:

I see the lights flashing
All over the floor, it's so exciting
All I wanna do is get up
With my friends now, let's stand up!
(Chorus)

Join the Parade

Verse 1:

Lookin' out my window
I see the crowds forming
The music's boomin'
I can feel my heart beatin'
I can't help but try and see what's happenin'
Running through the crowd
I'm about to shout out loud...

Chorus:

Wa-oh-wa-oh-wa-oh,
Let's join the parade
Wa-oh-wa-oh-wa-oh,
Let's dance, don't be afraid!
Wa-oh-wa-oh-wa-oh,
Let's march with our friends
Wa-oh-wa-oh-wa-oh,
Let's do it all again

Verse 2:

Everyone is dressed up
In such crazy costumes
Come on and dress up with me
What do you wanna be?
(Chorus)

It's Magic

Verse 1:

When we are together, hanging out
It's always fun, there really is no doubt
When I'm feeling sad or a little blue
You always turn my frown into a smile, it's true

Chorus:

How do you do that?
It's magic
How do you do-oooh that?
It's magic, whoah-oh-oh
It's magical...
With you, every moment's never dull
With you, it's magical,
That we're just so compatible

Verse:

When we're laughing and having lots of fun
I'm so happy my best friend's number one
I promise that I'll be there for you
Thank you for being there for me too

Dance, Dance, Dance

Verse 1:

Put on the music, are you listening?

The beat is playing loud and the lights are glowing.

Are you ready, to move your body?

Come on let's dance to the rhythm it's fun you'll see.

Chorus:

Just listen to the beat and move your feet,
Just close your eyes and follow me now!

Dance, dance, dance, to the beat,

Come on let's stomp, stomp, stomp in the streets,

Put your hands together,

Clap, clap, clap to the beat,

Let's lift our feet and

Jump, jump, jump feel our heart beat, yeah

Verse 2:

I feel alright under the spotlight

I'm with my friends right now and we're 'bout to ignite

It's up to us now

We're gonna sing loud

Come on let's dance to the rhythm in front of the crowd

(Chorus)

Vacation

Verse 1:

Packing up all my clothes in a suitcase

Making sure that everything's in place

Cause I'm gonna go away on vacay

Chorus 1:

On vacation with my friends

Gonna make some new memories

I'm gonna play in the sun

I'm gonna have lots of fun, yeah

Verse 2:

I feel the sand underneath my toes

I see the waves ebbing to and fro-oh-oh

I just love goin' away on vacay

Chorus 2:

On vacation with my friends

Gonna make some new memories

I'm gonna play in the sun

I'm gonna have lots of fun

'Cause I'm on a vacay with my friends

Gonna make some new memories

I'm gonna play in the sun

I'm gonna have lots of fun, yeah

Stronger Than You Know

Verse:

Sometimes when things are tough, you
might feel like giving up

No matter, what you do, it feels like it's not
enough

Don't stop believing in everything you do

Just know that, everyone's with you every
step of the way

Chorus:

You are stronger than you know

Don't forget when you feel low

Keep moving forward don't look back

You're strong remember that

You are stronger than you know

Don't forget when you feel low

Keep moving forward don't look back

You are strong remember that

Please don't forget...

You are stronger than you know

You are stronger than you know

Candy Wonderland

Verse 1:

Take me to a place that's sweet

Where the gum drops and jelly beans gleam

Look out the window, what do I see?

We've arrived here, finally!

Chorus:

We're here at the candy wonderland,

With gummy bears and lollipops in my hand

Candies, I love eating candies

Gimme a, gimme a treat please

Verse 2:

Let's go out looking for our favorite candy

So many colors, what do you see?

Red, orange, yellow and green,

Sparkling back at me!

(Chorus)

EPILEPSY WARNING

A small percentage of users may experience epileptic seizures when viewing flashing lights or patterns.

Please consult your doctor if you have an epileptic condition or experience any unusual symptoms while playing. If you feel at all uncomfortable, please cease playing.

TROUBLESHOOTING

Problem	Possible cause	Correction
Your Kidi Star Dance™ system has stopped working or will not turn on	Incorrect battery polarities	Ensure that the batteries are installed correctly
	Weak batteries	Replace with new batteries
	AC/DC connection problem	Ensure that the adaptor connection is secure
Memory card not detected	Memory card is not fully inserted to the slot	Check if the memory card is inserted correctly
	Memory card format is not supported	Check to see if the memory card is a supported type. The Kidi Star Dance™ system only supports microSD or microSDHC card from 1 to 32GB and formatted in FAT/FAT32 file systems. The Kidi Star Dance™ system does not support NTFS or other file systems.
Can't play the MP3 files on the memory card	MP3 format is not supported	The Kidi Star Dance™ system only supports the MP3 MPEG-1 Audio Layer 3 format. Other MP3 formats are not supported.

TROUBLESHOOTING

Problem	Possible cause	Correction
Bands have no response in motion games	The Bands are not turned on	Make sure you turn on the Bands before use. To preserve battery life, the Bands will auto power off when idle for over 3 minutes, you need to turn them back on to use them again.
	The Bands have not been paired with the main unit	Make sure you have paired the two Bands with the main unit before use. To pair the Bands, please go to HOME > SYSTEM SETUP > BAND PAIRING
Bands respond slowly	Band battery power is low	Replace with new Band batteries
	There's interference from other wireless device(s)	Check if there are other wireless devices operating in close proximity to the Kidi Star Dance™ system, such as a router or cordless phone. Try another location to see if that solves the problem.

Problem	Possible cause	Correction
One of the Bands has no response in a game	Only one Band is paired with the main unit	Re-pair to add the second Band. To pair the Bands, please go to HOME > SYSTEM SETUP > BAND PAIRING
	Two-player mode was not selected at the beginning of game	In Motion Challenge or Dancing Games, please make sure to use the Left and Right Buttons to select Band A + B mode before playing.
During pairing my Band has been turned on and shaken but it is not recognized by the main unit	The Band needs to be reset	Please turn the Band off and turn it on again and try to pair again.

IMPORTANT NOTE:

Creating and developing **VTech®** products is accompanied by a responsibility that we at **VTech®** take very seriously. We make every effort to ensure the accuracy of the information, which forms the value of our products. However, errors sometimes can occur. It is important for you to know that we stand behind our products and encourage you to call our Consumer Services Department at 1-800-521-2010 in the U.S. or 1-877-352-8697 in Canada, or by going to our website at vtechkids.com and filling out our Contact Us form located under the Customer Support link with any problems and/or suggestions that you might have. A service representative will be happy to help you.

NOTE:

This equipment has been tested and found to comply with the limits for a Class B digital device, pursuant to Part 15 of the FCC Rules. These limits are designed to provide reasonable protection against harmful interference in a residential installation. This equipment generates, uses and can radiate radio frequency energy and, if not

installed and used in accordance with the instructions, may cause harmful interference to radio communications. However, there is no guarantee that interference will not occur in a particular installation. If this equipment does cause harmful interference to radio or television reception, which can be determined by turning the equipment off and on, the user is encouraged to try to correct the interference by one or more of the following measures:

- Reorient or relocate the receiving antenna.
- Increase the separation between the equipment and receiver.
- Connect the equipment into an outlet on a circuit different from that to which the receiver is connected.
- Consult the dealer or an experienced radio/TV technician for help.

Supplier's Declaration of Conformity

Trade Name: VTech®
Model: 5205
Product Name: Kidi Star Dance™
Responsible Party: VTech Electronics North America, LLC
Address: 1156 W. Shure Drive, Suite 200,
Arlington Heights, IL 60004
Website: vtechkids.com

THIS DEVICE COMPLIES WITH PART 15 OF THE FCC RULES. OPERATION IS SUBJECT TO THE FOLLOWING TWO CONDITIONS: (1) THIS DEVICE MAY NOT CAUSE HARMFUL INTERFERENCE, AND (2) THIS DEVICE MUST ACCEPT ANY INTERFERENCE RECEIVED, INCLUDING INTERFERENCE THAT MAY CAUSE UNDESIRE OPERATION.

Caution: Changes or modifications not expressly approved by the party responsible for compliance could void the user's authority to operate the equipment.

**CLASS 1
LED PRODUCT**

**Visit our website for more
information about our products,
downloads, resources and more.**

vtechkids.com

Read our complete warranty policy online at
vtechkids.com/warranty

