



PACKTALK BOLD

EN POCKET GUIDE



OPERATED BY
NATURAL VOICE



POWERED BY
DMC

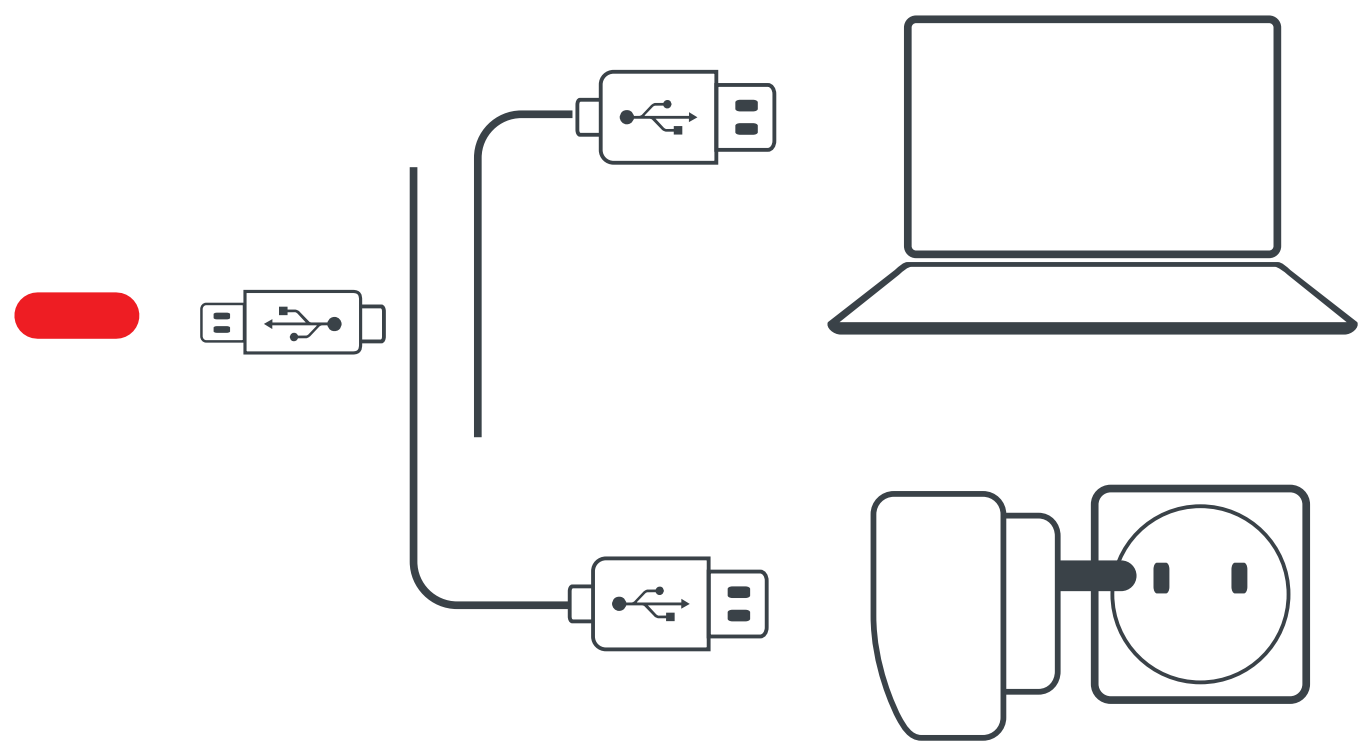
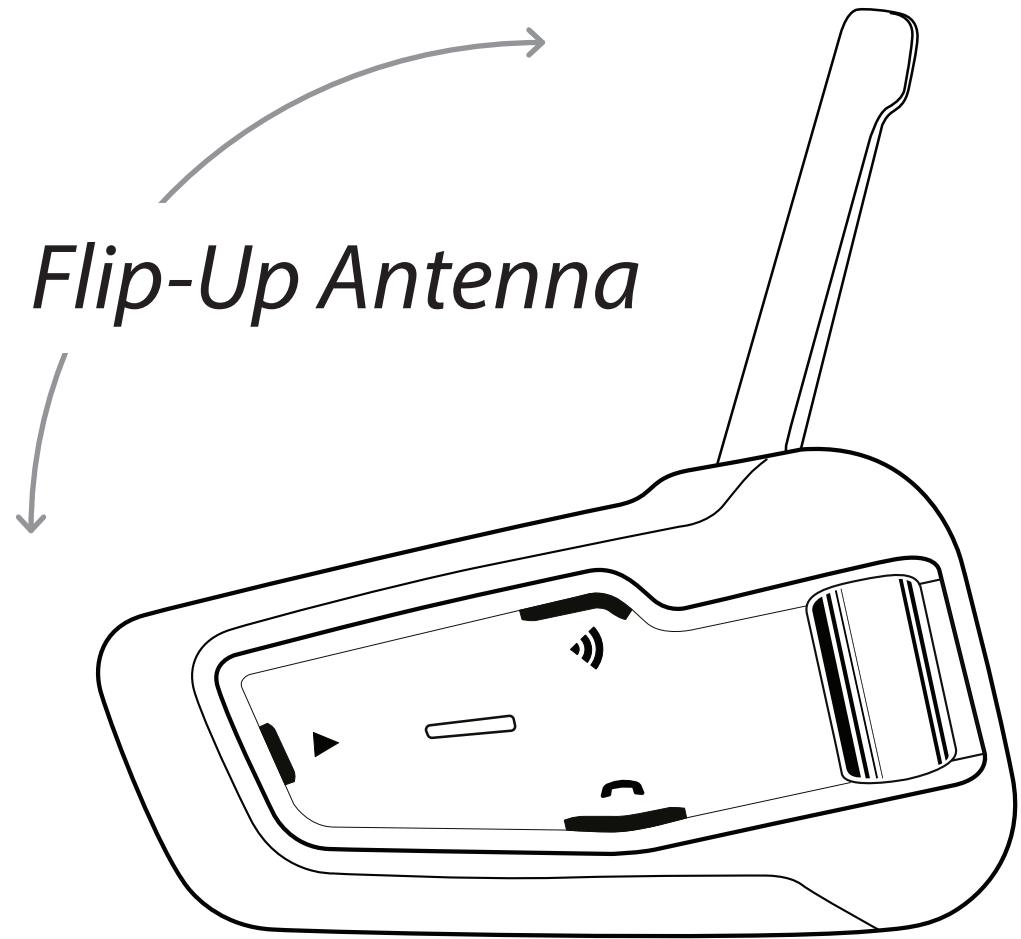
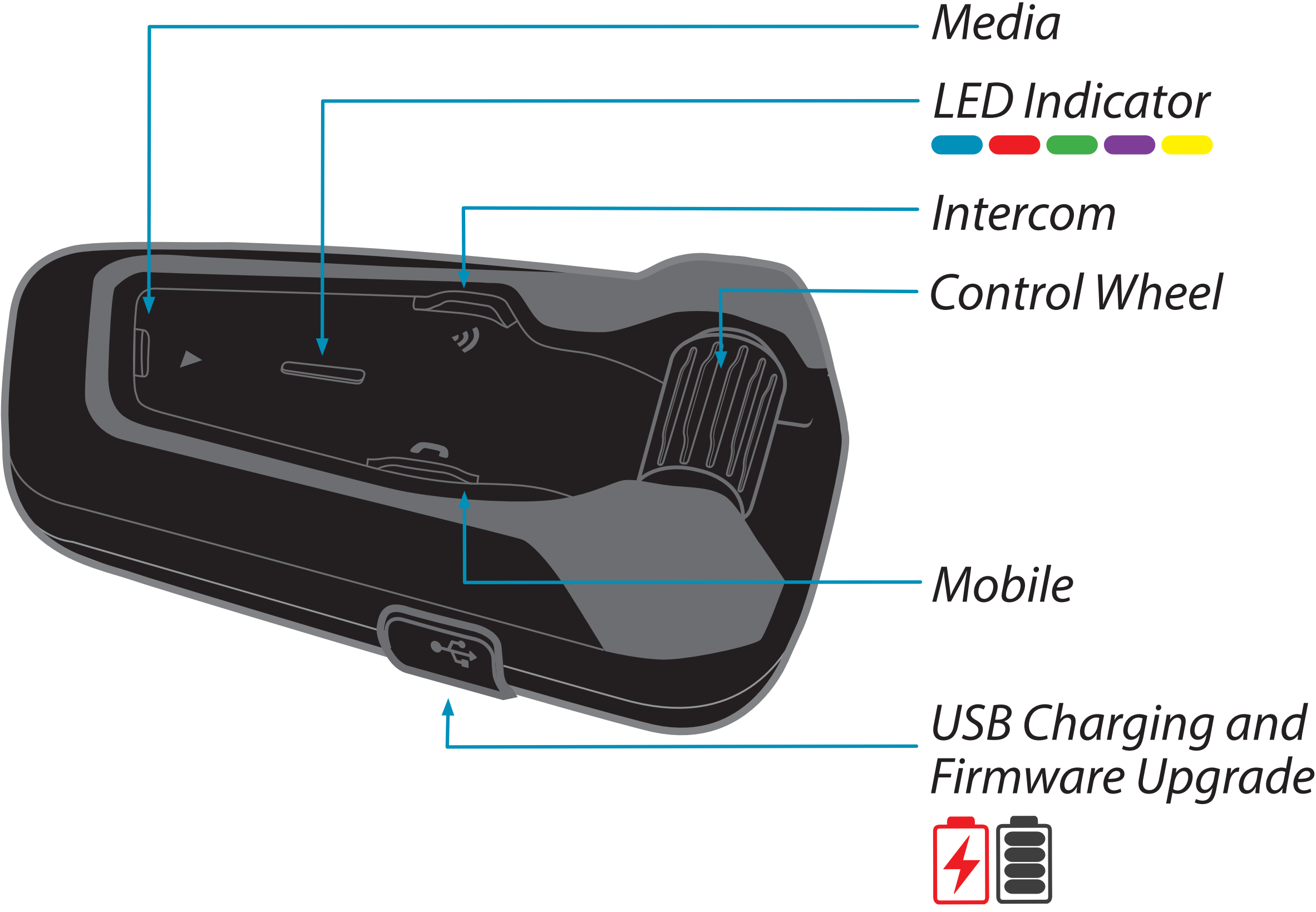

“Language can be changed via the Cardo Connect mobile app”

Getting Started



On / Off

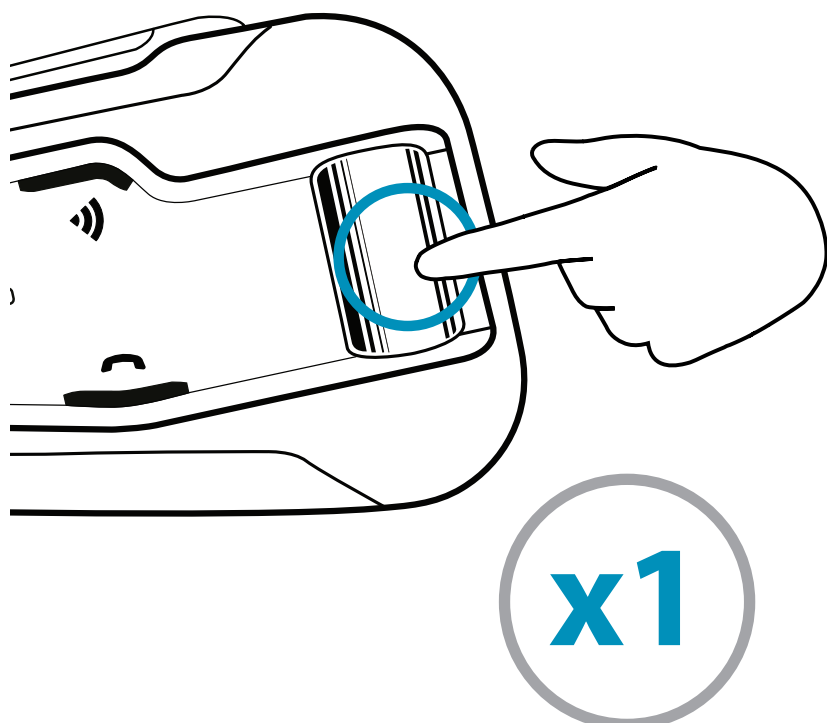
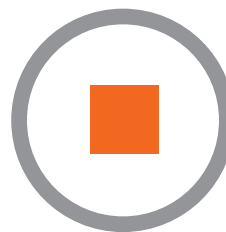
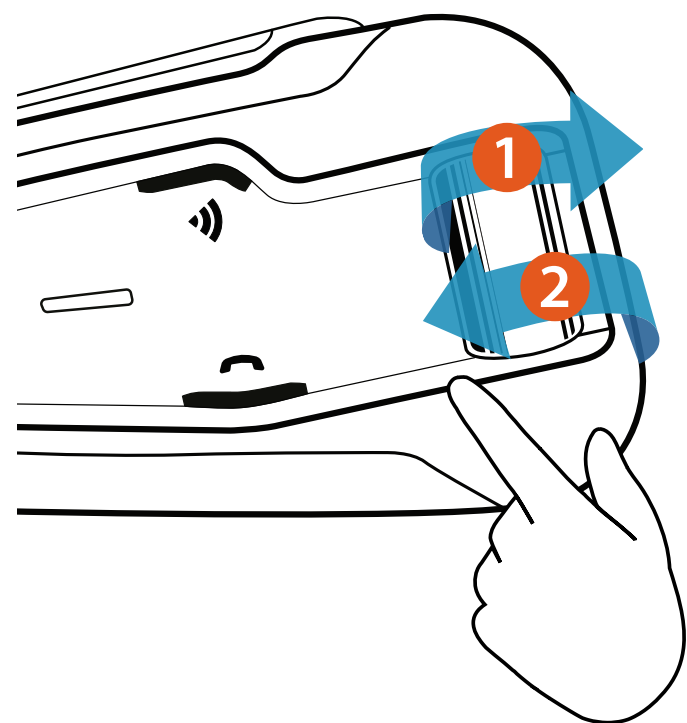
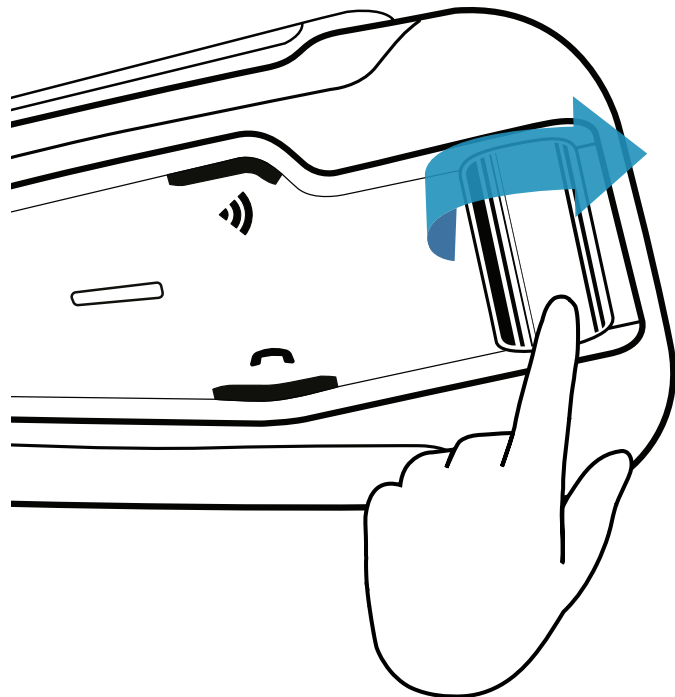
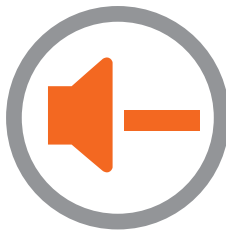
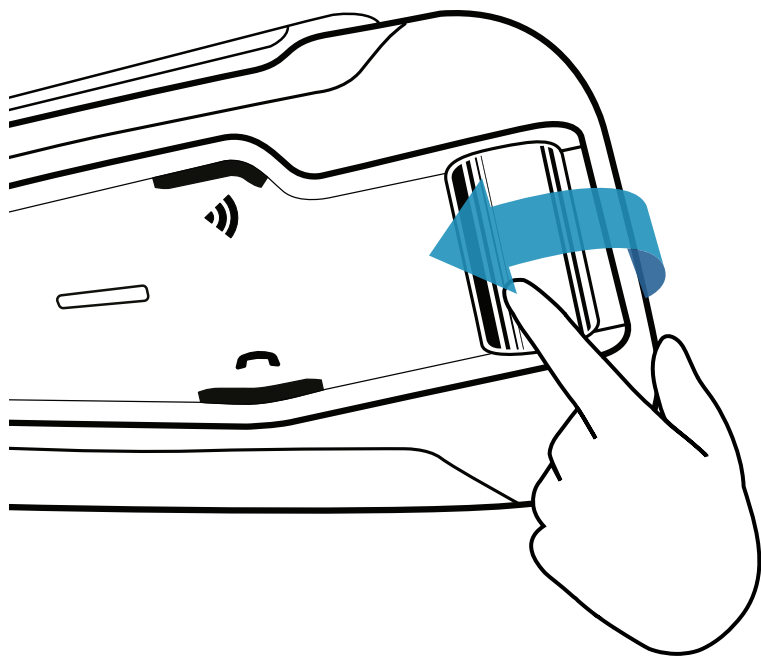
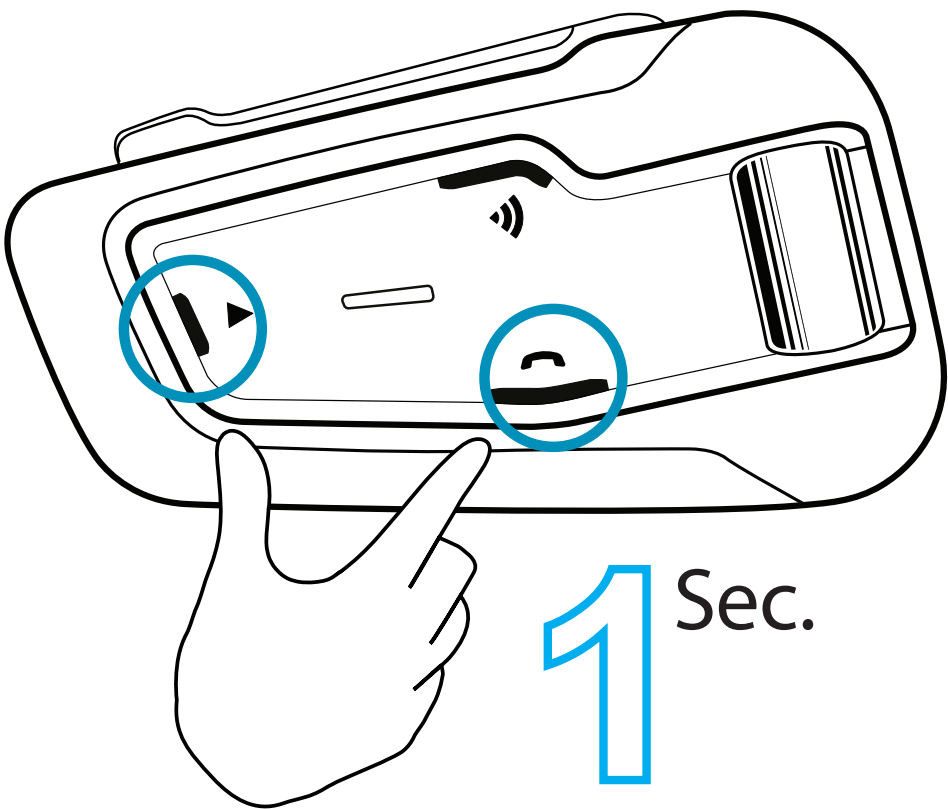

Use while charging

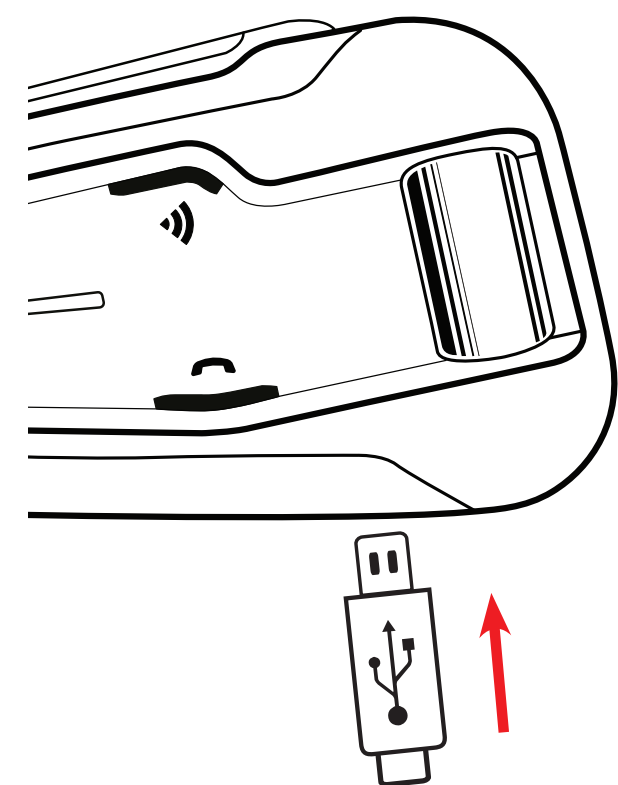

1 Sec.

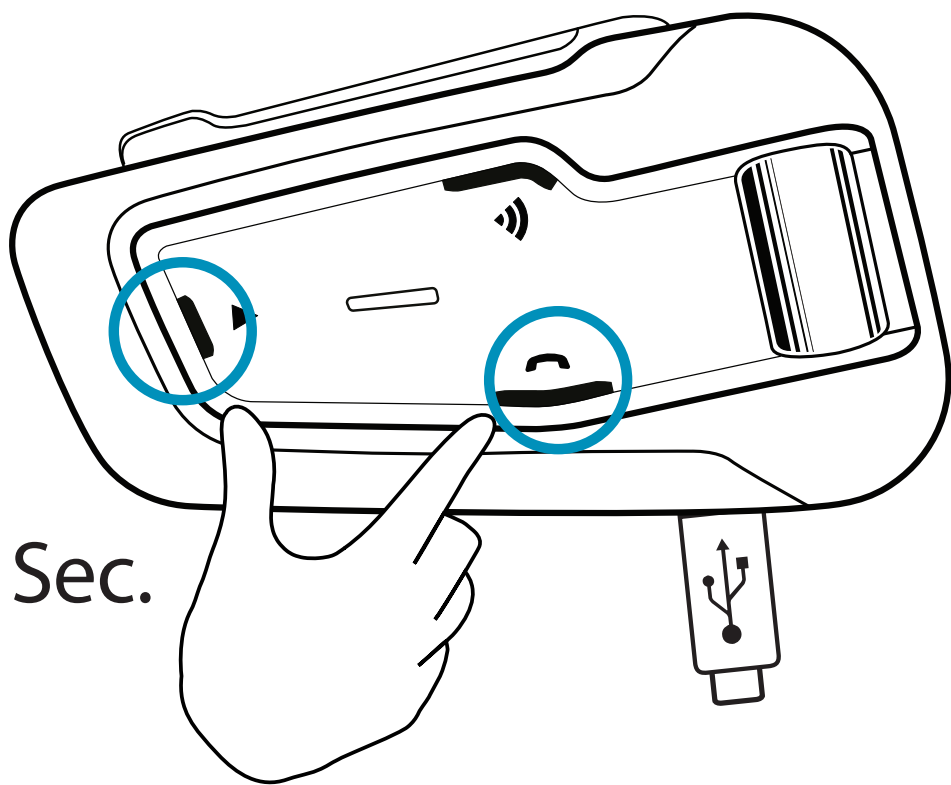

Pair Mobile Devices

1 Initiate Pairing

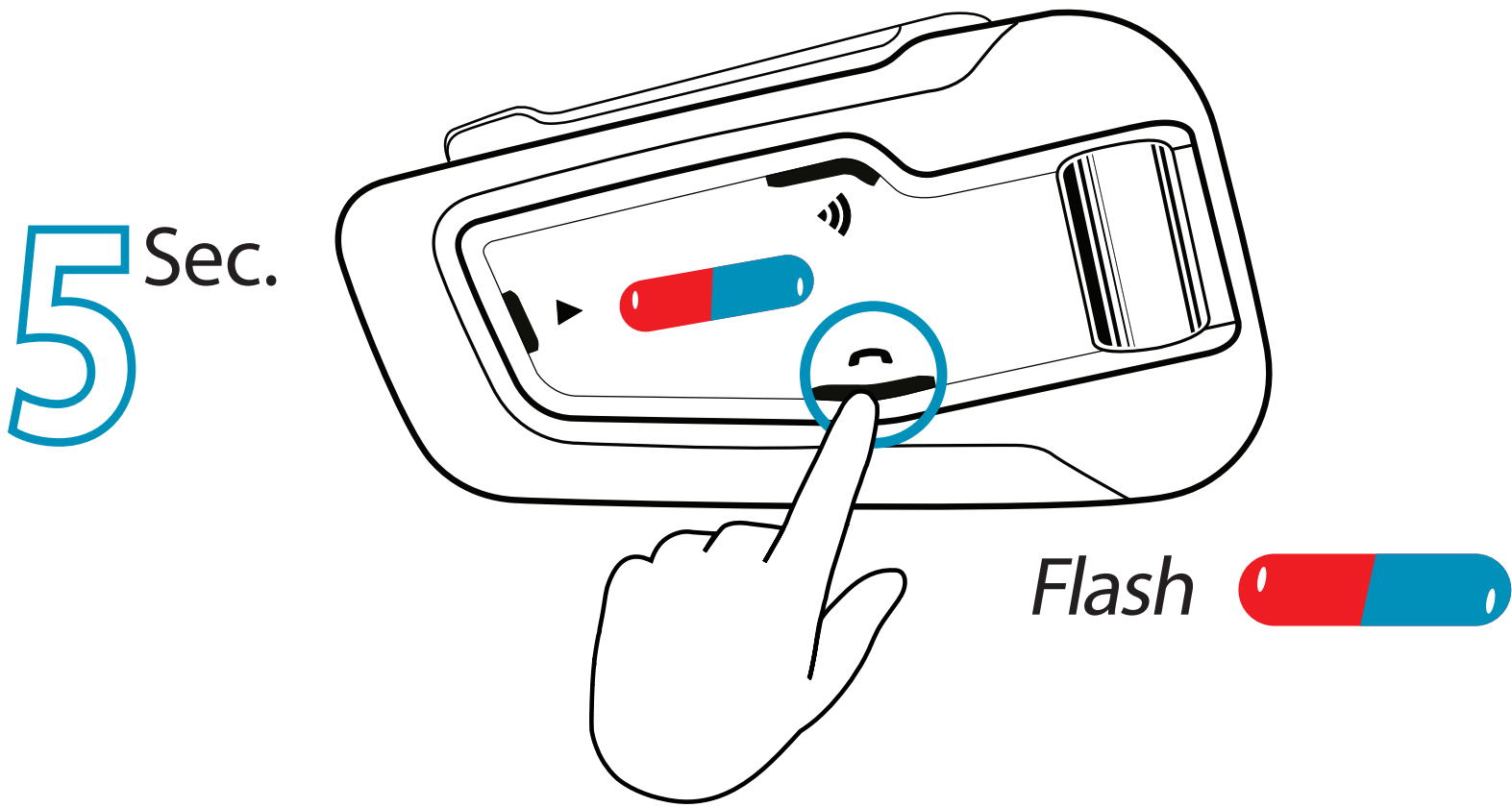

2 Pair Phone

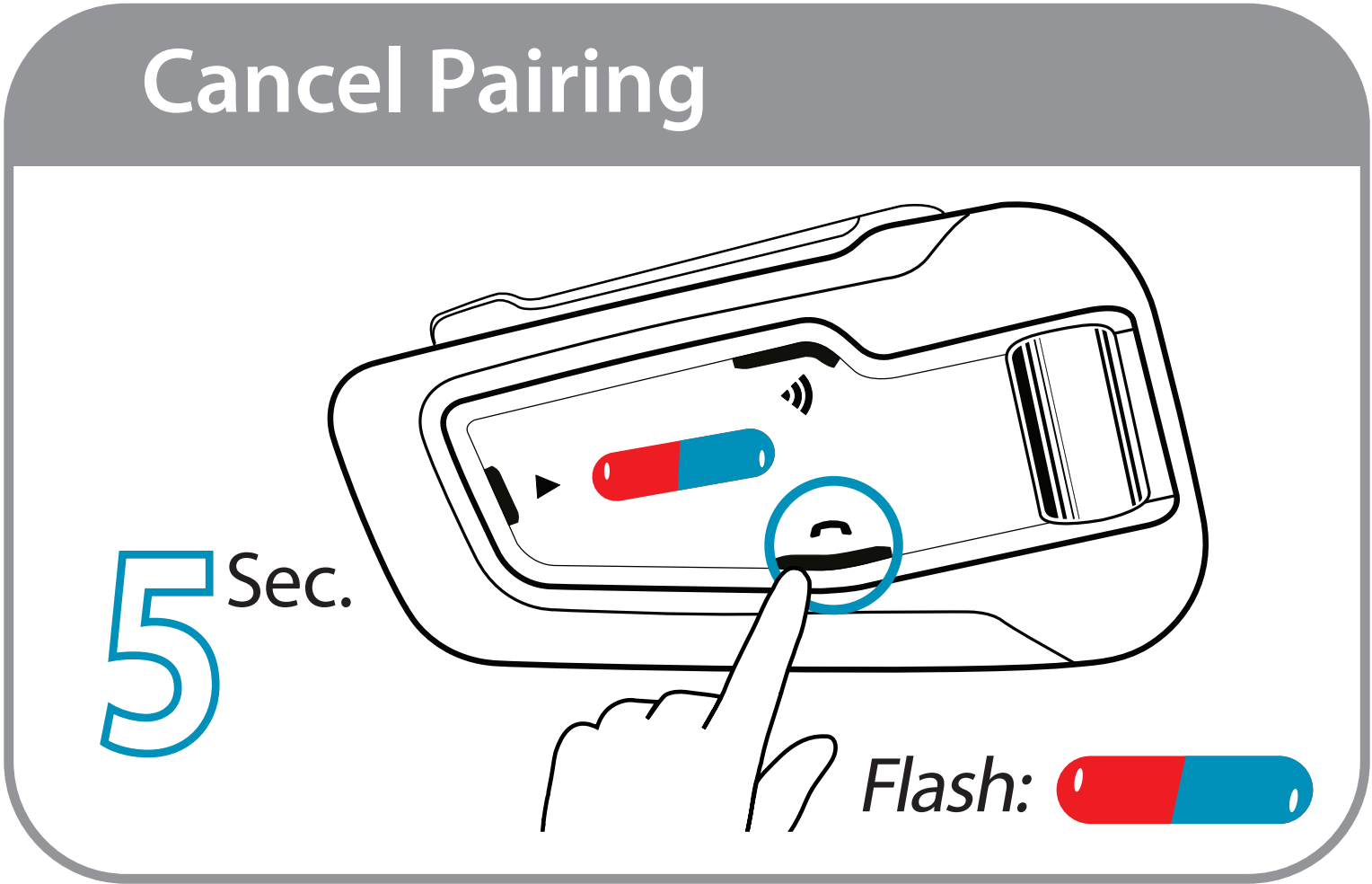

Pair Mobile Devices

1 Initiate Pairing

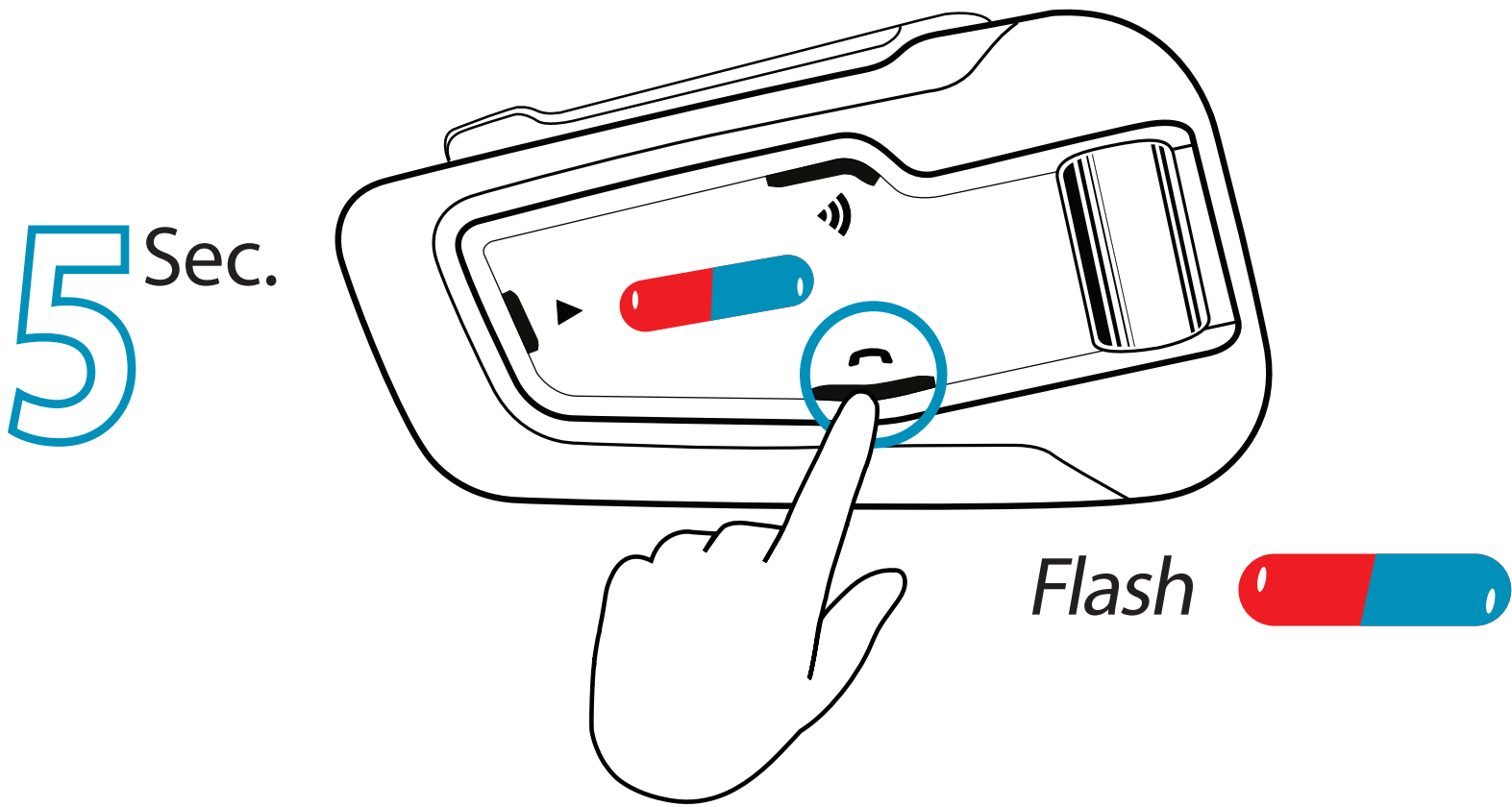

2 Add a 2nd Phone / GPS

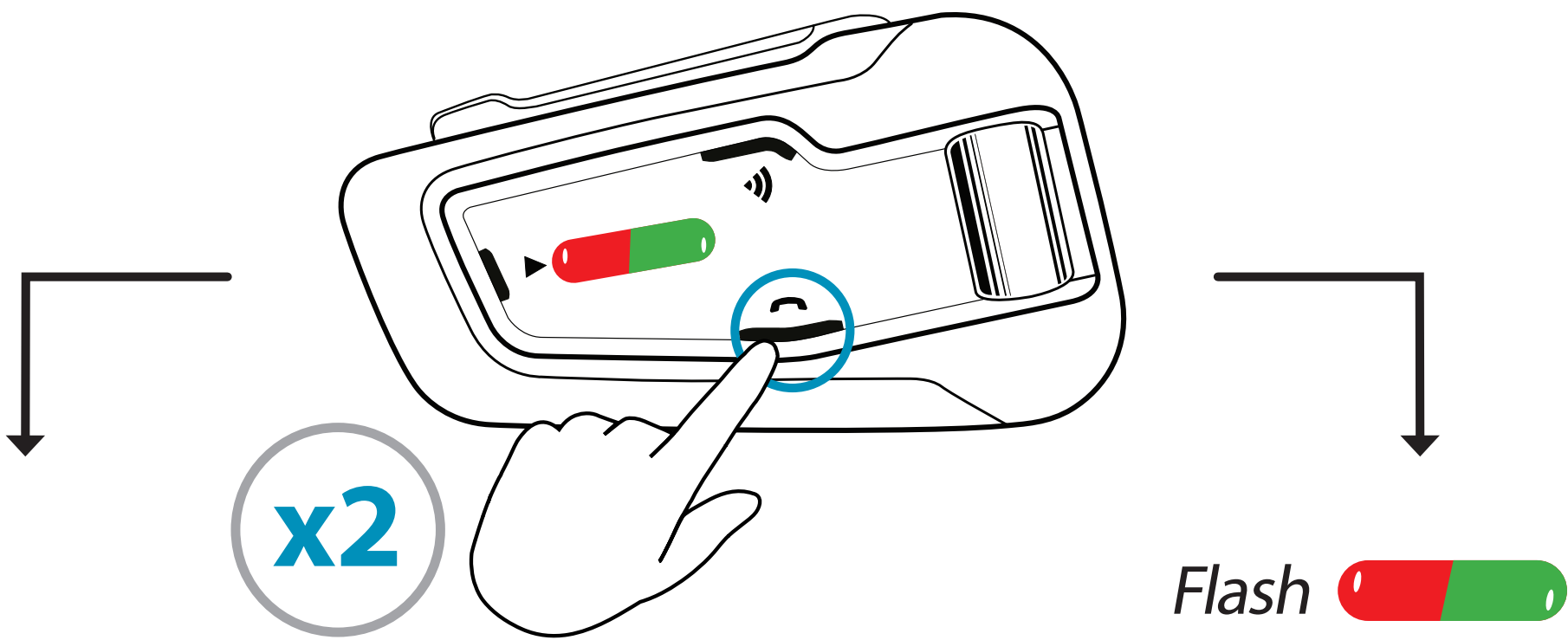

3 Pair Phone

Search for
Bluetooth
devices



3 Pair GPS

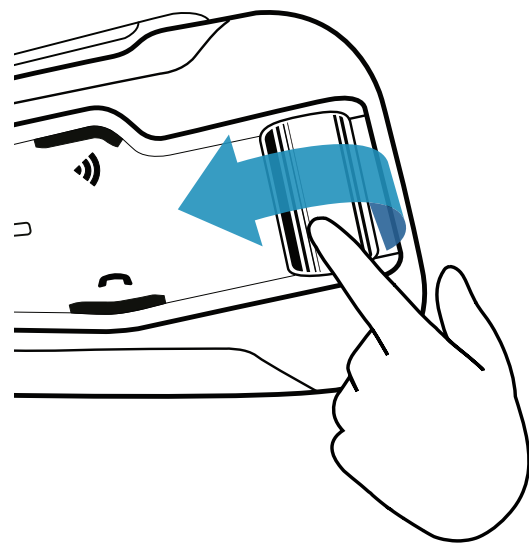

3a

Search for
Bluetooth
devices on
the GPS



END

Paired successfully

Flash



Phone



Voice Dial

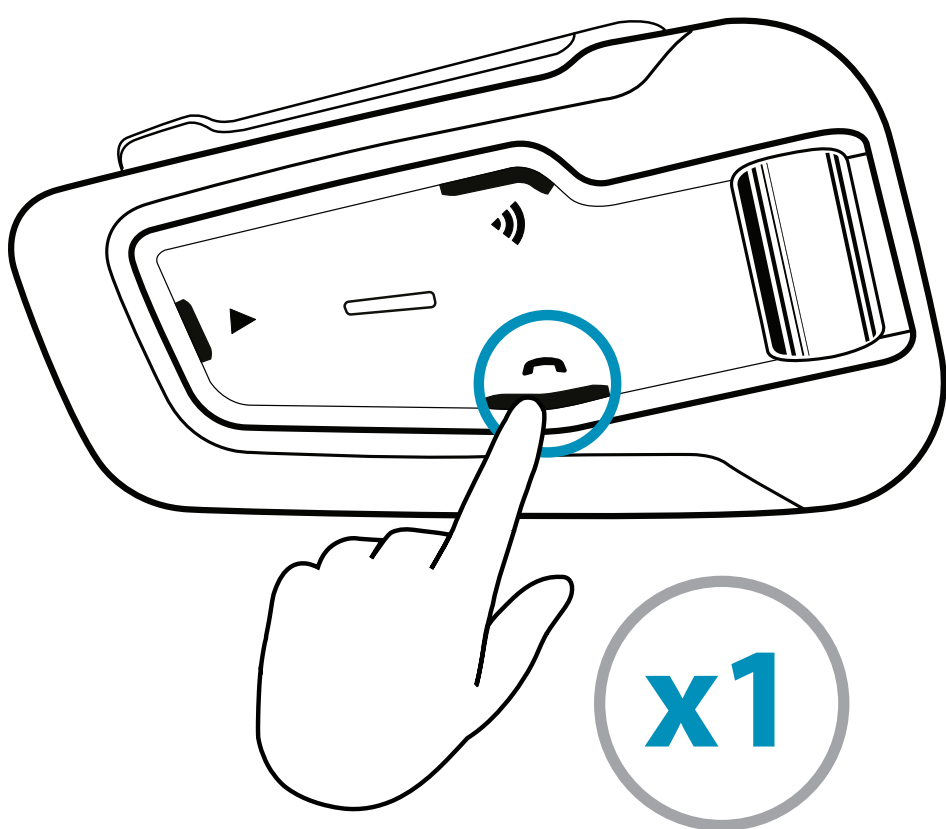

Redial

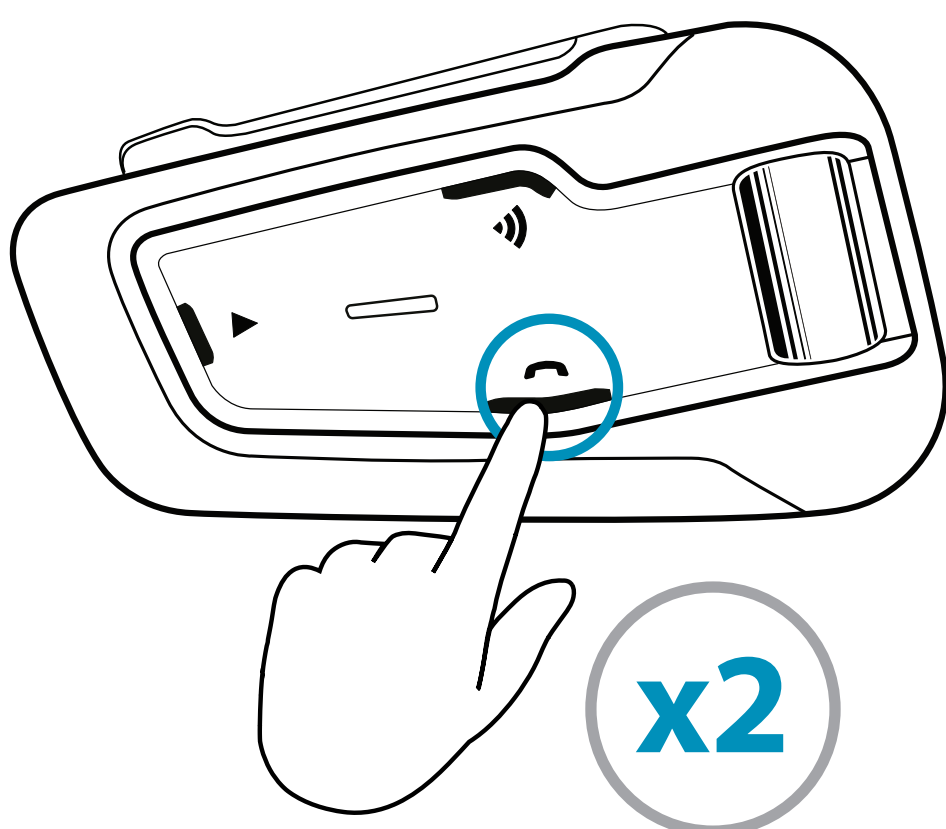

Speed Dial

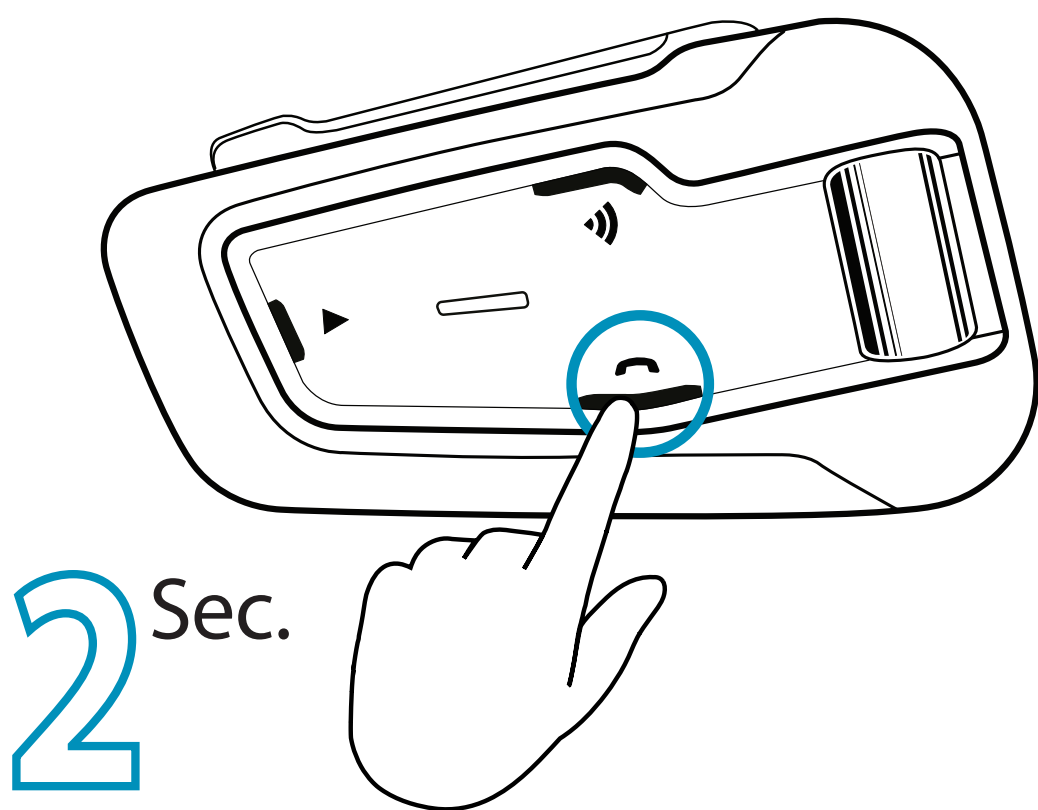

Set via app

Share call with DMC group

Bridging active phone calls to the DMC group

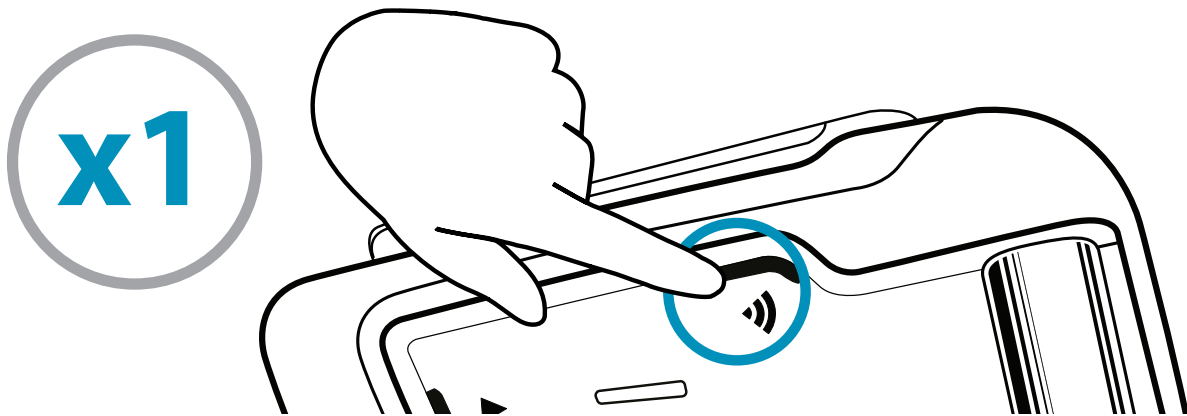

Start / Stop sharing call

Phone



Answer a Call

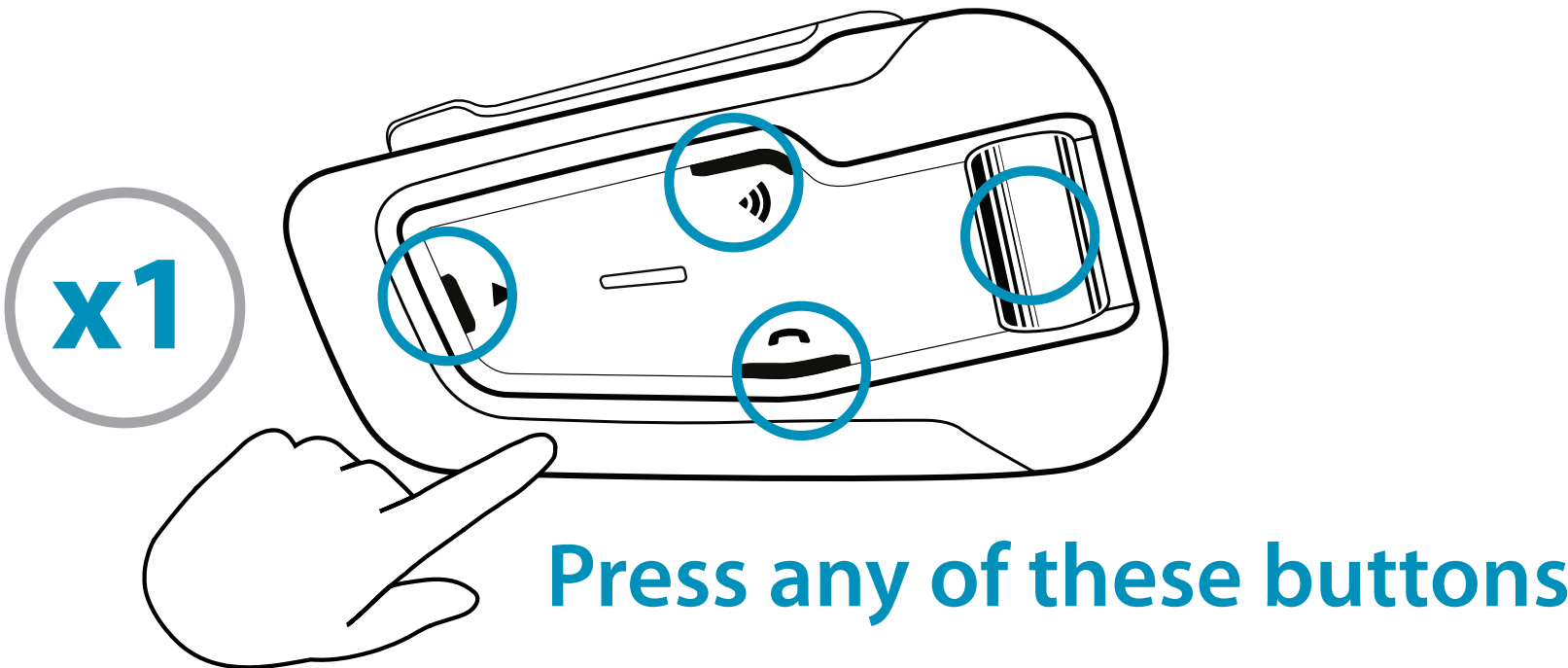

Ignore a Call

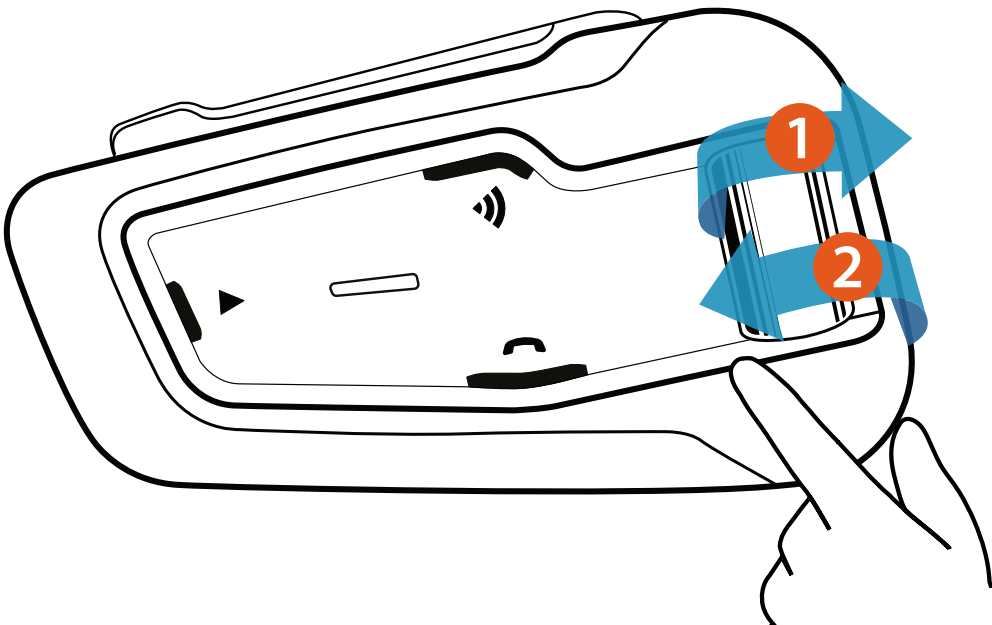

Reject a Call

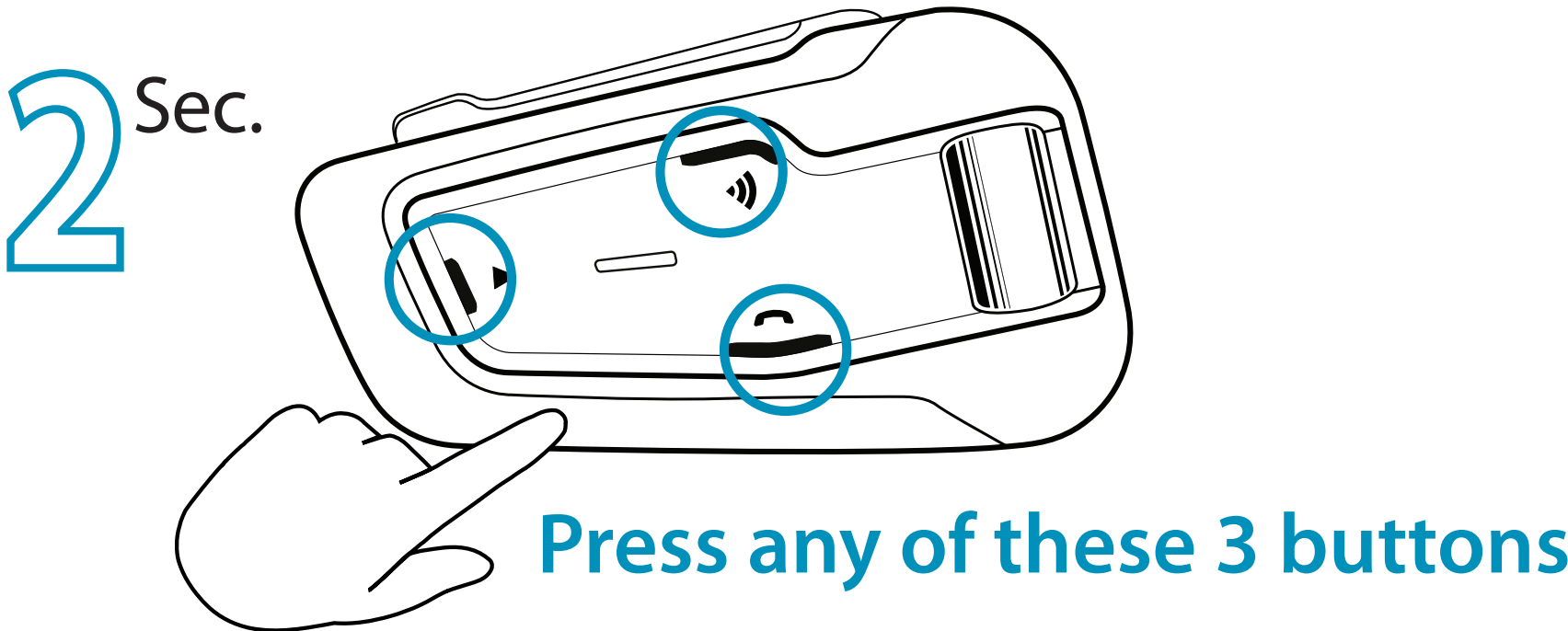

End a Call

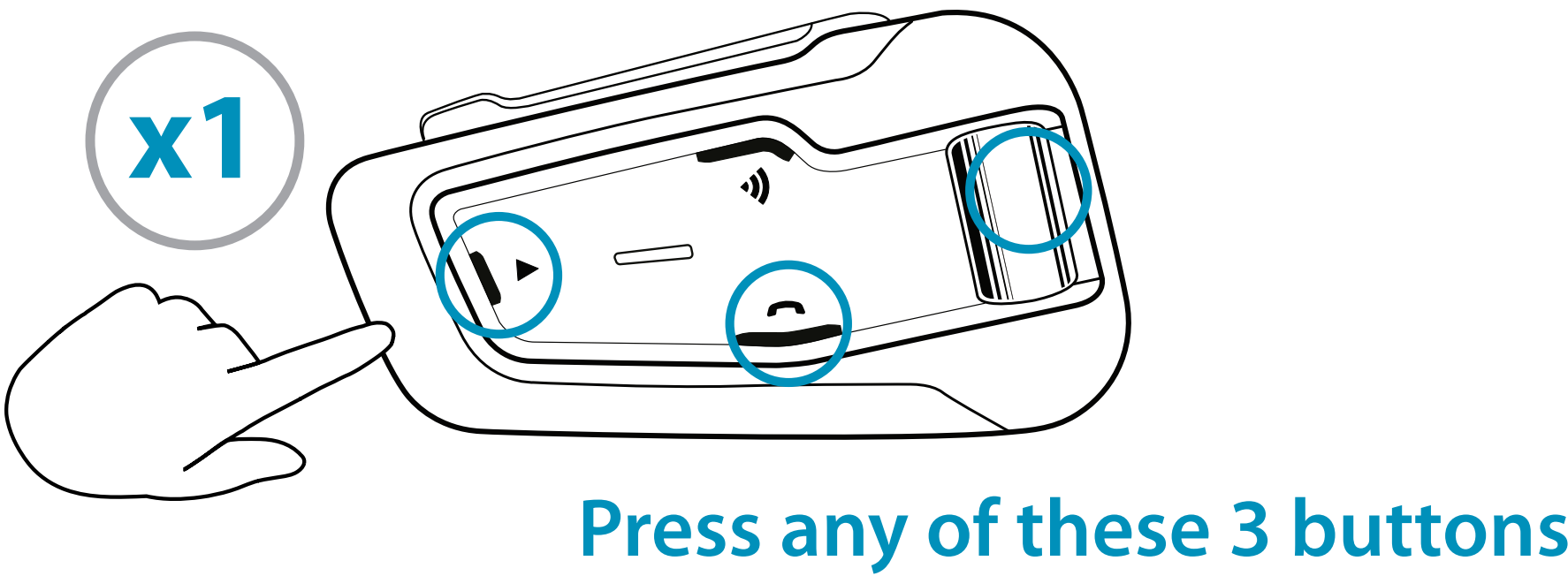

Audio

FM Radio



On



Off

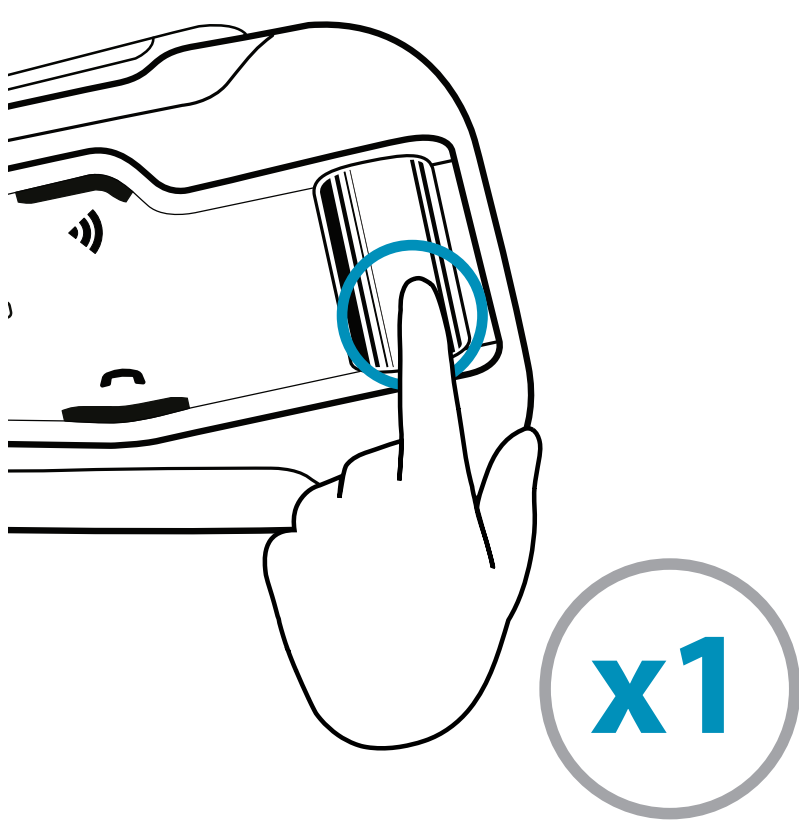
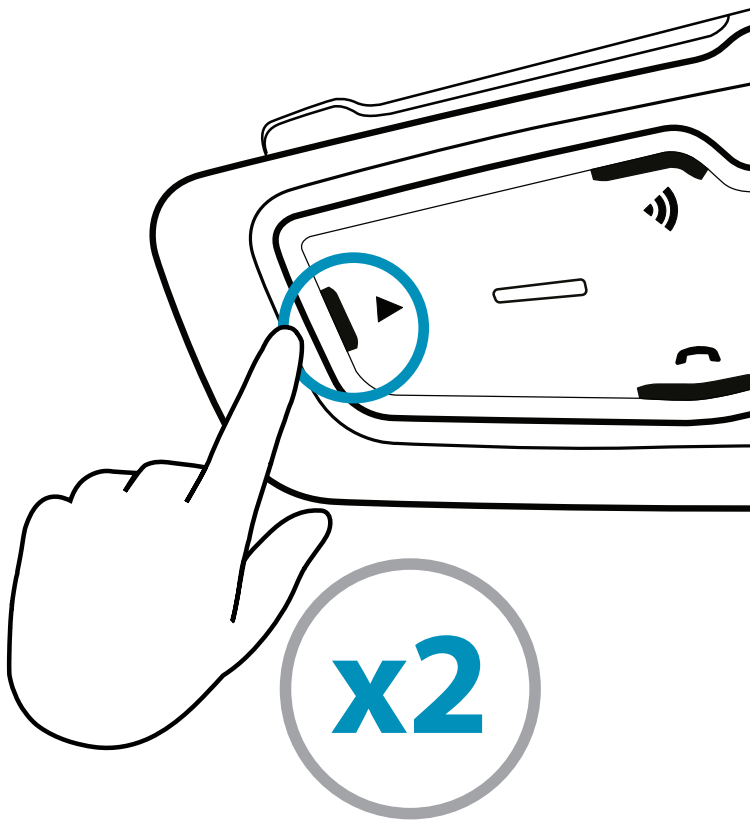

Previous



Next

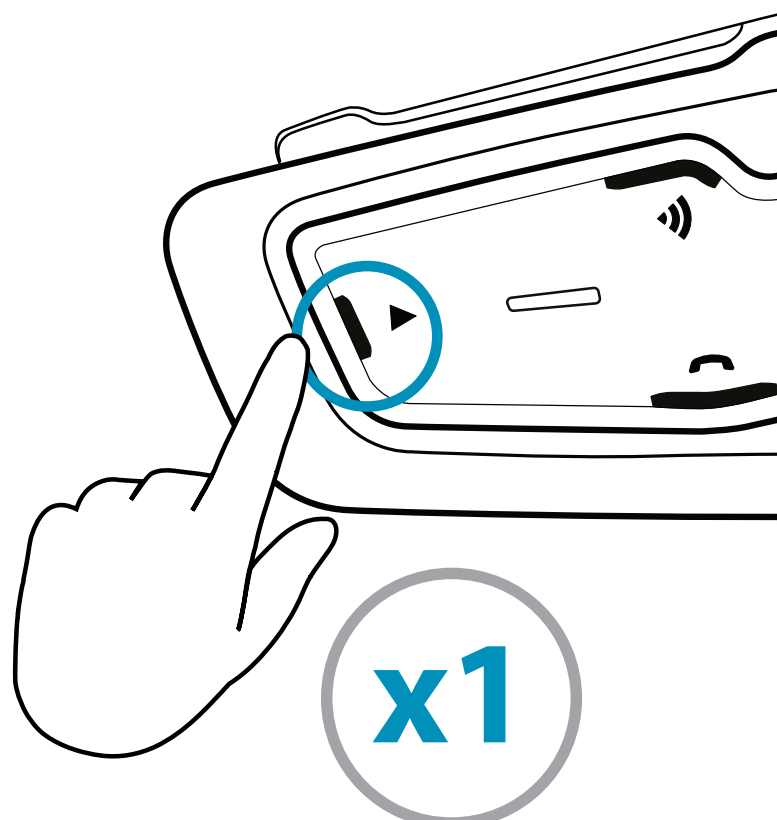
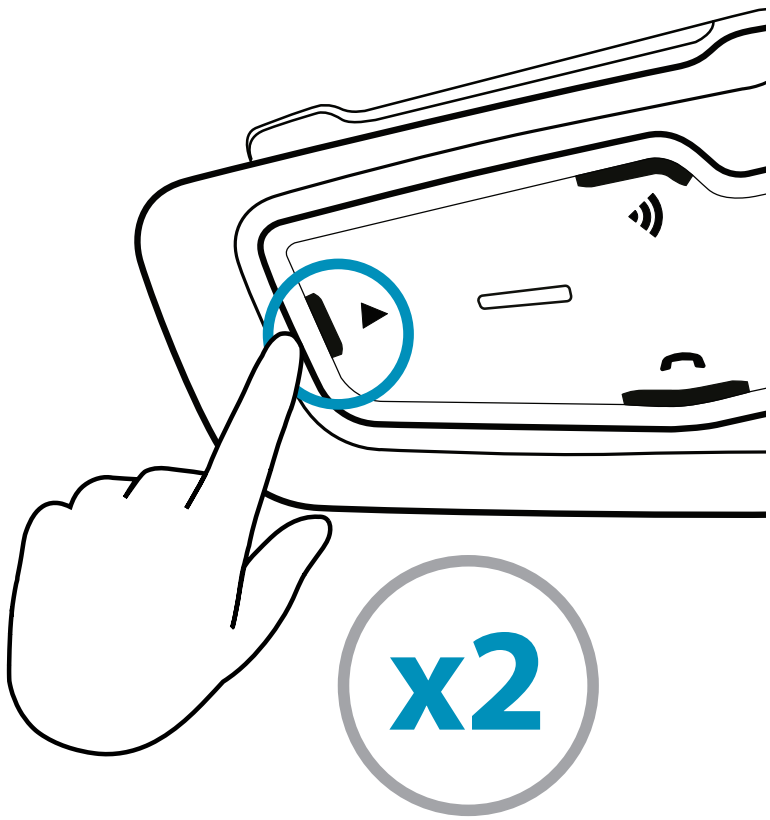

Auto Scan

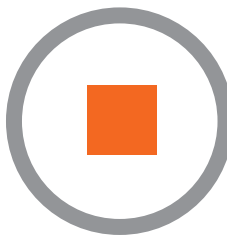

Stop Scan

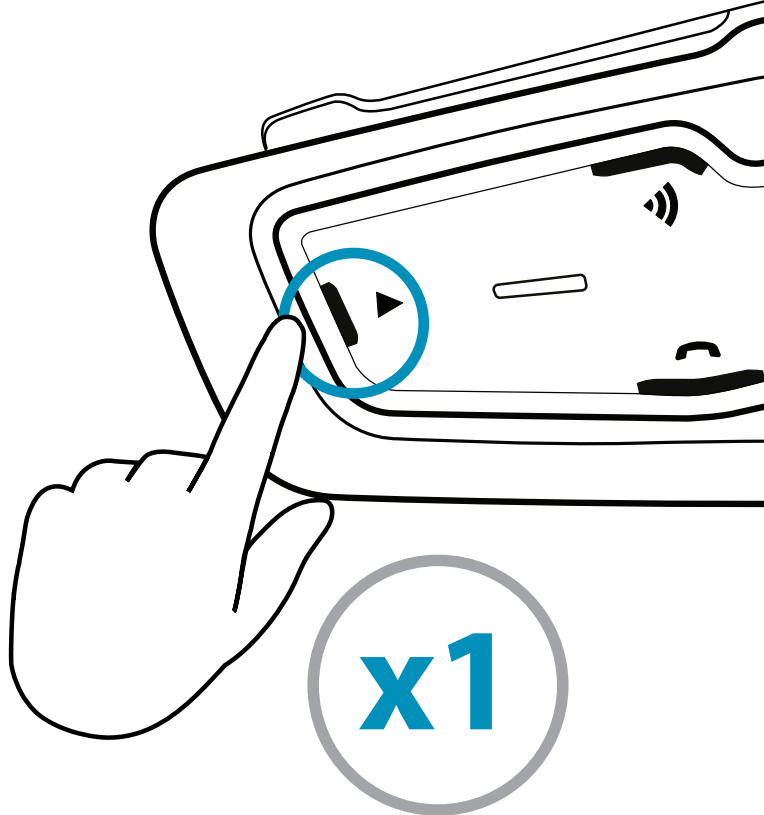
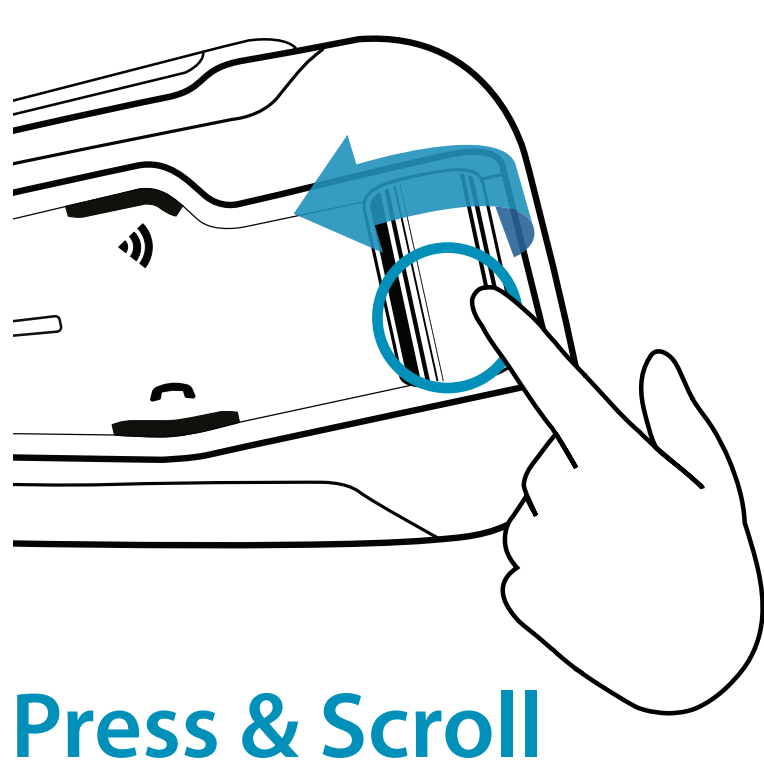

Audio

Music



On



Off

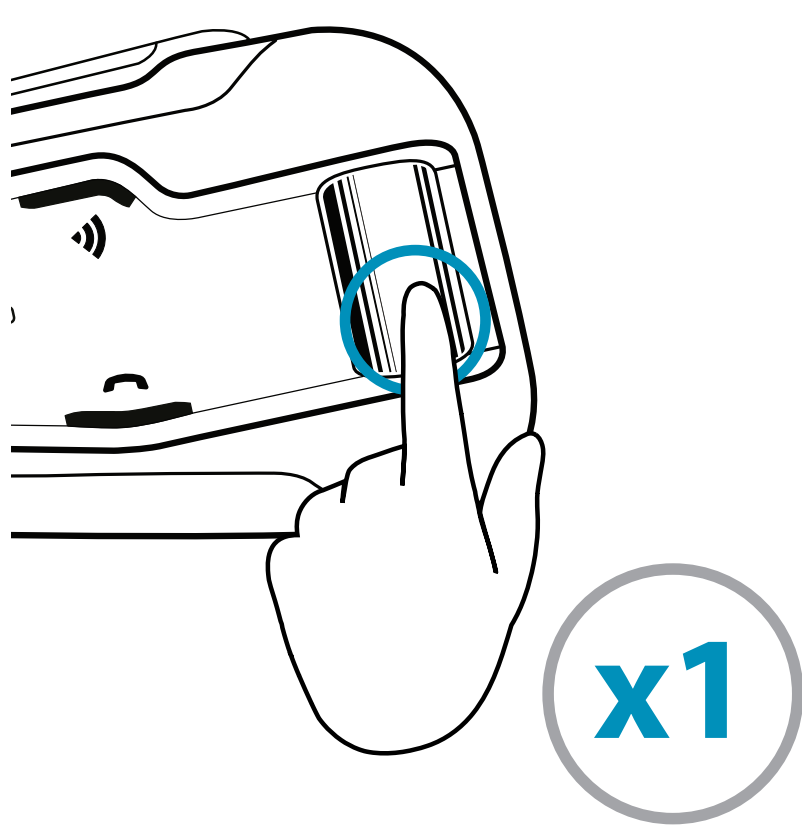
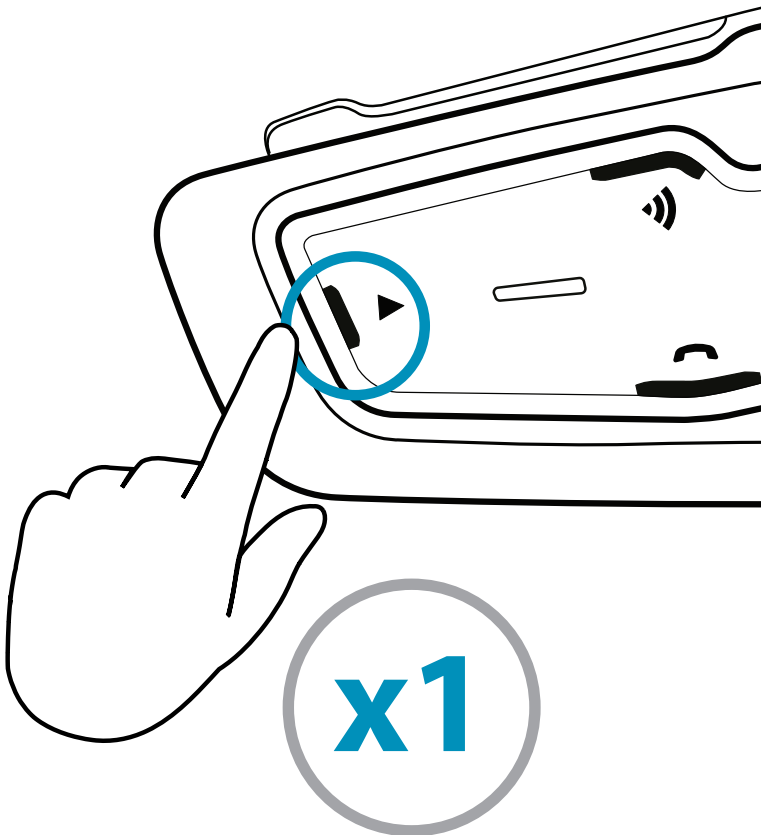

Previous



Next

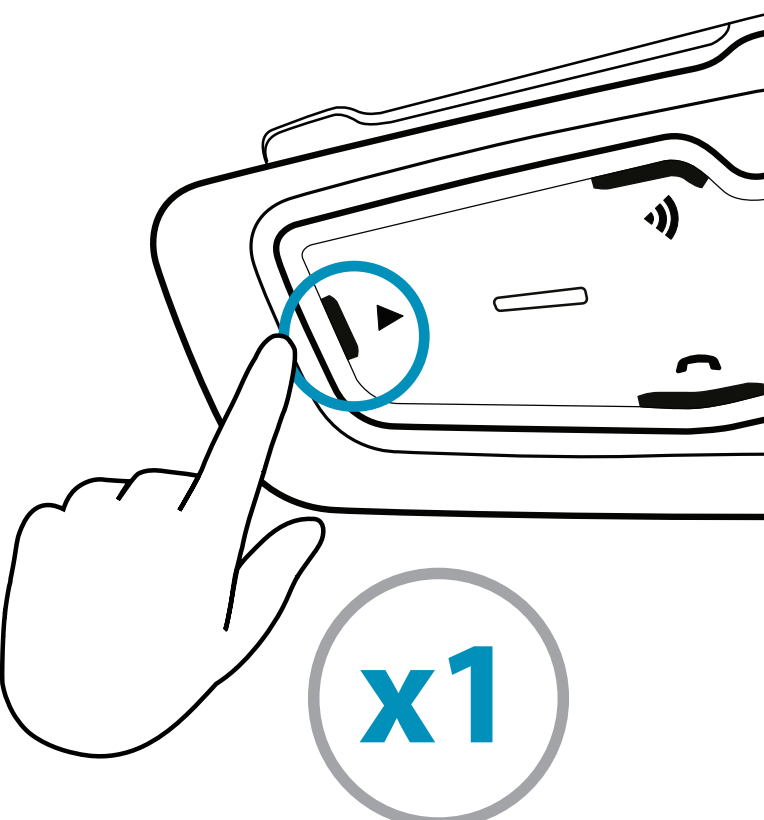
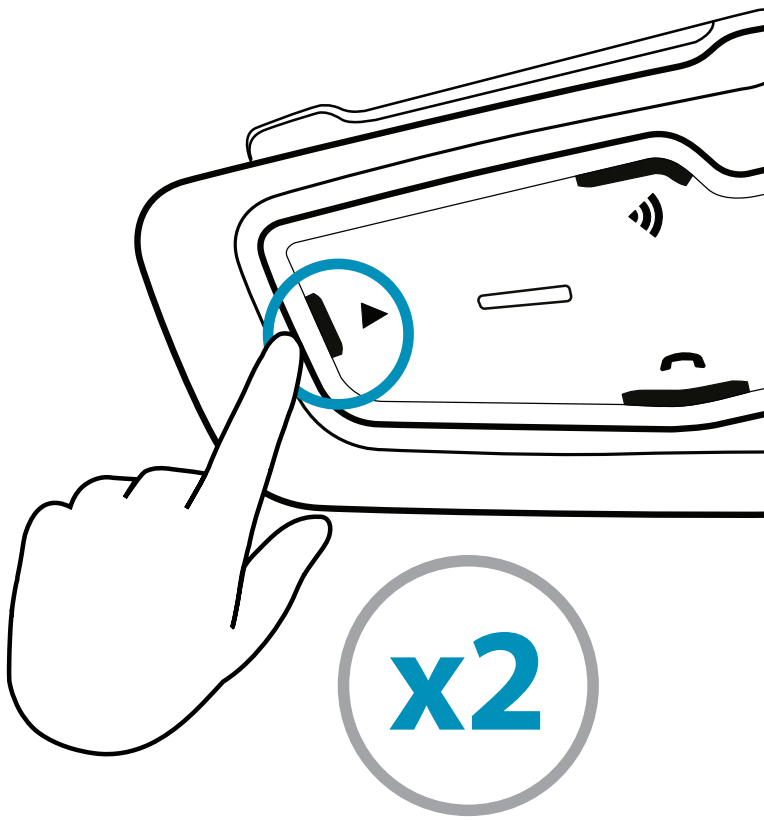

FM/ Music Toggle

2 Sec.

Sharing Audio

(When in Bluetooth mode)
See opposite page

2 Sec.

Start / Stop sharing

DMC Intercom Grouping

Verify you are in  DMC Mode *Flash* 

 **Bluetooth / DMC**
Change Intercom Mode

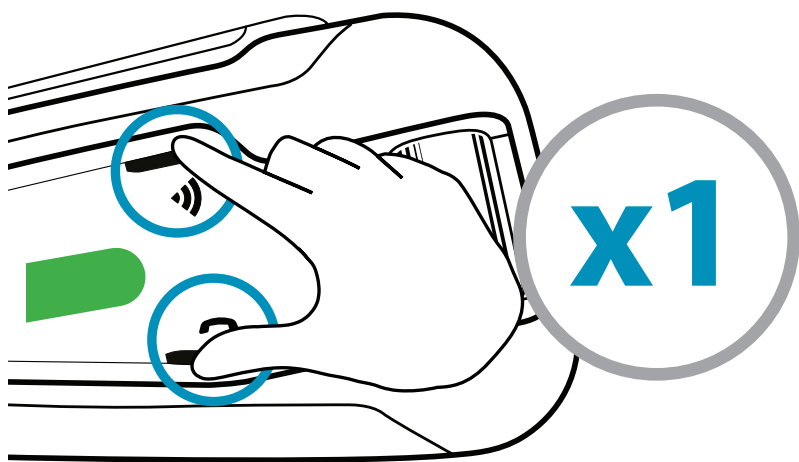

Create / Join a new DMC Group

1 Admin + all group members / new member

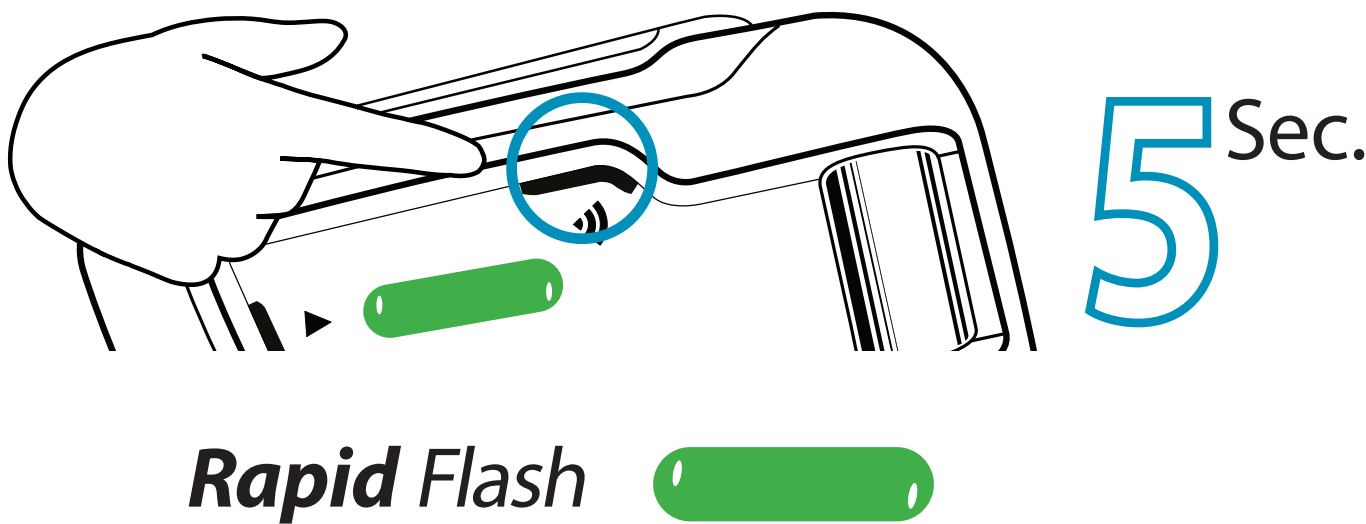

2 THEN ONLY ONE GROUP ADMIN

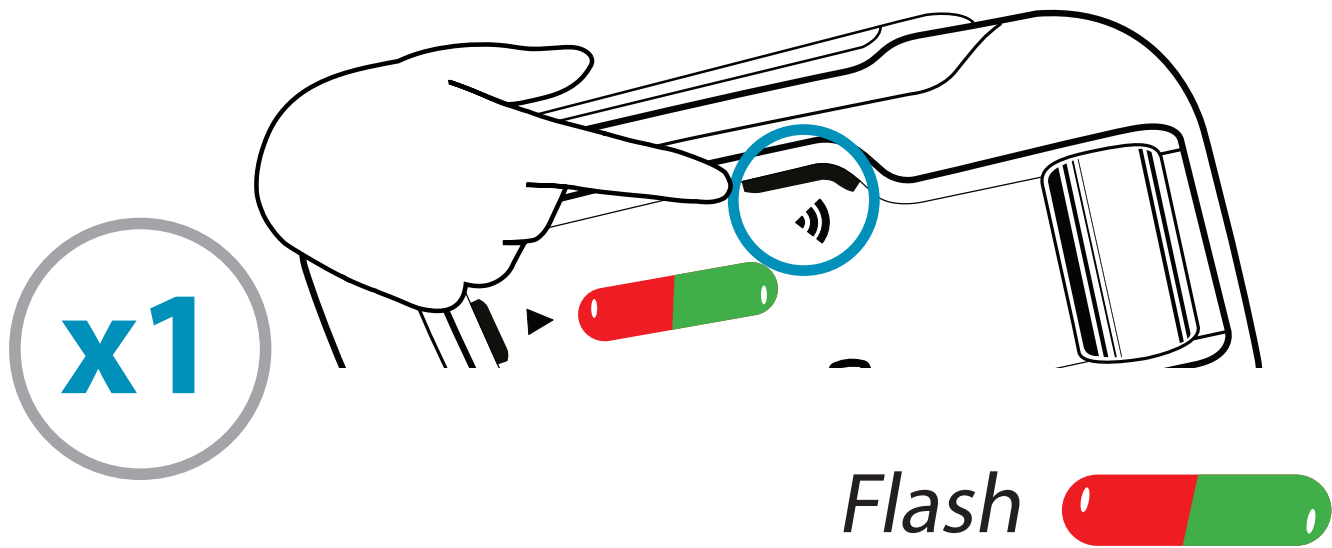

Grouped successfully *Flash* 

Cancel Grouping

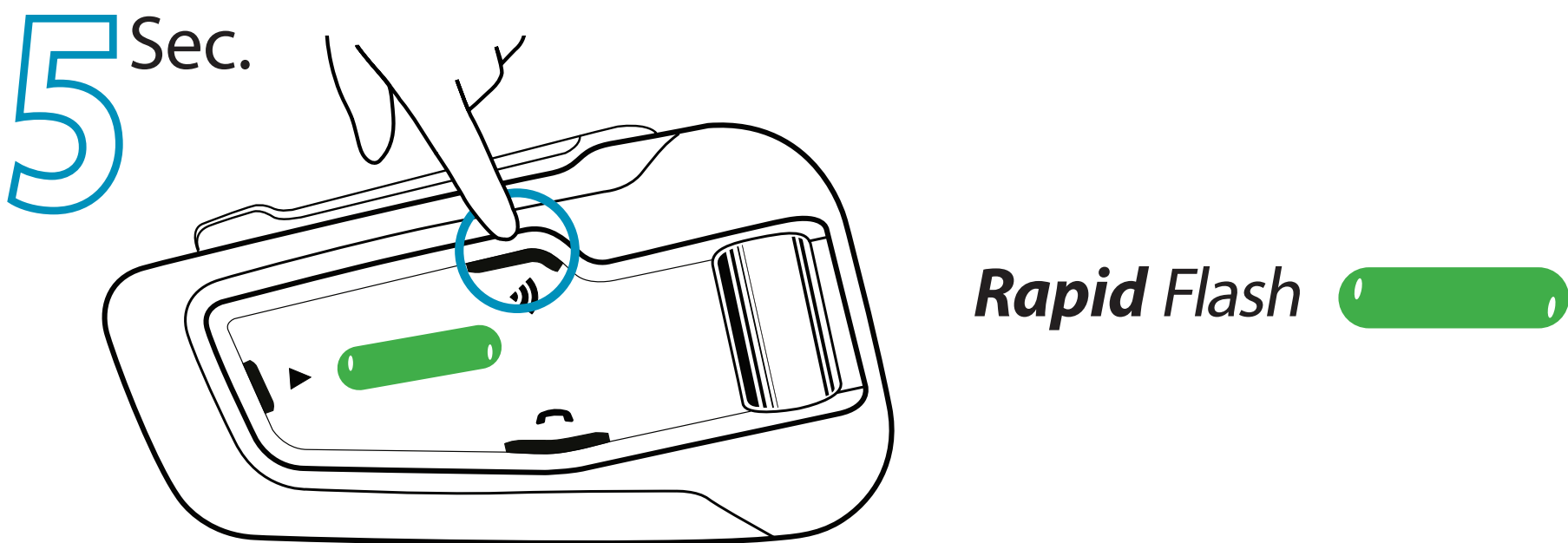

Using DMC Intercom

Talking - always on

 Mute Group /  Unmute Group

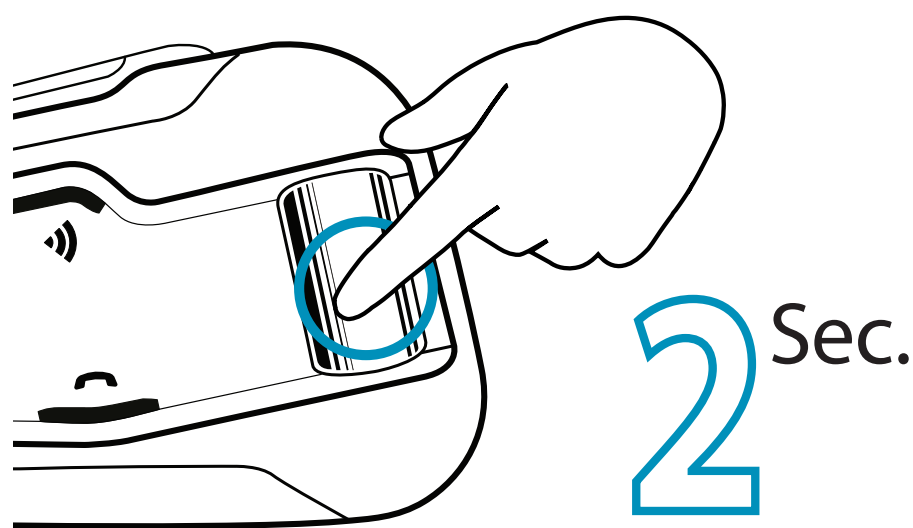

Private Chat

Chat privately with one of the group members

1 Choose member for private chat via Mobile App



2 Start / Stop chat

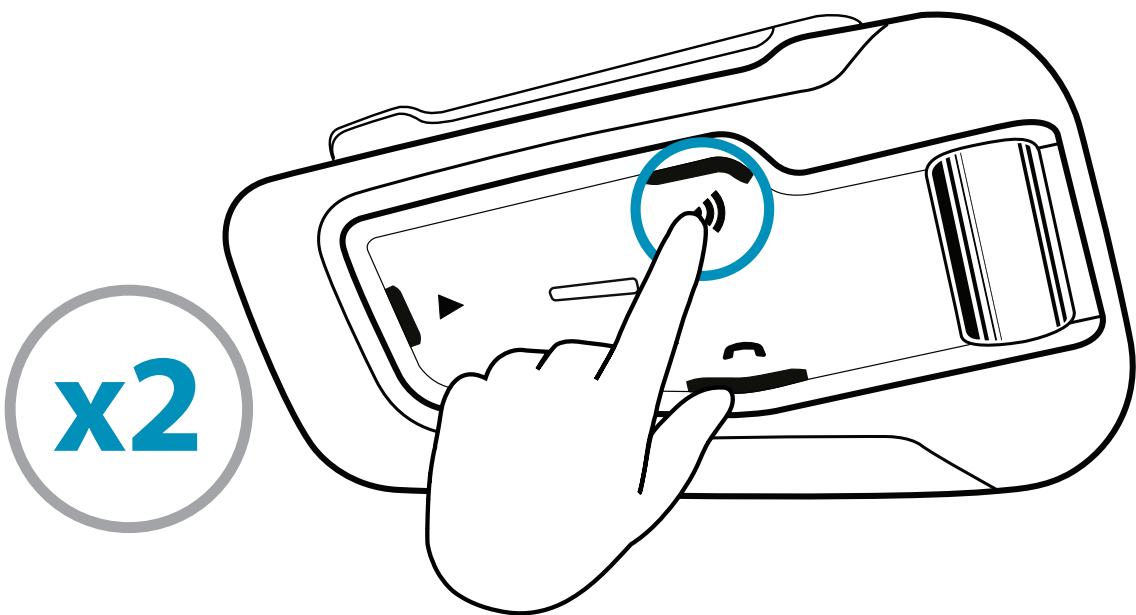

Bridge (add) a non-DMC passenger

1 **First**, verify that passenger is paired via Bluetooth.
(see 2-way Bluetooth intercom pairing)

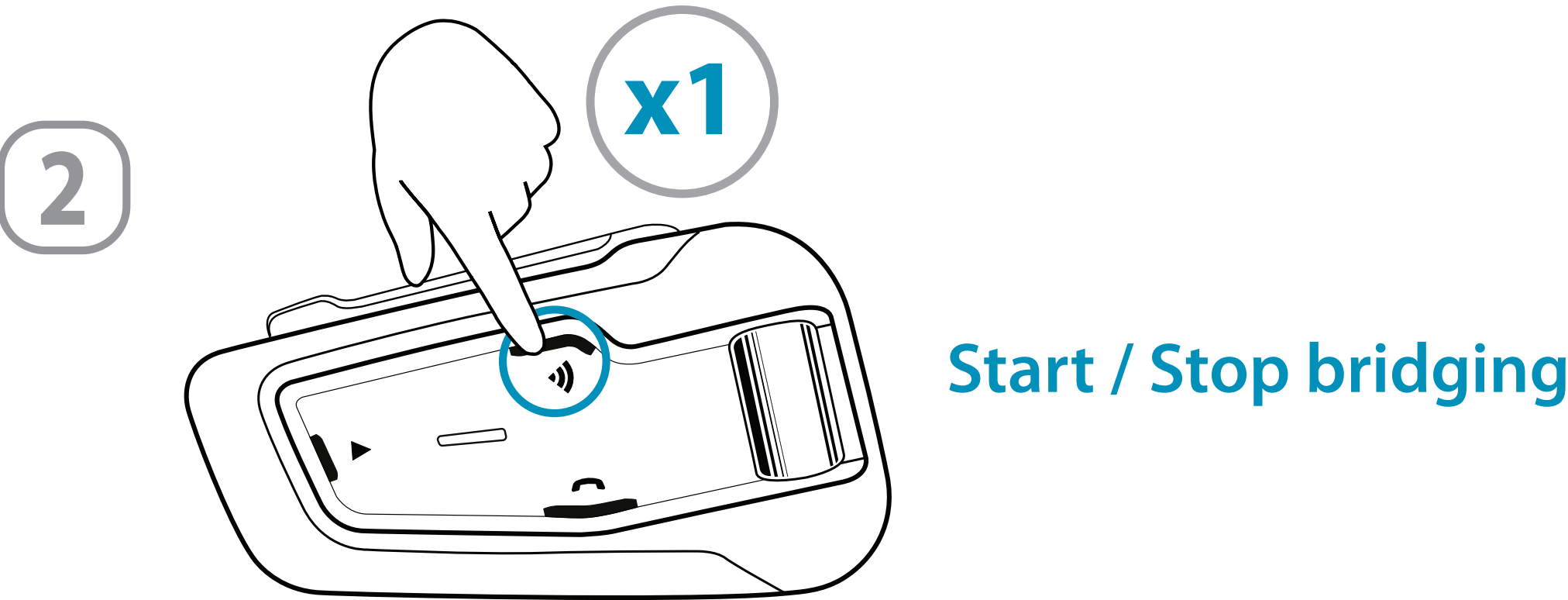

Set a Cardo non DMC Intercom

Verify you are in  Bluetooth Mode Flash 

 **Bluetooth / DMC**
Change Intercom Mode

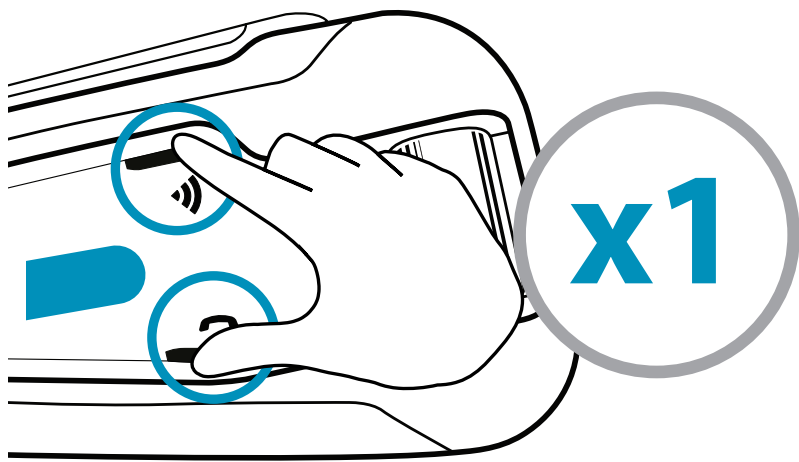

2-way
pairing

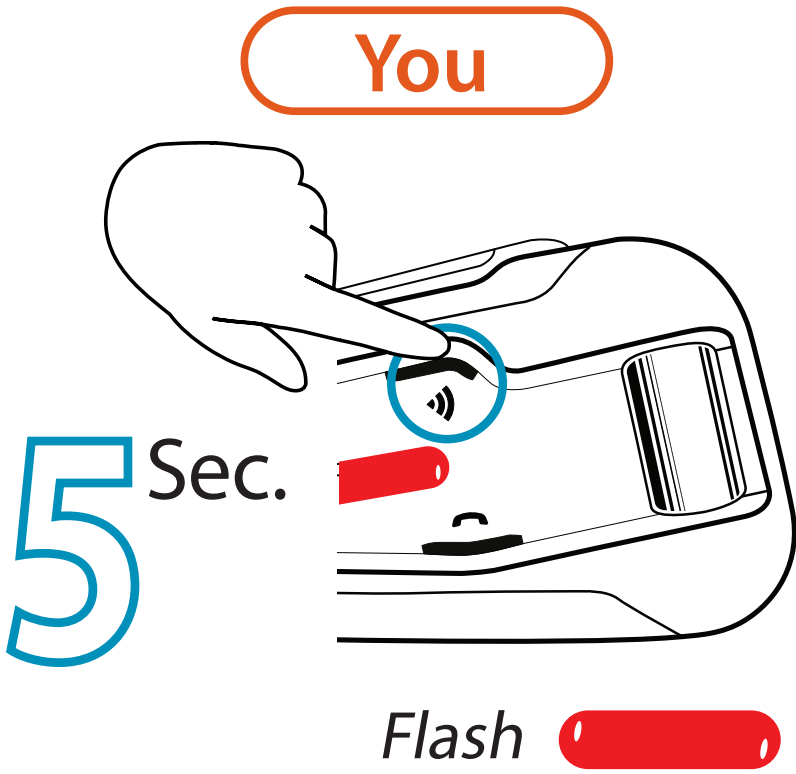

Initiate intercom pairing

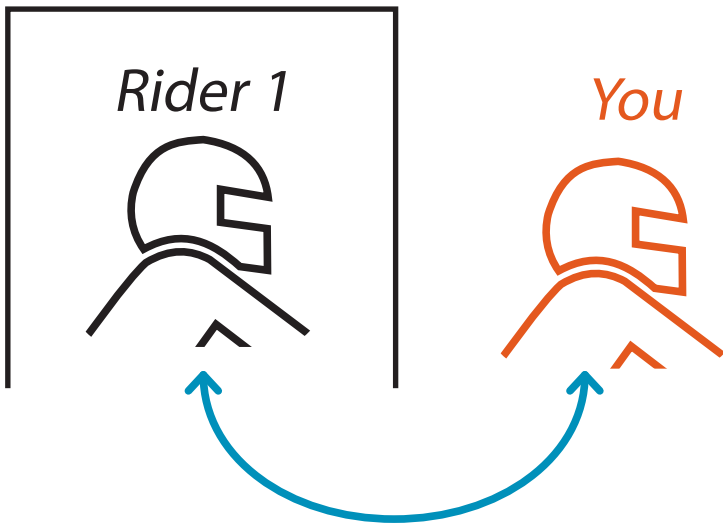

Adding
3rd rider

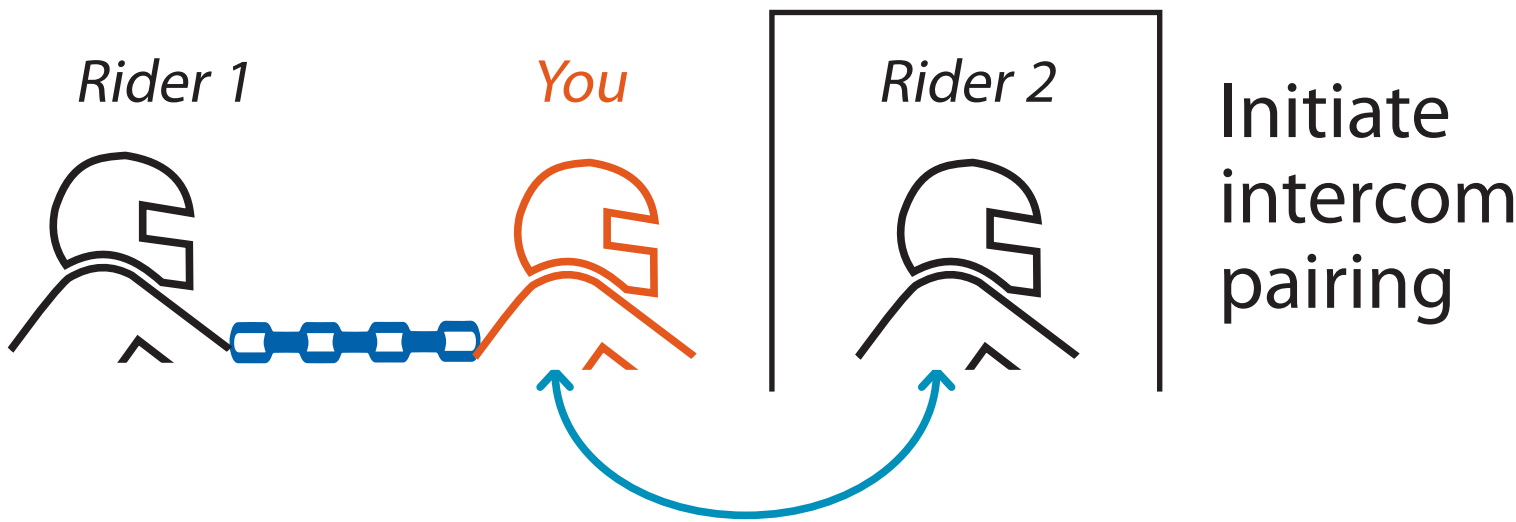
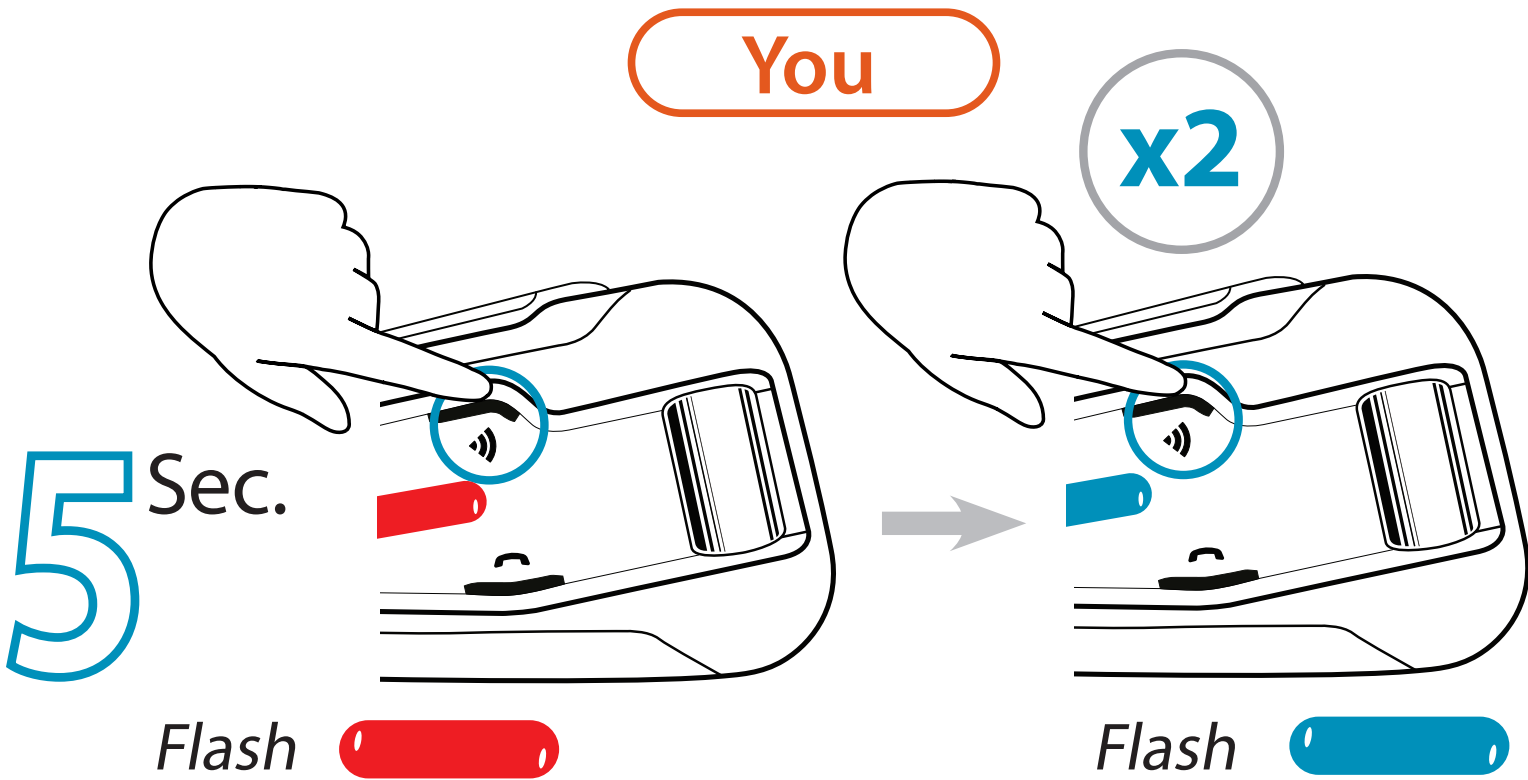

Adding
4th rider

Rider 2 connects to Rider 3
on Rider 2's free channel

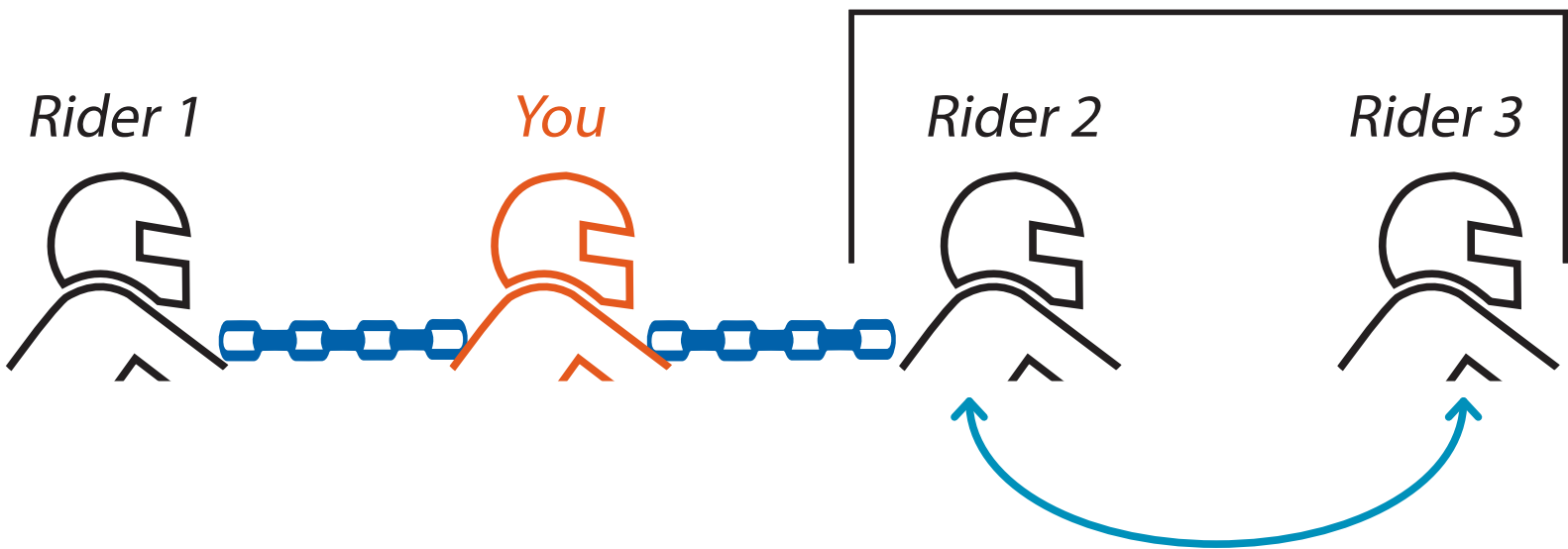

Set a universal intercom

Verify you are in  Bluetooth Mode Flash 

 **Bluetooth / DMC**
Change Intercom Mode

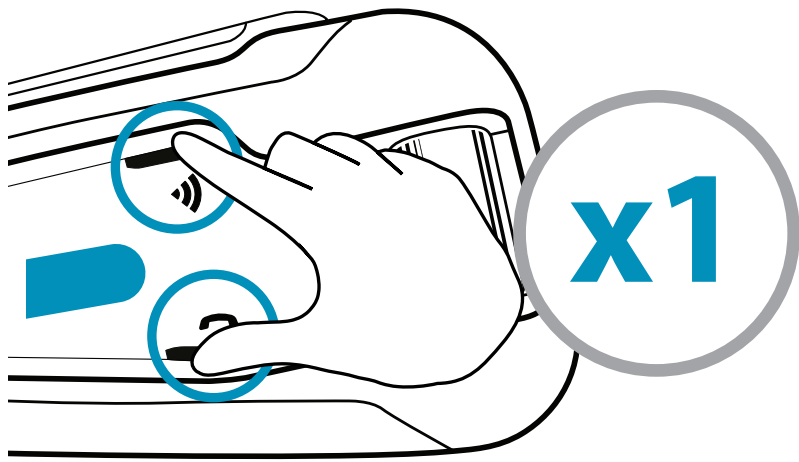

2-way pairing

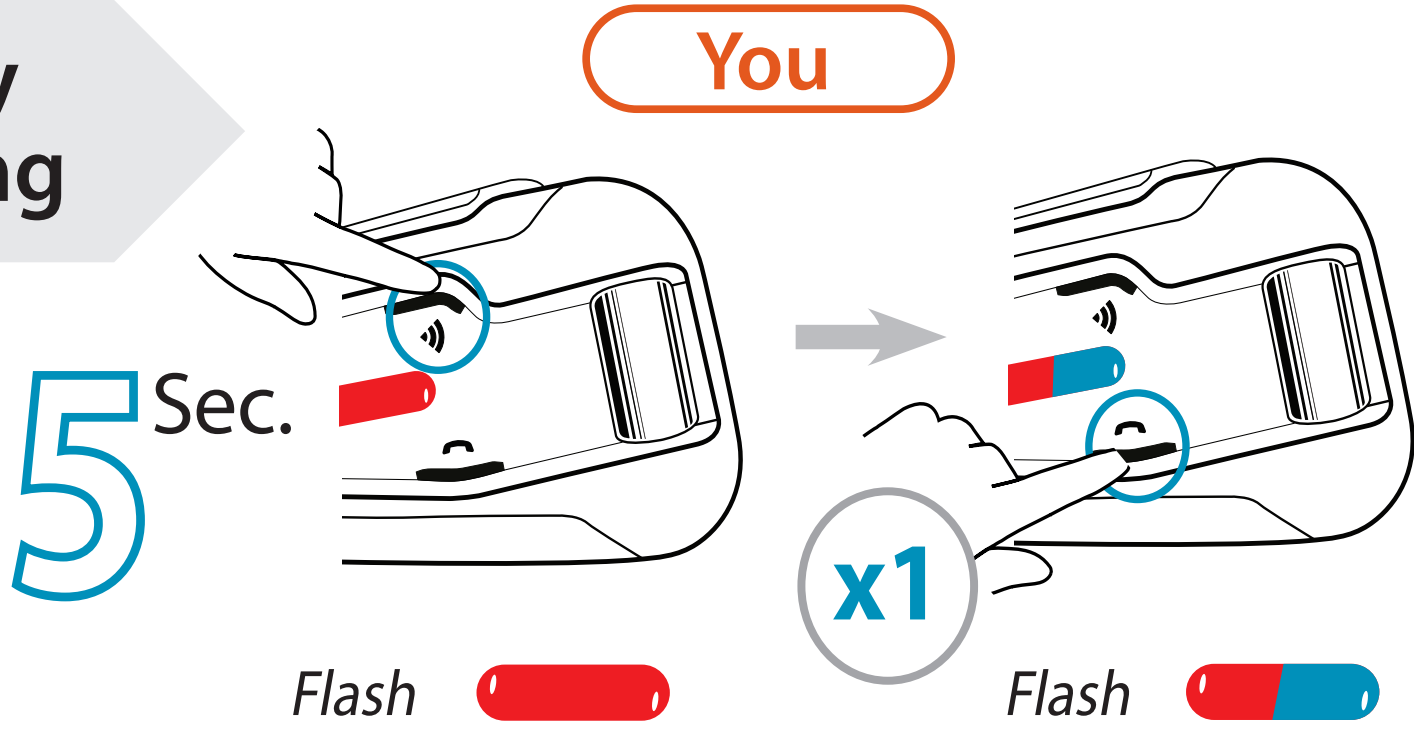

Initiate phone pairing

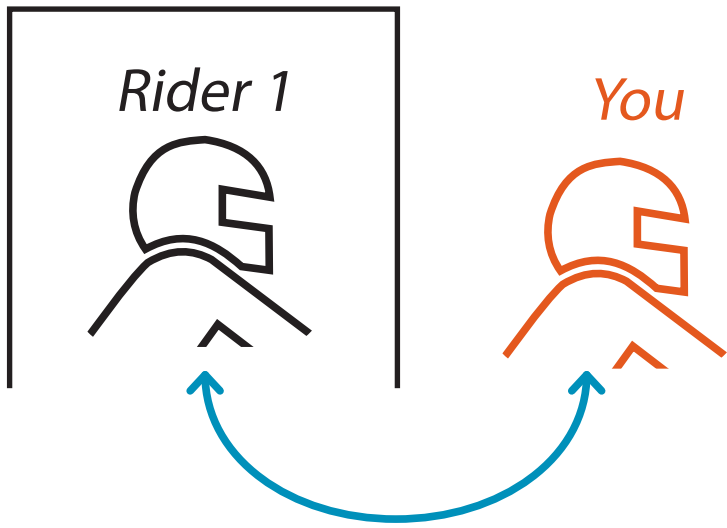

Adding 3rd rider

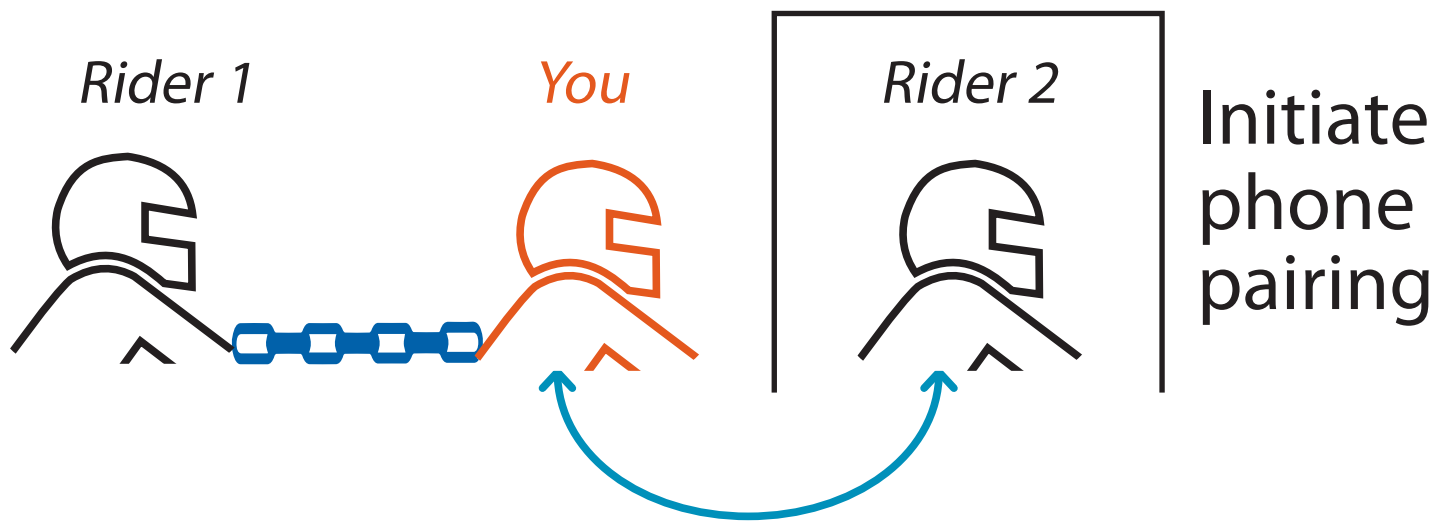
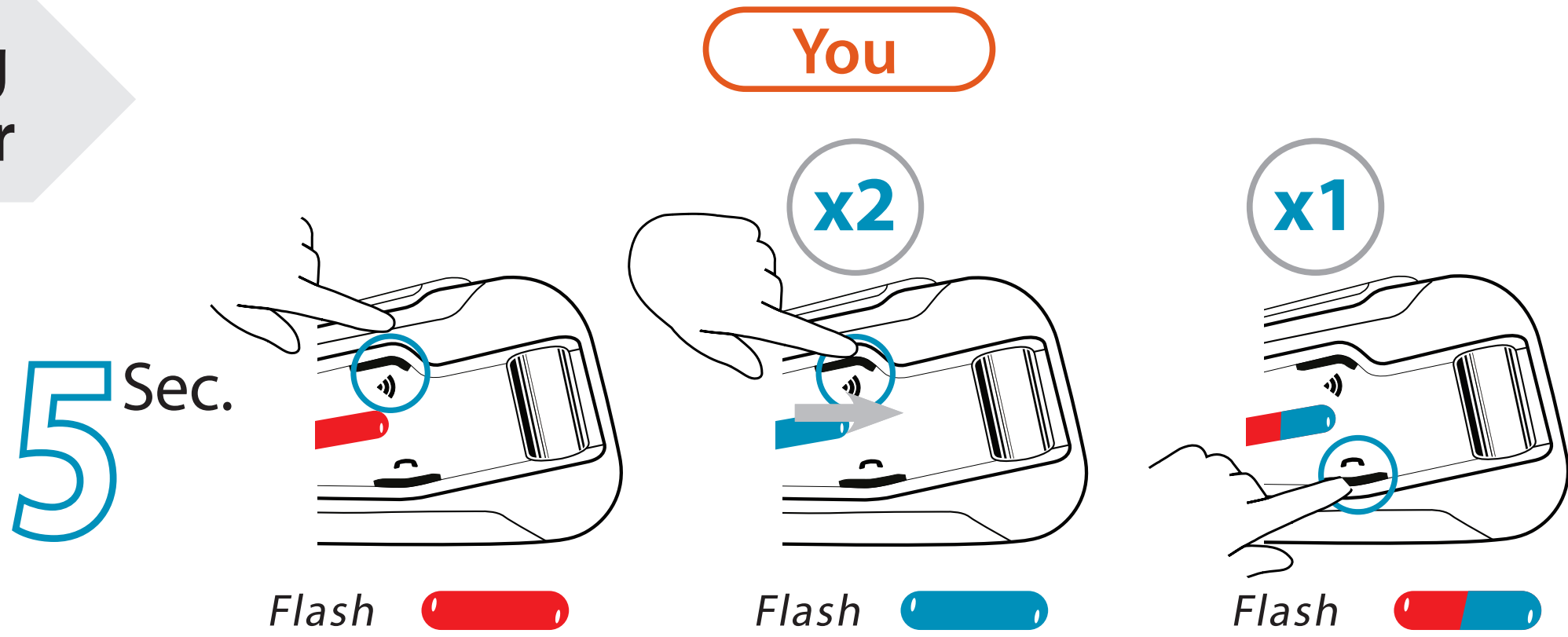

Adding 4th rider

Rider 2 connects to Rider 3 on Rider 2's free channel

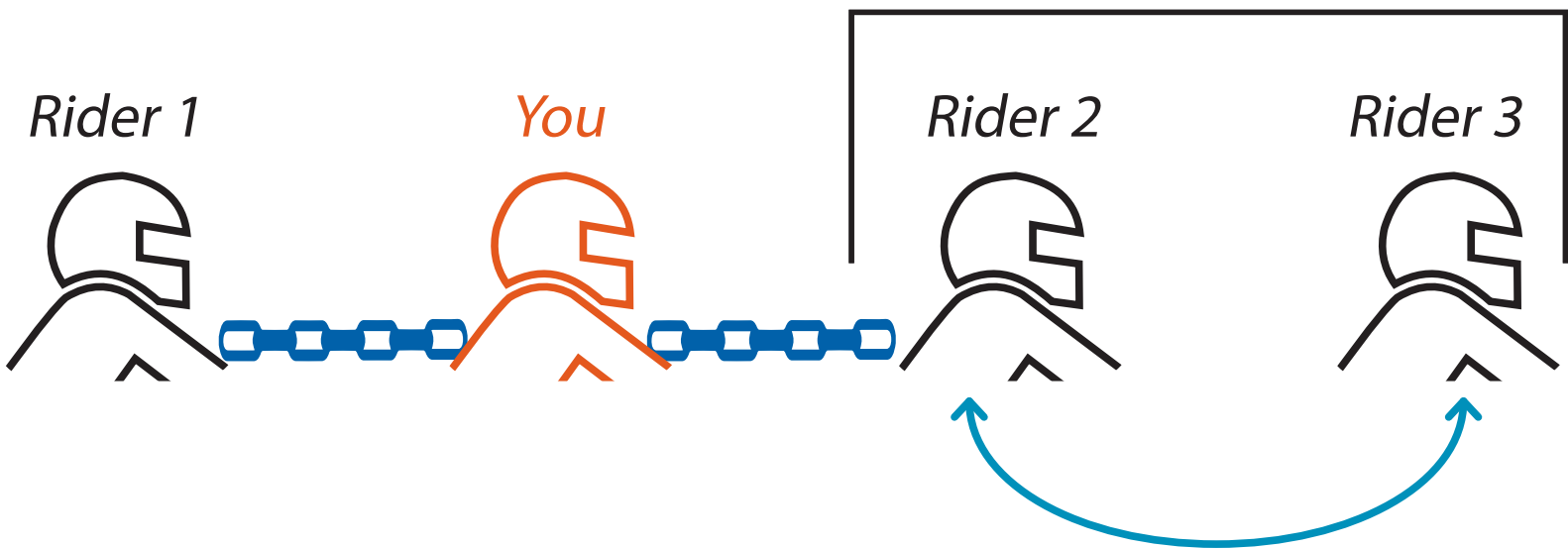

Intercom



Start / End / Add Rider 1

Rider 1

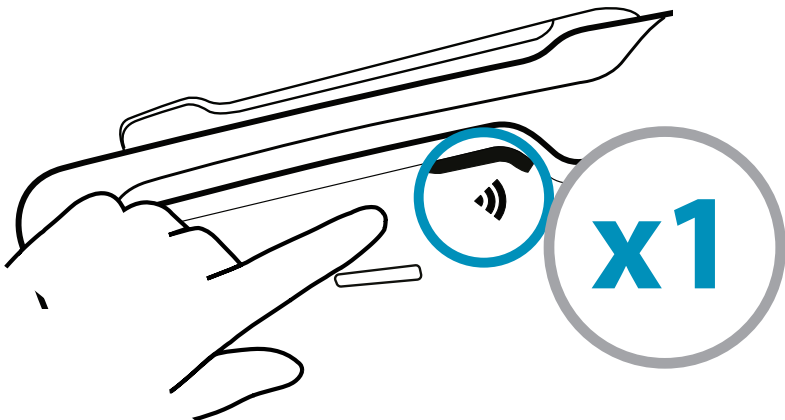

Start / End / Add Rider 2

Rider 2

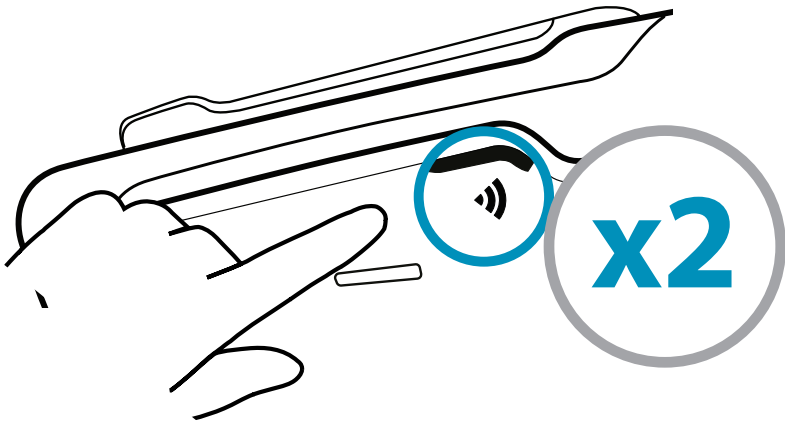

Initiate 4 way intercom Conference

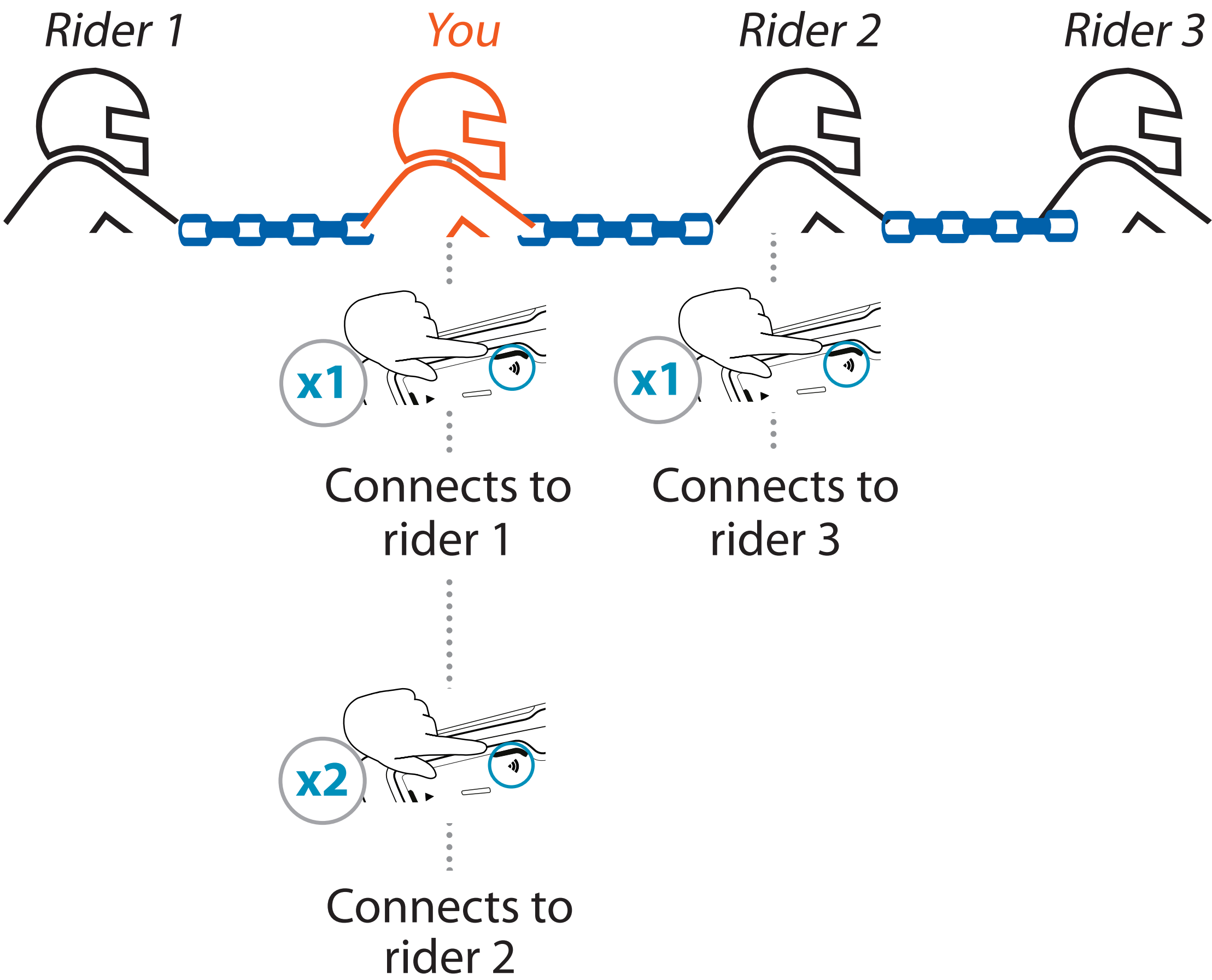

Voice Commands

Always On!



- “Hey Cardo, **radio on**”
- “Hey Cardo, **radio off**”
- “Hey Cardo, **next station**”
- “Hey Cardo, **previous station**”



- “Hey Cardo, **music on**”
- “Hey Cardo, **music off**”
- “Hey Cardo, **next track**”
- “Hey Cardo, **previous track**”



- “Hey Cardo, **volume up**”
- “Hey Cardo, **volume down**”
- “Hey Cardo, **mute audio**”
- “Hey Cardo, **unmute audio**”



- “Hey Cardo, **speed dial**”
- “Hey Cardo, **redial number**”
- **Answer**
- **Ignore**



- “Hey Siri”
- “Ok Google”



- “Hey Cardo, **battery status**”
- “Hey Cardo, **call intercom**”

Factory Reset

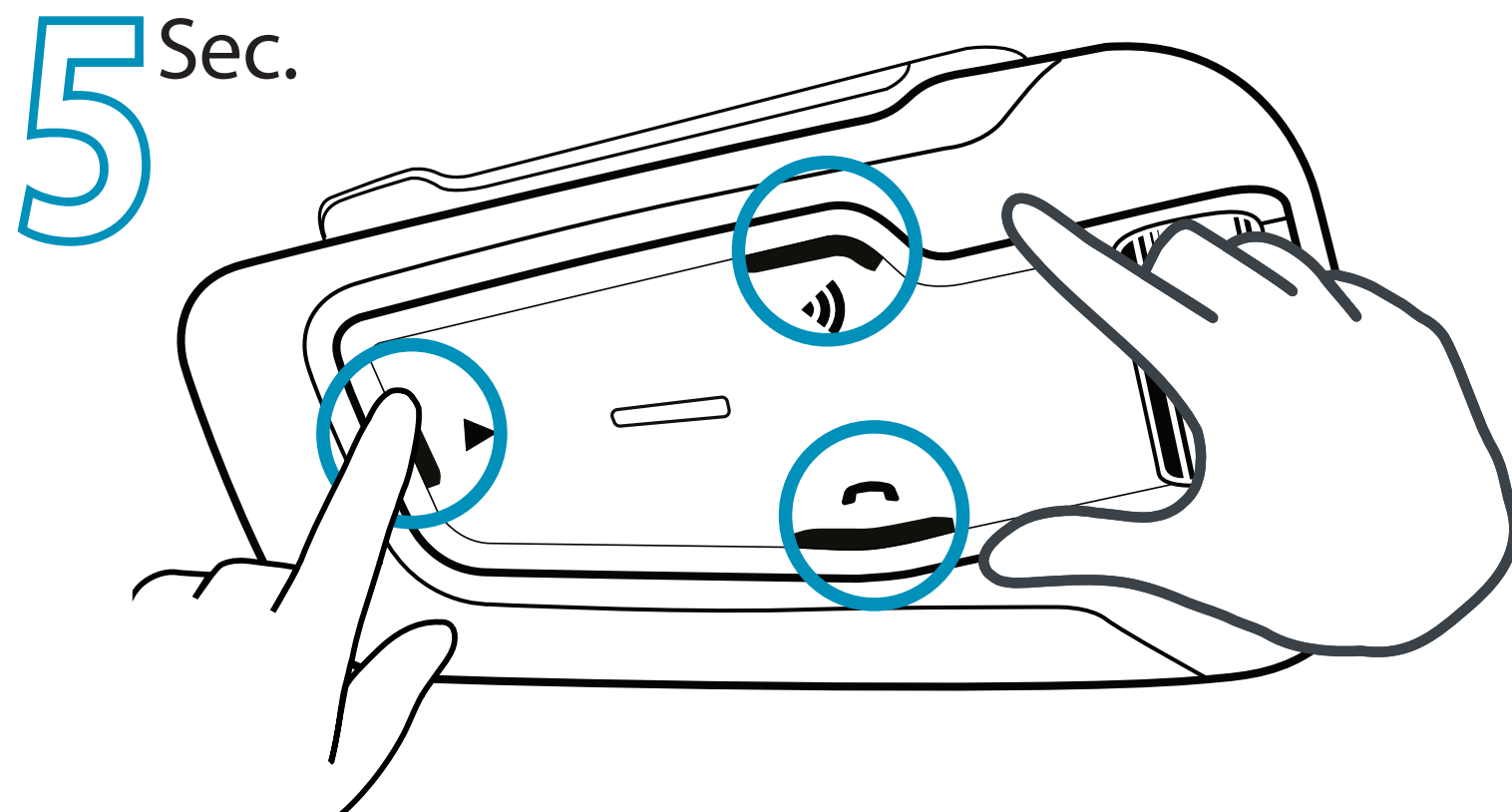

Cardo Mobile App

- Easy configuration
- Remote control operation
- On-the-go setting customization
- Managing DMC groups

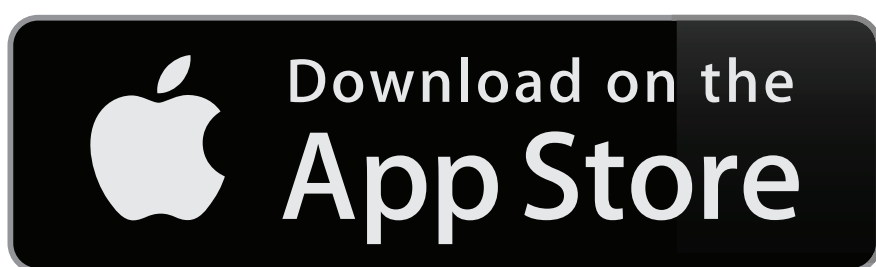

Cardo
Connect
App



Full version of the manual
cardosystems.com/support

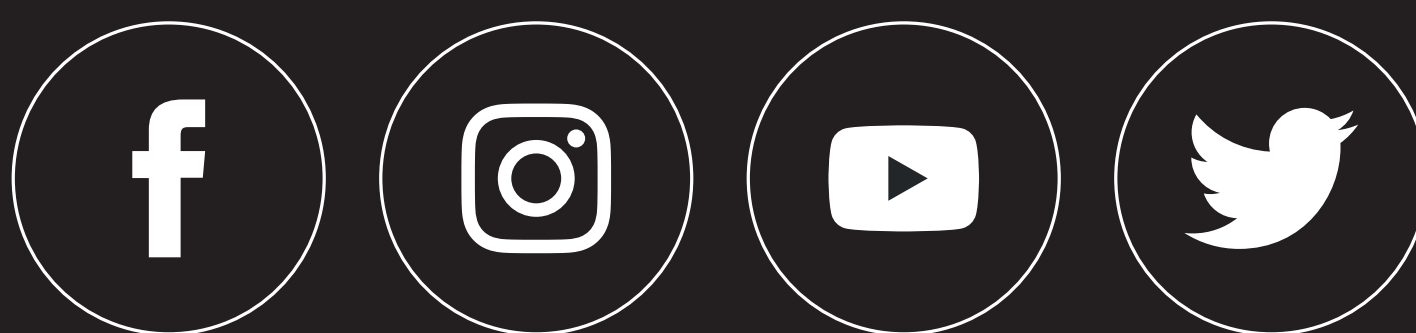

cardosystems.com